

July 21, 1994

Mr. Andrew Louis
P.O. Box 163
Honaunau, HI 96726

Dear Mr. Louis:

Ohana Dwelling Permit (OHD 94-214)
Tax Map Key: 8-7-13:27, Lot 11

3599

The subject application has been reviewed by the concerned agencies and note:

1. The subject tax map key parcel is served by an acceptable street;
2. The subject application can meet with the State Department of Health wastewater treatment and disposal systems requirements;
3. The copy of document(s) received relating to subject tax map key parcel to establish title and exhibits contained therein do not include any deed restriction or covenant to prohibit construction of requested ohana dwelling; and,
4. The site plan dated June 27, 1994 denotes two off-street parking stalls on the property.

In view of the above, by this letter, you are hereby granted permission to construct the Ohana Dwelling (Additional Single Family Dwelling), subject to the following condition(s):

- (a) The building permit for the Ohana Dwelling shall be applied for and secured from the Department of Public Works, Building Division on or before July 21, 1995. It should be noted that the permit is effective for only one (1) year and should applicant fail to secure a building permit within this period, a new application must be applied for.

Please bring or attach a copy of this Permit to expedite processing the building plans and building permit application to construct the ohana dwelling.

CG396

JUL 22 1994

Mr. Andrew Louis

Page 2

July 21, 1994

- (b) Off-street parking space for two vehicles is designated on the submitted site plan to fulfill the off-street parking requirement. The off-street parking spaces may not be employed for storage or other use unless and until approved alternative on-site parking arrangements are established.
- (c) All construction drawings together with approved site plan drawn to scale submitted with the ohana dwelling building permit application shall denote location and identify required two (2) off-street parking spaces.
- (d) The ohana dwelling shall conform to all requirements of codes and statutes pertaining to access and building construction.
- (e) The applicant shall conform to State Department of Health standards and regulations and following comment(s) dated July 13, 1994:

"The subject proposal is located in a critical wastewater Disposal Area. The existing cesspool may service a total of 1,000 gallons of wastewater. A total of five bedrooms are allowed in the two dwelling units. A second cesspool is not allowed. A septic tank system designed by a Registered Professional Engineer may be utilized."
- (f) This Ohana Dwelling permit is subject to all other applicable rules, regulations and requirements, including but not limited to those of the Planning Department, Department of Public Works, and State Department of Health.

Should you have any questions regarding the above, please feel free to contact Gilbert Bailado of my staff at 961-8288.

Sincerely,

VIRGINIA GOLDSTEIN
Planning Director

GB:kn:lcm
4546D

xc: Department of Health,
Chief Sanitarian
Real Property Tax Division - Kona
West Hawaii Office

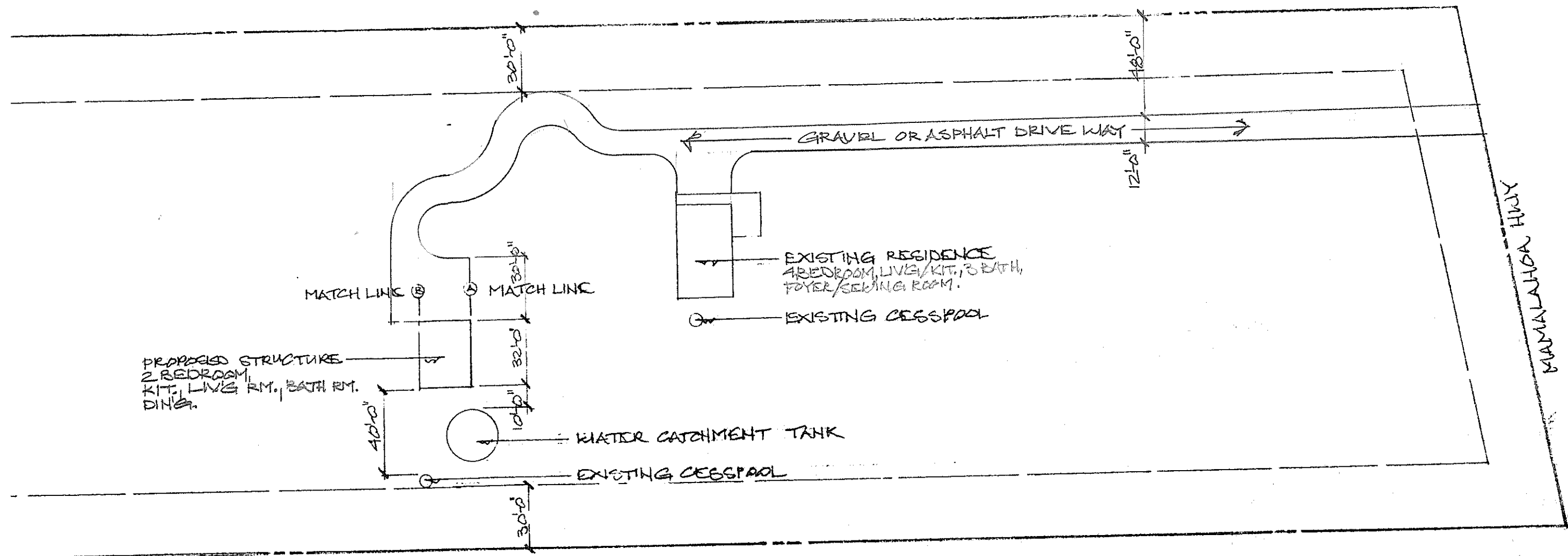

This set of approved plans and specifications shall be used at all times during construction.

PLOT LAYOUT

SCALE: 1" = 50'-0"
 OWNER: ANDREW LOUIS
 T.M.K: 8-7-13 LOT 11 PARCEL 27
 LOC: SOUTH KONA

Date _____
 APPROVED _____ BUILDING DEPARTMENT

THIS WORK WAS PREPARED BY ME OR UNDER MY SUPERVISION AND CONSTRUCTION OF THIS PROJECT WILL BE UNDER MY SUPERVISION. ANY CHANGE OR DEVIATION FROM THIS PLAN REQUIRES A REVIEW BY THE ARCHITECT.

[Signature]
 Signature

