

Stephen K. Yamashiro  
Mayor

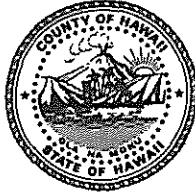

Virginia Goldstein  
Director

Norman Olesen  
Deputy Director

## County of Hawaii

### PLANNING DEPARTMENT

25 Aupuni Street, Room 109 • Hilo, Hawaii 96720-4252  
(808) 961-8288 • Fax (808) 961-9615

August 25, 1995

Mr. Rohn Marvick  
P.O. Box 2339  
Kailua-Kona, HI 96745

(94-357)

Dear Mr. Marvick:

Ohana Dwelling Permit (OHD 3748)  
Deborah L. Koehn & David Blehert  
Tax Map Key: 8-6-13:41

The subject application has been reviewed by the concerned agencies and note:

1. The subject tax map key parcel is served by an acceptable street;
2. The subject application can meet with the State Department of Health wastewater treatment and disposal systems requirements;
3. The copy of document(s) received relating to subject tax map key parcel to establish title and exhibits contained therein do not include any deed restriction or covenant to prohibit construction of requested Ohana dwelling; and,
4. The site plan denotes two off-street parking stalls on the property.

In view of the above, by this letter, you are hereby granted permission to construct the Ohana Dwelling, subject to the following condition(s):

- (a) The building permit for the Ohana Dwelling shall be applied for and secured from the Department of Public Works, Building Division.

Please bring or attach a copy of this Permit to expedite processing the building plans and building permit application to construct the Ohana dwelling.

C5987

AUG 28 1995

Mr. Rohn Marvick  
Page 2  
August 25, 1995

- (b) Off-street parking space for two vehicles is designated on the submitted site plan to fulfill the off-street parking requirement. The off-street parking spaces may not be employed for storage or other use unless and until approved alternative on-site parking arrangements are established.
- (c) All construction drawings together with approved site plan drawn to scale submitted with the Ohana dwelling building permit application shall denote location and identify required two (2) off-street parking spaces.
- (d) This Ohana Dwelling permit is subject to all other applicable rules, regulations and requirements, including but not limited to those of the Planning Department, Department of Public Works, and State Department of Health.

Please note that the Ohana Permit has a statutory base relating to Chapter 46, Hawaii Revised Statutes (HRS), and Chapter 25, of the Hawaii County Code, the Zoning Code. Zoning also has a statutory base which includes Chapter 205, HRS as well. Obtaining an Ohana Permit does not relieve you from compliance with Chapter 205.

Chapter 205, HRS, does not authorize residential dwellings as a permissible use in the Agricultural District as classified by the State Land Use Commission, unless the dwelling is related to an agricultural activity or is a "farm dwelling". Again, with or without an Ohana Dwelling Permit you must comply with Chapter 205, HRS.

Farm dwelling is defined in Section 205-4.5(a)(4) as "a single family dwelling located on and used in conjunction with a farm, including clusters of single-family farm dwellings permitted within agricultural parks developed by the State, or where agricultural activity provides income to the family occupying the dwelling."

Penalty for violation of Section 205-4.5, Hawaii Revised Statutes, is a fine of not more than \$5,000. If any person who is cited for a violation of the law fails to remove the violation within six months of such citation and the violation continues, such person is subject to a citation for a new and separate violation. There shall be a fine of not more than \$5,000 for any additional violation.

Mr. Rohn Marvick  
Page 3  
August 25, 1995

Should you have any questions regarding the above, please feel free to contact Ed Cheplic of my staff at 961-8288.

Sincerely,

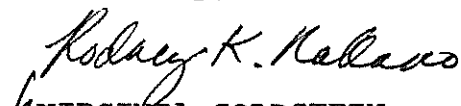
  
VIRGINIA GOLDSTEIN  
Planning Director

EC:dmo/mjs  
LMarv.dmo

xc: Department of Health,  
Chief Sanitarian  
Department of Public Works  
Real Property Tax Division  
West Hawaii Office



186.96'

MIN. BUILDING SETBACKS  
20'-0" ALL AROUND

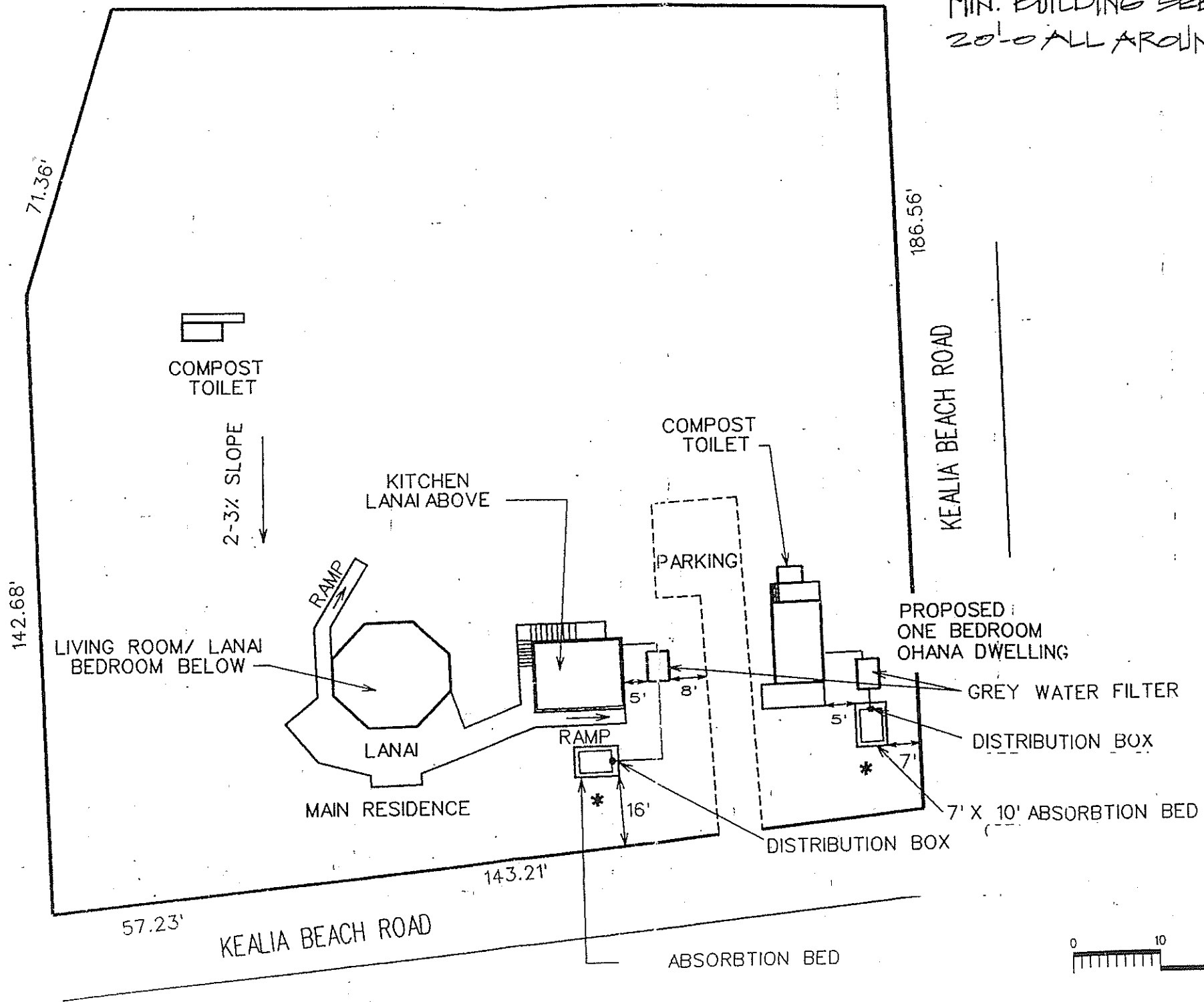

# SITE PLAN

T.M.K.: (3)8-6-13:41