

Stephen K. Yamashiro  
Mayor

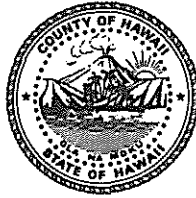

Virginia Goldstein  
Director

Norman Olesen  
Deputy Director

## County of Hawaii

### PLANNING DEPARTMENT

25 Aupuni Street, Room 109 • Hilo, Hawaii 96720-4252  
(808) 961-8288 • Fax (808) 961-9615

CERTIFIED MAIL  
P 008 113 458

May 17, 1995

Mr. Lawrence T. Masutani  
545 Kaaahi Street  
Honolulu, HI 96817

Dear Mr. Masutani:

Ohana Dwelling Permit (OHD 95-22)  
Site Engineering, Inc.  
TAX MAP KEY: 2-5-27:13, Lot 1

The subject application has been reviewed by the concerned agencies and note:

1. The subject tax map key parcel is served by an acceptable street;
2. The subject application can meet with the State Department of Health wastewater treatment and disposal systems requirements;
3. The copy of document(s) received relating to subject tax map key parcel to establish title and exhibits contained therein do not include any deed restriction or covenant to prohibit construction of requested Ohana dwelling; and,
4. The site plan denotes two off-street parking stalls on the property.

In view of the above, by this letter, you are hereby granted permission to construct the Ohana Dwelling (95-22), subject to the following condition(s):

- (a) The building permit for the Ohana Dwelling shall be applied for and secured from the Department of Public Works, Building Division.

C5310

MAY 18 1995

Mr. Lawrence T. Masutani  
Page 2  
May 17, 1995

Please bring or attach a copy of this Permit to expedite processing the building plans and building permit application to construct the Ohana dwelling.

- (b) Off-street parking space for two vehicles is designated on the submitted site plan to fulfill the off-street parking requirement. The off-street parking spaces may not be employed for storage or other use unless and until approved alternative on-site parking arrangements are established.
- (c) All construction drawings together with approved site plan drawn to scale submitted with the Ohana dwelling building permit application shall denote location and identify required two (2) off-street parking spaces.
- (d) This Ohana Dwelling permit is subject to all other applicable rules, regulations and requirements, including but not limited to those of the Planning Department, Department of Public Works, and State Department of Health.

Should you have any questions regarding the above, please feel free to contact Rodney Nakano of my staff at 961-8288.

Sincerely,

  
VIRGINIA GOLDSTEIN  
Planning Director

RKN:dmo  
LSiteEn2.rkn

xc: Department of Health,  
Chief Sanitarian  
Department of Public Works  
Real Property Tax Division

DEPARTMENT OF PUBLIC WORKS

ENGINEERING DIVISION

DRIVEWAY: IN ACCORDANCE WITH CHAPTER 22 OF THE HAWAII COUNTY CODE, A PERMIT SHALL BE OBTAINED FOR DRIVEWAY CONSTRUCTION WORK WITHIN THE COUNTY ROAD RIGHT-OF-WAY.

GRADING: ALL EARTHWORK AND GRADING SHALL CONFORM TO CHAPTER 10 OF THE HAWAII COUNTY CODE. A PERMIT MAY BE REQUIRED FOR LOT GRUBBYING AND/OR GRADING.

DRAINAGE: NO ADDITIONAL RAINFALL RUNOFF GENERATED BY THIS PROJECT SHALL BE DISPOSED OF ONTO COUNTY ROADWAYS OR ADJACENT PROPERTIES. ALL DRAINAGE IMPROVEMENTS SHALL CONFORM TO CHAPTER 27 OF THE HAWAII COUNTY CODE.

DEPARTMENT OF PUBLIC WORKS  
ENGINEERING DIVISION

REVIEWED BY: [Signature]

DATE: 6/19/95

T.M.K. 2-5-27: 13



**SITE PLAN**  
1"=20'

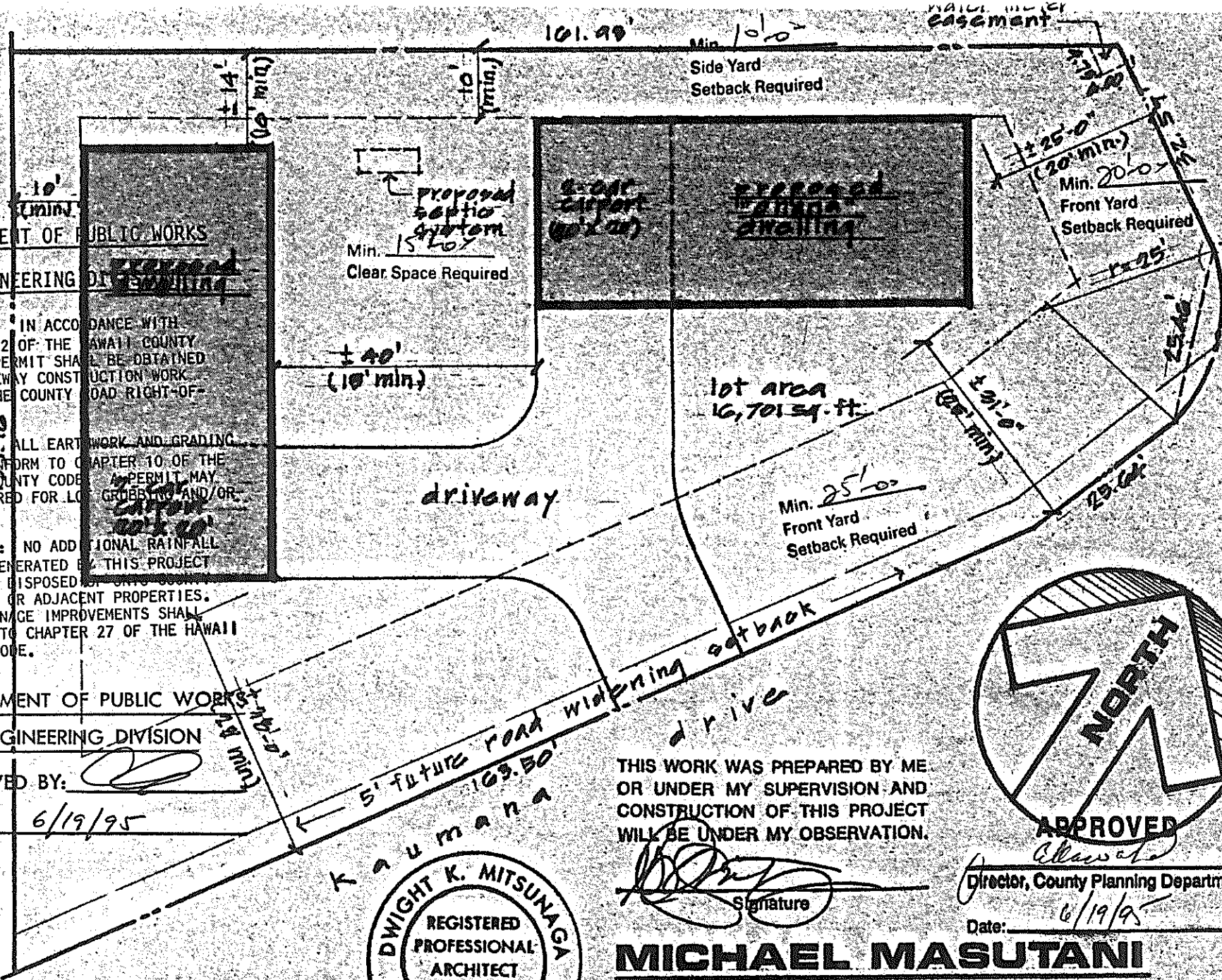

THIS WORK WAS PREPARED BY ME OR UNDER MY SUPERVISION AND CONSTRUCTION OF THIS PROJECT WILL BE UNDER MY OBSERVATION.

[Signature]  
Signature

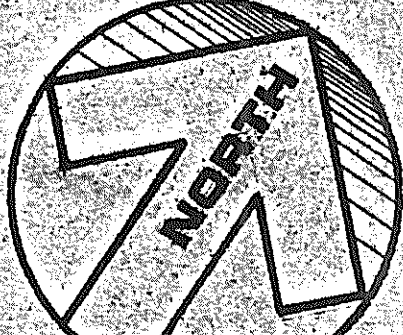

APPROVED  
[Signature]  
Director, County Planning Department

Date: 6/19/95

**MICHAEL MASUTANI**

T.M.K.: 2-5-27: 13 LOT NO. 1  
POR. PONAHAUAI, KAUMANA, S. HILO, HAWAII