

Stephen K. Yamashiro
Mayor

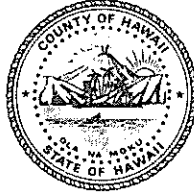

Virginia Goldstein
Director

Russell Kokubun
Deputy Director

County of Hawaii

PLANNING DEPARTMENT

25 Aupuni Street, Room 109 • Hilo, Hawaii 96720-4252
(808) 961-8288 • Fax (808) 961-8742

CERTIFIED MAIL

Z 095 324 966

November 10, 1999

Ms. Roberta Kvenild
P. O. Box 393
Honolulu, HI 96728

Dear Ms. Kvenild:

OHANA DWELLING PERMIT NO. 3849 (OHD 99-008)
Applicant: ROBERTA KVENILD
Titleholder: ROBERTA KVENILD
Additional Single Family Dwelling
Tax Map Key: (3) 2-8-014:009

The subject Application for Ohana Dwelling Unit Permit was reviewed by the agencies and includes the following respective comments:

1. The Department of Public Works (DPW) memorandum dated September 20, 1999, states in part:

"All new driveway construction will require a driveway permit from the Department of Public Works."
2. The Department of Water Supply (DWS) memorandum dated October 6, 1999, states in part:

"We have reviewed the subject application and have the following comments."

011035

NOV. 10 1999

Ms. Roberta Kvenild
Page 2
November 10, 1999

For your information, an existing 5/8-inch meter services the property and is adequate for only one dwelling at 600 gallons per day. This application is proposing an additional detailed dwelling, so the installation of a separate 5/8-inch meter by the applicant is required in accordance with Department regulations.

Therefore, the Department has no objections to the proposed application subject to the applicant understanding and accepting the following conditions:

1. Installation, by the Department of Water Supply, of a second 1-inch service lateral to service a 5/8-inch meter, which shall be restricted to a maximum daily flow of 600 gallons as the existing service is.
2. Remittance of the following charges, which are subject to change to change, to our Customer Service Section:
 - a. Facilities Charge (One 2nd service at \$3,375.00) \$3,375.00
 - b. Service Lateral Installation Charge
(Install one meter on a County road) 1,200.00

Total \$4,575.00

Should there be any questions, please call our Water Resources and Planning Branch at 961-8665."

3. The State of Hawaii Department of Health (DOH-HILO) memorandum dated September 23, 1999, states:

"The existing cesspool may service a total of 1,000 gallons per day of wastewater. A total of five bedrooms are allowed in the two dwelling units. A second cesspool is not allowed because of the lack of land area."

4. The signed original and notarized affidavit dated August 5, 1999, included with the Ohana Dwelling application states that:

Ms. Robert Kvenild
Page 3
November 10, 1999

"THIS AFFIDAVIT attests to the fact that I, ROBERTA J. KVENILD, am the title holder of the property located at 28-1654 Government Main Road, Honomu, TMK (3) 2-8-14:9.

There are no provisions of any restriction, covenant or other land use restrictions applicable to the lot by way of a deed or lease or other provisions do not prohibit construction or placement of an Ohana dwelling unit or a second dwelling unit."

5. We are also aware that The Hawaii County Fire Department (HFD) has raised the following concerns:

"Fire apparatus access roads shall be in accordance with UFC Section 10.207..."

"Fire extinguisher shall be in accordance with UFC Standard 10-1."

In view of the HFD concerns, the detailed building construction plans and building permit application to construct the new ohana dwellings unit shall be reviewed and approved by the Hawaii County Fire Department (HFD).

In view of the above, by this letter, you are hereby granted permission to construct a single family dwelling Ohana Dwelling Unit subject to the following conditions:

1. The proposed Ohana Dwelling unit shall comply with Ordinance No. 96 47 and Rule 12, the County of Hawaii Planning Department's Rules of Practice and Procedure relating to Ohana Dwelling Units.

Non-transferability: The permit for the Ohana Dwelling unit shall be personal to the applicant until construction of the Ohana Dwelling unit has been completed. The permit shall not be transferable or assignable to any other person prior to its completion.

Prohibition of Advertising, Sales, Transfers: No person shall advertise or represent to the public that a permit to construct an Ohana Dwelling unit is transferable with the sale of the property on which the permit has been granted.

Ms. Roberta Kvenild
Page 4
November 10, 1999

2. Building Permit: The applicant is required to comply with the State Department of Health requirements in Hilo and secure a building permit from the Department of Public Works, Building Division, to construct the proposed ohana dwelling unit on or before November 9, 2000.

Please bring or attach a copy of this Permit to help the reviewing agencies to understand and expedite the review and processing of the building construction plans and building permit application to construct the additional building improvements and establish the Ohana Dwelling on the subject parcel.

- a. A one time 30-day time extension to obtain the building permit may be granted by the Planning Director. A written time extension request shall be filed with the Planning Director not less than forty-five (45) days prior to the expiration date of the ohana dwelling unit permit. The Planning Director shall render a decision on the time extension request prior to the expiration date of the permit.
 - b. The applicant shall not be able to obtain further extensions beyond the initial 30-day time extension. Further, such failure to conform to the time requirement shall not be cause to petition the Planning Director, Board of Appeals or any other governmental body for relief from the time requirement.
3. Requirements for Height, Site Area (Lot size), Yard (Setback) and Off-Street Parking (Parking spaces):
 - a. Height limit: The height limit for the proposed ohana dwelling unit shall be twenty-five (25'-0") feet.
 - b. Zoning and Minimum Building Site Area (Lot Size): The subject TMK parcel containing 15,000 square feet is zoned Single Family Residential (RS-10) and Urban "U" by the State. The subject lot exceeds the minimum building site area (lot size) of 10,000 square feet.
 - c. Minimum Yards (Setbacks): The proposed ohana dwelling unit is required to comply with the minimum building yards of the Zoning Code, RATIFIED: APRIL 6, 1999. The minimum building yards are as follows: front/rear yards - minimum twenty-five (25'-0") feet and side yards - minimum fifteen (15'-0") feet.

Ms. Roberta Kvenild

Page 5

November 10, 1999

- d. Off-Street Parking: An Ohana Dwelling unit shall be provided with a minimum of two (2) off-street parking spaces which comply with the requirements of Section 25-4-53, Chapter 25, RATIFIED: APRIL 6, 1999. All existing and additional parking spaces shall be arranged so as to be individually accessible.
4. This Ohana Dwelling permit is subject to all other applicable rules, regulations and requirements of the Planning Department, Department of Public Works, Fire Department and State Department of Health and other reviewing agencies/divisions listed on the Building Permit Application.
5. Variances: Ohana dwelling units are prohibited on a building site, which is the subject of an approved variance from the Subdivision Code (Chapter 23), the Zoning Code (Chapter 25), and property where a second dwelling unit is specifically prohibited by a change of zone ordinance.
 - a. No variance from the requirements of Chapter 23 and Chapter 25, Hawaii County Code, as amended, shall be granted to permit the construction or placement of an Ohana Dwelling unit.
 - b. An Ohana Dwelling unit shall not be permitted on a lot which has been the subject of a previously granted variance from any provision of Chapter 23 and Chapter 25, Hawaii County Code, as amended.

Should you have any questions regarding the above, please feel free to contact this office at 961-8288.

Sincerely,

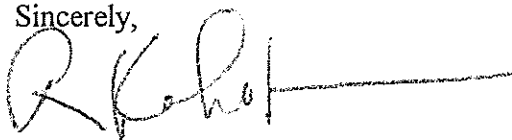

VIRGINIA GOLDSTEIN
Planning Director

WRY/RK:gp

P:\WP60\WRY\FORMLETTOD281409.LTR

Ms. Robert Kvenild
Page 6
November 10, 1999

xc: Department of Health, Chief Sanitarian
Department of Public Works
Real Property Tax Division
Department of Water Supply

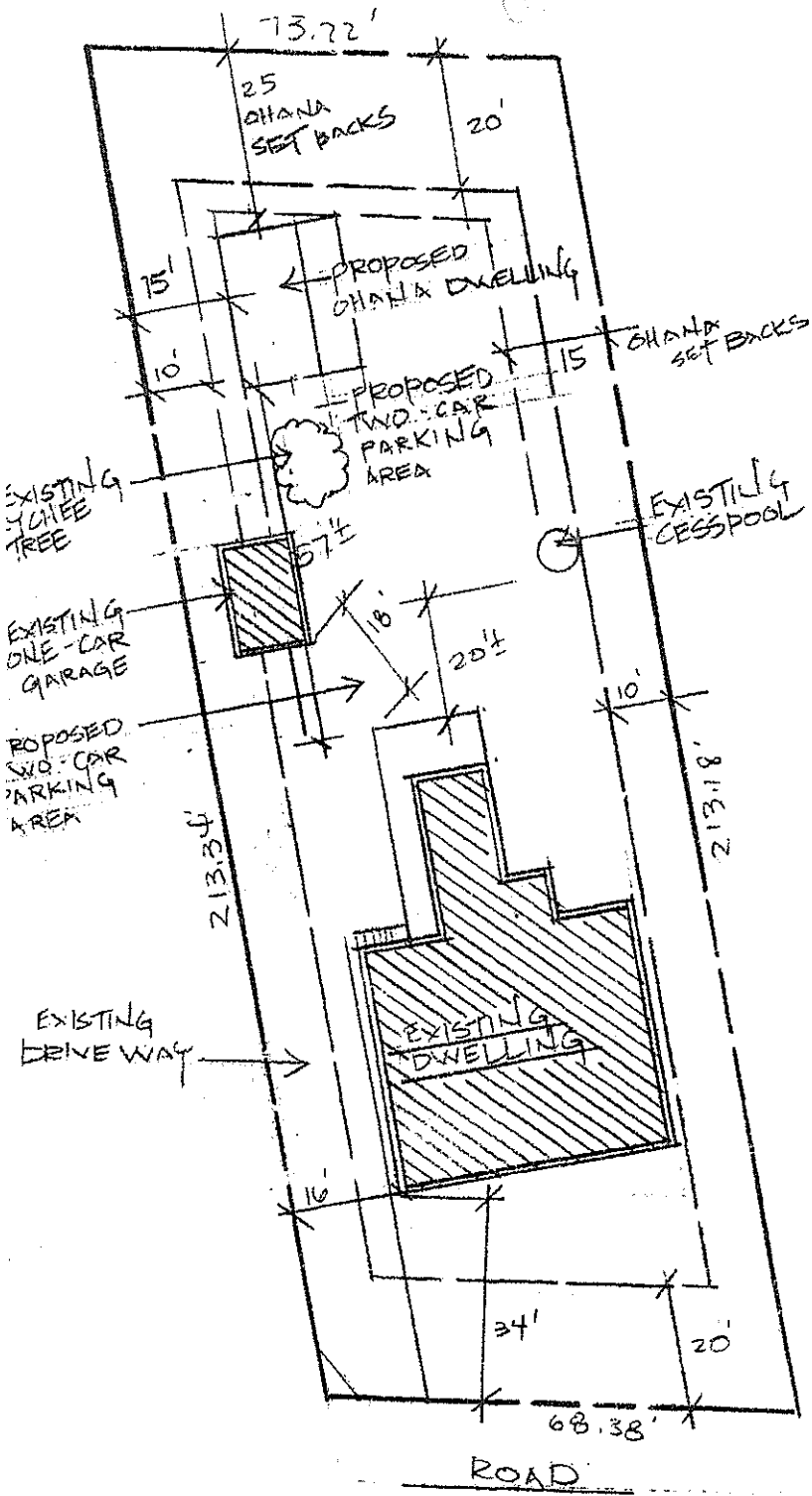

REVISED SITE PLAN

SCALE: 1" = 30' ... 10/19/99

A. PROPOSED CHANA DWELLING FOR:
MS. ROBERTA KVENILD
TRK: 2-8-14, 9
LOCATION: HONOHU VILLAGE
HONOHU, SOUTH HILLO, HI

LOCATION
 (NOTE: DIMENSIONS FOR EXISTING ONE-CAR GARAGE ARE BASED ON VERBAL REMARKS PER PHONE CONVERSATION WITH THE ABOVE PARTY.)

10/19/99

STACY OJANO