

COUNTY OF HAWAII - STATE OF HAWAII

ORDINANCE NO. 163

AN ORDINANCE AMENDING SECTION 7.24 (KAU ZONE MAP) OF ORDINANCE NO. 63 (ZONING ORDINANCE), REVISED ORDINANCES OF THE COUNTY OF HAWAII 1967, AS AMENDED, BY CHANGING THE DISTRICT CLASSIFICATION FOR AN AREA OF LAND FROM AGRICULTURAL (A-20a) TO AGRICULTURAL (A-5a) IN KIOLAKAA-KEEA HOMESTEADS, KAU, HAWAII.

BE IT ORDAINED BY THE BOARD OF SUPERVISORS IN AND FOR THE COUNTY OF HAWAII:

SECTION 1. Section 7.24 of Ordinance No. 63 (Zoning Ordinance), Revised Ordinances of the County of Hawaii 1967, as amended, is hereby amended by adding thereto the following subsection:

"7.24(a). The district classification of the following area situated at Kiolakaa-Keaa Homesteads, Kau, Hawaii, shall be Agricultural (A-5a):

Beginning at a pipe at the southwest corner of this parcel of land, the coordinates of said point of beginning referred to Government Survey Triangulation Station "Stein 2" being 886.69 feet north and 19,180.84 feet west and running by azimuths measured clockwise from true south:

- 1. 245° 06' 15" 848.23 feet along the remainder of Grant 9560 to David M. Keliikoa to a pipe in the middle of a stonewall;
- 2. 334° 35' 10" 1030.39 feet along the middle of a stonewall along a portion of Grant 7225 to Job Nalau Kamoku to a pipe on the north side of the Mamalahoa Highway;

Thence along the north side of the Mamalahoa Highway for next ten (10) courses, the azimuths and distances being:

- 3. 98° 45' 26.30 feet;

Thence along a curve to the left having a radius of 300.00 feet, the chord azimuth and distance being:

Ord. No. _____
 File No. _____
 M. B. No. 532-557
 Date: OCT 1 1967

4. 86° 51' 123.72 feet;

5. 74° 57' 67.04 feet;

Thence along a curve to the right having a radius of 280.00 feet, the chord azimuth and distance being:

6. 91° 55' 45" 128.49 feet;

7. 108° 54' 30" 122.11 feet;

Thence along a curve to the left having a radius of 640.00 feet, the chord azimuth and distance being:

8. 101° 35' 45" 162.92 feet;

9. 94° 17' 97.59 feet;

Thence along a curve to the right having a radius of 170.00 feet, the chord azimuth and distance being:

10. 115° 38' 30" 80.12 feet;

11. 137° 00' 37.67 feet;

Thence along a curve to the left having a radius of 164.73 feet, the chord azimuth and distance being:

12. 97° 26' 55" 209.79 feet to a pipe in the middle of a stonewall;

13. 155° 37' 20" 461.61 feet along the middle of a stonewall along portion of Grant 9349 to Richard H. Whittington to the point of beginning and containing an area of 14.27 acres more or less."

as outlined in dark green on the map attached hereto, marked "Exhibit A," and by reference made a part hereof.

SECTION 2. This Ordinance shall take effect upon its approval.

INTRODUCED BY:

SUPERVISOR, COUNTY OF HAWAII

Hilo, Hawaii

Date of Introduction: October 16, 1968

Date of Adoption: November 6, 1968

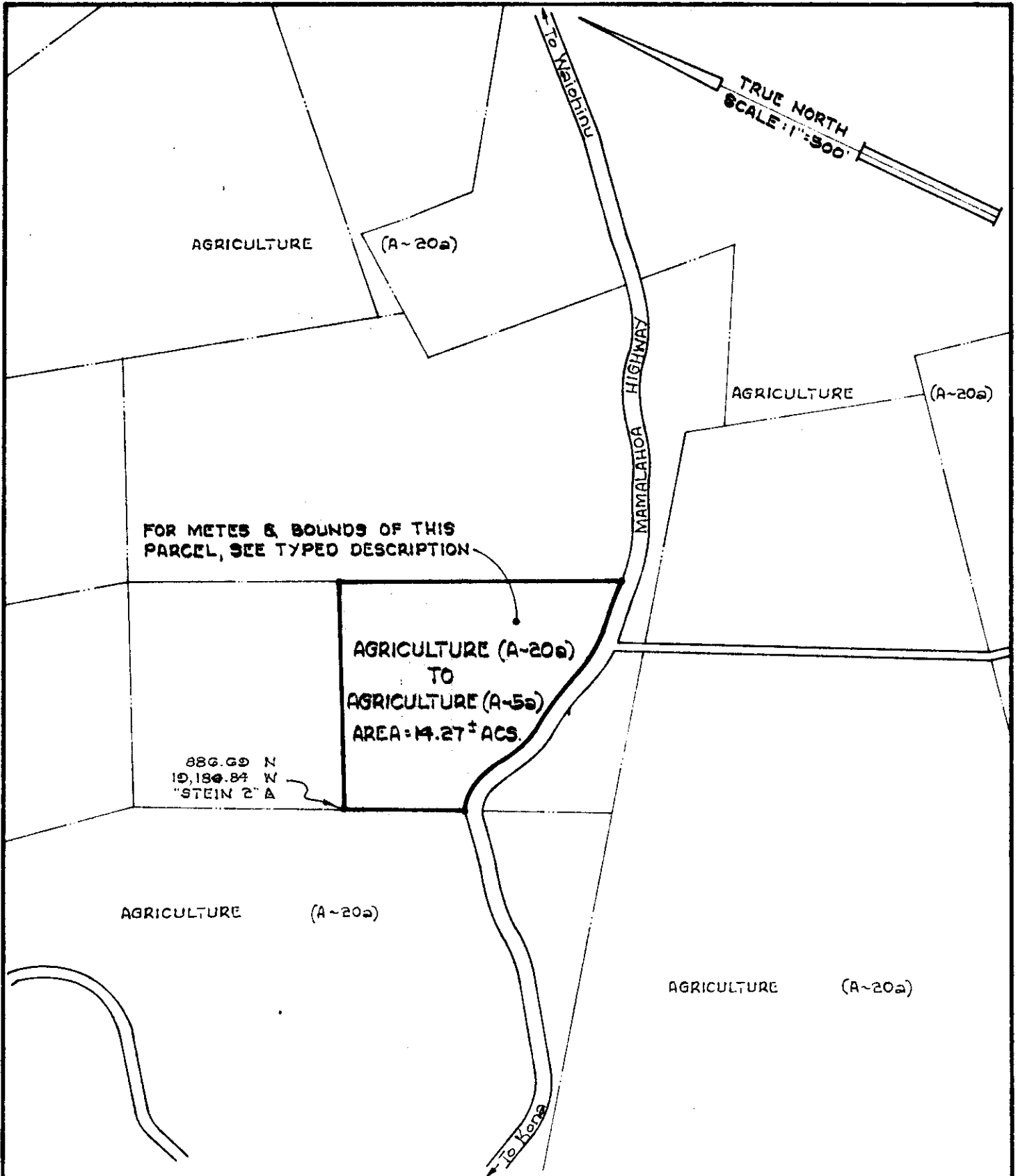

AMENDMENT TO THE COUNTY ZONING ORDINANCE

AMENDMENT NO. 1 OF SECTION 7.24, KAU DISTRICT ZONE MAP, PORTION OF ORDINANCE III, CHANGING THE DISTRICT CLASSIFICATION FROM AGRICULTURE (A-20a) TO AGRICULTURE (A-5a) IN KIOLAKAA-KEAA HOMESTEADS, KAU, HAWAII.

DATE OF PUBLIC HEARING: SEPT. 12, 1968

DATE OF APPROVAL:

PREPARED BY: PLANNING COMMISSION
COUNTY OF HAWAII

ORDINANCE NO. 163

(BILL NO. 536 - 1968)

AN ORDINANCE AMENDING SECTION 7.24 (KAU ZONE MAP) OF ORDINANCE NO. 63 (ZONING ORDINANCE), REVISED ORDINANCES OF THE COUNTY OF HAWAII 1967, AS AMENDED, BY CHANGING THE DISTRICT CLASSIFICATION FOR AN AREA OF LAND FROM AGRICULTURAL (A-20a) TO AGRICULTURAL (A-5a) IN KIOLAKAA-KEAA HOMESTEADS, KAU, HAWAII.

Date Introduced: October 16, 1968 - Date Approved:
November 6, 1968 - Date Effective: November 6, 1968.

ORDINANCE NO. 164

(Bill No. 537 - 1968)

AN ORDINANCE TO AMEND THE GENERAL PLAN OF PAHOA BY CHANGING THE LAND USE DESIGNATION FOR CERTAIN AREAS OF LAND FROM RESIDENTIAL USE TO VILLAGE COMMERCIAL USE IN NANAWALE HOMESTEADS, PUNA, HAWAII.

Date Introduced: October 16, 1968 - Date Approved:
November 6, 1968 - Date Effective: November 6, 1968.

Copies of the foregoing Ordinances, in full, are on file in the Office of the County Clerk for use and examination by the public.

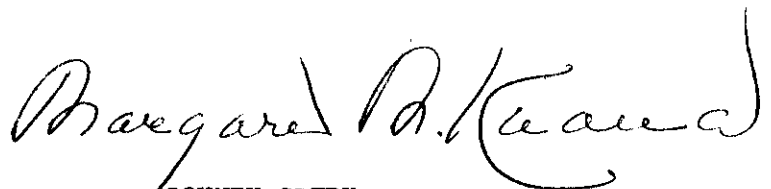

COUNTY CLERK
COUNTY OF HAWAII