

COUNTY OF HAWAII - STATE OF HAWAII

ORDINANCE NO. 168

AN ORDINANCE AMENDING SECTION 7.05 (KAILUA-HONALO ZONE MAP) OF ORDINANCE NO. 63 (ZONING ORDINANCE), REVISED ORDINANCES OF THE COUNTY OF HAWAII 1967, AS AMENDED, BY CHANGING THE DISTRICT CLASSIFICATION FROM SINGLE FAMILY RESIDENTIAL (RS-15) TO SINGLE FAMILY RESIDENTIAL (RS-7.5) IN WAIAHA 2ND, NORTH KONA, HAWAII.

BE IT ORDAINED BY THE BOARD OF SUPERVISORS IN AND FOR THE COUNTY OF HAWAII:

SECTION 1. Section 7.05 of Ordinance No. 63 (Zoning Ordinance), Revised Ordinances of the County of Hawaii 1967, as amended, is hereby further amended by adding thereto the following subsection:

"7.05(c). The district classification of the following area situated at Waiaha 2nd, North Kona, Hawaii, shall be Single Family Residential (RS-7.5):

Beginning at a pipe at the southwest corner of this parcel of land the coordinates of said point of beginning referred to Government Survey Triangulation Station 'North Meridian' being 5586.87 feet south and 4312.32 feet east, and running by azimuths measured clockwise from true south:

- 1. 162° 54' 334.86 feet along the remainder of Grant 5327 to Samuel Liftee to a pipe in the middle of a stonewall;
- 2. 256° 51' 65.76 feet along the middle of a stonewall to a pipe;
- 3. 254° 38' 30" 147.50 feet along the middle of a stonewall to a pipe;
- 4. 250° 05' 39.34 feet along the middle of a stonewall to a pipe;
- 5. 254° 32' 285.07 feet along the middle of a stonewall to a pipe;
- 6. 255° 12' 174.88 feet along the middle of a stonewall to a pipe;
- 7. 254° 29' 176.29 feet along the middle of a stonewall to a pipe;

Ord. No. 168

File No. \_\_\_\_\_

M. B. No. 584-595

Date: NOV 6 1968

NOV 20 1968

8.	253 <sup>0</sup>	28'		81.34 feet along the middle of a stonewall to a pipe;
9.	254 <sup>0</sup>	18'		108.90 feet along the middle of a stonewall to a pipe;
10.	251 <sup>0</sup>	05'	30"	389.65 feet along the middle of a stonewall to a pipe;
11.	251 <sup>0</sup>	43'	30"	124.57 feet along the middle of a stonewall to a pipe;
12.	255 <sup>0</sup>	03'		404.68 feet along the middle of a stonewall to a pipe;
13.	255 <sup>0</sup>	53'		287.80 feet along the middle of a stonewall to a pipe;
14.	254 <sup>0</sup>	39'		100.42 feet along the middle of a stonewall to a pipe on the west side of Kailua-Holualoa Government Road;
15.	323 <sup>0</sup>	13'	30"	82.75 feet along the west side of Kailua-Holualoa Government Road to a pipe;
16.	327 <sup>0</sup>	02'		45.19 feet along the west side of Kailua-Holualoa Government Road to a pipe;
17.	335 <sup>0</sup>	56'		85.78 feet along the west side of Kailua-Holualoa Government Road to a nail;
18.	331 <sup>0</sup>	28'		65.37 feet along the west side of Kailua-Holualoa Government Road to a nail;
19.	292 <sup>0</sup>	20'		45.00 feet along the south side of Kailua-Holualoa Government Road to a pipe;
20.	288 <sup>0</sup>	46'		139.65 feet along the south side of Kailua-Holualoa Government Road to a pipe;
21.	296 <sup>0</sup>	23'		38.25 feet along the south side of Kailua-Holualoa Government Road to a pipe;
22.	303 <sup>0</sup>	46'		24.48 feet along the south side of Kailua-Holualoa Government Road to a pipe;
23.	317 <sup>0</sup>	25'	30"	32.25 feet along the southwest side of Kailua-Holualoa Government Road to a pipe;
24.	332 <sup>0</sup>	56'	30"	39.50 feet along the west side of Kailua-Holualoa Government Road to a pipe;

- |     |                  |     |     |  |
|-----|------------------|-----|-----|--|
| 25. | 312 <sup>o</sup> | 10' | 30" | 74.74 feet along the southwest side of Kailua-Holualoa Government Road to a pipe;  |
| 26. | 74 <sup>o</sup>  | 06' | 30" | 477.81 feet along the middle of a stonewall to a pipe;   |
| 27. | 74 <sup>o</sup>  | 39' |     | 596.05 feet along the middle of a stonewall to a pipe;   |
| 28. | 74 <sup>o</sup>  | 44' | 30" | 851.33 feet along the middle of a stonewall to a pipe;   |
| 29. | 75 <sup>o</sup>  | 21' | 30" | 347.23 feet along the middle of a stonewall to a pipe;   |
| 30. | 165 <sup>o</sup> | 01' |     | 202.28 feet along the remainder of Grant 5327 to Samuel Liftee to a pipe;  |
| 31. | 72 <sup>o</sup>  | 54' |     | 434.45 feet along the remainder of Grant 5327 to Samuel Liftee to the point of beginning and containing an area of 29.349 acres. |

as outlined in red on the map attached hereto, marked 'Exhibit A,' and by reference made a part hereof."

SECTION 2. This Ordinance shall take effect upon its approval.

INTRODUCED BY:

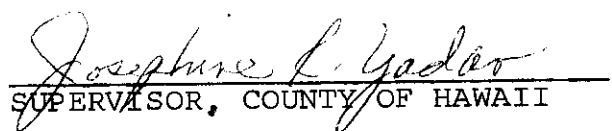
  
 SUPERVISOR, COUNTY OF HAWAII

Hilo, Hawaii

Date of Introduction: November 6, 1968

Date of Adoption: November 20, 1968

ORDINANCE NO. 167

(Bill No. 540 - 1968)

AN ORDINANCE AMENDING SECTION 7.06 (NORTH AND SOUTH KOHALA ZONE MAP) OF ORDINANCE NO. 63 (ZONING ORDINANCE), REVISED ORDINANCES OF THE COUNTY OF HAWAII 1967, AS AMENDED, BY CHANGING THE DISTRICT CLASSIFICATION FOR A CERTAIN AREA OF LAND FROM AGRICULTURE (A-20a) TO AGRICULTURE (A-3a) IN KAA'UHUU HOMESTEADS, NORTH KOHALA, HAWAII.

Date Introduced: November 6, 1968 - Date Approved:  
November 20, 1968 - Date Effective: November 20, 1968

ORDINANCE NO. 168

(Bill No. 541 - 1968)

AN ORDINANCE AMENDING SECTION 7.05 (KAILUA-HONALO ZONE MAP) OF ORDINANCE NO. 63 (ZONING ORDINANCE), REVISED ORDINANCES OF THE COUNTY OF HAWAII 1967, AS AMENDED, BY CHANGING THE DISTRICT CLASSIFICATION FROM SINGLE FAMILY RESIDENTIAL (RS-15) TO SINGLE FAMILY RESIDENTIAL (RS-7.5) IN WAIAHA 2ND, NORTH KONA, HAWAII.

Date Introduced: November 6, 1968 - Date Approved:  
November 20, 1968 - Date Effective: November 20, 1968

Copies of the foregoing Ordinances, in full, are on file in the Office of the County Clerk for use and examination by the public.

  
COUNTY CLERK  
COUNTY OF HAWAII

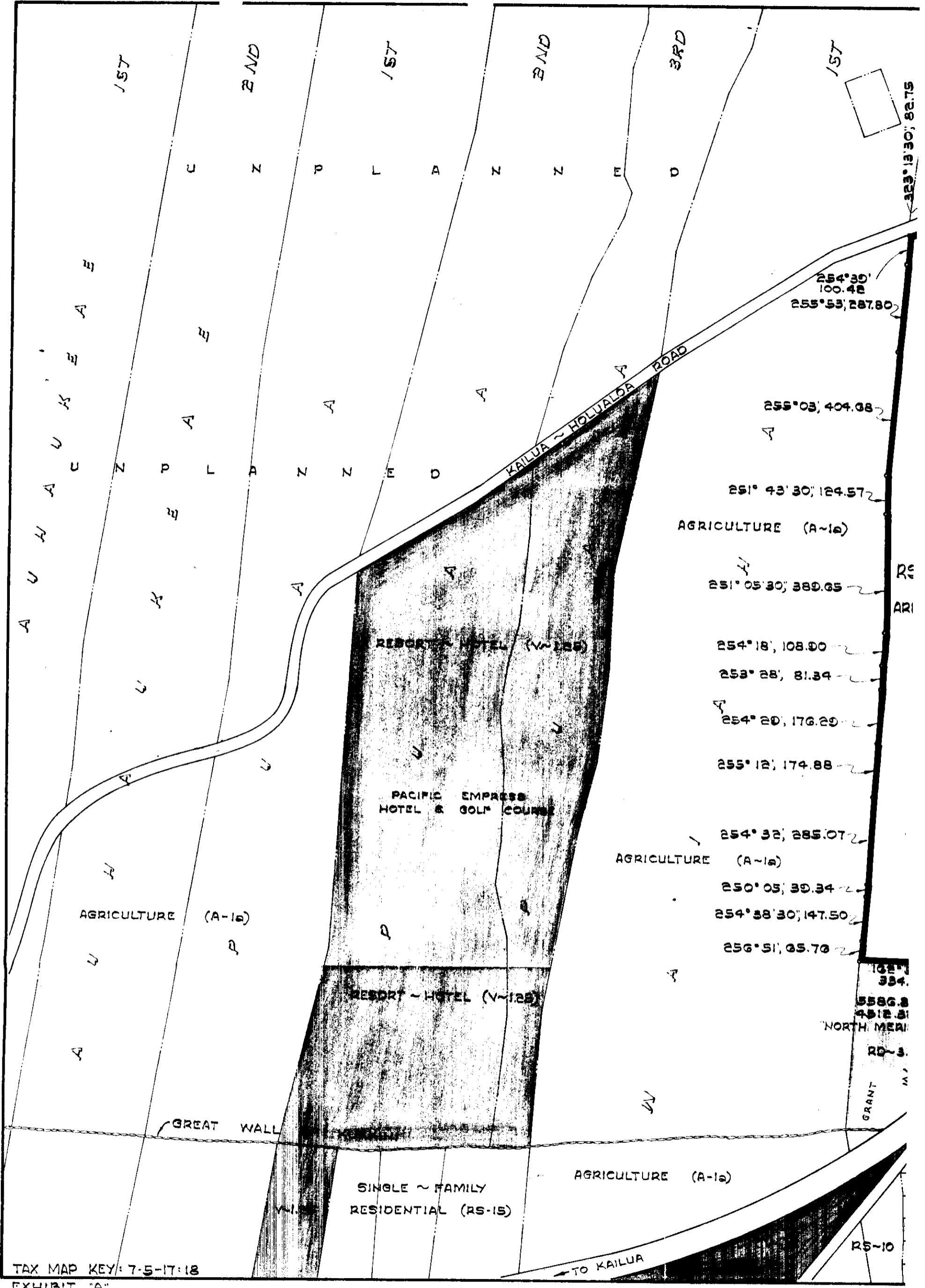

TAX MAP KEY: 7-5-17:18  
EXHIBIT "A"

254°30', 100.42  
255°53', 287.80

255°03', 404.08

251°43'30", 124.57

AGRICULTURE (A-1a)

251°05'30", 389.65

RS-10

254°18', 108.90

253°28', 81.34

254°20', 176.29

255°12', 174.88

AGRICULTURE (A-1a)

254°32', 285.07

250°05', 39.34

254°58'30", 147.50

256°51', 65.76

1051  
384.  
5586.3  
4512.51  
NORTH MEAN  
RD-3  
GRANT

TO KAILUA

RS-10

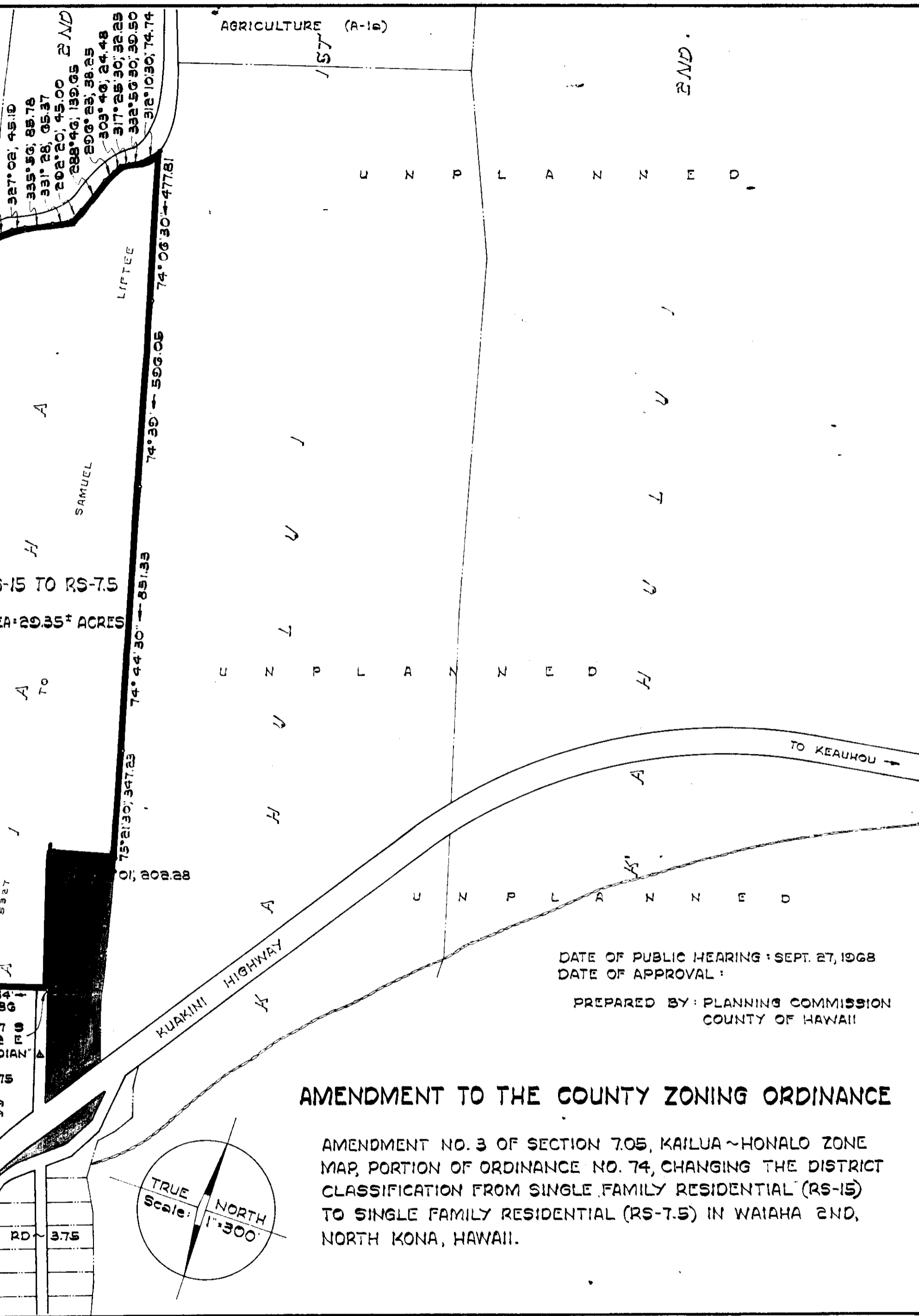

DATE OF PUBLIC HEARING : SEPT. 27, 1968  
 DATE OF APPROVAL :  
 PREPARED BY : PLANNING COMMISSION  
 COUNTY OF HAWAII

### AMENDMENT TO THE COUNTY ZONING ORDINANCE

AMENDMENT NO. 3 OF SECTION 7.05, KAILUA-HONALO ZONE MAP, PORTION OF ORDINANCE NO. 74, CHANGING THE DISTRICT CLASSIFICATION FROM SINGLE FAMILY RESIDENTIAL (RS-15) TO SINGLE FAMILY RESIDENTIAL (RS-7.5) IN WAIAHA 2ND, NORTH KONA, HAWAII.

