

COUNTY OF HAWAII - STATE OF HAWAII

ORDINANCE NO. 264

AN ORDINANCE AMENDING SECTION 7.02, THE NORTH KONA ZONE MAP, ORDINANCE NO. 63 (ZONING ORDINANCE), REVISED ORDINANCES OF THE COUNTY OF HAWAII 1967, AS AMENDED, BY CHANGING THE DISTRICT CLASSIFICATION FROM AGRICULTURAL (A-5a) TO VILLAGE COMMERCIAL (CV-7.5) AND AGRICULTURAL (A-1a) IN HONUAINO 2ND, NORTH KONA, HAWAII.

BE IT ORDAINED BY THE COUNCIL OF THE COUNTY OF HAWAII:

SECTION 1. Section 7.02 of Ordinance No. 63 (Zoning Ordinance), Revised Ordinances of the County of Hawaii 1967, as amended, is hereby further amended by adding thereto the following subsections:

"7.02(g-1) The district classification of the following area situated at Honuaino 2nd, North Kona, Hawaii, shall be Village Commercial (CV-7.5):

Beginning at the northeast corner of this parcel of land at the southwest corner of Land Court Application 1605 and at the northwest corner of a portion of R. P. 1098, L. C. Aw. 614 to Charles Hall, the coordinates of said point of beginning referred to Government Survey Triangulation Station "PUU O HAU" being 6917.30 feet north and 9243.74 feet east and running by azimuths measured clockwise from true south:

1. 331° 10' 30" 216.60 feet along a portion of R. P. 1098, L. C. Aw. 614 to Charles Hall;
2. 72° 19' 30" 151.31 feet along existing roadway;
3. 76° 14' 40" 79.58 feet along same;
4. 167° 04' 00" 219.20 feet along Parcel 2;
5. 256° 08' 30" 171.08 feet along a portion of R. P. 1098, L. C. Aw. 614 to Charles Hall, Ethel V. Paris, owner to the point of beginning and containing an area of 43,560 square feet or 1.00 acre.

"7.02(g-2) The district classification of the following area situated at Honuaino 2nd, North Kona, Hawaii, shall be Agricultural (A-1a):

Beginning at the northeast corner of this parcel of land and on the southerly side of a portion of R. P. 1098, L. C. Aw. 614

Ord. No. 264

File No. _____

M. B. No. 3111

Date: SEP 3 1969 SEP 17 1969

to Charles Hall the coordinates of said point of beginning referred to Government Survey Triangulation Station "PUU O HAU" being 6,876.32 feet north and 9,077.64 feet east and running by azimuths measured clockwise from true south:

1. 347^o 04' 00" 219.20 feet along Parcel 3;
2. 76^o 14' 40" 107.98 feet along existing roadway;
3. 74^o 53' 30" 280.24 feet along same;
4. 164^o 01' 40" 225.25 feet along Parcel 1;
5. 256^o 08' 30" 400.00 feet along a portion of R. P. 1098, L. C. Aw. 614 to Charles Hall, Ethel V. Paris, owner to the point of beginning and containing an area of 87,120 square feet or 2.00 acres.

All as outlined in red on the map attached hereto, marked Exhibit "A," and by reference made a part hereof."

SECTION 2. This ordinance shall take effect upon its approval.

INTRODUCED BY:



Councilman, County of Hawaii

Date of Introduction: September 3, 1969

Date of Adoption: September 17, 1969

Effective Date: September 22, 1969

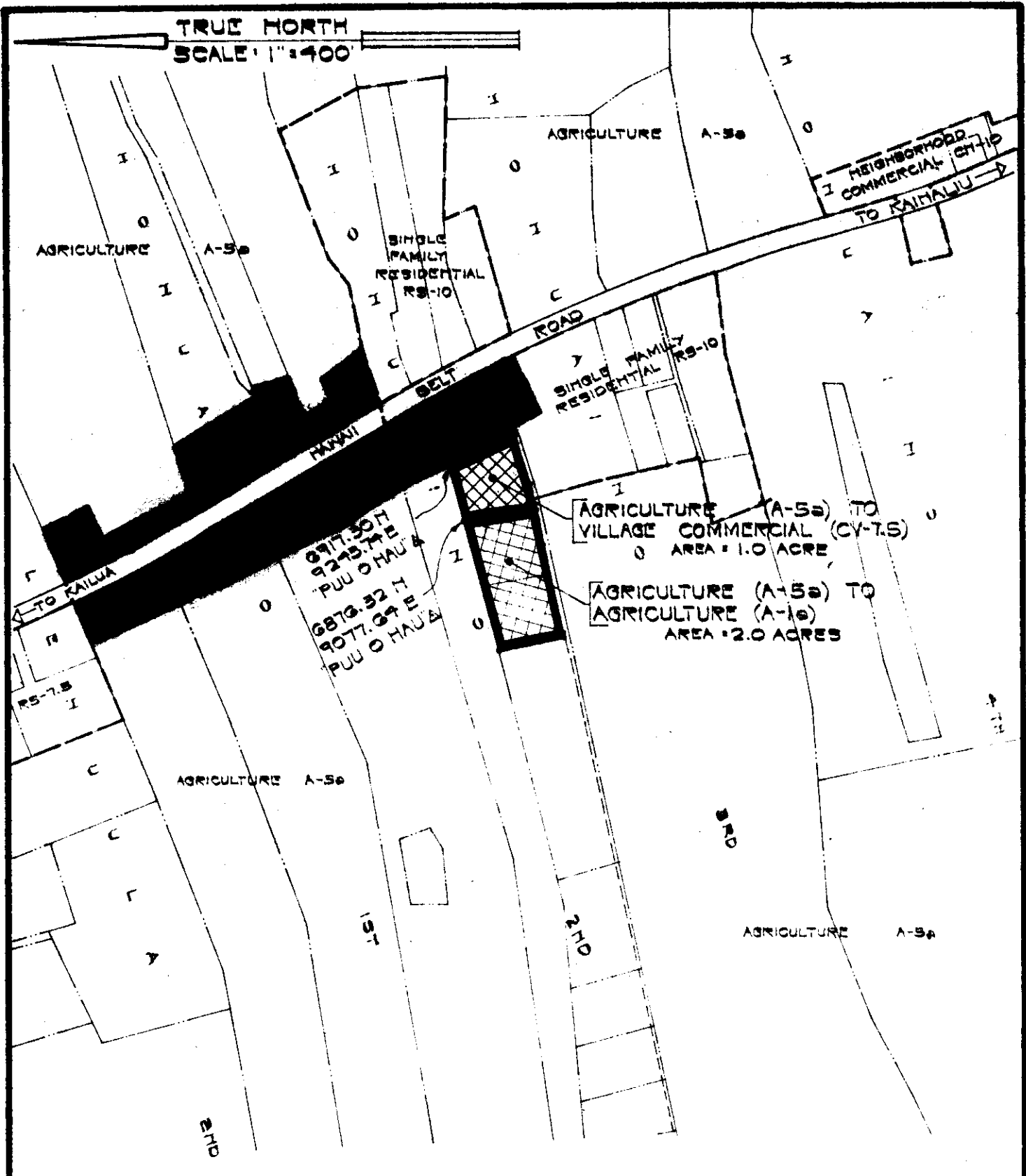

AMENDMENT TO THE COUNTY ZONING ORDINANCE

AMENDMENT NO. 7 OF SECTION 7.02, NORTH KOHA ZONE MAP, PORTION OF ORDINANCE NO. 79, CHANGING THE DISTRICT CLASSIFICATION FROM AGRICULTURE (A-5a) TO VILLAGE COMMERCIAL (CV-7.5) AND AGRICULTURE (A-1a) IN HONUAINO 2ND, N. KOHA, HAWAII.

DATE OF PUBLIC HEARINGS: APRIL 21, 1939
 DATE OF APPROVAL:
 PREPARED BY: PLANNING DEPARTMENT
 COUNTY OF HAWAII

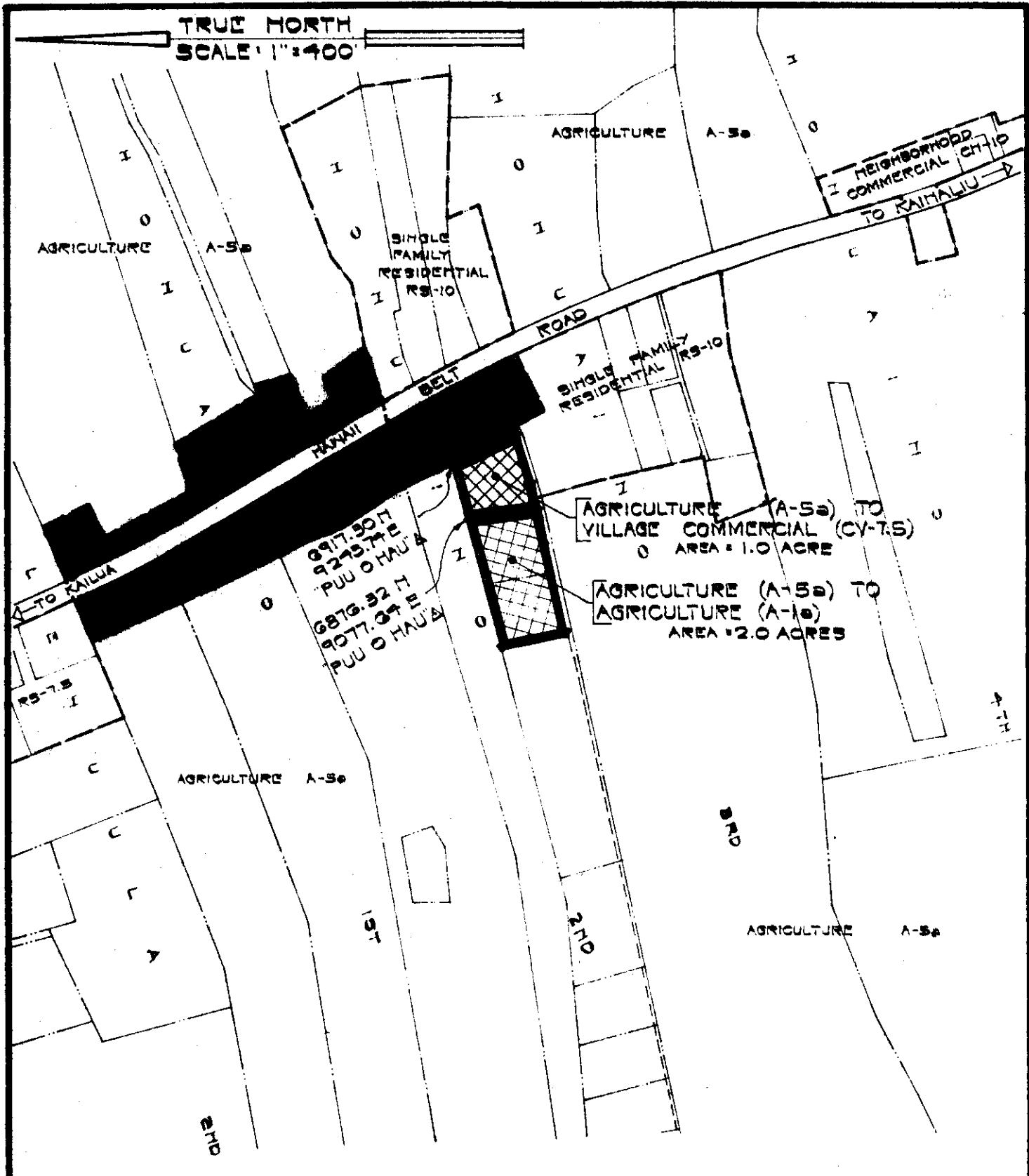

AMENDMENT TO THE COUNTY ZONING ORDINANCE

AMENDMENT NO. 7 OF SECTION 7.02, NORTH KOHA ZONE MAP, PORTION OF ORDINANCE NO. 74, CHANGING THE DISTRICT CLASSIFICATION FROM AGRICULTURE (A-5a) TO VILLAGE COMMERCIAL (CY-7.5) AND AGRICULTURE (A-1a) IN HONUAHIO 2ND, N. KOHA, HAWAII.

DATE OF PUBLIC HEARING: APRIL 24, 1969
 DATE OF APPROVAL:
 PREPARED BY: PLANNING DEPARTMENT
 COUNTY OF HAWAII

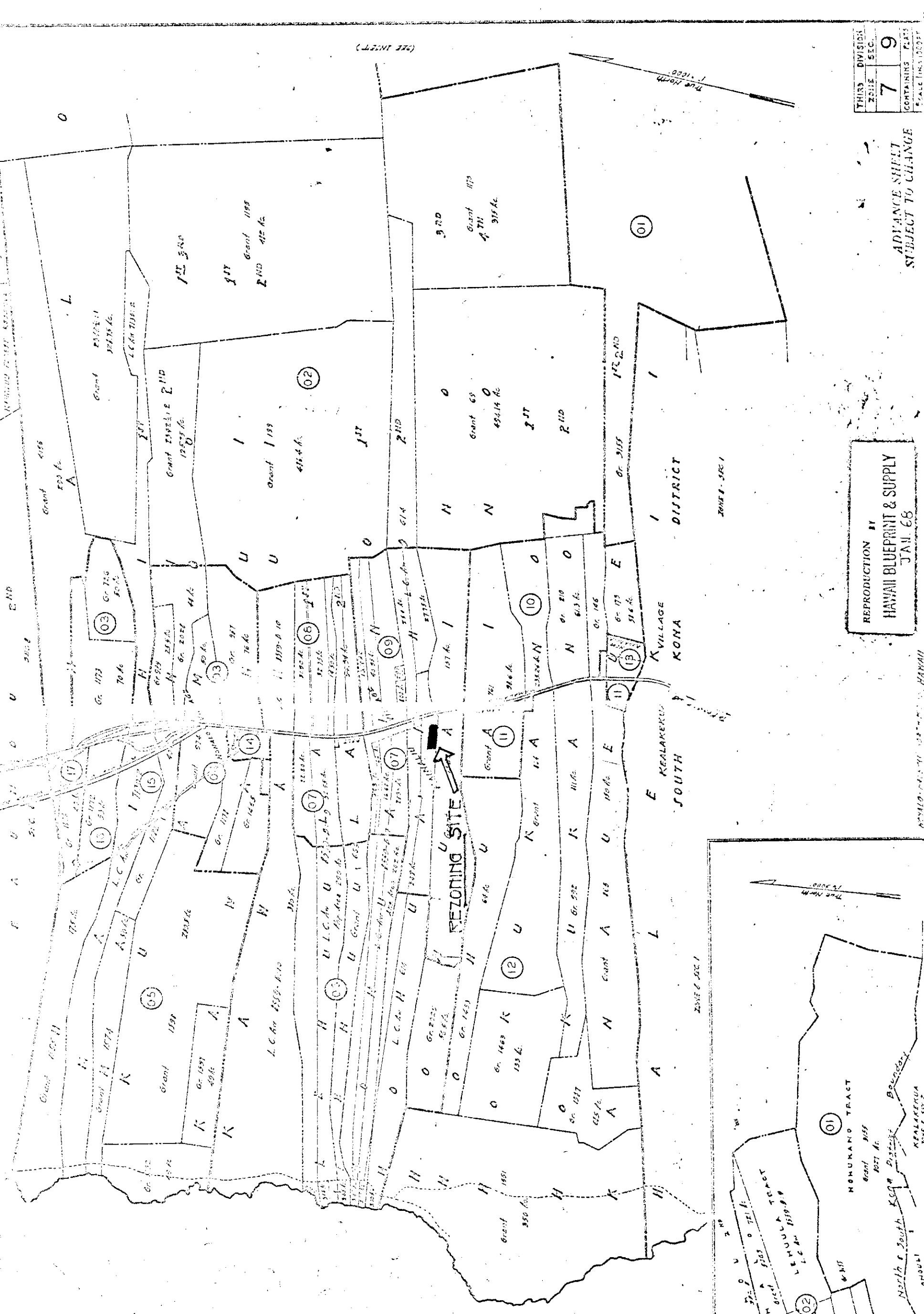

(SEE INSERT)

THIRD DIVISION	7	9
ZONE		
SECTION		
CONTAINING PLATS		
SCALE 1/4" = 100'		

ADVANCE SHEET
SUBJECT TO CHANGE

REPRODUCTION BY
HAWAII BLUEPRINT & SUPPLY
JAN 68

REZONING SITE

NONUKANO TRACT
Grant 935
1027 Ac

LEHUULA TRACT
Grant 1539-9-9
L.C.A.

North & South Kona District Boundary

KEALAKEKUA NORTH DISTRICT

ORDINANCE NO. 264
(Bill No. 643-1969)

AN ORDINANCE AMENDING SECTION 7.02, THE NORTH KONA ZONE MAP, ORDINANCE NO. 63 (ZONING ORDINANCE), REVISED ORDINANCES OF THE COUNTY OF HAWAII 1967, AS AMENDED, BY CHANGING THE DISTRICT CLASSIFICATION FROM AGRICULTURAL (A-5a) TO VILLAGE COMMERCIAL (CV-7.5) AND AGRICULTURAL (A-1a) IN HONUAINO 2ND, NORTH KONA, HAWAII.

Date Approved: September 17, 1969
Date Effective: September 22, 1969

Copies of the foregoing Ordinance, in full, are on file in the Office of the County Clerk for use and examination by the public.

I hereby certify that the foregoing Ordinance passed second and final reading at the meeting of the County Council on September 17, 1969, by the following aye and no vote:

AYES: Councilmen De Luz, Edwards, Matayoshi, Souza, Yadao, Yamada and Council Chairman Hisaoka - 7.

NOES: None.

ABSENT AND EXCUSED: Councilmen Carpenter and Greenwell - 2.

Tadashi Suzuki
COUNTY CLERK
COUNTY OF HAWAII