

COUNTY OF HAWAII - STATE OF HAWAII

ORDINANCE NO. 286

AN ORDINANCE AMENDING SECTION 7.30, THE PAPAIKOU-ONOMEA ZONE MAP, ORDINANCE NO. 63 (ZONING ORDINANCE), REVISED ORDINANCES OF THE COUNTY OF HAWAII 1967, AS AMENDED, BY CHANGING THE DISTRICT CLASSIFICATION FROM SINGLE FAMILY RESIDENTIAL (RS-7.5) TO VILLAGE COMMERCIAL (CV-10) IN PAPAIKOU, SOUTH HILO, HAWAII, COVERED BY TAX MAP KEY 2-7-28:16 & 17.

BE IT ORDAINED BY THE COUNCIL OF THE COUNTY OF HAWAII:

SECTION 1. Section 7.30 of Ordinance No. 63 (Zoning Ordinance), Revised Ordinances of the County of Hawaii 1967, as amended, is hereby further amended by adding thereto the following subsection:

"7.30(a). The district classification of the following area situated at Papaikou, South Hilo, Hawaii, shall be Village Commercial (CV-10):

Beginning at a pipe at the southeast corner of this parcel of land, being also on the west side of Mamalahoa Highway, the Coordinates of which referred to Government Survey Triangulation Station "Alala" being 19,150.68 feet South and 5,433.60 feet East and thence running by azimuths measured clockwise from true South:

1. 69° 20' 19.00 feet along Plantation Road;
2. 91° 23' 21.34 feet along Plantation Road;
3. 117° 15' 16.00 feet along Plantation Road;
4. 138° 20' 12.00 feet along Plantation Road;
5. 147° 00' 21.70 feet along Plantation Road;
6. 169° 45' 85.60 feet along Plantation Road;
7. 169° 47' 55.70 feet along Plantation Road;
8. 192° 40' 30.30 feet along Plantation Road;
9. 181° 02' 40.30 feet along Plantation Road;
10. 165° 30' 35.40 feet along Plantation Road;
11. 312° 30' 23.00 feet along Plantation Road;
12. 318° 20' 20.00 feet along Plantation Road;
13. 327° 00' 22.00 feet along Plantation Road;
14. 337° 10' 22.00 feet along Plantation Road;
15. 342° 06' 25.86 feet along Plantation Road;
16. 347° 00' 182.30 feet along west side of Mamalahoa Highway to the point of beginning and containing an area of 14,138 square feet.

Ord. No. 286

File No. _____

M. B. No. 465, 490

All as outlined in red on the map attached hereto, marked Exhibit "A," and by reference made a part hereof."

SECTION 2. This ordinance shall take effect upon its approval.

INTRODUCED BY:

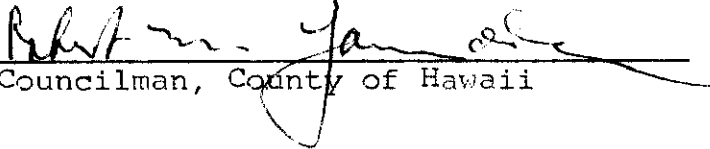
Councilman, County of Hawaii

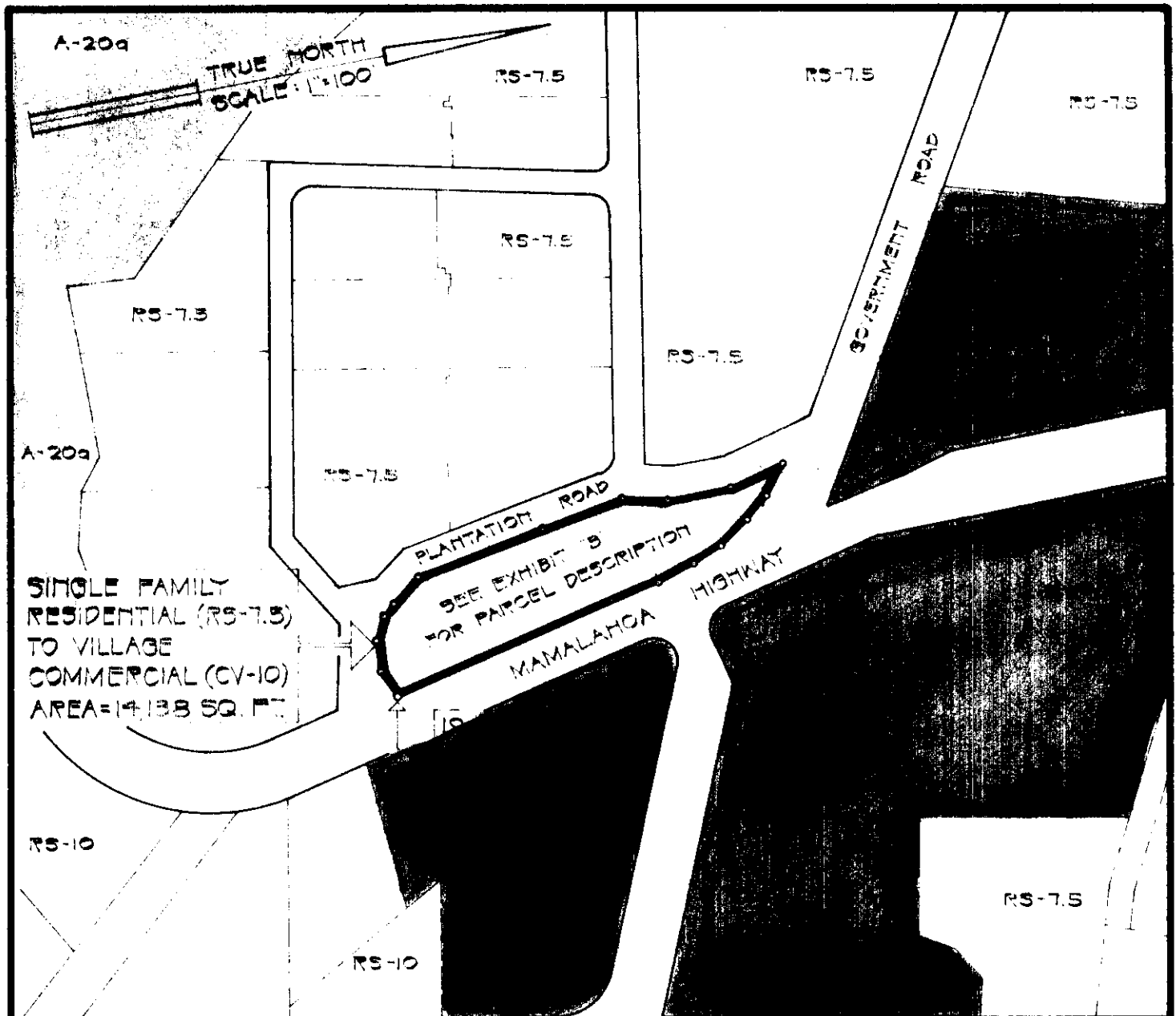

← TO HILO HAWAII BELT ROAD TO HONOKAA →

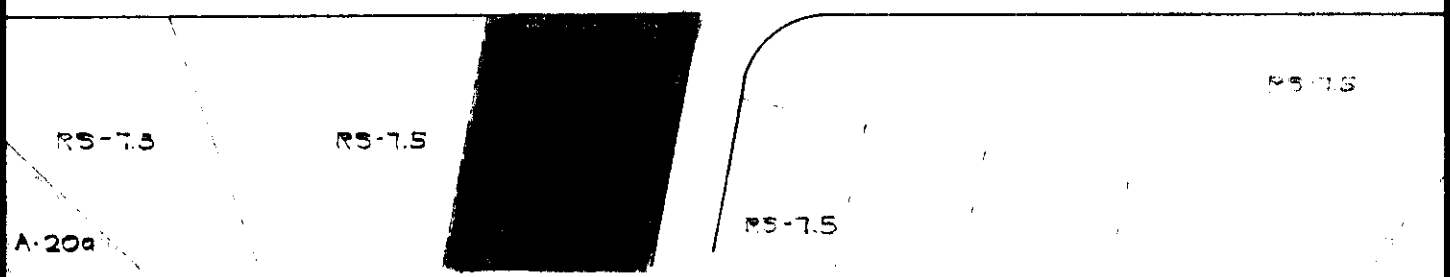

AMENDMENT TO THE COUNTY ZONING ORDINANCE

AMENDMENT NO. 1 OF SECTION 7.30, PAPAIKOU-ONOMEA ZONE MAP, PORTION OF ORDINANCE NO. 190, CHANGING THE DISTRICT CLASSIFICATION FROM SINGLE FAMILY RESIDENTIAL (RS-7.5) TO VILLAGE COMMERCIAL (CV-10) IN PAPAIKOU, S. HILO, HAWAII.

DATE OF PUBLIC HEARING: OCT. 10, 1969
 DATE OF APPROVAL:
 PREPARED BY: PLANNING DEPARTMENT
 COUNTY OF HAWAII

TMK: 2-7-28:16,17

OCT. 29, 1969

EXHIBIT 'A'

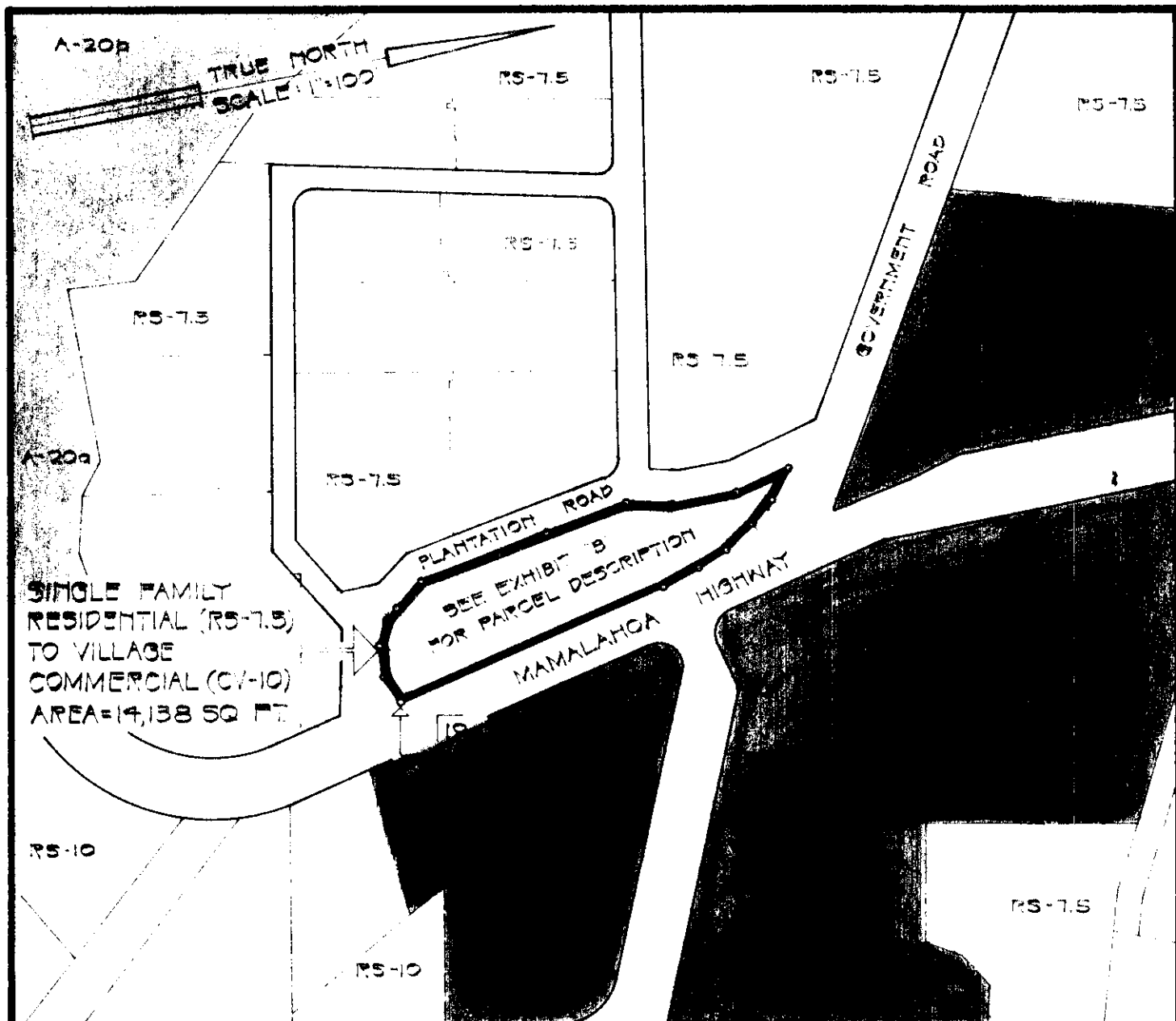

← TO HILO HAWAII BELT ROAD TO HONOKAA →

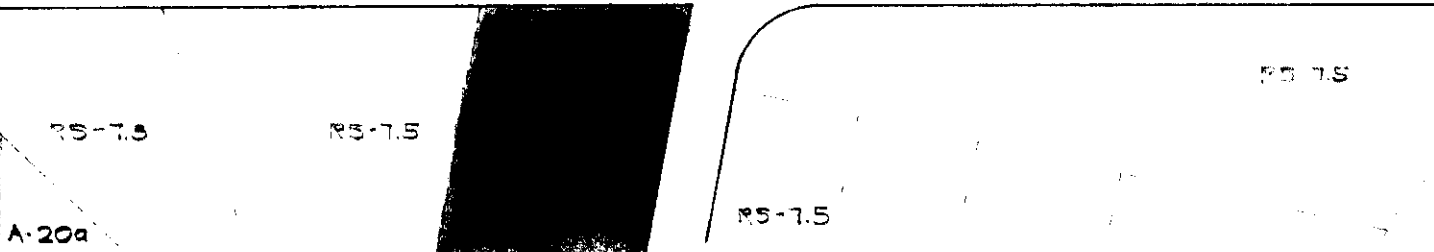

AMENDMENT TO THE COUNTY ZONING ORDINANCE

AMENDMENT NO. 1 OF SECTION 7.30, PAPAIKOU-ONOMEA ZONE MAP, PORTION OF ORDINANCE NO. 190, CHANGING THE DISTRICT CLASSIFICATION FROM SINGLE FAMILY RESIDENTIAL (RS-7.5) TO VILLAGE COMMERCIAL (CV-10) IN PAPAIKOU, S. MILO, HAWAII.

DATE OF PUBLIC HEARING: OCT. 10, 1969
 DATE OF APPROVAL:
 PREPARED BY: PLANNING DEPARTMENT
 COUNTY OF HAWAII

TMK: 2-7-28:16,17

OCT. 29, 1969

EXHIBIT "A"

ORDINANCE NO. 286
(Bill No. 673-1969)

AN ORDINANCE AMENDING SECTION 7.30, THE PAPAIKOU-ONOMEA ZONE MAP, ORDINANCE NO. 63 (ZONING ORDINANCE), REVISED ORDINANCES OF THE COUNTY OF HAWAII 1967, AS AMENDED, BY CHANGING THE DISTRICT CLASSIFICATION FROM SINGLE FAMILY RESIDENTIAL (RS-7.5) TO VILLAGE COMMERCIAL (CV-10) IN PAPAIKOU, SOUTH HILO HAWAII, COVERED BY TAX MAP KEY 2-7-28:16 & 17.

Date Approved: December 4, 1969
Date Effective: December 15, 1969

Copies of the foregoing Ordinance, in full, are on file in the Office of the County Clerk for use and examination by the public.

I hereby certify that the foregoing Ordinance passed second and final reading at the meeting of the County Council on December 4, 1969, by the following aye and no vote:

AYES: Councilmen De Luz, Edwards, Greenwell, Matayoshi, Souza, Yadao, Yamada and Chairman Hisaoka - 8.

NOES: None.

ABSENT AND EXCUSED: Councilman Carpenter - 1.

Tadashi Suzuki
COUNTY CLERK
COUNTY OF HAWAII

AN ORDINANCE AMENDING SECTION 7.30, THE PAPAIKOU-ONOMEA ZONE MAP, ORDINANCE NO. 63 (ZONING ORDINANCE), REVISED ORDINANCES OF THE COUNTY OF HAWAII 1967, AS AMENDED, BY CHANGING THE DISTRICT CLASSIFICATION FROM SINGLE FAMILY RESIDENTIAL (RS-7.5) TO VILLAGE COMMERCIAL (CV-10) IN PAPAIKOU, SOUTH HILO HAWAII, COVERED BY TAX MAP KEY 2-7-28:16 & 17.

Date Approved: December 4, 1969
Date Effective: December 15, 1969

Copies of the foregoing Ordinance, in full, are on file in the Office of the County Clerk for use and examination by the public.

I hereby certify that the foregoing Ordinance passed second and final reading at the meeting of the County Council on December 4, 1969, by the following aye and no vote:

AYES: Councilmen De Luz, Edwards, Greenwell, Matayoshi, Souza, Yadao, Yamada and Chairman Hisaoka—8.

Noes: None.

ABSENT AND EXCUSED: Councilman Carpenter—1.

TADASHI SUZUKI
COUNTY CLERK
COUNTY OF HAWAII