

COUNTY OF HAWAII - STATE OF HAWAII

ORDINANCE NO. 298

AN ORDINANCE AMENDING SECTION 7.06, THE NORTH AND SOUTH KOHALA DISTRICTS ZONE MAP, ORDINANCE NO. 63 (ZONING ORDINANCE), REVISED ORDINANCES OF THE COUNTY OF HAWAII 1967, AS AMENDED, BY CHANGING THE DISTRICT CLASSIFICATION FROM AGRICULTURAL (A-20a) TO AGRICULTURAL (A-1a) IN KAHEI HOMESTEADS, NORTH KOHALA, HAWAII COVERED BY TAX MAP KEY 5-5-01:56.

BE IT ORDAINED BY THE COUNCIL OF THE COUNTY OF HAWAII:

SECTION 1. Section 7.06 of Ordinance No. 63 (Zoning Ordinance), Revised Ordinances of the County of Hawaii 1967, as amended, is hereby further amended by adding thereto the following subsection:

"7.06(d). The district classification of the following area situated at Kahei Homesteads, North Kohala, Hawaii, shall be Agricultural (A-1a):

Beginning at the southeast corner of this parcel of land, on the west side of a Homestead Road, the coordinates of said point of beginning referred to Government Survey Triangulation Station "PUU ONALE" being 3,402.13 feet south and 1,471.83 feet west and running by azimuths measured clockwise from true south:

- 1. 106° 43' 244.0 feet;
- 2. 171° 43' 168.0 feet;
- 3. 186° 56' 208.0 feet;
- 4. 279° 38' 418.5 feet to the west side of the Homestead Road;
- 5. 41° 27' 28.9 feet along west side of the Homestead Road;
- 6. 22° 15' 94.6 feet along west side of the Homestead Road;
- 7. 25° 25' 290.5 feet along west side of the Homestead Road to the point of beginning and containing an area of 3.00 acres.

All as outlined in red on the map attached hereto, marked Exhibit "A," and by reference made a part hereof."

C.C. No. ....

FILED .....

M. D. No. 2, 591

Date: JAN 7 1970

JAN 22 1970

SECTION 2. This ordinance shall take effect upon its approval.

INTRODUCED BY:

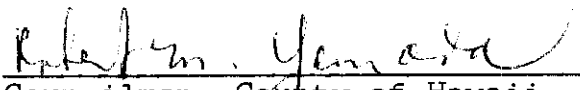
  
\_\_\_\_\_  
Councilman, County of Hawaii

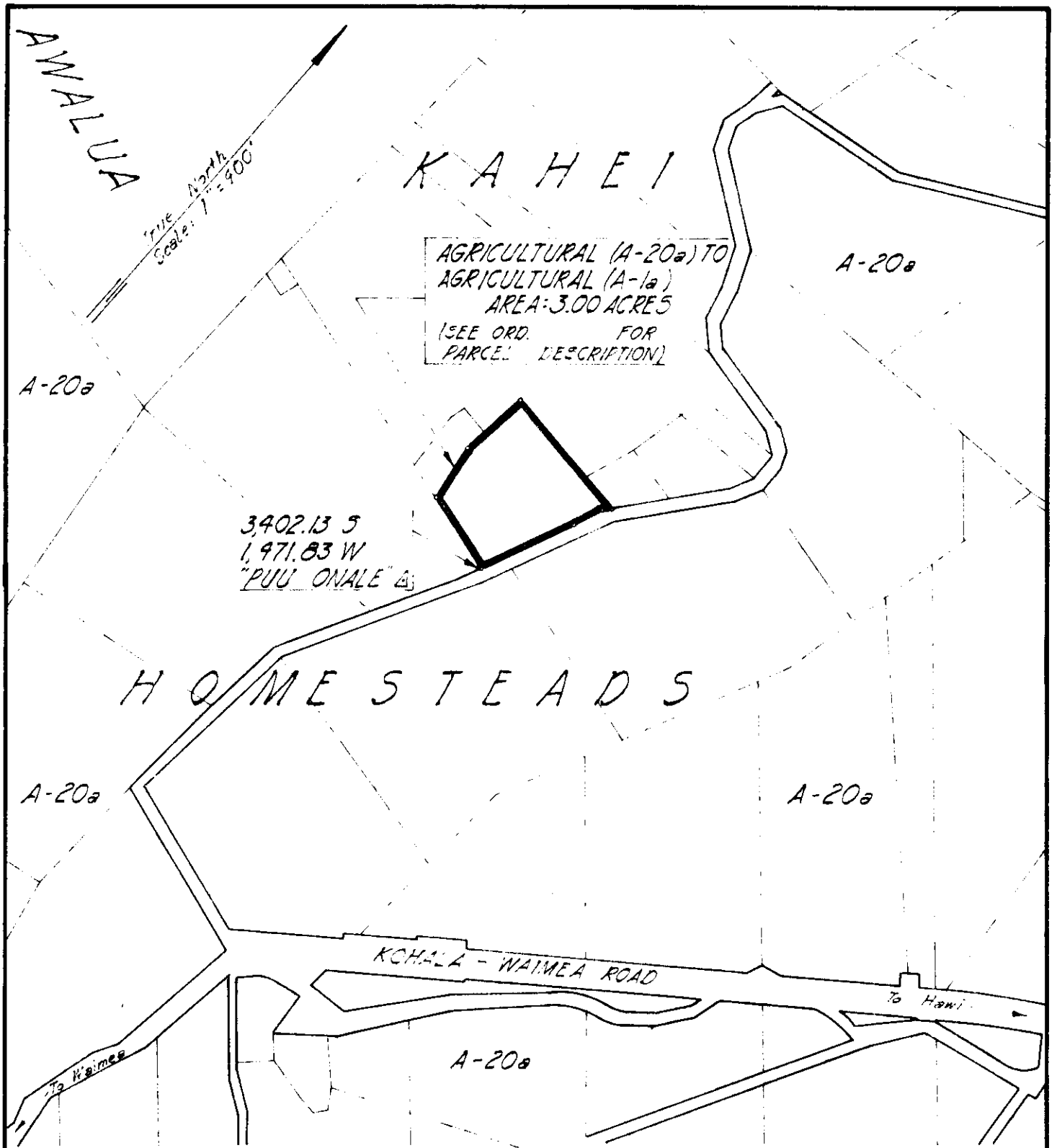

## AMENDMENT TO THE COUNTY ZONING ORDINANCE

AMENDMENT NO. 5 OF SECTION 706, NORTH & SOUTH KOHALA DISTRICTS  
ZONE MAP, PORTION OF ORDINANCE NO. 109, CHANGING THE DISTRICT  
CLASSIFICATION FROM AGRICULTURAL (A-20a) TO AGRICULTURAL (A-1a)  
IN KAHEI HOMESTEADS, NORTH KOHALA, HAWAII.

DATE OF PUBLIC HEARING: NOV. 20, 1969

DATE OF APPROVAL:

ORDINANCE NO.

PREPARED BY: PLANNING DEPARTMENT  
COUNTY OF HAWAII

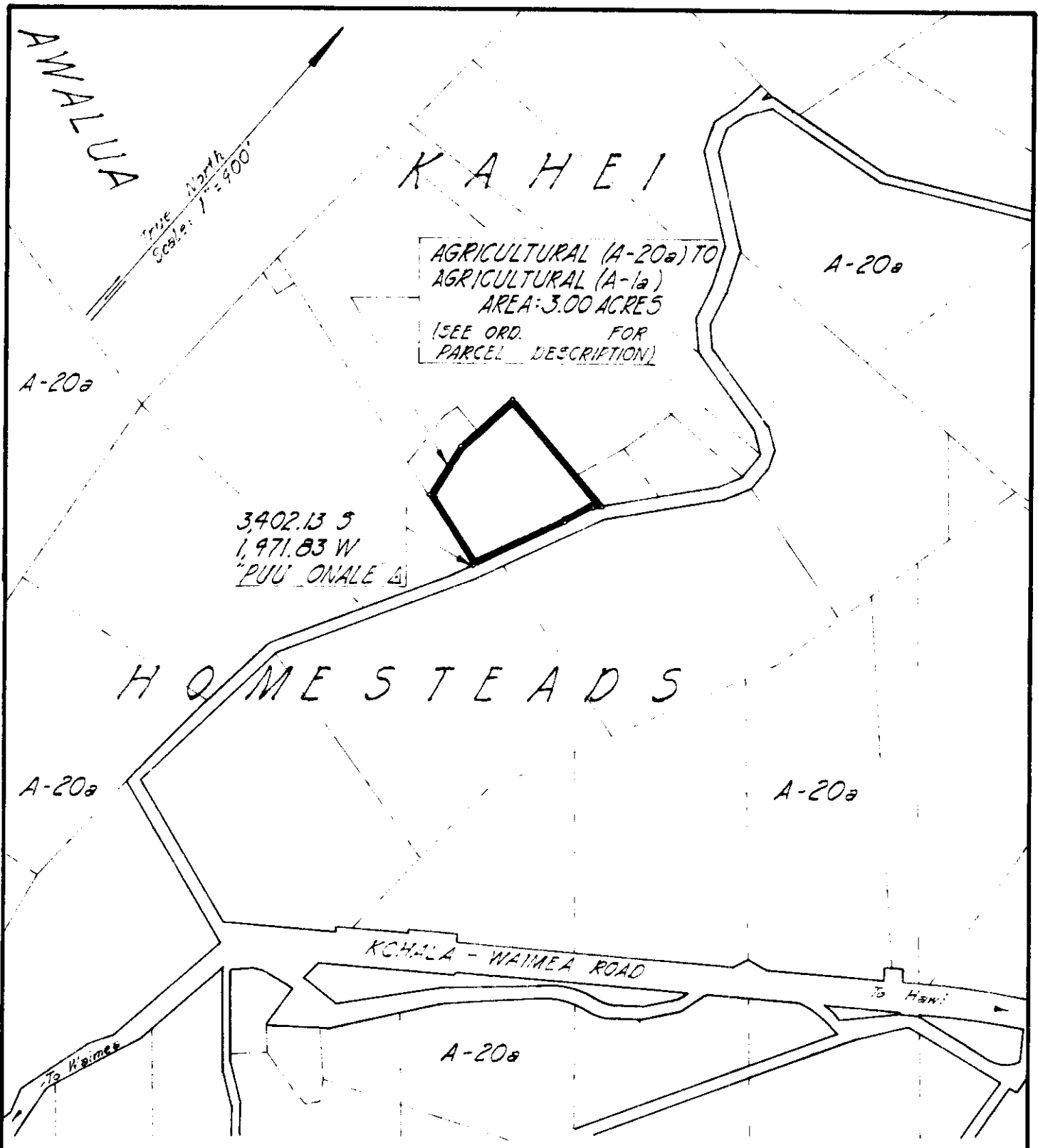

**AMENDMENT TO THE COUNTY ZONING ORDINANCE**

AMENDMENT NO. 5 OF SECTION 706, NORTH & SOUTH KOHALA DISTRICTS ZONE MAP, PORTION OF ORDINANCE NO. 109, CHANGING THE DISTRICT CLASSIFICATION FROM AGRICULTURAL (A-20a) TO AGRICULTURAL (A-1a) IN KAHEI HOMESTEADS, NORTH KOHALA, HAWAII.

DATE OF PUBLIC HEARING: NOV. 20, 1969

DATE OF APPROVAL:

ORDINANCE NO.

PREPARED BY: PLANNING DEPARTMENT  
COUNTY OF HAWAII

ORDINANCE NO. 298  
(Bill No. 684-1970)

AN ORDINANCE AMENDING SECTION 7.06, THE NORTH AND SOUTH KOHALA DISTRICTS ZONE MAP, ORDINANCE NO. 63 (ZONING ORDINANCE), REVISED ORDINANCES OF THE COUNTY OF HAWAII 1967, AS AMENDED, BY CHANGING THE DISTRICT CLASSIFICATION FROM AGRICULTURAL (A-20a) TO AGRICULTURAL (A-1a) IN KAHEI HOMESTEADS, NORTH KOHALA, HAWAII COVERED BY TAX MAP KEY 5-5-01:56.

Date Approved: January 22, 1970  
Date Effective: January 28, 1970

Copies of the foregoing Ordinance, in full, are on file in the Office of the County Clerk for use and examination by the public.

I hereby certify that the foregoing Ordinance passed second and final reading at the meeting of the County Council on January 22, 1970, by the following aye and no vote:

AYES: Councilmen Carpenter, De Luz, Edwards, Greenwell, Matayoshi, Souza, Yadao, Yamada and Chairman Hisaoka - 9.

NOES: None.

*Tadashi Suzuki*

COUNTY CLERK  
COUNTY OF HAWAII

AN ORDINANCE AMENDING SECTION 7.06, THE NORTH AND SOUTH KOHALA DISTRICTS ZONE MAP, ORDINANCE NO. 63 (ZONING ORDINANCE), REVISED ORDINANCES OF THE COUNTY OF HAWAII 1967, AS AMENDED, BY CHANGING THE DISTRICT CLASSIFICATION FROM AGRICULTURAL (A-20a) TO AGRICULTURAL (A-1a) IN KAHEI HOMESTEADS, NORTH KOHALA, HAWAII COVERED BY TAX MAP KEY 5-5-01:56.

Date Approved: January 22, 1970  
Date Effective: January 28, 1970

Copies of the foregoing Ordinance, in full, are on file in the Office of the County Clerk for use and examination by the public.

I hereby certify that the foregoing Ordinance passed second and final reading at the meeting of the County Council on January 22, 1970, by the following aye and no vote:

AYES: Councilmen Carpenter, De Luz, Edwards, Greenwell, Matayoshi, Souza, Yadao, Yamada and Chairman Hisaoka - 9.

NOES: None.  
TADASHI SUZUKI  
COUNTY CLERK  
COUNTY OF HAWAII  
(666-Hawaii Tribune-Herald:  
February 4, 1970)