

COUNTY OF HAWAII - STATE OF HAWAII

ORDINANCE NO. 351

AN ORDINANCE AMENDING SECTION 7.02, THE NORTH KONA ZONE MAP, ORDINANCE NO. 63 (ZONING ORDINANCE), REVISED ORDINANCES OF THE COUNTY OF HAWAII 1967, AS AMENDED, BY CHANGING THE DISTRICT CLASSIFICATION FROM AGRICULTURAL (A-1a) TO VILLAGE COMMERCIAL (CV-10) IN HOLUALOA 2ND, NORTH KONA, HAWAII, COVERED BY TAX MAP KEY 7-6-13:19.

BE IT ORDAINED BY THE COUNCIL OF THE COUNTY OF HAWAII:

SECTION 1. Section 7.02 of Ordinance No. 63 (Zoning Ordinance), Revised Ordinances of the County of Hawaii 1967, as amended, is hereby further amended by adding thereto the following subsection:

"7.02(1). The district classification of the following area situated at Holualoa 2nd, North Kona, Hawaii, shall be Village Commercial (CV-10):

Beginning at the northwest corner of this parcel of land and on the northeasterly side of Kuakini Highway, the coordinates of said point of beginning referred to Government Survey Triangulation Station "NORTH MERIDIAN" being 11,321.29 feet south and 9,715.12 feet east, and running by azimuths measured clockwise from true south:

1. 244^o 11' 537.65 feet along the remainder of R. P. 4475, L. C. Award 7713, Apana 43 to Victoria Kamamalu to a point on the southwesterly side of Kailua-Keauhou Middle Government Road; thence following along the southwesterly side of said road and along the northeasterly face of an old stone wall for the next sixteen (16) courses:
2. 292^o 02' 30" 100.73 feet to a "+" cut in rock;
3. 303^o 57' 26.23 feet to a "+" cut in rock;
4. 295^o 23' 209.47 feet to a "+" cut in rock;
5. 291^o 34' 30" 47.19 feet to a "+" cut in rock;
6. 281^o 01' 134.46 feet to a "+" cut in rock;
7. 285^o 41' 30" 33.47 feet to a "+" cut in rock;
8. 297^o 40' 28.62 feet to a "+" cut in rock;
9. 303^o 32' 30" 48.81 feet to a "+" cut in rock;

10.	300 ^o	54'	30"	71.41 feet to a "+" cut in rock;
11.	300 ^o	54'		47.30 feet to a "+" cut in rock;
12.	322 ^o	20'	30"	75.18 feet to a "+" cut in rock;
13.	315 ^o	45'		27.04 feet to a "+" cut in rock;
14.	303 ^o	29'	30"	25.62 feet;
15.	309 ^o	34'		48.31 feet;
16.	318 ^o	39'		23.09 feet to a spike;
17.	330 ^o	11'		20.41 feet to a spike; thence continuing along the westerly side of the Kailua-Keauhou Middle Government Road and along the easterly face of an old stone wall for the next five (5) courses:
18.	6 ^o	13'		145.21 feet to a "+" cut in rock;
19.	358 ^o	42'		35.59 feet to a "+" cut in rock;
20.	353 ^o	11'	30"	36.77 feet to a "+" cut in rock;
21.	353 ^o	35'	30"	220.63 feet to a "+" cut in rock;
22.	352 ^o	48'		69.51 feet; thence along the windings of the middle of an old stone wall along the northerly boundary of Grant 1591 to Hoolowaihonua for the next nine (9) courses, the direct azimuths and distances being:
23.	75 ^o	28'		57.92 feet to a nail in rock;
24.	87 ^o	08'		39.22 feet to a nail in rock;
25.	60 ^o	41'		68.78 feet to a nail in rock;
26.	82 ^o	30'	30"	47.57 feet to a nail in rock;
27.	73 ^o	42'		281.51 feet to a nail in rock;
28.	87 ^o	19'		20.31 feet to a nail in rock;
29.	77 ^o	31'		291.95 feet to a spike in rock;
30.	86 ^o	14'		51.75 feet to a spike in rock;
31.	75 ^o	46'		52.88 feet to a spike in rock in the easterly side of Kuakini Highway;

32. 154° 11' 1,045.08 feet along the easterly side
of Kuakini Highway to the
point of beginning and con-
taining an area of 23.777
acres, a little more or less.

All as outlined in red on the map attached hereto, marked
Exhibit "A," and by reference made a part hereof."

SECTION 2. This ordinance shall take effect upon its approval.

INTRODUCED BY:

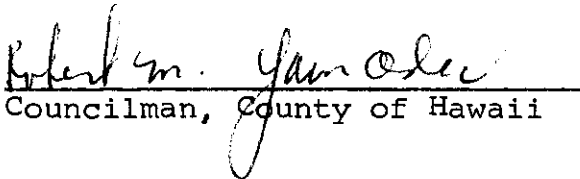
Councilman, County of Hawaii

Hilo, Hawaii

Date of Introduction: October 21, 1970

Date Adoption: November 5, 1970

Hilo, Hawaii

Date of Introduction: October 21, 1970

Date of Adoption: November 5, 1970

First Reading			
	AYES	NOES	A/E
Carpenter	X		
De Luz	X		
Edwards	X		
Greenwell	X		
Matayoshi	X		
Souza	X		
Yadao	X		
Yamada	X		
Chr Hisaoka	X		
	9	0	0

Publication Date: NOV 23 1970

Second & Final Reading			
	AYES	NOES	A/E
Carpenter	X		
De Luz	X		
Edwards	X		
Greenwell	X		
Matayoshi	X		
Souza	X		
Yadao	X		
Yamada	X		
Chr Hisaoka	X		
	9	0	0

Publication Date: NOV 17 1970

We do hereby certify that the foregoing BILL was adopted by the County Council and published as indicated above.

Chr Hisaoka
Council Chairman

Tadashi Suzuki
County Clerk

Approved/~~Disapproved~~ this 12th day of November, 1970.

Shunichi Kimura
Mayor, County of Hawaii

C. No. 351
P. No. 881-890-910
Date October 21, 1970
November 5, 1970

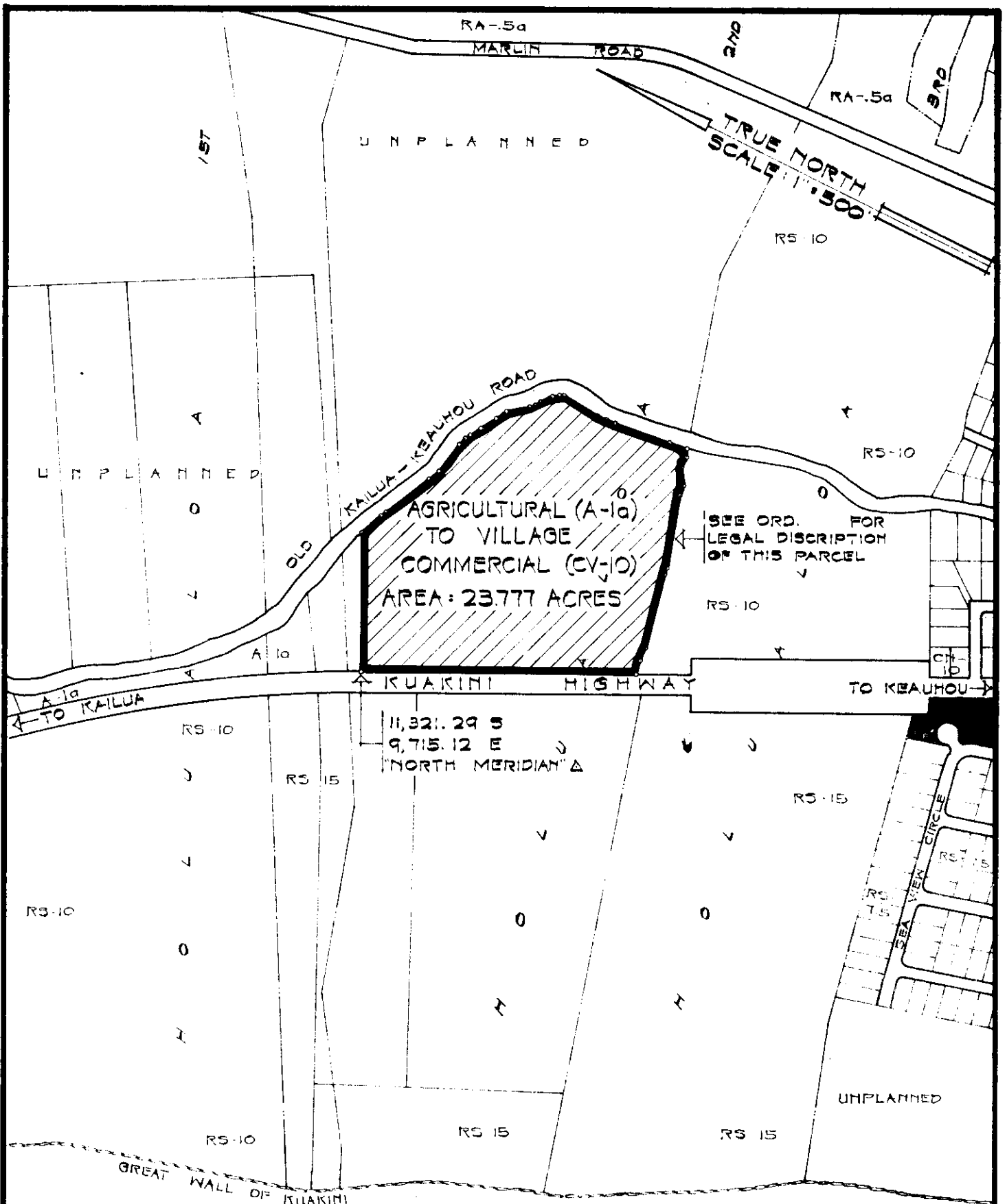

AMENDMENT TO THE COUNTY ZONING ORDINANCE

AMENDMENT NO. 12 OF SECTION 7.02, NORTH KONA ZONE MAP, PORTION OF ORDINANCE NO. 74, CHANGING THE DISTRICT CLASSIFICATION FROM AGRICULTURAL (A-1a) TO VILLAGE COMMERCIAL (CV-10) IN HOLUALOA 2ND, NORTH KONA, HAWAII.

DATE OF PUBLIC HEARING: SEPT. 25, 1970
 DATE OF APPROVAL:
 ORDINANCE NO.
 PREPARED BY: PLANNING DEPARTMENT
 COUNTY OF HAWAII