

COUNTY OF HAWAII - STATE OF HAWAII

ORDINANCE NO. 381

AN ORDINANCE AMENDING SECTION 7.27, THE WAIOHINU ZONE MAP, ORDINANCE NO. 63 (ZONING ORDINANCE), REVISED ORDINANCES OF THE COUNTY OF HAWAII 1967, AS AMENDED, BY CHANGING THE DISTRICT CLASSIFICATION FROM SINGLE FAMILY RESIDENTIAL (RS-15) TO RESORT-HOTEL (V-1.5) IN WAIOHINU, KA'U, HAWAII, COVERED BY TAX MAP KEY 9-5-01:25, 30 AND 44.

BE IT ORDAINED BY THE COUNTY COUNCIL IN AND FOR THE COUNTY OF HAWAII:

SECTION 1. Section 7.27 of Ordinance No. 63 (Zoning Ordinance), Revised Ordinances of the County of Hawaii 1967, as amended, is hereby further amended by adding thereto the following subsection:

"7.27(a). The district classification of the following area situated at Waiohinu, Ka'u, Hawaii, shall be Resort-Hotel (V-1.5):

Beginning at a 1/2" pipe at the south corner of this parcel of land and on northeast side of Mamalahoa Highway, the coordinates of said point of beginning referred to Government Survey Triangulation Station "PUU A AO" being 1333.72 south and 4212.51 east, and running by azimuths measured clockwise from true south:

1. 123 16' 00" 379.02 feet along the northeast side of Mamalahoa Highway;
2. 227 47' 00" 248.36 feet along the remainder of L.C.A. 10683 to Pipi;
3. 322 31' 20" 61.50 feet along a portion of L.C.A. 9174 Apana 1 to Keaweheana 2;
4. 228 21' 00" 190.05 feet along the remainder of L.C.A. 9174 Apana 1 to Keaweheana 2;
5. 142 31' 20" 221.82 feet along same;
6. 55 10' 00" 189.55 feet along same;
7. 142 31' 20" 126.00 feet along a portion of L.C.A. 10683 to Pipi;
8. 228 45' 00" 210.00 feet along portions of Kamehameha IV Deed to C. N. Spencer and L.C.A. 10307 Apana 1 to I;

- | | | | | | |
|-----|-----|-----|-----|--------|---|
| 9. | 322 | 31' | 20" | 460.00 | feet along the remainder of L.C.A. 9174 Apana 1 to Keaweheana 2; |
| 10. | 341 | 50' | 20" | 61.76 | feet along the remainder of L.C.A. 9174 Apana 1 to Keaweheana 2 and L.C.A. 10683 to Pipi; |
| 11. | 37 | 13' | 00" | 147.00 | feet along the Roman Catholic Church Cemetery Lot being portion of L.C.A. 10683 to Pipi; |
| 12. | 306 | 00' | 00" | 82.00 | feet along same; |
| 13. | 33 | 51' | 00" | 204.10 | feet along the northwest side of Roman Catholic Church Cemetery Road to the point of beginning and containing an area of 3.185 acres. |

All as outlined in red on the map attached hereto, marked Exhibit "A" and by reference made a part hereof."

SECTION 2. This ordinance shall take effect upon its approval.

INTRODUCED BY:

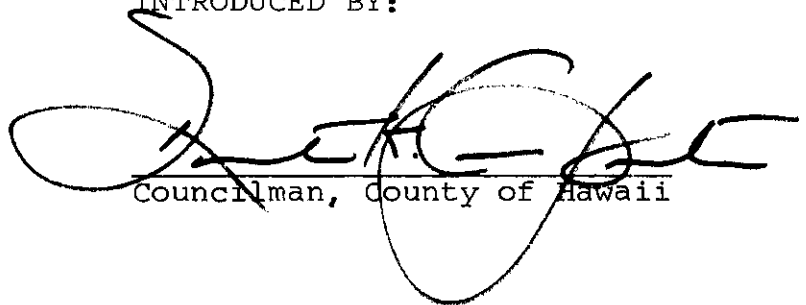

Councilman, County of Hawaii

Hilo, Hawaii

Date of Introduction: March 10, 1971

Date of Adoption: March 24, 1971

Hilo, Hawaii

Date: March 10, 1971

FIRST READING			
	AYES	NOES	A/E
Carpenter	X		
De Luz	X		
Edwards			X
Greenwell			X
Hisaoka	X		
Souza	X		
Yadao	X		
Yamada	X		
Chr Matayoshi	X		
	7	0	2

MAR 16 1971

Publication Date: _____

Laupahoehoe, Hawaii

Date: March 24, 1971

SECOND & FINAL READING			
	AYES	NOES	A/E
Carpenter	X		
De Luz	X		
Edwards	X		
Greenwell			X
Hisaoka	X		
Souza	X		
Yadao	X		
Yamada	X		
Chr Matayoshi	X		
	8	0	1

APR 2 1971

Publication Date: _____

We do hereby certify that the foregoing BILL was adopted by the County Council and published as indicated above.

 Council Chairman

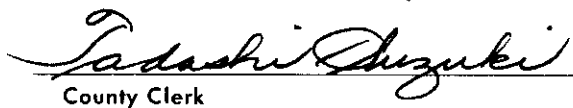
 County Clerk

Approved/Disapproved this 30th day of March, 1971



 Mayor, County of Hawaii

Bill No. 782
 Reference: PEDLC-50
 M. B. No. 1001, 1012
 Ord. No. 381

**SINGLE FAMILY RESIDENTIAL (RS-15)
TO RESORT-HOTEL (V-1.5)
AREA: 3.185 ACRES**

TRUE NORTH
SCALE 1" = 200'

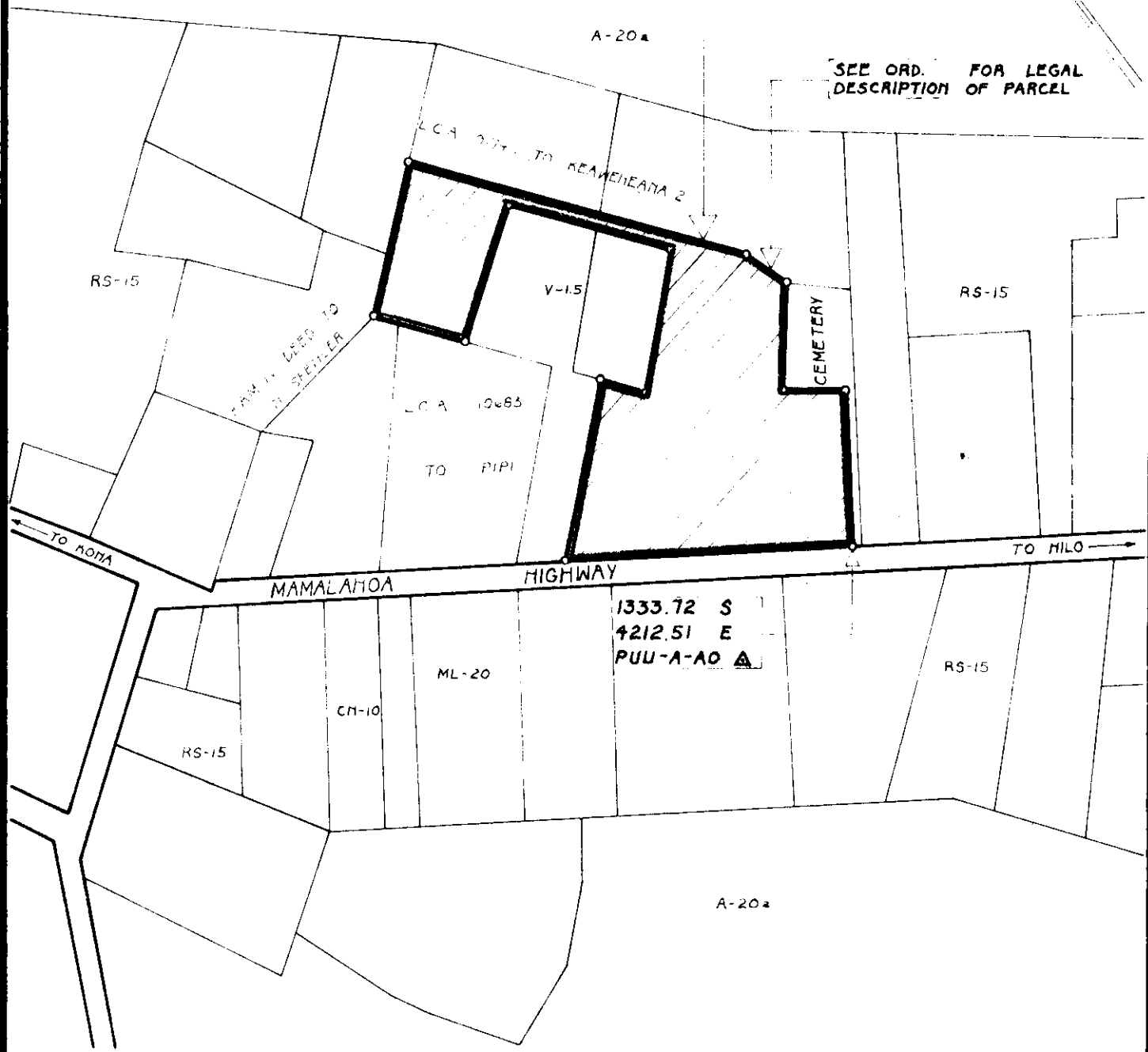
SEE ORD. FOR LEGAL DESCRIPTION OF PARCEL



AMENDMENT TO THE COUNTY ZONING ORDINANCE

AMENDMENT NO. 1 OF SECTION 7.27, WAIOHINU ZONE MAP,
PORTION OF ORDINANCE NO. III, CHANGING THE DISTRICT CLASSI-
FICATION FROM SINGLE FAMILY RESIDENTIAL (RS-15) TO RESORT-
HOTEL (V-1.5) IN WAIOHINU, KA'U, HAWAII.

DATE OF PUBLIC HEARING: DEC. 18, 1970
DATE OF APPROVAL:
ORDINANCE NO.
PREPARED BY PLANNING DEPARTMENT
COUNTY OF HAWAII

TMK: 9-5-01-25, 30 & 44

FEB. 25, 1971

EXHIBIT "A"