

COUNTY OF HAWAII - STATE OF HAWAII

ORDINANCE NO. 431

AN ORDINANCE AMENDING SECTION 7.05, THE KAILUA-HONALO URBAN ZONE MAP, ORDINANCE NO. 63 (ZONING ORDINANCE), REVISED ORDINANCES OF THE COUNTY OF HAWAII 1967, AS AMENDED, BY CHANGING THE DISTRICT CLASSIFICATION FROM RESORT (V-1.25) TO SINGLE-FAMILY RESIDENTIAL (RS-7.5) IN KAHALUU, NORTH KONA, HAWAII, COVERED BY TAX MAP KEY 7-8-14:6, 74, 81, 82, 83, 84.

BE IT ORDAINED BY THE COUNCIL OF THE COUNTY OF HAWAII.

SECTION 1. Section 7.05 of Ordinance No. 63 (Zoning Ordinance), Revised Ordinances of the County of Hawaii 1967, as amended, is hereby further amended by adding thereto the following subsection:

"7.05 (J). The district classification of the following area situated at Kahaluu, North Kona, Hawaii, shall be Single-Family Residential (RS-7.5):

Beginning at the Southeast corner of this parcel of land, the North corner of L. C. Aw. 6071 to Hoopale, and on the Southwest side of Alii Drive, the coordinates of said point of beginning referred to Government Survey Triangulation Station "Keauhou Coast" being 10,260.70 feet North and 153.03 feet West, and running thence by azimuths measured clockwise from true South:

- | | | | | |
|-----|------|-----|-----|------------------------------------------------------------------------------------------------------------------------------------------------------------------|
| 1. | 66° | 42' | 22" | 99.61 feet along L. C. Aw. 6071 to Hoopale; Thence along the shoreline for the next six (6) courses, the direct azimuths and distances being |
| 2. | 140° | 07' | 30" | 121.06 feet; |
| 3. | 166° | 22' | 22" | 80.73 feet; |
| 4. | 151° | 07' | 22" | 60.15 feet; |
| 5. | 154° | 33' | 22" | 115.46 feet; |
| 6. | 137° | 44' | 22" | 121.46 feet; |
| 7. | 151° | 02' | 52" | 110.22 feet; |
| 8. | 244° | 40' | 22" | 97.00 feet along Lot 25-A, Kahaluu Beach Lots; |
| 9. | 334° | 40' | 22" | 125.00 feet along the Southwest side of Alii Drive; Thence along same on a curve to the left with a radius of 1457.70 feet, the chord azimuth and distance being |
| 10. | 328° | 49' | 07" | 300.74 feet; |
| 11. | 322° | 49' | 50" | 34.19 feet along the Southwest side of Alii Drive; |
| 12. | 74° | 30' | 22" | 70.63 feet along R. P. 5926, L. C. Aw. 5671, Ap. I to Kahalalahale; |
| 13. | 327° | 42' | 22" | 42.10 feet along same; |
| 14. | 254° | 21' | 22" | 74.54 feet along same; |
| 15. | 322° | 49' | 52" | 104.42 feet along the Southwest side of Alii Drive to the point of beginning and containing an area of 1.27 acres. |

All as outlined in red on the map attached hereto, marked Exhibit "A" and by reference made a part hereof."

SECTION 2. This ordinance shall take effect upon its approval.

INTRODUCED BY:

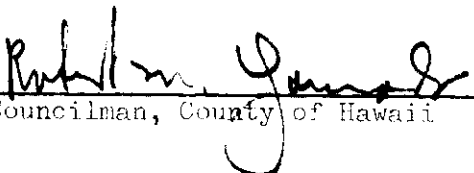

Councilman, County of Hawaii

Hilo, Hawaii

Date of Introduction: **October 20, 1971**

Date of Adoption: **November 3, 1971**

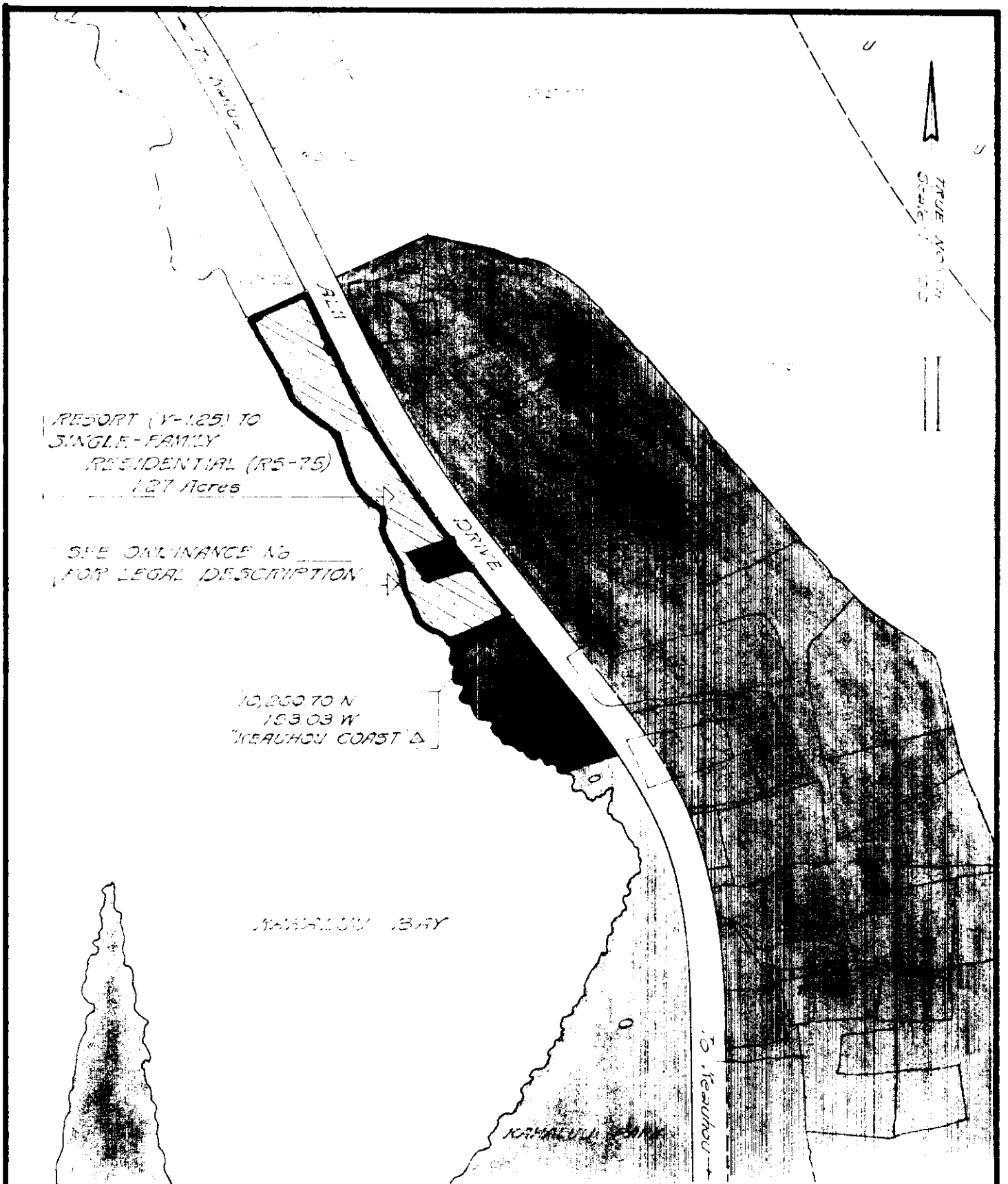

AMENDMENT TO THE COUNTY ZONING ORDINANCE

AMENDMENT NO. 10 OF SECTION 7.05, KAILUA-HONALO ZONE
 MAP PORTION OF ORDINANCE NO. 74, CHANGING THE DISTRICT
 CLASSIFICATION FROM RESORT-HOTEL ~1,250 SQ. FT. (V-125) TO
 SINGLE-FAMILY RESIDENTIAL ~7,500 SQ. FT. (RS-75) IN KAHALOO,
 NORTH KONA, HAWAII.

DATE OF PUBLIC HEARING 7-8-71

DATE OF APPROVAL:

ORDINANCE NO.

PREPARED BY: PLANNING DEPARTMENT
 COUNTY OF HAWAII

TAX MAP KEY 7-8-14 6,748,8283,84

SEPT. 1, 1971

EXHIBIT "A"

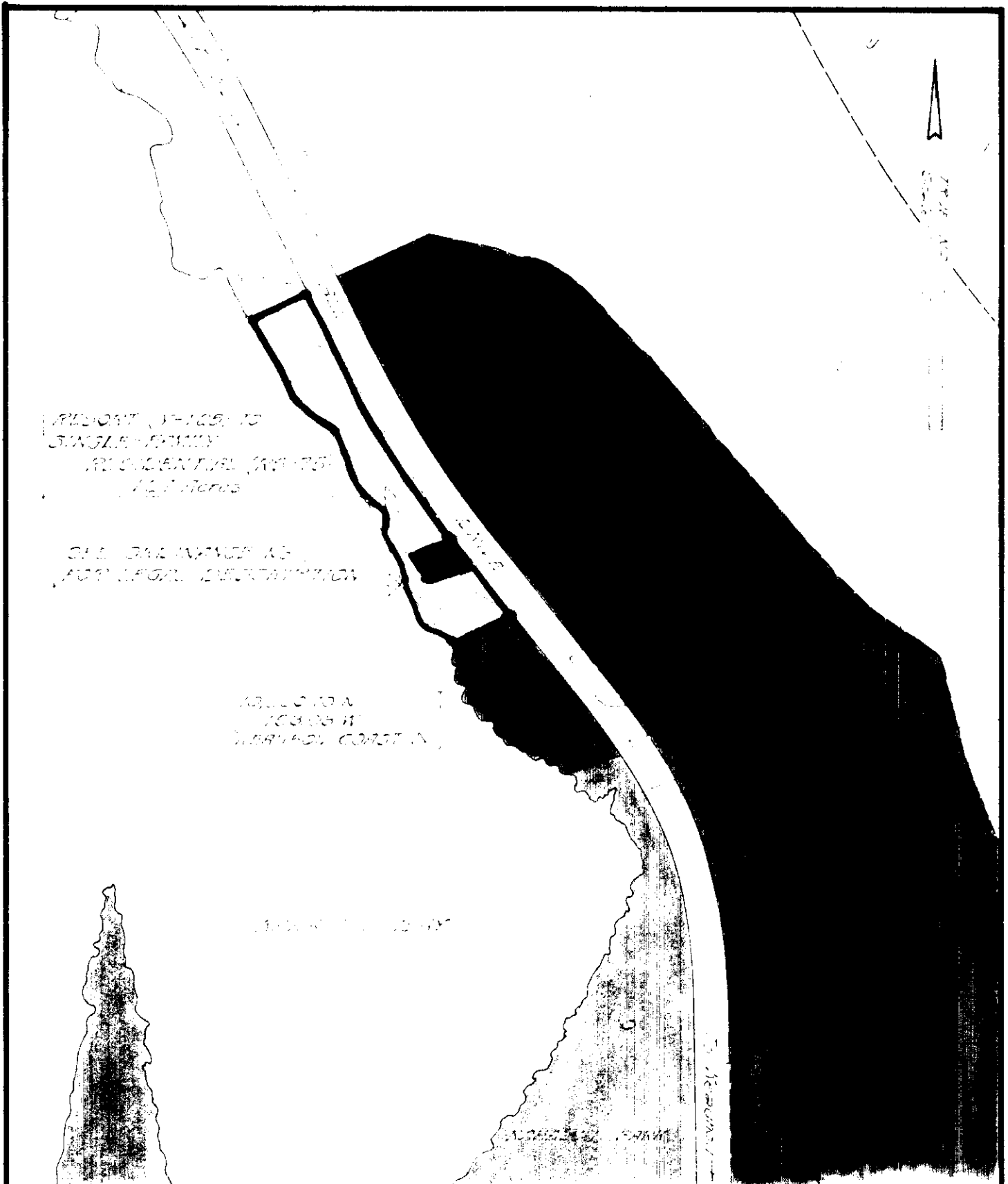

AMENDMENT TO THE COUNTY ZONING ORDINANCE

AMENDMENT NO. 10 OF SECTION 7.05, KAILUA-HONALO ZONE
 MAP PORTION OF ORDINANCE NO 74, CHANGING THE DISTRICT
 CLASSIFICATION FROM ALCOVE-HOTEL - 1250 SQ FT (V-125) TO
 SINGLE-FAMILY RESIDENTIAL - 7500 SQ FT (RS-75) IN KAHALUU,
 NORTH KONA, HAWAII

DATE OF PUBLIC HEARING 7-8-71
 DATE OF APPROVAL
 ORDINANCE NO
 PREPARED BY PLANNING DEPARTMENT
 COUNTY OF HAWAII

TAX MAP KEY 7-8-14 6,748,888,884

SEPT. 1, 1971

EXHIBIT "A"

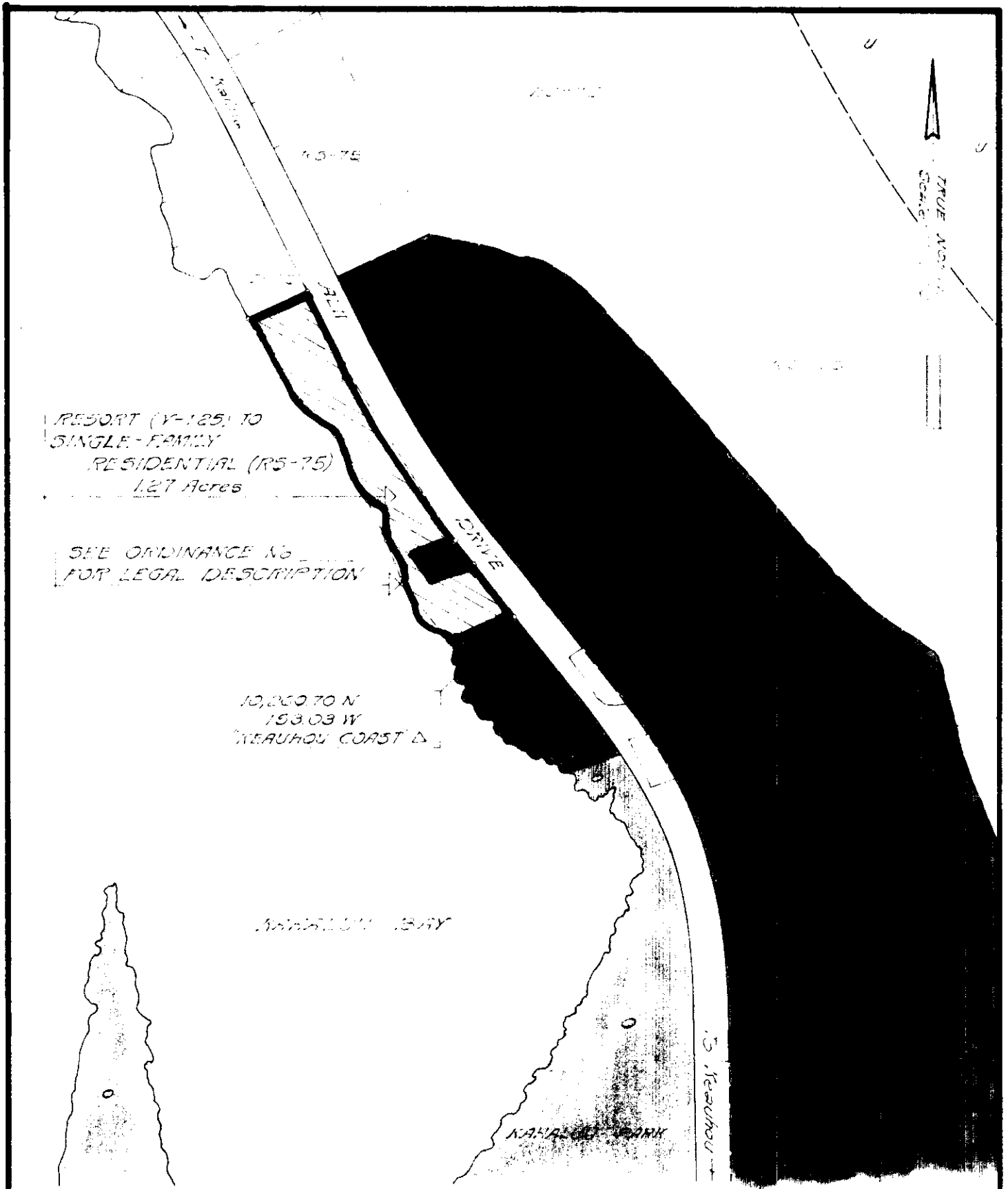

AMENDMENT TO THE COUNTY ZONING ORDINANCE

AMENDMENT NO. 10 OF SECTION 7.05, KAILUA-HONALO ZONE
 MAP, PORTION OF ORDINANCE NO. 74, CHANGING THE DISTRICT
 CLASSIFICATION FROM RESORT-HOTEL ~1250 SQ. FT. (V-125) TO
 SINGLE-FAMILY RESIDENTIAL ~7,500 SQ. FT. (RS-75) IN KAAHALUO,
 NORTH KONA, HAWAII.

DATE OF PUBLIC HEARING 7-8-71

DATE OF APPROVAL

ORDINANCE NO.

PREPARED BY: PLANNING DEPARTMENT
 COUNTY OF HAWAII

TAX MAP KEY: 7-8-14 6,148,828,84

SEPT. 1, 1971

EXHIBIT "A"

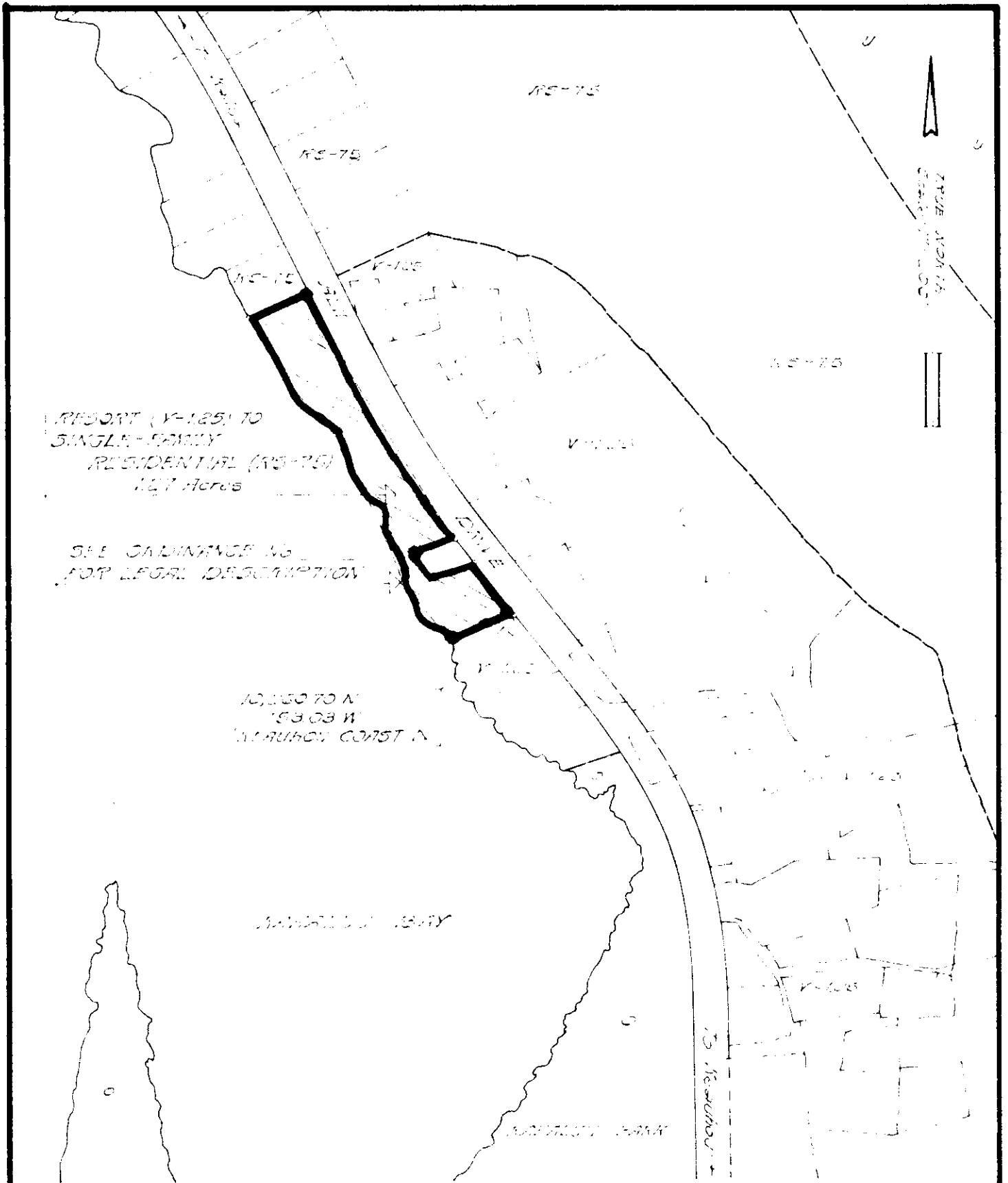

AMENDMENT TO THE COUNTY ZONING ORDINANCE

AMENDMENT NO. 10 OF SECTION 7.05, KAILUA-HONALO ZONE
 MAP PORTION OF ORDINANCE NO. 74, CHANGING THE DISTRICT
 CLASSIFICATION FROM RESORT-HOTEL ~1,250 SQ FT (V-125) TO
 SINGLE-FAMILY RESIDENTIAL ~7,500 SQ FT (RS-75) IN KAHALUU,
 NORTH KONA, HAWAII.

DATE OF PUBLIC HEARING 7-8-71

DATE OF APPROVAL

ORDINANCE NO.

PREPARED BY: PLANNING DEPARTMENT

COUNTY OF HAWAII

TAX MAP KEY 7-8-14 61481828384

SEPT. 1, 1971

EXHIBIT "A"

Hilo, Hawaii

Date: October 20, 1971

FIRST READING			
	AYES	NOES	A/E
Carpenter	X		
De Luz	X		
Edwards	X		
Greenwell	X		
Hisaoka	X		
Souza	X		
Yadao	X		
Yamada	X		
Chr Matayoshi	X		
	9	0	0

Publication Date: OCT 3 1971

Hilo, Hawaii

Date: November 3, 1971

SECOND & FINAL READING			
	AYES	NOES	A/E
Carpenter	X		
De Luz	X		
Edwards	X		
Greenwell	X		
Hisaoka	X		
Souza	X		
Yadao	X		
Yamada	X		
Chr Matayoshi	X		
	9	0	0

Publication Date: NOV 29 1971

We do hereby certify that the foregoing BILL was adopted by the County Council and published as indicated above.

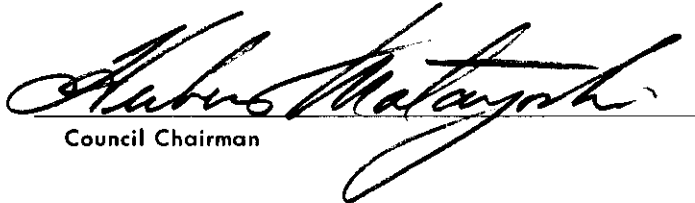
 Council Chairman

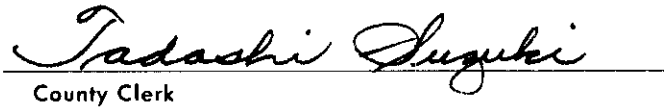
 County Clerk

Approved/~~Disapproved~~ this 5th day of
November, 1971

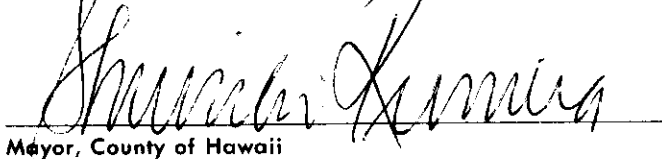
 Mayor, County of Hawaii

Bill No. 826
 Reference: C-1642/PEDLC-64
 M. B. No.
 Ord. No. 431

Bill No. 826 - 1971

AN ORDINANCE AMENDING SECTION 7.05, THE KAILUA-HONALO URBAN ZONE MAP, ORDINANCE NO. 63 (ZONING ORDINANCE), REVISED ORDINANCES OF THE COUNTY OF HAWAII 1967, AS AMENDED, BY CHANGING THE DISTRICT CLASSIFICATION FROM RESORT (V-1.25) TO SINGLE-FAMILY RESIDENTIAL (RS-7.5) IN KAHALUU, NORTH KONA, HAWAII, COVERED BY TAX MAP KEY 7-8-14:6, 74, 81, 82, 83, 84.

This Bill proposes to amend the Kailua-Honalo Urban Zone Map by changing the district classification from Resort - Hotel - 1,250 sq. ft. zone (V-1.25) to Single - Family Residential - 7,500 sq. ft. zone (RS-7.5) in Kahaluu, North Kona, Hawaii, containing an area of 1.27 acre parcel of land situated makai of Alii Drive in the Kahaluu Beach Lots area.

Date Introduced: October 20, 1971

Copies of the foregoing Bill, in full, are on file in the Office of the County Clerk for use and examination by the public.

I hereby certify that the foregoing Bill passed first reading at the meeting of the County Council on October 20, 1971, by the following aye and no vote:

AYES: Councilmen Carpenter, De Luz, Edwards, Greenwell, Hisaoka, Souza, Yadao, Yamada and Chairman Matayoshi - 9.

NOES: None.



COUNTY CLERK
COUNTY OF HAWAII

000 400 000 - 1971
AN ORDINANCE AMENDING SECTION 7.05, THE KAILUA-HONALO URBAN ZONE MAP, ORDINANCE NO. 63 (ZONING ORDINANCE), REVISED ORDINANCES OF THE COUNTY OF HAWAII 1967, AS AMENDED, BY CHANGING THE DISTRICT CLASSIFICATION FROM RESORT (V-1.25) TO SINGLE-FAMILY RESIDENTIAL (RS-7.5) IN KAHALUU, NORTH KONA, HAWAII, COVERED BY TAX MAP KEY 7-8-14:6, 74, 81, 82, 83, 84.

This Bill proposes to amend the Kailua-Honalo Urban Zone Map by changing the district classification from Resort Hotel—1,250 sq. ft. zone (V-1.25) to Single—Family Residential—7,500 sq. ft. zone (RS-7.5) in Kahaluu, North Kona, Hawaii, containing an area of 1.27 acre parcel of land situated makai of Alii Drive in the Kahaluu Beach Lots area.

Date Introduced: October 20, 1971

Copies of the foregoing Bill, in full, are on file in the Office of the County Clerk for use and examination by the public.

I hereby certify that the foregoing Bill passed first reading at the meeting of the County Council on October 20, 1971, by the following aye and no vote:

AYES: Councilmen Carpenter, De Luz, Edwards, Greenwell, Hisaoka, Souza, Yadao, Yamada and Chairman Matayoshi—9.

NOES: None.

TADASHI SUZUKI
COUNTY CLERK
COUNTY OF HAWAII

ORDINANCE NO. 431
(Bill No. 826-1971)

AN ORDINANCE AMENDING SECTION 7.05, THE KAILUA-HONALO URBAN ZONE MAP, ORDINANCE NO. 63 (ZONING ORDINANCE), REVISED ORDINANCES OF THE COUNTY OF HAWAII 1967, AS AMENDED, BY CHANGING THE DISTRICT CLASSIFICATION FROM RESORT (V-1.25) TO SINGLE-FAMILY RESIDENTIAL (RS-7.5) IN KAHALUU, NORTH KONA, HAWAII, COVERED BY TAX MAP KEY 7-8-14:6, 74, 81, 82, 83, 84.

Date Approved: November 3, 1971

Date Effective: November 5, 1971

Copies of the foregoing Ordinance, in full, are on file in the Office of the County Clerk for use and examination by the public.

I hereby certify that the foregoing Ordinance passed second and final reading at the meeting of the County Council on November 3, 1971, by the following aye and no vote:

AYES: Councilmen Carpenter, De Luz, Edwards, Greenwell, Hisaoka, Souza, Yadao, Yamada and Chairman Matayoshi - 9.

NOES: None.

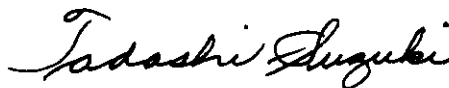

COUNTY CLERK
COUNTY OF HAWAII

AN ORDINANCE AMENDING SECTION 7.05, THE KAILUA-HONALO URBAN ZONE MAP, ORDINANCE NO. 63 (ZONING ORDINANCE), REVISED ORDINANCES OF THE COUNTY OF HAWAII 1967, AS AMENDED, BY CHANGING THE DISTRICT CLASSIFICATION FROM RESORT (V-1.25) TO SINGLE-FAMILY RESIDENTIAL (RS-7.5) IN KAHALUU, NORTH KONA, HAWAII, COVERED BY TAX MAP KEY 7-8-14:6, 74, 81, 82, 83, 84.

Date Approved: November 3, 1971
Date Effective: November 5, 1971

Copies of the foregoing Ordinance, in full, are on file in the Office of the County Clerk for use and examination by the public.

I hereby certify that the foregoing Ordinance passed second and final reading at the meeting of the County Council on November 3, 1971, by the following aye and no vote:

AYES: Councilmen Carpenter, De Luz, Edwards, Greenwell, Hisaoka, Souza, Yadao, Yamada and Chairman Matayoshi—9.

NOES: None.
TADASHI SUZUKI
COUNTY CLERK
COUNTY OF HAWAII

Tadashi Suzuki
COUNTY CLERK

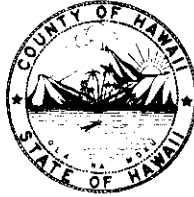

Robert Shioji
DEPUTY COUNTY CLERK

OFFICE OF THE COUNTY CLERK

COUNTY OF HAWAII
HILO, HAWAII 96720

Mayor Shunichi Kimura
County of Hawaii
Hilo, Hawaii

I hereby transmit Ordinance Bill No. 826 passed by
the County Council on second and final reading.

Tadashi Suzuki
COUNTY CLERK

Encl.

Dated: November 4, 1971