

COUNTY OF HAWAII - STATE OF HAWAII

ORDINANCE NO. 455

AN ORDINANCE AMENDING SECTION 7.02, THE NORTH KONA ZONE MAP, ORDINANCE NO. 63 (ZONING ORDINANCE), REVISED ORDINANCES OF THE COUNTY OF HAWAII 1967, AS AMENDED, BY CHANGING THE DISTRICT CLASSIFICATION FROM AGRICULTURAL (A-1a) TO MULTIPLE FAMILY RESIDENTIAL (RM-2) IN PUA A 1st, NORTH KONA, HAWAII, COVERED BY TAX MAP KEY 7-5-09:57.

BE IT ORDAINED BY THE COUNCIL OF THE COUNTY OF HAWAII:

SECTION 1. Section 7.02 of Ordinance No. 63 (Zoning Ordinance), Revised Ordinances of the County of Hawaii 1967, as amended, is hereby further amended by adding thereto the following subsection:

"7.02 (o). The district classification of the following area situated at Puaa 1st, North Kona, Hawaii, shall be Multiple Family Residential (RM-2):

Beginning at the Northwest corner of this parcel of land and on the East side of Kuakini Highway, the coordinates of said point of beginning referred to Government Survey Triangulation Station "KAHELO" being 4,971.88 feet North and 882.55 feet West, thence running by azimuths measured clockwise from true South:

- | | | | | | |
|----|------|-----|-----|--------|--|
| 1. | 266° | 44' | 30" | 758.74 | feet along the remainder of R. P. 7845, L. C. Aw. 7715, Apana 13 to Lota Kamehameha; |
| 2. | 346° | 29' | 45" | 421.61 | feet along same; |
| 3. | 84° | 27' | 00" | 631.26 | feet along same; |
| 4. | 151° | 59' | 00" | 484.67 | feet along the East side of Kuakini Highway to the point of beginning and containing an area of 6.858 acres. |

All as outlined in red on the map attached hereto, marked Exhibit "A" and by reference made a part hereof."

SECTION 2. Section 1 of this ordinance shall take effect forthwith upon the conditions that (1) the proposed development shall comply to the goals, policies and standards of multiple residential developments as contained within the General Plan and (2) the zoning of the mauka three (3) acres will not become effective until substantial development has occurred in the lower 3.858 acres. Substantial development is defined as building permits issued and construction commenced on 15 per cent of the permanent structures of the entire project. For

the purpose of computing the 15 per cent, it shall be understood to include the total number of units (128) involved in the project.

SECTION 3. In the event that any portion of this ordinance is declared invalid, such invalidity shall not affect the other parts of this ordinance.

SECTION 4. This ordinance shall take effect upon its approval.

INTRODUCED BY:



Councilman, County of Hawaii

Hilo, Hawaii

Date of Introduction: March 1, 1972

Date of Adoption: March 13, 1972

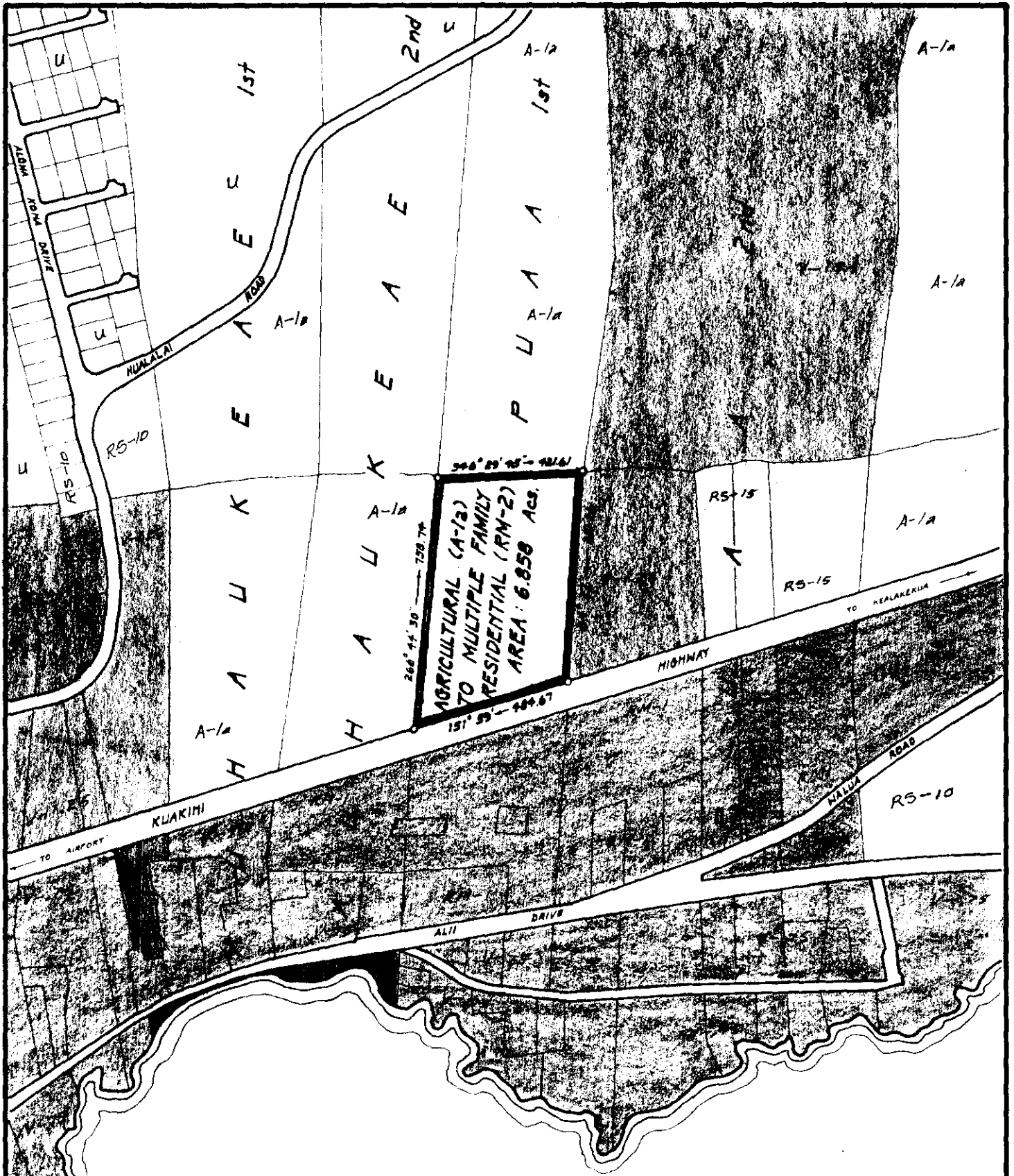

AMENDMENT TO THE COUNTY ZONING ORDINANCE

AMENDMENT NO. 15 OF SECTION 7.02, THE NORTH KONA ZONE MAP, PORTION OF ORDINANCE NO. 74, CHANGING THE DISTRICT CLASSIFICATION FROM AGRICULTURAL (A-12) TO MULTIPLE FAMILY RESIDENTIAL (RM-2) IN PUU A A 1st, NORTH KONA, HAWAII.

DATE OF PUBLIC HEARING: JAN. 20, 1972

DATE OF APPROVAL:

ORDINANCE NO.

PREPARED BY: PLANNING DEPT.
COUNTY OF HAWAII

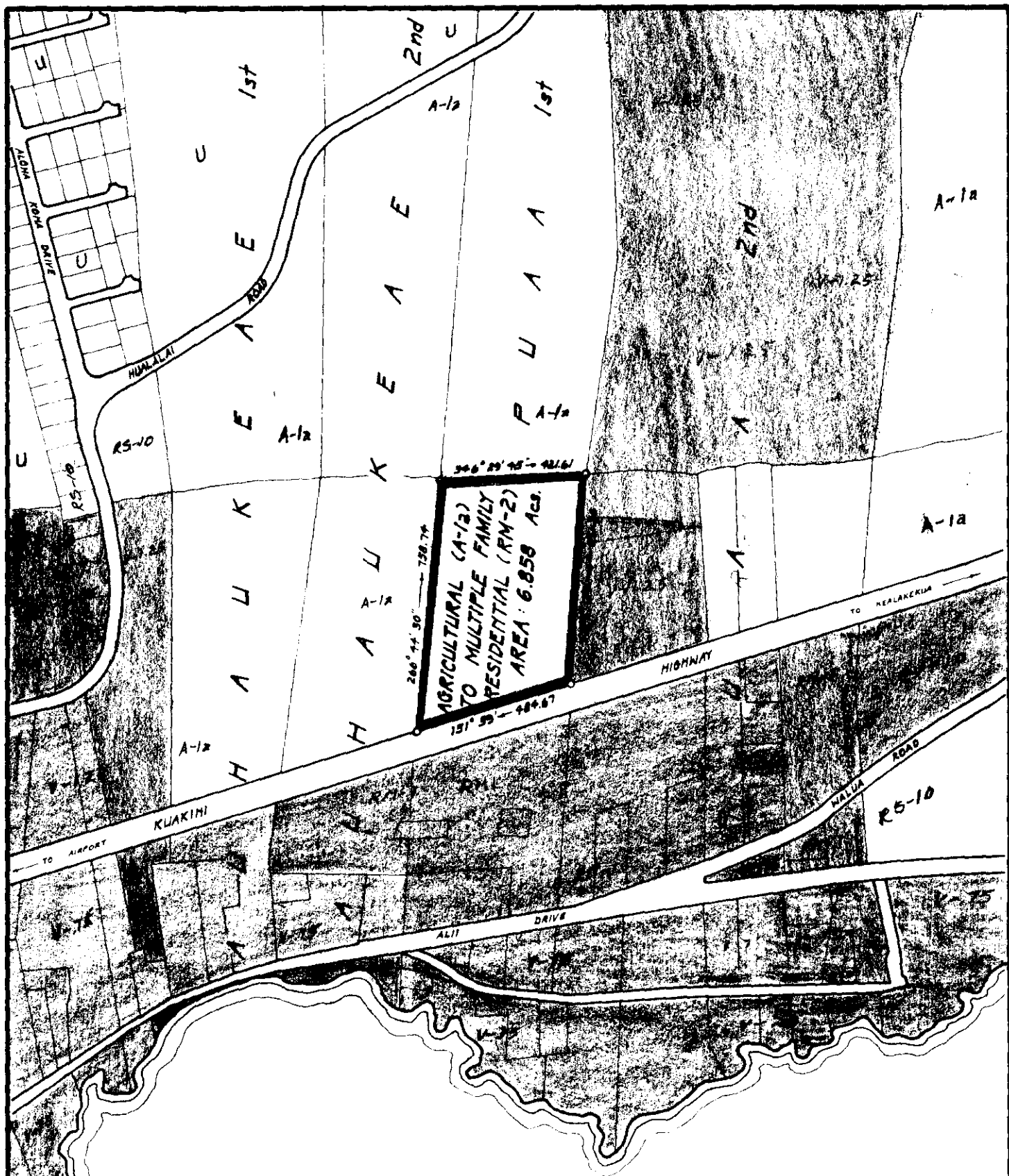

246° 44' 50" → 158.74
 151° 59' → 244.67
 346° 29' 15" → 421.61
 AGRICULTURAL (A-1a)
 TO MULTIPLE FAMILY
 RESIDENTIAL (RM-2)
 AREA: 6.858 Acs.

AMENDMENT TO THE COUNTY ZONING ORDINANCE

AMENDMENT NO. 15 OF SECTION 7.02, THE
 NORTH KOMA ZONE MAP, PORTION OF ORDINANCE
 NO. 74, CHANGING THE DISTRICT CLASSIFICATION
 FROM AGRICULTURAL (A-1a) TO MULTIPLE FAMILY
 RESIDENTIAL (RM-2) IN PUU A A 1st, NORTH KOMA, HAWAII.

DATE OF PUBLIC HEARING: JAN. 20, 1972
 DATE OF APPROVAL:
 ORDINANCE NO.
 PREPARED BY: PLANNING DEPT.
 COUNTY OF HAWAII

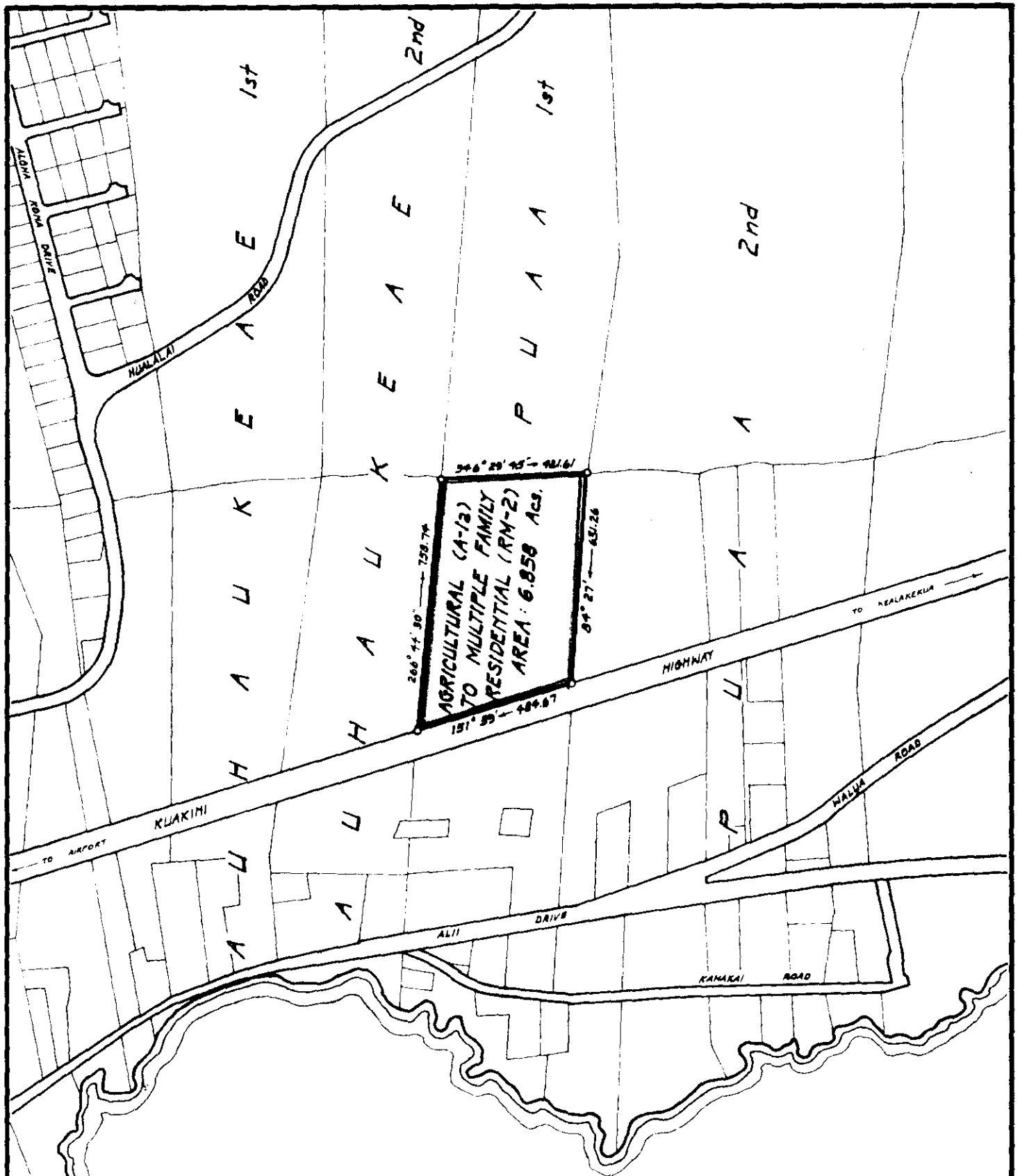

AMENDMENT TO THE COUNTY ZONING ORDINANCE

AMENDMENT NO. 15 OF SECTION 7.02, THE NORTH KONA ZONE MAP, PORTION OF ORDINANCE NO. 74, CHANGING THE DISTRICT CLASSIFICATION FROM AGRICULTURAL (A-12) TO MULTIPLE FAMILY RESIDENTIAL (RM-2) IN PUA 1st, NORTH KONA, HAWAII.

DATE OF PUBLIC HEARING: JAN. 20, 1972

DATE OF APPROVAL:

ORDINANCE NO.

PREPARED BY: PLANNING DEPT.
COUNTY OF HAWAII

Hilo, Hawaii
 Date: March 1, 1972

FIRST READING			
	AYES	NOES	A/E
Carpenter	X		
De Luz	X		
Edwards	X		
Greenwell	X		
Hisaoka	X		
Souza	X		
Yadao	X		
Yamada	X		
Chr Matayoshi	X		
	9	0	0

MAR 9 1972

Publication Date: _____

Hilo, Hawaii
 Date: March 13, 1972

SECOND & FINAL READING			
	AYES	NOES	A/E
Carpenter	X		
De Luz	X		
Edwards	X		
Greenwell	X		
Hisaoka	X		
Souza	X		
Yadao	X		
Yamada	X		
Chr Matayoshi	X		
	9	0	0

MAR 30 1972

Publication Date: _____

We do hereby certify that the foregoing BILL was adopted by the County Council and published as indicated above.

Shunichi Matayoshi
 Council Chairman

Tadashi Suzuki
 County Clerk

Approved/Disapproved this 23rd day of
December, 1971

Shunichi Kimura
 Mayor, County of Hawaii

Bill No. 854
 Reference: 9-1847/PEDLC-73
 M. B. No. 1025
 Ord. No. 455

Bill No. 854 - 1972

AN ORDINANCE AMENDING SECTION 7.02, THE NORTH KONA ZONE MAP, ORDINANCE NO. 63 (ZONING ORDINANCE), REVISED ORDINANCES OF THE COUNTY OF HAWAII 1967, AS AMENDED, BY CHANGING THE DISTRICT CLASSIFICATION FROM AGRICULTURAL (A-1a) TO MULTIPLE FAMILY RESIDENTIAL (RM-2) IN PUA A 1st, NORTH KONA, HAWAII, COVERED BY TAX MAP KEY 7-5-09:57.

This Bill proposes to amend the North Kona Zone Map by changing the district classification from an Agricultural (A-1a) zone to a Multiple Family Residential (RM-2) in Puaa 1st, North Kona, Hawaii, containing an area of 6.858 acre parcel of land fronting Kuakini Highway on the mauka side and adjacent to the Pacific Empress Hotel.

Date Introduced: March 1, 1972

Copies of the foregoing Bill, in full, are on file in the Office of the County Clerk for use and examination by the public.

I hereby certify that the foregoing Bill passed first reading at the meeting of the County Council on March 1, 1972, by the following aye and no vote.

AYES: Councilmen Carpenter De Luz, Edwards, Greenwell, Hisaoka, Souza, Yadao Yamada and Chairman Matayoshi - 9.

NOES: None.

Bill No. 854
AN ORDINANCE AMENDING
SECTION 7.02, THE NORTH
KONA ZONE MAP,
ORDINANCE NO. 63 (ZONING OR-
DINANCE), REVISED ORDINANCES OF
THE COUNTY OF HAWAII 1967, AS
AMENDED BY CHANGING THE
DISTRICT CLASSIFICATION FROM
AGRICULTURAL (A-1a) TO MULTIPLE
FAMILY RESIDENTIAL (RM-2) IN
PUA A 1st, NORTH KONA, HAWAII,
COVERED BY TAX MAP KEY 7-5-09:57.

This Bill proposes to amend the North Kona Zone Map by changing the district classification from an Agricultural (A-1a) zone to a Multiple Family Residential (RM-2) in Puaa 1st, North Kona, Hawaii, containing an area of 6.858 acre parcel of land fronting Kuakini Highway on the mauka side and adjacent to the Pacific Empress Hotel.

Date Introduced: March 1, 1972

Copies of the foregoing Bill, in full, are on file in the Office of the County Clerk for use and examination by the public.

I hereby certify that the foregoing Bill passed first reading at the meeting of the County Council on March 1, 1972, by the following aye and no vote.

AYES: Councilmen Carpenter De Luz, Edwards, Greenwell, Hisaoka, Souza, Yadao Yamada and Chairman Matayoshi - 9.

NOES: None.

Tadashi Suzuki
COUNTY CLERK
COUNTY OF HAWAII

Tadashi Suzuki
COUNTY CLERK
COUNTY OF HAWAII

ORDINANCE NO. 1451
(Bill No. 214-1972)

AN ORDINANCE AMENDING SECTION 17-20, THE NINTH HONA FORD LAW, ORDINANCE NO. 107 (ZONING ORDINANCE), REVISED ORDINANCES OF THE COUNTY OF HAWAII 1967, AS AMENDED, BY CHANGING THE DISTRICT CLASSIFICATION FROM AGRICULTURAL (A-1a) TO MULTIPLE FAMILY RESIDENTIAL (RM-2) IN PUA A 1st, NORTH KONA, HAWAII, COVERED BY TAX MAP KEY 7-5-09:57.

Date Approved: March 13, 1972
Date Effective: March 23, 1972

Copies of the foregoing Ordinance, in full, are on file in the Office of the County Clerk for use and examination by the public.

I hereby certify that the foregoing Ordinance passed second and final reading at the meeting of the County Council on March 13, 1972, by the following aye and no vote:

AYES: Councilmen Carpenter, De Luz, Edwards, Greenwell, Hisaoka, Souza, Yadao Yamada and Chairman Matayoshi - 9.

NOES: None.

Tadashi Suzuki

COUNTY CLERK
COUNTY OF HAWAII

1451
ORDINANCE NO. 1451
(Bill No. 214-1972)
AN ORDINANCE AMENDING SECTION 17-20, THE NINTH HONA FORD LAW, ORDINANCE NO. 107 (ZONING ORDINANCE), REVISED ORDINANCES OF THE COUNTY OF HAWAII 1967, AS AMENDED, BY CHANGING THE DISTRICT CLASSIFICATION FROM AGRICULTURAL (A-1a) TO MULTIPLE FAMILY RESIDENTIAL (RM-2) IN PUA A 1st, NORTH KONA, HAWAII, COVERED BY TAX MAP KEY 7-5-09:57.

Date Approved: March 13, 1972
Date Effective: March 23, 1972
Copies of the foregoing Ordinance, in full, are on file in the Office of the County Clerk for use and examination by the public.
I hereby certify that the foregoing Ordinance passed second and final reading at the meeting of the County Council on March 13, 1972, by the following aye and no vote:
AYES: Councilmen Carpenter, De Luz, Edwards, Greenwell, Hisaoka, Souza, Yadao, Yamada and Chairman Matayoshi - 9.

NOES: None.
TADASHI SUZUKI
COUNTY CLERK
COUNTY OF HAWAII

Tadashi Suzuki
COUNTY CLERK



Robert Shioji
DEPUTY COUNTY CLERK

OFFICE OF THE COUNTY CLERK

COUNTY OF HAWAII
HILO, HAWAII 96720

Mayor Shunichi Kimura
County of Hawaii
Hilo, Hawaii

I hereby transmit Ordinance Bill No. 374 passed by
the County Council on second and final reading.

Tadashi Suzuki
COUNTY CLERK

Encl.

Dated: March 14, 1972