

COUNTY OF HAWAII - STATE OF HAWAII

ORDINANCE NO. 456

AN ORDINANCE AMENDING SECTION 7.31, THE PEPEEKEO ZONE MAP, ORDINANCE NO. 63 (ZONING ORDINANCE), REVISED ORDINANCES OF THE COUNTY OF HAWAII 1967, AS AMENDED, BY CHANGING THE DISTRICT CLASSIFICATION FROM SINGLE-FAMILY RESIDENTIAL (RS-7.5) TO GENERAL INDUSTRIAL (MG-5a) IN PEPEEKEO AND MAKAHANALOA, SOUTH HILO, HAWAII, COVERED BY TAX MAP KEY 2-8-07: PORTION 1 AND PORTION 53.

BE IT ORDAINED BY THE COUNCIL OF THE COUNTY OF HAWAII:

SECTION 1. Section 7.31 of Ordinance No. 63 (Zoning Ordinance), Revised Ordinances of the County of Hawaii 1967, as amended, is hereby further amended by adding thereto the following subsection:

"7.31(a). The district classification of the following area situated at Pepeekeo and Makahanaloa, South Hilo, Hawaii, shall be General Industrial (MG-5a):

Beginning at a point at the southwest corner of this parcel of land, the coordinates of said point of beginning referred to Government Survey Triangulation Station "Alala" being 2672.00 feet north and 7738.00 feet east, and running by azimuths measured clockwise from true south:

1. 188° 24' 50" 328.00 feet along the remainder of R. P. 7192, L. C. Aw. 8559-B, Apanas 17 and 18 to Wm. C. Lunalilo; thence along the remainder of R. P. 7192, L. C. Aw. 8559-B, Apanas 17 and 18 to Wm. C. Lunalilo for the next five (5) courses:
2. 240° 04' 40" 424.00 feet;
3. 45° 24' 120.40 feet;
4. 317° 51' 10" 146.40 feet;
5. 38° 35' 50" 427.85 feet;
6. 86° 58' 40" 161.30 feet to the point of beginning and containing an area of 2.640 acres.

All as outlined in red on the map attached hereto, marked Exhibit "A" and by reference made a part hereof."

SECTION 2. This ordinance shall take effect upon its approval.

INTRODUCED BY:

Robert M. Yamada
 Councilman, County of Hawaii

Hilo, Hawaii

Date of Introduction: March 1, 1972
 Date of Adoption: March 12, 1972



AMENDMENT TO THE COUNTY ZONING ORDINANCE

AMENDMENT NO. 1 OF SECTION 7.31, PEPEEKEO ZONE MAP, PORTION OF ORDINANCE NO. 190, CHANGING THE DISTRICT CLASSIFICATION FROM SINGLE FAMILY RESIDENTIAL (RS-7.5) TO GENERAL INDUSTRIAL (MG-5a) IN PEPEEKEO & MAKAHANALOA, SOUTH HILO, HAWAII.

DATE OF PUBLIC HEARING : FEB. 25, 1972

DATE OF APPROVAL :

ORDINANCE NO.

PREPARED BY: PLANNING DEPARTMENT
COUNTY OF HAWAII

TMK 2-8-071POR 1

EXHIBIT "A"

28 FEB. 1972

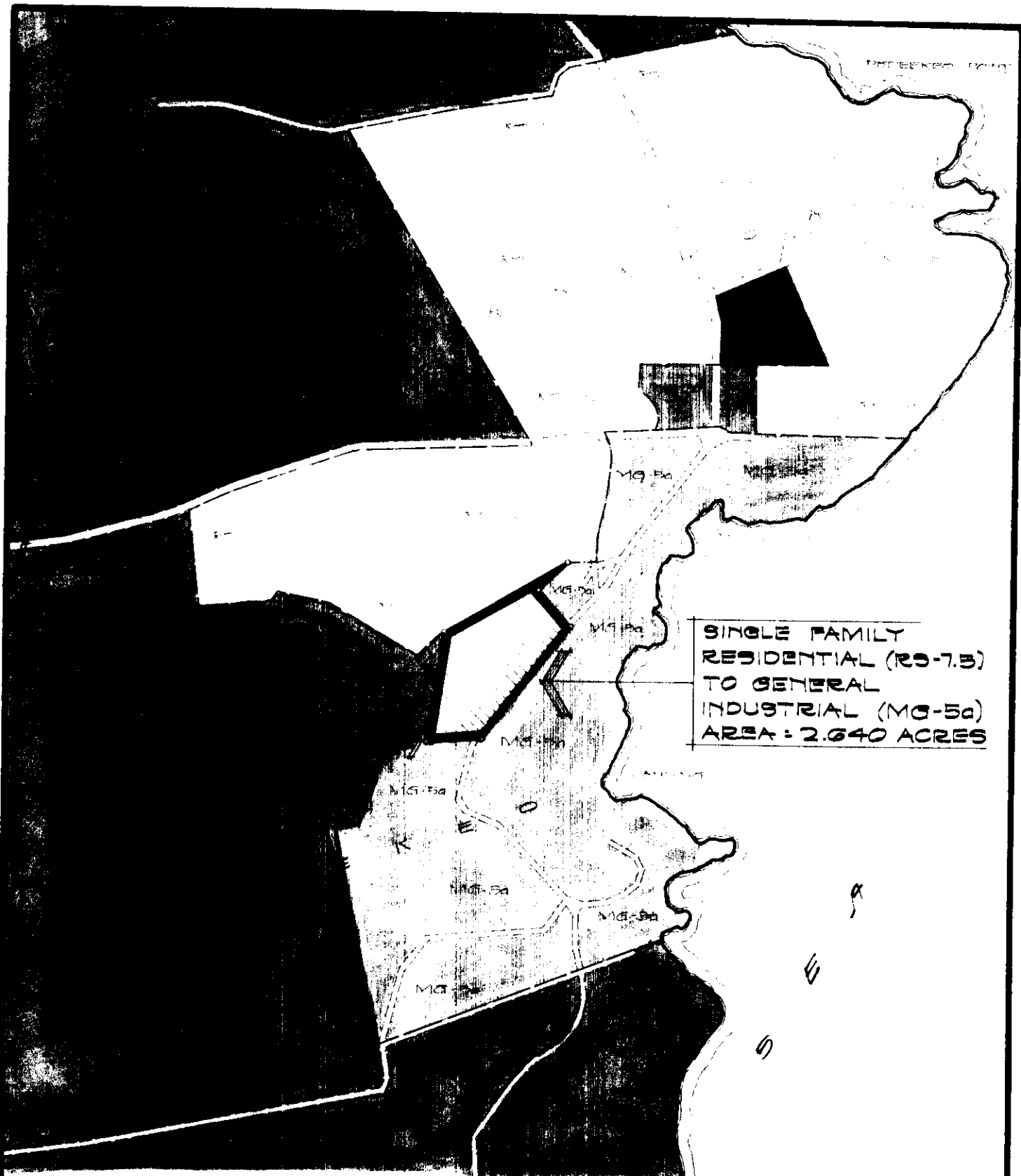

AMENDMENT TO THE COUNTY ZONING ORDINANCE

AMENDMENT NO. 1 OF SECTION 7.31, PEPEEKEO ZONE MAP, PORTION OF ORDINANCE NO. 190, CHANGING THE DISTRICT CLASSIFICATION FROM SINGLE FAMILY RESIDENTIAL (RS-7.5) TO GENERAL INDUSTRIAL (MG-5a) IN PEPEEKEO & MAKAHANALOA, SOUTH HILO, HAWAII.

DATE OF PUBLIC HEARING : FEB. 25, 1972

DATE OF APPROVAL :

ORDINANCE NO.

PREPARED BY: PLANNING DEPARTMENT
COUNTY OF HAWAII

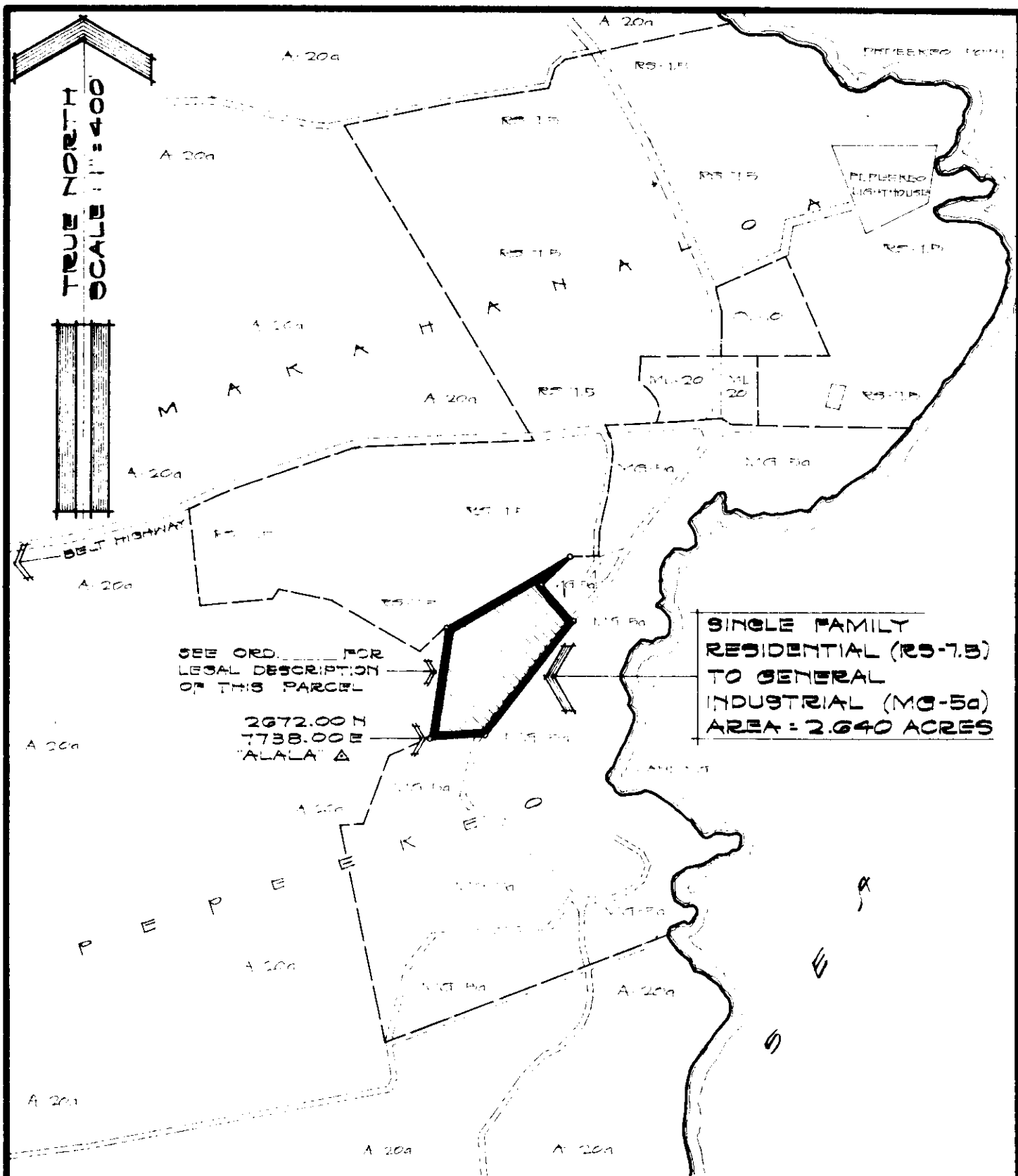

AMENDMENT TO THE COUNTY ZONING ORDINANCE

AMENDMENT NO. 1 OF SECTION 7.31, PEPEEKEO ZONE MAP, PORTION OF ORDINANCE NO. 190, CHANGING THE DISTRICT CLASSIFICATION FROM SINGLE FAMILY RESIDENTIAL (RS-7.5) TO GENERAL INDUSTRIAL (MG-5a) IN PEPEEKEO & MAKAHANALOA, SOUTH HILO, HAWAII.

DATE OF PUBLIC HEARING : FEB. 25, 1972
 DATE OF APPROVAL :
 ORDINANCE NO.

PREPARED BY: PLANNING DEPARTMENT
 COUNTY OF HAWAII

Hilo, Hawaii
 Date: March 1, 1972

FIRST READING			
	AYES	NOES	A/E
Carpenter			EX
De Luz	X		
Edwards	X		
Greenwell	X		
Hisaoka			EX
Souza	X		
Yadao	X		
Yamada	X		
Chr Matayoshi	X		
	7	0	2

Publication Date: MAR 9 1972

Hilo, Hawaii
 Date: March 13, 1972

SECOND & FINAL READING			
	AYES	NOES	A/E
Carpenter			EX
De Luz	X		
Edwards	X		
Greenwell	X		
Hisaoka	X		
Souza	X		
Yadao	X		
Yamada	X		
Chr Matayoshi	X		
	8	0	2

Publication Date: MAR 30 1972

We do hereby certify that the foregoing BILL was adopted by the County Council and published as indicated above.

 Council Chairman

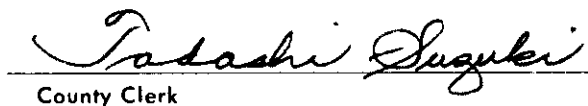
 County Clerk

Approved/Disapproved this 23rd day of
March, 1972

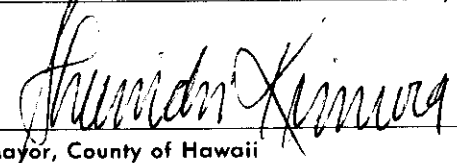
 Mayor, County of Hawaii

Bill No. 855
 Reference: _____
 M. B. No. 1635-10
 Ord. No. 456

Bill 855 - 1972

AN ORDINANCE AMENDING SECTION 7.31, THE PEPEEKEO ZONE MAP, ORDINANCE NO. 63 (ZONING ORDINANCE), REVISED ORDINANCES OF THE COUNTY OF HAWAII 1967, AS AMENDED, BY CHANGING THE DISTRICT CLASSIFICATION FROM SINGLE FAMILY RESIDENTIAL (RS-7.5) TO GENERAL INDUSTRIAL (MG-5a) IN PEPEEKEO AND MAKAHANALOA, SOUTH HILO, HAWAII, COVERED BY TAX MAP KEY 2-8-07: PORTION 1 AND PORTION 53.

This Bill proposes to amend the Pepeekeo Zone Map by changing the district classification from a Single-family Residential - 7,500 square foot (RS-7.5) zoned district to a General Industrial - 5 acre (MG-5a) zoned district in Pepeekeo and Makahanaloa, South Hilo, Hawaii, containing an area of 2.6 acres of land.

Date Introduced: March 1, 1972

Copies of the foregoing Bill, in full, are on file in the Office of the County Clerk for use and examination by the public.

I hereby certify that the foregoing Bill passes first reading at the meeting of the County Council on March 1, 1972, by the following aye and no vote.

AYES: Councilmen De Luz, Edwards, Greenwell, Souza, Yadao, Yamada and Chairman Matayoshi - 7.

NOES: None.

EXCUSED FROM VOTING: Councilmen Carpenter and Hisaoka - 2.

BILL 855 - 1972

AN ORDINANCE AMENDING SECTION 7.31, THE PEPEEKEO ZONE MAP, ORDINANCE NO. 63, REVISED ORDINANCES OF THE COUNTY OF HAWAII 1967, AS AMENDED, BY CHANGING THE DISTRICT CLASSIFICATION FROM SINGLE FAMILY RESIDENTIAL (RS-7.5) TO GENERAL INDUSTRIAL (MG-5a) IN PEPEEKEO AND MAKAHANALOA, SOUTH HILO, HAWAII, COVERED BY TAX MAP KEY 2 8 07:

This Bill proposes to amend the Pepeekeo Zone Map by changing the district classification from a Single-family Residential 7,500 square foot (RS-7.5) zoned district to a General Industrial-5 acre (MG-5a) zoned district in Pepeekeo and Makahanaloa, South Hilo, Hawaii, containing an area of 2.6 acres of land.

Date Introduced: March 1, 1972

Copies of the foregoing Bill, in full, are on file in the Office of the County Clerk for use and examination by the public.

I hereby certify that the foregoing Bill passes first reading at the meeting of the County Council on March 1, 1972, by the following aye and no vote.

AYES: Councilmen De Luz, Edwards, Greenwell, Souza, Yadao, Yamada and Chairman Matayoshi - 7.

NOES: None

EXCUSED FROM VOTING: Councilmen Carpenter and Hisaoka - 2.

Tadashi Suzuki
COUNTY CLERK
COUNTY OF HAWAII

Tadashi Suzuki
COUNTY CLERK
COUNTY OF HAWAII

ORDINANCE NO. 456
(BILL NO. 815-1972)

AN ORDINANCE AMENDING SECTION 7.31, THE PEPEEKEO ZONE MAP, ORDINANCE NO. 63 (ZONING ORDINANCE), REVISED ORDINANCES OF THE COUNTY OF HAWAII 1967, AS AMENDED, BY CHANGING THE DISTRICT CLASSIFICATION FROM SINGLE-FAMILY RESIDENTIAL (RS-7.5) TO GENERAL INDUSTRIAL (MG-5a) IN PEPEEKEO AND MAKAHANALOA, SOUTH HILO, HAWAII, COVERED BY TAX MAP KEY 2-8-07: PORTION 1 AND PORTION 53.

Date Approved: March 13, 1972
Date Effective: March 23, 1972

Copies of the foregoing Ordinance, in full, are on file in the Office of the County Clerk for use and examination by the public.

I hereby certify that the foregoing Ordinance passed second and file reading at the meeting of the County Council on March 13, 1972, by the following yeas and nays:

AYES: Councilmen Carpenter, De Luz, Edwards, Greenwell, Hisaoka, Souza, Yadao and Chairman Matayoshi - 9.
NOES: None.

WITNESSED:

Tadashi Suzuki

COUNTY CLERK

ORDINANCE NO. 456
AN ORDINANCE AMENDING SECTION 7.31, THE PEPEEKEO ZONE MAP, ORDINANCE NO. 63 (ZONING ORDINANCE), REVISED ORDINANCES OF THE COUNTY OF HAWAII 1967, AS AMENDED, BY CHANGING THE DISTRICT CLASSIFICATION FROM SINGLE-FAMILY RESIDENTIAL (RS-7.5) TO GENERAL INDUSTRIAL (MG-5a) IN PEPEEKEO AND MAKAHANALOA, SOUTH HILO, HAWAII, COVERED BY TAX MAP KEY 2-8-07: PORTION 1 AND PORTION 53.

Date Approved: March 13, 1972
Date Effective: March 23, 1972
Copies of the foregoing Ordinance, in full, are on file in the Office of the County Clerk for use and examination by the public.
I hereby certify that the foregoing Ordinance passed second and file reading at the meeting of the County Council on March 13, 1972, by the following yeas and no vote:
AYES: Councilmen Carpenter, De Luz, Edwards, Greenwell, Hisaoka, Souza, Yadao and Chairman Matayoshi - 9.
NOES: None.

TADASHI SUZUKI
COUNTY CLERK
COUNTY OF HAWAII



PLANNING COMMISSION
Planning Department

25 AUPUNI STREET • HILO, HAWAII 96720

SHUNICHI KIMURA
Mayor

COUNTY OF
HAWAII

Chairman

February 29, 1972

The Honorable Herbert Matayoshi
Chairman, County Council
and Members of the Council
County of Hawaii
Hilo, Hawaii

Re: Rezoning Request - Hilo Coast Processing Company
Pepeekeo, South Hilo, Hawaii
TMK: 2-8-07:por. 1 and por. 53

The Planning Commission after a duly held public hearing on February 25, 1972 voted to recommend for your approval the proposed bill to change the district classification from a Single-family Residential - 7,500 square foot (RS-7.5) zoned district to a General Industrial - 5 acre (MG-5a) zoned district for approximately 2.6 acres of land situated in Pepeekeo, South Hilo, Hawaii.

For your favorable consideration, an amendment to Section 7.31 of Ordinance No. 63 is being transmitted.

Mauricio Valera, Jr.
Mauricio Valera, Jr.
Vice Chairman
For
O. W. Efurud, Jr.
Chairman

GM:mh

Attachments 2 - 1/2

cc Hilo Coast Processing Co.
Chief Engineer
Manager-DWS
Dept. of Health

APPROVED:

for Stanley A. Robinson
MAYOR

Tadashi Suzuki
COUNTY CLERK

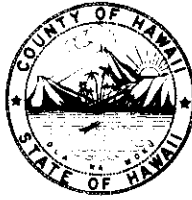

Robert Shioji
DEPUTY COUNTY CLERK

OFFICE OF THE COUNTY CLERK
COUNTY OF HAWAII
HILO, HAWAII 96720

Mayor Shunichi Kimura
County of Hawaii
Hilo, Hawaii

I hereby transmit Ordinance Bill No. 855 passed by
the County Council on second and final reading.

A handwritten signature in cursive script that reads "Tadashi Suzuki".

COUNTY CLERK

Encl.

Dated: March 14, 1972