

COUNTY OF HAWAII - STATE OF HAWAII

ORDINANCE NO. 479

AN ORDINANCE AMENDING SECTION 7.02, THE NORTH KONA ZONE MAP, ORDINANCE NO. 63 (ZONING ORDINANCE), REVISED ORDINANCES OF THE COUNTY OF HAWAII 1967, AS AMENDED, BY CHANGING THE DISTRICT CLASSIFICATION FROM AGRICULTURAL (A-5a) TO AGRICULTURAL (A-3a) AND FROM UNPLANNED (U) TO AGRICULTURAL (A-1a) IN KEOPU 3RD, NORTH KONA, HAWAII, COVERED BY TAX MAP KEY 7-5-24:10-21 and 28-42.

BE IT ORDAINED BY THE COUNCIL OF THE COUNTY OF HAWAII:

SECTION 1. Section 7.02 of Ordinance No. 63 (Zoning Ordinance), Revised Ordinances of the County of Hawaii 1967, as amended, is hereby further amended by adding thereto the following subsections:

"7.02 (r-1). The district classification of the following area situated at Keopu 3rd, North Kona, Hawaii, shall be Agricultural (A-3a):

Beginning at a "4" on rock at the northeast corner of this parcel of land, and on the westerly side of Mamalahoa Highway, the coordinates of which referred to Government Survey Triangulation Station "KAHELO" being 13,058.35 feet North and 9,837.01 feet East, and thence running by azimuths measured clockwise from True South:

Along the westerly side of Mamalahoa Highway for the following eight (8) courses:

1. 334° 31' 155.93 feet;
2. 340° 38' 30" 209.61 feet to a pipe in concrete;
3. 338° 18' 30" 98.26 feet to a pipe in concrete;
4. 357° 20' 30" 84.58 feet to a pipe in concrete;
5. 9° 12' 30" 41.75 feet to a pipe in concrete;
6. 4° 07' 30" 170.23 feet to a pipe in concrete;
7. 358° 57' 31.51 feet to a pipe in concrete;
8. 353° 06' 30" 101.71 feet to a pipe in concrete; thence
9. 61° 34' 90.03 feet along stonewall along L. C. Aw. 7346 to Kaina, to a pipe in concrete;
10. 77° 48' 189.50 feet along stonewall to a pipe in concrete;
11. 167° 32' 139.66 feet along stonewall to a pipe in concrete;
12. 76° 38' 48.31 feet along stonewall to a pipe in concrete;

- |     |      |     |     |  |
|-----|------|-----|-----|--|
| 13. | 66°  | 08' | 30" | 35.45 feet along stonewall to a pipe in concrete;  |
| 14. | 58°  | 56' | 30" | 117.80 feet along stonewall to a pipe in concrete; |
| 15. | 70°  | 33' | 30" | 113.49 feet along stonewall to a pipe in concrete; |
| 16. | 61°  | 43' | 30" | 55.88 feet along stonewall to a pipe in concrete;  |
| 17. | 64°  | 17' |     | 459.35 feet along stonewall to a pipe in concrete; |
| 18. | 72°  | 29' |     | 471.75 feet along stonewall to a pipe in concrete; |
| 19. | 340° | 56' |     | 57.45 feet along stonewall to a pipe in concrete;  |
| 20. | 349° | 16' |     | 79.90 feet along stonewall to a pipe in concrete;  |
| 21. | 342° | 38' |     | 80.45 feet along stonewall to a pipe in concrete;  |

Thence along stonewall along Grant 3100 to J. W. Kuakamaunu for the following nineteen (19) courses:

- |     |     |     |     |                                    |
|-----|-----|-----|-----|------------------------------------|
| 22. | 68° | 28' |     | 108.51 feet to a pipe in concrete; |
| 23. | 63° | 32' | 30" | 26.71 feet to a pipe in concrete;  |
| 24. | 71° | 54' |     | 52.57 feet to a pipe in concrete;  |
| 25. | 65° | 42' |     | 32.85 feet to a pipe in concrete;  |
| 26. | 67° | 49' | 30" | 111.65 feet to a pipe in concrete; |
| 27. | 78° | 57' |     | 57.68 feet to a pipe in concrete;  |
| 28. | 72° | 21' | 30" | 111.25 feet to a pipe in concrete; |
| 29. | 75° | 10' | 30" | 60.38 feet to a pipe in concrete;  |
| 30. | 69° | 41' |     | 94.29 feet to a pipe in concrete;  |
| 31. | 75° | 16' |     | 77.53 feet to a pipe in concrete;  |
| 32. | 70° | 24' |     | 64.84 feet to a pipe in concrete;  |
| 33. | 56° | 36' |     | 91.19 feet to a pipe in concrete;  |
| 34. | 59° | 18' |     | 52.71 feet to a pipe in concrete;  |
| 35. | 60° | 46' |     | 62.04 feet to a pipe in concrete;  |
| 36. | 62° | 59' | 30" | 63.19 feet to a pipe in concrete;  |
| 37. | 60° | 57' | 30" | 73.60 feet to a pipe in concrete;  |
| 38. | 54° | 26' |     | 199.11 feet to a pipe in concrete; |
| 39. | 54° | 41' |     | 155.89 feet to a pipe in concrete; |

- |     |      |     |  |
|-----|------|-----|--|
| 40. | 64°  | 10' | 80.00 feet to a point; thence  |
| 41. | 159° | 03' | 872.79 feet along the remainder of R. P. 4475,<br>L. C. Aw. 7713:5 to V. Kamamalu to a<br>point; |

Thence, along stonewall, along Grant 978 to Kialoa for the following thirty-nine (39) courses:

- |     |      |     |     |                                    |
|-----|------|-----|-----|------------------------------------|
| 42. | 239° | 25' | 30" | 16.35 feet to a pipe in concrete;  |
| 43. | 246° | 46' | 30" | 112.54 feet to a pipe in concrete; |
| 44. | 245° | 42' |     | 57.99 feet to a pipe in concrete;  |
| 45. | 245° | 04' | 30" | 44.92 feet to a pipe in concrete;  |
| 46. | 242° | 19' |     | 88.74 feet to a pipe in concrete;  |
| 47. | 246° | 05' | 30" | 74.66 feet to a pipe in concrete;  |
| 48. | 233° | 59' |     | 234.49 feet to a pipe in concrete; |
| 49. | 237° | 45' |     | 35.51 feet to a pipe in concrete;  |
| 50. | 238° | 09' |     | 85.27 feet to a pipe in concrete;  |
| 51. | 245° | 04' |     | 166.59 feet to a pipe in concrete; |
| 52. | 252° | 43' | 30" | 91.28 feet to a pipe in concrete;  |
| 53. | 252° | 54' |     | 138.25 feet to a pipe in concrete; |
| 54. | 248° | 46' |     | 82.19 feet to a pipe in concrete;  |
| 55. | 248° | 12' | 30" | 153.01 feet to a pipe in concrete; |
| 56. | 251° | 51' |     | 99.62 feet to a pipe in concrete;  |
| 57. | 257° | 05' |     | 47.72 feet to a pipe in concrete;  |
| 58. | 254° | 03' | 30" | 37.79 feet to a pipe in concrete;  |
| 59. | 249° | 59' |     | 97.82 feet to a pipe in concrete;  |
| 60. | 252° | 00' |     | 56.73 feet to a pipe in concrete;  |
| 61. | 251° | 41' |     | 74.19 feet to a pipe in concrete;  |
| 62. | 248° | 13' |     | 164.58 feet to a pipe in concrete; |
| 63. | 242° | 09' |     | 120.54 feet to a pipe in concrete; |
| 64. | 239° | 18' |     | 76.14 feet to a pipe in concrete;  |

65.	233°	32'		70.17 feet to a pipe in concrete;
66.	249°	47'	30"	157.47 feet to a pipe in concrete;
67.	251°	49'	30"	93.83 feet to a pipe in concrete;
68.	235°	51'		53.11 feet to a pipe in concrete;
69.	254°	36'		67.20 feet to a pipe in concrete;
70.	240°	28'	30"	93.79 feet to a pipe in concrete;
71.	242°	39'		89.88 feet to a pipe in concrete;
72.	250°	44'		28.82 feet to a pipe in concrete;
73.	243°	18'		86.59 feet to a pipe in concrete;
74.	247°	11'		33.75 feet to a pipe in concrete;
75.	244°	50'		82.56 feet to a pipe in concrete;
76.	243°	21'	30"	113.77 feet to a pipe in concrete;
77.	236°	35'		29.54 feet to a pipe in concrete;
78.	245°	55'	30"	53.79 feet to a pipe in concrete;
79.	242°	24'	30"	31.18 feet to a pipe in concrete;
80.	245°	52'		60.05 feet to the point of beginning and containing an area of 57.518 Acres.

"7.02 (r-2). The district classification of the following area situated at Keopu 3rd, North Kona, Hawaii, shall be Agricultural (A-1a):

Beginning at a point at the southeast corner of this parcel of land, and on the northwest side of Grant 3100 to J. W. Kuakamaunu, the coordinates of which referred to Government Survey Triangulation Station "KAHELO" being 11,280.94 feet North and 5,871.79 feet East and thence running by azimuths measured clockwise from True South:

Along the stonewall, along Grant 3100 to J. W. Kuakamaunu for the following thirteen (13) courses:

1.	64°	10'		75.13 feet to a pipe in concrete;
2.	58°	15'	30"	99.84 feet to a pipe in concrete;
3.	53°	22'		21.78 feet to a pipe in concrete;
4.	51°	38'		33.48 feet to a pipe in concrete;
5.	46°	47'		31.78 feet to a pipe in concrete;
6.	56°	08'	30"	198.17 feet to a pipe in concrete;

7.	47°	59'		145.85 feet to a pipe in concrete;
8.	50°	51'	30"	73.18 feet to a pipe in concrete;
9.	44°	58'	30"	97.37 feet to a pipe in concrete;
10.	59°	23'		57.03 feet to a pipe in concrete;
11.	35°	28'	30"	60.22 feet to a pipe in concrete;
12.	50°	25'		135.33 feet to a pipe in concrete;
13.	52°	57'		51.77 feet to a "4" on rock; thence
14.	60°	28'	10"	16.35 feet across the existing roadway to a pipe in concrete; thence

Continuing along stonewall, along Grant 3100 to J. W. Kuakamaunu for the following six (6) courses:

15.	59°	25'	30"	25.44 feet to a pipe in concrete;
16.	44°	46'		54.58 feet to a pipe in concrete;
17.	56°	37'		203.25 feet to a pipe in concrete;
18.	55°	35'	30"	77.97 feet to a pipe in concrete;
19.	59°	13'		91.48 feet to a pipe in concrete;
20.	67°	14'	30"	203.02 feet to a pipe in concrete; thence
21.	159°	06'		221.33 feet along stonewall, along remainder of R. P. 4475, L. C. Aw. 7713, Apana 5 to V. Kamamalu, to a pipe in concrete;
22.	163°	09'	30"	324.68 feet along remainder of R. P. 4475, L. C. Aw. 7713, Apana 5 to V. Kamamalu, to a pipe in concrete;
23.	131°	57'		14.74 feet along remainder of R. P. 4475, L. C. Aw. 7713, Apana 5 to V. Kamamalu, to a pipe in concrete; thence

Along stonewall, along the remainder of R. P. 4475, L. C. Aw. 7713, Apana 5 to V. Kamamalu for the following six (6) courses:

24.	166°	40'		195.50 feet to a pipe in concrete;
25.	162°	08'		95.96 feet to a pipe in concrete;
26.	153°	04'	30"	59.56 feet to a pipe in concrete;
27.	148°	33'	30"	60.33 feet to a pipe in concrete;

28. 152° 13' 61.49 feet to a pipe in concrete;
29. 156° 30' 119.02 feet to a pipe in concrete; thence
- Along stonewall, along Grant 1589 to Laenui for the following seven (7) courses:
30. 228° 33' 35.41 feet to a pipe in concrete;
31. 238° 48' 15.56 feet to a pipe in concrete;
32. 225° 42' 53.72 feet to a pipe in concrete;
33. 232° 18' 30" 198.91 feet to a pipe in concrete;
34. 236° 43' 64.98 feet to a pipe in concrete;
35. 249° 38' 195.20 feet to a pipe in concrete;
36. 242° 33' 30" 61.27 feet to a pipe in concrete; thence
37. 239° 52' 50" 26.39 feet across the existing roadway to a pipe in concrete; thence

Continuing along stonewall, along Grant 1589 to Laenui for the following nine (9) courses:

38. 247° 09' 30" 120.16 feet to a pipe in concrete;
39. 250° 07' 98.53 feet to a pipe in concrete;
40. 255° 35' 129.53 feet to a pipe in concrete;
41. 244° 27' 30" 37.23 feet to a pipe in concrete;
42. 239° 40' 78.89 feet to a pipe in concrete;
43. 247° 13' 57.67 feet to a pipe in concrete;
44. 257° 05' 30" 132.93 feet to a pipe in concrete;
45. 248° 40' 43.95 feet to a pipe in concrete;
46. 244° 45' 92.44 feet to a pipe in concrete; thence
47. 239° 25' 30" 249.68 feet along Grant 978 to Kialoa to a point; thence
48. 339° 03' 872.79 feet along the remainder of R. P. 4475, L. C. Aw. 7713, Apana 5 to V. Kamamalu to the point of beginning and containing an area of 40.360 Acres.

"All as outlined in red on the map attached hereto, marked Exhibit "A" and by reference made a part hereof."

SECTION 2. Section 1 of this ordinance shall take effect forthwith upon the conditions that (A) the agriculture (A-3a) zoned section be incrementally zoned in two (2) increments. The first increment shall consist of ten (10) lots and the second increment the remaining lots. The effective date of zoning for the second increment shall be after development has occurred on the first zoning increment. Development is defined as building permits issued for residential dwelling units and construction partially completed--partially completed in the sense of having roofs on those units--on fifteen (15) percent of the permanent structures of the first increment; (B) the agriculture (A-1a) zoned section be incrementally zoned in two (2) increments. The first increment shall consist of twenty-four (24) lots and the second increment the remaining lots. The effective date of zoning for the second increment shall be after development has occurred on the first zoning increment. Development is defined as building permits issued for residential dwelling units and construction partially completed--partially completed in the sense of having roofs on those units--on twenty-five (25) percent of the permanent structures of the first increment; and (C) the owner or lessee of the subject properties submit a subdivision plan for preliminary approval within one (1) year from the date of approval of the change of zone. Should this condition not be met, the Planning Commission shall reserve the right to initiate action to rezone the subject property to its former zoning designation.

SECTION 3. In the event that any portion of this ordinance is declared invalid, such invalidity shall not affect the other parts of this ordinance.

SECTION 4. This ordinance shall take effect upon its approval.

INTRODUCED BY:

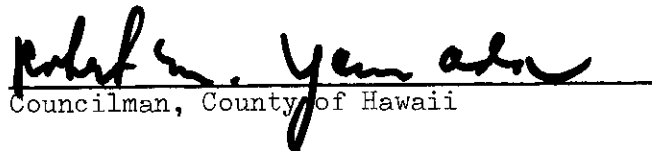
  
Councilman, County of Hawaii

Hilo, Hawaii

Date of Introduction: June 7, 1972

Date of Adoption: June 21, 1972

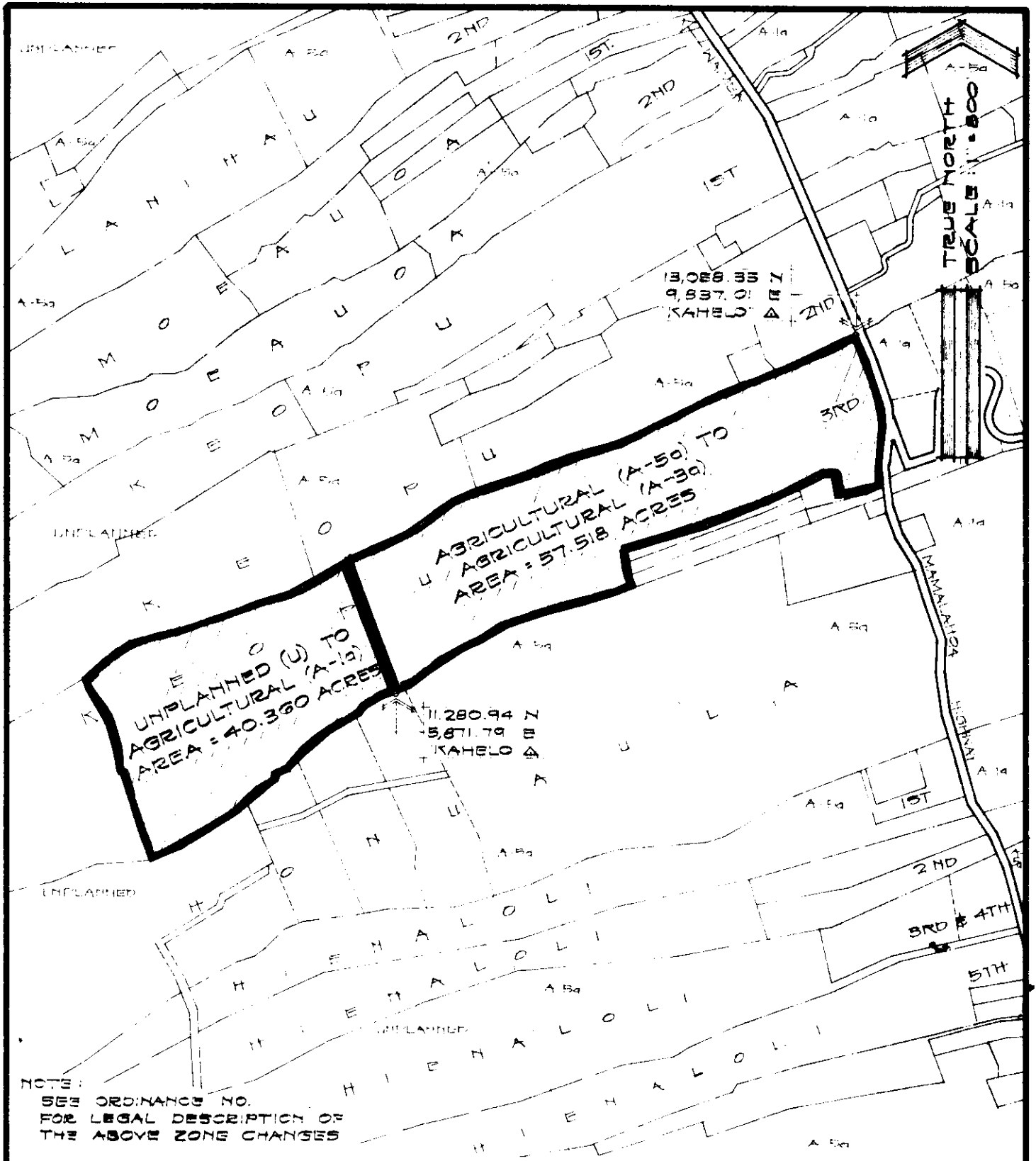

**AMENDMENT TO THE COUNTY ZONING ORDINANCE**  
 AMENDMENT NO. 18 OF SECTION 7.02, THE NORTH KONA  
 ZONE MAP, PORTION OF ORDINANCE NO. 74, CHANGING  
 THE DISTRICT CLASSIFICATION FROM AGRICULTURAL (A-5a)  
 TO AGRICULTURAL (A-3a) AND FROM UNPLANNED (U) TO  
 AGRICULTURAL (A-1a) IN KEOPU 3RD, NORTH KONA, HAWAII.

DATE OF PUBLIC HEARING : MARCH 24, 1972  
 DATE OF APPROVAL :  
 ORDINANCE NO.  
 PREPARED BY : PLANNING DEPARTMENT  
 COUNTY OF HAWAII

TMK : 7-5-24

11 MAY 1972

EXHIBIT 'A'



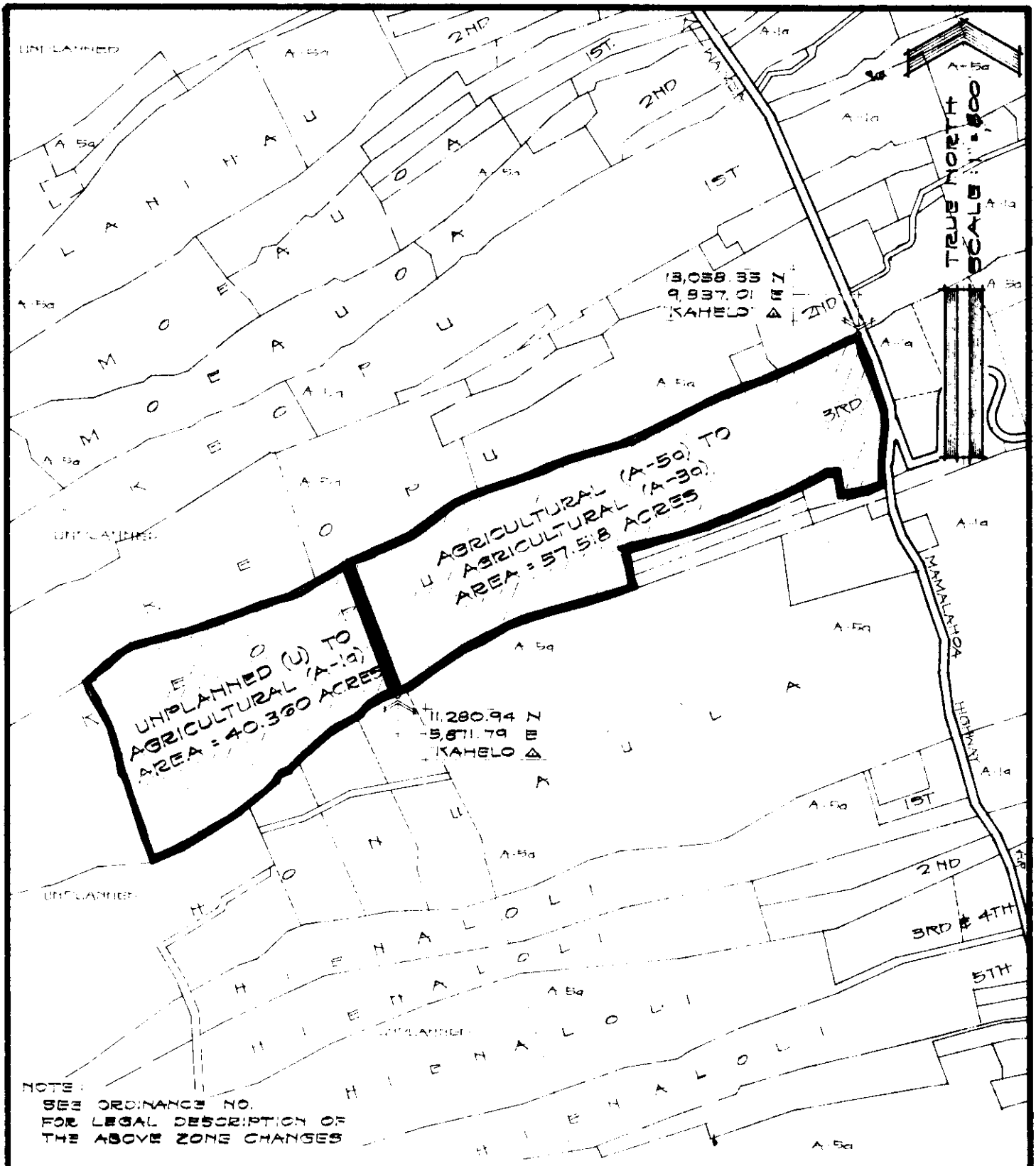

NOTE:  
 SEE ORDINANCE NO.  
 FOR LEGAL DESCRIPTION OF  
 THE ABOVE ZONE CHANGES

**AMENDMENT TO THE COUNTY ZONING ORDINANCE**

AMENDMENT NO. 18 OF SECTION 7.02, THE NORTH KONA ZONE MAP, PORTION OF ORDINANCE NO. 74, CHANGING THE DISTRICT CLASSIFICATION FROM AGRICULTURAL (A-5a) TO AGRICULTURAL (A-3a) AND FROM UNPLANNED (U) TO AGRICULTURAL (A-1a) IN KEOPU 3RD, NORTH KONA, HAWAII.

DATE OF PUBLIC HEARING : MARCH 24, 1972  
 DATE OF APPROVAL :  
 ORDINANCE NO.  
 PREPARED BY : PLANNING DEPARTMENT  
 COUNTY OF HAWAII

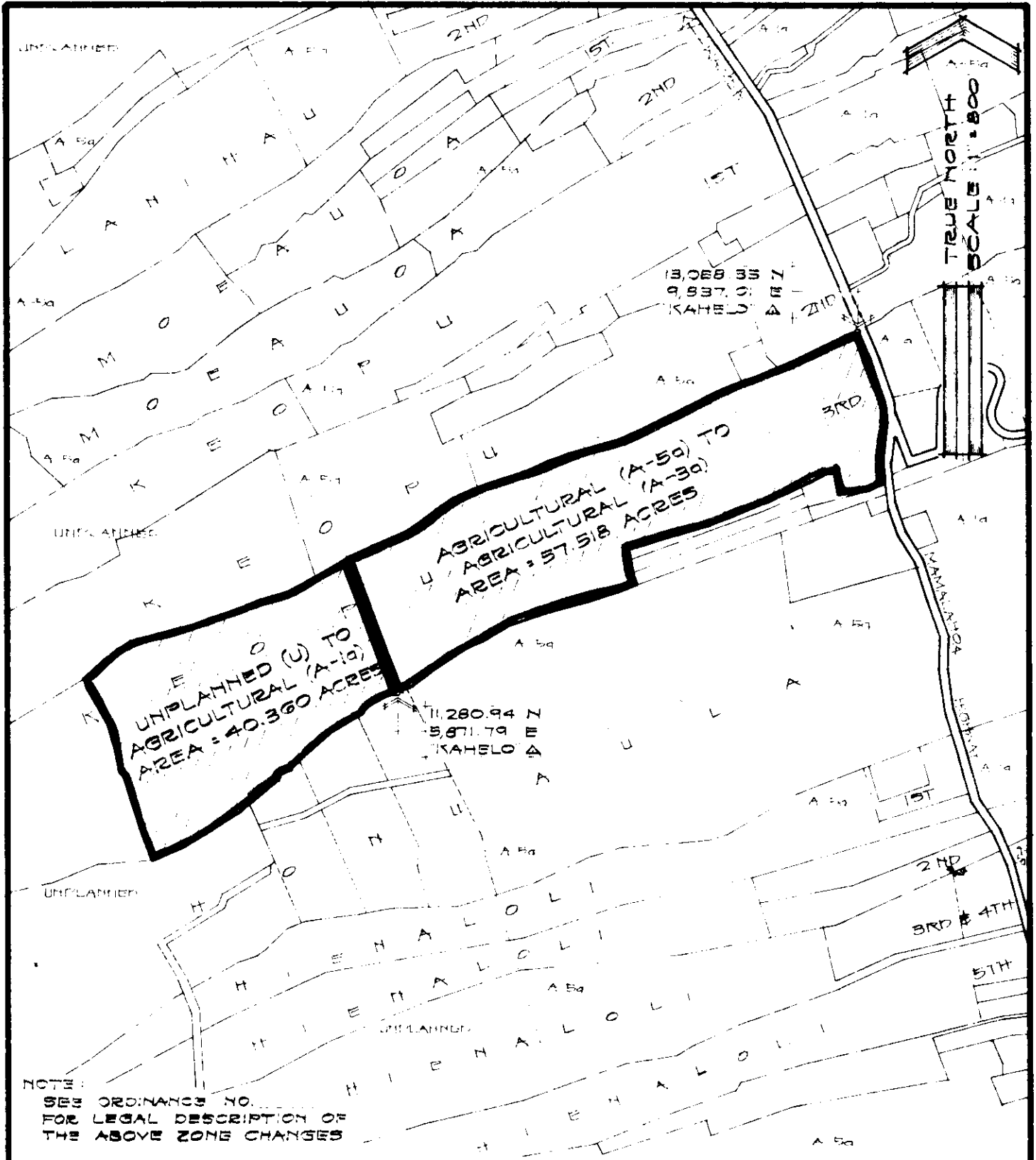

NOTE:  
 SEE ORDINANCE NO. \_\_\_\_\_  
 FOR LEGAL DESCRIPTION OF  
 THE ABOVE ZONE CHANGES

**AMENDMENT TO THE COUNTY ZONING ORDINANCE**

AMENDMENT NO. 18 OF SECTION 7.02, THE NORTH KONA ZONE MAP, PORTION OF ORDINANCE NO. 74, CHANGING THE DISTRICT CLASSIFICATION FROM AGRICULTURAL (A-5a) TO AGRICULTURAL (A-3a) AND FROM UNPLANNED (U) TO AGRICULTURAL (A-1a) IN KEOPU 3RD, NORTH KONA, HAWAII.

DATE OF PUBLIC HEARING : MARCH 24, 1972  
 DATE OF APPROVAL :  
 ORDINANCE NO.  
 PREPARED BY : PLANNING DEPARTMENT  
 COUNTY OF HAWAII

Hilo, Hawaii

Date: June 7, 1972

FIRST READING			
	AYES	NOES	A/E
Carpenter	X		
De Luz	X		
Edwards	X		
Greenwell	X		
Hisaoka	X		
Souza	X		
Yadao	X		
Yamada	X		
Chr Matayoshi	X		
	9	0	0

Publication Date: June 13, 1972

Hilo, Hawaii

Date: June 21, 1972

SECOND & FINAL READING			
	AYES	NOES	A/E
Carpenter	X		
De Luz			X
Edwards			X
Greenwell	X		
Hisaoka	X		
Souza	X		
Yadao	X		
Yamada	X		
Chr Matayoshi	X		
	7	0	2

Publication Date: July 3, 1972

We do hereby certify that the foregoing BILL was adopted by the County Council and published as indicated above.

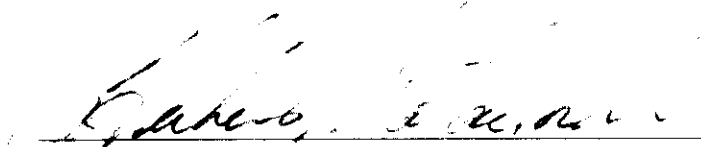
  
 Council Chairman

  
 County Clerk

Approved/Disapproved this 27<sup>th</sup> day of  
June, 1972

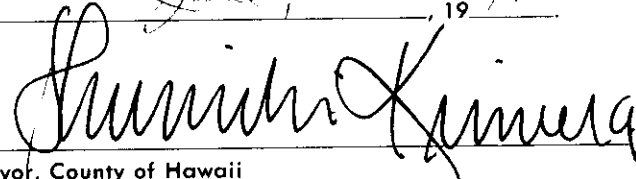
  
 Mayor, County of Hawaii

Bill No. 879  
 Reference: C-1971/PEDLC-79  
 M.B. No. 1197, 1821  
 ORD. No. 179

Bill No. 879 - 1972

AN ORDINANCE AMENDING SECTION 7.02, THE NORTH KONA ZONE MAP, ORDINANCE NO. 63 (ZONING ORDINANCE), REVISED ORDINANCES OF THE COUNTY OF HAWAII 1967, AS AMENDED, BY CHANGING THE DISTRICT CLASSIFICATION FROM AGRICULTURAL (A-5a) TO AGRICULTURAL (A-3a) AND FROM UNPLANNED (U) TO AGRICULTURAL (A-1a) IN KEOPU 3RD, NORTH KONA, HAWAII, COVERED BY TAX MAP KEY 7-5-24:10-21 and 2E-42.

This bill proposes to amend the North Kona Zone Map by changing the district classification for approximately 57.5 acres of land situated in Keopu 3rd, North Kona from an Agricultural (A-5a) to an Agricultural (A-3a) zoned district and of approximately 40.4 acres of land from an Unplanned (U) 5 acres to an Agricultural (A-1a) zoned district.

Date Introduced: June 7, 1972

Copies of the foregoing Bill, in full, are on file in the Office of the County Clerk for use and examination by the public.

---

I hereby certify that the foregoing Bill passed first reading at the meeting of the County Council on June 7, 1972, by the following aye and no vote:

AYES: Councilmen Carpenter, De Luz, Edwards, Greenwell, Hisaoka, Souza, Yadao, Yamada and Chairman Matayoshi - 9.

NOES: None.

7.02, THE NORTH KONA ZONE MAP, ORDINANCE NO. 63 (ZONING ORDINANCE), REVISED ORDINANCES OF THE COUNTY OF HAWAII 1967, AS AMENDED, BY CHANGING THE DISTRICT CLASSIFICATION FROM AGRICULTURAL (A-5a) TO AGRICULTURAL (A-3a) AND FROM UNPLANNED (U) TO AGRICULTURAL (A-1a) IN KEOPU 3RD, NORTH KONA, HAWAII, COVERED BY TAX MAP KEY 7-5-24:10-21 and 2E-42.

This bill proposes to amend the North Kona Zone Map by changing the district classification for approximately 57.5 acres of land situated in Keopu 3rd, North Kona from an Agricultural (A-5a) to an Agricultural (A-3a) zoned district and of approximately 40.4 acres of land from an Unplanned (U) 5 acres to an Agricultural (A-1a) zoned district.

Date Introduced: June 7, 1972

Copies of the foregoing Bill, in full, are on file in the Office of the County Clerk for use and examination by the public.

I hereby certify that the foregoing Bill passed first reading at the meeting of the County Council on June 7, 1972, by the following aye and no vote:

AYES: Councilmen Carpenter, De Luz, Edwards, Greenwell, Hisaoka, Souza, Yadao, Yamada and Chairman Matayoshi - 9.

NOES: None.

Tadashi Suzuki  
COUNTY CLERK  
COUNTY OF HAWAII  
(948 - Hawaii Tribune-Herald:  
June 13, 1972.)

*Tadashi Suzuki*

COUNTY CLERK  
COUNTY OF HAWAII

ORDINANCE NO. 479  
(Bill No. 879-1972)

AN ORDINANCE AMENDING SECTION 7.02, THE NORTH KONA ZONE MAP, ORDINANCE NO. 63 (ZONING ORDINANCE), REVISED ORDINANCES OF THE COUNTY OF HAWAII 1967, AS AMENDED, BY CHANGING THE DISTRICT CLASSIFICATION FROM AGRICULTURAL (A-5a) TO AGRICULTURAL (A-3a) AND FROM UNPLANNED (U) TO AGRICULTURAL (A-1a) IN KEOPU 3RD, NORTH KONA, HAWAII, COVERED BY TAX MAP KEY 7-5-24:10-21 and 28-42.

Date Approved: June 21, 1972  
Date Effective: June 27, 1972

Copies of the foregoing Ordinance, in full, are on file in the Office of the County Clerk for use and examination by the public.

---

I hereby certify that the foregoing Ordinance passed second and final reading at the meeting of the County Council on June 21, 1972, by the following aye and no vote:

AYES: Councilmen Carpenter, Greenwell, Hisaoka, Souza, Yadao, Yamada, and Chairman Matayoshi - 7.

NOES: None.

ABSENT AND EXCUSED: Councilmen De Luz and Edwards - 2.

AMENDING SECTION  
7.02, THE NORTH KONA ZONE MAP,  
ORDINANCE NO. 63 (ZONING OR  
DINANCE), REVISED ORDINANCES OF  
THE COUNTY OF HAWAII 1967, AS  
AMENDED, BY CHANGING THE  
DISTRICT CLASSIFICATION FROM  
AGRICULTURAL (A-5a) TO  
AGRICULTURAL (A-3a) AND FROM  
UNPLANNED (U) TO AGRICULTURAL  
(A-1a) IN KEOPU 3RD, NORTH KONA,  
HAWAII, COVERED BY TAX MAP KEY  
7-5-24:10-21 and 28-42.

Date Approved: June 21, 1972  
Date Effective: June 27, 1972

Copies of the foregoing Ordinance, in full, are on file in the Office of the County Clerk for use and examination by the public.

I hereby certify that the foregoing Ordinance passed second and final reading at the meeting of the County Council on June 21, 1972, by the following aye and no vote:

AYES: Councilmen Carpenter, Greenwell, Hisaoka, Souza, Yadao, Yamada, and Chairman Matayoshi 7.

NOES: None.

ABSENT AND EXCUSED: Councilmen De Luz and Edwards—2.

Robert S. Shioji  
DEPUTY COUNTY CLERK  
COUNTY OF HAWAII

*Robert S. Shioji*  
DEPUTY COUNTY CLERK  
COUNTY OF HAWAII

Tadashi Suzuki  
COUNTY CLERK

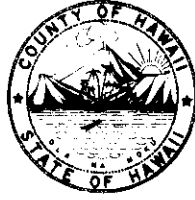

Robert Shioji  
DEPUTY COUNTY CLERK

**OFFICE OF THE COUNTY CLERK**  
COUNTY OF HAWAII  
HILO, HAWAII 96720

Mayor Shunichi Kimura  
County of Hawaii  
Hilo, Hawaii

I hereby transmit Ordinance Bill No. 879 passed by  
the County Council on second and final reading.

*Tadashi Suzuki*  
COUNTY CLERK

Encl.

Dated: June 21, 1972 CLERK