

COUNTY OF HAWAII - STATE OF HAWAII

ORDINANCE NO. 189

AN ORDINANCE AMENDING SECTION 7.09, THE KAMUELA ZONE MAP, ORDINANCE NO. 63 (ZONING ORDINANCE), REVISED ORDINANCES OF THE COUNTY OF HAWAII 1967, AS AMENDED, BY CHANGING THE DISTRICT CLASSIFICATION FROM AGRICULTURAL (A-1a) TO SINGLE-FAMILY RESIDENTIAL (RS-15) AT WAIMEA, SOUTH KOHALA, HAWAII, COVERED BY TAX MAP KEY 6-5-07:28.

BE IT ORDAINED BY THE COUNCIL OF THE COUNTY OF HAWAII:

SECTION 1. Section 7.09 of Ordinance No. 63 (Zoning Ordinance), Revised Ordinances of the County of Hawaii 1967, as amended, is hereby further amended by adding thereto the following subsection:

"7.09 (b). The following area situated at Waimea, South Kohala, Hawaii, shall be single-family residential (RS-15):

Beginning at the east corner of this lot, being the west corner of Hokuula Road and a 20 foot road reservation, the co-ordinates of said point of beginning referred to Government Survey Triangulation Station "West Base" being 558.41 feet south and 3380.58 feet west as shown on Government Survey Registered Map No. 2470 and running by true azimuths:

1. 55° 09' 193.3 feet along Hokuula Road;
2. 97° 30' 226.8 feet along Hokuula Road;
3. 187° 30' 535.7 feet along Lot 16, Block 1 to an unmarked point;
4. 325° 09' 547.7 feet along 20 foot road reservation to the point of beginning. Area: 2.61 acres.

All as outlined in red on the map attached hereto, marked Exhibit "A" and by reference made a part hereof."

SECTION 2. Section 1 of this ordinance shall take effect forthwith upon the condition that the owner or lessee of the subject area submit a subdivision plan and secure preliminary approval no later than one year from the date of approval of the change of zone request. Should this condition not be met, the Planning Commission shall reserve the right to initiate action to rezone the area to its former designation.

SECTION 3. In the event that any portion of this ordinance is declared invalid, such invalidity shall not affect the other parts of this ordinance.

SECTION 4. This ordinance shall take effect upon its approval.

INTRODUCED BY:

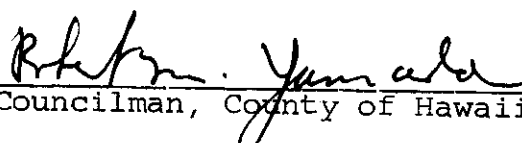

Councilman, County of Hawaii

Hilo, Hawaii

Date of Introduction: July 12, 1972

Date of Adoption: July 26, 1972

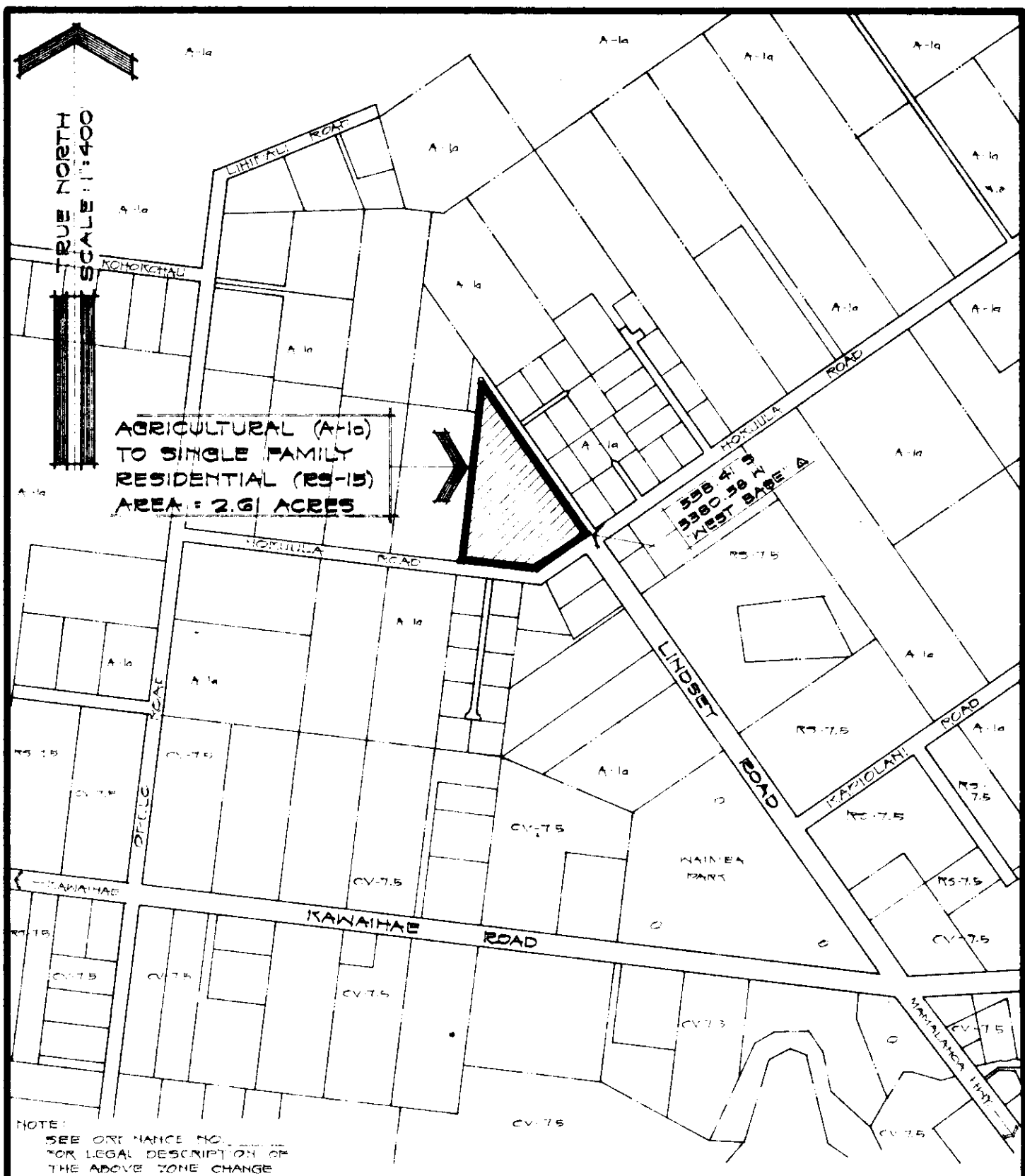

AMENDMENT TO THE COUNTY ZONING ORDINANCE
AMENDMENT NO. 2 OF SECTION 7.09, THE KAMUELA
ZONE MAP, PORTION OF ORDINANCE NO. 109, CHANGING
THE DISTRICT CLASSIFICATION FROM AGRICULTURAL
(A-1a) TO SINGLE FAMILY RESIDENTIAL (RS-15) AT
WAIMEA, SOUTH KOHALA, HAWAII.

DATE OF PUBLIC HEARING : MAY 25, 1972
 DATE OF APPROVAL :
 ORDINANCE NO.
 PREPARED BY : PLANNING DEPARTMENT
 COUNTY OF HAWAII

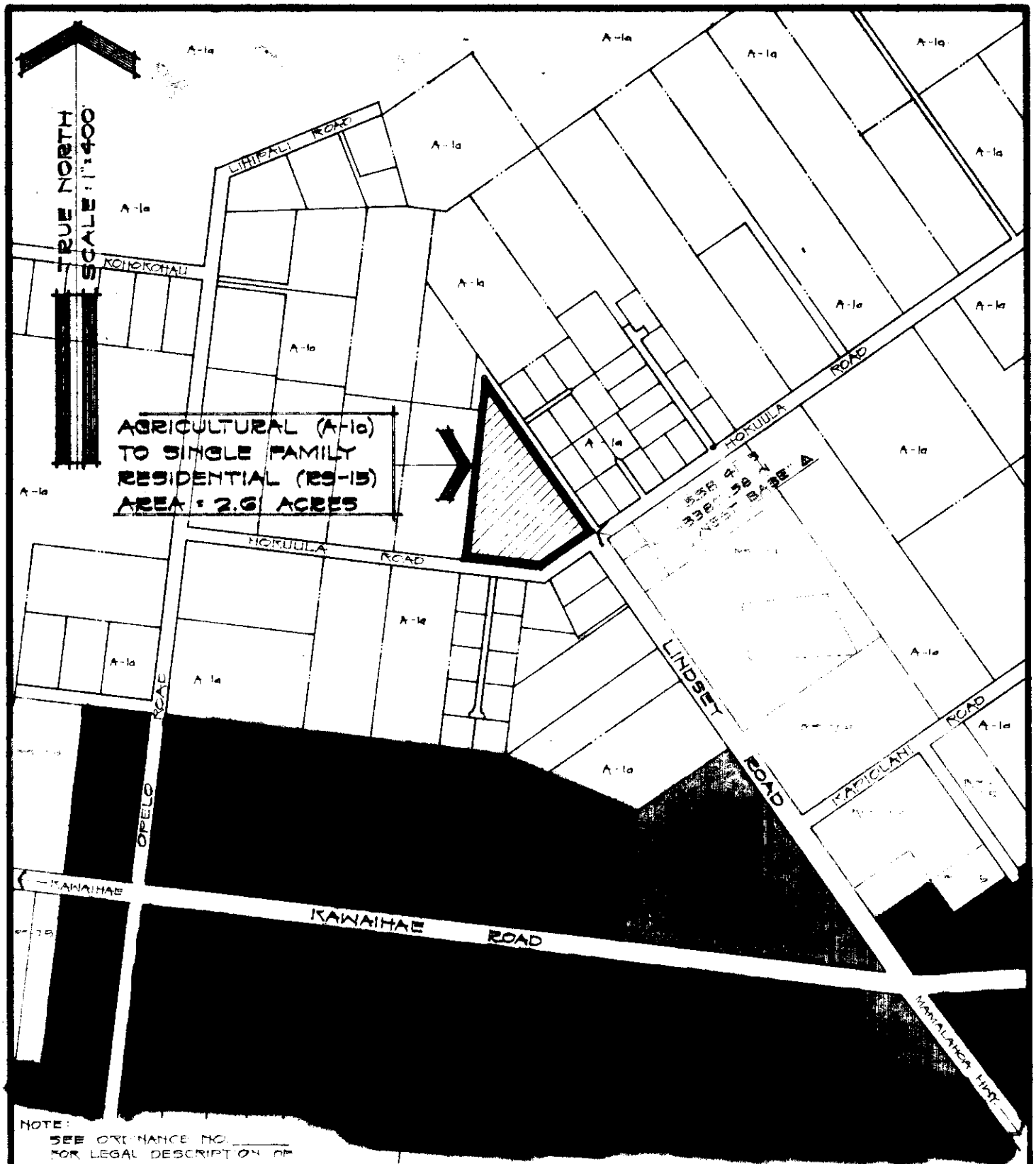

AGRICULTURAL (A-1a)
 TO SINGLE FAMILY
 RESIDENTIAL (RS-15)
 AREA = 2.6 ACRES

NOTE:
 SEE ORDINANCE NO. _____
 FOR LEGAL DESCRIPTION OF
 THE ABOVE ZONE CHANGE

AMENDMENT TO THE COUNTY ZONING ORDINANCE
 AMENDMENT NO. 2 OF SECTION 7.09, THE KAMUELA
 ZONE MAP, PORTION OF ORDINANCE NO. 109, CHANGING
 THE DISTRICT CLASSIFICATION FROM AGRICULTURAL
 (A-1a) TO SINGLE FAMILY RESIDENTIAL (RS-15) AT
 WAIMEA, SOUTH KOHALA, HAWAII.

DATE OF PUBLIC HEARING : MAY 25, 1972
 DATE OF APPROVAL :
 ORDINANCE NO.
 PREPARED BY : PLANNING DEPARTMENT
 COUNTY OF HAWAII

TMK G-5-07:28

2 JUNE 1972

EXHIBIT "A"

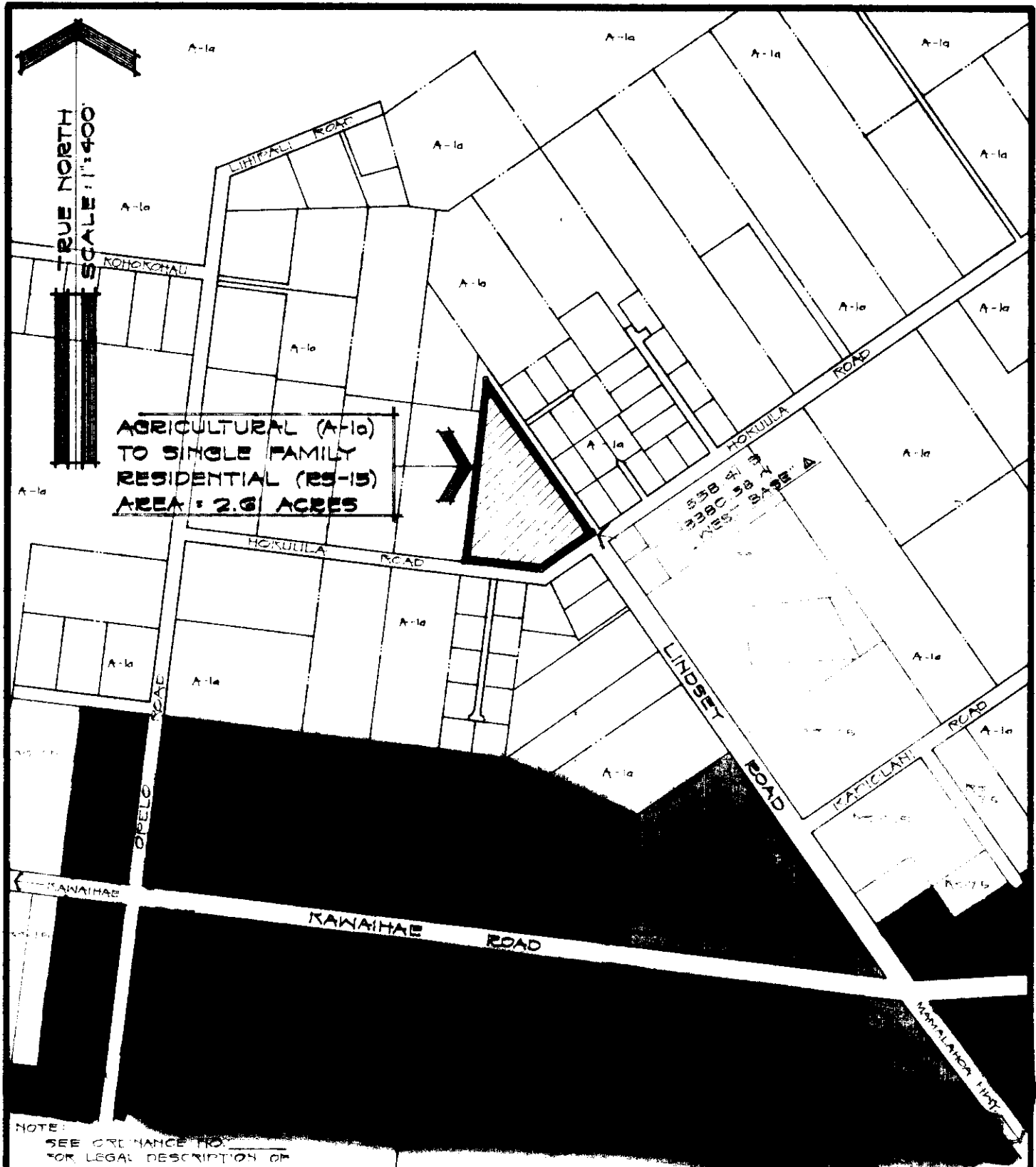

AMENDMENT TO THE COUNTY ZONING ORDINANCE
AMENDMENT NO. 2 OF SECTION 7.09, THE KAMUELA
ZONE MAP, PORTION OF ORDINANCE NO. 109, CHANGING
THE DISTRICT CLASSIFICATION FROM AGRICULTURAL
(A-1a) TO SINGLE FAMILY RESIDENTIAL (RS-15) AT
WAIMEA, SOUTH KOHALA, HAWAII.

DATE OF PUBLIC HEARING : MAY 25, 1972
 DATE OF APPROVAL :
 ORDINANCE NO.
 PREPARED BY : PLANNING DEPARTMENT
 COUNTY OF HAWAII

Hilo, Hawaii
 Date: July 12, 1972

FIRST READING			
	AYES	NOES	A/E
Carpenter	X		
De Luz	X		
Edwards	X		
Greenwell	X		
Hisaoka	X		
Souza	X		
Yadao	X		
Yamada	X		
Chr Matayoshi	X		
	9	0	0

Publication Date: July 12, 1972

Hilo, Hawaii
 Date: July 26, 1972

SECOND & FINAL READING			
	AYES	NOES	A/E
Carpenter	X		
De Luz	X		
Edwards	X		
Greenwell	X		
Hisaoka	X		
Souza	X		
Yadao	X		
Yamada	X		
Chr Matayoshi	X		
	9	0	0

Publication Date: August 7, 1972

We do hereby certify that the foregoing BILL was adopted by the County Council and published as indicated above.

 Council Chairman

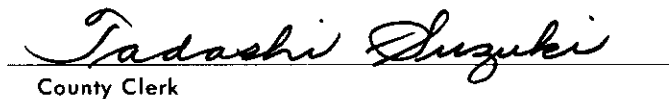
 County Clerk

Approved/Disapproved this 1st day of August, 1972

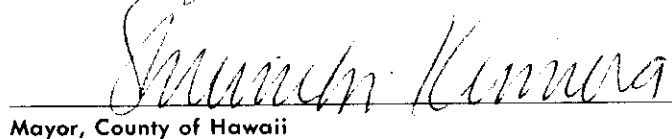
 Mayor, County of Hawaii

Bill No. 889
 Reference: C-2013/PEDIC-81
 M.B. No. 1864
 ORD. No. 489

Bill No. 889 - 1972

AN ORDINANCE AMENDING SECTION 7.09, THE KAMUELA ZONE MAP, ORDINANCE NO. 63 (ZONING ORDINANCE), REVISED ORDINANCES OF THE COUNTY OF HAWAII 1967, AS AMENDED, BY CHANGING THE DISTRICT CLASSIFICATION FROM AGRICULTURAL (A-1a) TO SINGLE-FAMILY RESIDENTIAL (RS-15) AT WAIMEA, SOUTH KOHALA, HAWAII, COVERED BY TAX MAP KEY 6-5-07:28.

This Bill proposes to amend the Kamuela Zone Map by changing the district classification for approximately 2.61 acres of land situated in Waimea, South Kohala, Hawaii, from agriculture (A-1a) to single-family residential (RS-15) zoned district.

Date Introduced: July 12, 1972

Copies of the foregoing Bill, in full, are on file in the Office of the County Clerk for use and examination by the public.

I hereby certify that the foregoing Bill passed first reading at the meeting of the County Council on July 12, 1972, by the following aye and no vote:

AYES: Councilmen Carpenter, De Luz, Edwards, Greenwell, Hisaoka, Souza, Yadao, Yamada and Chairman Matayoshi - 9.

NOES: None.

AN ORDINANCE AMENDING SECTION 7.09, THE KAMUELA ZONE MAP, ORDINANCE NO. 63 (ZONING ORDINANCE), REVISED ORDINANCES OF THE COUNTY OF HAWAII 1967, AS AMENDED, BY CHANGING THE DISTRICT CLASSIFICATION FROM AGRICULTURAL (A-1a) TO SINGLE-FAMILY RESIDENTIAL (RS-15) AT WAIMEA, SOUTH KOHALA, HAWAII, COVERED BY TAX MAP KEY 6-5-07:28.

This Bill proposes to amend the Kamuela Zone Map by changing the district classification for approximately 2.61 acres of land situated in Waimea, South Kohala, Hawaii, from agriculture (A-1a) to single family residential (RS-15) zoned district.

Date Introduced: July 12, 1972

Copies of the foregoing Bill, in full, are on file in the Office of the County Clerk for use and examination by the public.

I hereby certify that the foregoing Bill passed first reading at the meeting of the County Council on July 12, 1972, by the following aye and no vote:

AYES: Councilmen Carpenter, De Luz, Edwards, Greenwell, Hisaoka, Souza, Yadao, Yamada and Chairman Matayoshi - 9.

NOES: None.

Tadashi Suzuki
COUNTY CLERK
COUNTY OF HAWAII

Tadashi Suzuki
COUNTY CLERK
COUNTY OF HAWAII

ORDINANCE NO. 489
(Bill No. 889-1972)

AN ORDINANCE AMENDING SECTION 7.09, THE KAMUELA ZONE MAP, ORDINANCE NO. 63 (ZONING ORDINANCE), REVISED ORDINANCES OF THE COUNTY OF HAWAII 1967, AS AMENDED, BY CHANGING THE DISTRICT CLASSIFICATION FROM AGRICULTURAL (A-1a) TO SINGLE-FAMILY RESIDENTIAL (RS-15) AT WAIMEA, SOUTH KOHALA, HAWAII, COVERED BY TAX MAP KEY 6-5-07:28.

Date Approved: July 26, 1972
Date Effective: August 1, 1972

Copies of the foregoing Ordinance, in full, are on file in the Office of the County Clerk for use and examination by the public.

I hereby certify that the foregoing Ordinance passed second and final reading at the meeting of the County Council on July 26, 1972, by the following aye and no vote:

AYES: Councilmen Carpenter, De Luz, Edwards, Greenwell, Hisaoka, Souza, Yadao, Yamada and Chairman Matayoshi - 9.

NOES: None.

Tadashi Suzuki

COUNTY CLERK
COUNTY OF HAWAII

AN ORDINANCE AMENDING SECTION 7.09, THE KAMUELA ZONE MAP, ORDINANCE NO. 63 (ZONING ORDINANCE), REVISED ORDINANCES OF THE COUNTY OF HAWAII 1967, AS AMENDED, BY CHANGING THE DISTRICT CLASSIFICATION FROM AGRICULTURAL (A-1a) TO SINGLE-FAMILY RESIDENTIAL (RS-15) AT WAIMEA, SOUTH KOHALA, HAWAII, COVERED BY TAX MAP KEY 6-5-07:28.

Date Approved: July 26, 1972
Date Effective: August 1, 1972

Copies of the foregoing Ordinance, in full, are on file in the Office of the County Clerk for use and examination by the public.

I hereby certify that the foregoing Ordinance passed second and final reading at the meeting of the County Council on July 26, 1972, by the following aye and no vote.

AYES: Councilmen Carpenter, De Luz, Edwards, Greenwell, Hisaoka, Souza, Yadao, Yamada and Chairman Matayoshi - 9.

NOES: None.

Tadashi Suzuki
COUNTY CLERK
COUNTY OF HAWAII

(1972—Hawaii Tribune-Herald:
Aug. 7, 1972.)

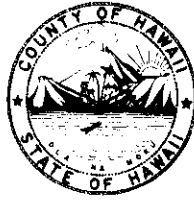

Tadashi Suzuki
COUNTY CLERK

Robert Shioji
DEPUTY COUNTY CLERK

OFFICE OF THE COUNTY CLERK
COUNTY OF HAWAII
HILO, HAWAII 96720

Mayor Shunichi Kimura
County of Hawaii
Hilo, Hawaii

I hereby transmit Ordinance Bill No. 889 passed by
the County Council on second and final reading.

Tadashi Suzuki
COUNTY CLERK

Encl.

Dated: July 26, 1972

RECEIVED
JUL 27 1972

1972 JUL 27