

COUNTY OF HAWAII - STATE OF HAWAII

ORDINANCE NO. 190

AN ORDINANCE AMENDING SECTION 7.02, THE NORTH KONA ZONE MAP, ORDINANCE NO. 63 (ZONING ORDINANCE), REVISED ORDINANCES OF THE COUNTY OF HAWAII 1967, AS AMENDED, BY CHANGING THE DISTRICT CLASSIFICATION FROM AGRICULTURAL (A-1a) TO SINGLE FAMILY RESIDENTIAL (RS-10) IN HOLUALOA 1ST AND 2ND, NORTH KONA, HAWAII, COVERED BY TAX MAP KEY 7-6-03:PORTION 26.

BE IT ORDAINED BY THE COUNCIL OF THE COUNTY OF HAWAII:

SECTION 1. Section 7.02 of Ordinance No. 63 (Zoning Ordinance), Revised Ordinances of the County of Hawaii 1967, as amended, is hereby further amended by adding thereto the following subsection:

"7.02 (t). The district classification of the following area situated at Holualoa 1st and 2nd, North Kona, Hawaii, shall be single-family residential (RS-10):

Beginning at the northwest corner of this parcel of land, the coordinates of which referred to Government Survey Triangulation Station "KAILUA" being 6,035.05 feet south and 15,756.62 feet east, and thence running by azimuths measured clockwise from true south:

Along stonewall, along R. P. 7786, L. C. Aw. 7947:1 to Kala for the following twelve (12) courses:

- | | | | |
|-----|------------------|---------|---------------------|
| 1. | 271 ^o | 41' | 46.71 feet; |
| 2. | 263 ^o | 13' | 64.10 feet; |
| 3. | 270 ^o | 06' | 40.10 feet; |
| 4. | 255 ^o | 38' | 50.37 feet; |
| 5. | 259 ^o | 29' 30" | 41.61 feet; |
| 6. | 268 ^o | 17' 30" | 24.15 feet; |
| 7. | 240 ^o | 28' | 67.12 feet; |
| 8. | 244 ^o | 27' | 48.94 feet; |
| 9. | 250 ^o | 44' | 51.11 feet; |
| 10. | 269 ^o | 31' 30" | 83.22 feet; |
| 11. | 264 ^o | 46' | 45.81 feet; |
| 12. | 241 ^o | 33' | 24.30 feet, thence; |

- 13. 323^o 37' 30" 118.70 feet along Allotment 98 of the Partition of the Holualoa 1 and 2 Hui Lands;
- 14. 355^o 14' 202.74 feet along Allotment 98 of the Partition of the Holualoa 1 and 2 Hui Lands;
- 15. 97^o 00' 206.70 feet along remainder of Allotment 24;
- 16. 87^o 00' 155.58 feet along remainders of Allotments 24 and G;

Thence along remainders of Allotments G and 23 on a 370.00 foot radius curve to the left, the chord azimuth and distance being:

- 17. 74^o 00' 166.46 feet;
- 18. 61^o 00' 201.78 feet along remainder of Allotment 23;
- 19. 184^o 09' 147.51 feet along the easterly side of Mamalahoa Highway;
- 20. 187^o 46' 30" 129.13 feet along the easterly side of Mamalahoa Highway;
- 21. 205^o 11' 38.40 feet along the easterly side of Mamalahoa Highway to the point of beginning and containing an area of 3.714 acres.

"All as outlined in red on the map attached hereto, marked Exhibit "A" and by reference made a part hereof."

SECTION 2. Section 1 of this ordinance shall take effect forthwith upon the conditions that (A) the subject area be zoned in three (3) increments; the first two (2) increments consisting of five (5) lots each, and the third increment consisting of the remaining lots. The effective date of zone for the next increment shall be after development has occurred on the previous zoning increment or increments. Development is defined as building permits issued for residential dwelling units and construction partially completed--partially completed in the sense of having roofs on those units--on 25% of the permanent structures of the previous increment or increments; and (B) the owner or lessee of the subject area submit a subdivision plan for

preliminary approval no later than one year from the date of approval of the change of zone request. Should this condition not be met, the Planning Commission shall reserve the right to initiate action to re-zone the subject area to its original designation.

SECTION 3. In the event that any portion of this ordinance is declared invalid, such invalidity shall not affect the other parts of this ordinance.

SECTION 4. This ordinance shall take effect upon its approval.

INTRODUCED BY:

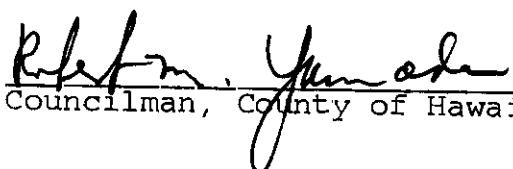

Councilman, County of Hawaii

Hilo, Hawaii

Date of Introduction: July 12, 1972

Date of Adoption: July 26, 1972

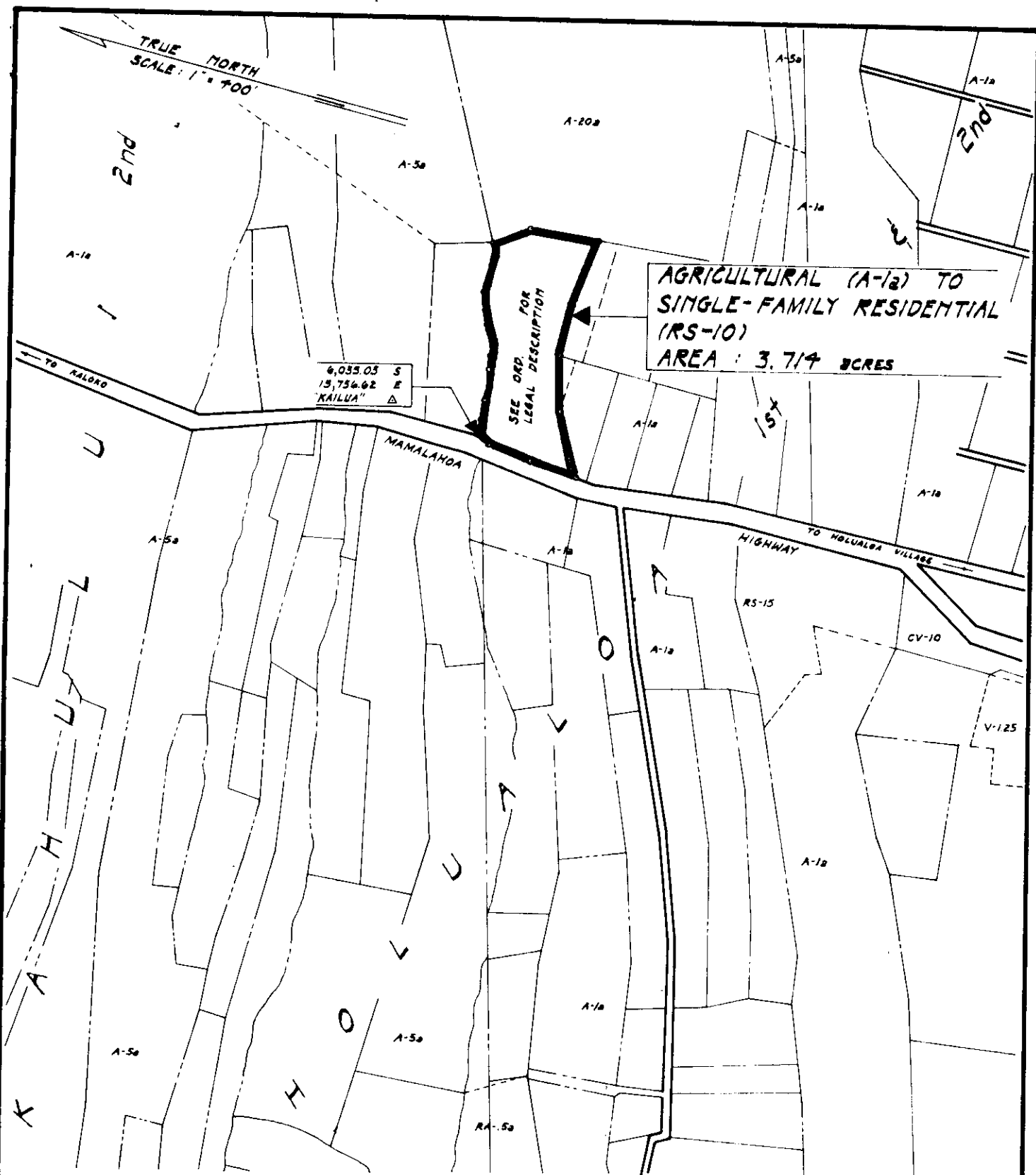

AMENDMENT to the COUNTY ZONING ORDINANCE

Amendment No. 20 of Section 7.02, the North Kona Zone Map, portion of Ordinance No. 79, changing the district classification from AGRICULTURAL (A-1a) to SINGLE-FAMILY RESIDENTIAL (RS-10) in Holualoa 1st and 2nd, North Kona, Hawaii.

Date of Public Hearing : March 29, 1972
 Date of Approval :
 Ordinance No.
 Prepared by : Planning Dept.
 County of Hawaii

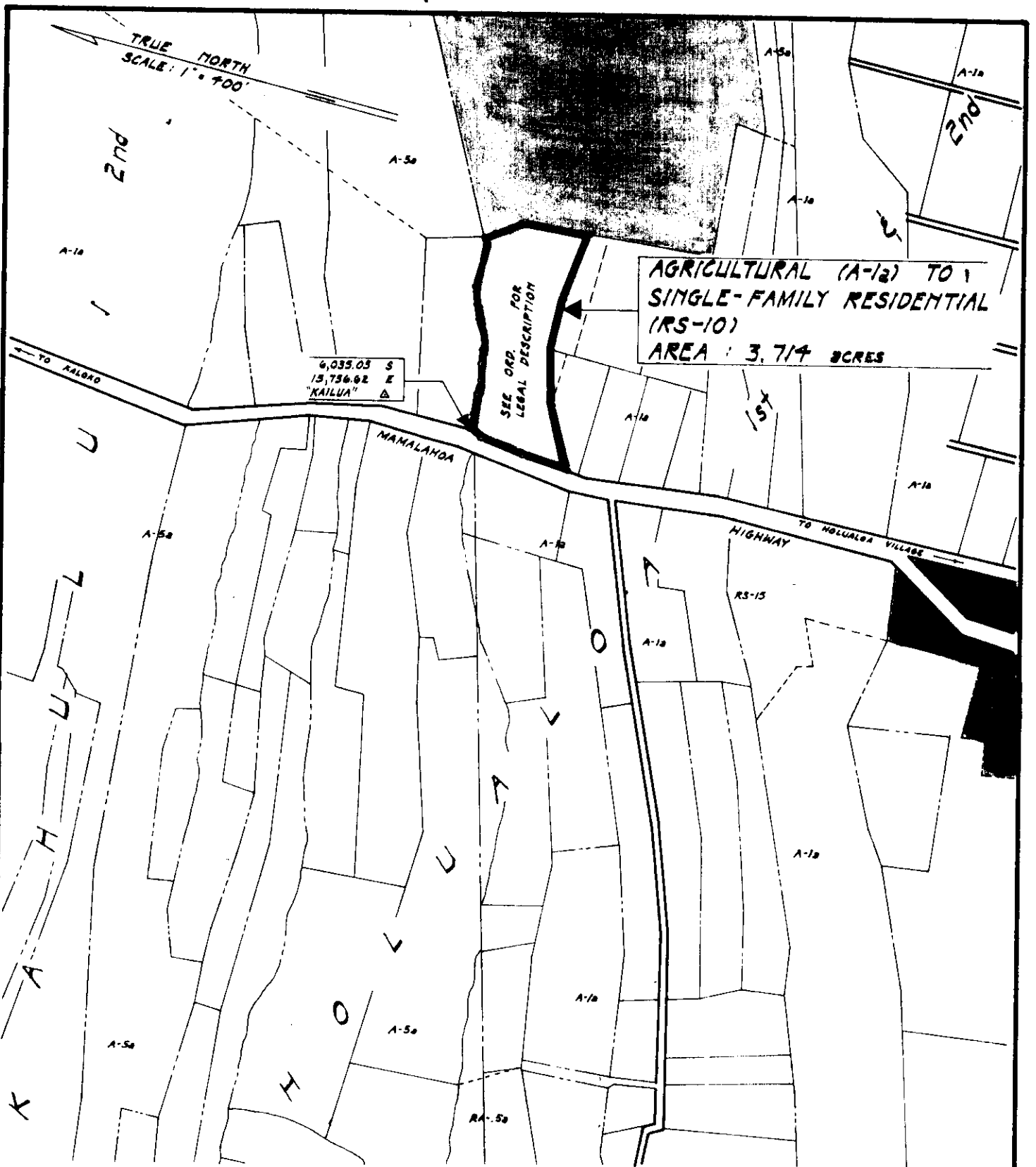

AMENDMENT to the COUNTY ZONING ORDINANCE

Amendment No. 20 of Section 7.02, the North Kona Zone Map, portion of Ordinance No. 74, changing the district classification from AGRICULTURAL (A-1a) to SINGLE-FAMILY RESIDENTIAL (RS-10) in Houaloea 1st and 2nd, North Kona, Hawaii.

Date of Public Hearing : March 29, 1972
 Date of Approval :
 Ordinance No.
 Prepared by : Planning Dept.
 County of Hawaii

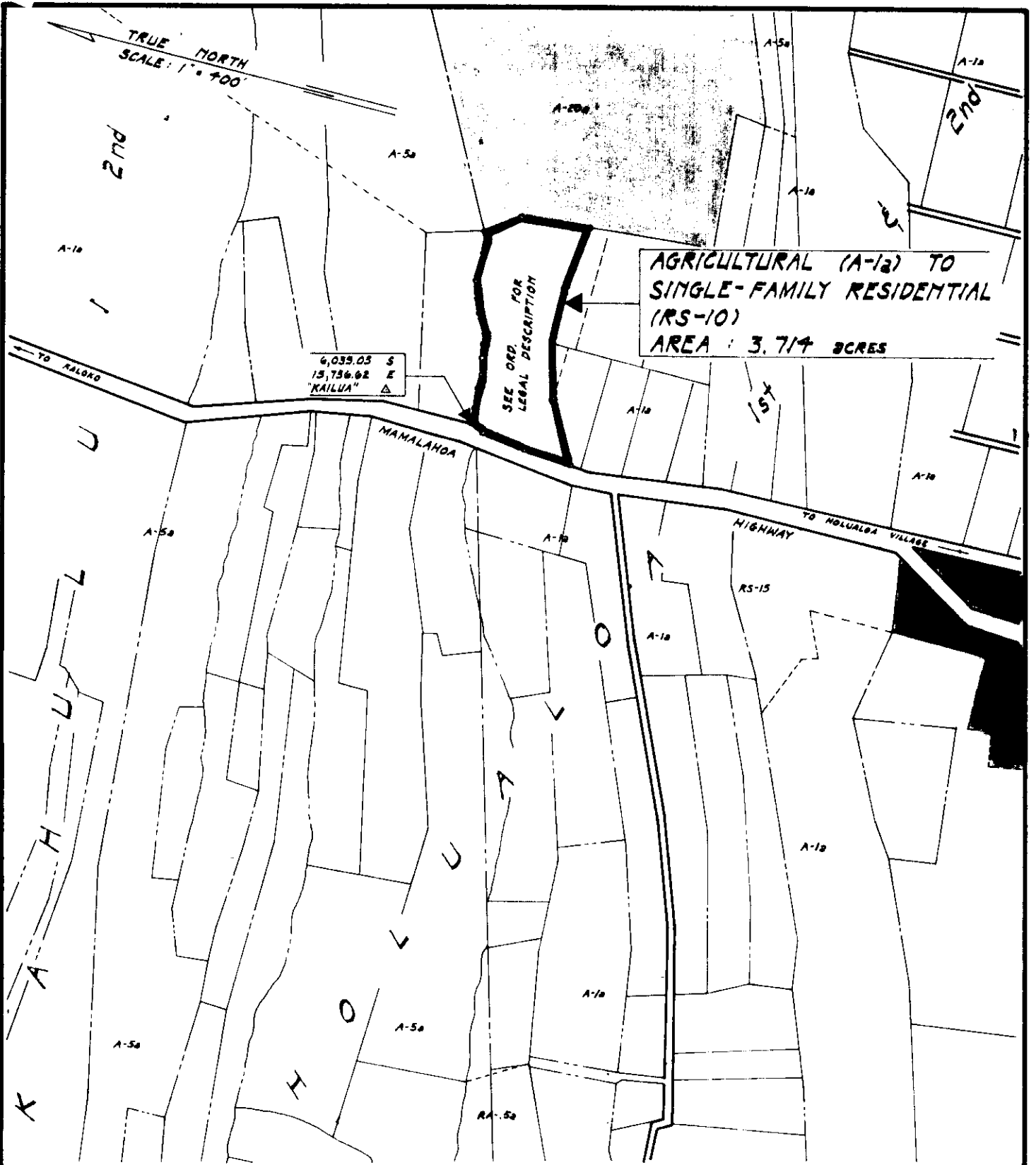

AMENDMENT to the COUNTY ZONING ORDINANCE

Amendment No. 20 of Section 7.02, the North Kona Zone Map, portion of Ordinance No. 74, changing the district classification from AGRICULTURAL (A-1a) to SINGLE-FAMILY RESIDENTIAL (RS-10) in Holualoa 1st and 2nd, North Kona, Hawaii.

Date of Public Hearing : March 24, 1972
 Date of Approval :
 Ordinance No. :
 Prepared by : Planning Dept.
 County of Hawaii

Hilo, Hawaii
 Date: July 12, 1972

Hilo, Hawa.
 Date: July 26, 1972

FIRST READING			
	AYES	NOES	A/E
Carpenter	X		
De Luz	X		
Edwards	X		
Greenwell	X		
Hisaoka	X		
Souza	X		
Yadao	X		
Yamada	X		
Chr Matayoshi	X		
	9	0	0

SECOND & FINAL READING			
	AYES	NOES	A/E
Carpenter	X		
De Luz	X		
Edwards	X		
Greenwell	X		
Hisaoka	X		
Souza	X		
Yadao	X		
Yamada	X		
Chr Matayoshi	X		
	9	0	0

Publication Date: July 17, 1972

Publication Date: July 27, 1972

We do hereby certify that the foregoing BILL was adopted by the County Council and published as indicated above.

Chr Matayoshi
 Council Chairman

Tadashi Suzuki
 County Clerk

Approved/~~Disapproved~~ this 12th day of August, 1972

Munichi Kimura
 Mayor, County of Hawaii

Bill No. 890
 Reference: C-2014/PEDLC-81
 M.B. No. 1833, 1865
 ORD. Bill No. 190

Bill No. 890 - 1972

AN ORDINANCE AMENDING SECTION 7.02, THE NORTH KONA ZONE MAP, ORDINANCE NO. 63 (ZONING ORDINANCE), REVISED ORDINANCES OF THE COUNTY OF HAWAII 1967, AS AMENDED, BY CHANGING THE DISTRICT CLASSIFICATION FROM AGRICULTURAL (A-1a) TO SINGLE FAMILY RESIDENTIAL (RS-10) IN HOLUALOA 1ST AND 2ND, NORTH KONA, HAWAII, COVERED BY TAX MAP KEY 7-6-03:PORTION 26.

This Bill proposes to amend the North Kona Zone Map by changing the district classification for approximately 3.714 acres of land situated in Holualoa 1st and 2nd, North Kona, Hawaii, from agricultural (A-1a) to single-family residential (RS-10) zoned district.

Date Introduced: July 12, 1972

Copies of the foregoing Bill, in full, are on file in the Office of the County Clerk for use and examination by the public.

I hereby certify that the foregoing Bill passed first reading at the meeting of the County Council on July 12, 1972, by the following aye and no vote:

AYES: Councilmen Carpenter, De Luz, Edwards, Greenwell, Hisaoka, Souza, Yadao, Yamada, and Chairman Matayoshi - 9.

NOES: None.

ORDINANCE NO. 89 (ZONING ORDINANCES), REVISED ORDINANCES OF THE COUNTY OF HAWAII 1967, AS AMENDED, BY CHANGING THE DISTRICT CLASSIFICATION FROM AGRICULTURAL (A-1a) TO SINGLE FAMILY RESIDENTIAL (RS-10) IN HOLUALOA 1ST AND 2ND, NORTH KONA, HAWAII, COVERED BY TAX MAP KEY 7-6-03:PORTION 26.

This Bill proposes to amend the North Kona Zone Map by changing the district classification for approximately 3.714 acres of land situated in Holualoa 1st and 2nd, North Kona, Hawaii, from agricultural (A-1a) to single-family residential (RS-10) zoned district.

Date Introduced: July 12, 1972

Copies of the foregoing Bill, in full, are on file in the Office of the County Clerk for use and examination by the public.

I hereby certify that the foregoing Bill passed first reading at the meeting of the County Council on July 12, 1972, by the following aye and no vote:

AYES: Councilmen Carpenter, De Luz, Edwards, Greenwell, Hisaoka, Souza, Yadao, Yamada, and Chairman Matayoshi—9.

NOES: None.

Tadashi Suzuki
COUNTY CLERK
COUNTY OF HAWAII

Tadashi Suzuki
COUNTY CLERK
COUNTY OF HAWAII

ORDINANCE NO. 490
(Bill No. 890-1972)

AN ORDINANCE AMENDING SECTION 7.02, THE NORTH KONA ZONE MAP, ORDINANCE NO. 63 (ZONING ORDINANCE), REVISED ORDINANCES OF THE COUNTY OF HAWAII 1967, AS AMENDED, BY CHANGING THE DISTRICT CLASSIFICATION FROM AGRICULTURAL (A-1a) TO SINGLE FAMILY RESIDENTIAL (RS-10) IN HOLUALOA 1ST AND 2ND, NORTH KONA, HAWAII, COVERED BY TAX MAP KEY 7-6-03:PORTION 26.

Date Approved: July 26, 1972
Date Effective: August 1, 1972

Copies of the foregoing Ordinance, in full, are on file in the Office of the County Clerk for use and examination by the public.

I hereby certify that the foregoing Ordinance passed second and final reading at the meeting of the County Council on July 26, 1972, by the following aye and no vote:

AYES: Councilmen Carpenter, De Luz, Edwards, Greenwell, Hisaoka, Souza, Yadao, Yamada and Chairman Matayoshi - 9.

NOES: None.



COUNTY CLERK
COUNTY OF HAWAII

AN ORDINANCE AMENDING SECTION 7.02, THE NORTH KONA ZONE MAP, ORDINANCE NO. 63 (ZONING ORDINANCE), REVISED ORDINANCES OF THE COUNTY OF HAWAII 1967, AS AMENDED, BY CHANGING THE DISTRICT CLASSIFICATION FROM AGRICULTURAL (A-1a) TO SINGLE FAMILY RESIDENTIAL (RS-10) IN HOLUALOA 1ST AND 2ND, NORTH KONA, HAWAII, COVERED BY TAX MAP KEY 7-6-03: PORTION 26.

Date Approved: July 26, 1972
Date Effective: August 1, 1972

Copies of the foregoing Ordinance, in full, are on file in the Office of the County Clerk for use and examination by the public.

I hereby certify that the foregoing Ordinance passed second and final reading at the meeting of the County Council on July 26, 1972, by the following aye and no vote:

AYES: Councilmen Carpenter, De Luz, Edwards, Greenwell, Hisaoka, Souza, Yadao, Yamada and Chairman Matayoshi - 9.
NOES: None.

Tadashi Suzuki
COUNTY CLERK
COUNTY OF HAWAII

Tadashi Suzuki
COUNTY CLERK

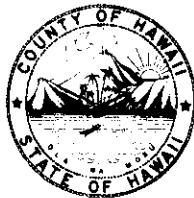

Robert Shioji
DEPUTY COUNTY CLERK

OFFICE OF THE COUNTY CLERK

COUNTY OF HAWAII
HILO, HAWAII 96720

Mayor Shunichi Kimura
County of Hawaii
Hilo, Hawaii

I hereby transmit Ordinance Bill No. 890 passed by
the County Council on second and final reading.

Tadashi Suzuki
COUNTY CLERK

Encl.

Dated: July 26, 1972

CLERK
COUNTY CLERK
HAWAII

1972 JUL 26