

COUNTY OF HAWAII - STATE OF HAWAII

ORDINANCE NO. 191

AN ORDINANCE AMENDING SECTION 7.22, THE PAHOA ZONE MAP, ORDINANCE NO. 63 (ZONING ORDINANCE), REVISED ORDINANCES OF THE COUNTY OF HAWAII 1967, AS AMENDED, BY CHANGING THE DISTRICT CLASSIFICATION FROM SINGLE FAMILY RESIDENTIAL (RS-10) TO VILLAGE COMMERCIAL (CV-10) AT NANAWALE HOMESTEADS, PAHOA, PUNA, HAWAII, COVERED BY TAX MAP KEY 1-5-11:14.

BE IT ORDAINED BY THE COUNCIL OF THE COUNTY OF HAWAII:

SECTION 1. Section 7.22 of Ordinance No. 63 (Zoning Ordinance), Revised Ordinances of the County of Hawaii 1967, as amended, is hereby further amended by adding thereto the following subsection:

"7.22(b). The district classification of the following area situated at Pahoa, Puna, Hawaii, shall be Village Commercial (CV-10):

Beginning at a point at the southwest corner of this lot and on the north side of Pahoa Road, the coordinates of said point of beginning, referred to Government Survey Triangulation Station "VILLAGE FLAG", being 1108.89 feet South and 1484.81 feet East, thence running by azimuths measured clockwise from true South:

1. 212° 48' 30" 228.34 feet along Lot 14;
2. 304° 58' 49.95 feet along Lot 30 and Lot 31;
3. 32° 17' 224.11 feet along Lot 12;
4. 120° 12' 52.00 feet along the North side of Pahoa Road to the point of beginning, containing an area of 11,522 Square Feet, more or less.

"All as outlined in red on the map attached hereto, marked Exhibit "A" and by reference made a part hereof."

SECTION 2. Section 1 of this ordinance shall take effect forthwith upon the condition that the owner or lessee of the subject property be responsible for securing a building permit and assuring construction started for a commercial office building within one (1)

year from the date of approval of the change of zone. Should this condition not be met, the Planning Commission shall reserve the right to re-evaluate the area and initiate action to rezone the property to its former zoning designation.

SECTION 3. In the event that any portion of this ordinance is declared invalid, such invalidity shall not affect the other parts of this ordinance.

SECTION 4. This ordinance shall take effect upon its approval.

INTRODUCED BY

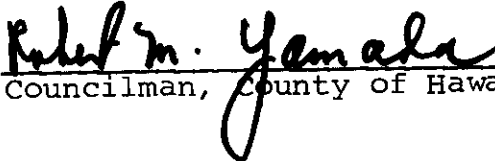

Councilman, County of Hawaii

Hilo, Hawaii

Date of Introduction: July 12, 1972

Date of Adoption: July 26, 1972

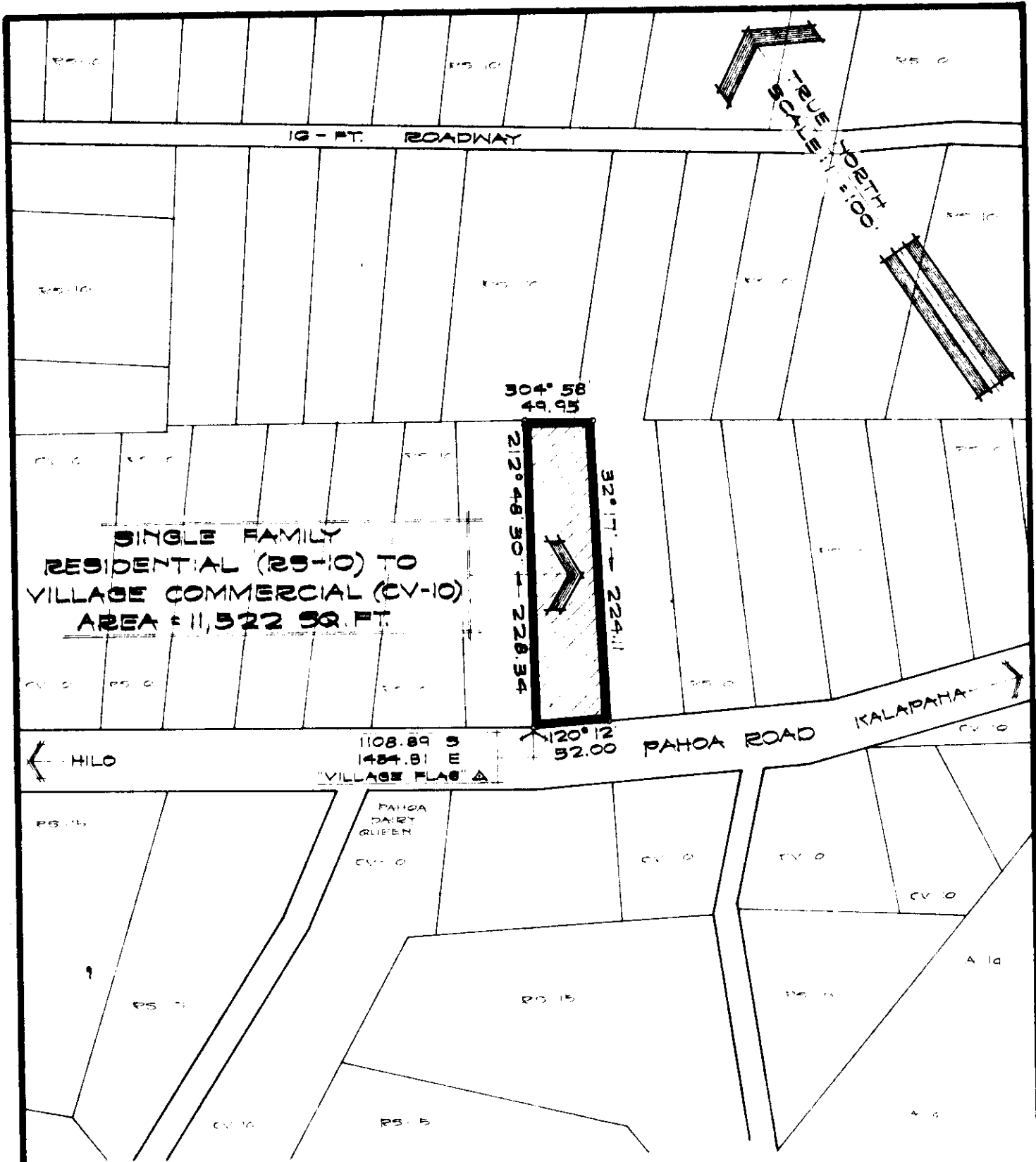

AMENDMENT TO THE COUNTY ZONING ORDINANCE

AMENDMENT NO. 2 OF SECTION 7.22, THE PAHOA ZONE MAP, PORTION OF ORDINANCE NO. III, CHANGING THE DISTRICT CLASSIFICATION FROM SINGLE FAMILY RESIDENTIAL (RS-10) TO VILLAGE COMMERCIAL (CV-10) AT NANAWALE HOMESTEADS, PUNA, HAWAII.

DATE OF PUBLIC HEARING : JUNE 15, 1972
 DATE OF APPROVAL :
 ORDINANCE NO.
 PREPARED BY : PLANNING DEPARTMENT
 COUNTY OF HAWAII

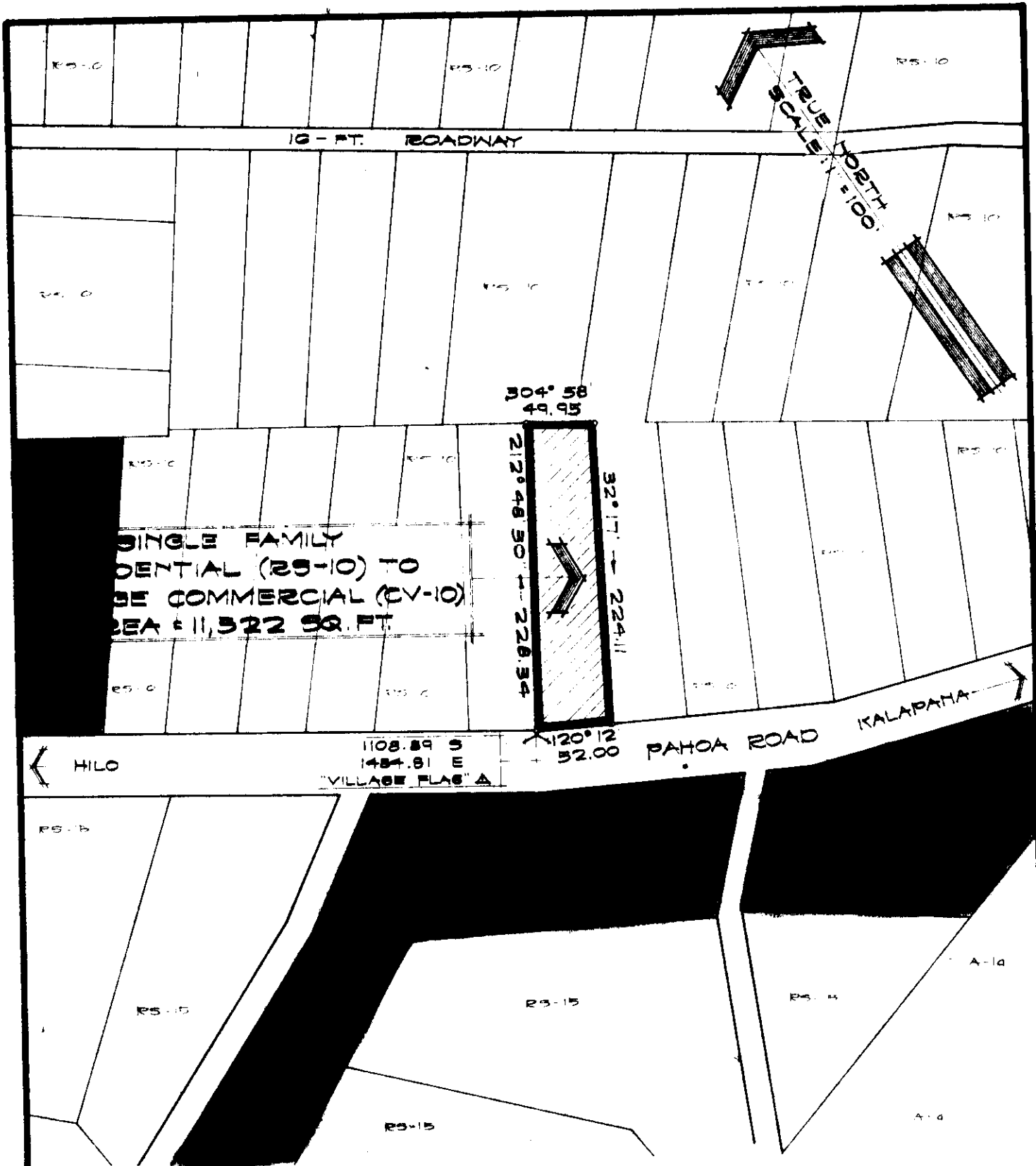

AMENDMENT TO THE COUNTY ZONING ORDINANCE

AMENDMENT NO. 2 OF SECTION 7.22, THE PAHOA ZONE MAP, PORTION OF ORDINANCE NO. III, CHANGING THE DISTRICT CLASSIFICATION FROM SINGLE FAMILY RESIDENTIAL (RS-10) TO VILLAGE COMMERCIAL (CV-10) AT NANAWALE HOMESTEADS, PUNA, HAWAII.

DATE OF PUBLIC HEARING : JUNE 15, 1972
 DATE OF APPROVAL :
 ORDINANCE NO.
 PREPARED BY : PLANNING DEPARTMENT
 COUNTY OF HAWAII

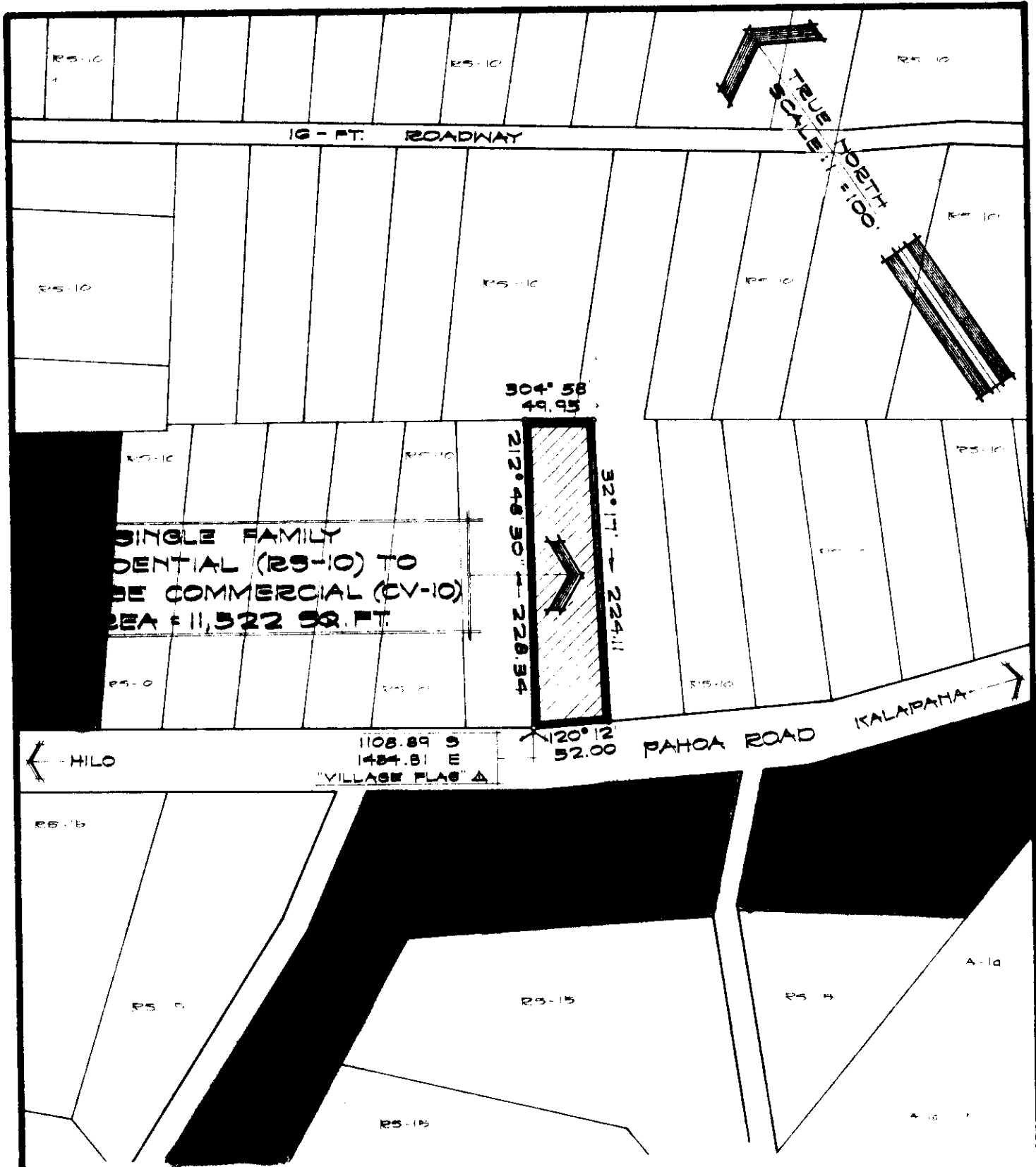

AMENDMENT TO THE COUNTY ZONING ORDINANCE

AMENDMENT NO. 2 OF SECTION 7.22, THE PAHOA ZONE MAP, PORTION OF ORDINANCE NO. III, CHANGING THE DISTRICT CLASSIFICATION FROM SINGLE FAMILY RESIDENTIAL (RS-10) TO VILLAGE COMMERCIAL (CV-10) AT NANAWALE HOMESTEADS, PUNA, HAWAII.

DATE OF PUBLIC HEARING : JUNE 15, 1972

DATE OF APPROVAL :

ORDINANCE NO.

PREPARED BY : PLANNING DEPARTMENT
COUNTY OF HAWAII

TMK 1-5-11-14

14 JUNE 1972

EXHIBIT "A"

Hilo, Hawaii
 Date: July 12, 1972

Hilo, Hawa.
 Date: July 26, 1972

FIRST READING			
	AYES	NOES	A/E
Carpenter	X		
De Luz	X		
Edwards	X		
Greenwell	X		
Hisaaka	X		
Souza	X		
Yadao	X		
Yamada	X		
Chr Matayoshi	X		
	9	0	0

SECOND & FINAL READING			
	AYES	NOES	A/E
Carpenter	X		
De Luz	X		
Edwards	X		
Greenwell	X		
Hisaaka	X		
Souza	X		
Yadao	X		
Yamada	X		
Chr Matayoshi	X		
	9	0	0

Publication Date: July 17, 1972

Publication Date: August 7, 1972

We do hereby certify that the foregoing BILL was adopted by the County Council and published as indicated above.

 Council Chairman

 County Clerk

Approved/Disapproved this 1st day of August, 1972

 Mayor, County of Hawaii

Bill No. 894
 Reference: C-2028/PEDLC-81
 M.B. No. 1841, 1866
 ORD. 191
 B&C No. _____

Bill No. 894 - 1972

AN ORDINANCE AMENDING SECTION 7.22, THE PAHOA ZONE MAP, ORDINANCE NO. 63 (ZONING ORDINANCE), REVISED ORDINANCES OF THE COUNTY OF HAWAII 1967, AS AMENDED, BY CHANGING THE DISTRICT CLASSIFICATION FROM SINGLE FAMILY RESIDENTIAL (RS-10) TO VILLAGE COMMERCIAL (CV-10) AT NANAWALE HOMESTEADS, PAHOA, PUNA, HAWAII, COVERED BY TAX MAP KEY 1-5-11:14.

This Bill proposes to amend the Pahoa Zone Map by changing the district classification from single family residential (RS-10) to village commercial (CV-10) zone in Nanawale Homesteads, Pahoa, Puna, Hawaii, subject to the requirement that the applicant, land owner, or lessee be responsible "for securing a building permit and assuring construction started for a commercial office building within one year from the official date of approval of the change of zone, and should this condition not be met, the Planning Commission shall reserve the right to re-evaluate the area and initiate action to rezone the property to its former zoning designation."

Date Introduced: July 12, 1972

Copies of the foregoing Bill, in full, are on file in the Office of the County Clerk for use and examination by the public.

I hereby certify that the foregoing Bill passed first reading at the meeting of the County Council on July 12, 1972, by the following ye and no vote:

AYES: Councilmen Carpenter, De Luz, Edwards, Greenwell, Hisaoka, Souza, Yadao, Yamada and Chairman Matayoshi - 9.

NONES: None.



THE COUNTY OF HAWAII 1967, AS AMENDED, BY CHANGING THE DISTRICT CLASSIFICATION FROM SINGLE FAMILY RESIDENTIAL (RS-10) TO VILLAGE COMMERCIAL (CV-10) AT NANAWALE HOMESTEADS, PAHOA, PUNA, HAWAII, COVERED BY TAX MAP KEY 1-5-11:14.

This Bill proposes to amend the Pahoa Zone Map by changing the district classification from single family residential (RS-10) to village commercial (CV-10) zone in Nanawale Homesteads, Pahoa, Puna, Hawaii, subject to the requirement that the applicant, land owner, or lessee be responsible "for securing a building permit and assuring construction started for a commercial office building within one year from the official date of approval of the change of zone, and should this condition not be met, the Planning Commission shall reserve the right to re-evaluate the area and initiate action to rezone the property to its former zoning designation."

Date Introduced: July 12, 1972



COUNTY CLERK
COUNTY OF HAWAII

ORDINANCE NO. 494
(Bill No. 894-1972)

AN ORDINANCE AMENDING SECTION 7.22, THE PAHOA ZONE MAP, ORDINANCE NO. 63 (ZONING ORDINANCE), REVISED ORDINANCES OF THE COUNTY OF HAWAII 1967, AS AMENDED, BY CHANGING THE DISTRICT CLASSIFICATION FROM SINGLE FAMILY RESIDENTIAL (RS-10) TO VILLAGE COMMERCIAL (CV-10) AT NANAWALE HOMESTEADS, PAHOA, PUNA, HAWAII, COVERED BY TAX MAP KEY 1-5-11:14.

Date Approved: July 26, 1972
Date Effective: August 1, 1972

Copies of the foregoing Ordinance, in full, are on file in the Office of the County Clerk for use and examination by the public.

I hereby certify that the foregoing Ordinance passed second and final reading at the meeting of the County Council on July 26, 1972, by the following aye and no vote:

AYES: Councilmen Carpenter, De Luz, Edwards, Greenwell, Hisaoka, Souza, Yadao, Yamada and Chairman Matayoshi - 9.

NOES: None.



COUNTY CLERK
COUNTY OF HAWAII



ORDINANCE, REVISED ORDINANCES OF THE COUNTY OF HAWAII 1967, AS AMENDED, BY CHANGING THE DISTRICT CLASSIFICATION FROM SINGLE FAMILY RESIDENTIAL (RS-10) TO VILLAGE COMMERCIAL (CV-10) AT NANAWALE HOMESTEADS, PAHOA, PUNA, HAWAII, COVERED BY TAX MAP KEY 1-5-11:14.

Date Approved: July 26, 1972
Date Effective: August 1, 1972

Copies of the foregoing Ordinance, in full, are on file in the Office of the County Clerk for use and examination by the public.

I hereby certify that the foregoing Ordinance passed second and final reading at the meeting of the County Council on July 26, 1972, by the following aye and no vote:

AYES: Councilmen Carpenter, De Luz, Edwards, Greenwell, Hisaoka, Souza, Yadao, Yamada and Chairman Matayoshi-9.

NOES: None.

Tadashi Suzuki
COUNTY CLERK
COUNTY OF HAWAII

Tadashi Suzuki
COUNTY CLERK

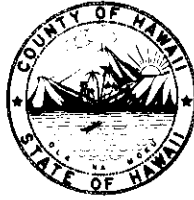

Robert Shioji
DEPUTY COUNTY CLERK

OFFICE OF THE COUNTY CLERK
COUNTY OF HAWAII
HILO, HAWAII 96720

Mayor Shunichi Kimura
County of Hawaii
Hilo, Hawaii

I hereby transmit Ordinance Bill No. 894 passed by
the County Council on second and final reading.

Tadashi Suzuki

COUNTY CLERK

Encl.

Dated: July 26, 1972