

COUNTY OF HAWAII - STATE OF HAWAII

ORDINANCE NO. 199

AN ORDINANCE AMENDING SECTION 7.30, THE PAPAIKOU-ONOMEA ZONE MAP, ORDINANCE NO. 63 (ZONING ORDINANCE), REVISED ORDINANCES OF THE COUNTY OF HAWAII 1967, AS AMENDED, BY CHANGING THE DISTRICT CLASSIFICATION FROM SINGLE-FAMILY RESIDENTIAL (RS-20) TO SINGLE-FAMILY RESIDENTIAL (RS-15) IN KALAOA, SOUTH HILO, HAWAII, COVERED BY TAX MAP KEY 2-7-31:1, 2, 20, 21, 22 and 23.

BE IT ORDAINED BY THE COUNCIL OF THE COUNTY OF HAWAII:

SECTION 1. Section 7.30 of Ordinance No. 63 (Zoning Ordinance), Revised Ordinances of the County of Hawaii 1967, as amended, is hereby further amended by adding thereto the following subsection:

"7.30(b). The district classification of the following area situated at Kalaoa, South Hilo, Hawaii, shall be Single-Family Residential (RS-15):

Beginning at a pipe at the Northeast corner of this parcel of land and on the West side of Old Government Road, the coordinates of said point of beginning referred to Government Survey Triangulation Station "ALALA" being 14160.87 feet South and 5410.81 feet East, and running by azimuths measured clockwise from true South:

1.     3°     00'                   377.00 feet along the West side of Old Government Road to a pipe;
2.     1°     00'                   159.00 feet along the West side of Old Government Road to a point in the middle of a stream;

Thence following along the middle of a stream in all its windings, the direct azimuths and distances between points in the middle of said stream for the next two (2) courses being:

3.     130°    29'  12"           395.64 feet;
4.     156°    46'  16"           176.59 feet;
5.     234°    46'                99.37 feet along the remainder of R. P. 5542, L. C. Aw. 8629, Apana 1 to Kaapa to a pipe;

6. 259° 17' 30" 317.43 feet along the remainder of R. P. 5542, L. C. Aw. 8629, Apana 1 to Kaapa to the point of beginning and containing an area of 2.734 acres.

"All as outlined in red on the map attached hereto, marked Exhibit "A" and by reference made a part hereof."

SECTION 2. Section 1 of this ordinance shall take effect forthwith upon the conditions that (A) the owner or lessee of the subject property submit a subdivision plan for preliminary approval within one (1) year from the date of approval of the change of zone and (B) the owner or lessee not begin construction of any additional dwellings until the existing 2" pipeline has been replaced.

SECTION 3. In the event that any portion of this ordinance is declared invalid, such invalidity shall not affect the other parts of this ordinance.

SECTION 4. This ordinance shall take effect upon its approval.

INTRODUCED BY:

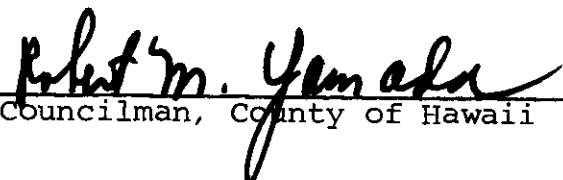
  
\_\_\_\_\_  
Councilman, County of Hawaii

Hilo, Hawaii

Date of Introduction: July 12, 1972

Date of Adoption: July 26, 1972

Date of Public Hearing : May 11, 1972  
Date of Approval :  
Ordinance No.  
Prepared by : Planning Dept.  
County of Hawaii

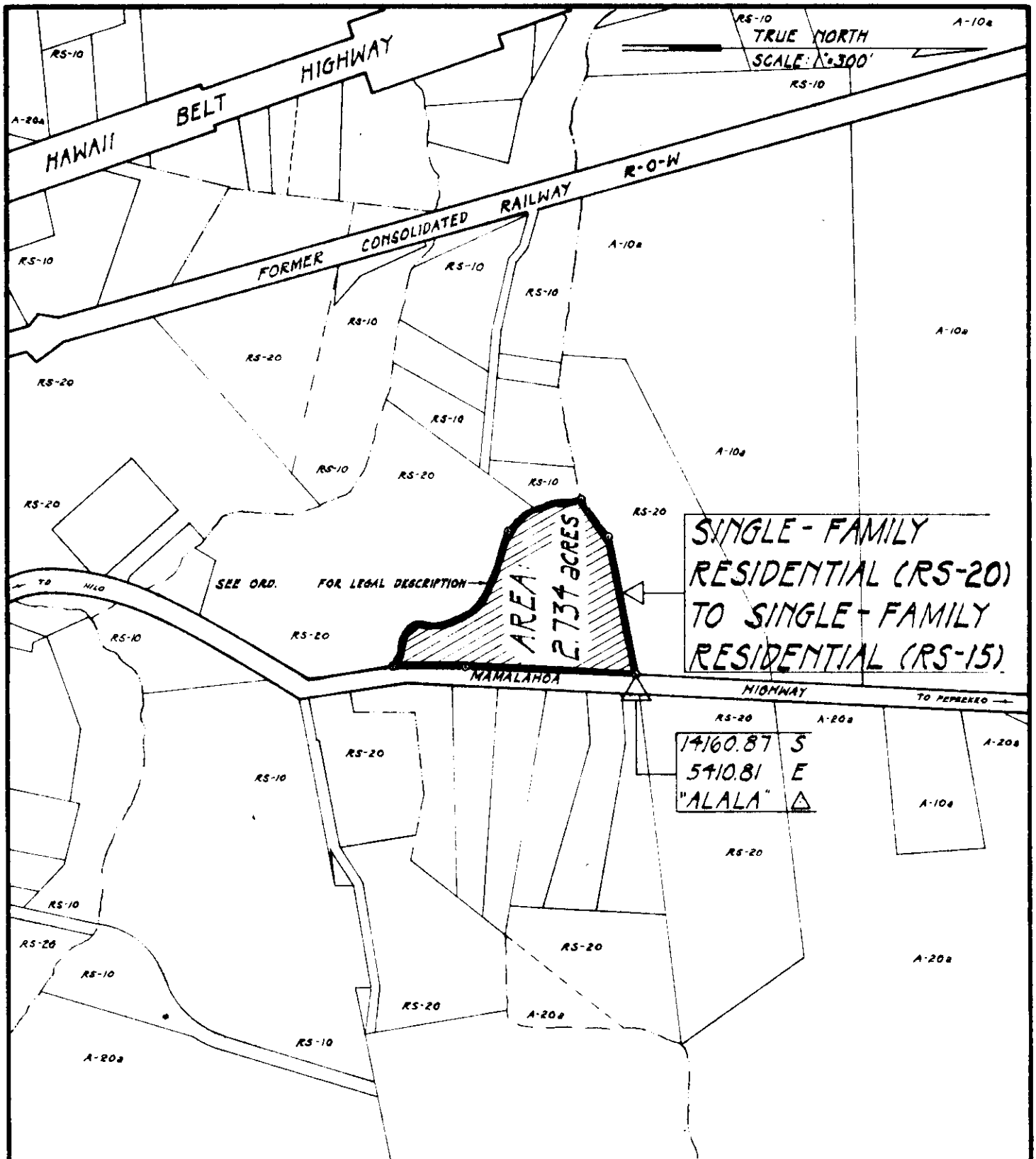

## AMENDMENT to the COUNTY ZONING ORDINANCE

Amendment No. 2 of Section 7.30, the PAPAIKOU - ONOMEA ZONE MAP, portion of Ordinance No. 190, changing the district classification from SINGLE-FAMILY RESIDENTIAL (RS-20) to SINGLE-FAMILY RESIDENTIAL (RS-15) in Kalaoa, South Hilo, Hawaii.

Date of Public Hearing : May 11, 1972

Date of Approval :

Ordinance No.

Prepared by : Planning Dept.  
County of Hawaii

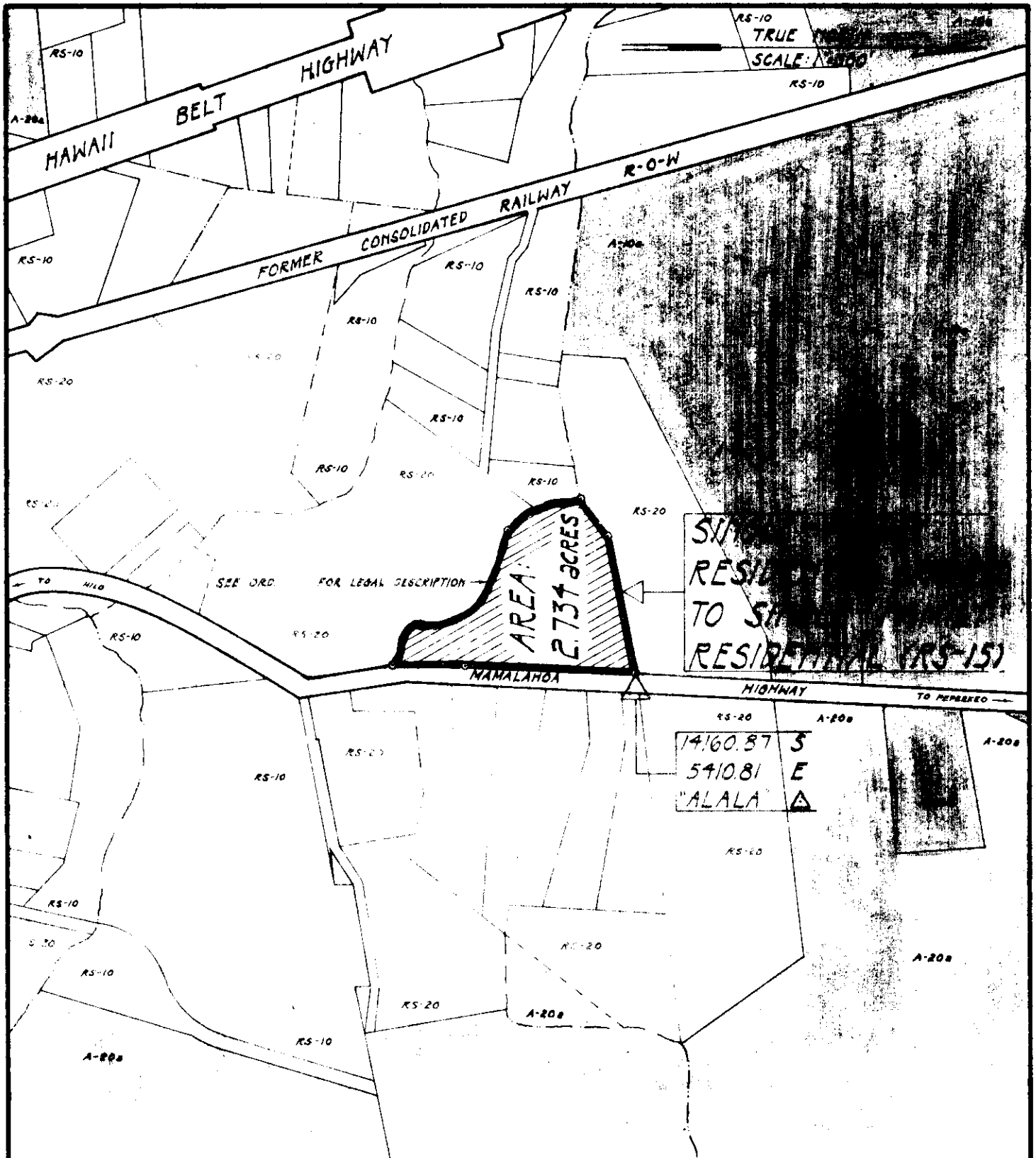

## AMENDMENT to the COUNTY ZONING ORDINANCE

Amendment No. 2 of Section 7.30, the PAPAIKOU - ONOMEA ZONE MAP, portion of Ordinance No. 190, changing the district classification from SINGLE-FAMILY RESIDENTIAL (RS-20) to SINGLE-FAMILY RESIDENTIAL (RS-15) in Kalaoa, South Hilo, Hawaii.

Date of Public Hearing : May 11, 1972

Date of Approval :

Ordinance No.

Prepared by : Planning Dept.  
County of Hawaii

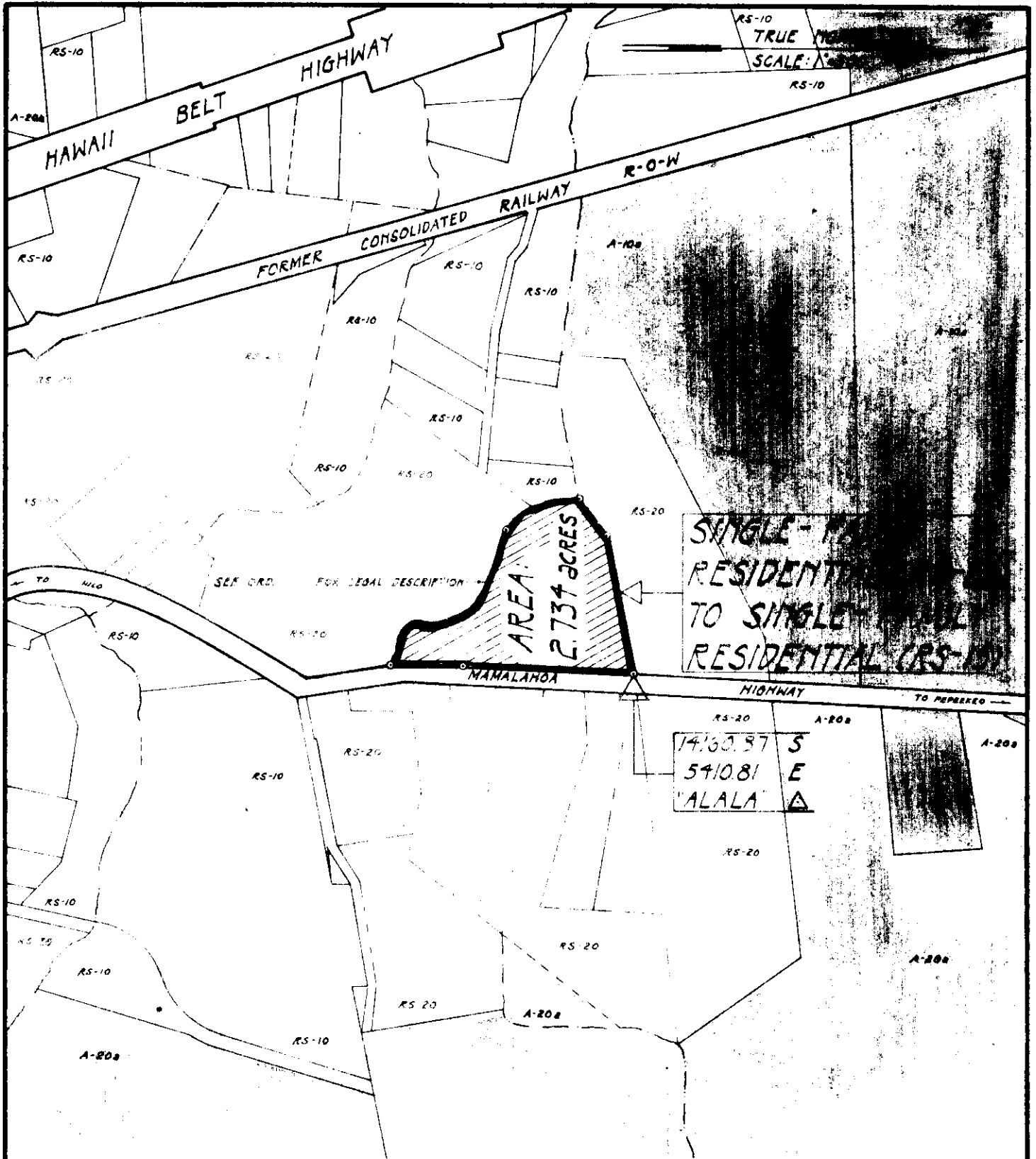

## AMENDMENT to the COUNTY ZONING ORDINANCE

Amendment No. 2 of Section 7.30, the PAPAIKOU - ONOMEA ZONE MAP, portion of Ordinance No. 190, changing the district classification from SINGLE-FAMILY RESIDENTIAL (RS-20) to SINGLE-FAMILY RESIDENTIAL (RS-15) in Kalaoa, South Hilo, Hawaii.

Date of Public Hearing : May 11, 1972

Date of Approval :

Ordinance No.

Prepared by : Planning Dept.  
County of Hawaii

Hilo, Hawaii  
 Date: July 12, 1972

FIRST READING			
	AYES	NOES	A/E
Carpenter	X		
De Luz	X		
Edwards	X		
Greenwell	X		
Hisaoka	X		
Souza	X		
Yadao	X		
Yamada	X		
Chr Matayoshi	X		
	9	0	0

Publication Date: July 17, 1972

Hilo, Hawaii  
 Date: July 26, 1972

SECOND & FINAL READING			
	AYES	NOES	A/E
Carpenter	X		
De Luz	X		
Edwards	X		
Greenwell	X		
Hisaoka	X		
Souza	X		
Yadao	X		
Yamada	X		
Chr Matayoshi	X		
	9	0	0

Publication Date: August 7, 1972

We do hereby certify that the foregoing BILL was adopted by the County Council and published as indicated above.

  
 Council Chairman

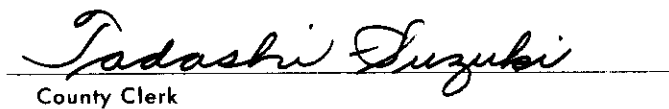
  
 County Clerk

Approved/Disapproved this 12<sup>th</sup> day of August, 1972

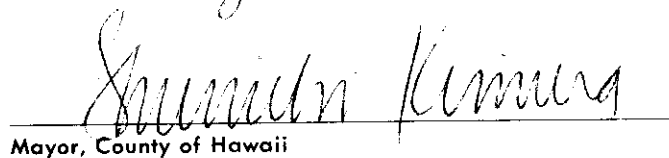
  
 Mayor, County of Hawaii

Bill No. 899  
 Reference: C-2032/PEDLC-81  
 M.B. No. 1843, 1868  
 ORD. No. 199

Bill No. 899 - 1972

AN ORDINANCE AMENDING SECTION 7.30, THE PAPAIKOU-ONOMEA ZONE MAP, ORDINANCE NO. 63 (ZONING ORDINANCE), REVISED ORDINANCE OF THE COUNTY OF HAWAII 1967, AS AMENDED, BY CHANGING THE DISTRICT CLASSIFICATION FROM SINGLE-FAMILY RESIDENTIAL (RS-20) TO SINGLE-FAMILY RESIDENTIAL (RS-15) IN KALAOA, SOUTH HILO, HAWAII, COVERED BY TAX MAP KEY 2-7-31:1, 2, 20, 21, 22 and 23.

This Bill proposes to amend the Papaikou-Onomea Zone Map, by changing the district classification from a single family residential (RS-20) to a single family residential (RS-15) zoned district in Kalaoa, South Hilo, Hawaii, subject to the owner or lessee submitting a subdivision plan for preliminary approval within one year from the official date of approval of the rezoning and not begin construction of any additional dwellings until the existing 2" pipeline has been replaced.

Date Introduced: July 12, 1972

Copies of the foregoing Bill, in full, are on file in the Office of the County Clerk for use and examination by the public.

---

I hereby certify that the foregoing Bill passed first reading at the meeting of the County Council on July 12, 1972, by the following aye and no vote:

AYES: Councilmen Carpenter, De Luz, Edwards, Greenwell, Hisaoka, Souza, Yadao, Yamada and Chairman Matayoshi -- 9.

NOES: None.

*Tadashi Suzuki*

COUNTY CLERK  
COUNTY OF HAWAII

MAP, ORDINANCE NO. 63 (ZONING ORDINANCE), REVISED ORDINANCE OF THE COUNTY OF HAWAII 1967, AS AMENDED, BY CHANGING THE DISTRICT CLASSIFICATION FROM SINGLE-FAMILY RESIDENTIAL (RS-20) TO SINGLE-FAMILY RESIDENTIAL (RS-15) IN KALAOA, SOUTH HILO, HAWAII, COVERED BY TAX MAP KEY 2-7-31:1, 2, 20, 21, 22 and 23.

This Bill proposes to amend the Papaikou-Onomea Zone Map, by changing the district classification from a single family residential (RS-20) to a single family residential (RS-15) zoned district in Kalaoa, South Hilo, Hawaii, subject to the owner or lessee submitting a subdivision plan for preliminary approval within one year from the official date of approval of the rezoning and not begin construction of any additional dwellings until the existing 2" pipeline has been replaced.

Date Introduced: July 12, 1972

Copies of the foregoing Bill, in full, are on file in the Office of the County Clerk for use and examination by the public.

I hereby certify that the foregoing Bill

ORDINANCE NO. 499  
(Bill No. 899-1972)

AN ORDINANCE AMENDING SECTION 7.30, THE PAPAIKOU-ONOMEA ZONE MAP, ORDINANCE NO. 63 (ZONING ORDINANCE), REVISED ORDINANCES OF THE COUNTY OF HAWAII 1967, AS AMENDED, BY CHANGING THE DISTRICT CLASSIFICATION FROM SINGLE-FAMILY RESIDENTIAL (RS-20) TO SINGLE-FAMILY RESIDENTIAL (RS-15) IN KALAOA, SOUTH HILO, HAWAII, COVERED BY TAX MAP KEY 2-7-31:1, 2, 20, 21, 22 and 23.

Date Approved: July 26, 1972  
Date Effective: August 1, 1972

Copies of the foregoing Ordinance, in full, are on file in the Office of the County Clerk for use and examination by the public.

---

I hereby certify that the foregoing Ordinance passed second and final reading at the meeting of the County Council on July 26, 1972, by the following aye and no vote:

AYES: Councilmen Carpenter, De Luz, Edwards, Greenwell, Hisaoka, Souza, Yadao, Yamada and Chairman Matayoshi -9.

NOES: None.

*Tadashi Suzuki*  
COUNTY CLERK  
COUNTY OF HAWAII

7.30, THE PAPAIKOU-ONOMEA ZONE MAP, ORDINANCE NO. 63 (ZONING ORDINANCE), REVISED ORDINANCES OF THE COUNTY OF HAWAII 1967, AS AMENDED, BY CHANGING THE DISTRICT CLASSIFICATION FROM SINGLE-FAMILY RESIDENTIAL (RS-20) TO SINGLE-FAMILY RESIDENTIAL (RS-15) IN KALAOA, SOUTH HILO, HAWAII, COVERED BY TAX MAP KEY 2-7-31:1, 2, 20, 21, 22 and 23.

Date Approved: July 26, 1972  
Date Effective: August 1, 1972

Copies of the foregoing Ordinance, in full, are on file in the Office of the County Clerk for use and examination by the public.

I hereby certify that the foregoing Ordinance passed second and final reading at the meeting of the County Council on July 26, 1972, by the following aye and no vote:

AYES: Councilmen Carpenter, De Luz, Edwards, Greenwell, Hisaoka, Souza, Yadao, Yamada and Chairman Matayoshi—9.

NOES: None.

Tadashi Suzuki  
COUNTY CLERK  
COUNTY OF HAWAII



Tadashi Suzuki  
COUNTY CLERK

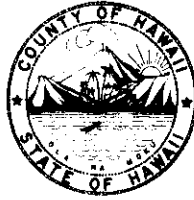

Robert Shioji  
DEPUTY COUNTY CLERK

**OFFICE OF THE COUNTY CLERK**

COUNTY OF HAWAII  
HILO, HAWAII 96720

Mayor Shunichi Kimura  
County of Hawaii  
Hilo, Hawaii

I hereby transmit Ordinance Bill No. 899 passed by  
the County Council on second and final reading.

*Tadashi Suzuki*

COUNTY CLERK

Encl.

Dated: July 26, 1972