

COUNTY OF HAWAII - STATE OF HAWAII
 ORDINANCE NO. 505

AN ORDINANCE AMENDING SECTION 7.09, THE KAMUELA ZONE MAP, ORDINANCE NO. 63 (ZONING ORDINANCE), REVISED ORDINANCES OF THE COUNTY OF HAWAII 1967, AS AMENDED, BY CHANGING THE DISTRICT CLASSIFICATION FROM AGRICULTURAL (A-5a) TO NEIGHBORHOOD COMMERCIAL (CN-7.5) IN PUUKAPU HOMESTEADS, WAIMEA, SOUTH KOHALA, HAWAII, COVERED BY TAX MAP KEY 6-4-01: PORTION OF 91.

BE IT ORDAINED BY THE COUNCIL OF THE COUNTY OF HAWAII:

SECTION 1. Section 7.09 of Ordinance No. 63 (Zoning Ordinance), Revised Ordinances of the County of Hawaii 1967, as amended is hereby further amended by adding thereto the following subsection:

"7.09(d). The district classification of the following area situated at Puukapu Homesteads, Waimea, South Kohala, Hawaii, shall be Neighborhood Commercial (CN-7.5):

Beginning at the east corner of this parcel of land and on the northerly side of Government Main Road, the coordinates of said point of beginning referred to Government Survey Triangulation Station "WEST BASE" being 757.30 feet south and 663.06 feet east, and running by azimuths measured clockwise from true south:

1. 70° 21' 139.00 feet along the northerly side of Government Main Road;
2. 149° 07' 436.00 feet along the remainder of Grant 4210 to Elizabeth W. Lyons;
3. 250° 21' 133.93 feet along the remainder of Grant 4210 to Elizabeth W. Lyons;
4. 327° 30' 30" 177.06 feet along the remainder of Grant 4210 to Elizabeth W. Lyons;
5. 329° 07' 260.00 feet along the remainder of Grant 4210 to Elizabeth W. Lyons to the point of beginning and containing an area of 59,006 square feet or 1.335 acres.

"All as outlined in red on the map attached hereto, marked Exhibit "A" and by reference made a part hereof."

SECTION 2. This ordinance shall take effect upon its approval.

INTRODUCED BY:

Councilman, County of Hawaii

Hilo, Hawaii

Date of Introduction: July 26, 1972

Date of Adoption: August 9, 1972

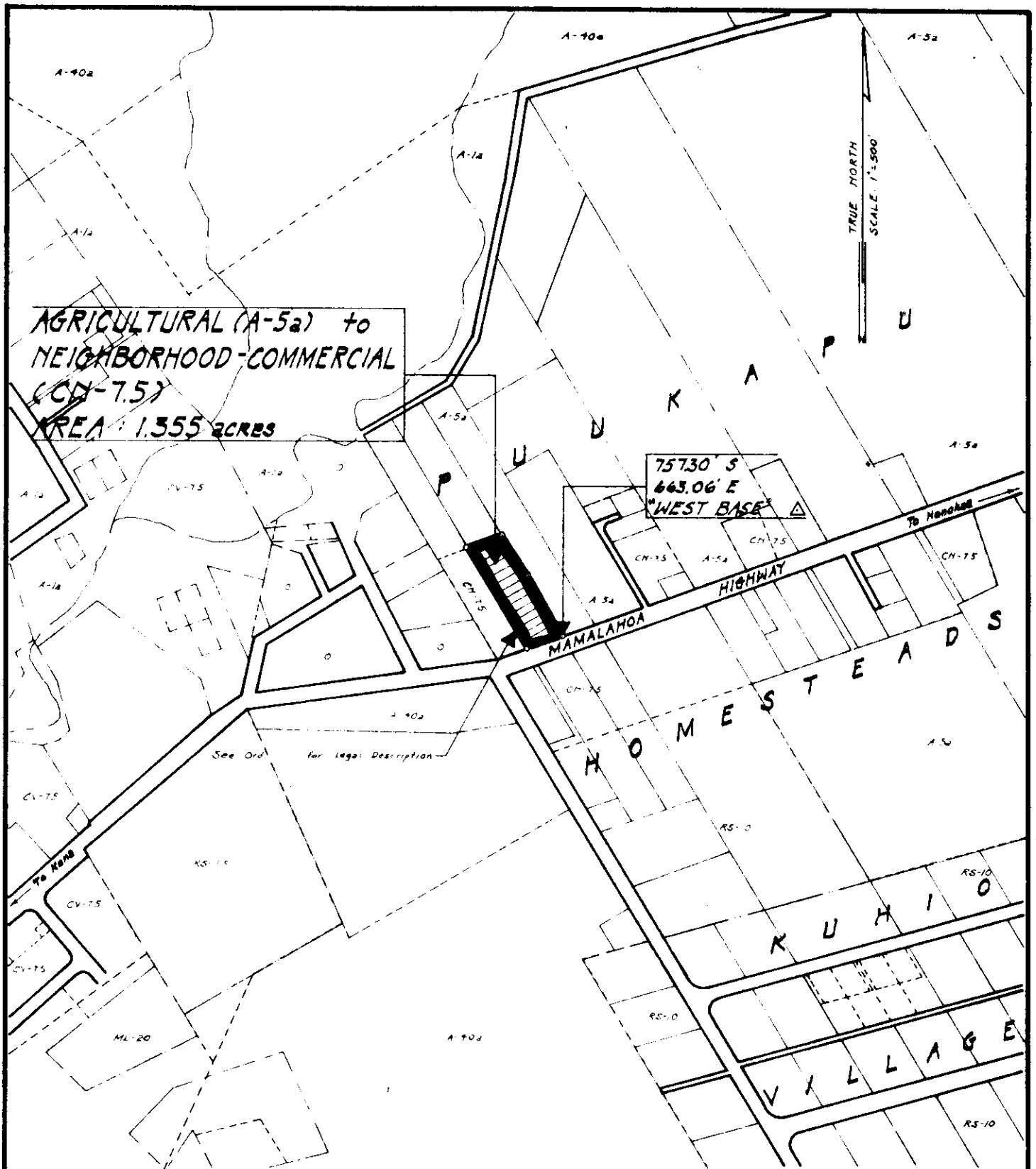

AMENDMENT to the COUNTY ZONING ORDINANCE

Amendment No. 4 of Section 7.09, the KAMUELA ZONE MAP, portion of Ordinance 109, changing the district classification from AGRICULTURAL (A-5a) to NEIGHBORHOOD-COMMERCIAL (CN-7.5) in Puukapu Homesteads, Waimea, South Kohala, Hawaii.

Date of Public Hearing: May 25, 1972
 Date of Approval:
 Ordinance No.
 Prepared by: Planning Dept.
 County of Hawaii

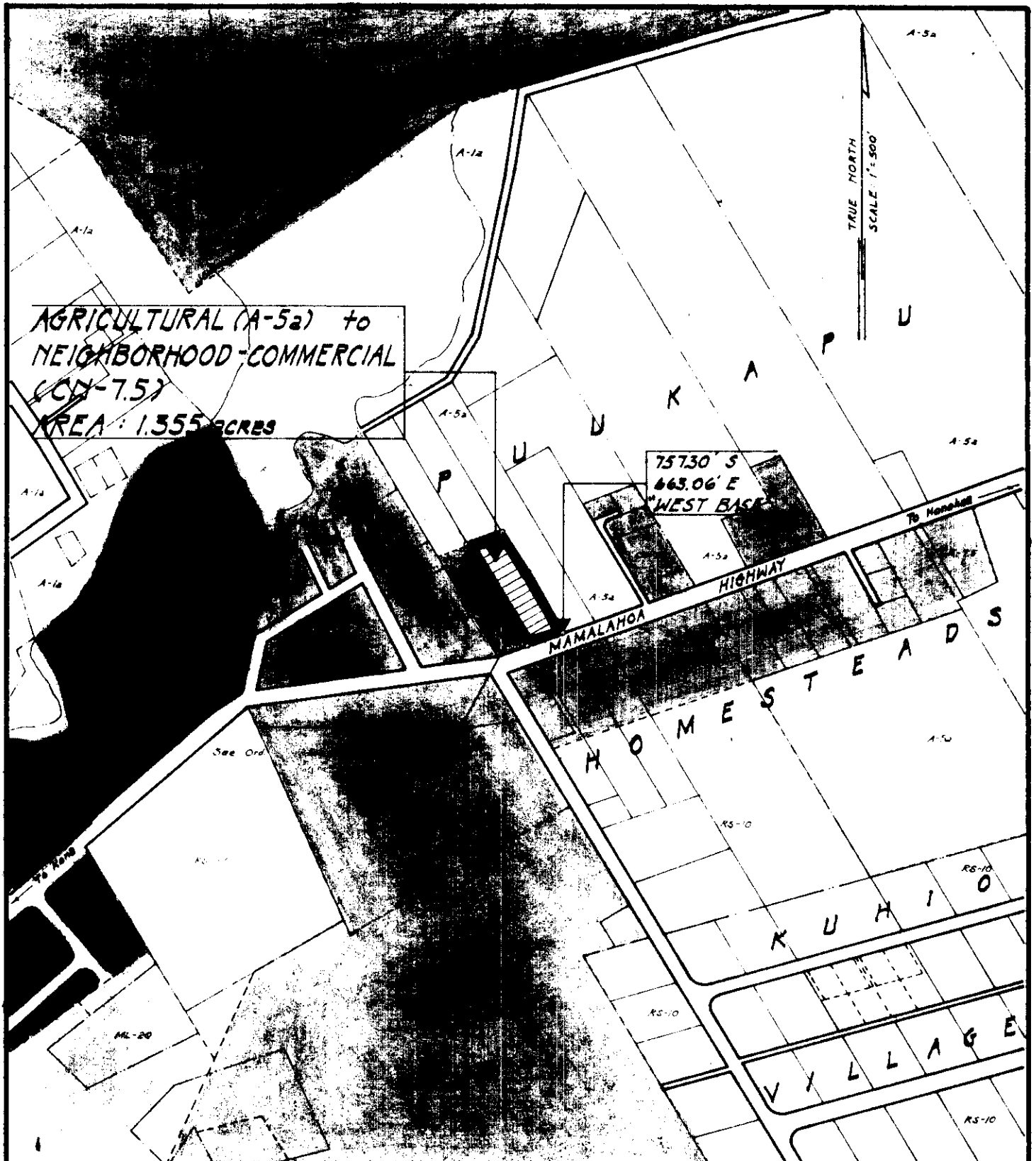

AGRICULTURAL (A-5a) to
 NEIGHBORHOOD-COMMERCIAL
 (CN-7.5)
 AREA: 1.355 ACRES

757.30 S
 663.06 E
 WEST BASE

AMENDMENT to the COUNTY ZONING ORDINANCE

Amendment No. 4 of Section 7.09, the KAMUELA ZONE MAP, portion of Ordinance 109, changing the district classification from AGRICULTURAL (A-5a) to NEIGHBORHOOD-COMMERCIAL (CN-7.5) in Puukapu Homesteads, Waimea, South Kohala, Hawaii.

Date of Public Hearing: May 25, 1972
 Date of Approval:
 Ordinance No.
 Prepared by: Planning Dept
 County of Hawaii

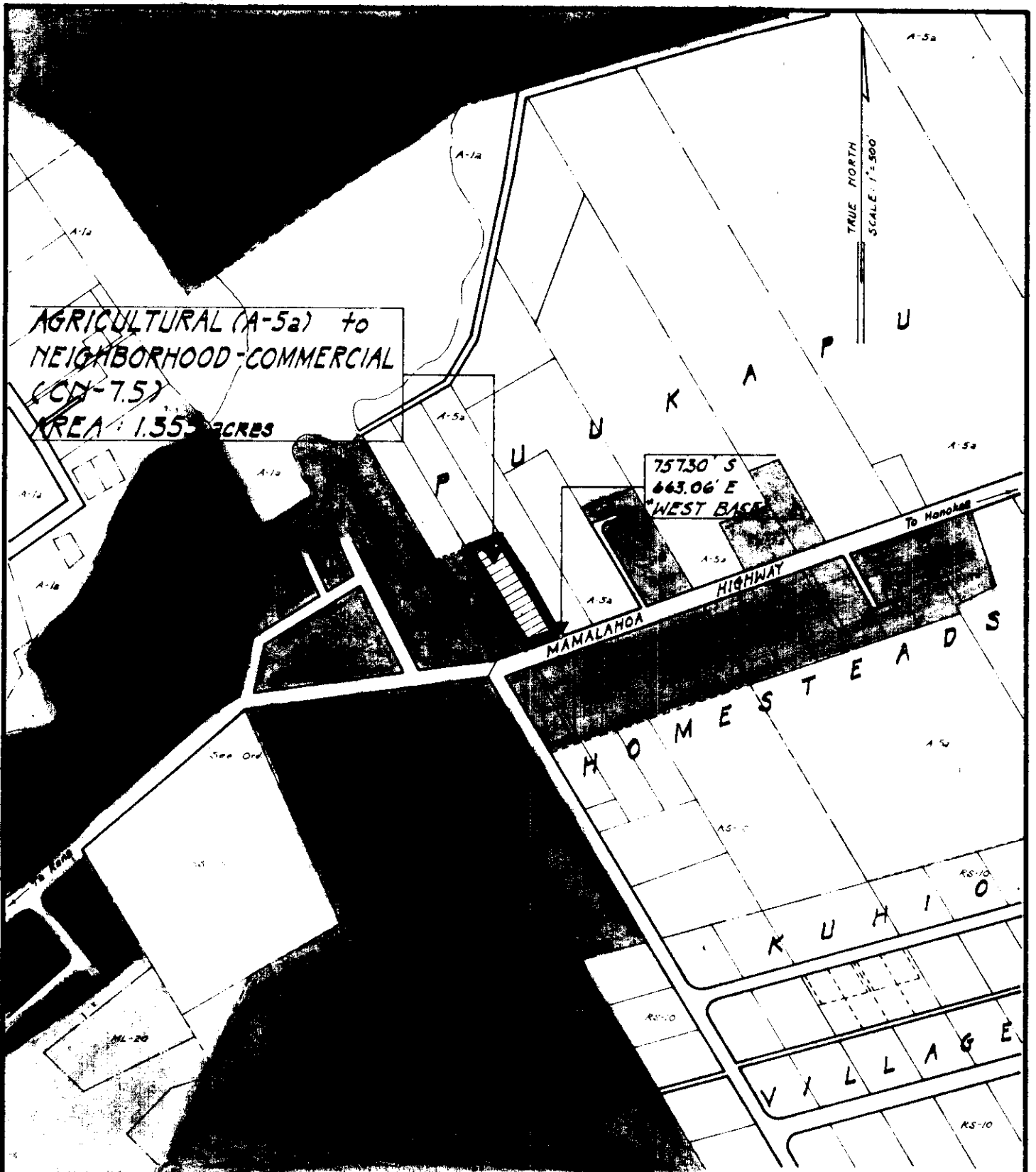

AMENDMENT to the COUNTY ZONING ORDINANCE

Amendment No. 4 of Section 7.09, the KAMUELA ZONE MAP, portion of Ordinance 109, changing the district classification from AGRICULTURAL (A-5a) to NEIGHBORHOOD-COMMERCIAL (CN-7.5) in Puukapu Homesteads, Waimea, South Kohala, Hawaii.

Date of Public Hearing: May 25, 1972
 Date of Approval:
 Ordinance No.
 Prepared by: Planning Dept
 County of Hawaii

Hilo, Hawaii
 Date: July 26, 1972

FIRST READING			
	AYES	NOES	A/E
Carpenter	X		
De Luz	X		
Edwards	X		
Greenwell	X		
Hisaoka	X		
Souza	X		
Yadao	X		
Yamada	X		
Chr Matayoshi	X		
	9	0	0

Publication Date: July 31, 1972

Hilo, Hawa.
 Date: August 9, 1972

SECOND & FINAL READING			
	AYES	NOES	A/E
Carpenter	X		
De Luz	X		
Edwards	X		
Greenwell	X		
Hisaoka	X		
Souza	X		
Yadao	X		
Yamada	X		
Chr Matayoshi	X		
	9	0	0

Publication Date: August 21, 1972

We do hereby certify that the foregoing BILL was adopted by the County Council and published as indicated above.

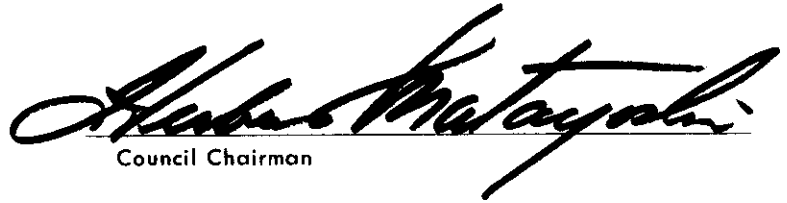
 Council Chairman

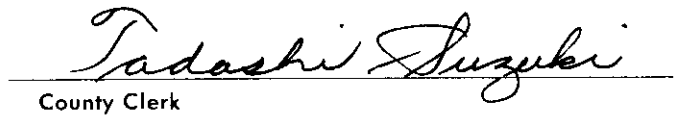
 County Clerk

Approved/Disapproved this 15th day of August, 1972

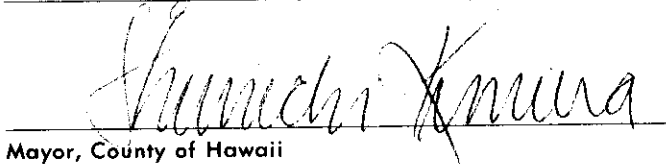
 Mayor, County of Hawaii

Bill No. 903
 Reference: C-2045/PEDLC-83
 M.B. No. 1860, 1876
 ORD. No. 505

Bill No. 903 - 1972

AN ORDINANCE AMENDING SECTION 7.09, THE KAMUELA ZONE MAP, ORDINANCE NO. 63 (ZONING ORDINANCE), REVISED ORDINANCES OF THE COUNTY OF HAWAII 1967, AS AMENDED, BY CHANGING THE DISTRICT CLASSIFICATION FROM AN AGRICULTURAL (A-5a) TO NEIGHBORHOOD COMMERCIAL (CN-7.5) IN PUUKAPU HOMESTEADS, WAIMEA, SOUTH KOHALA, HAWAII, COVERED BY TAX MAP KEY 6-4-01:PORTION OF 91.

This Bill proposes to amend the Kamuela Zone Map by changing the district classification from an agricultural (A-5a) to a neighborhood commercial (CN-7.5) zoned district in Puukapu Homesteads, Waimea, South Kohala, Hawaii.

Date Introduced: July 26, 1972

Copies of the foregoing Bill, in full, are on file in the Office of the County Clerk for use and examination by the public.

I hereby certify that the foregoing Bill passed first reading at the meeting of the County Council on July 26, 1972, by the following aye and no vote:

AYES: Councilmen Carpenter, De Luz, Edwards, Greenwell, Hisaoka, Souza, Yadao, Yamada and Chairman Matayoshi - 9.

NOES: None.

REVISED ORDINANCES OF THE COUNTY OF HAWAII 1967, AS AMENDED, BY CHANGING THE DISTRICT CLASSIFICATION FROM AN AGRICULTURAL (A-5a) TO NEIGHBORHOOD COMMERCIAL (CN-7.5) IN PUUKAPU HOMESTEADS, WAIMEA, SOUTH KOHALA, HAWAII, COVERED BY TAX MAP KEY 6-4-01:PORTION OF 91.

This Bill proposes to amend the Kamuela Zone Map by changing the district classification from an agricultural (A-5a) to a neighborhood commercial (CN-7.5) zoned district in Puukapu Homesteads, Waimea, South Kohala, Hawaii.

Date Introduced: July 26, 1972

Copies of the foregoing Bill, in full, are on file in the Office of the County Clerk for use and examination by the public.

I hereby certify that the foregoing Bill passed first reading at the meeting of the County Council on July 26, 1972, by the following aye and no vote:

AYES: Councilmen Carpenter, De Luz, Edwards, Greenwell, Hisaoka, Souza, Yadao, Yamada and Chairman Matayoshi—9.

NOES: None.

Tadashi Suzuki
COUNTY CLERK
COUNTY OF HAWAII



COUNTY CLERK
COUNTY OF HAWAII

ORDINANCE NO. 505
(Bill No. 903-1972)

AN ORDINANCE AMENDING SECTION 7.09, THE KAMUELA ZONE MAP, ORDINANCE NO. 63 (ZONING ORDINANCE), REVISED ORDINANCES OF THE COUNTY OF HAWAII 1967, AS AMENDED, BY CHANGING THE DISTRICT CLASSIFICATION FROM AGRICULTURAL (A-5a) TO NEIGHBORHOOD COMMERCIAL (CN-7.5) IN PUUKAPU HOMESTEADS, WAIMEA, SOUTH KOHALA, HAWAII, COVERED BY TAX MAP KEY 6-4-01:PORTION OF 91.

Date Approved: August 9, 1972
Date Effective: August 15, 1972

Copies of the foregoing Ordinance, in full, are on file in the Office of the County Clerk for use and examination by the public.

I hereby certify that the foregoing Ordinance passed second and final reading at the meeting of the County Council on August 9, 1972, by the following aye and no vote:

AYES: Councilmen Carpenter, De Luz, Edwards, Greenwell, Hisaoka, Souza, Yadao, Yamada and Chairman Matayoshi - 9.

NOES: None.



COUNTY CLERK
COUNTY OF HAWAII

7.09, THE KAMUELA ZONE MAP, ORDINANCE NO. 63 (ZONING ORDINANCE), REVISED ORDINANCES OF THE COUNTY OF HAWAII 1967, AS AMENDED, BY CHANGING THE DISTRICT CLASSIFICATION FROM AGRICULTURAL (A-5a) TO NEIGHBORHOOD COMMERCIAL (CN-7.5) IN PUUKAPU HOMESTEADS, WAIMEA, SOUTH KOHALA, HAWAII, COVERED BY TAX MAP KEY 6-4-01:PORTION OF 91.

Date Approved: August 9, 1972
Date Effective: August 15, 1972

Copies of the foregoing Ordinance, in full, are on file in the Office of the County Clerk for use and examination by the public.

I hereby certify that the foregoing Ordinance passed second and final reading at the meeting of the County Council on August 9, 1972, by the following aye and no vote:

AYES: Councilmen Carpenter, De Luz, Edwards, Greenwell, Hisaoka, Souza, Yadao, Yamada and Chairman Matayoshi-9.
NOES: None.

Tadashi Suzuki
COUNTY CLERK
COUNTY OF HAWAII



PLANNING COMMISSION
Planning Department

25 AUPUNI STREET • HILO, HAWAII 93720

SHUNICHI KIMURA
Mayor

COUNTY OF
HAWAII

Chairman

July 14, 1972

Honorable Herbert T. Matayoshi
Chairman, County Council
and Members of the Council
County of Hawaii
Hilo, Hawaii

Re: Rezoning Request - Lydia M. Webster
Tax Map Key 6-4-01: Portion of 91

The Planning Commission, after a duly held public hearing on May 25, 1972, voted to recommend for your approval the proposed Bill to change the district classification from an Agricultural (A-5a) to a Neighborhood Commercial (CN-7.5) zoned district in Puukapu Homesteads, Waimea, South Kohala, Hawaii.

For your favorable consideration, an amendment to Section 7.09 of Ordinance No. 63 is being transmitted.

Mauricio Valera, Jr.
Vice Chairman
For
O. W. Efurud, Jr.
Chairman

lat

Enclosures - 2

cc Lydia M. Webster
Chief Engineer, Public Works
Manager, Water Supply
Dept. of Health

APPROVED:

SHUNICHI KIMURA, MAYOR

COMM. NO. 2045
To: FILE

Tadashi Suzuki
COUNTY CLERK

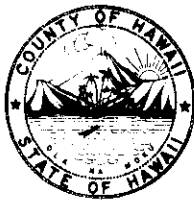

Robert Shioji
DEPUTY COUNTY CLERK

OFFICE OF THE COUNTY CLERK

COUNTY OF HAWAII
HILO, HAWAII 96720

Mayor Shunichi Kimura
County of Hawaii
Hilo, Hawaii

I hereby transmit Ordinance Bill No. 903 passed by
the County Council on second and final reading.

COUNTY CLERK

Encl.

Dated: August 9, 1972