

COUNTY OF HAWAII - STATE OF HAWAII

ORDINANCE NO. 506

AN ORDINANCE AMENDING SECTION 7.02, THE NORTH KONA ZONE MAP, ORDINANCE NO. 63 (ZONING ORDINANCE), REVISED ORDINANCES OF THE COUNTY OF HAWAII 1967, AS AMENDED, BY CHANGING THE DISTRICT CLASSIFICATION FROM AGRICULTURAL (A-20a) TO AGRICULTURAL (A-1a) IN KALAOA 1ST, NORTH KONA, HAWAII, COVERED BY TAX MAP KEY 7-3-02:12.

BE IT ORDAINED BY THE COUNCIL OF THE COUNTY OF HAWAII:

SECTION. Section 7.02 of Ordinance No. 63 (Zoning Ordinance), Revised Ordinances of the County of Hawaii 1967, as amended, is hereby further amended by adding thereto the following subsection:

"7.02 (w). The district classification of the following area situated at Kalaoa 1st, North Kona, Hawaii, shall be Agricultural (A-1a):

Beginning at the northwest corner of this lot and on the mauka side of the old Government road, the coordinates of said point of beginning referred to Government Survey Triangulation Station "MOANUIAHEA" being 3,719.61 feet south and 8,497.08 feet west and running by azimuths measured clockwise from true south:

1. 267^o 27' 30" 1070.16 feet along the south side of a 20-foot road, between this lot and lot No. 41;
2. 0^o 59' 40" 647.52 feet along lot No. 38;
3. 82^o 37' 30" 966.80 feet along the north side of a 20-foot road between this lot and Kalaoa 2;
4. 192^o 49' 50" 294.22 feet along Grant 3159 to Maigret;
5. 82^o 32' 30" 264.94 feet along Grant 3159 to Maigret to the old Government road;
6. 196^o 14' 40" 140.10 feet along the mauka side of the old Government road;
7. 189^o 50' 345.26 feet along the same to the initial point and containing an area of 16.543 acres.

"All as outlined in red on the map attached hereto, marked Exhibit "A" and by reference made a part hereof."

SECTION 2. Section 1 of this ordinance shall take effect forthwith upon the conditions that (A) the area be zoned in two increments. The first increment shall consist of eight (8) lots; the second the remaining lots. The effective date of zoning for the second increment shall be after development has occurred on the first increment. Development is defined as building permits issued for residential dwelling units and construction partially completed - partially completed in the sense of having roofs on two (2) new dwellings in the first increment, and (B) the owner or lessee of the subject area submit a subdivision plan and secure preliminary approval of the first increment within one (1) year from the date of approval of the change of zone request. Should this condition not be met, the Planning Commission shall reserve the right to initiate action to rezone the subject area to its former designation.

SECTION 3. In the event that any portion of this ordinance is declared invalid, such invalidity shall not affect the other parts of this ordinance.

SECTION 4. This ordinance shall take effect upon its approval.

INTRODUCED BY:

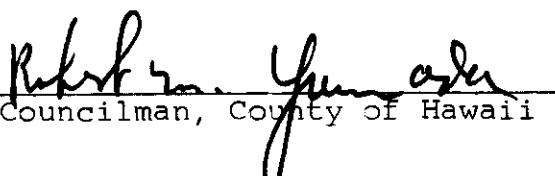
Councilman, County of Hawaii

Hilo, Hawaii

Date of Introduction: July 26, 1972

Date of Adoption: August 9, 1972

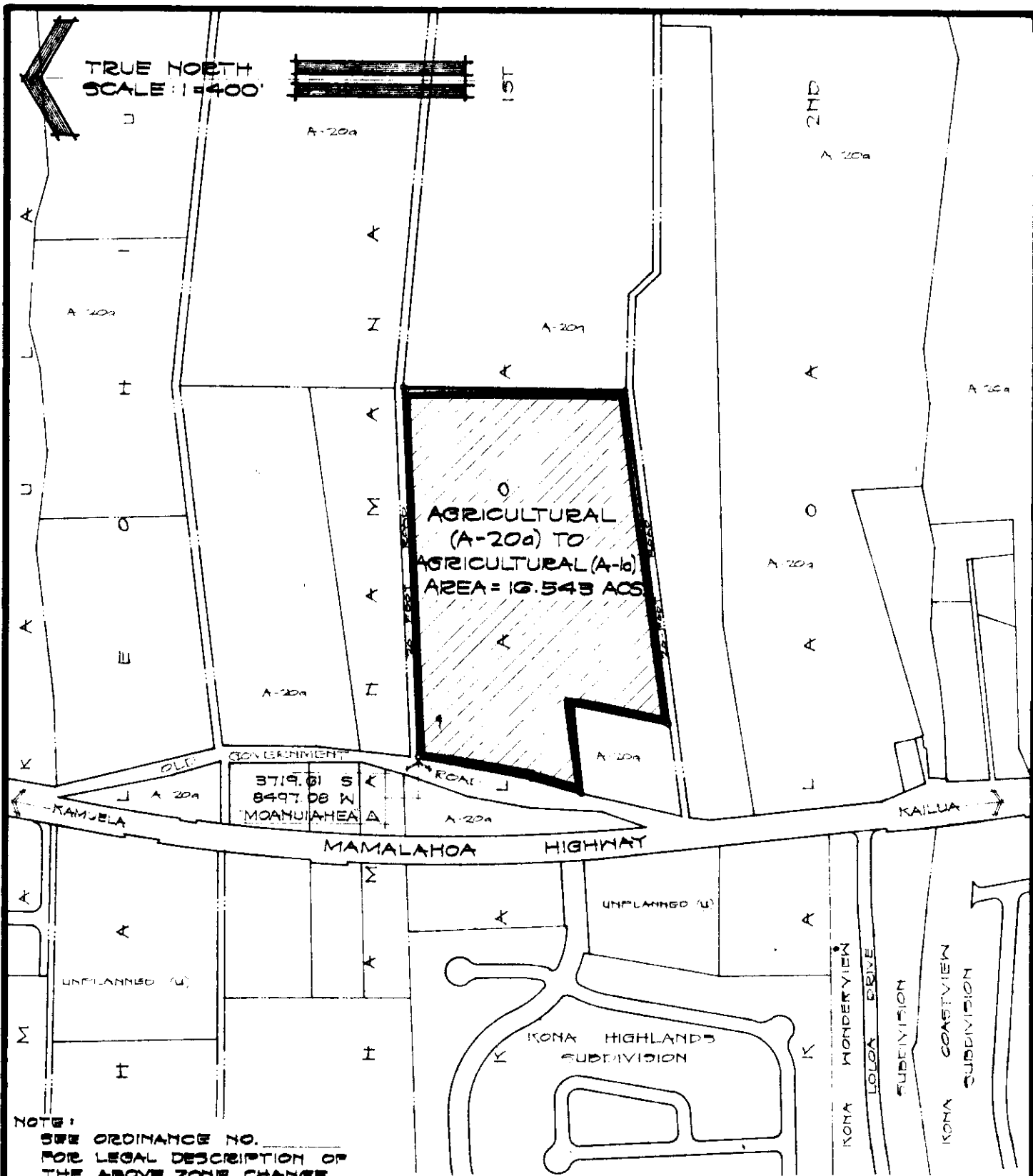

AMENDMENT TO THE COUNTY ZONING ORDINANCE

AMENDMENT NO. 23 OF SECTION 7.02, THE NORTH KONA ZONE MAP, PORTION OF ORD. NO. 74, CHANGING THE DISTRICT CLASSIFICATION FROM AGRICULTURAL (A-20a) TO AGRICULTURAL (A-1a) IN KALAOA FIRST, NORTH KONA, HAWAII.

DATE OF PUBLIC HEARING: JUNE 29, 1972
 DATE OF APPROVAL:
 ORDINANCE NO.
 PREPARED BY: PLANNING DEPARTMENT
 COUNTY OF HAWAII

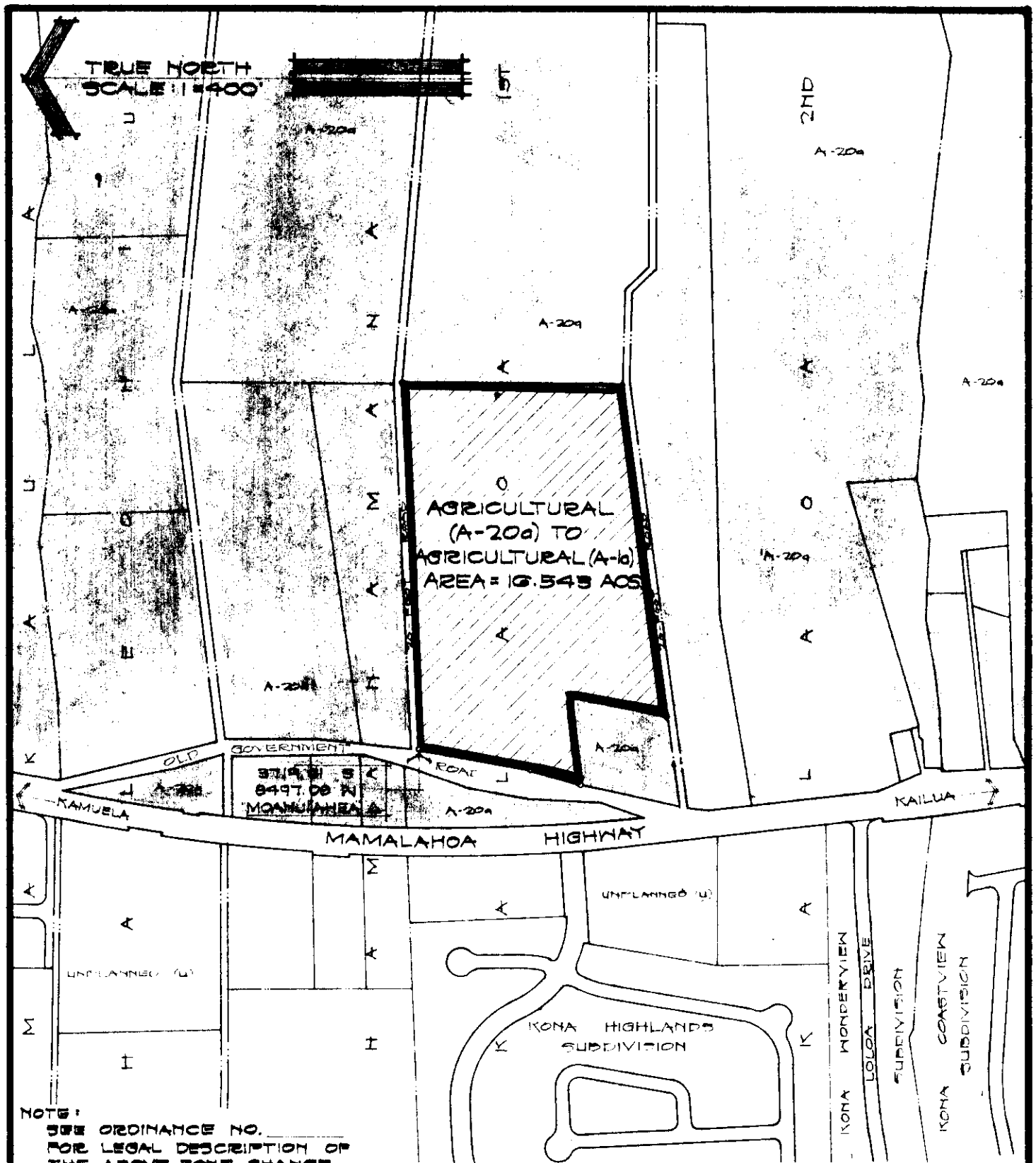

AMENDMENT TO THE COUNTY ZONING ORDINANCE

AMENDMENT NO. 23 OF SECTION 7.02, THE NORTH KONA ZONE MAP, PORTION OF ORD. NO. 74, CHANGING THE DISTRICT CLASSIFICATION FROM AGRICULTURAL (A-20a) TO AGRICULTURAL (A-1a) IN KALAOA FIRST, NORTH KONA, HAWAII.

DATE OF PUBLIC HEARING: JUNE 29, 1972
 DATE OF APPROVAL:
 ORDINANCE NO.
 PREPARED BY: PLANNING DEPARTMENT
 COUNTY OF HAWAII

Hilo, Hawaii
Date: July 26, 1972

FIRST READING			
	AYES	NOES	A/E
Carpenter	X		
De Luz	X		
Edwards	X		
Greenwell	X		
Hisaoka	X		
Souza	X		
Yadao	X		
Yamada	X		
Chr Matayoshi	X		
	9	0	0

Publication Date: July 31, 1972

Hilo, Hawaii
Date: August 9, 1972

SECOND & FINAL READING			
	AYES	NOES	A/E
Carpenter	X		
De Luz	X		
Edwards	X		
Greenwell	X		
Hisaoka	X		
Souza	X		
Yadao	X		
Yamada	X		
Chr Matayoshi	X		
	9	0	0

Publication Date: August 21, 1972

We do hereby certify that the foregoing BILL was adopted by the County Council and published as indicated above.

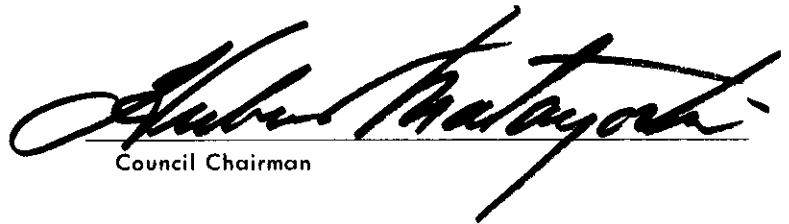
Council Chairman

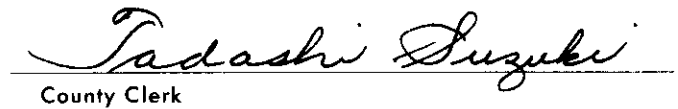
County Clerk

Approved/Disapproved this 15th day of August, 1972

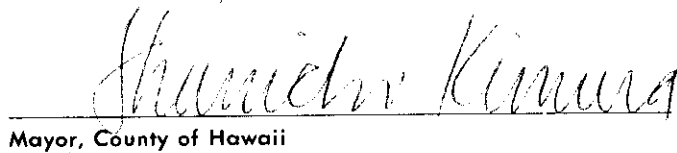
Mayor, County of Hawaii

Bill No. 904
Reference: C-2046/PEDLC-83
M.B. No. 1861-1876
ORD. No. 506

Bill No. 904 - 1972

AN ORDINANCE AMENDING SECTION 7.02, THE NORTH KONA ZONE MAP, ORDINANCE NO. 63 (ZONING ORDINANCE), REVISED ORDINANCES OF THE COUNTY OF HAWAII 1967, AS AMENDED, BY CHANGING THE DISTRICT CLASSIFICATION FROM AGRICULTURAL (A-20a) TO AGRICULTURAL (A-1a) IN KALAOA 1ST, NORTH KONA, HAWAII, COVERED BY TAX MAP KEY 7-3-02:12.

This Bill proposes to amend the North Kona Zone Map by changing the district classification from an agricultural (A-20a) to an agricultural (A-1a) zoned district in Kalaoa 1st, North Kona, Hawaii.

Date Introduced: July 26, 1972

Copies of the foregoing Bill, in full, are on file in the Office of the County Clerk for use and examination by the public.

I hereby certify that the foregoing Bill passed first reading at the meeting of the County Council on July 26, 1972, by the following aye and no vote:

AYES: Councilmen Carpenter, De Luz, Edwards, Greenwell, Hisaoka, Souza, Yadao, Yamada and Chairman Matayoshi - 9.

NOES: None.



COUNTY CLERK
COUNTY OF HAWAII



ORDINANCE NO. 904 (ZONING ORDINANCE), REVISED ORDINANCES OF THE COUNTY OF HAWAII 1967, AS AMENDED, BY CHANGING THE DISTRICT CLASSIFICATION FROM AGRICULTURAL (A-20a) TO AGRICULTURAL (A-1a) IN KALAOA 1ST, NORTH KONA, HAWAII, COVERED BY TAX MAP KEY 7-3-02:12.

This Bill proposes to amend the North Kona Zone Map by changing the district classification from an agricultural (A-20a) to an agricultural (A-1a) zoned district in Kalaoa 1st, North Kona, Hawaii.

Date Introduced: July 26, 1972.
Copies of the foregoing Bill, in full, are on file in the Office of the County Clerk for use and examination by the public.

I hereby certify that the foregoing Bill passed first reading at the meeting of the County Council on July 26, 1972, by the following aye and no vote:

AYES: Councilmen Carpenter, De Luz, Edwards, Greenwell, Hisaoka, Souza, Yadao, Yamada and Chairman Matayoshi - 9.

NOES: None.

Tadashi Suzuki
COUNTY CLERK
COUNTY OF HAWAII

ORDINANCE NO. 506
(Bill No. 904-1972)

AN ORDINANCE AMENDING SECTION 7.02, THE NORTH KONA ZONE MAP, ORDINANCE NO. 63 (ZONING ORDINANCE), REVISED ORDINANCES OF THE COUNTY OF HAWAII 1967, AS AMENDED, BY CHANGING THE DISTRICT CLASSIFICATION FROM AGRICULTURAL (A-20a) TO AGRICULTURAL (A-1a) IN KALAOA 1ST, NORTH KONA, HAWAII, COVERED BY TAX MAP KEY 7-3-02:12.

Date Approved: August 9, 1972
Date Effective: August 15, 1972

Copies of the foregoing Ordinance, in full, are on file in the Office of the County Clerk for use and examination by the public.

I hereby certify that the foregoing Ordinance passed second and final reading at the meeting of the County Council on August 9, 1972, by the following aye and no vote:

AYES: Councilmen Carpenter, De Luz, Edwards, Greenwell, Hisaoka, Souza, Yadao, Yamada and Chairman Matayoshi - 9.

NOES: None.

7.02, THE NORTH KONA ZONE MAP, ORDINANCE NO. 63 (ZONING ORDINANCE), REVISED ORDINANCES OF THE COUNTY OF HAWAII 1967, AS AMENDED, BY CHANGING THE DISTRICT CLASSIFICATION FROM AGRICULTURAL (A-20a) TO AGRICULTURAL (A-1a) IN KALAOA 1ST, NORTH KONA, HAWAII, COVERED BY TAX MAP KEY 7-3-02:12.

Date/Approved: August 9, 1972
Date Effective: August 15, 1972.

Copies of the foregoing Ordinance, in full, are on file in the Office of the County Clerk for use and examination by the public.

I hereby certify that the foregoing Ordinance passed second and final reading at the meeting of the County Council on August 9, 1972, by the following aye and no vote:

AYES: Councilmen Carpenter, De Luz, Edwards, Greenwell, Hisaoka, Souza, Yadao, Yamada and Chairman Matayoshi - 9.

NOES: None

Tadashi Suzuki
COUNTY CLERK
COUNTY OF HAWAII

(145—Hawaii Tribune-Herald,
Aug. 21, 1972.)

Tadashi Suzuki

COUNTY CLERK
COUNTY OF HAWAII



PLANNING COMMISSION
Planning Department

26 AUPUNI STREET • HILO, HAWAII 96720

SHUNICHI KIMURA
Mayor

COUNTY OF
HAWAII

Chairman

July 11, 1972

Honorable Herbert T. Matayoshi
Chairman, County Council
and Members of the Council
County of Hawaii
Hilo, Hawaii

Re: Rezoning Request - S. Kapehe, Et. al.
Tax Map Key 7-3-02:12

The Planning Commission, after a duly held public hearing on June 29, 1972, voted to recommend for your approval the proposed Bill to change the district classification from an Agricultural (A-20a) to an Agricultural (A-1a) zoned district in Kalaoa 1st, North Kona, Hawaii.

For your favorable consideration, an amendment to Section 7.02 of Ordinance No. 63 is being transmitted.

O. W. Efurud, Jr.
Chairman

.lat

Enclosures - 2

cc Louis Rodrigues
S. Kapehe, et al.
Chief Engineer, Public Works
Manager, Water Supply
Department of Health

APPROVED:

SHUNICHI KIMURA
MAYOR

CGMM. NO. 2046
To: PEDLC

Tadashi Suzuki
COUNTY CLERK

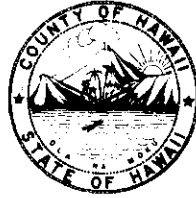

Robert Shioji
DEPUTY COUNTY CLERK

OFFICE OF THE COUNTY CLERK
COUNTY OF HAWAII
HILO, HAWAII 96720

Mayor Shunichi Kimura
County of Hawaii
Hilo, Hawaii

I hereby transmit Ordinance Bill No. 904 passed by
the County Council on second and final reading.

COUNTY CLERK

Encl.

Dated: August 9, 1972

RECEIVED
COUNTY CLERK
AUG 10 1972

AUG 11 1972