

COUNTY OF HAWAII - STATE OF HAWAII

ORDINANCE NO. 508

AN ORDINANCE AMENDING SECTION 7.03, THE SOUTH KONA ZONE MAP, ORDINANCE NO. 63 (ZONING ORDINANCE), REVISED ORDINANCES OF THE COUNTY OF HAWAII 1967, AS AMENDED, BY CHANGING THE DISTRICT CLASSIFICATION FROM AGRICULTURAL (A-20a) TO AGRICULTURAL (A-1a) AT KEALIA 2ND, SOUTH KONA, HAWAII, COVERED BY TAX MAP KEY 8-6-02:33.

BE IT ORDAINED BY THE COUNCIL OF THE COUNTY OF HAWAII:

SECTION 1. Section 7.03 of Ordinance No. 63 (Zoning Ordinance), Revised Ordinances of the County of Hawaii 1967, as amended, is hereby further amended by adding thereto the following subsection:

"7.03 (k). The district classification of the following area situated at Kealia 2nd, North Kona, Hawaii, shall be Agricultural (A-1a):

Beginning at a pipe on the mauka side of Government Main Road, at the southwest corner of this lot, the coordinates of said point of beginning referred to Government Triangulation Station "KANONI" being 12,668.98 south and 13,019.23 east and running by azimuths measured clockwise from true south:

1. 167^o 15' 150.00 feet along mauka side of Government Main Road to a pipe;

2. 259^o 49' 438.53 feet following a stone wall, along the south boundary of Grant 1196 to a pipe marked 96;

Thence along same, the direct azimuths and distances being:

3. 254^o 58' 454.20 feet to a pipe marked 95;

4. 259^o 21' 527.70 feet to a pipe;

5. 347^o 45' 155.50 feet along the remainder of L. C. Aw. 7716:6;

6. 78^o 19' 1420.00 feet along same to the point of beginning and containing an area of 5.00 acres.

"All as outlined in red on the map attached hereto, marked Exhibit "A" and by reference made a part hereof."

SECTION 2. Section 1 of this ordinance shall take effect forthwith upon the condition that the owner or lessee of the subject property submit a subdivision plan and secure preliminary approval within one (1) year from the date of approval of the change of zone request. Should this condition not be met, the Planning Commission shall reserve the right to initiate action to rezone the subject property to its former designation.

SECTION 3. In the event that any portion of this ordinance is declared invalid, such invalidity shall not affect the other parts of this ordinance.

SECTION 4. This ordinance shall take effect upon its approval.

INTRODUCED BY:

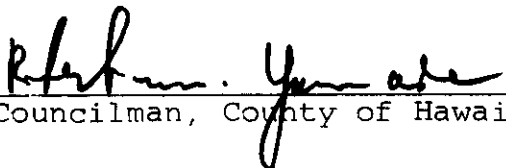

Councilman, County of Hawaii

Hilo, Hawaii

Date of Introduction: July 26, 1972

Date of Adoption: August 9, 1972

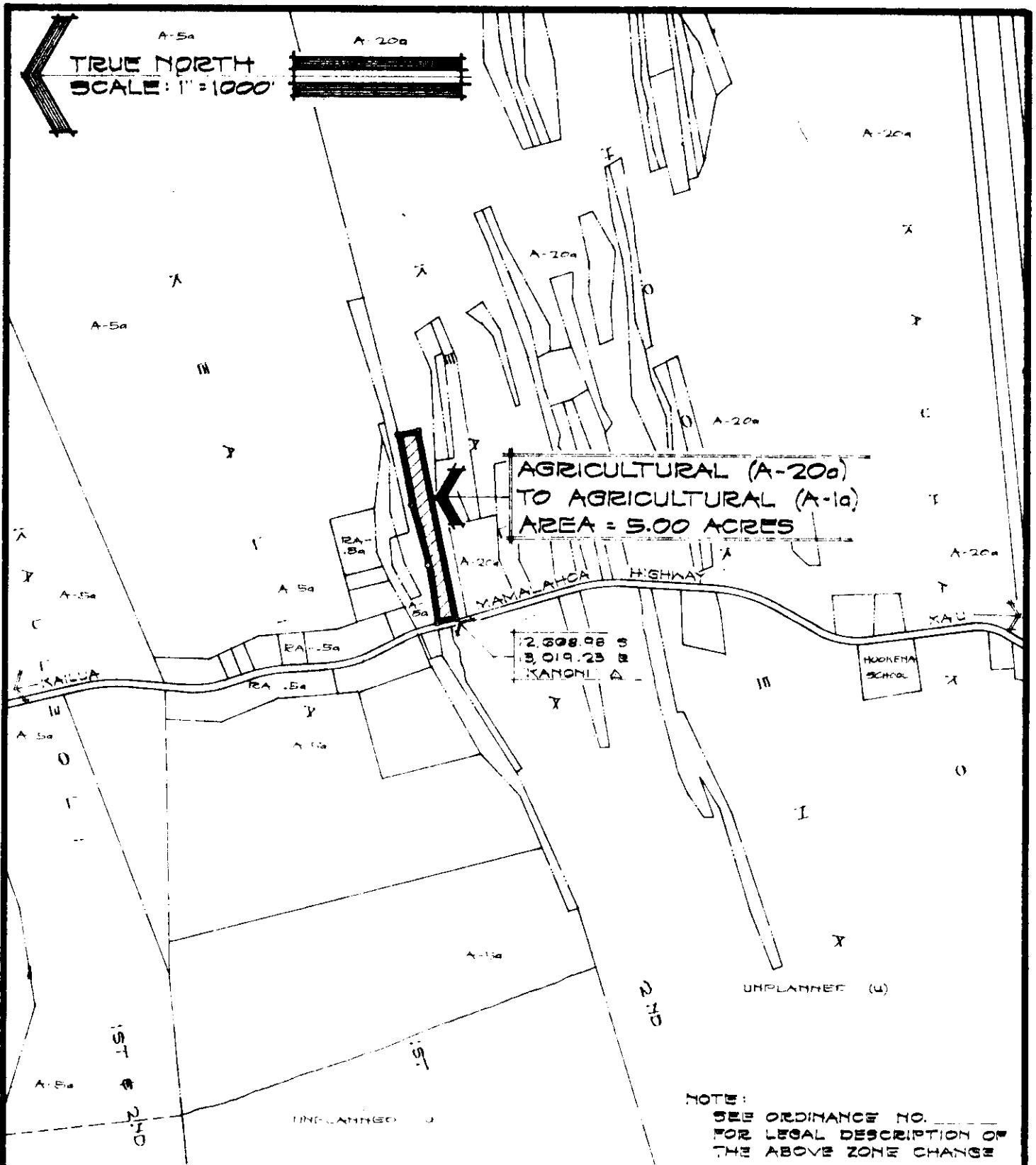

AMENDMENT TO THE COUNTY ZONING ORDINANCE

AMENDMENT NO. 11 OF SECTION 7.03, THE SOUTH KONA ZONE MAP, PORTION OF ORDINANCE NO. 74, CHANGING THE DISTRICT CLASSIFICATION FROM AGRICULTURAL (A-20a) TO AGRICULTURAL (A-1a) AT KEALIA 2ND, SOUTH KONA, HAWAII.

DATE OF PUBLIC HEARING: JUNE 29, 1972
 DATE OF APPROVAL:
 ORDINANCE NO.
 PREPARED BY: PLANNING DEPARTMENT
 COUNTY OF HAWAII

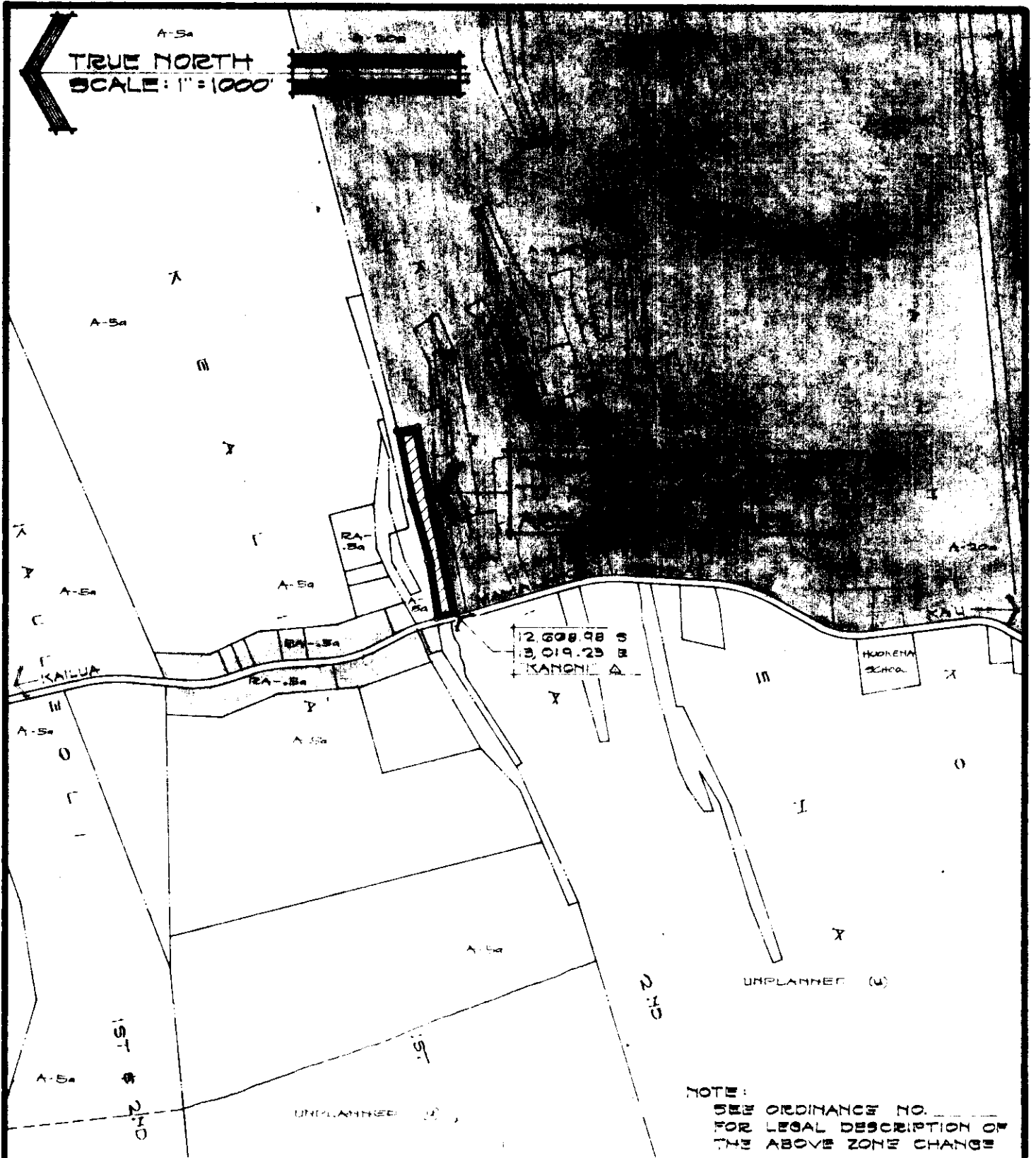

AMENDMENT TO THE COUNTY ZONING ORDINANCE

AMENDMENT NO. 11 OF SECTION 7.03, THE SOUTH KONA ZONE MAP, PORTION OF ORDINANCE NO. 74, CHANGING THE DISTRICT CLASSIFICATION FROM AGRICULTURAL (A-20a) TO AGRICULTURAL (A-1a), AT KEALIA 2ND, SOUTH KONA, HAWAII.

DATE OF PUBLIC HEARING: JUNE 29, 1972
 DATE OF APPROVAL:
 ORDINANCE NO.
 PREPARED BY: PLANNING DEPARTMENT
 COUNTY OF HAWAII

TMK 8-6-02:35

7 JULY 1972

EXHIBIT "A"

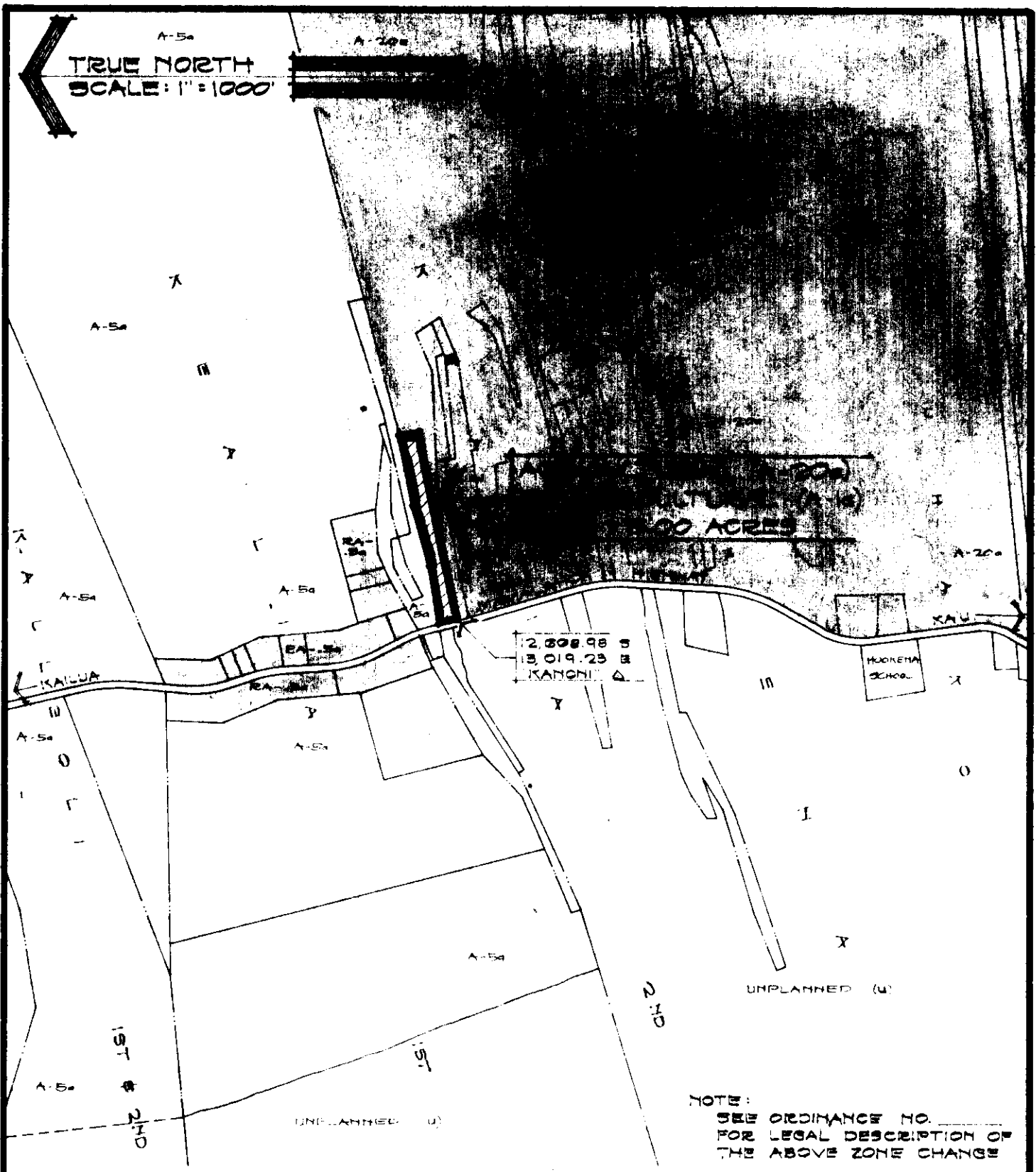

AMENDMENT TO THE COUNTY ZONING ORDINANCE

AMENDMENT NO. 11 OF SECTION 7.03, THE SOUTH KONA ZONE MAP, PORTION OF ORDINANCE NO. 74, CHANGING THE DISTRICT CLASSIFICATION FROM AGRICULTURAL (A-20a) TO AGRICULTURAL (A-1a) AT KEALIA 2ND, SOUTH KONA, HAWAII.

DATE OF PUBLIC HEARING: JUNE 29, 1972
 DATE OF APPROVAL:
 ORDINANCE NO.
 PREPARED BY: PLANNING DEPARTMENT
 COUNTY OF HAWAII

TMK 8-0-02:55

7 JULY 1972

EXHIBIT "A"

Hilo, Hawaii
Date: July 26, 1972

FIRST READING			
	AYES	NOES	A/E
Carpenter	X		
De Luz	X		
Edwards	X		
Greenwell	X		
Hisaoka	X		
Souza	X		
Yadao	X		
Yamada	X		
Chr Matayoshi	X		
	9	0	0

Publication Date: July 31, 1972

Hilo, Hawa
Date: August 9, 1972

SECOND & FINAL READING			
	AYES	NOES	A/E
Carpenter	X		
De Luz	X		
Edwards	X		
Greenwell	X		
Hisaoka	X		
Souza	X		
Yadao	X		
Yamada	X		
Chr Matayoshi	X		
	9	0	0

Publication Date: August 21, 1972

We do hereby certify that the foregoing BILL was adopted by the County Council and published as indicated above.

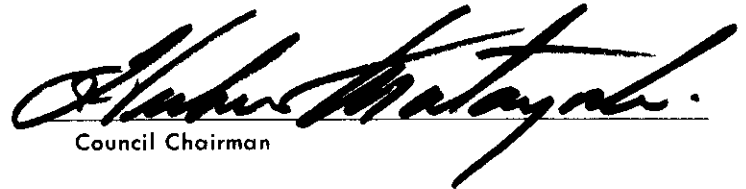
Council Chairman

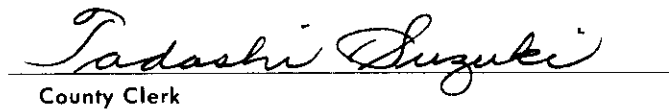
County Clerk

Approved/Disapproved this 15th day of August, 1972

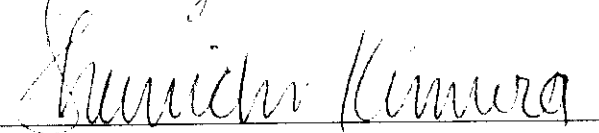
Mayor, County of Hawaii

Bill No. 906
Reference: C-2048/PEDLC-83
M.B. No. 1861, 1897
ORD. ~~NO~~ No. 508

Bill No. 906 - 1972

AN ORDINANCE AMENDING SECTION 7.03, THE SOUTH KONA ZONE MAP, ORDINANCE NO. 63 (ZONING ORDINANCE), REVISED ORDINANCES OF THE COUNTY OF HAWAII 1967, AS AMENDED, BY CHANGING THE DISTRICT CLASSIFICATION FROM AGRICULTURAL (A-20a) TO AGRICULTURAL (A-1a) AT KEALIA 2ND, SOUTH KONA, HAWAII, COVERED BY TAX MAP KEY 8-6-02:33.

This Bill proposes to amend the South Kona Zone Map by changing the district classification from an agricultural (A-20a) to an agricultural (A-1a) zoned district in Kealia 2nd, South Kona, Hawaii.

Date Introduced: July 26, 1972

Copies of the foregoing Bill, in full, are on file in the Office of the County Clerk for use and examination by the public.

I hereby certify that the foregoing Bill passed first reading at the meeting of the County Council on July 26, 1972, by the following aye and no vote:

AYES: Councilmen Carpenter, De Luz, Edwards, Greenwell, Hisaoka, Souza, Yadao, Yamada and Chairman Matayoshi - 9.

NOES: None.

Tadashi Suzuki

COUNTY CLERK
COUNTY OF HAWAII

ORDINANCE NO. 63 (ZONING ORDINANCE), REVISED ORDINANCES OF THE COUNTY OF HAWAII 1967, AS AMENDED, BY CHANGING THE DISTRICT CLASSIFICATION FROM AGRICULTURAL (A-20a) TO AGRICULTURAL (A-1a) AT KEALIA 2ND, SOUTH KONA, HAWAII, COVERED BY TAX MAP KEY 8-6-02:33.

This Bill proposes to amend the South Kona Zone Map by changing the district classification from an agricultural (A-20a) to an agricultural (A-1a) zoned district in Kealia 2nd, South Kona, Hawaii.
Date introduced: July 26, 1972

Copies of the foregoing Bill, in full, are on file in the Office of the County Clerk for use and examination by the public.

I hereby certify that the foregoing Bill passed first reading at the meeting of the County Council on July 26, 1972, by the following aye and no vote:

AYES: Councilmen Carpenter, De Luz, Edwards, Greenwell, Hisaoka, Souza, Yadao, Yamada and Chairman Matayoshi - 9.

NOES: None.

Tadashi Suzuki
COUNTY CLERK
COUNTY OF HAWAII

ORDINANCE NO. 508
(Bill No. 906-1972)

AN ORDINANCE AMENDING SECTION 7.03, THE SOUTH KONA ZONE MAP, ORDINANCE NO. 63 (ZONING ORDINANCE), REVISED ORDINANCES OF THE COUNTY OF HAWAII 1967, AS AMENDED, BY CHANGING THE DISTRICT CLASSIFICATION FROM AGRICULTURAL (A-20a) TO AGRICULTURAL (A-1a) AT KEALIA 2ND, SOUTH KONA, HAWAII, COVERED BY TAX MAP KEY 8-6-02:33.

Date Approved: August 9, 1972
Date Effective: August 15, 1972

Copies of the foregoing Ordinance, in full, are on file in the Office of the County Clerk for use and examination by the public.

I hereby certify that the foregoing Ordinance passed second and final reading at the meeting of the County Council on August 9, 1972, by the following aye and no vote:

AYES: Councilmen Carpenter, De Luz, Edwards, Greenwell, Hisaoka, Souza, Yadao, Yamada and Chairman Matayoshi - 9.

NOES: None.

Tadashi Suzuki

COUNTY CLERK
COUNTY OF HAWAII

ORDINANCE NO. 508
(Bill No. 906-1972)
AN ORDINANCE AMENDING SECTION 7.03, THE SOUTH KONA ZONE MAP, ORDINANCE NO. 63 (ZONING ORDINANCE), REVISED ORDINANCES OF THE COUNTY OF HAWAII 1967, AS AMENDED, BY CHANGING THE DISTRICT CLASSIFICATION FROM AGRICULTURAL (A-20a) TO AGRICULTURAL (A-1a) AT KEALIA 2ND, SOUTH KONA, HAWAII, COVERED BY TAX MAP KEY 8-6-02:33.

Date Approved: August 9, 1972
Date Effective: August 15, 1972

Copies of the foregoing Ordinance, in full, are on file in the Office of the County Clerk for use and examination by the public.

I hereby certify that the foregoing Ordinance passed second and final reading at the meeting of the County Council on August 9, 1972, by the following aye and no vote:

AYES: Councilmen Carpenter, De Luz, Edwards, Greenwell, Hisaoka, Souza, Yadao, Yamada and Chairman Matayoshi - 9.
NOES: None

Tadashi Suzuki
COUNTY CLERK
COUNTY OF HAWAII



PLANNING COMMISSION
Planning Department

25 AUPUNI STREET • HILO, HAWAII 96720

BHUNICHI KIMURA
Mayor

COUNTY OF
HAWAII

Chairman

July 11, 1972

Honorable Herbert T. Matayoshi
Chairman, County Council
and Members of the Council
County of Hawaii
Hilo, Hawaii

Re: Rezoning Request - Candilaria Dinson
Tax Map Key 8-6-02:33

The Planning Commission, after a duly held public hearing on June 29, 1972, voted to recommend for your approval the proposed Bill to change the district classification from an Agricultural (A-20a) to an Agricultural (A-1a) zoned district in Kealia 2nd, South Kona, Hawaii.

For your favorable consideration, an amendment to Section 7.03 of Ordinance No. 63 is being transmitted.

O. W. Efurd, Jr.
Chairman

.lat

Enclosures - 2

cc Candilaria Dinson
Chief Engineer, Public Works
Manager, Water Supply
Department of Health

APPROVED:

SHUNICHI KIMURA
MAYOR

COMM. NO. 2048
To: PEDIC

Tadashi Suzuki
COUNTY CLERK



Robert Shioji
DEPUTY COUNTY CLERK

OFFICE OF THE COUNTY CLERK
COUNTY OF HAWAII
HILO, HAWAII 96720

Mayor Shunichi Kimura
County of Hawaii
Hilo, Hawaii

I hereby transmit Ordinance Bill No. 906 passed by
the County Council on second and final reading.

COUNTY CLERK

Encl.

Dated: August 9, 1972