

COUNTY OF HAWAII - STATE OF HAWAII

ORDINANCE NO. 510

AN ORDINANCE AMENDING SECTION 7.02, THE NORTH KONA ZONE MAP, ORDINANCE NO. 63, (ZONING ORDINANCE), REVISED ORDINANCES OF THE COUNTY OF HAWAII 1967, AS AMENDED, BY CHANGING THE DISTRICT CLASSIFICATION FROM UNPLANNED (U) TO SINGLE FAMILY RESIDENTIAL (RS-15) AT KEAUKOU 2ND, NORTH KONA, HAWAII, COVERED BY TAX MAP KEY 7-8-19:PORTION OF 29.

BE IT ORDAINED BY THE COUNCIL OF THE COUNTY OF HAWAII:

SECTION 1. Section 7.02 of Ordinance No. 63 (Zoning Ordinance), Revised Ordinances of the County of Hawaii 1967, as amended, is hereby further amended by adding thereto the following subsection:

"7.02 (bb) The district classification of the following area situated at Keauhou 2nd, North Kona, Hawaii, shall be single-family residential (RS-15):

Beginning at the northwest corner of this parcel of land, being also the northwest corner of Lot 29 of the B. P. Bishop Estate's Puuloa 1 Subdivision, the coordinates of which referred to Government Survey Triangulation Station "KEAUKOU" being 2169.1 feet south and 664.5 feet east, and thence running by azimuths measured clockwise from true south:

1. 290° 32' 10" 50.00 feet along remainder of R. P. 7844, L. C. Aw. 7715:12 to Lota Kamehameha;
2. 344° 49' 10" 189.21 feet along same;
3. 75° 05' 50" 133.78 feet along same to a pipe in Concrete No. 36;
4. 118° 00' 10" 69.20 feet along remainder of Lot 29, along remainder of R. P. 7844, L. C. Aw. 7715:12 to Lota Kamehameha;

Thence along the southeasterly side of Lot A (Puuloa Road) on a 1447.92 foot radius curve to the left, the chord azimuth and distance being:

5. 204° 56' 58" 222.84 feet to the point of beginning and containing an area of 25,498 square feet.

"All as outlined in red on the map attached hereto, marked Exhibit "A" and by reference made a part hereof."

SECTION 2. In the event that any portion of this ordinance is declared invalid, such invalidity shall not affect the other parts of this ordinance.

SECTION 3. This ordinance shall take effect upon its approval.

INTRODUCED BY:

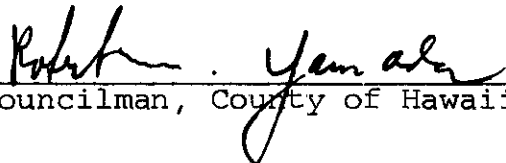

Councilman, County of Hawaii

Hilo, Hawaii

Date of Introduction: August 9, 1972

Date of Adoption: August 23, 1972

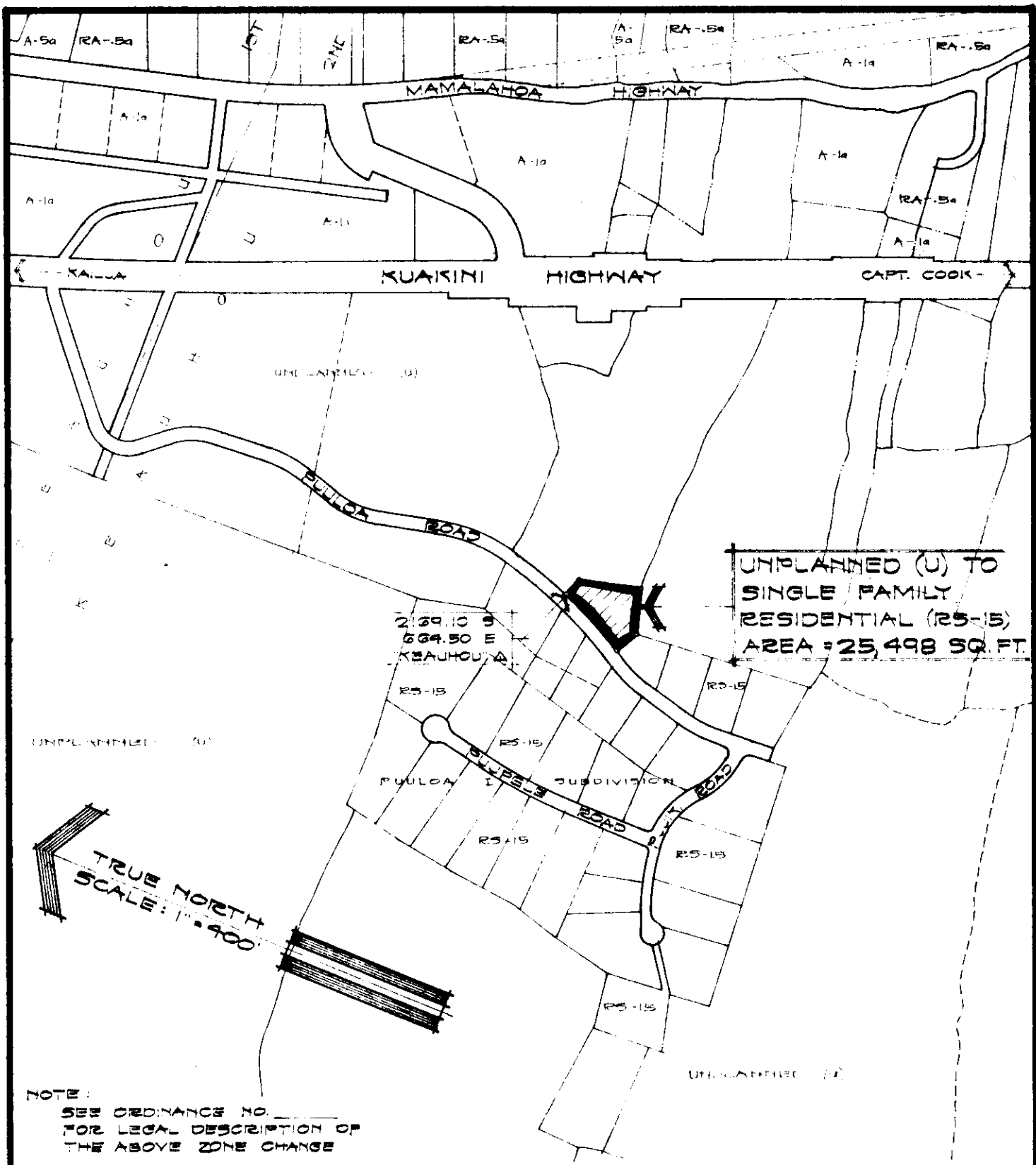

AMENDMENT TO THE COUNTY ZONING ORDINANCE

AMENDMENT NO. 28 OF SECTION 7.02, THE NORTH KONA ZONE MAP, PORTION OF ORDINANCE NO. 74, CHANGING THE DISTRICT CLASSIFICATION FROM UNPLANNED (U) TO SINGLE FAMILY RESIDENTIAL (RS-15) AT KEAUKOU 2ND, NORTH KONA, HAWAII.

DATE OF PUBLIC HEARING: MARCH 24, 1972
 DATE OF APPROVAL:
 ORDINANCE NO.
 PREPARED BY: PLANNING DEPARTMENT
 COUNTY OF HAWAII

Hilo, Hawaii
 Date: August 9, 1972

FIRST READING			
	AYES	NOES	A/E
Carpenter	X		
De Luz	X		
Edwards	X		
Greenwell	X		
Hisaoka	X		
Souza	X		
Yadao	X		
Yamada	X		
Chr Matayoshi	X		
	9	0	0

Publication Date: August 14, 1972

Hilo, Hawa.
 Date: August 23, 1972

SECOND & FINAL READING			
	AYES	NOES	A/E
Carpenter	X		
De Luz	X		
Edwards	X		
Greenwell	X		
Hisaoka	X		
Souza	X		
Yadao	X		
Yamada	X		
Chr Matayoshi	X		
	9	0	0

Publication Date: September 5, 1972

We do hereby certify that the foregoing BILL was adopted by the County Council and published as indicated above.

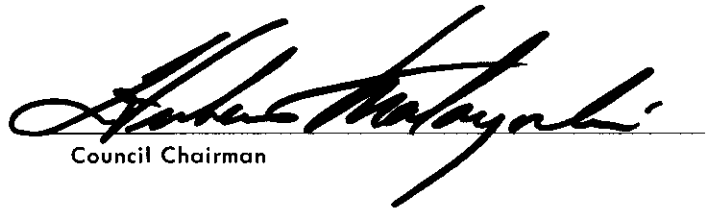
 Council Chairman

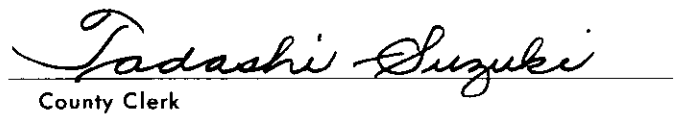
 County Clerk

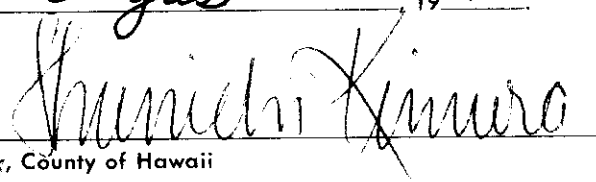
Approved/~~Disapproved~~ this 28th day of
August, 19 72

 Mayor, County of Hawaii

Bill No. 908
 Reference: C-2065/PEDLC-84
 M.B. No. 1592-111
 ORD. ~~NO~~ No. 510

Bill No. 908 - 1972

AN ORDINANCE AMENDING SECTION 7.02, THE NORTH KONA ZONE MAP, ORDINANCE NO. 63, (ZONING ORDINANCE), REVISED ORDINANCES OF THE COUNTY OF HAWAII 1967, AS AMENDED, BY CHANGING THE DISTRICT CLASSIFICATION FROM UNPLANNED (U) TO SINGLE FAMILY RESIDENTIAL (RS-15) AT KEAUHOU 2ND, NORTH KONA, HAWAII, COVERED BY TAX MAP KEY 7-8-19:PORTION OF 29.

This Bill proposes to amend the North Kona Zone Map by changing the district classification of approximately 25,498 square feet of land situated in Keauhou 2nd, North Kona, Hawaii, from an unplanned (U) zoned district to a single-family residential (RS-15) zoned district.

Date Introduced: August 9, 1972

Copies of the foregoing Bill, in full, are on file in the Office of the County Clerk for use and examination by the public.

I hereby certify that the foregoing Bill passed first reading at the meeting of the County Council on August 9, 1972, by the following aye and no vote:

AYES: Councilmen Carpenter, De Luz, Edwards, Greenwell
Hisaoka, Souza, Yadao, Yamada and Chairman Matayoshi - 9.

NOES: None.

ORDINANCE NO. 908 (ZONING ORDINANCE), REVISED ORDINANCES OF THE COUNTY OF HAWAII 1967, AS AMENDED, BY CHANGING THE DISTRICT CLASSIFICATION FROM UNPLANNED (U) TO SINGLE FAMILY RESIDENTIAL (RS-15) AT KEAUHOU 2ND, NORTH KONA, HAWAII, COVERED BY TAX MAP KEY 7-8-19:PORTION OF 29.

This Bill proposes to amend the North Kona Zone Map by changing the district classification of approximately 25,498 square feet of land situated in Keauhou 2nd, North Kona, Hawaii, from an unplanned (U) zoned district to a single-family residential (RS-15) zoned district.

Date Introduced: August 9, 1972

Copies of the foregoing Bill, in full, are on file in the Office of the County Clerk for use and examination by the public.

I hereby certify that the foregoing Bill passed first reading at the meeting of the County Council on August 9, 1972, by the following aye and no vote:

AYES: Councilmen Carpenter, De Luz, Edwards, Greenwell, Hisaoka, Souza, Yadao, Yamada and Chairman Matayoshi—9.

NOES: None.

Tadashi Suzuki
COUNTY CLERK
COUNTY OF HAWAII



COUNTY CLERK
COUNTY OF HAWAII

ORDINANCE NO. 510
(Bill No. 908-1972)

AN ORDINANCE AMENDING SECTION 7.02, THE NORTH KONA ZONE MAP, ORDINANCE NO. 63, (ZONING ORDINANCE), REVISED ORDINANCES OF THE COUNTY OF HAWAII 1967, AS AMENDED, BY CHANGING THE DISTRICT CLASSIFICATION FROM UNPLANNED (U) TO SINGLE FAMILY RESIDENTIAL (RS-15) AT KEAUKOU 2ND, NORTH KONA, HAWAII, COVERED BY TAX MAP KEY 7-8-19:PORTION OF 29.

Date Approved: August 23, 1972
Date Effective: August 28, 1972

Copies of the foregoing Ordinance, in full, are on file in the Office of the County Clerk for use and examination by the public.

I hereby certify that the foregoing Ordinance passed second and final reading at the meeting of the County Council on August 23, 1972, by the following aye and no vote:

AYES: Councilmen Carpenter, De Luz, Edwards, Greenwell, Hisaoka, Souza, Yadao, Yamada and Chairman Matayoshi - 9.

NOES: None.

Tadashi Suzuki

COUNTY CLERK
COUNTY OF HAWAII

AN ORDINANCE AMENDING SECTION 7.02, THE NORTH KONA ZONE MAP, ORDINANCE NO. 63, (ZONING ORDINANCE), REVISED ORDINANCES OF THE COUNTY OF HAWAII 1967, AS AMENDED, BY CHANGING THE DISTRICT CLASSIFICATION FROM UNPLANNED (U) TO SINGLE FAMILY RESIDENTIAL (RS-15) AT KEAUKOU 2ND, NORTH KONA, HAWAII, COVERED BY TAX MAP KEY 7-8-19:PORTION OF 29.

Date Approved: August 23, 1972
Date Effective: August 28, 1972

Copies of the foregoing Ordinance, in full, are on file in the Office of the County Clerk for use and examination by the public.

I hereby certify that the foregoing Ordinance passed second and final reading at the meeting of the County Council on August 23, 1972, by the following aye and no vote:

AYES: Councilmen Carpenter, De Luz, Edwards, Greenwell, Hisaoka, Souza, Yadao, Yamada and Chairman Matayoshi - 9.

NOES: None.
TADASHI SUZUKI
COUNTY CLERK
COUNTY OF HAWAII

COUNTY OF HAWAII
OFFICE OF THE CORPORATION COUNSEL
25 Aupuni Street
Hilo, Hawaii 96720

MEMORANDUM

To: Tadashi Suzuki, County Clerk

Date September 7, 1972

From: Clifford H. F. Lum, Corporation Counsel

Subject: Ordinance No. 510

Ordinance No. 510 as adopted by the County Council contains a typographical error on page 2, second paragraph. Section 4 should read Section 3.

Please make the necessary correction. Thank you.

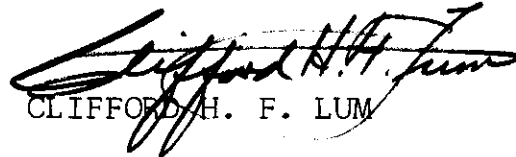

CLIFFORD H. F. LUM

cc: Planning Dept.
Mayor

Note: Please make the correction as noted above. Thank you.

COUNTY CLERK

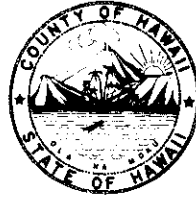
Tadashi Suzuki
COUNTY CLERK



Robert Shioji
DEPUTY COUNTY CLERK

OFFICE OF THE COUNTY CLERK
COUNTY OF HAWAII
HILO, HAWAII 96720

Mayor Shunichi Kimura
County of Hawaii
Hilo, Hawaii

I hereby transmit Ordinance Bill No. 908 passed by
the County Council on second and final reading.

Tadashi Suzuki
COUNTY CLERK

Encl.

Dated: August 23, 1972