

COUNTY OF HAWAII - STATE OF HAWAII

ORDINANCE NO. 533

AN ORDINANCE AMENDING SECTION 7.29, THE CITY OF HILO ZONE MAP, ORDINANCE NO. 63 (ZONING ORDINANCE), REVISED ORDINANCES OF THE COUNTY OF HAWAII 1967, AS AMENDED, BY CHANGING THE DISTRICT CLASSIFICATION FROM OPEN (O) TO LIMITED INDUSTRIAL (ML-20) AT WAIAKEA HOUSELOTS, WAIAKEA, SOUTH HILO, HAWAII, COVERED BY TAX MAP KEY 2-2-35:69.

BE IT ORDAINED BY THE COUNCIL OF THE COUNTY OF HAWAII:

SECTION 1. Section 7.29 of Ordinance No. 63 (Zoning Ordinance), Revised Ordinances of the County of Hawaii 1967, as amended, is hereby further amended by adding thereto the following subsection:

"7.29 (j). The district classification of the following area situated at Waiakea Houselots, Waiakea, South Hilo, Hawaii, shall be Limited Industrial (ML-20):

Beginning at the southwest corner of this lot, the northwest corner of Lot 6, Block 24, and on the east side of Kanoelehua Avenue, said point is located 1363.00 feet South and 11,125.00 feet East from Government Survey Triangulation Station "HALAI," as shown on Government Survey Registered Map 2566, thence from said point of beginning by azimuths (measured clockwise from true South) and distances as follows:

1. 180<sup>o</sup> 00' 100.00 feet along the east side of Kanoelehua Avenue;
2. 270<sup>o</sup> 00' 273.40 feet along Lot 3 (revised), Block 24;
3. 341<sup>o</sup> 00' 105.76 feet along the southwest side of Road Reserve;
4. 90<sup>o</sup> 00' 307.84 feet along Lots 7 and 6, Block 24 to the point of beginning and containing an area of 29,062 square feet, or thereabouts.

"All as outlined in red on the map attached hereto, marked Exhibit "A" and by reference made a part hereof."

SECTION 2. Section 1 of this ordinance shall take effect forthwith upon the conditions that (A) the owner or lessee of the subject property be responsible for securing a building permit and beginning construction of the proposed structure within one (1) year from the date of approval of the change of zone; (B) the proposed building

conform with all pertinent standards of the General Plan document as well as other rules and regulations of the County; and (C) egress and ingress to the subject area be provided which would properly reflect the programmed 4-lane divided highway. Should any of these conditions not be met, action may be taken to rezone the land to an appropriate zoning classification.

SECTION 3. In the event that any portion of this ordinance is declared invalid, such invalidity shall not affect the other parts of this ordinance.

SECTION 4. This ordinance shall take effect upon its approval.

INTRODUCED BY:

  
Councilman, County of Hawaii

Hilo, Hawaii

Date of Introduction: October 11, 1972

Date of Adoption: October 25, 1972



TRUE NORTH  
SCALE: 1" = 200'



ML-20

ML-20

GENERAL LYMAN FIELD

ML-20

ML-20

ML-20

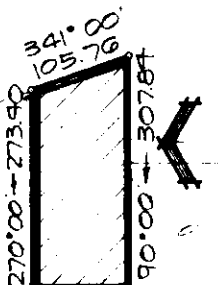

OPEN (O) TO LIMITED  
INDUSTRIAL (ML-20)  
AREA = 29,062 SQ. FT.

ML-20

KAM AVENUE

1563.00 S  
11,125.00 E  
HALAI A

VOLCANO

KANOELEHUA

AVENUE

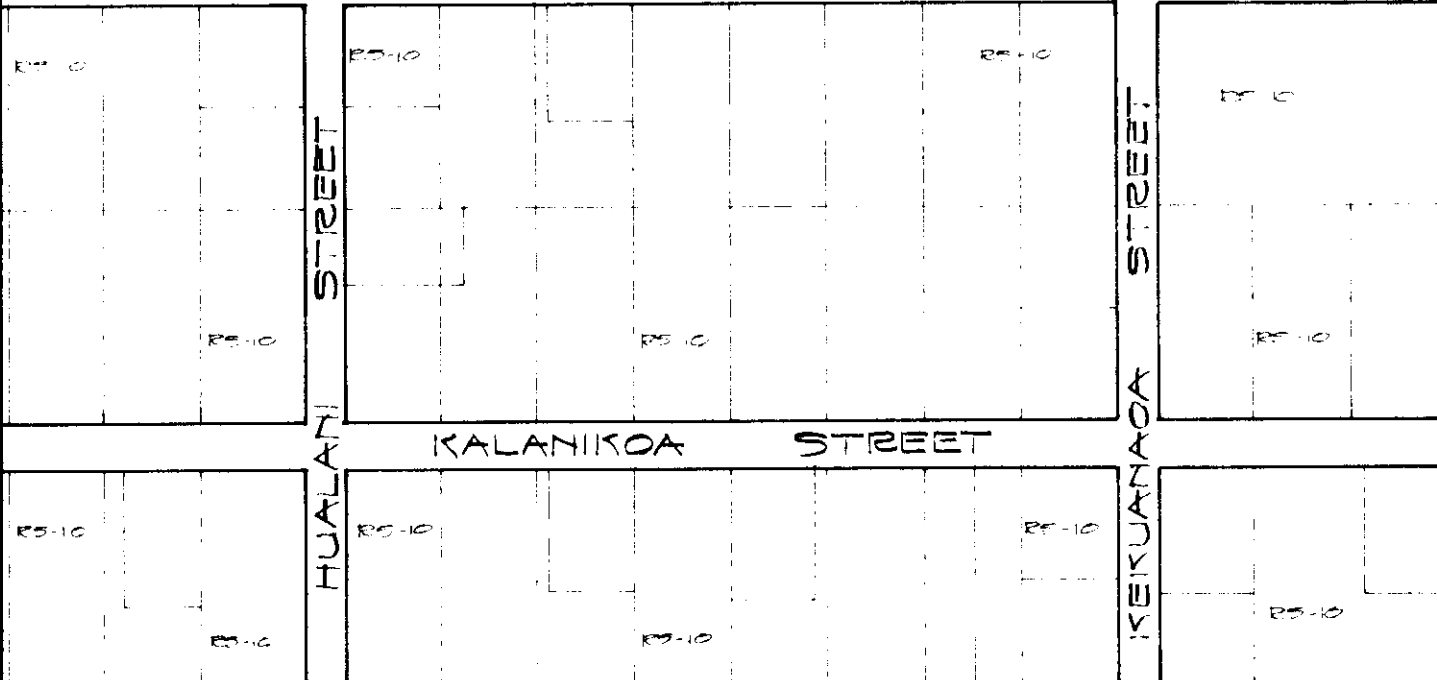

### AMENDMENT TO THE COUNTY ZONING ORDINANCE

AMENDMENT NO. 10 OF SECTION 7.29, THE CITY OF HILO ZONE MAP, PORTION OF ORDINANCE NO. 187, CHANGING THE DISTRICT CLASSIFICATION FROM OPEN (O) TO LIMITED INDUSTRIAL (ML-20) AT WAIAKEA HSELOTS, WAIAKEA SO. HILO, HAWAII.

DATE OF PUBLIC HEARING: SEPT. 14, 1972  
DATE OF APPROVAL:  
ORDINANCE NO.  
PREPARED BY: PLANNING DEPARTMENT  
COUNTY OF HAWAII

TMK 2-2-35:69

30 AUG. 1972

EXHIBIT "A"

ML-20

ETMAN

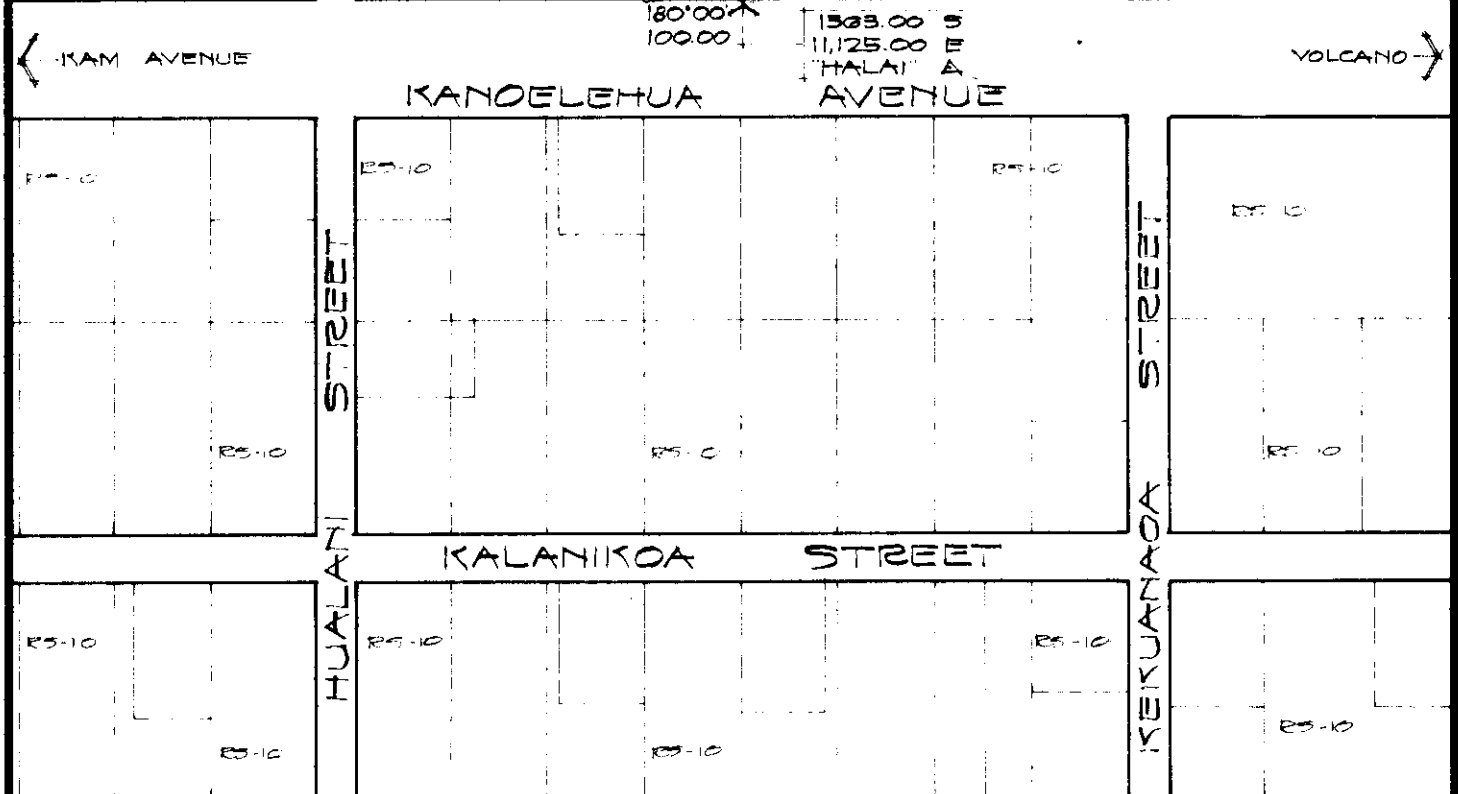

**AMENDMENT TO THE COUNTY ZONING ORDINANCE**

AMENDMENT NO. 10 OF SECTION 7.29, THE CITY OF HILO ZONE MAP, PORTION OF ORDINANCE NO. 187, CHANGING THE DISTRICT CLASSIFICATION FROM OPEN (O) TO LIMITED INDUSTRIAL (ML-20) AT WAIAKEA HSELOTS, WAIAKEA SO. HILO, HAWAII.

DATE OF PUBLIC HEARING : SEPT. 14, 1972  
 DATE OF APPROVAL :  
 ORDINANCE NO.  
 PREPARED BY : PLANNING DEPARTMENT  
 COUNTY OF HAWAII

TMK 2-2-35:69

30 AUG. 1972

EXHIBIT "A"

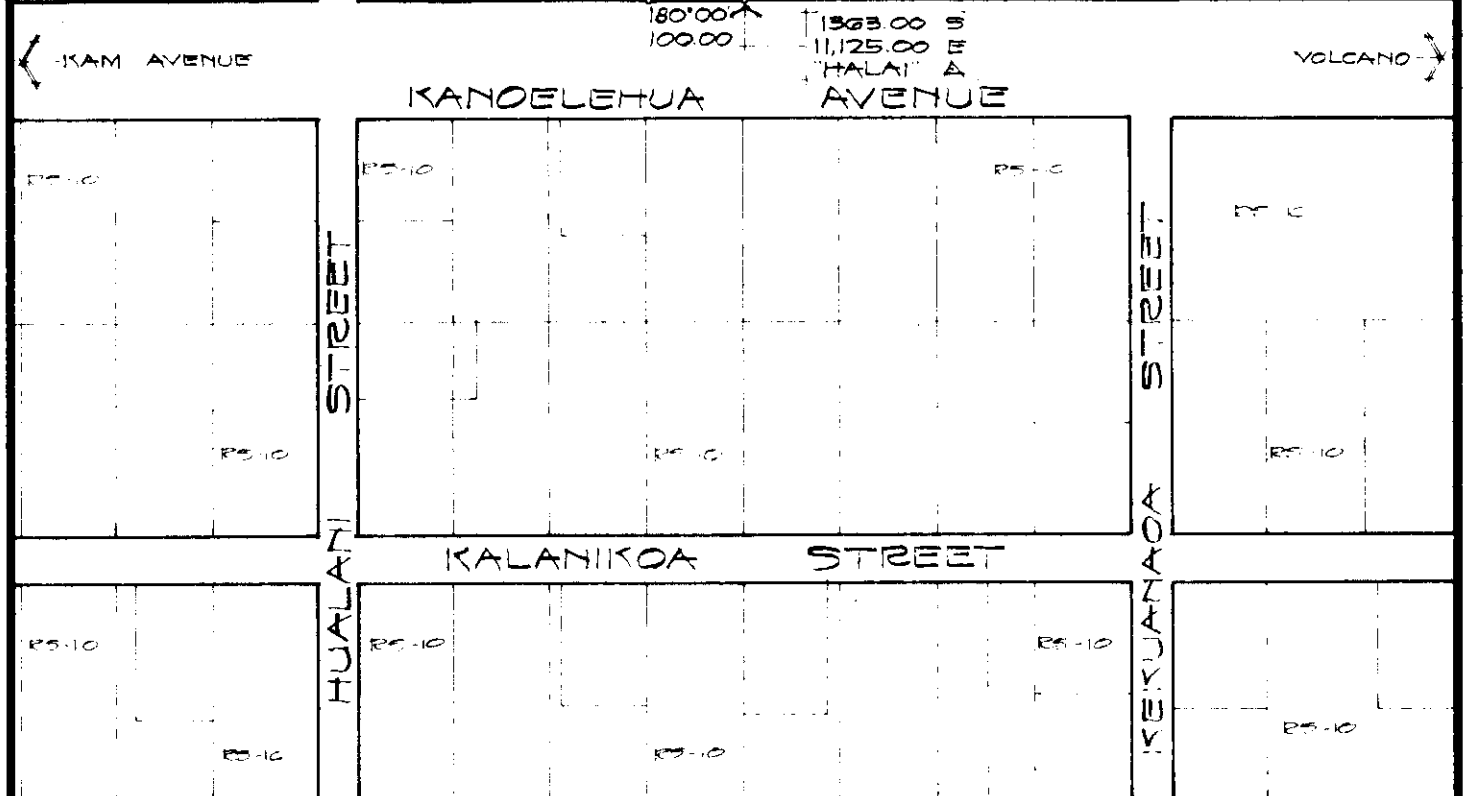
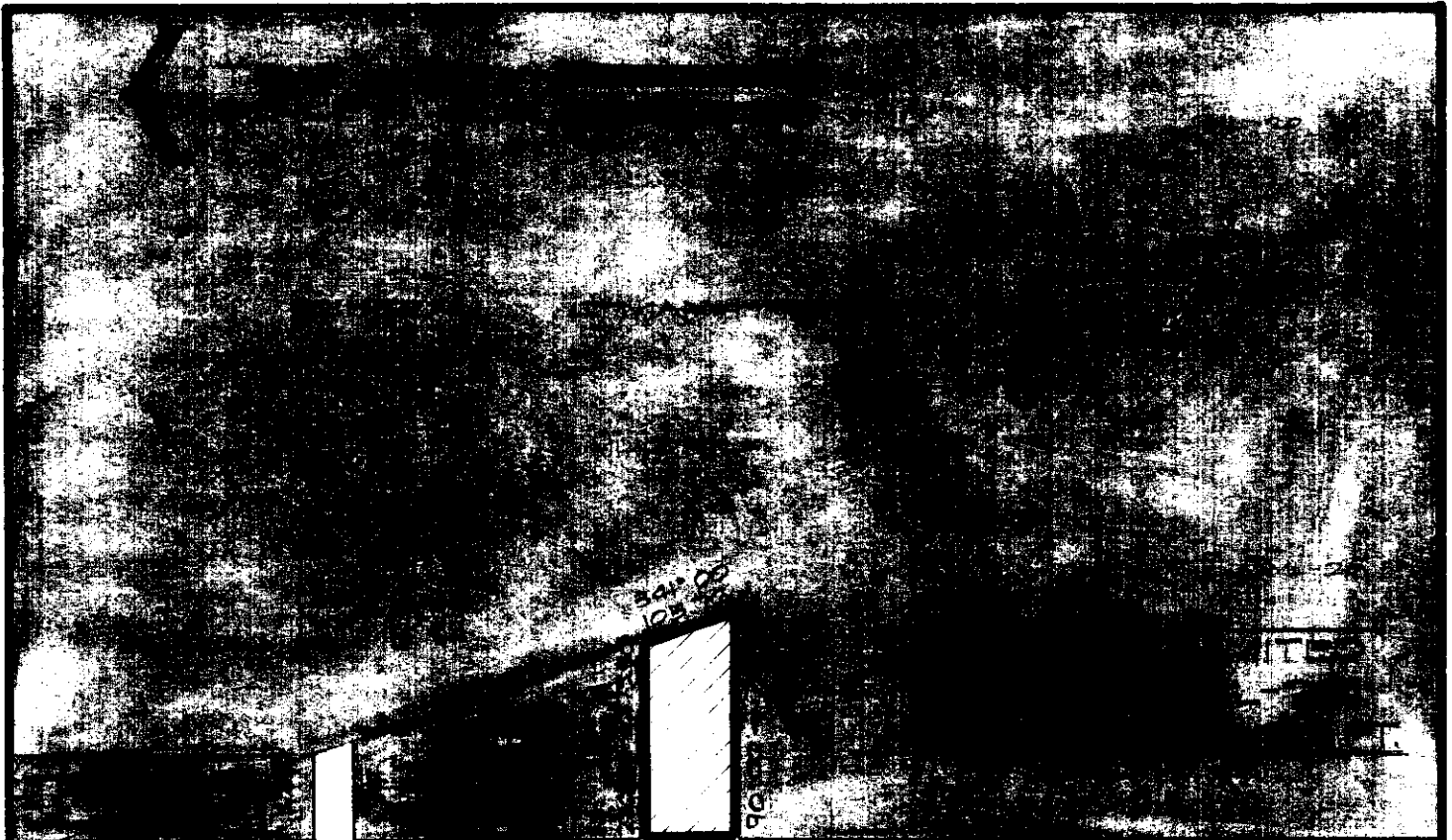

**AMENDMENT TO THE COUNTY ZONING ORDINANCE**

AMENDMENT NO. 10 OF SECTION 7.29, THE CITY OF HILO ZONE MAP, PORTION OF ORDINANCE NO. 187, CHANGING THE DISTRICT CLASSIFICATION FROM OPEN (O) TO LIMITED INDUSTRIAL (ML-20) AT WAIAKEA HSELOTS, WAIAKEA SO. HILO, HAWAII.

DATE OF PUBLIC HEARING : SEPT. 14, 1972  
 DATE OF APPROVAL :  
 ORDINANCE NO.  
 PREPARED BY : PLANNING DEPARTMENT  
 COUNTY OF HAWAII

Hilo, Hawaii

Date: October 11, 1972

FIRST READING			
	AYES	NOES	A/E
Carpenter	X		
De Luz	X		
Edwards	X		
Greenwell	X		
Hisaoka	X		
Souza	X		
Yadao	X		
Yamada	X		
Chr Matayoshi	X		
	9	0	0

Hilo, Haw.

Date: October 25, 1972

SECOND & FINAL READING			
	AYES	NOES	A/E
Carpenter	X		
De Luz	X		
Edwards	X		
Greenwell	X		
Hisaoka	X		
Souza	X		
Yadao	X		
Yamada	X		
Chr Matayoshi	X		
	9	0	0

Publication Date: October 17, 1972

Publication Date: November 7, 1972

We do hereby certify that the foregoing BILL was adopted by the County Council and published as indicated above.

  
 Council Chairman

  
 County Clerk

Approved/~~Disapproved~~ this 2<sup>nd</sup> day of  
November 19 72

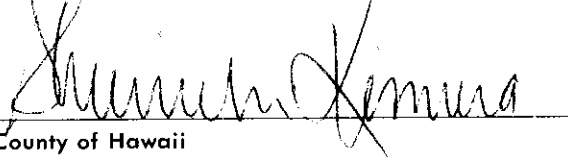
  
 Mayor, County of Hawaii

Bill No. 930  
 Reference: C-2135/PEDLC-88  
 M.B. No. 1995 2024  
543

ORD. No. 543

Bill No. 930 - 1972

AN ORDINANCE AMENDING SECTION 7.29, THE CITY OF HILO ZONE MAP, ORDINANCE NO. 63 (ZONING ORDINANCE), REVISED ORDINANCES OF THE COUNTY OF HAWAII 1967, AS AMENDED, BY CHANGING THE DISTRICT CLASSIFICATION FROM OPEN (O) TO LIMITED INDUSTRIAL (ML-20) AT WAIAKEA HOUSELOTS, WAIAKEA, SOUTH HILO, HAWAII, COVERED BY TAX MAP KEY 2-2-35:69.

This Bill proposes to amend the City of Hilo Zone Map by changing the district classification from open (O) to limited industrial (ML-20) zoned district at Waiakea Houselots, Waiakea, South Hilo, Hawaii.

Date Introduced: October 11, 1972

Copies of the foregoing Bill, in full, are on file in the Office of the County Clerk for use and examination by the public.

---

I hereby certify that the foregoing Bill passed first reading at the meeting of the County Council on October 11, 1972, by the following aye and no vote:

AYES: Councilmen Carpenter, De Luz, Edwards, Greenwell, Hisaoka, Souza, Yadao, Yamada and Chairman Matayoshi - 9.

NOES: None.

  
COUNTY CLERK  
COUNTY OF HAWAII

AN ORDINANCE AMENDING SECTION 7.29, THE CITY OF HILO ZONE MAP, ORDINANCE NO. 63 (ZONING ORDINANCE), REVISED ORDINANCES OF THE COUNTY OF HAWAII 1967, AS AMENDED, BY CHANGING THE DISTRICT CLASSIFICATION FROM OPEN (O) TO LIMITED INDUSTRIAL (ML-20) AT WAIAKEA HOUSELOTS, WAIAKEA, SOUTH HILO, HAWAII, COVERED BY TAX MAP KEY 2-2-35:69.

This Bill proposes to amend the City of Hilo Zone Map by changing the district classification from open (O) to limited industrial (ML-20) zoned district at Waiakea Houselots, Waiakea, South Hilo, Hawaii.

Date Introduced: October 11, 1972  
Copies of the foregoing Bill, in full, are on file in the Office of the County Clerk for use and examination by the public.

I hereby certify that the foregoing Bill passed first reading at the meeting of the County Council on October 11, 1972, by the following aye and no vote:

AYES: Councilmen Carpenter, De Luz, Edwards, Greenwell, Hisaoka, Souza, Yadao, Yamada and Chairman Matayoshi - 9.

NOES: None.

Tadashi Suzuki  
COUNTY CLERK  
COUNTY OF HAWAII

ORDINANCE NO. 533  
(Bill No. 930-1972)

AN ORDINANCE AMENDING SECTION 7.29, THE CITY OF HILO ZONE MAP, ORDINANCE NO. 63 (ZONING ORDINANCE), REVISED ORDINANCES OF THE COUNTY OF HAWAII 1967, AS AMENDED, BY CHANGING THE DISTRICT CLASSIFICATION FROM OPEN (O) TO LIMITED INDUSTRIAL (ML-20) AT WAIAKEA HOUSELOTS, WAIAKEA, SOUTH HILO, HAWAII, COVERED BY TAX MAP KEY 2-2-35:69.

Date Approved: October 25, 1972  
Date Effective: November 2, 1972

Copies of the foregoing Ordinance, in full, are on file in the Office of the County Clerk for use and examination by the public.

---

I hereby certify that the foregoing Ordinance passed second and final reading at the meeting of the County Council on October 25, 1972, by the following ye and no vote:

AYES: Councilmen Carpenter, De Luz, Edwards, Greenwell, Hisaoka, Souza, Yadao, Yamada and Chairman Matayoshi - 9.

NOES: None.

*Tadashi Suzuki*

COUNTY CLERK  
COUNTY OF HAWAII

AN ORDINANCE AMENDING SECTION 7.29, THE CITY OF HILO ZONE MAP, ORDINANCE NO. 63 (ZONING ORDINANCE), REVISED ORDINANCES OF THE COUNTY OF HAWAII 1967, AS AMENDED, BY CHANGING THE DISTRICT CLASSIFICATION FROM OPEN (O) TO LIMITED INDUSTRIAL (ML-20) AT WAIAKEA HOUSELOTS, WAIAKEA, SOUTH HILO, HAWAII, COVERED BY TAX MAP KEY 2-2-35:69.

Date Approved: October 25, 1972  
Date Effective: November 2, 1972

Copies of the foregoing Ordinance, in full, are on file in the Office of the County Clerk for use and examination by the public.

I hereby certify that the foregoing Ordinance passed second and final reading at the meeting of the County Council on October 25, 1972, by the following ye and no vote:

AYES: Councilmen Carpenter, De Luz, Edwards, Greenwell, Hisaoka, Souza, Yadao, Yamada and Chairman Matayoshi - 9.  
NOES: None.

Tadashi Suzuki  
COUNTY CLERK  
COUNTY OF HAWAII



Tadashi Suzuki  
COUNTY CLERK



Robert Shioji  
DEPUTY COUNTY CLERK

**OFFICE OF THE COUNTY CLERK**  
COUNTY OF HAWAII  
HILO, HAWAII 96720

Mayor Shunichi Kimura  
County of Hawaii  
Hilo, Hawaii

I hereby transmit Ordinance Bill No. 930 passed by  
the County Council on second and final reading.

*Tadashi Suzuki*

COUNTY CLERK

Encl.

Dated: October 25, 1972