

COUNTY OF HAWAII - STATE OF HAWAII

ORDINANCE NO. 539

AN ORDINANCE AMENDING SECTION 7.29, THE CITY OF HILO ZONE MAP, ORDINANCE NO. 63 (ZONING ORDINANCE), REVISED ORDINANCES OF THE COUNTY OF HAWAII 1967, AS AMENDED, BY CHANGING THE DISTRICT CLASSIFICATION FROM UNPLANNED (U) TO LIMITED INDUSTRIAL (ML-20) IN WAIAKEA, SOUTH HILO, HAWAII, COVERED BY TAX MAP KEY 2-1-12:PORTION OF 1 AND 3.

BE IT ORDAINED BY THE COUNCIL OF THE COUNTY OF HAWAII:

SECTION 1. Section 7.29 of Ordinance No. 63 (Zoning Ordinance), Revised Ordinances of the County of Hawaii 1967, as amended, is hereby further amended by adding thereto the following subsection:

"7.29 (k). The district classification of the following area situated at Waiakea, South Hilo, Hawaii, shall be Limited Industrial (ML-20):

Beginning at the northwest corner of this parcel of land, on the southwest corner of Parcel 2, Addition to General Lyman Field (Extension to Runway 8-26), Governor's Executive Order 2134, the coordinates of said point of beginning referred to Government Survey Triangulation Station "HALAI" being 488.32 feet North and 18,063.89 feet East, as shown on Government Survey Registered H. T. S. Plat 919-B, thence running by azimuth measured clockwise from True South:

1. 266<sup>o</sup> 19' 4561.38 feet along Parcel 2, Addition to General Lyman Field (Extension to Runway 8-26), Governor's Executive Order 2134 and along Parcel 1-B;
2. 324<sup>o</sup> 49' 958.70 feet along Lot 47-D-3-B (Map 13) of Land Court Application 433;
3. 9<sup>o</sup> 57' 30" 1696.70 feet along Lot 47-D-3-B (Map 13) of Land Court Application 433;
4. 90<sup>o</sup> 00' 4931.77 feet along the remainder of Government Land and along the Hawaii National Guard Site, Governor's Executive Order 1562;
5. 180<sup>o</sup> 00' 900.00 feet along the Hawaii National Guard Site, Governor's Executive Order 1562;
6. 116<sup>o</sup> 33' 54" 447.21 feet along the Hawaii National Guard Site, Governor's Executive Order 1562;

- 7. 90° 00' 600.00 feet along the Hawaii National Guard Site, Governor's Executive Order 1562;
- 8. 179° 58' 30" 918.38 feet along Parcel "A," General Lyman Field, Governor's Executive Order 1519;
- 9. 269° 56' 30" 768.34 feet along Parcel "A," General Lyman Field, Governor's Executive Order 1919;
- 10. 267° 50' 234.89 feet along Parcel "A," General Lyman Field, Governor's Executive Order 1519;

Thence along Parcel "A," General Lyman Field, Governor's Executive Order 1519, on a curve to the left with a radius of 100.00 feet, the chord azimuth and distance being:

- 11. 235° 05' 108.20 feet;
- 12. 202° 20' 77.50 feet along Parcel "A," General Lyman Field, Governor's Executive Order 1519, to the point of beginning and containing an area of 289.501 acres.

All as outlined in red on the map attached hereto, marked Exhibit "A" and by reference made a part hereof."

SECTION 2. Section 1 of this ordinance shall take effect forthwith upon the condition that construction of the proposed facilities begin within one (1) year from the date of approval of the change of zone. Should this condition not be met, action may be taken to rezone the land to a more appropriate zoning classification.

SECTION 3. In the event that any portion of this ordinance is declared invalid, such invalidity shall not affect the other parts of this ordinance.

SECTION 4. This ordinance shall take effect upon its approval.

INTRODUCED BY:

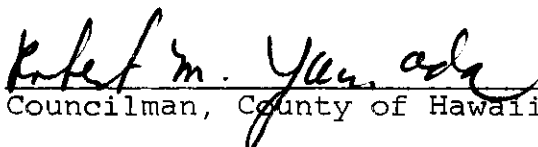
  
 Councilman, County of Hawaii

Hilo, Hawaii

Date of Introduction: October 25, 1972

Date of Adoption: November 9, 1972

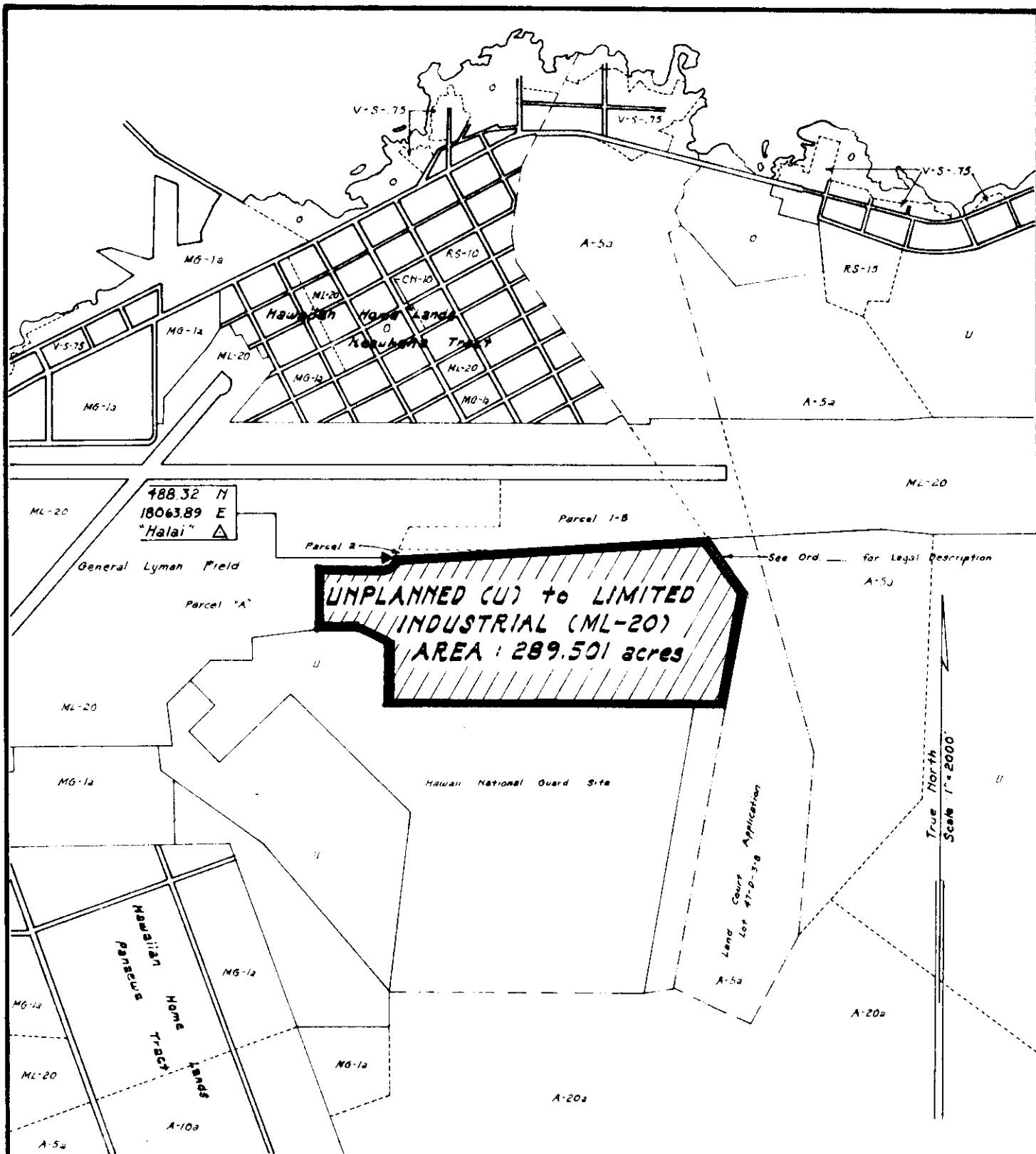

# AMENDMENT to the COUNTY ZONING ORDINANCE

Amendment No. 11 of Section 7.29, the CITY OF HILO ZONE MAP, portion of Ordinance No. 187, changing the district classification from UNPLANNED (U) to LIMITED INDUSTRIAL (ML-20) in Waiakea, South Hilo, Hawaii.

Date of Public Hearing: Sept. 14, 1972

Date of Approval:

Ordinance No.

Prepared by: Planning Dept.  
County of Hawaii

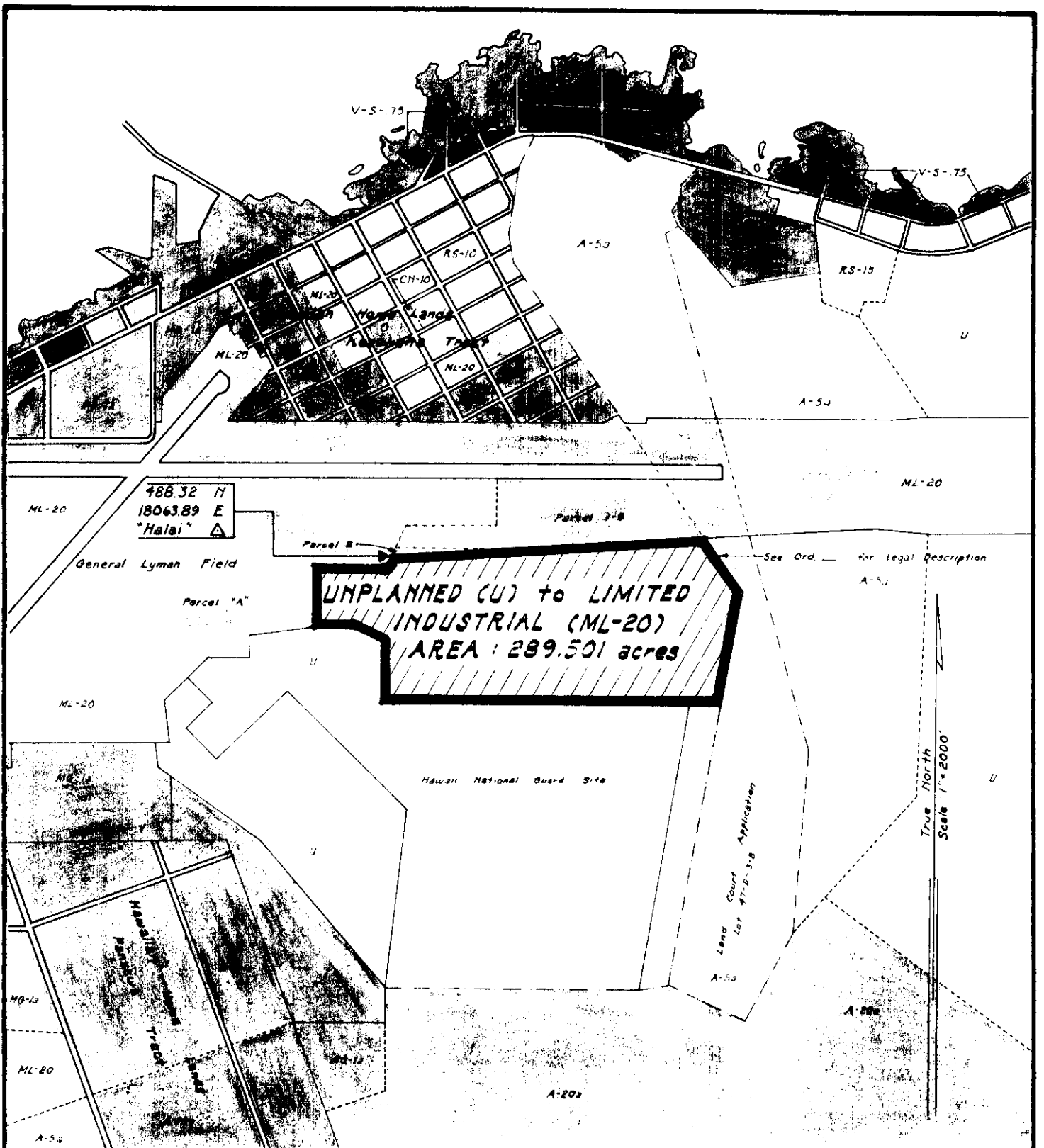

# AMENDMENT to the COUNTY ZONING ORDINANCE

Amendment No. 11 of Section 7.29, the CITY OF HILO ZONE MAP, portion of Ordinance No. 187, changing the district classification from UNPLANNED (U) to LIMITED INDUSTRIAL (ML-20) in Waiakea, South Hilo, Hawaii.

Date of Public Hearing: Sept. 14, 1972

Date of Approval:

Ordinance No.

Prepared by: Planning Dept.  
County of Hawaii

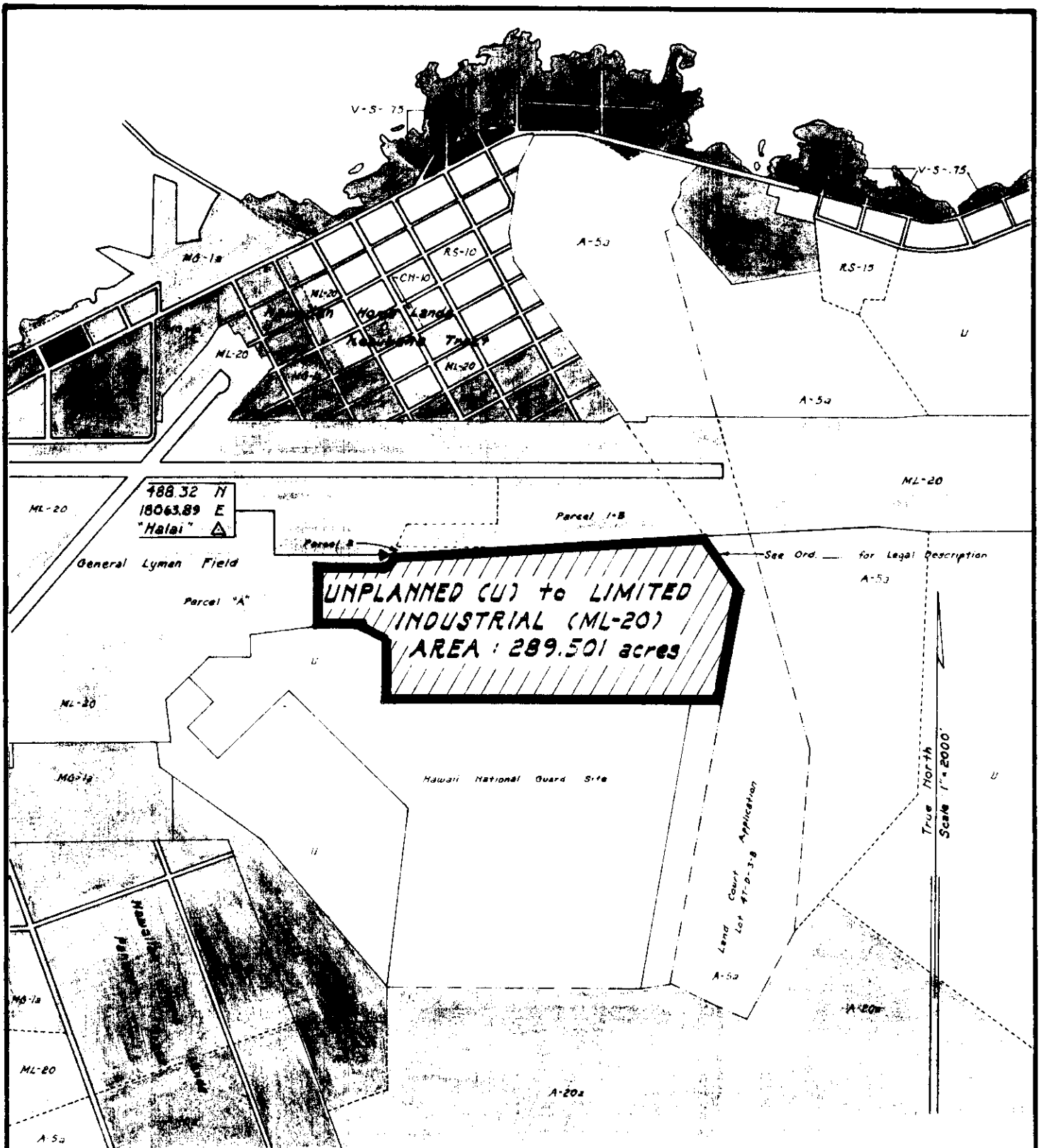

## AMENDMENT to the COUNTY ZONING ORDINANCE

Amendment No. 11 of Section 7.29, the CITY OF HILO ZONE MAP, portion of Ordinance No. 187, changing the district classification from UNPLANNED (U) to LIMITED INDUSTRIAL (ML-20) in Waiakea, South Hilo, Hawaii.

Date of Public Hearing: Sept. 14, 1972

Date of Approval:

Ordinance No.

Prepared by: Planning Dept.  
County of Hawaii

Hilo, Hawaii

Date: October 25, 1972

FIRST READING			
	AYES	NOES	A/E
Carpenter	X		
De Luz	X		
Edwards	X		
Greenwell	X		
Hisaoka	X		
Souza	X		
Yadao	X		
Yamada	X		
Chr Matayoshi	X		
	9	0	0

Publication Date: October 30, 1972

Hilo, Hawaii

Date: November 9, 1972

SECOND & FINAL READING			
	AYES	NOES	A/E
Carpenter	X		
De Luz	X		
Edwards	X		
Greenwell	X		
Hisaoka	X		
Souza	X		
Yadao	X		
Yamada	X		
Chr Matayoshi	X		
	9	0	0

Publication Date: November 20, 1972

We do hereby certify that the foregoing BILL was adopted by the County Council and published as indicated above.

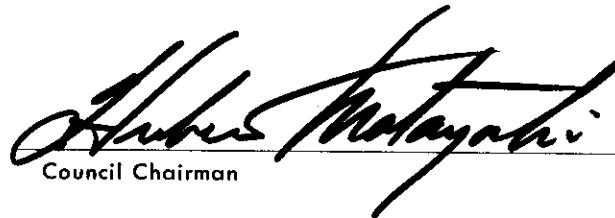
  
 Council Chairman

  
 County Clerk

Approved/Disapproved this 14th day of  
November, 1972.

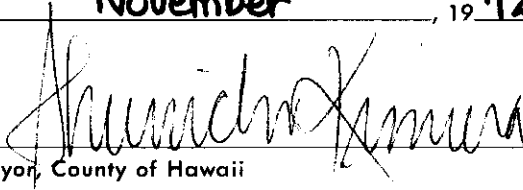
  
 Mayor, County of Hawaii

Bill No. 937  
 Reference: C-2151/PEDLC-89  
 M.B. No. 2014  
 ORD. No. 539

Bill No. 937 - 1972

AN ORDINANCE AMENDING SECTION 7.29, THE CITY OF HILO ZONE MAP, ORDINANCE NO. 63 (ZONING ORDINANCE), REVISED ORDINANCES OF THE COUNTY OF HAWAII 1967, AS AMENDED, BY CHANGING THE DISTRICT CLASSIFICATION FROM UNPLANNED (U) TO LIMITED INDUSTRIAL (ML-20) IN WAIAKEA, SOUTH HILO, HAWAII, COVERED BY TAX MAP KEY 2-1-12: PORTION OF 1 AND 3.

This Bill proposes to amend the City of Hilo Zone Map by changing the district classification of land from an unplanned (U) to a limited industrial (ML-20) zoned district in Waiakea, South Hilo, Hawaii.

Date Introduced: October 25, 1972

Copies of the foregoing Bill, in full, are on file in the Office of the County Clerk for use and examination by the public.

---

I hereby certify that the foregoing Bill passed first reading at the meeting of the County Council on October 25, 1972, by the following aye and no vote:

AYES: Councilmen Carpenter, De Luz, Edwards, Greenwell, Hisaoka, Souza, Yadao, Yamada and Chairman Matayoshi - 9.

NOES: None.

ORDINANCE NO. 63 (ZONING ORDINANCE), REVISED ORDINANCES OF THE COUNTY OF HAWAII 1967, AS AMENDED, BY CHANGING THE DISTRICT CLASSIFICATION FROM UNPLANNED (U) TO LIMITED INDUSTRIAL (ML-20) IN WAIAKEA, SOUTH HILO, HAWAII, COVERED BY TAX MAP KEY 2-1-12: PORTION OF 1 AND 3.

This Bill proposes to amend the City of Hilo Zone Map by changing the district classification of land from an unplanned (U) to a limited industrial (ML-20) zoned district in Waiakea, South Hilo, Hawaii.

Date Introduced: October 25, 1972

Copies of the foregoing Bill, in full, are on file in the Office of the County Clerk for use and examination by the public.

I hereby certify that the foregoing Bill passed first reading at the meeting of the County Council on October 25, 1972, by the following aye and no vote:

AYES: Councilmen Carpenter, De Luz, Edwards, Greenwell, Hisaoka, Souza, Yadao, Yamada and Chairman Matayoshi - 9.

NOES: None.

Tadashi Suzuki  
COUNTY CLERK  
COUNTY OF HAWAII

1913—Honolulu Tribune-Herald:  
Oct. 30, 1972

*Tadashi Suzuki*  
COUNTY CLERK  
COUNTY OF HAWAII

ORDINANCE NO. 539  
(Bill No. 937-1972)

AN ORDINANCE AMENDING SECTION 7.29, THE CITY OF HILO ZONE MAP, ORDINANCE NO. 63 (ZONING ORDINANCE), REVISED ORDINANCES OF THE COUNTY OF HAWAII 1967, AS AMENDED, BY CHANGING THE DISTRICT CLASSIFICATION FROM UNPLANNED (U) TO LIMITED INDUSTRIAL (ML-20) IN WAIAKEA, SOUTH HILO, HAWAII, COVERED BY TAX MAP KEY 2-1-12: PORTION OF 1 AND 3.

Date Approved: November 9, 1972  
Date Effective: November 14, 1972

Copies of the foregoing Ordinance, in full, are on file in the Office of the County Clerk for use and examination by the public.

---

I hereby certify that the foregoing Ordinance passed second and final reading at the meeting of the County Council on November 9, 1972, by the following aye and no vote:

AYES: Councilmen Carpenter, De Luz, Edwards, Greenwell, Hisaoka, Souza, Yadao, Yamada and Chairman Matayoshi - 9.

NOES: None.

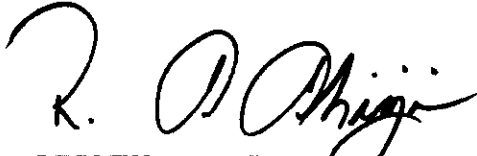
  
DEPUTY COUNTY CLERK  
COUNTY OF HAWAII

7.29. THE CITY OF HILO ZONE MAP, ORDINANCE NO. 63 (ZONING ORDINANCE), REVISED ORDINANCES OF THE COUNTY OF HAWAII 1967, AS AMENDED, BY CHANGING THE DISTRICT CLASSIFICATION FROM UNPLANNED (U) TO LIMITED INDUSTRIAL (ML-20) IN WAIAKEA, SOUTH HILO, HAWAII, COVERED BY TAX MAP KEY 2-1-12: PORTION OF 1 AND 3.

Date Approved: November 9, 1972  
Date Effective: November 14, 1972  
Copies of the foregoing Ordinance, in full, are on file in the Office of the County Clerk for use and examination by the public.

I hereby certify that the foregoing Ordinance passed second and final reading at the meeting of the County Council on November 9, 1972, by the following aye and no vote:

AYES: Councilmen Carpenter, De Luz, Edwards, Greenwell, Hisaoka, Souza, Yadao, Yamada and Chairman Matayoshi - 9.

NOES: None.  
R. S. SHIOJI  
DEPUTY COUNTY CLERK  
COUNTY OF HAWAII



Tadashi Suzuki  
COUNTY CLERK

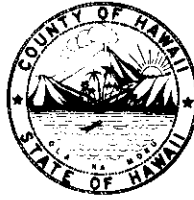

Robert Shioji  
DEPUTY COUNTY CLERK

**OFFICE OF THE COUNTY CLERK**  
COUNTY OF HAWAII  
HILO, HAWAII 96720

Mayor Shunichi Kimura  
County of Hawaii  
Hilo, Hawaii

I hereby transmit Ordinance Bill No. 937 passed by  
the County Council on second and final reading.

*Tadashi Suzuki*

COUNTY CLERK

Encl.

Dated: November 10, 1972