

COUNTY OF HAWAII - STATE OF HAWAII

ORDINANCE NO. 512

AN ORDINANCE AMENDING SECTION 7.09, THE KAMUELA ZONE MAP, ORDINANCE NO. 63 (ZONING ORDINANCE), REVISED ORDINANCES OF THE COUNTY OF HAWAII 1967, AS AMENDED, BY CHANGING THE DISTRICT CLASSIFICATION FROM AGRICULTURAL (A-40a) TO AGRICULTURAL (A-3a) AT PUUKAPU HOMESTEADS, 2ND SERIES, SOUTH KOHALA, HAWAII, COVERED BY TAX MAP KEY 6-4-02:132.

BE IT ORDAINED BY THE COUNCIL OF THE COUNTY OF HAWAII:

SECTION 1. Section 7.09 of Ordinance No. 63 (Zoning Ordinance), Revised Ordinances of the County of Hawaii 1967, as amended, is hereby further amended by adding thereto the following subsection:

"7.09 (f). The district classification of the following area situated at Puukapu Homesteads, 2nd Series, South Kohala, Hawaii, shall be Agricultural (A-3a):

Beginning at the northwesterly corner of this parcel of land on the southerly side of Mamalahoa Highway, being also the north-easterly corner of Lot 1 of Kamuela Haven, File Plan 710, the coordinates of which referred to Government Survey Triangulation Station "EAST BASE" being 6,761.41 feet North and 2,363.91 feet East and running by azimuths measured clockwise from true South:

1. 253° 50' 367.49 feet along the southerly side of Mamalahoa Highway;
2. 346° 10' 820.00 feet along remainder of Grant 7402 to Piko Bell;
3. 256° 10' 8.00 feet along remainder of Grant 7402 to Piko Bell;
4. 346° 10' 2,293.49 feet along Land Court Application 1629, Amended;
5. 76° 10' 375.19 feet along Lot 4, Puukapu Pasture Lots;
6. 166° 10' 3,098.53 feet along Lots 37 to 1, inclusive, of Kamuela Haven, File Plan 710 to the point of beginning and containing an area of 26.60 acres.

"All as outlined in red on the map attached hereto, marked Exhibit "A" and by reference made a part hereof."

SECTION 2. Section 1 of this ordinance shall take effect forthwith upon the conditions that (A) the area be zoned in two (2) increments.

The first increment shall consist of four (4) lots and the second, the remaining lots. The effective date of zoning for the second increment shall be after development has occurred on the first increment. Development is defined as building permits issued for a residential dwelling unit and construction partially completed - partially completed in a sense of having a roof on that unit. This together with the existing residence would assure a minimum of twenty-five (25) per cent housing development on the total number of lots; and (B) the owner or lessee of the subject area be responsible for submitting and securing preliminary approval of a subdivision plan within one (1) year from the date of approval of the change of zone request. Should this condition not be met, action may be taken to rezone the area to a more appropriate zoning classification.

SECTION 3. In the event that any portion of this ordinance is declared invalid, such invalidity shall not affect the other parts of this ordinance.

SECTION 4. This ordinance shall take effect upon its approval.

INTRODUCED BY:

Councilman, County of Hawaii

Hilo, Hawaii

Date of Introduction: November 9, 1972

Date of Adoption: November 29, 1972

- 2 -

PREPARED BY: PLANNING DEPARTMENT
COUNTY OF HAWAII

TMK 6-4-02:132

EXHIBIT "A"

18 OCT. 1972

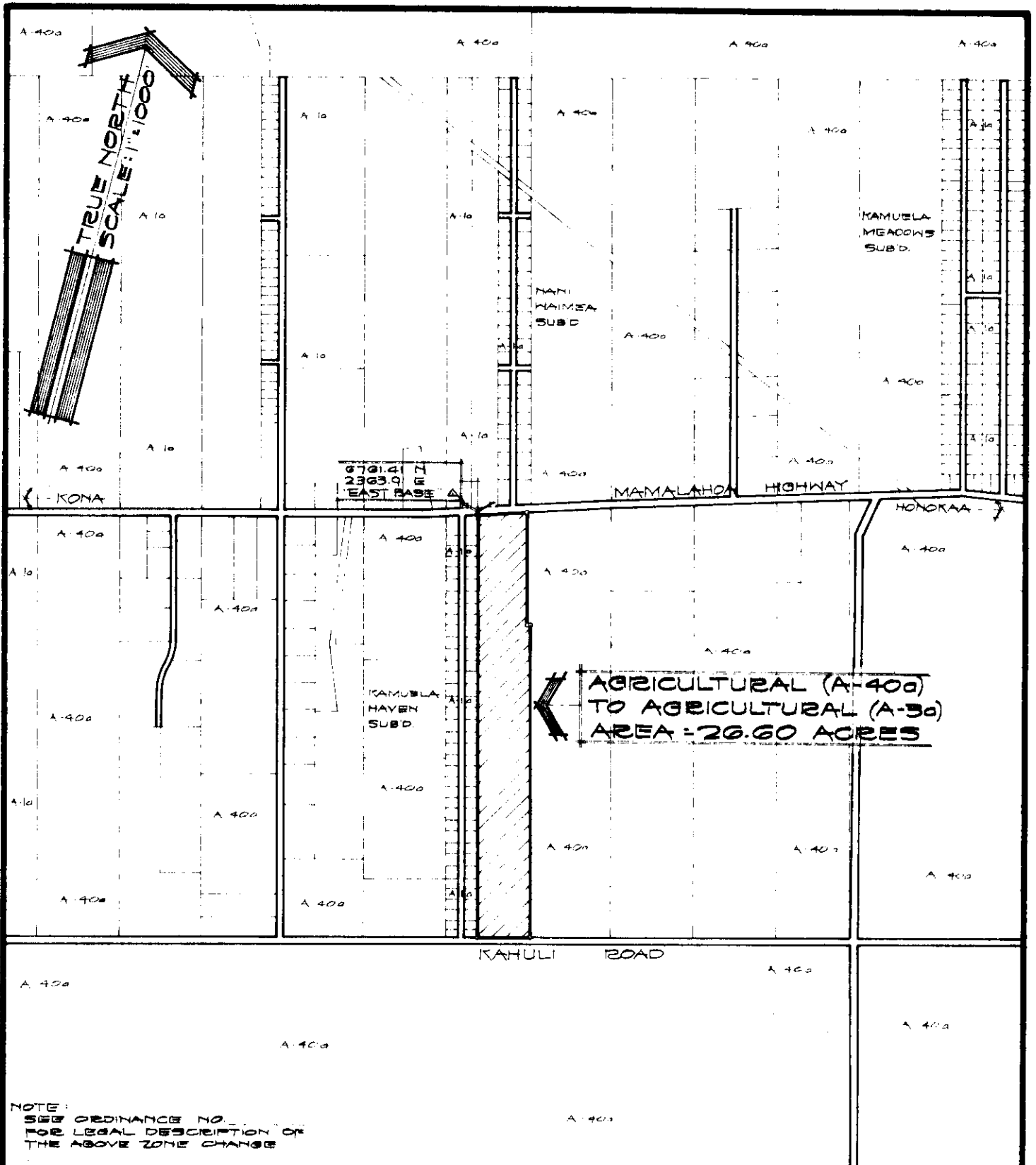

AMENDMENT TO THE COUNTY ZONING ORDINANCE
 AMENDMENT NO. 6 OF SECTION 7.09, THE KAMUELA ZONE MAP, PORTION OF ORDINANCE NO. 109, CHANGING THE DISTRICT CLASSIFICATION FROM AGRICULTURAL (A-40a) TO AGRICULTURAL (A-30) AT PUUKAPU HOMESTEADS, 2ND SERIES, SOUTH KOHALA, HAWAII.

DATE OF PUBLIC HEARING : SEPT. 14, 1972
 DATE OF APPROVAL :
 ORDINANCE NO.
 PREPARED BY : PLANNING DEPARTMENT
 COUNTY OF HAWAII



NOTE:
 SEE ORDINANCE NO. _____
 FOR LEGAL DESCRIPTION OF
 THE ABOVE ZONE CHANGE

AMENDMENT TO THE COUNTY ZONING ORDINANCE

AMENDMENT NO. 6 OF SECTION 7.09, THE KAMUELA ZONE MAP, PORTION OF ORDINANCE NO. 109, CHANGING THE DISTRICT CLASSIFICATION FROM AGRICULTURAL (A-40a) TO AGRICULTURAL (A-30) AT PUUKAPU HOMESTEADS, 2ND SERIES, SOUTH KOHALA, HAWAII.

DATE OF PUBLIC HEARING: SEPT. 14, 1972

DATE OF APPROVAL:

ORDINANCE NO.

PREPARED BY: PLANNING DEPARTMENT
 COUNTY OF HAWAII

TMK 6-4-02:132

10 OCT. 1972

EXHIBIT "A"

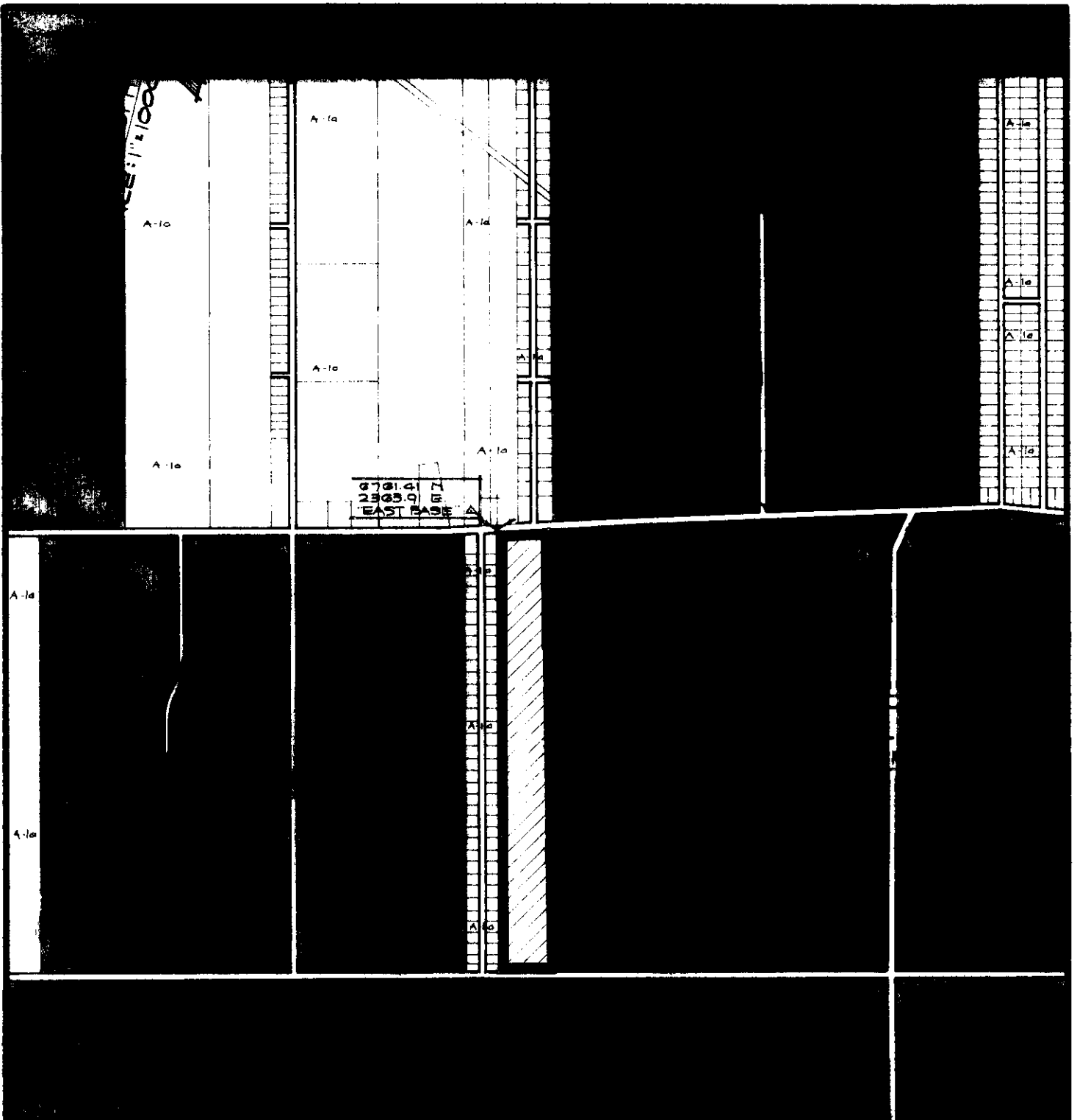

NOTE:
 SEE ORDINANCE NO. _____
 FOR LEGAL DESCRIPTION OF
 THE ABOVE ZONE CHANGE

AMENDMENT TO THE COUNTY ZONING ORDINANCE

AMENDMENT NO. 6 OF SECTION 7.09, THE KAMUELA ZONE MAP, PORTION OF ORDINANCE NO. 109, CHANGING THE DISTRICT CLASSIFICATION FROM AGRICULTURAL (A-40a) TO AGRICULTURAL (A-3a) AT PUUKAPU HOMESTEADS, 2ND SERIES, SOUTH KOHALA, HAWAII.

DATE OF PUBLIC HEARING : SEPT. 14, 1972
 DATE OF APPROVAL :
 ORDINANCE NO.
 PREPARED BY : PLANNING DEPARTMENT
 COUNTY OF HAWAII

TMK 6-4-02:132

18 OCT. 1972

EXHIBIT "A"

207 903

Hilo, Hawaii
 Date: November 9, 1972

FIRST READING			
	AYES	NOES	A/E
Carpenter	X		
De Luz	X		
Edwards	X		
Greenwell	X		
Hisaoka	X		
Souza	X		
Yadao	X		
Yamada	X		
Chr Matayoshi	X		
	9	0	0

November 16, 1972

Publication Date: _____

Hilo, Hawaii
 Date: November 29, 1972

SECOND & FINAL READING			
	AYES	NOES	A/E
Carpenter	X		
De Luz	X		
Edwards	X		
Greenwell	X		
Hisaoka	X		
Souza	X		
Yadao	X		
Yamada	X		
Chr Matayoshi	X		
	9	0	0

December 10, 1972

Publication Date: _____

We do hereby certify that the foregoing BILL was adopted by the County Council and published as indicated above.

Abur Matayoshi
 Council Chairman

Tadashi Suzuki
 County Clerk

Approved/Disapproved this 12th day of
December, 1972

Shunichi Kimura
 Mayor, County of Hawaii

Bill No. 940
 Reference: C-2166/PEDLC-90
 M.B. No. 2040, 2067
 ORD. & RES. No. 542

Bill No.940 - 1972

AN ORDINANCE AMENDING SECTION 7.09, THE KAMUELA ZONE MAP, ORDINANCE NO. 63 (ZONING ORDINANCE), REVISED ORDINANCES OF THE COUNTY OF HAWAII 1967, AS AMENDED, BY CHANGING THE DISTRICT CLASSIFICATION FROM AGRICULTURAL (A-40a) TO AGRICULTURAL (A-3a) AT PUKAPU HOMESTEADS, 2ND SERIES, SOUTH KOHALA, HAWAII, COVERED BY TAX MAP KEY 6-4-02:132.

This Bill proposes to amend the Kamuela Zone Map by changing the district classification of land from an agricultural - 40 acre minimum lot size (A-40a) to an agricultural - 3 acre minimum lot size (A-3a) zoned district in Puukapu Homesteads, 2nd Series, South Kohala, Hawaii.

Date Introduced: November 9, 1972

Copies of the foregoing Bill, in full, are on file in the Office of the County Clerk for use and examination by the public.

I hereby certify that the foregoing Bill passed first reading at the meeting of the County Council on November 9, 1972, by the following aye and no vote:

AYES: Councilmen Carpenter, De Luz, Edwards, Greenwell, Hisaoka, Souza, Yadao, Yamada and Chairman Matayoshi - 9.

NOES: None.



7.09, THE KAMUELA ZONE MAP, ORDINANCE NO. 63 (ZONING ORDINANCE), REVISED ORDINANCES OF THE COUNTY OF HAWAII 1967, AS AMENDED, BY CHANGING THE DISTRICT CLASSIFICATION FROM AGRICULTURAL (A-40a) TO AGRICULTURAL (A-3a) AT PUKAPU HOMESTEADS, 2ND SERIES, SOUTH KOHALA, HAWAII, COVERED BY TAX MAP KEY 6-4-02:132.

This Bill proposes to amend the Kamuela Zone Map by changing the district classification of land from an agricultural-40 acre minimum lot size (A-40a) to an agricultural-3 acre minimum lot size (A-3a) zoned district in Puukapu Homesteads, 2nd Series, South Kohala, Hawaii.

Date Introduced: November 9, 1972

Copies of the foregoing Bill, in full, are on file in the Office of the County Clerk for use and examination by the public.

I hereby certify that the foregoing Bill passed first reading at the meeting of the County Council of November 9, 1972, by the following aye and no vote:

AYES: Councilmen Carpenter, De Luz, Edwards, Greenwell, Hisaoka, Souza, Yadao, Yamada and Chairman Matayoshi - 9.

NOES: None.

Tadashi Suzuki
COUNTY CLERK
COUNTY OF HAWAII

Tadashi Suzuki

COUNTY CLERK
COUNTY OF HAWAII

ORDINANCE NO. 542
(Bill No. 940-1972)

AN ORDINANCE AMENDING SECTION 7.09, THE KAMUELA ZONE MAP, ORDINANCE NO. 63 (ZONING ORDINANCE), REVISED ORDINANCES OF THE COUNTY OF HAWAII 1967, AS AMENDED, BY CHANGING THE DISTRICT CLASSIFICATION FROM AGRICULTURAL (A-40a) TO AGRICULTURAL (A-3a) AT PUUKAPU HOMESTEADS, 2ND SERIES, SOUTH KOHALA, HAWAII, COVERED BY TAX MAP KEY 6-4-02:132.

Date Approved: November 29, 1972
Date Effective: December 1, 1972

Copies of the foregoing Ordinance, in full, are on file in the Office of the County Clerk for use and examination by the public.

I hereby certify that the foregoing Ordinance passed second and final reading at the meeting of the County Council on November 29, 1972, by the following aye and no vote:

AYES: Councilmen Carpenter, De Luz, Edwards, Greenwell, Hisaoka, Souza, Yadao, Yamada and Chairman Matayoshi - 9.

NOES: None.

Tadashi Suzuki
COUNTY CLERK
COUNTY OF HAWAII

AN ORDINANCE AMENDING SECTION 7.09, THE KAMUELA ZONE MAP, ORDINANCE NO. 63 (ZONING ORDINANCE), REVISED ORDINANCES OF THE COUNTY OF HAWAII 1967, AS AMENDED, BY CHANGING THE DISTRICT CLASSIFICATION FROM AGRICULTURAL (A-40a) TO AGRICULTURAL (A-3a) AT PUUKAPU HOMESTEADS, 2ND SERIES, SOUTH KOHALA, HAWAII, COVERED BY TAX MAP KEY 6-4-02:132.

Date Approved: November 29, 1972
Date Effective: December 1, 1972

Copies of the foregoing Ordinance, in full, are on file in the Office of the County Clerk for use and examination by the public.

I hereby certify that the foregoing Ordinance passed second and final reading at the meeting of the County Council on November 29, 1972, by the following aye and no vote:

AYES: Councilmen Carpenter, De Luz, Edwards, Greenwell, Hisaoka, Souza, Yadao, Yamada and Chairman Matayoshi - 9.

NOES: None.

Tadashi Suzuki
COUNTY CLERK
COUNTY OF HAWAII

Tadashi Suzuki
COUNTY CLERK



Robert Shioji
DEPUTY COUNTY CLERK

OFFICE OF THE COUNTY CLERK
COUNTY OF HAWAII
HILO, HAWAII 96720

Mayor Shunichi Kimura
County of Hawaii
Hilo, Hawaii

I hereby transmit Ordinance Bill No. 940 passed by
the County Council on second and final reading.

Tadashi Suzuki

COUNTY CLERK

Encl.

Dated: November 29, 1972