

COUNTY OF HAWAII - STATE OF HAWAII

ORDINANCE NO. 546

AN ORDINANCE AMENDING SECTION 7.29, THE CITY OF HILO ZONE MAP, ORDINANCE NO. 63 (ZONING ORDINANCE), REVISED ORDINANCES OF THE COUNTY OF HAWAII 1967, AS AMENDED, BY CHANGING THE DISTRICT CLASSIFICATION FROM SINGLE FAMILY RESIDENTIAL (RS-7.5) TO MULTIPLE FAMILY RESIDENTIAL (RM-2) AT PIIHONUA, SOUTH HILO, HAWAII, COVERED BY TAX MAP KEY 2-3-15:3 AND 49.

BE IT ORDAINED BY THE COUNCIL OF THE COUNTY OF HAWAII:

SECTION 1. Section 7.29 of Ordinance No. 63 (Zoning Ordinance), Revised Ordinances of the County of Hawaii 1967, as amended, is hereby further amended by adding thereto the following subsection:

"7.29 (m). The district classification of the following area situated at Piihonua, South Hilo, Hawaii, shall be Multiple Family Residential (RM-2):

Beginning at a pipe at the west corner of this parcel of land, the coordinates of said point of beginning referred to Government Survey Triangulation Station "HALAI" being 1387.72 feet North and 873.60 feet West, and running by azimuths measured clockwise from true South:

1. 241^o 27' 261.44 feet along Government Land to a pipe; thence along Government Land along a curve to the left having a radius of 474.06 feet, the chord azimuth and distance being:
2. 239^o 10' 15" 37.71 feet to a pipe;
3. 326^o 48' 209.25 feet along Government Land to a pipe;
4. 56^o 48' 80.00 feet along Government Land to a pipe;
5. 326^o 48' 10.00 feet along Government Land to a pipe;
6. 56^o 48' 80.00 feet along Grant 12478 to a pipe;
7. 146^o 48' 5.00 feet along Grant S-14011;
8. 56^o 48' 261.40 feet along Grants S-14011, S-14086 and S-14103 and also across Grant 9494 to a pipe;
9. 157^o 22' 24.41 feet along the easterly side of Hale Street to a pipe;
10. 236^o 48' 101.34 feet across Grant 9494 and also along the remainder of Grant 12854 to a pipe;

11. 151^o 27' 213.74 feet along the remainder of Grant 12854 and across the abandoned portion of Wailuku Drive to the point of beginning and containing an area of 1.649 acres.

"All as outlined in red on the map attached hereto marked Exhibit "A" and by reference made a part hereof."

SECTION 2. Section 1 of this ordinance shall take effect forthwith upon the conditions that (A) the applicant or the owner of the subject area be responsible for securing a building permit within one (1) year from the date of approval of the request. The development shall conform substantially to the preliminary building plans submitted in conjunction with the rezoning request. Should this condition not be met, action may be initiated to reclassify the subject area to a more appropriate designation; (B) the development comply with the policies and standards for multiple residential development of the General Plan document; and (C) the applicant or owner of the subject area be responsible for widening Hale Street to a minimum pavement width of 20 feet from Waianuenue Avenue to the driveway entrance of the project and that a sewer line also be constructed to Waianuenue Avenue.

SECTION 3. In the event that any portion of this ordinance is declared invalid, such invalidity shall not affect the other parts of this ordinance.

SECTION 4. This ordinance shall take effect upon its approval.

INTRODUCED BY:

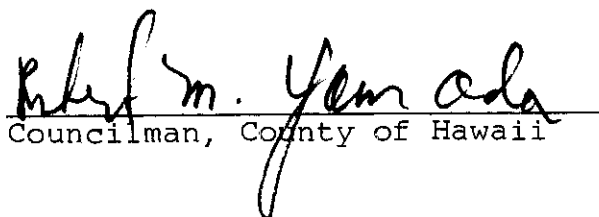
Councilman, County of Hawaii

Hilo, Hawaii

Date of Introduction: November 29, 1972

Date of Adoption: December 1, 1972

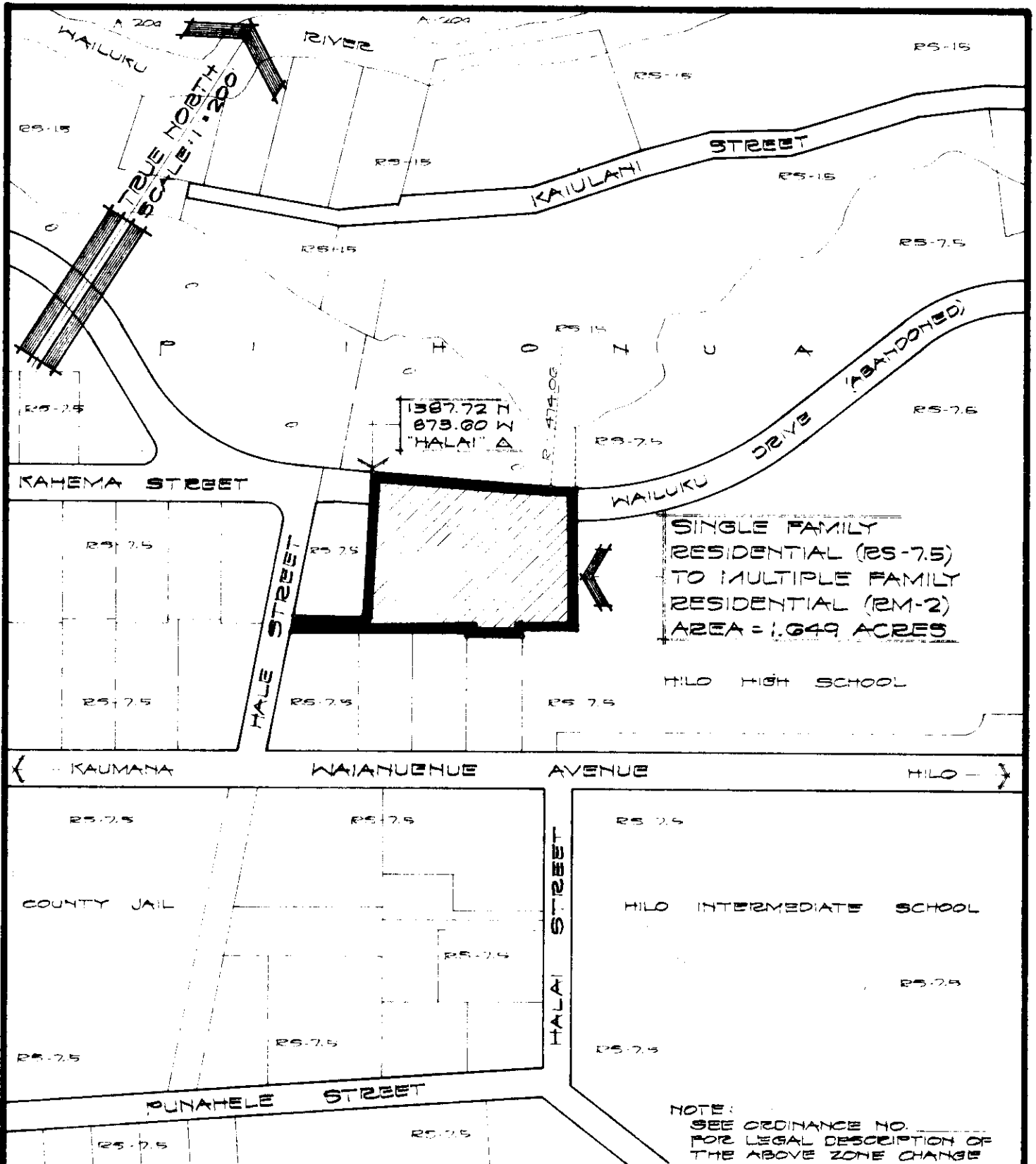

NOTE:
SEE ORDINANCE NO. _____
FOR LEGAL DESCRIPTION OF
THE ABOVE ZONE CHANGE

AMENDMENT TO THE COUNTY ZONING ORDINANCE

AMENDMENT NO. 13 OF SECTION 7.29, THE CITY OF HILO ZONE MAP, PORTION OF ORDINANCE NO. 187, CHANGING THE DISTRICT CLASSIFICATION FROM SINGLE FAMILY RESIDENTIAL (RS-7.5) TO MULTIPLE FAMILY RESIDENTIAL (RM-2) AT PIIHONUA, SOUTH HILO, HAWAII.

DATE OF PUBLIC HEARING: OCT. 20, 1972
DATE OF APPROVAL:
ORDINANCE NO.
PREPARED BY: PLANNING DEPARTMENT
COUNTY OF HAWAII

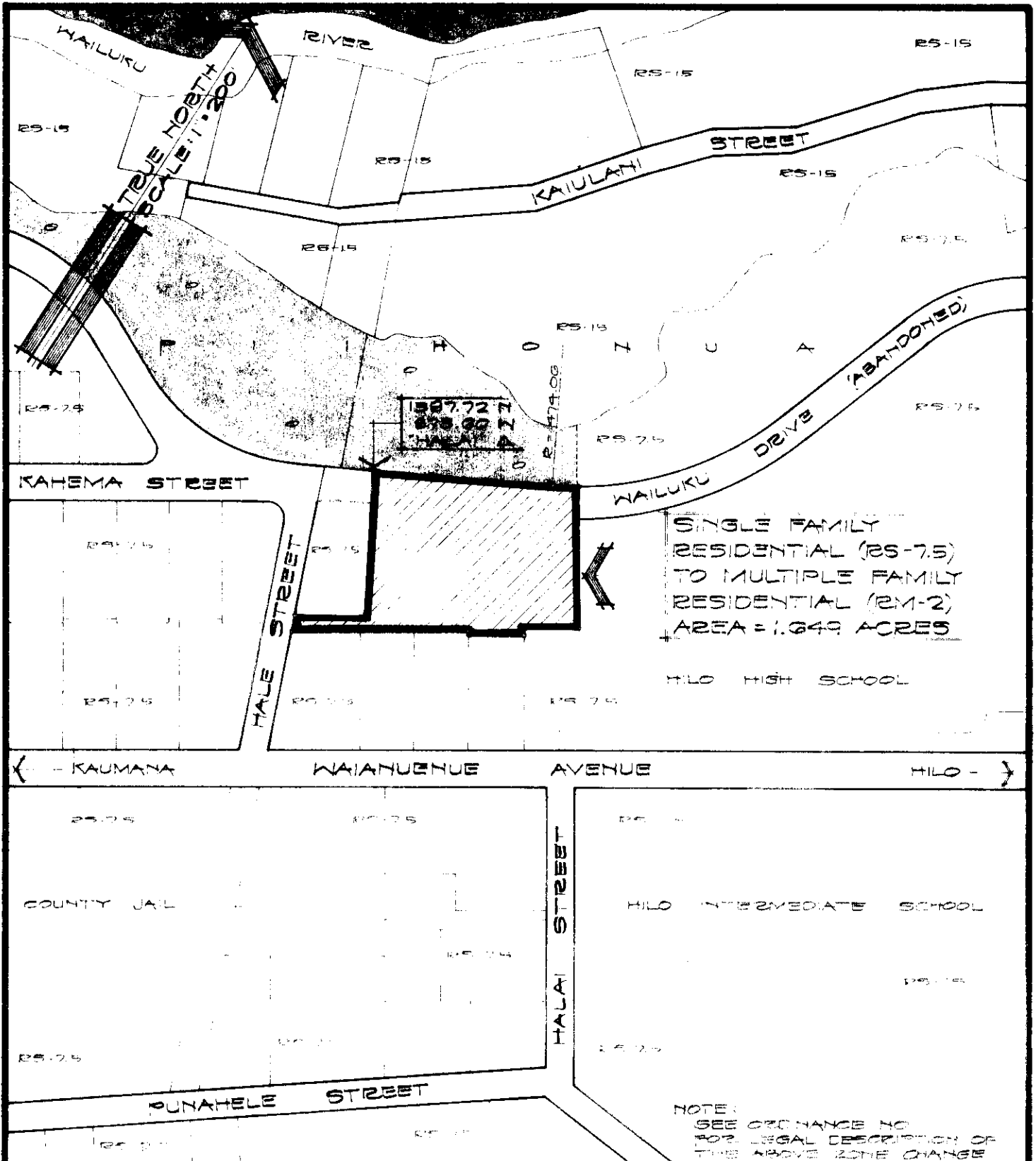

AMENDMENT TO THE COUNTY ZONING ORDINANCE

AMENDMENT NO. 13 OF SECTION 7.29, THE CITY OF HILO ZONE MAP, PORTION OF ORDINANCE NO. 187, CHANGING THE DISTRICT CLASSIFICATION FROM SINGLE FAMILY RESIDENTIAL (RS-7.5) TO MULTIPLE FAMILY RESIDENTIAL (RM-2) AT PIHONUVA, SOUTH HILO, HAWAII.

DATE OF PUBLIC HEARING: OCT. 26, 1972
 DATE OF APPROVAL:
 ORDINANCE NO.
 PREPARED BY: PLANNING DEPARTMENT
 COUNTY OF HAWAII

Hilo, Hawaii

Date: November 29, 1972

FIRST READING			
	AYES	NOES	A/E
Carpenter	X		
De Luz	X		
Edwards	X		
Greenwell	X		
Hisaoka	X		
Souza	X		
Yadao	X		
Yamada	X		
Chr Matayoshi	X		
	9	0	0

Publication Date: November 30, 1972

Hilo, Hawaii

Date: December 1, 1972

SECOND & FINAL READING			
	AYES	NOES	A/E
Carpenter			X
De Luz	X		
Edwards			X
Greenwell	X		
Hisaoka	X		
Souza	X		
Yadao			X
Yamada	X		
Chr Matayoshi	X		
	6		3

Publication Date: December 17, 1972

We do hereby certify that the foregoing BILL was adopted by the County Council and published as indicated above.

 Council Chairman

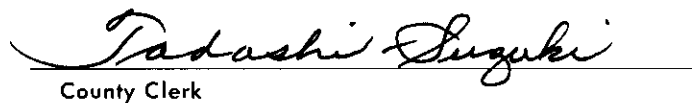
 County Clerk

Approved/Disapproved this 30th day of
December, 1972

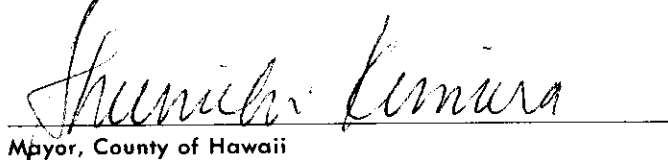
 Mayor, County of Hawaii

Bill No. 944
 Reference: C-2184/PEDLC-91
 M.B. No. 2065
 ORD. No. 516

Bill No. 944 - 1972

AN ORDINANCE AMENDING SECTION 7.29, THE CITY OF HILO ZONE MAP, ORDINANCE NO. 63 (ZONING ORDINANCE), REVISED ORDINANCES OF THE COUNTY OF HAWAII 1967, AS AMENDED, BY CHANGING THE DISTRICT CLASSIFICATION FROM SINGLE FAMILY RESIDENTIAL (RS-7.5) TO MULTIPLE FAMILY RESIDENTIAL (RM-2) AT PIHONUA, SOUTH HILO, HAWAII, COVERED BY TAX MAP KEY 2-3-15:3 AND 49.

This Bill proposes to amend the City of Hilo Zone Map by changing the district classification of land from a single family residential - 7,500 square foot minimum lot size (RS-7.5) to a multiple family residential - 2,000 square foot minimum land area per dwelling unit (RM-2) zoned district in Piihonua, Hawaii.

Date Introduced: November 29, 1972

Copies of the foregoing Bill, in full, are on file in the Office of the County Clerk for use and examination by the public.

I hereby certify that the foregoing Bill passed first reading at the meeting of the County Council on November 29, 1972, by the following aye and no vote:

AYES: Councilmen Carpenter, De Luz, Edwards, Greenwell, Hisaoka, Souza, Yadao, Yamada and Chairman Matayoshi - 9.

NOES: None.

~~Bill No. 944 - 1972~~

AN ORDINANCE AMENDING SECTION 7.29, THE CITY OF HILO ZONE MAP, ORDINANCE NO. 63 (ZONING ORDINANCE), REVISED ORDINANCES OF THE COUNTY OF HAWAII 1967, AS AMENDED, BY CHANGING THE DISTRICT CLASSIFICATION FROM SINGLE FAMILY RESIDENTIAL (RS-7.5) TO MULTIPLE FAMILY RESIDENTIAL (RM-2) AT PIHONUA, SOUTH HILO, HAWAII, COVERED BY TAX MAP KEY 2-3-15:3 AND 49.



COUNTY CLERK
COUNTY OF HAWAII

This Bill proposes to amend the City of Hilo Zone Map by changing the district classification of land from a single family residential - 7,500 square foot minimum lot size (RS-7.5) to a multiple family residential - 2,000 square foot minimum land area per dwelling unit (RM-2) zoned district in Piihonua, Hawaii.

ORDINANCE NO. 546
(Bill No. 944-1972)

AN ORDINANCE AMENDING SECTION 7.29, THE CITY OF HILO ZONE MAP, ORDINANCE NO. 63 (ZONING ORDINANCE), REVISED ORDINANCES OF THE COUNTY OF HAWAII 1967, AS AMENDED, BY CHANGING THE DISTRICT CLASSIFICATION FROM SINGLE FAMILY RESIDENTIAL (RS-7.5) TO MULTIPLE FAMILY RESIDENTIAL (RM-2) AT PIIHONUA, SOUTH HILO, HAWAII, COVERED BY TAX MAP KEY 2-3-15:3 AND 49.

Date Approved: December 1, 1972
Date Effective: December 8, 1972

Copies of the foregoing Ordinance, in full, are on file in the Office of the County Clerk for use and examination by the public.

I hereby certify that the foregoing Ordinance passed second and final reading at the meeting of the County Council on December 1, 1972, by the following aye and no vote:

AYES: Councilmen De Luz, Greenwell, Hisaoka, Souza, Yamada and Chairman Matayoshi - 6.

NOES: None.

ABSENT: Councilmen Carpenter, Edwards, and Yadao - 3.



COUNTY CLERK
COUNTY OF HAWAII

AN ORDINANCE AMENDING SECTION 7.29, THE CITY OF HILO ZONE MAP, ORDINANCE NO. 63 (ZONING ORDINANCE), REVISED ORDINANCES OF THE COUNTY OF HAWAII 1967, AS AMENDED, BY CHANGING THE DISTRICT CLASSIFICATION FROM SINGLE FAMILY RESIDENTIAL (RS-7.5) TO MULTIPLE FAMILY RESIDENTIAL (RM-2) AT PIIHONUA, SOUTH HILO, HAWAII, COVERED BY TAX MAP KEY 2-3-15:3 AND 49.

Date Approved: December 1, 1972
Date Effective: December 8, 1972

Copies of the foregoing Ordinance, in full, are on file in the Office of the County Clerk for use and examination by the public.

I hereby certify that the foregoing Ordinance passed second and final reading at the meeting of the County Council on December 1, 1972, by the following aye and no vote:

AYES: Councilmen De Luz, Greenwell, Hisaoka, Souza, Yamada and Chairman Matayoshi - 6.

NOES: None.

ABSENT: Councilmen Carpenter, Edwards, and Yadao - 3.

Tadashi Suzuki,
COUNTY CLERK
COUNTY OF HAWAII

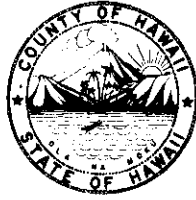

Tadashi Suzuki
COUNTY CLERK

Robert Shioji
DEPUTY COUNTY CLERK

OFFICE OF THE COUNTY CLERK
COUNTY OF HAWAII
HILO, HAWAII 96720

Mayor Shunichi Kimura
County of Hawaii
Hilo, Hawaii

I hereby transmit Ordinance Bill No. 944 passed by
the County Council on second and final reading.

COUNTY CLERK

Encl.

Dated: December 6, 1972