

COUNTY OF HAWAII - STATE OF HAWAII

ORDINANCE NO. 551

AN ORDINANCE AMENDING SECTION 7.29, THE CITY OF HILO ZONE MAP, ORDINANCE NO. 63 (ZONING ORDINANCE), REVISED ORDINANCES OF THE COUNTY OF HAWAII 1967, AS AMENDED, BY CHANGING THE DISTRICT CLASSIFICATION FROM AGRICULTURAL (A-1a) TO SINGLE FAMILY RESIDENTIAL (RS-15) AT WAIAKEA HOMESTEADS, 2nd SERIES, WAIAKEA, SOUTH HILO, HAWAII, COVERED BY TAX MAP KEY 2-4-44:2.

BE IT ORDAINED BY THE COUNCIL OF THE COUNTY OF HAWAII:

SECTION 1. Section 7.29 of Ordinance 63 (Zoning Ordinance), Revised Ordinances of the County of Hawaii 1967, as amended, is hereby further amended by adding thereto the following subsection:

"7.29(n). The district classification of the following area situated at Waiakea Homesteads, 2nd Series, Waiakea, South Hilo, Hawaii shall be Single Family Residential (RS-15):

Beginning at the northeast corner of this parcel of land the coordinates of said point of beginning referred to Government Survey Triangulation Station "Halai" being 13632.80 feet South and 3045.89 feet West, and running by azimuths measured clockwise from true South:

1. 355° 40' 300.00 feet along Lot 47, Macadamia Grove Estates Subdivision;
2. 85° 40' 290.40 feet along the remainder of Lot 723, Grant 11308 to H. H. Padgett, to a point on the east side of Kupulau Street;
3. 175° 40' 300.00 feet along the east side of Kupulau Street;
4. 265° 40' 290.40 feet along Lots 65 and 48, Macadamia Grove Estates Subdivision, to the point of beginning and containing an area of 2.00 acres.

"All as outlined in red on the map attached hereto, marked Exhibit "A" and by reference made a part hereof."

SECTION 2. Section 1 of this ordinance shall take effect forthwith upon the condition that the owner or lessee of the subject area submit a subdivision plan for preliminary approval within one (1) year from the date of approval of the subject request. Should this condition not be met, action may be taken to rezone the subject area to an appropriate designation.

SECTION 3. In the event that any portion of this ordinance is declared invalid, such invalidity shall not affect the other parts of this ordinance.

SECTION 4. This ordinance shall take effect upon its approval.

INTRODUCED BY:

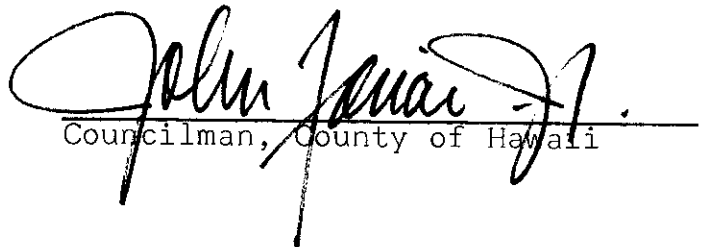
Councilman, County of Hawaii

Hilo, Hawaii

Date of Introduction: **January 3, 1973**

Date of Adoption: **January 16, 1973**

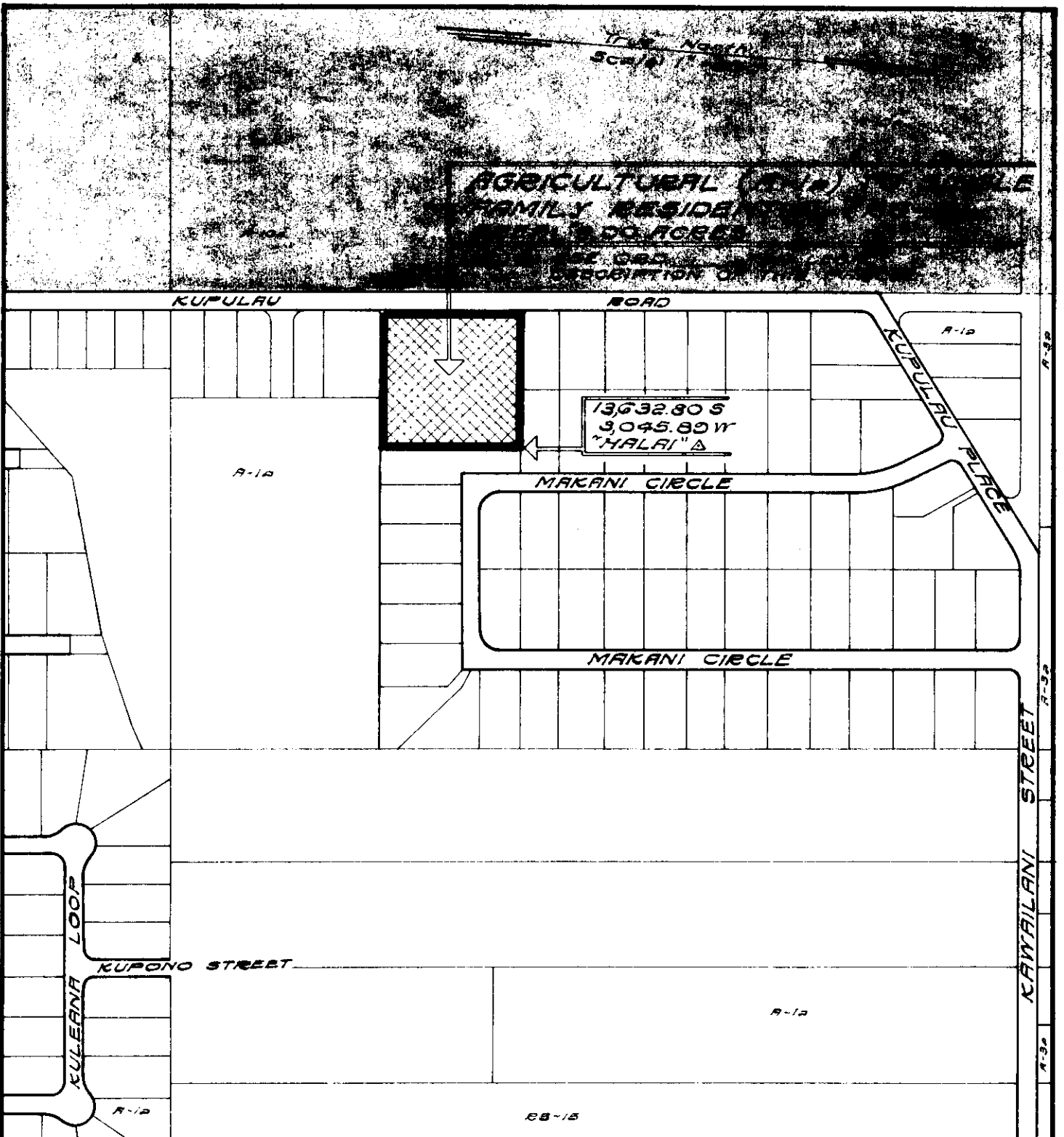

AMENDMENT TO THE COUNTY ZONING ORDINANCE

AMENDMENT NO. 14 OF SECTION 7.29, THE CITY OF HILO ZONE MAP, PORTION OF ORDINANCE NO. 187, CHANGING THE DISTRICT CLASSIFICATION FROM AGRICULTURAL (A-1a) TO SINGLE FAMILY RESIDENTIAL (RS-15) IN WAIAKEA HOMESTEADS, 2nd SERIES, WAIAKEA, SOUTH HILO, HAWAII.

DATE OF PUBLIC HEARING: November 16, 1972
 DATE OF APPROVAL:
 ORDINANCE NO.
 PREPARED BY: PLANNING DEPARTMENT
 COUNTY OF HAWAII

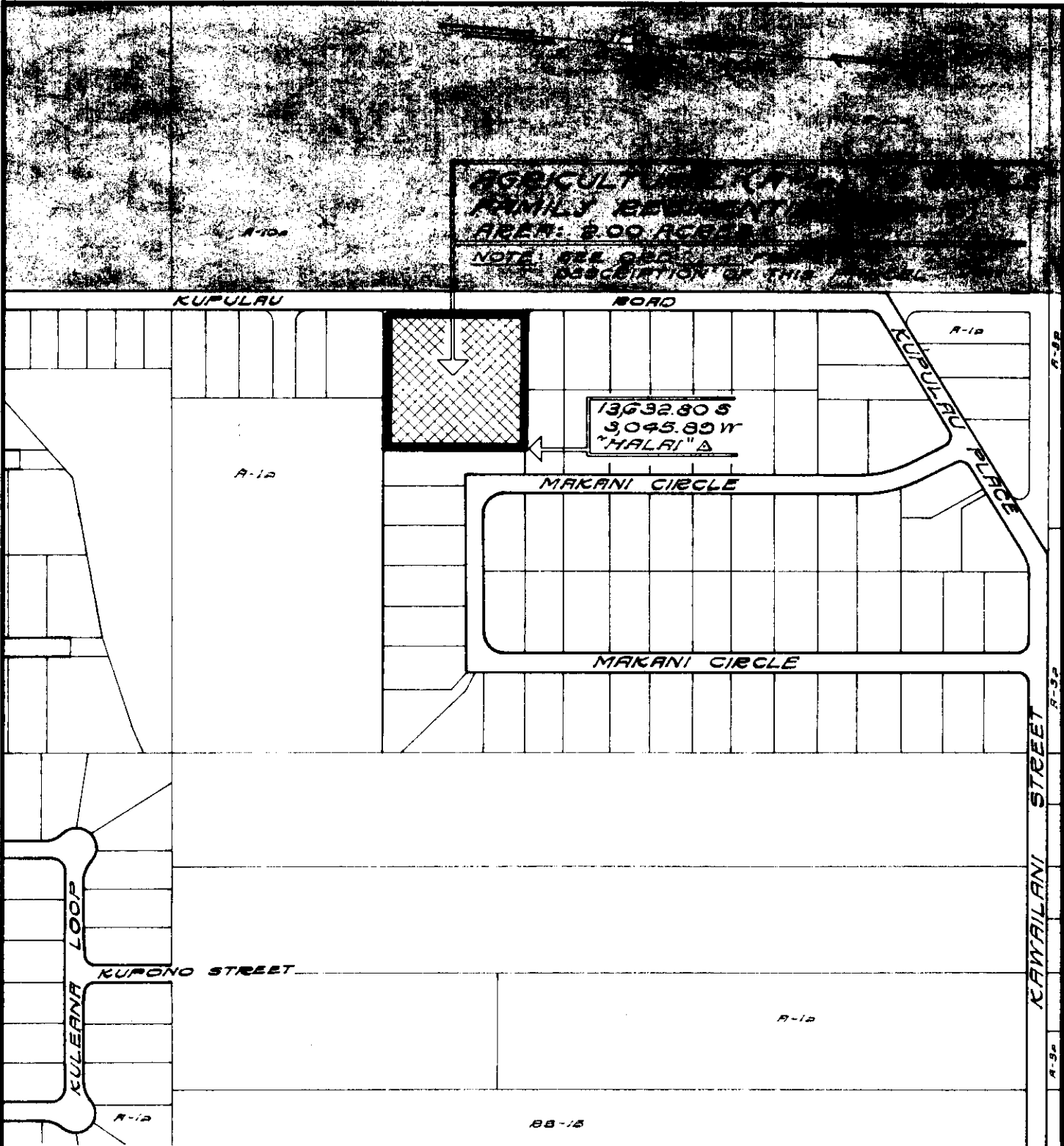

AGRICULTURAL LOT
 FAMILY RESIDENTIAL
 AREA: 2.00 ACRES
 NOTE: SEE SUBDIVISION
 ASSOCIATION OF THIS AREA

13632.80 S
 3045.89 W
 "HALAI" A

AMENDMENT TO THE COUNTY ZONING ORDINANCE

AMENDMENT NO. 14 OF SECTION 7.29, THE CITY OF HILO ZONE MAP, PORTION OF ORDINANCE NO. 187, CHANGING THE DISTRICT CLASSIFICATION FROM AGRICULTURAL (A-12) TO SINGLE FAMILY RESIDENTIAL (RS-15) IN WAIAKEA HOMESTEADS, 2nd SERIES, WAIAKEA, SOUTH HILO, HAWAII.

DATE OF PUBLIC HEARING: November 16, 1972
 DATE OF APPROVAL:
 ORDINANCE NO.
 PREPARED BY: PLANNING DEPARTMENT
 COUNTY OF HAWAII

True North
Scale: 1"=300'

A-10a

AGRICULTURAL (A-1a) TO SINGLE FAMILY RESIDENTIAL (RS-15)
AREA: 2.00 ACRES

NOTE: SEE ORD. _____ FOR LEGAL DESCRIPTION OF THIS PARCEL

A-10a

KUPULAU

ROAD

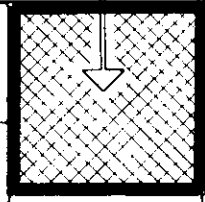

13632.80 S
3045.89 W
"HALAI" Δ

A-1a

A-1a

MAKANI CIRCLE

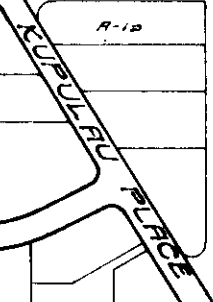

MAKANI CIRCLE

A-3a

A-3a

KAWAILANI STREET

A-3a

KULEANA LOOP

KUPONO STREET

A-1a

A-1a

RS-15

AMENDMENT TO THE COUNTY ZONING ORDINANCE

AMENDMENT NO. 14 OF SECTION 7.29, THE CITY OF HILO ZONE MAP, PORTION OF ORDINANCE NO. 187, CHANGING THE DISTRICT CLASSIFICATION FROM AGRICULTURAL (A-1a) TO SINGLE FAMILY RESIDENTIAL (RS-15) IN WAIAKEA HOMESTEADS, 2nd SERIES, WAIAKEA, SOUTH HILO, HAWAII.

DATE OF PUBLIC HEARING: November 10, 1972
DATE OF APPROVAL:
ORDINANCE NO.
PREPARED BY: PLANNING DEPARTMENT
COUNTY OF HAWAII

Hilo, Hawaii
Date: January 3, 1973

FIRST READING			
	AYES	NOES	A/E
Carpenter	X		
De Luz	X		
Farias	X		
Fujii	X		
Hisaoka	X		
Kawahara	X		
Matayoshi	X		
Yadao	X		
Chr. Yamada	X		
	9	0	0

Publication Date: January 9, 1973

Hilo, Hawaii
Date: January 16, 1973

SECOND & FINAL READING			
	AYES	NOES	A/E
Carpenter	X		
De Luz	X		
Farias	X		
Fujii	X		
Hisaoka	X		
Kawahara	X		
Matayoshi	X		
Yadao	X		
Chr. Yamada	X		
	9	0	0

Publication Date: January 21, 1973

We do hereby certify that the foregoing BILL was adopted by the County Council and published as indicated above.

Robert M. Yamada

Council Chairman

Tadashi Suzuki

County Clerk

Approved/~~Disapproved~~ this 22nd day of
January, 1973

Shunichi Kimura

Mayor, County of Hawaii

Bill No. 947
Reference: C-8/PRDC-1
M.B. No. 119,62
Ord. No. 551

Bill 947 - 1972

AN ORDINANCE AMENDING SECTION 7.29, THE CITY OF HILO ZONE MAP, ORDINANCE NO. 63 (ZONING ORDINANCE), REVISED ORDINANCES OF THE COUNTY OF HAWAII 1967, AS AMENDED, BY CHANGING THE DISTRICT CLASSIFICATION FROM AGRICULTURAL (A-1a) TO SINGLE FAMILY RESIDENTIAL (RS-15) AT WAIAKEA HOMESTEADS, 2ND SERIES, WAIAKEA, SOUTH HILO, HAWAII, COVERED BY TAX MAP KEY 2-4-44:2.

This Bill proposes to amend the City of Hilo Zone Map by changing the district classification of land from an agricultural (A-1a) to a single family residential (RS-15) in Waiakea Homesteads, 2nd Series, Waiakea, South Hilo, Hawaii.

Date Introduced: January 3, 1973

Copies of the foregoing Bill, in full, are on file in the Office of the County Clerk for use and examination by the public.

I hereby certify that the foregoing Bill passed first reading at the meeting of the County Council on January 3, 1973, by the following aye and no vote:

AYES: Councilmen Carpenter, De Luz, Farias, Fujii, Hisaoka, Kawahara, Matayoshi, Yadao, and Chairman Yamada - 9.

NOES: None.

BILL 947 - 1973
AN ORDINANCE AMENDING SECTION 7.29, THE CITY OF HILO ZONE MAP, ORDINANCE NO. 63 (ZONING ORDINANCE), REVISED ORDINANCES OF THE COUNTY OF HAWAII 1967, AS AMENDED, BY CHANGING THE DISTRICT CLASSIFICATION FROM AGRICULTURAL (A-1a) TO SINGLE FAMILY RESIDENTIAL (RS-15) AT WAIAKEA HOMESTEADS, 2ND SERIES, WAIAKEA, SOUTH HILO, HAWAII, COVERED BY TAX MAP KEY 2-4-44:2.

This Bill proposes to amend the City of Hilo Zone Map by changing the district classification of land from an agricultural (A-1a) to a single family residential (RS-15) in Waiakea Homesteads, 2nd Series, Waiakea, South Hilo, Hawaii.

Date Introduced: January 3, 1973

Copies of the foregoing Bill, in full, are on file in the Office of the County Clerk for use and examination by the public.

I hereby certify that the foregoing Bill passed first reading at the meeting of the County Council on January 3, 1973, by the following aye and no vote:

AYES: Councilmen Carpenter, De Luz, Farias, Fujii, Hisaoka, Kawahara, Matayoshi, Yadao, and Chairman Yamada—9.

NOES: None.

Tadashi Suzuki
COUNTY CLERK
COUNTY OF HAWAII

COUNTY CLERK
COUNTY OF HAWAII

ORDINANCE NO. 551
(Bill No. 947 - 1973)

AN ORDINANCE AMENDING SECTION 7.29, THE CITY OF HILO ZONE MAP, ORDINANCE NO. 63 (ZONING ORDINANCE), REVISED ORDINANCES OF THE COUNTY OF HAWAII 1967, AS AMENDED, BY CHANGING THE DISTRICT CLASSIFICATION FROM AGRICULTURAL (A-1a) TO SINGLE FAMILY RESIDENTIAL (RS-15) AT WAIAKEA HOMESTEADS, 2ND SERIES, WAIAKEA, SOUTH HILO, HAWAII, COVERED BY TAX MAP KEY 2-4-44:2.

Date Approved: January 16, 1973
Date Effective: January 22, 1973

Copies of the foregoing Ordinance, in full, are on file in the Office of the County Clerk for use and examination by the public.

I hereby certify that the foregoing Ordinance passed second and final reading at the meeting of the County Council on January 16, 1973, by the following aye and no vote:

AYES: Councilmen Carpenter, De Luz, Farias, Fujii, Hisaoka, Kawahara, Matayoshi, Yadao, and Chairman Yamada - 9.

NOES: None.

Tadashi Suzuki

COUNTY CLERK
COUNTY OF HAWAII

AN ORDINANCE AMENDING SECTION 7.29, THE CITY OF HILO ZONE MAP, ORDINANCE NO. 63 (ZONING ORDINANCE), REVISED ORDINANCES OF THE COUNTY OF HAWAII 1967, AS AMENDED, BY CHANGING THE DISTRICT CLASSIFICATION FROM AGRICULTURAL (A-1a) TO SINGLE FAMILY RESIDENTIAL (RS-15) AT WAIAKEA HOMESTEADS, 2ND SERIES, WAIAKEA, SOUTH HILO, HAWAII, COVERED BY TAX MAP KEY 2-4-44:2.

Date Approved: January 16, 1973
Date Effective: January 22, 1973

Copies of the foregoing Ordinance, in full, are on file in the Office of the County Clerk for use and examination by the public.

I hereby certify that the foregoing Ordinance passed second and final reading at the meeting of the County Council on January 16, 1973, by the following aye and no vote:

AYES: Councilmen Carpenter, De Luz, Farias, Fujii, Hisaoka, Kawahara, Matayoshi, Yadao, and Chairman Yamada - 9.

NOES: None.

TADASHI SUZUKI
COUNTY CLERK
COUNTY OF HAWAII

(974--Hawaii Tribune-Herald: Jan. 28, 1973)

Tadashi Suzuki
COUNTY CLERK



Robert Shioji
DEPUTY COUNTY CLERK

OFFICE OF THE COUNTY CLERK

COUNTY OF HAWAII
HILO, HAWAII 96720

Mayor Shunichi Kimura
County of Hawaii
Hilo, Hawaii

I hereby transmit Ordinance Bill No. 947 passed by
the County Council on second and final reading.

Tadashi Suzuki
COUNTY CLERK

Encl.

Dated: January 16, 1973