

COUNTY OF HAWAII - STATE OF HAWAII

ORDINANCE NO. 593

AN ORDINANCE AMENDING SECTION 7.01, THE NORTH AND SOUTH KONA DISTRICTS ZONE MAP, ORDINANCE NO. 63 (ZONING ORDINANCE), REVISED ORDINANCES OF THE COUNTY OF HAWAII 1967, AS AMENDED, BY CHANGING THE DISTRICT CLASSIFICATION FROM AGRICULTURAL (A-20a) TO AGRICULTURAL (A-1a) AT KEALIA 2ND, SOUTH KONA, HAWAII, COVERED BY TAX MAP KEY 8-6-02:22, 23 AND 36.

BE IT ORDAINED BY THE COUNCIL OF THE COUNTY OF HAWAII:

SECTION 1. Section 7.01 of Ordinance No. 63 (Zoning Ordinance) Revised Ordinances of the County of Hawaii 1967, as amended, is hereby further amended by adding thereto the following subsection:

"7.01(a). The district classificaton of the following area situated at Kealia 2nd, South Kona, Hawaii, shall be Agricultural (A-1a):

Beginning at a pipe at the northwest corner of this parcel of land the coordinates of said point of beginning referred to Hawaiian Plane Coordinate Grid System Zone 1 being 204,637.25 feet North and 368,741.26 feet East and running by plane azimuths measured clockwise from true South:

1. 260° 56' 158.30 feet along ancient trail along remainder of L. C. Aw. 10744, Apana 2 to Puakou to a pipe;
2. 258° 32' 264.35 feet along ancient trail along remainder of L. C. Aw. 10744, Apana 2 to Puakou to a pipe;
3. 248° 51' 302.10 feet along ancient trail along remainder of L. C. Aw. 10744, Apana 2 to Puakou to a pipe;
4. 243° 07' 30" 142.50 feet along ancient trail along remainder of L. C. Aw. 10744, Apana 2 to Puakou to a pipe;
5. 253° 16' 165.90 feet along ancient trail along remainder of L. C. Aw. 10744, Apana 2 to Puakou to a pipe;
6. 255° 27' 71.70 feet along ancient trail along remainder of L. C. Aw. 10744, Apana 2 to Puakou to a pipe;
7. 263° 42' 30" 11.40 feet along ancient trail along remainder of L. C. Aw. 10744, Apana 2 to Puakou to a pipe;

8.	299 ^o	07'		14.95 feet along ancient trail along remainder of L. C. Aw. 10744, Apana 2 to Puakou to a pipe;
9.	337 ^o	53'	30"	110.90 feet along remainder of L. C. Aw 10744, Apana 2 to Puakou and L. C. Aw. 1938-C to Kaahui to a pipe;
10.	338 ^o	57'	30"	119.15 feet along remainder of L. C. Aw. 1938-C to Kaahui and L. C. Aw. 7716, Apana 6 to Ruth Keelikolani to a pipe;
11.	336 ^o	18'		17.40 feet along remainder of L. C. Aw. 7716, Apana 6 to Ruth Keelikolani to a pipe;
				Thence following L. C. Aw. 9971, Apana 29 to William F. Leleihoku for the next seventeen (17) courses the direct azimuth and distance between points being:
12.	69 ^o	17'		51.00 feet to a pipe;
13.	61 ^o	51'		39.80 feet to a pipe;
14.	89 ^o	30'		13.95 feet to a nail in rock;
15.	73 ^o	59'		14.60 feet to a nail in rock;
16.	59 ^o	52'		21.95 feet to a spike in rock;
17.	70 ^o	42'	30"	60.60 feet to a pipe;
18.	76 ^o	07'	30"	94.10 feet to a pipe;
19.	63 ^o	45'		45.25 feet to a pipe;
20.	67 ^o	17'	30"	132.10 feet to a pipe;
21.	68 ^o	19'		130.60 feet to a pipe;
22.	75 ^o	53'	30"	201.95 feet to a pipe;
23.	79 ^o	40'	30"	93.75 feet to a pipe;
24.	76 ^o	31'	30"	120.45 feet to a pipe;
25.	81 ^o	51'	30"	183.15 feet to a pipe;
26.	183 ^o	15'	30"	140.95 feet to a pipe;
27.	87 ^o	16'	30"	20.00 feet along remainder of L. C. Aw. 1938-C to Kaahui to a pipe;
28.	176 ^o	03'		113.59 feet along remainder of L. C. Aw. 1938-C to Kaahui and L. C. Aw. 10744, Apana 2 to Puakou to the point of

beginning and containing an area of
7.233 acres.

"All as outlined in red on the map attached hereto, marked
Exhibit "A" and by reference made a part hereof."

SECTION 2. Section 1 of this ordinance shall take effect forthwith
upon the conditions that (A) the owner or lessee of the subject area be
responsible for submittal of a subdivision plan substantially as presented
and for securing tentative approval of the plan within one (1) year from
the date of approval of the change of zone; and (B) the owner or lessee
of the subject area be responsible for the construction of two (2)
dwellings within three (3) years of the date of approval of the change
of zone. Should these conditions not be met, action may be taken to
nullify any subdivision approval and to reclassify the subject area to a
more appropriate designation.

SECTION 3. In the event that any portion of this ordinance is
declared invalid, such invalidity shall not affect the other parts of
this ordinance.

SECTION 4. This ordinance shall take effect upon its approval.

INTRODUCED BY:

A handwritten signature in black ink, appearing to read "John J. ...". The signature is written over a horizontal line that serves as a separator between the signature and the title below it.
Councilman, County of Hawaii

Hilo, Hawaii

Date of Introduction: June 6, 1973

Date of Adoption: June 20, 1973

Effective Date: June 27, 1973

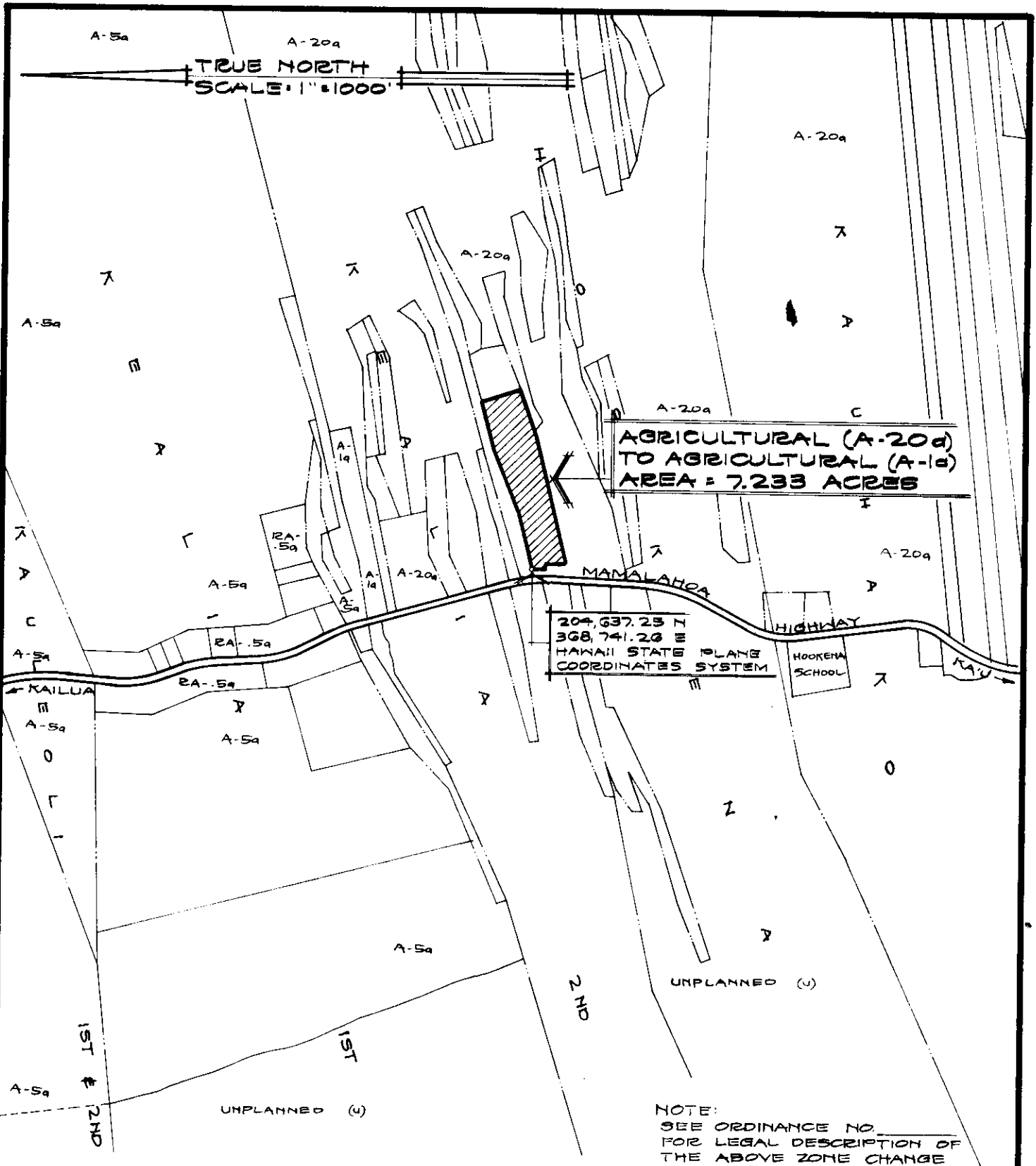

AMENDMENT TO THE COUNTY ZONING ORDINANCE

AMENDMENT NO. 1 OF SECTION 7.01, THE NORTH AND SOUTH KONA DISTRICTS ZONE MAP, PORTION OF ORDINANCE NO. 74, CHANGING THE DISTRICT CLASSIFICATION FROM AGRICULTURAL (A-20a) TO AGRICULTURAL (A-1a) AT KEALIA 2ND, SOUTH KONA, HAWAII.

DATE OF PUBLIC HEARING: APRIL 6, 1973

DATE OF APPROVAL:

ORDINANCE NO.

PREPARED BY: PLANNING DEPARTMENT
COUNTY OF HAWAII

TMK 8-6-02: 22, 23 & 36

APRIL 23, 1973

EXHIBIT "A"



NOTE:
 SEE ORDINANCE NO. _____
 FOR LEGAL DESCRIPTION OF
 THE ABOVE ZONE CHANGE

AMENDMENT TO THE COUNTY ZONING ORDINANCE

AMENDMENT NO. 1 OF SECTION 7.01, THE NORTH AND SOUTH KONA DISTRICTS ZONE MAP, PORTION OF ORDINANCE NO. 74, CHANGING THE DISTRICT CLASSIFICATION FROM AGRICULTURAL (A-20a) TO AGRICULTURAL (A-1a) AT KEALIA 2ND, SOUTH KONA, HAWAII.

DATE OF PUBLIC HEARING: APRIL 6, 1973
 DATE OF APPROVAL:
 ORDINANCE NO.
 PREPARED BY: PLANNING DEPARTMENT
 COUNTY OF HAWAII



AMENDMENT TO THE COUNTY ZONING ORDINANCE

AMENDMENT NO. 1 OF SECTION 7.01, THE NORTH AND SOUTH KONA DISTRICTS ZONE MAP, PORTION OF ORDINANCE NO. 74, CHANGING THE DISTRICT CLASSIFICATION FROM AGRICULTURAL (A-20a) TO AGRICULTURAL (A-1a) AT KEALIA 2ND, SOUTH KONA, HAWAII.

DATE OF PUBLIC HEARING: APRIL 6, 1973
 DATE OF APPROVAL:
 ORDINANCE NO.
 PREPARED BY: PLANNING DEPARTMENT
 COUNTY OF HAWAII

Hilo, Hawaii

Date: June 6, 1973

FIRST READING			
	AYES	NOES	A/E
Carpenter	X		
De Luz	X		
Farias	X		
Fujii	X		
Hisaoka	X		
Kawahara	X		
Matayoshi	X		
Yadao	X		
Chr. Yamada	X		
	9		

June 12, 1973

Publication Date: _____

Hilo, Hawaii

Date: June 20, 1973

SECOND & FINAL READING			
	AYES	NOES	A/E
Carpenter	X		
De Luz	X		
Farias	X		
Fujii	X		
Hisaoka	X		
Kawahara	X		
Matayoshi	X		
Yadao	X		
Chr. Yamada	X		
	9		

JUL 6 1973

Publication Date: _____

We do hereby certify that the foregoing BILL was adopted by the County Council and published as indicated above.

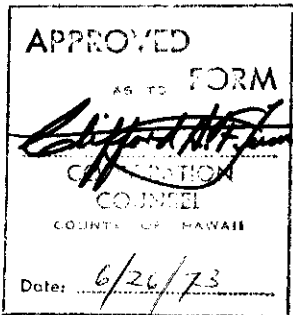

Robert M. Yamada

Council Chairman

Tadashi Suzuki

County Clerk

Approved/Disapproved this 27th day of June, 19 73

Shunichi Kimura

Mayor, County of Hawaii

Bill No. 997
Reference: C-312/PRDC-10
M.B. No. 240-261
Ord. No. 593

Bill No. 997 - 1973

AN ORDINANCE AMENDING SECTION 7.01, THE NORTH AND SOUTH KONA DISTRICTS ZONE MAP, ORDINANCE NO. 63 (ZONING ORDINANCE), REVISED ORDINANCES OF THE COUNTY OF HAWAII 1967, AS AMENDED, BY CHANGING THE DISTRICT CLASSIFICATION FROM AGRICULTURAL (A-20a) TO AGRICULTURAL (A-1a) AT KEALIA 2nd, SOUTH KONA, HAWAII, COVERED BY TAX MAP KEY 8-6-02:22, 23 AND 36.

This Bill amends the North and South Kona Districts Zone Map by changing the district classification from Agricultural (A-20a) to Agricultural (A-1a) at Kealia 2nd, S. Kona.

Date Introduced: June 6, 1973

Copies of the foregoing Bill, in full, are on file in the Office of the County Clerk for use and examination by the public.

I hereby certify that the foregoing Bill passed first reading at the meeting of the County Council on June 6, 1973, by the following aye and no vote:

AYES: Councilmen Carpenter, De Luz, Farias, Fujii, Hisaoka, Kawahara, Matayoshi, Yadao and Chairman Yamada - 9.

NOES: None.

Tadashi Suzuki

COUNTY CLERK
COUNTY OF HAWAII

NO. 63 (ZONING ORDINANCE),
REVISED ORDINANCES OF THE
COUNTY OF HAWAII 1967, AS AMEN-
DED, BY CHANGING THE DISTRICT
CLASSIFICATION FROM
AGRICULTURAL (A-20a) TO
AGRICULTURAL (A-1a) AT KEALIA
2nd, SOUTH KONA, HAWAII, COVERED
BY TAX MAP KEY 8-6-02:22, 23 AND 36.

This Bill amends the North and South
Kona Districts Zone Map by changing the
district classification from Agricultural
(A-20a) to Agricultural (A-1a) at Kealia
2nd, S. Kona.

Date Introduced: June 6, 1973

Copies of the foregoing Bill, in full, are
on file in the Office of the County Clerk for
use and examination by the public.

I hereby certify that the foregoing Bill
passed first reading at the meeting of the
County Council on June 6, 1973, by the
following aye and no vote:

AYES: Councilmen Carpenter, De Luz,
Farias, Fujii, Hisaoka, Kawahara,
Matayoshi, Yadao and Chairman
Yamada—9.

NOES: None.

TADASHI SUZUKI
COUNTY CLERK
COUNTY OF HAWAII

(158—Hawaii Tribune-Herald: June 12,
1973.)

ORDINANCE NO. 593
(Bill No. 997-1973)

AN ORDINANCE AMENDING SECTION 7.01, THE NORTH AND SOUTH KONA DISTRICTS ZONE MAP, ORDINANCE NO. 63 (ZONING ORDINANCE), REVISED ORDINANCES OF THE COUNTY OF HAWAII 1967, AS AMENDED, BY CHANGING THE DISTRICT CLASSIFICATION FROM AGRICULTURAL (A-20a) TO AGRICULTURAL (A-1a) AT KEALIA 2ND, SOUTH KONA, HAWAII, COVERED BY TAX MAP KEY 8-6-02:22, 23 AND 36.

Date Approved: June 20, 1973
Date Effective: June 27, 1973

Copies of the foregoing Ordinance, in full, are on file in the Office of the County Clerk for use and examination by the public.

I hereby certify that the foregoing Ordinance passed second and final reading at the meeting of the County Council on June 20, 1973, by the following aye and no vote:

AYES: Councilmen Carpenter, De Luz, Farias, Fujii, Hisaoka, Kawahara, Matayoshi, Yadao and Chairman Yamada - 9.

NOES: None.

Tadashi Suzuki

COUNTY CLERK
COUNTY OF HAWAII

7.01. THE NORTH AND SOUTH KONA DISTRICTS ZONE MAP, ORDINANCE NO. 63 (ZONING ORDINANCE), REVISED ORDINANCES OF THE COUNTY OF HAWAII 1967, AS AMENDED, BY CHANGING THE DISTRICT CLASSIFICATION FROM AGRICULTURAL (A-20a) TO AGRICULTURAL (A-1a) AT KEALIA 2ND, SOUTH KONA, HAWAII, COVERED BY TAX MAP KEY 8-6-02:22, 23 AND 36.

Date Approved: June 20, 1973
Date Effective: June 27, 1973

Copies of the foregoing Ordinance, in full, are on file in the Office of the County Clerk for use and examination by the public.

I hereby certify that the foregoing Ordinance passed second and final reading at the meeting of the County Council on June 20, 1973, by the following aye and no vote:

AYES: Councilmen Carpenter, De Luz, Farias, Fujii, Hisaoka, Kawahara, Matayoshi, Yadao and Chairman Yamada-9.

NOES: None.

Tadashi Suzuki
COUNTY CLERK
COUNTY OF HAWAII

Tadashi Suzuki
COUNTY CLERK

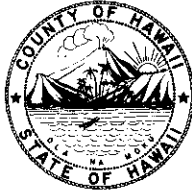

Robert Shioji
DEPUTY COUNTY CLERK

OFFICE OF THE COUNTY CLERK

COUNTY OF HAWAII
HILO, HAWAII 96720

Mayor Shunichi Kimura
County of Hawaii
Hilo, Hawaii

I hereby transmit Ordinance Bill No. 997 passed by
the County Council on second and final reading.

Tadashi Suzuki
COUNTY CLERK

Encl.

Dated: June 22, 1973