

COUNTY OF HAWAII - STATE OF HAWAII

ORDINANCE NO. 611

AN ORDINANCE AMENDING SECTION 7.02, THE NORTH KONA ZONE MAP, ARTICLE 2, CHAPTER 8 (ZONING CODE), HAWAII COUNTY CODE, AS AMENDED, BY CHANGING THE DISTRICT CLASSIFICATION FROM AGRICULTURAL (A-20a) TO AGRICULTURAL (A-1a) AT HONOKOHAU 1ST, NORTH KONA, HAWAII, COVERED BY TAX MAP KEY 7-4-02:PORTION OF 8.

BE IT ORDAINED BY THE COUNCIL OF THE COUNTY OF HAWAII:

SECTION 1. Section 7.02 of Article 2, Chapter 8 (Zoning Code), Hawaii County Code, as amended, is hereby further amended by adding thereto the following subsection:

"7.02(ii). The district classification of the following area situated at Honokohau 1st, North Kona, Hawaii, shall be Agricultural (A-1a):

Beginning at a 3/4 inch pipe in concrete at the northwest corner of this parcel of land, being also the southwest corner of Honokohau Tank Site, the coordinates of said point of beginning referred to Government Survey Triangulation Station 'KAILUA' being 16,192.15 feet North and 7,677.90 feet East and running by azimuths measured clockwise from true South:

1. 259° 32' 366.81 feet along Honokohau Tank Site, crossing over a 3/4 inch pipe in concrete at 99.84 feet and along remainder of L. C. Aw. 11216, Apana 36 to M. Kekauonohi;
2. 349° 32' 250.00 feet along remainder of L. C. Aw. 11216, Apana 36 to M. Kekauonohi;
3. 79° 32' 330.15 feet along remainder of L. C. Aw. 11216, Apana 36 to M. Kekauonohi;
4. 161° 11' 30" 252.67 feet following along portion of stone wall to the point of beginning and containing an area of 2.000 acres.

All as outlined in red on the map attached hereto, marked Exhibit 'A' and by reference made a part hereof."

SECTION 2. Section 1 of this ordinance shall take effect forthwith upon the condition that the applicant submit and secure tentative approval of the proposed subdivision plan within one (1) year of the date of approval of the change of zone and also be responsible for securing final subdivision approval.

SECTION 3. In the event that any portion of this ordinance is declared invalid, such invalidity shall not affect the other parts of this ordinance.

SECTION 4. This ordinance shall take effect upon its approval.

INTRODUCED BY:

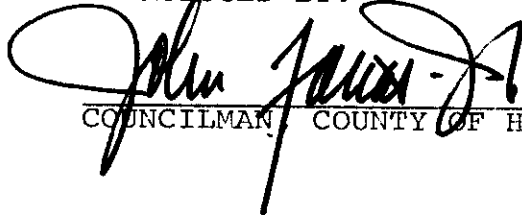
  
COUNCILMAN, COUNTY OF HAWAII

Hilo, Hawaii

Date of Introduction: October 24, 1973

Date of Adoption: November 20, 1973

Effective Date: November 28, 1973

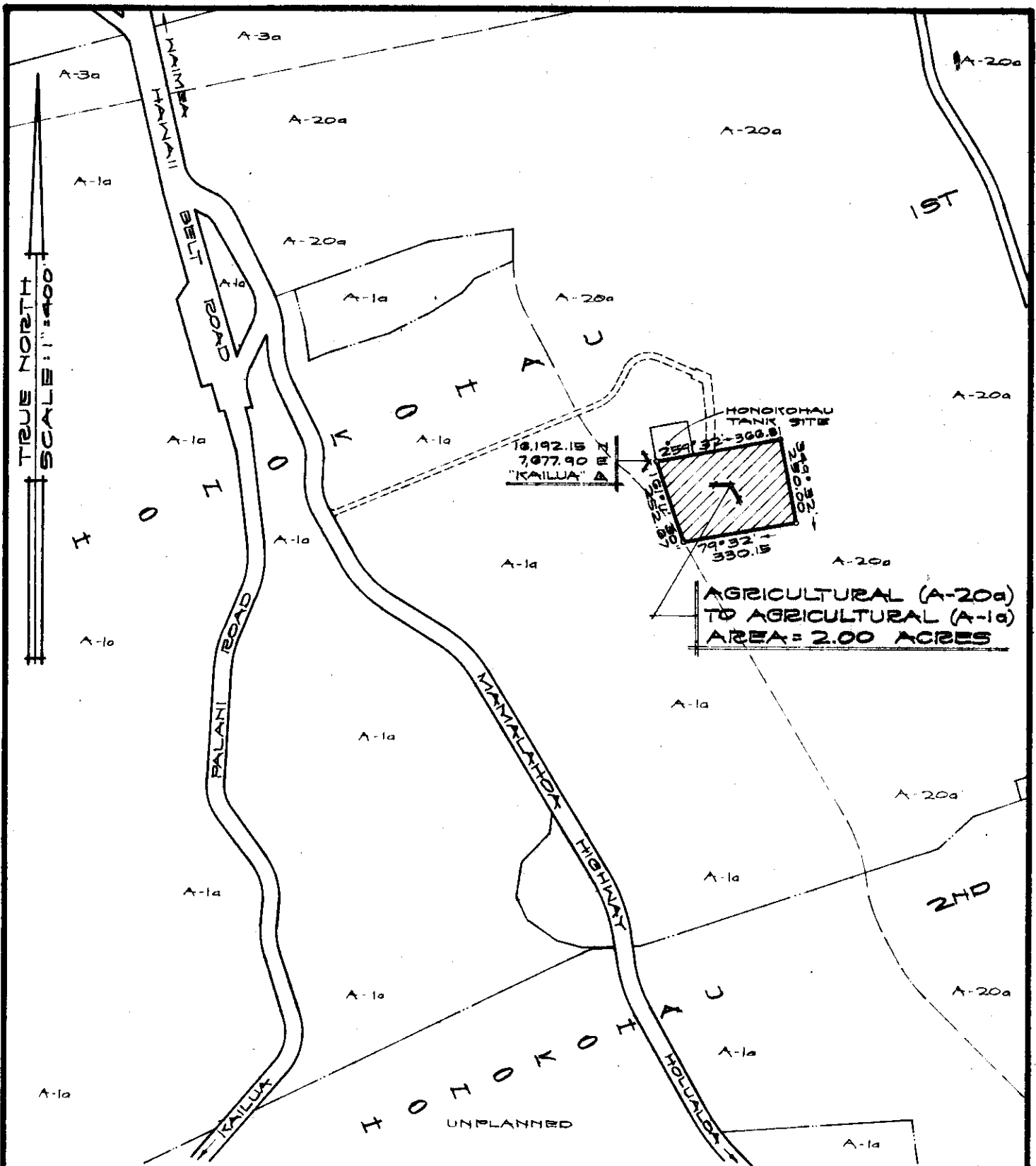

**AMENDMENT TO THE COUNTY ZONING ORDINANCE**

AMENDMENT NO. 35 OF SECTION 7.02, THE NORTH KONA ZONE MAP, PORTION OF ORDINANCE NO. 74, CHANGING THE DISTRICT CLASSIFICATION FROM AGRICULTURAL (A-20a) TO AGRICULTURAL (A-1a) AT HONOKOHAU 1ST, NORTH KONA, HAWAII.

DATE OF PUBLIC HEARING: JULY 19, 1973  
 DATE OF APPROVAL:  
 ORDINANCE NO.:  
 PREPARED BY: PLANNING DEPARTMENT  
 COUNTY OF HAWAII

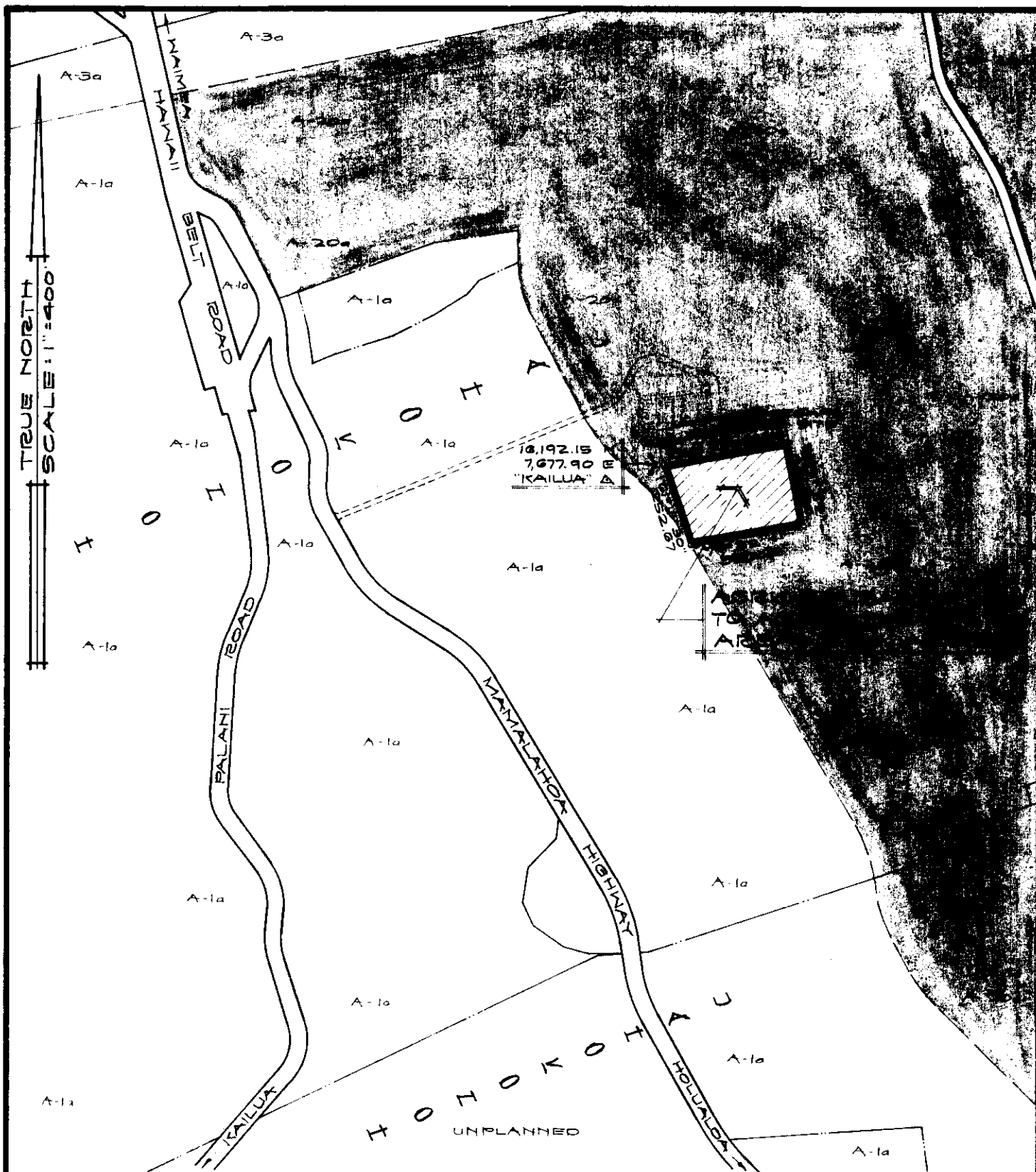

**AMENDMENT TO THE COUNTY ZONING ORDINANCE**

AMENDMENT NO. 35 OF SECTION 7.02, THE NORTH KONA ZONE MAP, PORTION OF ORDINANCE NO. 74, CHANGING THE DISTRICT CLASSIFICATION FROM AGRICULTURAL (A-20a) TO AGRICULTURAL (A-1a) AT HONOKOHAU 1ST, NORTH KONA, HAWAII.

DATE OF PUBLIC HEARING: JULY 19, 1973  
 DATE OF APPROVAL:  
 ORDINANCE NO.:  
 PREPARED BY: PLANNING DEPARTMENT  
 COUNTY OF HAWAII

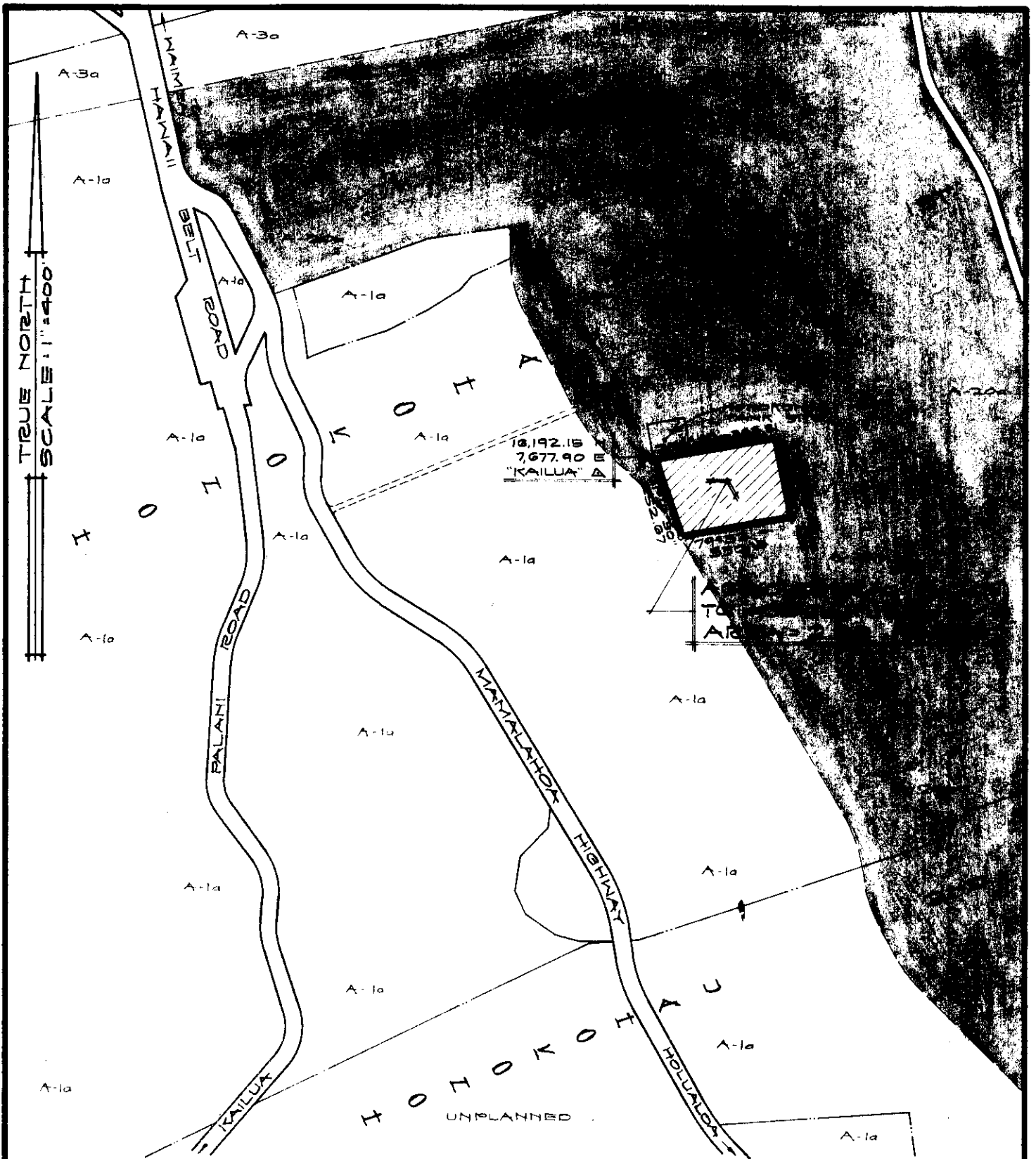

**AMENDMENT TO THE COUNTY ZONING ORDINANCE**

AMENDMENT NO. 35 OF SECTION 7.02, THE NORTH KONA ZONE MAP, PORTION OF ORDINANCE NO. 74, CHANGING THE DISTRICT CLASSIFICATION FROM AGRICULTURAL (A-20a) TO AGRICULTURAL (A-1a) AT HONOKOHAU 1ST, NORTH KONA, HAWAII.

DATE OF PUBLIC HEARING: JULY 19, 1973  
 DATE OF APPROVAL:  
 ORDINANCE NO.:  
 PREPARED BY: PLANNING DEPARTMENT  
 COUNTY OF HAWAII

Hilo, Hawaii  
Date: October 24, 1973

FIRST READING			
	AYES	NOES	A/E
Carpenter	X		
De Luz	X		
Farias	X		
Fujii	X		
Hisaoka	X		
Kawahara	X		
Matayoshi	X		
Yadao	X		
Chr. Yamada	X		
	9		

Publication Date: October 29, 1973

Hilo, Hawaii  
Date: November 20, 1973

SECOND & FINAL READING			
	AYES	NOES	A/E
Carpenter	X		
De Luz	X		
Farias	X		
Fujii	X		
Hisaoka	X		
Kawahara	X		
Matayoshi	X		
Yadao	X		
Chr. Yamada	X		
	9		

Publication Date: DEC 2 1973

We do hereby certify that the foregoing BILL was adopted by the County Council and published as indicated above.

**APPROVED as to  
FORM and NEATNESS**

*Clifford N. H. Kimura*

COPY TO THE COUNTY CLERK  
COUNTY OF HAWAII

Date: 11/21/73

*Robert M. Yamada*  
\_\_\_\_\_  
Council Chairman

*Robert M. Fujii*  
\_\_\_\_\_  
County Clerk

Approved/Disapproved this 28<sup>th</sup> day of  
November, 1973

*Haruichi Kimura*  
\_\_\_\_\_  
Mayor, County of Hawaii

Bill No. 1015  
Reference: C-453/PRDC-18  
M.B. No. 410  
Ord. No. 611

Tadashi Suzuki  
COUNTY CLERK

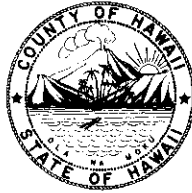

Robert Shioji  
DEPUTY COUNTY CLERK

OFFICE OF THE COUNTY CLERK

COUNTY OF HAWAII  
HILO, HAWAII 96720

Mayor Shunichi Kimura  
County of Hawaii  
Hilo, Hawaii

I hereby transmit Ordinance Bill No. 1015 passed by  
the County Council on second and final reading.

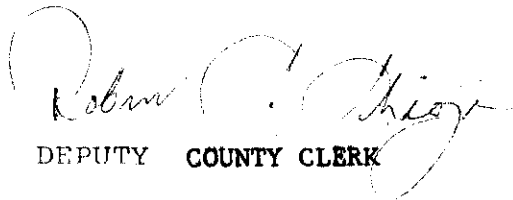
  
DEPUTY COUNTY CLERK

Encl.

ORDINANCE NO. 63 (ZONING ORDINANCE), REVISED ORDINANCES OF THE COUNTY OF HAWAII 1967, AS AMENDED, BY CHANGING THE DISTRICT CLASSIFICATION FROM AGRICULTURAL (A-20a) TO AGRICULTURAL (A-1a) AT HONOKOHAU 1ST, NORTH KONA, HAWAII, COVERED BY TAX MAP KEY 7-4-02: PORTION OF 8.

This Bill proposes to amend the North Kona Zone Map by changing the district classification from Agricultural (A-20a) to Agricultural (A-1a) at Honokohau 1st, N. Kona.

Date Introduced: October 24, 1973

Copies of the foregoing Bill, in full, are on file in the Office of the County Clerk for use and examination by the public.

I hereby certify that the foregoing Bill passed first reading at the meeting of the County Council on October 24, 1973, by the following aye and no vote:

AYES: Councilmen Carpenter, De Luz, Faries, Full, Hisaoka, Kawahara, Matayoshi, Yadao and Chairmen Yamada—9.

NOES: None.

Tadashi Suzuki  
COUNTY CLERK  
COUNTY OF HAWAII

(175—Hawaii Tribune-Herald:  
Oct. 29, 1973.)

Dated: Nov. 21, 1973

ORDINANCE NO. 611  
(Bill No. 1015-1973)

AN ORDINANCE AMENDING SECTION 7.02, THE NORTH KONA ZONE MAP, ARTICLE 2, CHAPTER 8 (ZONING CODE), HAWAII COUNTY CODE, AS AMENDED, BY CHANGING THE DISTRICT CLASSIFICATION FROM AGRICULTURAL (A-20a) TO AGRICULTURAL (A-1a) AT HONOKOHAU 1ST, NORTH KONA, HAWAII, COVERED BY TAX MAP KEY 7-4-02:PORTION OF 8.

Date Approved: November 20, 1973  
Date Effective: November 28, 1973

Copies of the foregoing Ordinance, in full, are on file in the Office of the County Clerk for use and examination by the public.

---

I hereby certify that the foregoing Ordinance passed second and final reading at the meeting of the County Council on November 20, 1973, by the following aye and no vote:

AYES: Councilmen Carpenter, De Luz, Farias, Fujii, Hisaoka, Kawahara, Matayoshi, Yadao and Chairman Yamada - 9.

NOES: None.

*Tadashi Suzuki*

COUNTY CLERK  
COUNTY OF HAWAII

ORDINANCE NO. 611  
BILL NO. 1015-1973  
AN ORDINANCE AMENDING SECTION 7.02, THE NORTH KONA ZONE MAP, ARTICLE 2, CHAPTER 8 (ZONING CODE), HAWAII COUNTY CODE, AS AMENDED, BY CHANGING THE DISTRICT CLASSIFICATION FROM AGRICULTURAL (A-20a) TO AGRICULTURAL (A-1a) AT HONOKOHAU 1ST, NORTH KONA, HAWAII, COVERED BY TAX MAP KEY 7-4-02:PORTION OF 8.

Date Approved: November 20, 1973  
Date Effective: November 28, 1973  
Copies of the foregoing Ordinance, in full, are on file in the Office of the County Clerk for use and examination by the public.

I hereby certify that the foregoing Ordinance passed second and final reading at the meeting of the County Council on November 20, 1973, by the following aye and no vote:

AYES: Councilmen Carpenter, De Luz, Farias, Fujii, Hisaoka, Kawahara, Matayoshi, Yadao and Chairman Yamada - 9.

NOES: None.  
TADASHI SUZUKI  
COUNTY CLERK  
COUNTY OF HAWAII