

COUNTY OF HAWAII - STATE OF HAWAII

ORDINANCE NO. 612

AN ORDINANCE AMENDING SECTION 7.02, THE NORTH KONA ZONE MAP, ARTICLE 2, CHAPTER 8 (ZONING CODE), HAWAII COUNTY CODE, AS AMENDED, BY CHANGING THE DISTRICT CLASSIFICATION FROM AGRICULTURAL (A-5a) TO AGRICULTURAL (A-1a), AT KAHULUI 1ST, NORTH KONA, HAWAII, COVERED BY TAX MAP KEY 7-5-16:33.

BE IT ORDAINED BY THE COUNCIL OF THE COUNTY OF HAWAII:

SECTION 1. Section 7.02 of Article 2, Chapter 8 (Zoning Code), Hawaii County Code, as amended, is hereby further amended by adding thereto the following subsection:

"7.02(hh). The district classification of the following area situated at Kahului 1st, North Kona, Hawaii, shall be Agricultural (A-1a):

Beginning at a pipe at the southeast corner of this parcel of land at the northeast corner of R. P. 7059, L. C. Aw. 7350 to Kialoa and on the westerly side of Mamalahoa Highway the coordinates of said point of beginning referred to Government Survey Triangulation Station 'KAILUA' being 3870.04 feet North and 15,740.89 feet East and running by azimuths measured clockwise from true South:

1. 81° 31' 50" 161.41 feet along stone wall north side of R. P. 7059, L. C. Aw. 7350 to Kialoa to a pipe;
2. 78° 05' 30" 149.51 feet along same to a pipe;
3. 79° 37' 10" 72.70 feet along same to a pipe;
4. 103° 17' 79.65 feet along same to a pipe;
5. 88° 25' 205.55 feet along same to a pipe;
6. 88° 17' 40" 205.43 feet along same;
7. 87° 34' 50" 143.95 feet along same to a pipe at the northwest corner of R. P. 7059, L. C. Aw. 7350 to Kialoa;
8. 167° 19' 108.21 feet along stone wall, remainder of Grant 976 to Kapae 1 to a pipe;

9. 262° 42' 30" 101.09 feet along stone wall, south boundary of Grant 4277 to A. F. Beard;
10. 247° 43' 50" 16.00 feet along same;
11. 262° 19' 20" 133.72 feet along same to a spike;
12. 261° 49' 132.00 feet along same;
13. 254° 04' 95.32 feet along same;
14. 252° 06' 40.20 feet along same;
15. 267° 10' 40" 36.93 feet along same to a spike;
16. 264° 03' 30" 132.79 feet along same to a spike;
17. 241° 10' 19.32 feet along same to a pipe;
18. 256° 08' 30" 145.26 feet along same to a pipe;
19. 265° 20' 39.93 feet along same to a pipe;
20. 246° 49' 20" 49.80 feet along same to a pipe;
21. 319° 52' 40" 85.86 feet along west side of Mamalahoa Highway to a pipe;
22. 329° 02' 30" 91.31 feet along same to a pipe;
23. 351° 39' 30" 71.69 feet along same to the point of beginning and containing an area of 3.948 acres.

All as outlined in red on the map attached hereto, marked Exhibit 'A' and by reference made a part hereof."

SECTION 2. Section 1 of this ordinance shall take effect forthwith upon the conditions that (A) the applicant submit and secure tentative approval of the proposed subdivision plan within one (1) year of the date of approval of the change of zone. The applicant shall also assume the responsibility for securing final subdivision approval; and (B) construction of the proposed dwelling commence within one (1) year of the date of final subdivision approval. Should these conditions not be met, action shall be taken to nullify any subdivision approval and to reclassify the subject area to a more appropriate designation.

SECTION 3. In the event that any portion of this ordinance is declared invalid, such invalidity shall not affect the other parts of this ordinance.

SECTION 4. This ordinance shall take effect upon its approval.

INTRODUCED BY:

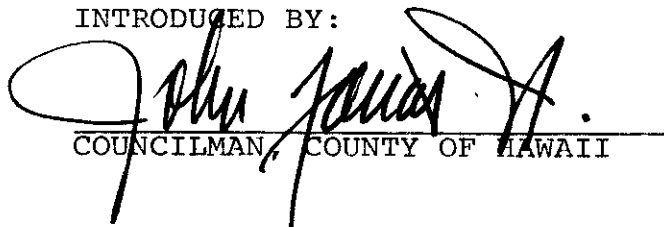

COUNCILMAN, COUNTY OF HAWAII

Hilo, Hawaii

Date of Introduction: October 24, 1973

Date of Adoption: November 20, 1973

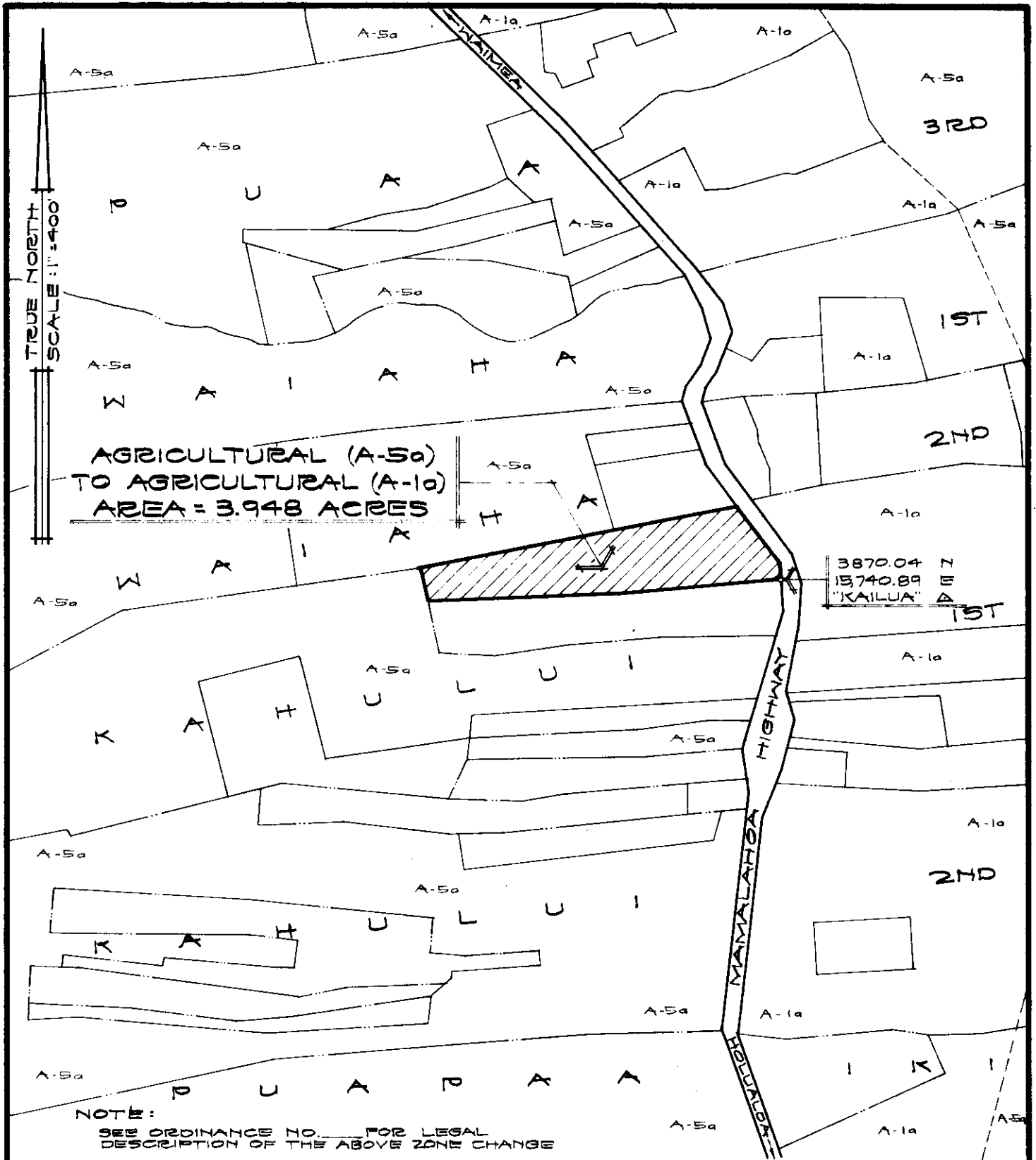
Effective Date: November 27, 1973



AMENDMENT TO THE COUNTY ZONING ORDINANCE

AMENDMENT NO. 36 OF SECTION 7.02, THE NORTH KONA ZONE MAP, PORTION OF ORDINANCE NO. 74, CHANGING THE DISTRICT CLASSIFICATION FROM AGRICULTURAL (A-5a) TO AGRICULTURAL (A-1a) AT KAHULUI 1ST, NORTH KONA, HAWAII.

DATE OF PUBLIC HEARING: JULY 19, 1973

DATE OF APPROVAL:

ORDINANCE NO.:

PREPARED BY: PLANNING DEPARTMENT
COUNTY OF HAWAII

TMK: 7-5-16:33

JUNE 27, 1973

EXHIBIT "A"

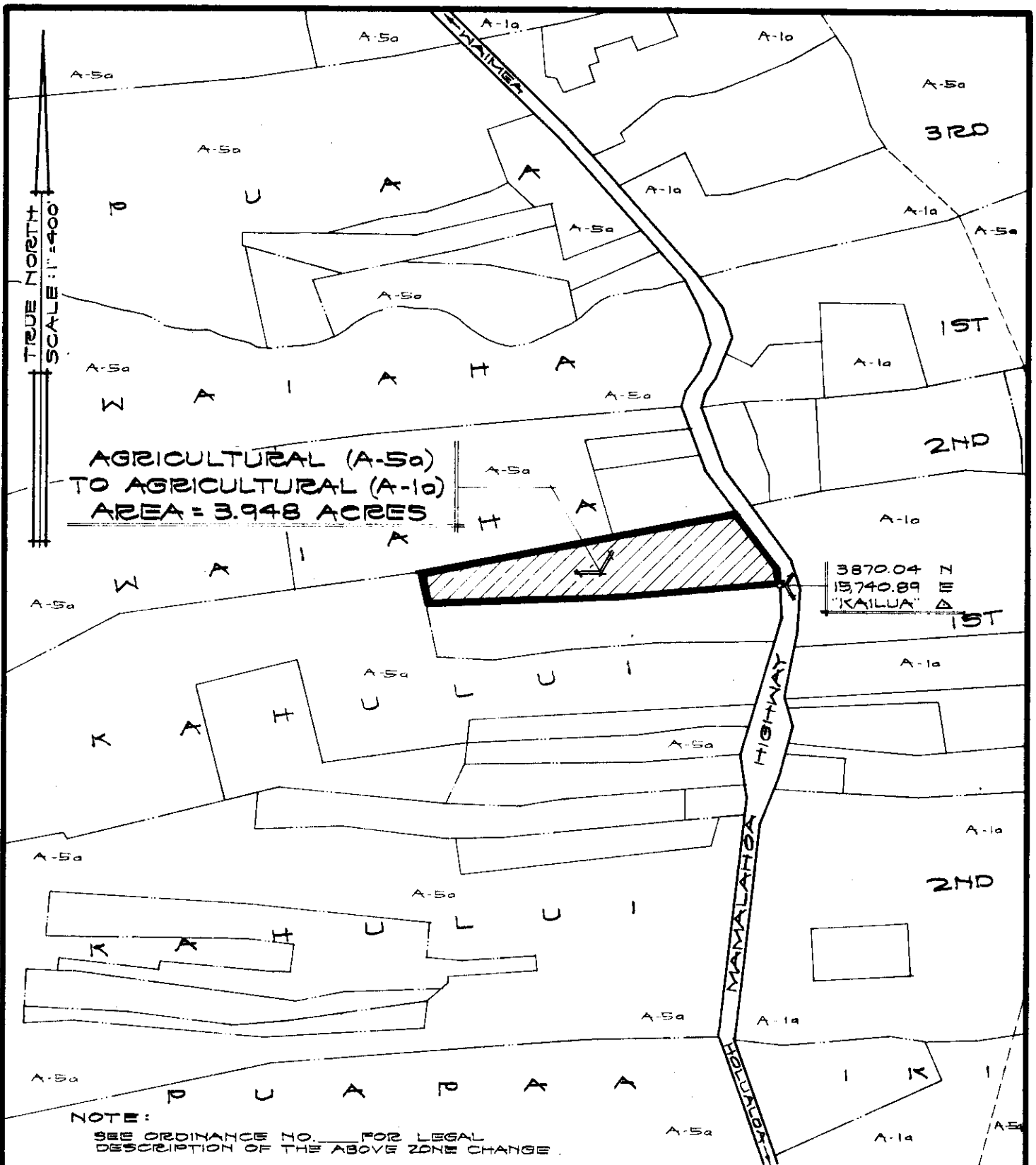

AMENDMENT TO THE COUNTY ZONING ORDINANCE

AMENDMENT NO. 36 OF SECTION 702, THE NORTH KONA ZONE MAP, PORTION OF ORDINANCE NO. 74, CHANGING THE DISTRICT CLASSIFICATION FROM AGRICULTURAL (A-5a) TO AGRICULTURAL (A-1a) AT KAHULUI 1ST, NORTH KONA, HAWAII.

DATE OF PUBLIC HEARING: JULY 19, 1973
 DATE OF APPROVAL:
 ORDINANCE NO.:
 PREPARED BY: PLANNING DEPARTMENT
 COUNTY OF HAWAII

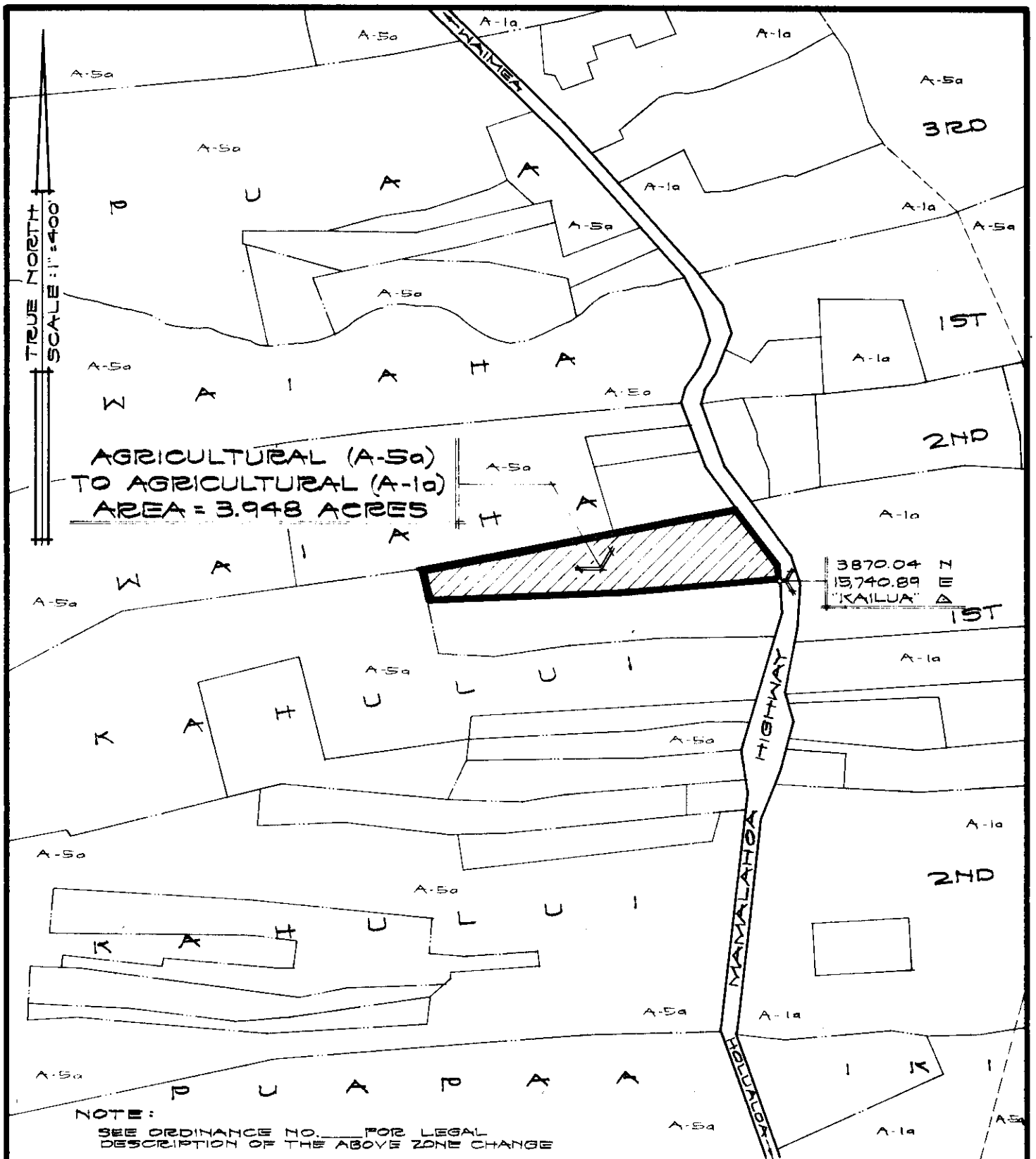

AMENDMENT TO THE COUNTY ZONING ORDINANCE

AMENDMENT NO. 36 OF SECTION 702, THE NORTH KONA ZONE MAP, PORTION OF ORDINANCE NO. 74, CHANGING THE DISTRICT CLASSIFICATION FROM AGRICULTURAL (A-5a) TO AGRICULTURAL (A-1a) AT KAHULUI 1ST, NORTH KONA, HAWAII.

DATE OF PUBLIC HEARING: JULY 19, 1973
 DATE OF APPROVAL:
 ORDINANCE NO.:
 PREPARED BY: PLANNING DEPARTMENT
 COUNTY OF HAWAII

TMK: 7-5-16:33

JUNE 27, 1973

EXHIBIT "A"

Hilo, Hawaii
 Date: October 24, 1973

FIRST READING			
	AYES	NOES	A/E
Carpenter	X		
De Luz	X		
Farias	X		
Fujii	X		
Hisaoka	X		
Kawahara	X		
Matayoshi	X		
Yadao	X		
Chr. Yamada	X		
	9		

Hilo, Hawaii
 Date: November 20, 1973

SECOND & FINAL READING			
	AYES	NOES	A/E
Carpenter	X		
De Luz	X		
Farias	X		
Fujii	X		
Hisaoka	X		
Kawahara	X		
Matayoshi	X		
Yadao	X		
Chr. Yamada	X		
	9		

Publication Date: October 29, 1973

Publication Date: DEC 2 1973

We do hereby certify that the foregoing BILL was adopted by the County Council and published as indicated above.

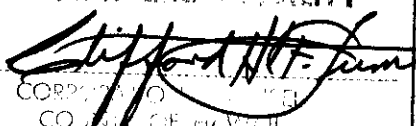
APPROVED as to
 FORM and LEGALITY

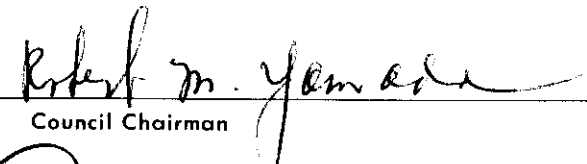
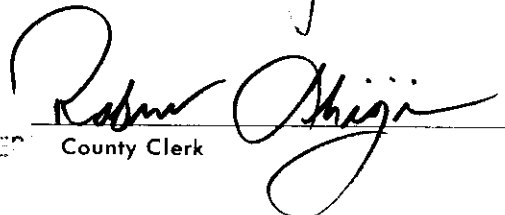
 CLIFFORD H. KIM
 COUNTY CLERK
 Date 11/21/73

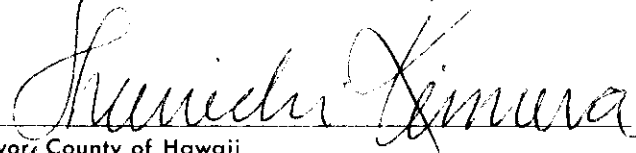

 Council Chairman

 County Clerk

Approved/Disapproved this 27th day of
November, 1973

 Mayor, County of Hawaii

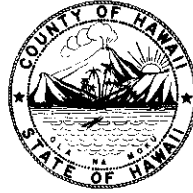
Bill No. 1017
 Reference: C-455/PRDC-18
 M.B. No. 410
 Ord. No. 612

Tadashi Suzuki
COUNTY CLERK



Robert Shioji
DEPUTY COUNTY CLERK

OFFICE OF THE COUNTY CLERK

COUNTY OF HAWAII
HILO, HAWAII 96720

Mayor Shunichi Kimura
County of Hawaii
Hilo, Hawaii

I hereby transmit Ordinance Bill No. 1017 passed by
the County Council on second and final reading.

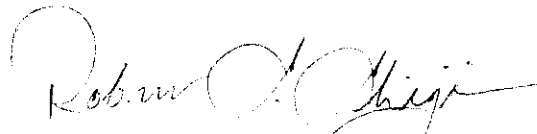
DEPUTY COUNTY CLERK

Encl.

Dated: Nov. 21, 1973

AN ORDINANCE AMENDING SECTION 7.05 OF THE NORTH KONA ZONE MAP, ORDINANCE NO. 63 (ZONING ORDINANCE), REVISED ORDINANCES OF THE COUNTY OF HAWAII 1967, AS AMENDED, BY CHANGING THE DISTRICT CLASSIFICATION FROM AGRICULTURAL (A-5a) TO AGRICULTURAL (A-1a), AT KAHULUI 1ST, NORTH KONA, HAWAII, COVERED BY TAX MAP KEY 7-3-16:33.

This Bill proposes to amend the North Kona Zone Map by changing the district classification from Agricultural (A-5a) to Agricultural (A-1a) at Kahului 1st, N. Kona.

Date introduced: October 24, 1973

Copies of the foregoing Bill, in full, are on file in the Office of the County Clerk for use and examination by the public.

I hereby certify that the foregoing Bill passed first reading at the meeting of the County Council on October 24, 1973, by the following aye and no vote:

AYES: Councilmen Carpenter, De Luz, Farias, Fujii, Hisaoka, Kawahara, Matayoshi, Yadao and Chairman Yamada—9.

NOES: None.

Tadashi Suzuki
COUNTY CLERK
COUNTY OF HAWAII

(177—Hawaii Tribune-Herald:
Oct. 29, 1973.)

ORDINANCE NO. 612
(Bill No. 1017-1973)

AN ORDINANCE AMENDING SECTION 7.02, THE NORTH KONA ZONE MAP, ARTICLE 2, CHAPTER 8 (ZONING CODE), HAWAII COUNTY CODE, AS AMENDED, BY CHANGING THE DISTRICT CLASSIFICATION FROM AGRICULTURAL (A-5a) TO AGRICULTURAL (A-1a) AT KAHULUI 1ST, NORTH KONA, HAWAII, COVERED BY TAX MAP KEY 7-5-16:33.

Date Approved: November 20, 1973
Date Effective: November 27, 1973

Copies of the foregoing Ordinance, in full, are on file in the Office of the County Clerk for use and examination by the public.

I hereby certify that the foregoing Ordinance passed second and final reading at the meeting of the County Council on November 20, 1973, by the following aye and no vote:

AYES: Councilmen Carpenter, De Luz, Farias, Fujii, Hisaoka, Kawahara, Matayoshi, Yadao and Chairman Yamada - 9.

NOES: None.

Tadashi Suzuki

COUNTY CLERK
COUNTY OF HAWAII

ORDINANCE NO. 612
AN ORDINANCE AMENDING SECTION 7.02, THE NORTH KONA ZONE MAP, ARTICLE 2, CHAPTER 8 (ZONING CODE), HAWAII COUNTY CODE, AS AMENDED, BY CHANGING THE DISTRICT CLASSIFICATION FROM AGRICULTURAL (A-5a) TO AGRICULTURAL (A-1a) AT KAHULUI 1ST, NORTH KONA, HAWAII, COVERED BY TAX MAP KEY 7-5-16:33.

Date Approved: November 20, 1973

Date Effective: November 27, 1973

Copies of the foregoing Ordinance, in full, are on file in the Office of the County Clerk for use and examination by the public.

I hereby certify that the foregoing Ordinance passed second and final reading at the meeting of the County Council on November 20, 1973, by the following aye and no vote:

AYES: Councilmen Carpenter, De Luz, Farias, Fujii, Hisaoka, Kawahara, Matayoshi, Yadao and Chairman Yamada - 9.

NOES: None.

TADASHI SUZUKI
COUNTY CLERK
COUNTY OF HAWAII