

COUNTY OF HAWAII - STATE OF HAWAII

ORDINANCE NO. 614

AN ORDINANCE AMENDING SECTION 7.05, THE KAILUA-HONALO URBAN ZONE MAP, ARTICLE 2, CHAPTER 8 (ZONING CODE), HAWAII COUNTY CODE, AS AMENDED, BY CHANGING THE DISTRICT CLASSIFICATION FROM SINGLE FAMILY RESIDENTIAL (RS-10) TO VILLAGE COMMERCIAL (CV-10) AT KEAUKOU 2ND, NORTH KONA, HAWAII, COVERED BY TAX MAP KEY 7-8-10:PORTION OF 39.

BE IT ORDAINED BY THE COUNCIL OF THE COUNTY OF HAWAII:

SECTION 1. Section 7.05 of Article 2, Chapter 8 (Zoning Code), Hawaii County Code, as amended, is hereby further amended by adding thereto the following subsection:

"7.05(n). The district classification of the following area situated at Keauhou 2nd, North Kona, Hawaii, shall be Village Commercial (CV-10):

Beginning at a pipe on the southeast corner of this parcel of land, on the westerly side of Kaleopapa Road, the coordinates of which, referred to Government Survey Triangulation Station 'KEAUKOU COAST' being 1970.49 feet North and 1558.61 feet East and running by azimuths measured clockwise from true South:

1. 58° 00' 554.88 feet along remainder of L. C. Award 7712, Ap. 12 to Lot Kamehameha to a pipe;
2. 153° 30' 508.76 feet along remainder of L. C. Award 7712, Ap. 12 to Lot Kamehameha to a pipe;
3. 249° 33' 30" 83.55 feet along the south side of Ehukai Street to a pipe in Concrete;

Thence along the south side of Ehukai Street on a curve to the right with a radius of 475.00 feet the chord azimuth and distance being:

4. 258° 47' 30" 152.43 feet to a pipe in concrete;
5. 268° 01' 30" 303.69 feet along the south side of Ehukai Street to a pipe in concrete;

Thence along the south side of Ehukai Street on a curve to the right with a radius of 30.00 feet the chord azimuth and distance being:

6. 305° 52' 38" 36.82 feet to a pipe in concrete;

Thence along the west side of Kaleopapa Road on a curve to the left with a radius of 430.00 feet the chord azimuth and distance being:

7. 326° 51' 38" 249.56 feet to the point of beginning and containing an area of 4.949 acres.

All as outlined in red on the map attached hereto, marked Exhibit 'A' and by reference made a part hereof."

SECTION 2. Section 1 of this ordinance shall take effect forthwith upon the conditions that (A) the applicant withdraw subdivision approval granted on September 24, 1969, involving a residential subdivision; (B) construction of the proposed facility, the convention hall, begin within one (1) year of the date of approval of the change of zone; and (C) all other applicable regulations be complied with. Should these conditions not be met, action shall be taken to rezone the subject property to a more appropriate designation.

SECTION 3. In the event that any portion of this ordinance is declared invalid, such invalidity shall not affect the other parts of this ordinance.

SECTION 4. This ordinance shall take effect upon its approval.

INTRODUCED BY:

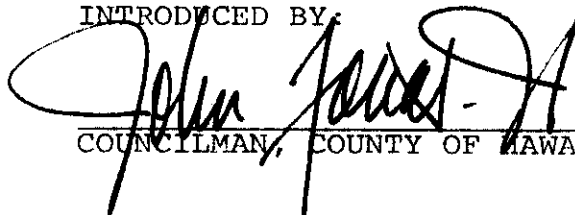
  
COUNCILMAN, COUNTY OF HAWAII

Hilo, Hawaii

Date of Introduction: October 24, 1973

Date of Adoption: November 20, 1973

Effective Date: November 28, 1973





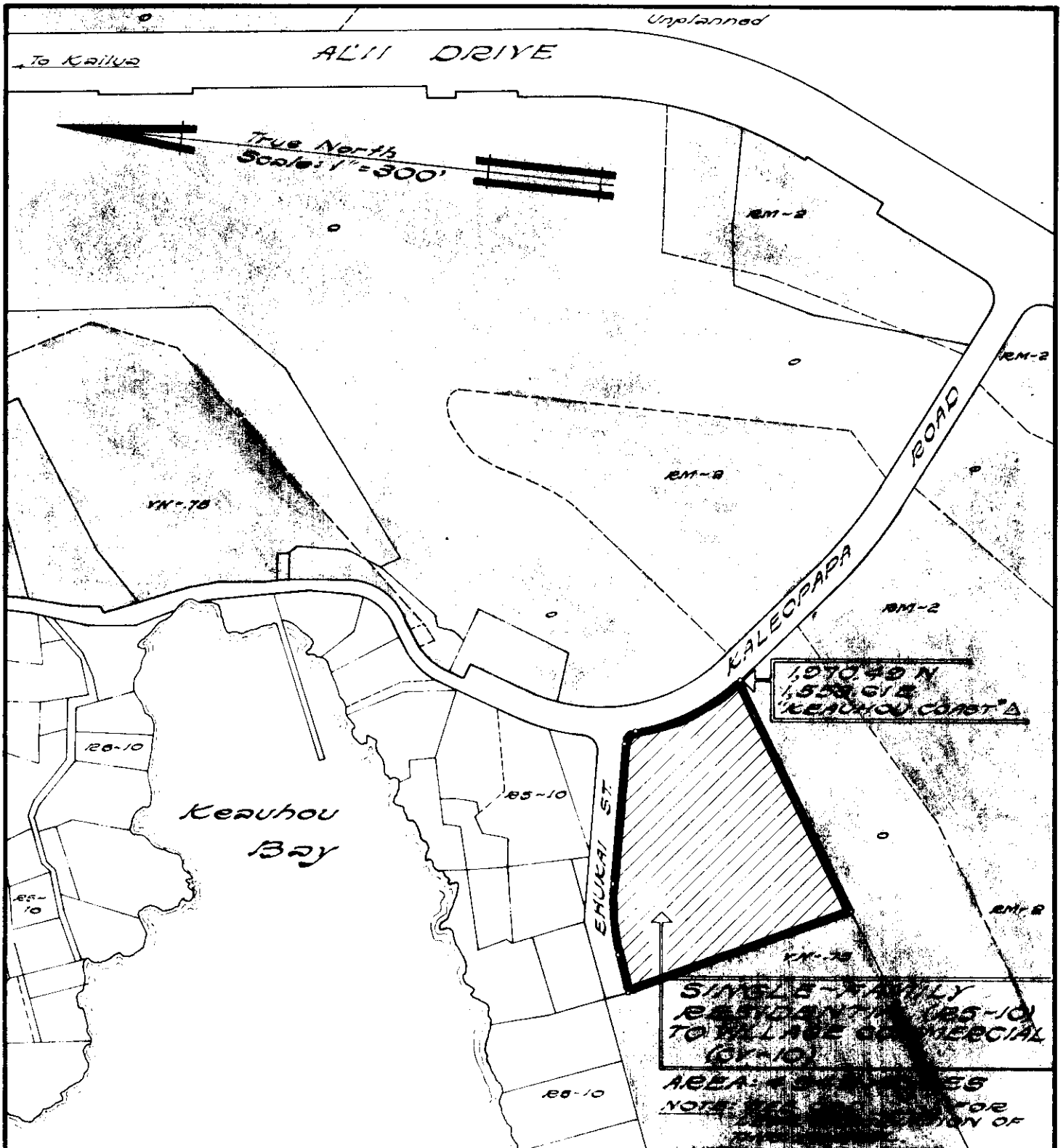

**AMENDMENT TO THE COUNTY ZONING ORDINANCE**

AMENDMENT No. 14 OF SECTION 7.05, THE KAILUA-HONALO URBAN ZONE MAP, PORTION OF ORDINANCE No. 74, CHANGING THE DISTRICT CLASSIFICATION FROM SINGLE-FAMILY RESIDENTIAL (RS-10) TO VILLAGE COMMERCIAL (CV-10) IN KEAUKOU 2nd, NORTH KONA, HAWAII.

DATE OF PUBLIC HEARING: AUG 23, 1973  
 DATE OF APPROVAL:  
 ORDINANCE No.  
 PREPARED BY: PLANNING DEPARTMENT  
 COUNTY OF HAWAII

Hilo, Hawaii  
Date: October 24, 1973

FIRST READING			
	AYES	NOES	A/E
Carpenter	X		
De Luz	X		
Farias	X		
Fujii	X		
Hisaoka	X		
Kawahara	X		
Matayoshi	X		
Yadao	X		
Chr. Yamada	X		
	9		

Publication Date: October 29, 1973

Hilo, Hawaii  
Date: November 20, 1973

SECOND & FINAL READING			
	AYES	NOES	A/E
Carpenter	X		
De Luz	X		
Farias	X		
Fujii	X		
Hisaoka	X		
Kawahara	X		
Matayoshi	X		
Yadao	X		
Chr. Yamada	X		
	9		

Publication Date: DEC 2 1973

We do hereby certify that the foregoing BILL was adopted by the County Council and published as indicated above.

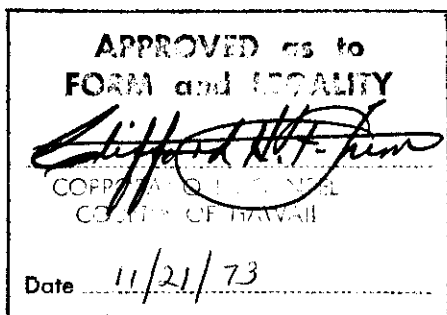

*Robert M. Yamada*  
\_\_\_\_\_  
Council Chairman

*Robert Shigei*  
\_\_\_\_\_  
County Clerk

Approved/Disapproved this 28<sup>th</sup> day of  
November, 19 73

*Hiroyuki Kimura*  
\_\_\_\_\_  
Mayor, County of Hawaii

Bill No. 1020  
Reference: C-508/PRDC-18  
M.B. No. 412  
Ord. No. 611

ORDINANCE NO. 614  
(Bill No. 1020-1973)

AN ORDINANCE AMENDING SECTION 7.05, THE KAILUA-HONALO URBAN ZONE MAP, ARTICLE 2, CHAPTER 8 (ZONING CODE), HAWAII COUNTY CODE, AS AMENDED, BY CHANGING THE DISTRICT CLASSIFICATION FROM SINGLE FAMILY RESIDENTIAL (RS-10) TO VILLAGE COMMERCIAL (CV-10) AT KEAUAHOU 2ND, NORTH KONA, HAWAII, COVERED BY TAX MAP KEY 7-8-10:PORTION OF 39.

Date Approved: November 20, 1973  
Date Effective: November 28, 1973

Copies of the foregoing Ordinance, in full, are on file in the Office of the County Clerk for use and examination by the public.

---

I hereby certify that the foregoing Ordinance passed second and final reading at the meeting of the County Council on November 20, 1973, by the following aye and no vote:

AYES: Councilmen Carpenter, De Luz, Farias, Fujii, Hisaoka, Kawahara, Matayoshi, Yadao and Chairman Yamada - 9.

NOES: None.

*Tadashi Suzuki*

COUNTY CLERK  
COUNTY OF HAWAII

7.05, THE KAILUA-HONALO URBAN ZONE MAP, ARTICLE 2, CHAPTER 8 (ZONING CODE), HAWAII COUNTY CODE, AS AMENDED, BY CHANGING THE DISTRICT CLASSIFICATION FROM SINGLE FAMILY RESIDENTIAL (RS-10) TO VILLAGE COMMERCIAL (CV-10) AT KEAUAHOU 2ND, NORTH KONA, HAWAII, COVERED BY TAX MAP KEY 7-8-10:PORTION OF 39.

Date Approved: November 20, 1973  
Date Effective: November 28, 1973

Copies of the foregoing Ordinance, in full, are on file in the Office of the County Clerk for use and examination by the public.

I hereby certify that the foregoing Ordinance passed second and final reading at the meeting of the County Council on November 20, 1973, by the following aye and no vote:

AYES: Councilmen Carpenter, De Luz, Farias, Fujii, Hisaoka, Kawahara, Matayoshi, Yadao and Chairman Yamada - 9.

NOES: None.  
TADASHI SUZUKI  
COUNTY CLERK  
COUNTY OF HAWAII

Tadashi Suzuki  
COUNTY CLERK

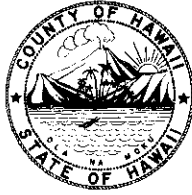

Robert Shioji  
DEPUTY COUNTY CLERK

OFFICE OF THE COUNTY CLERK

COUNTY OF HAWAII  
HILO, HAWAII 96720

Mayor Shunichi Kimura  
County of Hawaii  
Hilo, Hawaii

I hereby transmit Ordinance Bill No. 1020 passed by  
the County Council on second and final reading.

  
DEPUTY COUNTY CLERK

Encl.

Dated: Nov. 21, 1973

**ZONE MAP ORDINANCE NO. 15**  
(ZONING ORDINANCE), REVISED  
ORDINANCES OF THE COUNTY OF  
HAWAII 1947, AS AMENDED, BY  
CHANGING THE DISTRICT  
CLASSIFICATION FROM SINGLE-  
FAMILY RESIDENTIAL (RS-10) TO  
VILLAGE COMMERCIAL (CV-10) AT  
KEAUKOU 2ND, NORTH KONA,  
HAWAII, COVERED BY TAX MAP KEY  
7-8-10: PORTION OF 39.

This Bill proposes to amend the Kailua-Honalo Urban Zone Map by changing the district classification from Single Family Residential (RS-10) to Village Commercial (CV-10) at Keauhou 2nd, North Kona.

Date Introduced: October 24, 1973

Copies of the foregoing Bill, in full, are on file in the Office of the County Clerk for use and examination by the public.

I hereby certify that the foregoing Bill passed first reading at the meeting of the County Council on October 24, 1973, by the following aye and no vote:

AYES: Councilmen Carpenter, De Luz, Farias, Fujii, Hisaoka, Kawahara, MAsteyoshi, Yadao and Chairman Yamada - 9.

NOES: None.

TADASHI SUZUKI  
COUNTY CLERK  
COUNTY OF HAWAII