

COUNTY OF HAWAII - STATE OF HAWAII

ORDINANCE NO. 622

AN ORDINANCE AMENDING SECTION 7.02, THE NORTH KONA ZONE MAP, OF CHAPTER 8, (ZONING CODE), ARTICLE 2, HAWAII COUNTY CODE, AS AMENDED, BY CHANGING THE DISTRICT CLASSIFICATION FROM AGRICULTURAL (A-1a) TO SINGLE-FAMILY RESIDENTIAL (RS-10) AT KEALAKEHE, NORTH KONA, HAWAII, COVERED BY TAX MAP KEY 7-4-08:PORTION OF 17.

BE IT ORDAINED BY THE COUNCIL OF THE COUNTY OF HAWAII:

SECTION 1. Section 7.02 of Chapter 8 (Zoning Code), Article 2, Hawaii County Code, as amended, is hereby further amended by adding thereto the following subsection:

"7.02(hh). The district classification of the following area situated at Kealakehe, North Kona, Hawaii, shall be Single-Family Residential (RS-10):

Beginning at the southeast corner of this parcel of land, on the south corner of Kealakehe School Site, Governor's Executive Order 2312 and on the boundary between the lands of Keahuolu and Kealakehe, the coordinates of said point of beginning referred to Government Survey Triangulation Station "KEAHUOLU" being 6,374.72 feet North and 14,066.25 feet East, thence running by azimuths measured clockwise from true South:

1. 56° 38' 778.00 feet along R. P. 6851, L. C. Aw. 8452, Apana 12 to A. Keohokalole;
2. 74° 08' 540.74 feet along R. P. 6851, L. C. Aw. 8452, Apana 12 to A. Keohokalole;
3. 131° 26' 258.98 feet along the remainder of the Government Land;

Thence along the remainder of the Government Land, on a curve to the right with a radius of 2100.00 feet, the chord azimuth and distance being:

4. 156° 48' 1799.32 feet;

Thence along the remainder of the Government Land, on a curve to the right with a radius of 700.00 feet, the chord azimuth and distance being:

5. 206° 38' 579.83 feet;
6. 231° 06' 244.99 feet along the remainder of the Government Land;

Thence along the remainder of the Government Land, on a curve to the right with a radius of 900.00 feet, the chord azimuth and distance being:

7. 136° 50' 07" 133.86 feet;
8. 141° 06' 568.00 feet along the remainder of the Government Land;
9. 227° 23' 30" 223.90 feet along the remainder of the Government Land;

- | | | | |
|-----|------|-----|---|
| 10. | 171° | 57' | 769.58 feet along the remainder of the Government Land; |
| 11. | 261° | 57' | 530.00 feet along R. P. 6855, L. C. Aw. 9971, Apana 9 to W. P. Leleiohoku; |
| 12. | 284° | 00' | 278.92 feet along Grant 3456 to McDougall; |
| 13. | 335° | 06' | 994.36 feet along the Kona Hotel Workers' Housing Site; |
| 14. | 65° | 06' | 184.00 feet along the remainder of the Government Land; |
| 15. | 335° | 06' | 920.00 feet along the remainder of the Government Land; |
| 16. | 245° | 06' | 430.00 feet along the remainder of the Government Land and along the southeast side of Road Reserve; |
| 17. | 335° | 06' | 500.00 feet along the Low-Cost Housing Project Site; |
| 18. | 65° | 06' | 564.88 feet along the Kealakehe School Site, Governor's Executive Order 2312; |
| 19. | 335° | 06' | 1165.78 feet along the Kealakehe School Site, Governor's Executive Order 2312, to the point of beginning and containing an area of 120.587 acres. |

"All as outlined in red on the map attached hereto, marked Exhibit 'A' and by reference made a part hereof."

SECTION 2. Section 1 of this ordinance shall take effect forthwith upon the condition that a minimum park area of five (5) acres shall be provided in close proximity of the area to serve the proposed residential development with minimum improvements to the park area which shall include but not limited to grading and grassing which is acceptable to appropriate agencies. The park site shall be developed concurrently with the second increment and that the exact location and configuration of the park site shall be determined at the time of subdivision review of the second increment.

SECTION 3. In the event that any portion of this ordinance is declared invalid, such invalidity shall not affect the other parts of this ordinance.

SECTION 4. This ordinance shall take effect upon its approval.

INTRODUCED BY:

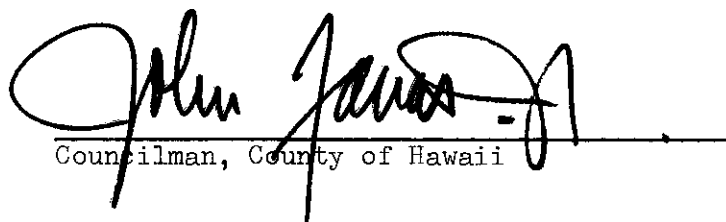

 Councilman, County of Hawaii

Hilo, Hawaii

Date of Introduction: October 24, 1973

Date of Adoption: March 20, 1974

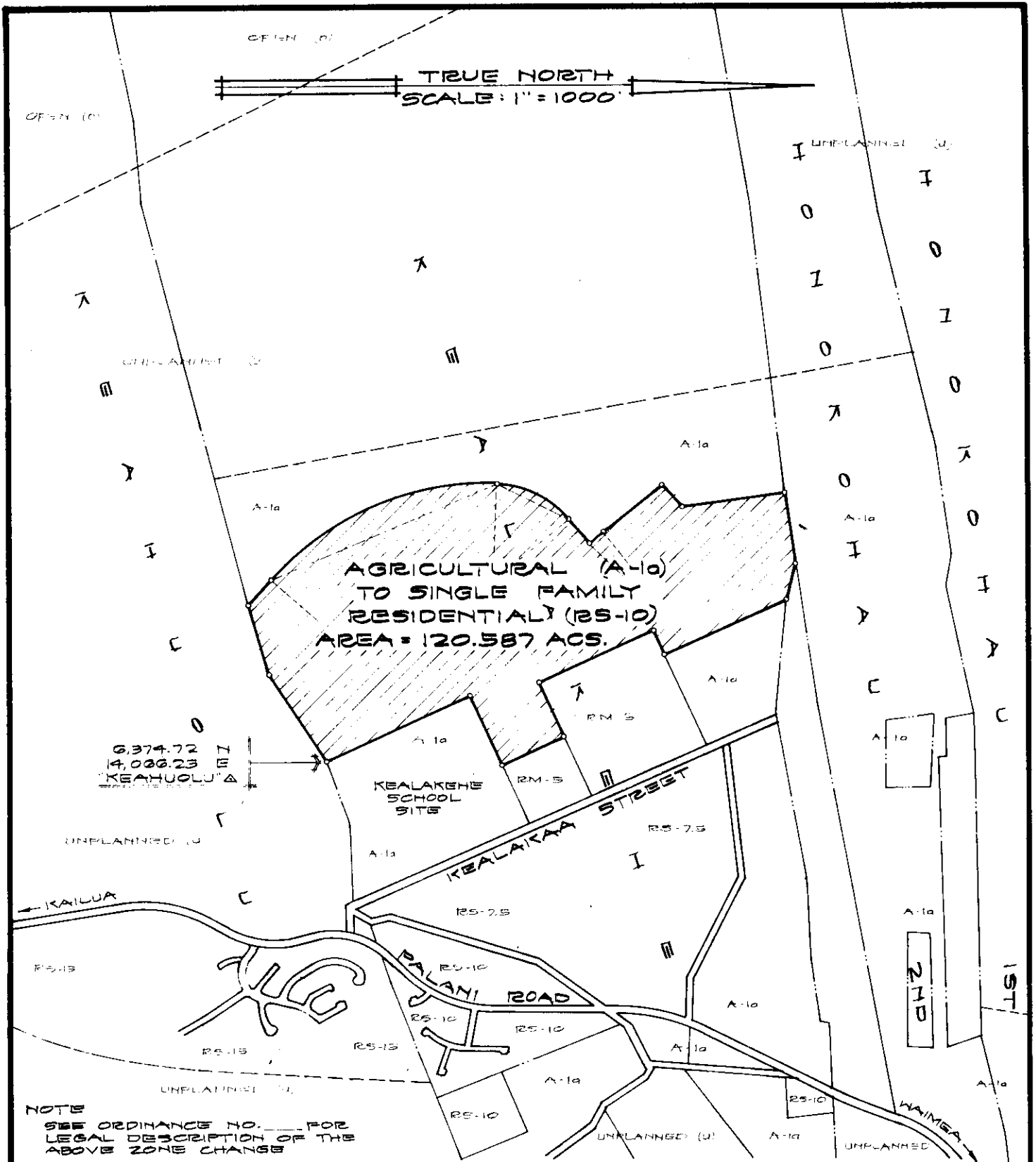
Date Effective: April 2, 1974



AMENDMENT TO THE COUNTY ZONING ORDINANCE

AMENDMENT NO. 34 OF SECTION 7.02, THE NORTH KONA ZONE MAP, PORTION OF ORDINANCE NO. 74, CHANGING THE DISTRICT CLASSIFICATION FROM AGRICULTURAL (A-1a) TO SINGLE FAMILY RESIDENTIAL (RS-10) AT KEALAKEHE, NORTH KONA, HAWAII.

DATE OF PUBLIC HEARING: MARCH 24, 1972
 DATE OF APPROVAL:
 ORDINANCE NO.:
 PREPARED BY: PLANNING DEPARTMENT
 COUNTY OF HAWAII

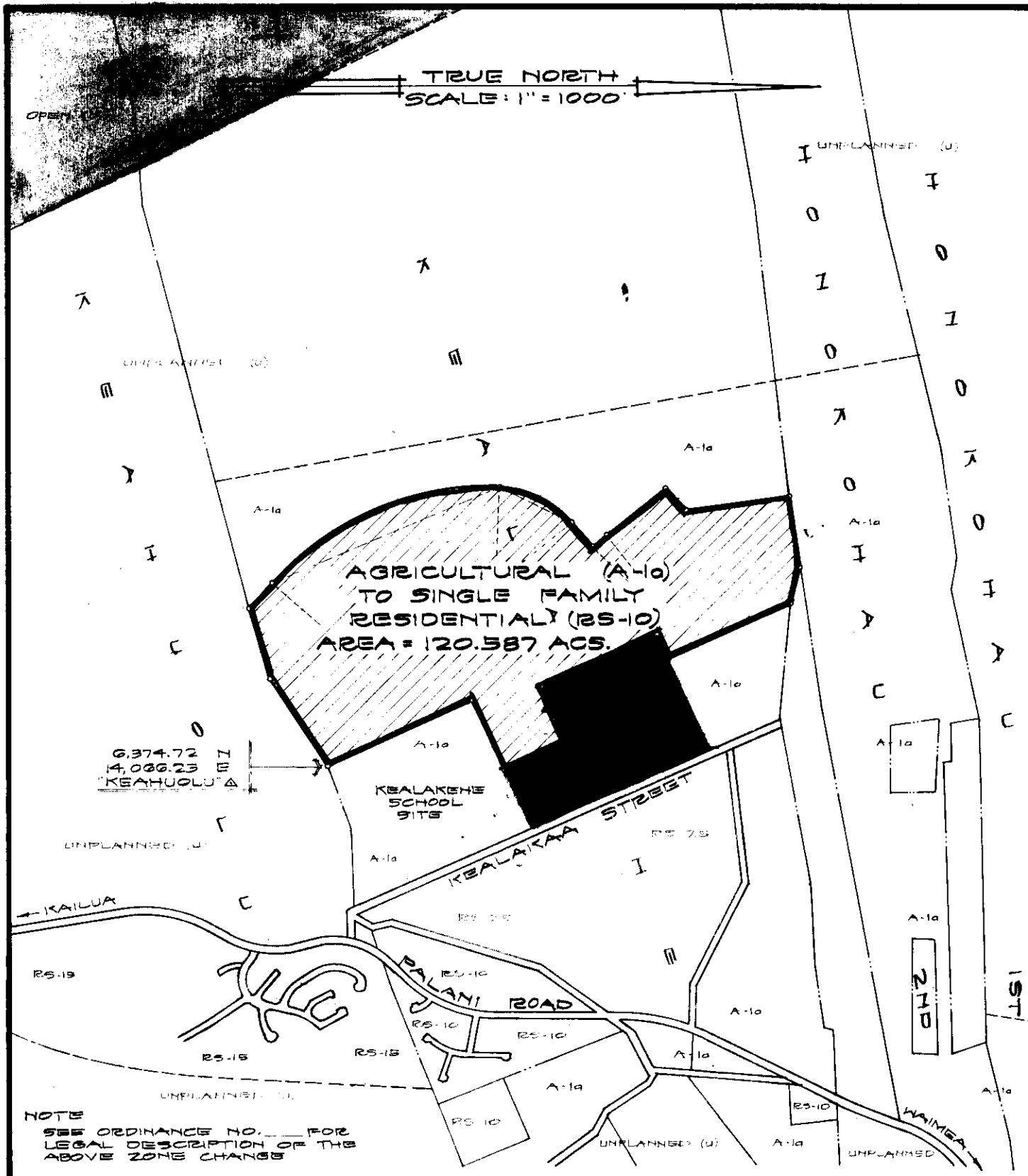

AMENDMENT TO THE COUNTY ZONING ORDINANCE

AMENDMENT NO. 34 OF SECTION 7.02, THE NORTH KONA ZONE MAP, PORTION OF ORDINANCE NO. 74, CHANGING THE DISTRICT CLASSIFICATION FROM AGRICULTURAL (A-1a) TO SINGLE FAMILY RESIDENTIAL (RS-10) AT KEALAKEHE, NORTH KONA, HAWAII.

DATE OF PUBLIC HEARING: MARCH 24, 1972
DATE OF APPROVAL:
ORDINANCE NO.:
PREPARED BY: PLANNING DEPARTMENT
COUNTY OF HAWAII

COUNTY OF HAWAII - STATE OF HAWAII

ORDINANCE NO. _____

AN ORDINANCE AMENDING SECTION 7.02, THE NORTH KONA ZONE MAP, ARTICLE 2, CHAPTER 8 (ZONING CODE), HAWAII COUNTY CODE, AS AMENDED, BY CHANGING THE DISTRICT CLASSIFICATION FROM AGRICULTURAL (A-1a) TO SINGLE FAMILY RESIDENTIAL (RS-10) AT KEALAKEHE, NORTH KONA, HAWAII, COVERED BY TAX MAP KEY 7-4-08:PORTION OF 17.

BE IT ORDAINED BY THE COUNCIL OF THE COUNTY OF HAWAII:

SECTION 1. Section 7.02 of Article 2, Chapter 8 (Zoning Code), Hawaii County Code, as amended, is hereby further amended by adding thereto the following subsection:

"7.02(gg). The district classification of the following area situated at Kealakehe, North Kona, Hawaii, shall be Single Family Residential (RS-10):

Beginning at the southeast corner of this parcel of land, on the south corner of Kealakehe School site, Governor's Executive Order 2312 and on the boundary between the lands of Keahuolu and Kealakehe, the coordinates of said point of beginning referred to Government Survey Triangulation Station 'KEAHUOLU' being 6,374.72 feet North and 14,066.25 feet East, thence running by azimuths measured clockwise from true South:

1. 56° 38' 778.00 feet along R. P. 6851, L. C. Aw. 8452, Apana 12 to A. Keohokalole;
2. 74° 08' 540.74 feet along R. P. 6851, L. C. Aw. 8452, Apana 12 to A. Keohokalole;
3. 131° 26' 258.98 feet along the remainder of the Government Land;

Thence along the remainder of the Government Land, on a curve to the right with a radius of 2100.00 feet, the chord azimuth and distance being:

4. 156° 48' 1799.32 feet;

Thence along the remainder of the Government Land, on a curve to the right with a radius of 700.00 feet, the chord azimuth and distance being:

5. 206° 38' 579.83 feet;
6. 231° 06' 244.99 feet along the remainder of the Government Land;

Thence along the remainder of the Government Land, on a curve to the right with a radius of 900.00 feet, the chord azimuth and distance being:

7. 136° 50' 07" 133.86 feet;
8. 141° 06' 568.00 feet along the remainder of the Government Land;
9. 227° 23' 30" 223.90 feet along the remainder of the Government Land;
10. 171° 57' 769.58 feet along the remainder of the Government Land;
11. 261° 57' 530.00 feet along R. P. 6855, L. C. Aw. 9971, Apana 9 to W. P. Leleiohoku;
12. 284° 00' 278.92 feet along Grant 3456 to McDougall;
13. 335° 06' 994.36 feet along the Kona Hotel Workers' Housing Site;
14. 65° 06' 184.00 feet along the remainder of the Government Land;
15. 335° 06' 920.00 feet along the remainder of the Government Land;
16. 245° 06' 430.00 feet along the remainder of the Government Land and along the southeast side of Road Reserve;
17. 335° 06' 500.00 feet along the Low-Cost Housing Project Site;
18. 65° 06' 564.88 feet along the Kealakehe School Site, Governor's Executive Order 2312;
19. 335° 06' 1165.78 feet along the Kealakehe School Site, Governor's Executive Order 2312, to the point of beginning and containing an area of 120.587 acres.

All as outlined in red on the map attached hereto, marked Exhibit 'A' and by reference made a part hereof."

SECTION 2. Section 1 of this ordinance shall take effect forthwith upon the condition that a minimum park area of five (5) acres be provided. Minimum improvements shall include but not be limited to grading and grassing which is acceptable to appropriate agencies. Should the condition not be met, action shall be taken to rezone the subject area to a more appropriate designation.

SECTION 3. In the event that any portion of this ordinance is declared invalid, such invalidity shall not affect the other parts of this ordinance.

SECTION 4. This ordinance shall take effect upon its approval.

INTRODUCED BY:

COUNCILMAN, COUNTY OF HAWAII

Date of Introduction:

Date of Adoption:

COUNTY OF HAWAII - STATE OF HAWAII

ORDINANCE NO. _____

AN ORDINANCE AMENDING SECTION 7.02, THE NORTH KONA ZONE MAP, ORDINANCE NO. 63 (ZONING ORDINANCE), REVISED ORDINANCE OF THE COUNTY OF HAWAII 1967, AS AMENDED, BY CHANGING THE DISTRICT CLASSIFICATION FROM AGRICULTURAL (A-1a) TO SINGLE FAMILY RESIDENTIAL (RS-10) AT KEALAKEHE, NORTH KONA, HAWAII, COVERED BY TAX MAP KEY 7-4-08: PORTION OF 17.

BE IT ORDAINED BY THE COUNCIL OF THE COUNTY OF HAWAII:

SECTION 1. Section 7.02 of Ordinance No. 63 (Zoning Ordinance) Revised Ordinances of the County of Hawaii 1967, as amended, is hereby further amended by adding thereto the following subsection:

"7.02(hh). The district classification of the following area situated at Kealakehe, North Kona, Hawaii, shall be Single Family Residential (RS-10):

Beginning at the southeast corner of this parcel of land, on the south corner of Kealakehe School Site, Governor's Executive Order 2312 and on the boundary between the lands of Keahuolu and Kealakehe, the coordinates of said point of beginning referred to Government Survey Triangulation Station "KEAHUOLU" being 6,374.72 feet North and 14,066.25 feet East, thence running by azimuths measured clockwise from true South:

1. 56° 38' 778.00 feet along R. P. 6851, L. C. Aw. 8452, Apana 12 to A. Keohokalole;
2. 74° 08' 540.74 feet along R. P. 6851, L. C. Aw. 8452, Apana 12 to A. Keohokalole;
3. 131° 26' 258.98 feet along the remainder of the Government Land;

Thence along the remainder of the Government Land, on a curve to the right with a radius of 2100.00 feet, the chord azimuth and distance being:

4. 156° 48' 1799.32 feet;

Thence along the remainder of the Government Land, on a curve to the right with a radius of 700.00 feet, the chord azimuth and distance being:

5. 206° 38' 579.83 feet;
6. 231° 06' 244.99 feet along the remainder of the Government Land;

Thence along the remainder of the Government Land, on a curve to the right with a radius of 900.00 feet, the chord azimuth and distance being:

7. 136° 50' 07" 133.86 feet;

- | | | | | |
|-----|------------------|---------|---------|---|
| 8. | 141 ^o | 06' | 568.00 | feet along the remainder of the Government Land; |
| 9. | 227 ^o | 23' 30" | 223.90 | feet along the remainder of the Government Land; |
| 10. | 171 ^o | 57' | 769.58 | feet along the remainder of the Government Land; |
| 11. | 261 ^o | 57' | 530.00 | feet along R. P. 6855, L. C. Aw. 9971, Apana 9 to W. P. Leleiohoku; |
| 12. | 284 ^o | 00' | 278.92 | feet along Grant 3456 to McDougall; |
| 13. | 335 ^o | 06' | 994.36 | feet along the Kona Hotel Workers' Housing Site; |
| 14. | 65 ^o | 06' | 184.00 | feet along the remainder of the Government Land; |
| 15. | 335 ^o | 06' | 920.00 | feet along the remainder of the Government Land; |
| 16. | 245 ^o | 06' | 430.00 | feet along the remainder of the Government Land and along the southeast side of Road Reserve; |
| 17. | 335 ^o | 06' | 500.00 | feet along the Low-Cost Housing Project Site; |
| 18. | 65 ^o | 06' | 564.88 | feet along the Kealakehe School Site, Governor's Executive Order 2312; |
| 19. | 335 ^o | 06' | 1165.78 | feet along the Kealakehe School Site, Governor's Executive Order 2312, to the point of beginning and containing an area of 120.587 acres. |

"All as outlined in red on the map attached hereto, marked Exhibit "A" and by reference made a part hereof."

SECTION 2. In the event that any portion of this ordinance is declared invalid, such invalidity shall not affect the other parts of this ordinance.

SECTION 3. This ordinance shall take effect upon its approval.

INTRODUCED BY:

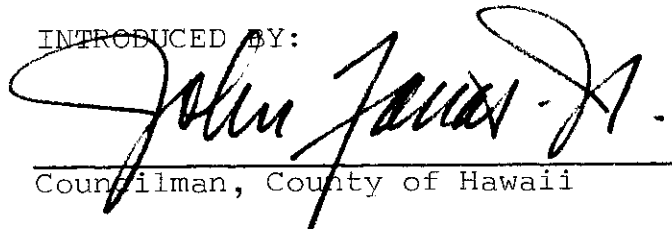

 Councilman, County of Hawaii

Hilo, Hawaii

Date of Introduction: **October 24, 1973**

Date of Adoption:

- | | | | | |
|-----|------------------|-----|-----|---|
| 8. | 141 ^o | 06' | | 568.00 feet along the remainder of the Government Land; |
| 9. | 227 ^o | 23' | 30" | 223.90 feet along the remainder of the Government Land; |
| 10. | 171 ^o | 57' | | 769.58 feet along the remainder of the Government Land; |
| 11. | 261 ^o | 57' | | 530.00 feet along R. P. 6855, L. C. Aw. 9971, Apana 9 to W. P. Leleiohoku; |
| 12. | 284 ^o | 00' | | 278.92 feet along Grant 3456 to McDougall; |
| 13. | 335 ^o | 06' | | 994.36 feet along the Kona Hotel Workers' Housing Site; |
| 14. | 65 ^o | 06' | | 184.00 feet along the remainder of the Government Land; |
| 15. | 335 ^o | 06' | | 920.00 feet along the remainder of the Government Land; |
| 16. | 245 ^o | 06' | | 430.00 feet along the remainder of the Government Land and along the southeast side of Road Reserve; |
| 17. | 335 ^o | 06' | | 500.00 feet along the Low-Cost Housing Project Site; |
| 18. | 65 ^o | 06' | | 564.88 feet along the Kealakehe School Site, Governor's Executive Order 2312; |
| 19. | 335 ^o | 06' | | 1165.78 feet along the Kealakehe School Site, Governor's Executive Order 2312, to the point of beginning and containing an area of 120.587 acres. |

"All as outlined in red on the map attached hereto, marked Exhibit "A" and by reference made a part hereof."

SECTION 2. Section 1 of this ordinance shall take effect forthwith upon the condition that a minimum park area of 5 acres be provided. Minimum improvements shall include but not be limited to grading and grassing which is acceptable to appropriate agencies. Should the condition not be met, action shall be taken to rezone the subject area to a more appropriate designation.

SECTION 3. In the event that any portion of this ordinance is declared invalid, such invalidity shall not affect the other parts of this ordinance.

SECTION 4. This ordinance shall take effect upon its approval.

INTRODUCED BY:

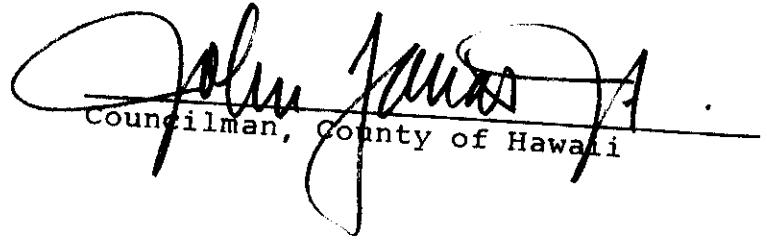
Councilman, County of Hawaii

Hilo, Hawaii

Date of Introduction:

Date of Adoption:

Hilo, Hawaii
 Date: October 24, 1973

FIRST READING			
	AYES	NOES	A/E
Carpenter	X		
De Luz	X		
Farias	X		
Fujii	X		
Hisaoka	X		
Kawahara	X		
Matayoshi	X		
Yadao	X		
Chr. Yamada	X		
	9		

Publication Date: October 29, 1973

Hilo, Hawaii
 Date: March 20, 1974

SECOND & FINAL READING			
	AYES	NOES	A/E
Carpenter	X		
De Luz	X		
Farias	X		
Fujii	X		
Hisaoka	X		
Kawahara	X		
Matayoshi	X		
Yadao	X		
Chr. Yamada	X		
	9		

Publication Date: APR 1974

We do hereby certify that the foregoing BILL was adopted by the County Council and published as indicated above.

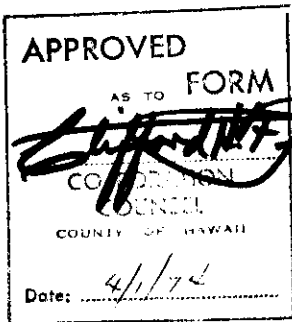

Kate M. Yamada
 Council Chairman

Tadashi Suzuki
 County Clerk

Approved/Disapproved this 2nd day of April 19 74
Samuel H. Kimura
 Mayor, County of Hawaii

Bill No. 1016
 Reference: C-454/PRDC-18
 M.B. No. 410
 Ord. No. 622

Bill No. 1016 - 1973

AN ORDINANCE AMENDING SECTION 7.02, THE NORTH KONA ZONE MAP, ORDINANCE NO. 63, (ZONING ORDINANCE), REVISED ORDINANCE OF THE COUNTY OF HAWAII 1967, AS AMENDED, BY CHANGING THE DISTRICT CLASSIFICATION FROM AGRICULTURAL (A-1a) TO SINGLE FAMILY RESIDENTIAL (RS-10) AT KEALAKEHE, NORTH KONA, HAWAII, COVERED BY TAX MAP KEY 7-4-08: PORTION OF 17.

This Bill proposes to amend the North Kona Zone Map by changing the district classification from Agricultural (A-1a) to Single Family Residential (RS-10) at Kealakehe, N. Kona.

Date Introduced: October 24, 1973

Copies of the foregoing Bill, in full, are on file in the Office of the County Clerk for use and examination by the public.

I hereby certify that the foregoing Bill passed first reading at the meeting of the County Council on October 24, 1973, by the following aye and no vote:

AYES: Councilmen Carpenter, De Luz, Farias, Fujii, Hisaoka, Kawahara, Matayoshi, Yadao and Chairman Yamada - 9.

NOES: None.



COUNTY CLERK
COUNTY OF HAWAII

ORDINANCE NO. 622
(Bill No. 1016-1974)

AN ORDINANCE AMENDING SECTION 7.02, THE NORTH KONA ZONE MAP, OF CHAPTER 8 (ZONING CODE), ARTICLE 2, HAWAII COUNTY CODE, AS AMENDED, BY CHANGING THE DISTRICT CLASSIFICATION FROM AGRICULTURAL (A-1a) TO SINGLE-FAMILY RESIDENTIAL (RS-10) AT KEALAKEHE, NORTH KONA, HAWAII, COVERED BY TAX MAP KEY 7-4-08:PORTION OF 17.

Date Approved: March 20, 1974
Date Effective: April 2, 1974

Copies of the foregoing Ordinance, in full, are on file in the Office of the County Clerk for use and examination by the public.

I hereby certify that the foregoing Ordinance passed second and final reading at the meeting of the County Council on March 20, 1974, by the following aye and no vote:

AYES: Councilmen Carpenter, De Luz, Farias, Fujii, Hisaoka, Kawahara, Matayoshi, Yadao and Chairman Yamada - 9.

NOES: None.

Tadashi Suzuki

COUNTY CLERK
COUNTY OF HAWAII

CHAPTER 8 ZONING CODE, ARTICLE
2, HAWAII COUNTY CODE, AS
AMENDED, BY CHANGING THE
DISTRICT CLASSIFICATION FROM
AGRICULTURAL (A-1a) TO SINGLE-
FAMILY RESIDENTIAL (RS-10) AT
KEALAKEHE, NORTH KONA, HAWAII,
COVERED BY TAX MAP KEY 7-4-
08:PORTION OF 17.

Date Approved: March 20, 1974

Date Effective: April 2, 1974

Copies of the foregoing Ordinance, in full, are on file in the Office of the County Clerk for use and examination by the public.

I hereby certify that the foregoing Ordinance passed second and final reading at the meeting of the County Council on March 20, 1974, by the following aye and no vote:

AYES: Councilmen Carpenter, De Luz, Farias, Fujii, Hisaoka, Kawahara, Matayoshi, Yadao and Chairman Yamada - 9.

NOES: None.

TADASHI SUZUKI
COUNTY CLERK
COUNTY OF HAWAII

Tadashi Suzuki
COUNTY CLERK

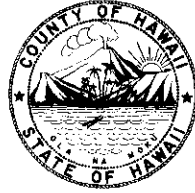

Robert Shioji
DEPUTY COUNTY CLERK

OFFICE OF THE COUNTY CLERK

COUNTY OF HAWAII
HILO, HAWAII 96720

Mayor Shunichi Kimura
County of Hawaii
Hilo, Hawaii

I hereby transmit Ordinance Bill No. 1016 passed by
the County Council on second and final reading.

DEPUTY COUNTY CLERK

Encl.

Dated: March 21, 1974