

COUNTY OF HAWAII - STATE OF HAWAII

ORDINANCE NO. 89

AN ORDINANCE AMENDING SECTION 7.02, THE NORTH KONA ZONE MAP OF CHAPTER 8 (ZONING CODE), ARTICLE 2, HAWAII COUNTY CODE, AS AMENDED, BY CHANGING THE DISTRICT CLASSIFICATION FROM UNPLANNED (U) TO SINGLE FAMILY RESIDENTIAL (RS-10) AT KEALAKEHE HOMESTEADS, NORTH KONA, HAWAII, COVERED BY TAX MAP KEY 7-4-04:24.

BE IT ORDAINED BY THE COUNCIL OF THE COUNTY OF HAWAII:

SECTION 1. Section 7.02 of Chapter 8 (Zoning Code), Article 2, Hawaii County Code, as amended, is hereby further amended by adding thereto the following subsection:

"7.02(pp). The district classification of the following area situated at Kealakehe Homesteads, North Kona, Hawaii, shall be Single Family Residential (RS-10):

Beginning at the South corner of this parcel of land, on the Easterly side of Tomi Tomi Road, the coordinates of said point of beginning referred to Government Survey Triangulation Station "LAPAUWILA" being 2,141.35 feet North and 1,199.36 feet East and running by azimuths measured clockwise from true South:

- | | | |
|----|-------------|--|
| 1. | 132° 36' | 99.67 feet along the Easterly side of Tomi Tomi Road; |
| 2. | 188° 43' | 68.83 feet along the Easterly side of Homestead Road to a spike found; |
| 3. | 246° 49' | 155.00 feet following stonewall and along Grant 3742 to J. R. Kailiuaua; |
| 4. | 338° 55' | 115.80 feet following stonewall and along Grant 3742 to J. R. Kailiuaua; |
| 5. | 53° 52' 30" | 150.06 feet following stonewall and along Grant 3742 to J. R. Kailiuaua to the point of beginning and containing an area of 22,812 Square Feet or 0.524 Acres. |

"All as outlined in red on the map attached hereto, marked Exhibit 'A' and by reference made a part hereof."

SECTION 2. Section 1 of this ordinance shall take effect forthwith upon the conditions that (A) the applicant, Easy Pipella, submit a subdivision plan and secure tentative approval within one (1) year of the

official date of approval of the change of zone request; and (B) construction of a single-family dwelling commence on one (1) of the lots within three (3) years of receipt of final subdivision approval. Should any of the foregoing conditions not be met, rezoning of the property to its former zoning designation may be initiated.

SECTION 3. In the event that any portion of this ordinance is declared invalid, such invalidity shall not affect the other parts of this ordinance.

SECTION 4. This ordinance shall take effect upon its approval.

INTRODUCED BY:

Frank De Luz

COUNCILMAN, COUNTY OF HAWAII

Hilo, Hawaii

Date of Introduction: January 22, 1975

Date of Adoption: February 5, 1975

Effective Date: February 12, 1975

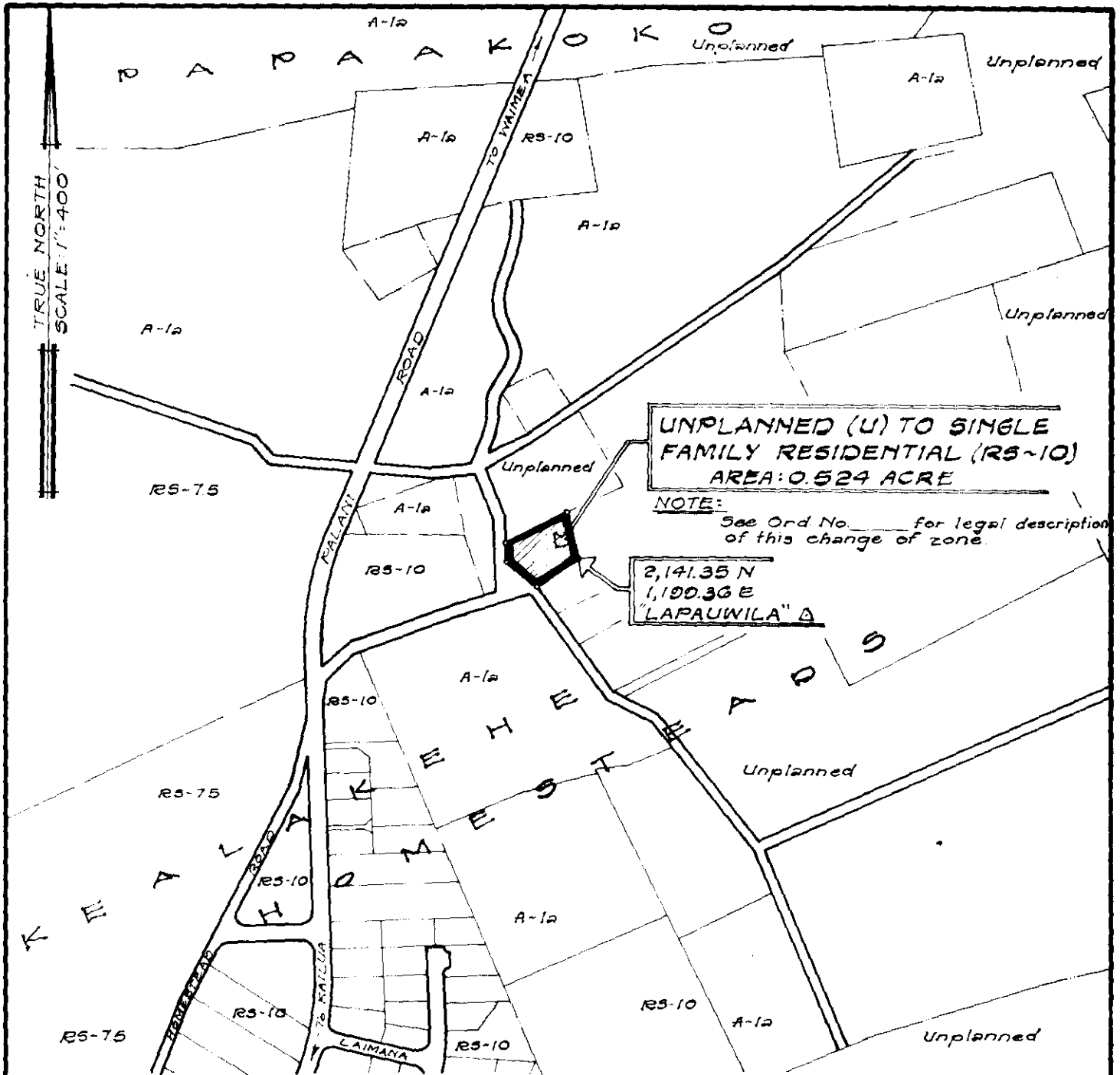

AMENDMENT TO THE ZONING CODE

AMENDMENT NO. OF CHAPTER 8 (ZONING CODE), ARTICLE 2, SECTION 7.02, THE NORTH KONA ZONE MAP, CHANGING THE DISTRICT CLASSIFICATION FROM UNPLANNED (U) TO SINGLE FAMILY RESIDENTIAL (RS-10) AT KEALAKEHE HOMESTEADS, NORTH KONA, HAWAII.

DATE OF PUBLIC HEARING: July 1, 1974

DATE OF APPROVAL:

ORDINANCE No.

PREPARED BY: PLANNING DEPARTMENT
COUNTY OF HAWAII

Hilo, Hawaii

Date: January 22, 1975

FIRST READING			
	AYES	NOES	A/E
Carpenter	X		
De Luz	X		
XX			
Fujii	X		
Hisaoka	X		
Kawahara	X		
Levin	X		
Yadao	X		
Chr. Yamada	X		
	8		

JAN 22

Publication Date: _____

Hilo, Hawaii

Date: February 5, 1975

SECOND & FINAL READING			
	AYES	NOES	A/E
Carpenter	X		
De Luz	X		
XXXX Lai	X		
Fujii	X		
Hisaoka	X		
Kawahara	X		
Levin	X		
Yadao	X		
Chr. Yamada	X		
	9		

Publication Date: February 18, 1975

We do hereby certify that the foregoing BILL was adopted by the County Council and published as indicated above.



Robert M. Yamada

 Council Chairman

Ted J. Suzuki

 County Clerk

Approved/Disapproved this 12th day of February, 1975.

Akiko Matayoshi

 Mayor, County of Hawaii

Bill No. 95
 Reference: C-1124/PRDLC-42
 M.B. No. _____
 Ord. No. 83

Bill No. 95 - 1975

AN ORDINANCE AMENDING SECTION 7.02, THE NORTH KONA ZONE MAP OF CHAPTER 8 (ZONING CODE), ARTICLE 2, HAWAII COUNTY CODE, AS AMENDED, BY CHANGING THE DISTRICT CLASSIFICATION FROM UNPLANNED (U) TO SINGLE FAMILY RESIDENTIAL (RS-10) AT KEALAKEHE HOMESTEADS, NORTH KONA, HAWAII, COVERED BY TAX MAP KEY 7-4-04:24.

This Bill amends Section 7.02, the North Kona Zone Map, Chapter 8 (Zoning Code), Article 2, Hawaii County Code, as amended, by changing the district classification from Unplanned (U) to Single Family Residential (RS-10) at Kealakehe Homesteads, N. Kona.

Date Introduced: January 22, 1975

Copies of the foregoing Bill, in full, are on file in the Office of the County Clerk for use and examination by the public.

I hereby certify that the foregoing Bill passed first reading at the meeting of the County Council on January 22, 1975, by the following aye and no vote:

AYES: Councilmen Carpenter, De Luz, Fujii, Hisaoka, Kawahara, Levin, Yadao and Chairman Yamada - 8.

NOES: None.



COUNTY CLERK
COUNTY OF HAWAII



CHAPTER 8 (ZONING CODE), ARTICLE 2, HAWAII COUNTY CODE AS AMENDED, BY CHANGING THE DISTRICT CLASSIFICATION FROM UNPLANNED (U) TO SINGLE FAMILY RESIDENTIAL (RS-10) AT KEALAKEHE HOMESTEADS, NORTH KONA, HAWAII, COVERED BY TAX MAP KEY 7-4-04:24.

This Bill amends Section 7.02, the North Kona Zone Map, Chapter 8 (Zoning Code), Article 2, Hawaii County Code, as amended, by changing the district classification from Unplanned (U) to Single Family Residential (RS-10) at Kealakehe Homesteads, N. Kona.

Date Introduced: January 22, 1975

Copies of the foregoing Bill, in full, are on file in the Office of the County Clerk for use and examination by the public.

I hereby certify that the foregoing Bill passed first reading at the meeting of the County Council on January 22, 1975, by the following aye and no vote:

AYES: Councilmen Carpenter, De Luz, Fujii, Hisaoka, Kawahara, Levin, Yadao and Chairman Yamada - 8.

NOES: None.

TED T. SUZUKI
COUNTY CLERK
COUNTY OF HAWAII

ORDINANCE NO. 89
(Bill No. 95-1975)

AN ORDINANCE AMENDING SECTION 7.02, THE NORTH KONA ZONE MAP OF CHAPTER 8 (ZONING CODE), ARTICLE 2, HAWAII COUNTY CODE, AS AMENDED, BY CHANGING THE DISTRICT CLASSIFICATION FROM UNPLANNED (U) TO SINGLE FAMILY RESIDENTIAL (RS-10) AT KEALAKEHE HOMESTEADS, NORTH KONA, HAWAII, COVERED BY TAX MAP KEY 7-4-04:24.

Date Approved: February 5, 1975
Date Effective: February 12, 1975

Copies of the foregoing Ordinance, in full, are on file in the Office of the County Clerk for use and examination by the public.

I hereby certify that the foregoing Ordinance passed second and final reading at the meeting of the County Council on February 5, 1975, by the following aye and no vote:

AYES: Councilmen Carpenter, De Luz, Fujii, Hisaoka, Kawahara, Lai, Levin, Yadao and Chairman Yamada - 9.

NOES: None.



COUNTY CLERK
COUNTY OF HAWAII

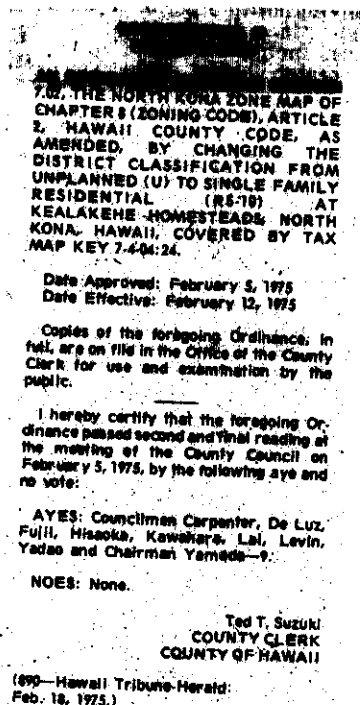

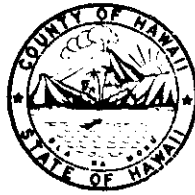

Ted T. Suzuki
COUNTY CLERK

Robert Shioji
DEPUTY COUNTY CLERK

OFFICE OF THE COUNTY CLERK
COUNTY OF HAWAII
HILO, HAWAII 96720

Mayor Herbert T. Matayoshi
County of Hawaii
Hilo; Hawaii

I hereby transmit Ordinance Bill No. 95
passed by the County Council on second and final
reading.

Ted T. Suzuki

COUNTY CLERK

Encl.

Dated: _____