

COUNTY OF HAWAII - STATE OF HAWAII

ORDINANCE NO. 107

AN ORDINANCE AMENDING SECTION 7.29, THE CITY OF HILO ZONE MAP OF CHAPTER 8 (ZONING CODE), ARTICLE 2, HAWAII COUNTY CODE, AS AMENDED, BY CHANGING THE DISTRICT CLASSIFICATION FROM AGRICULTURAL (A-3a) TO SINGLE FAMILY RESIDENTIAL (RS-15) AT WAIAKEA, SOUTH HILO, HAWAII, COVERED BY TAX MAP KEY 2-4-37:9.

BE IT ORDAINED BY THE COUNCIL OF THE COUNTY OF HAWAII:

SECTION 1. Section 7.29 of Chapter 8 (Zoning Code), Article 2, Hawaii County Code, as amended, is hereby further amended by adding thereto the following subsection:

"7.29(ff). The district classification of the following area situated at Waiakea, South Hilo, Hawaii, shall be Single Family Residential (RS-15):

Beginning at the southwest corner of this lot, the southeast corner of Lot 59, Camp 6 House Lots Extension, and on the north side of Road "A" (50 feet wide), the coordinates of said point of beginning referred to Government Survey Triangulation Station "HALAI" being 18,777.23 feet South and 1151.92 feet West, as shown on Government Survey Registered Map 2650, and running by azimuths measured clockwise from true South:

1. 175° 40' 381.16 feet along Lot 59, Camp 6 House Lots Extension;
2. 265° 40' 116.07 feet along Lot 1003, Waiakea Homesteads, 2nd Series (Grant 10543 to Shinkichi Higa);
3. 355° 40' 360.04 feet along Lot 61, Camp 6 House Lots Extension;
4. 69° 29' 90.46 feet along the north side of Road "A" (50 feet wide);
5. 93° 39' 29.48 feet along same to the point of beginning and containing an area of 1.00 acre.

"All as outlined as red on the map attached hereto, marked Exhibit 'A' and by reference made a part hereof."

SECTION 2. Section 1 of this ordinance shall take effect forthwith upon the conditions that (A) the applicant, David Prudencio, Sr., submit a subdivision plan and secure tentative approval within one (1) year of

the date of approval of the subject request. The applicant shall also be responsible for securing final subdivision approval; (B) construction of another single-family dwelling commence within three (3) years of receipt of final subdivision approval; and (C) fifteen (15) feet along Ainaola Drive be delineated and set aside for future road widening purposes. Should any of the foregoing conditions not be met, rezoning to its original zoning designation may be initiated.

SECTION 3. In the event that any portion of this ordinance is declared invalid, such invalidity shall not affect the other parts of this ordinance.

SECTION 4. This ordinance shall take effect upon its approval.

INTRODUCED BY:

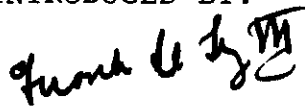

COUNCILMAN, COUNTY OF HAWAII

Hilo, Hawaii

Date of Introduction: April 9, 1975

Date of Adoption: April 24, 1975

Effective Date: May 2, 1975

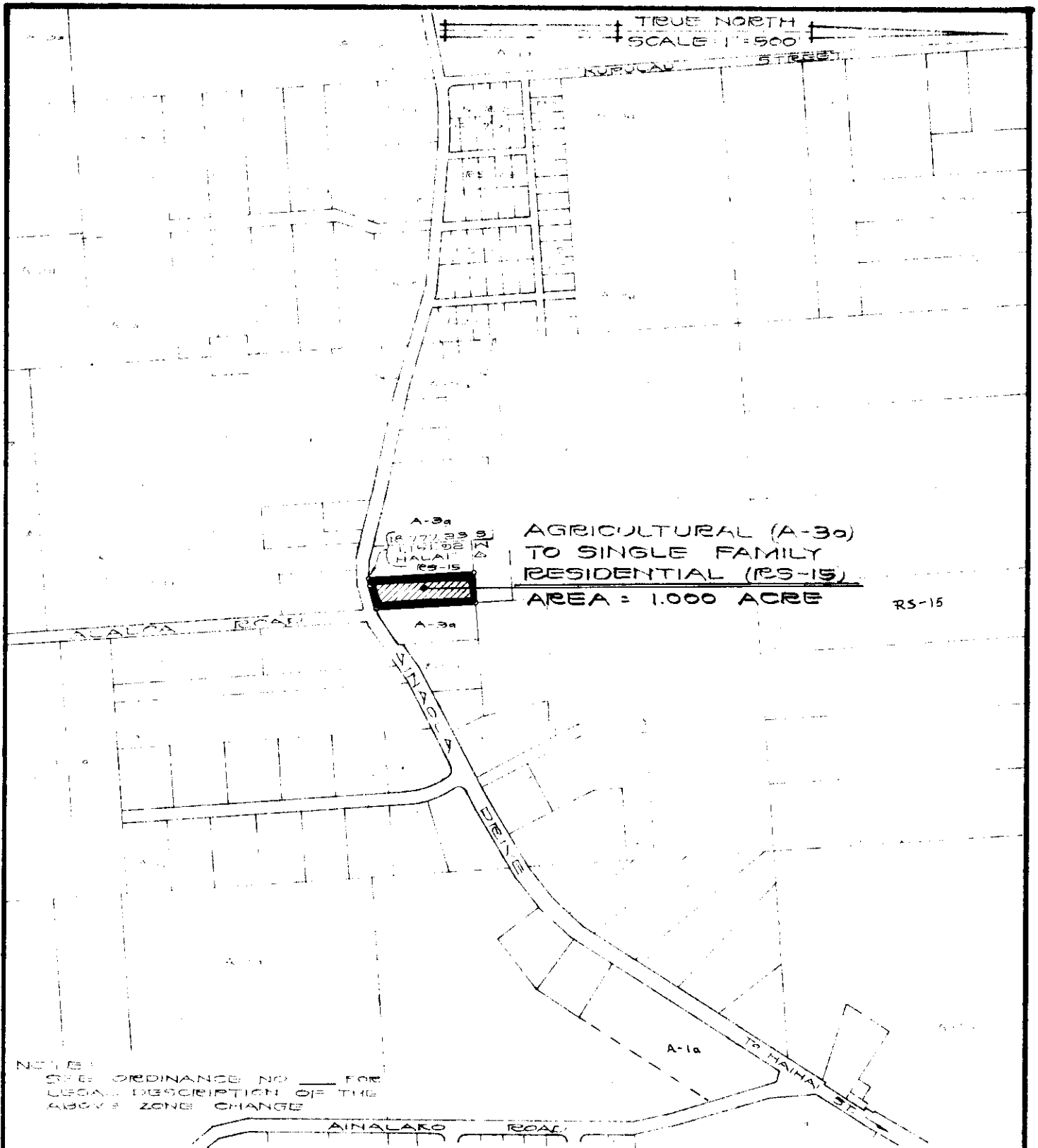

AMENDMENT TO THE ZONING CODE

AMENDMENT NO. _____ OF CHAPTER 8 (ZONING CODE),
ARTICLE 2, SECTION 7.29, THE CITY OF HILO ZONE
MAP, CHANGING THE DISTRICT CLASSIFICATION
FROM AGRICULTURAL (A-3a) TO SINGLE FAMILY
RESIDENTIAL (RS-15) AT WAIAKEA HOMESTEADS
2ND SERIES, WAIAKEA, SOUTH HILO, HAWAII.

DATE OF PUBLIC HEARING: JAN. 30, 1975
DATE OF APPROVAL:
ORDINANCE NO.
PREPARED BY: PLANNING DEPARTMENT
COUNTY OF HAWAII

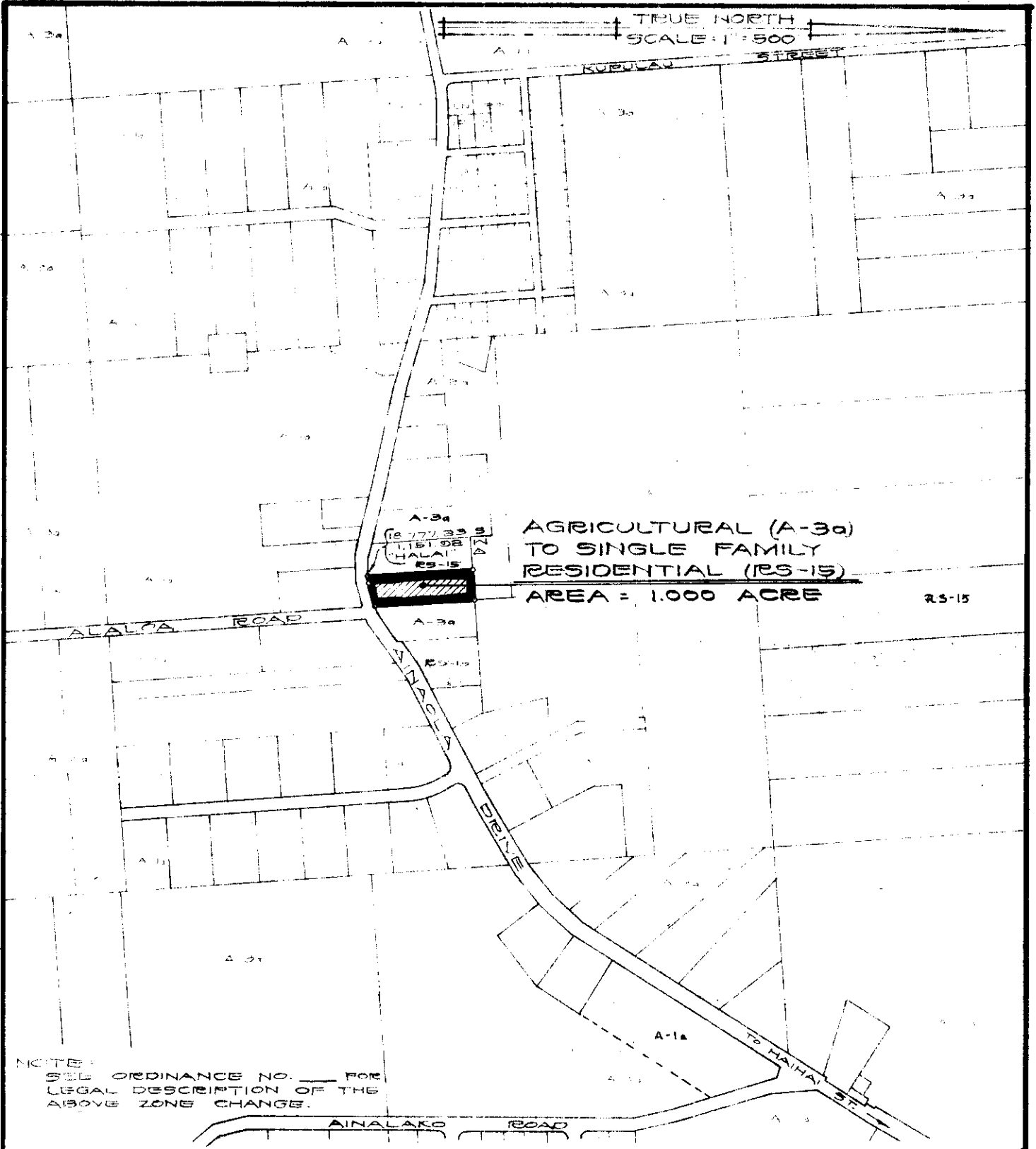

AMENDMENT TO THE ZONING CODE

AMENDMENT NO. _____ OF CHAPTER 8 (ZONING CODE),
ARTICLE 2, SECTION 7.29, THE CITY OF HILO ZONE
MAP, CHANGING THE DISTRICT CLASSIFICATION
FROM AGRICULTURAL (A-3a) TO SINGLE FAMILY
RESIDENTIAL (RS-15) AT WAIAKEA HOMESTEADS
2ND SERIES, WAIAKEA, SOUTH HILO, HAWAII.

DATE OF PUBLIC HEARING: JAN. 30, 1975
DATE OF APPROVAL:
ORDINANCE NO.
PREPARED BY: PLANNING DEPARTMENT
COUNTY OF HAWAII

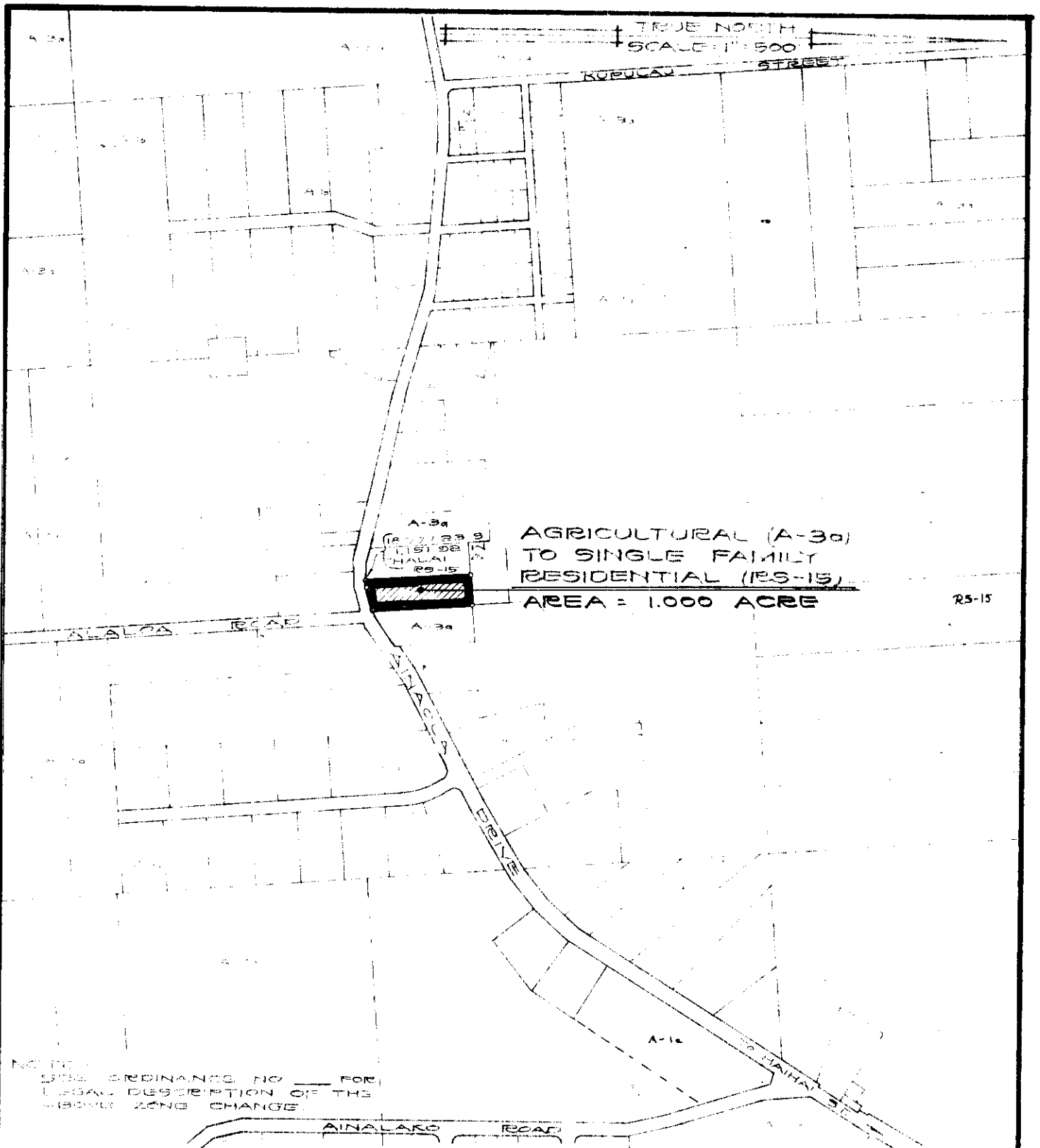

AMENDMENT TO THE ZONING CODE

AMENDMENT NO. _____ OF CHAPTER 8 (ZONING CODE), ARTICLE 2, SECTION 7.29, THE CITY OF HILO ZONE MAP, CHANGING THE DISTRICT CLASSIFICATION FROM AGRICULTURAL (A-3a) TO SINGLE FAMILY RESIDENTIAL (RS-15) AT WAIAKEA HOMESTEADS 2ND SERIES, WAIAKEA, SOUTH HILO, HAWAII.

DATE OF PUBLIC HEARING: JAN. 30, 1975
 DATE OF APPROVAL:
 ORDINANCE NO.
 PREPARED BY: PLANNING DEPARTMENT
 COUNTY OF HAWAII

TMK: 2-4-37:9

JAN. 30, 1975

EXHIBIT "A"

Hilo, Hawaii
Date: April 9, 1975

FIRST READING			
	AYES	NOES	A/E
Carpenter	X		
De Luz	X		
Fujii	X		
Hisaoka	X		
Kawahara	X		
Lai	X		
Levin	X		
Yadao	X		
Yamada	X		
	9		

Kailua-Kona, Hawaii
Date: April 24, 1975

SECOND & FINAL READING			
	AYES	NOES	A/E
Carpenter	X		
De Luz	X		
Fujii	X		
Hisaoka	X		
Kawahara	X		
Lai	X		
Levin	X		
Yadao	X		
Yamada	X		
	9		

Publication Date: APR 11 1975

Publication Date: May 11, 1975

We do hereby certify that the foregoing BILL was adopted by the County Council and published as indicated above.

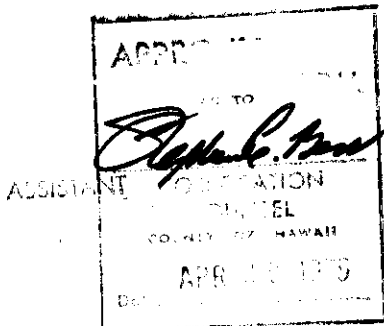

Robert M. Yamada
Council Chairman

R. D. Mijiri
Deputy County Clerk

Approved/Disapproved this 2nd day of May, 1975

Robert M. Yamada
Mayor, County of Hawaii

Bill No. 114
Reference: C-1226/PRDLC-48
M.B. No. 1210-
Ord. No. 10.

Ted T. Suzuki
COUNTY CLERK

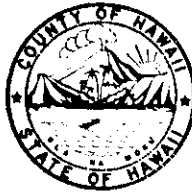

Robert Shioji
DEPUTY COUNTY CLERK

OFFICE OF THE COUNTY CLERK
COUNTY OF HAWAII
HILO, HAWAII 96720

Mayor Herbert T. Matayoshi
County of Hawaii
Hilo, Hawaii

I hereby transmit Ordinance Bill No. 114
passed by the County Council on second and final
reading.

DEPUTY COUNTY CLERK

Encl.

Dated: April 15, 1975

Bill No. 114 - 1975

AN ORDINANCE AMENDING SECTION 7.29, THE CITY OF HILO ZONE MAP OF CHAPTER 8 (ZONING CODE), ARTICLE 2, HAWAII COUNTY CODE, AS AMENDED, BY CHANGING THE DISTRICT CLASSIFICATION FROM AGRICULTURAL (A-3a) TO SINGLE FAMILY RESIDENTIAL (RS-15) AT WAIAKEA, SOUTH HILO, HAWAII, COVERED BY TAX MAP KEY 2-4-37:9.

This Bill amends Section 7.29, the City of Hilo Zone Map, Chapter 8 (Zoning Code), Article 2, Hawaii County Code, as amended, by changing the district classification from Agricultural (A-3a) to Single Family Residential (RS-15) at Waiakea, S. Hilo.

Date Introduced: April 9, 1975

Copies of the foregoing Bill, in full, are on file in the Office of the County Clerk for use and examination by the public.

I hereby certify that the foregoing Bill passed first reading at the meeting of the County Council on April 9, 1975, by the following aye and no vote:

AYES: Councilmen Carpenter, De Luz, Fujii, Hisaoka, Kawahara, Lai, Levin, Yadao and Chairman Yamada - 9.

NOES: None



COUNTY CLERK
COUNTY OF HAWAII

CHAPTER 8 (ZONING CODE), ARTICLE 2, HAWAII COUNTY CODE, AS AMENDED, BY CHANGING THE DISTRICT CLASSIFICATION FROM AGRICULTURAL (A-3a) TO SINGLE FAMILY RESIDENTIAL (RS-15) AT WAIAKEA, SOUTH HILO, HAWAII, COVERED BY TAX MAP KEY 2-4-37:9.

This Bill amends Section 7.29, the City of Hilo Zone Map, Chapter 8 (Zoning Code), Article 2, Hawaii County Code, as amended, by changing the district classification from Agricultural (A-3a) to Single Family Residential (RS-15) at Waiakea, S. Hilo.

Date Introduced: April 9, 1975
Copies of the foregoing Bill, in full, are on file in the Office of the County Clerk for use and examination by the public.

I hereby certify that the foregoing Bill passed first reading at the meeting of the County Council on April 9, 1975, by the following aye and no vote:

AYES: Councilmen Carpenter, De Luz, Fujii, Hisaoka, Kawahara, Lai, Levin, Yadao and Chairman Yamada - 9.

NOES: None

TED T. SUZUKI
COUNTY CLERK
COUNTY OF HAWAII

ORDINANCE NO. 107
(Bill No. 114-1975)

AN ORDINANCE AMENDING SECTION 7.29, THE CITY OF HILO ZONE MAP OF CHAPTER 8 (ZONING CODE), ARTICLE 2, HAWAII COUNTY CODE, AS AMENDED, BY CHANGING THE DISTRICT CLASSIFICATION FROM AGRICULTURAL (A-3a) TO SINGLE FAMILY RESIDENTIAL (RS-15) AT WAIAKEA, SOUTH HILO, HAWAII, COVERED BY TAX MAP KEY 2-4-37:9.

Date Approved: April 24, 1975
Date Effective: May 2, 1975

Copies of the foregoing Ordinance, in full, are on file in the Office of the County Clerk for use and examination by the public.

I hereby certify that the foregoing Ordinance passed second and final reading at the meeting of the County Council on April 24, 1975, by the following aye and no vote:

AYES: Councilmen Carpenter, De Luz, Fujii, Hisaoka, Kawahara, Lai, Levin, Yadao and Chairman Yamada - 9.

NOES: None.



COUNTY CLERK
COUNTY OF HAWAII

AN ORDINANCE AMENDING SECTION 7.29, THE CITY OF HILO ZONE MAP OF CHAPTER 8 (ZONING CODE), ARTICLE 2, HAWAII COUNTY CODE, AS AMENDED, BY CHANGING THE DISTRICT CLASSIFICATION FROM AGRICULTURAL (A-3a) TO SINGLE FAMILY RESIDENTIAL (RS-15) AT WAIAKEA, SOUTH HILO, HAWAII, COVERED BY TAX MAP KEY 2-4-37:9.

Date Approved: April 24, 1975
Date Effective: May 2, 1975
Copies of the foregoing Ordinance, in full, are on file in the Office of the County Clerk for use and examination by the public.

I hereby certify that the foregoing Ordinance passed second and final reading at the meeting of the County Council on April 24, 1975, by the following aye and no vote:
AYES: Councilmen Carpenter, De Luz, Fujii, Hisaoka, Kawahara, Lai, Levin, Yadao and Chairman Yamada - 9.

NOES: None.
TED T. SUZUKI
COUNTY CLERK
COUNTY OF HAWAII