

COUNTY OF HAWAII - STATE OF HAWAII

ORDINANCE NO. 108

AN ORDINANCE AMENDING SECTION 7.24, THE KA'U DISTRICT ZONE MAP OF CHAPTER 8 (ZONING CODE), ARTICLE 2, HAWAII COUNTY CODE, AS AMENDED, BY CHANGING THE DISTRICT CLASSIFICATION FROM OPEN (O) TO SINGLE FAMILY RESIDENTIAL (RS-20) AT NINOLE, KA'U, HAWAII, COVERED BY TAX MAP KEY 9-5-19:PORTION OF 11.

BE IT ORDAINED BY THE COUNCIL OF THE COUNTY OF HAWAII:

SECTION 1. Section 7.24 of Chapter 8 (Zoning Code), Article 2, Hawaii County Code, as amended, is hereby further amended by adding thereto the following subsection:

"7.24(g). The district classification of the following area situated at Ninole, Ka'u, Hawaii, shall be Single Family Residential (RS-20):

Beginning at the south corner of this parcel of land being also the southwest corner of Grant 825 to S. Kauai and the northwest corner of Grant 821 to Holoua, the coordinates of which referred to Government Survey Triangulation Station "HILL" (Puehu) being 4253.71 feet South and 350.82 feet West and running by azimuths measured clockwise from true South:

- |    |          |   |
|----|----------|---|
| 1. | 144° 40' | 762.48 feet along the Government Land of Ninole;  |
| 2. | 259° 00' | 130.63 feet along remainder of Grant 825 to S. Kauai;   |
| 3. | 299° 00' | 269.28 feet along remainder of Grant 825 to S. Kauai;   |
| 4. | 324° 00' | 149.00 feet along remainder of Grant 825 to S. Kauai;   |
| 5. | 1° 30'   | 396.00 feet along remainder of Grant 825 to S. Kauai to the point of beginning and containing an area of 2.734 acres. |

"All as outlined in red on the map attached hereto, marked Exhibit 'A' and by reference made a part hereof."

SECTION 2. Section 1 of this ordinance shall take effect forthwith upon the conditions that (A) the applicant, Hawaiiana Investment Company, Inc., submit a subdivision plan for the 2.7-acre parcel and secure tentative approval within one (1) year from the date of approval of the change

of zone request. The applicant shall also be responsible for securing final subdivision approval; (B) construction shall commence within one (1) year of receipt of the final subdivision approval; and (C) all applicable rules and regulations, including the "Plan Approval" process, be complied with. Should any of the foregoing conditions not be met, rezoning of the property to its original zoning designation may be initiated.

SECTION 3. In the event that any portion of this ordinance is declared invalid, such invalidity shall not affect the other parts of this ordinance.

SECTION 4. This ordinance shall take effect upon its approval.

INTRODUCED BY:



COUNCILMAN, COUNTY OF HAWAII

Hilo, Hawaii

Date of Introduction: April 9, 1975

Date of Adoption: April 24, 1975

Effective Date: May 2, 1975

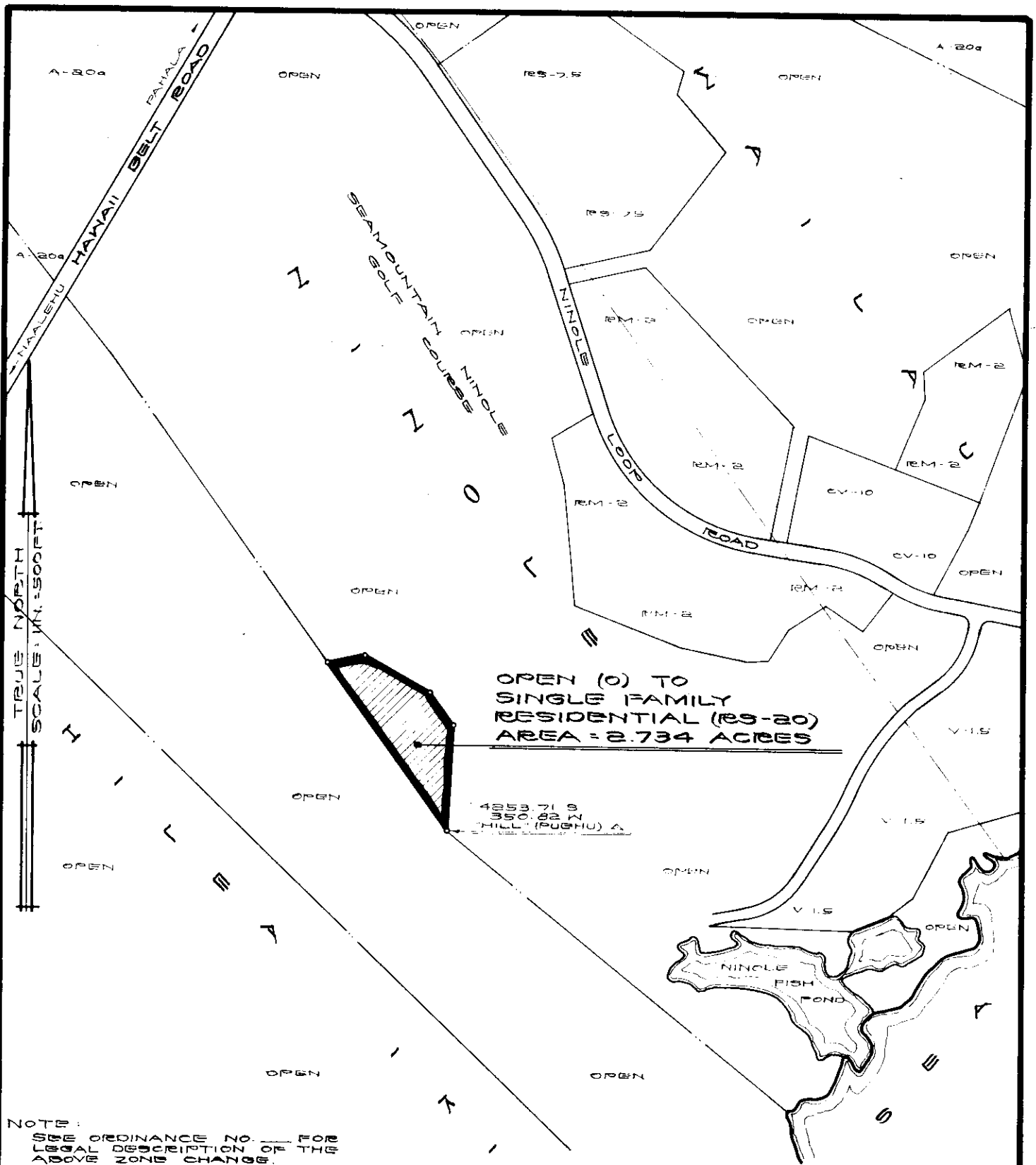

NOTE:  
SEE ORDINANCE NO. \_\_\_\_\_ FOR  
LEGAL DESCRIPTION OF THE  
ABOVE ZONE CHANGE.

## AMENDMENT TO THE ZONING CODE

AMENDMENT NO. \_\_\_\_\_ OF CHAPTER 8 (ZONING CODE), ARTICLE 2, SECTION 7.24, THE KA'U DISTRICT ZONE MAP, CHANGING THE DISTRICT CLASSIFICATION FROM OPEN (O) TO SINGLE FAMILY RESIDENTIAL (RS-20) AT NINOLE, KA'U, HAWAII.

DATE OF PUBLIC HEARING: JAN. 30, 1975  
DATE OF APPROVAL:  
ORDINANCE NO.  
PREPARED BY: PLANNING DEPARTMENT  
COUNTY OF HAWAII

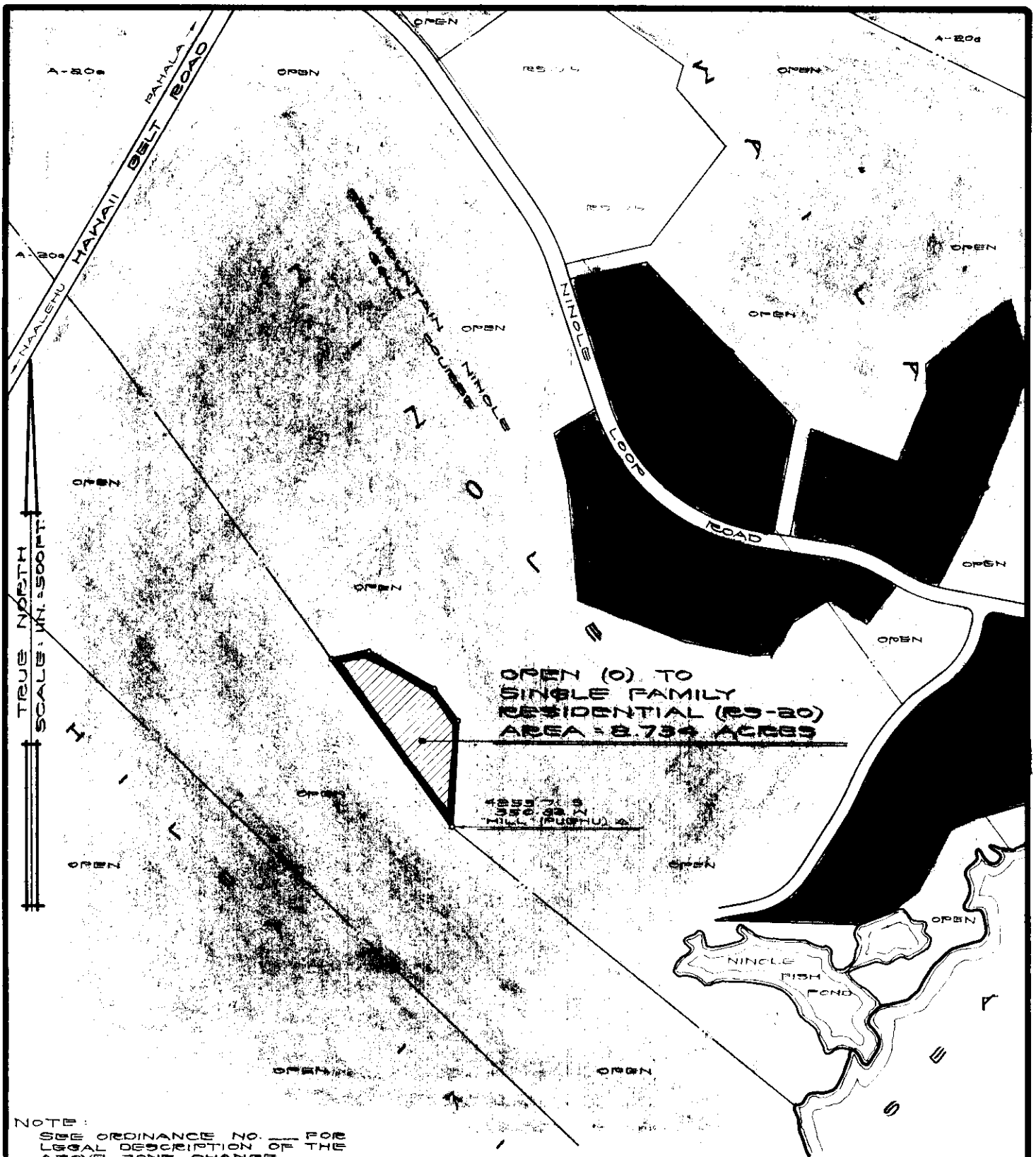

## AMENDMENT TO THE ZONING CODE

AMENDMENT NO. OF CHAPTER 8 (ZONING CODE), ARTICLE 2, SECTION 7.24, THE KA'U DISTRICT ZONE MAP, CHANGING THE DISTRICT CLASSIFICATION FROM OPEN (O) TO SINGLE FAMILY RESIDENTIAL (RS-20) AT NINOLE, KA'U, HAWAII.

DATE OF PUBLIC HEARING: JAN. 30, 1975

DATE OF APPROVAL:

ORDINANCE NO.

PREPARED BY: PLANNING DEPARTMENT  
COUNTY OF HAWAII

TMK: 9-5-19:11 (POB)

JAN. 30, 1975

EXHIBIT "A"

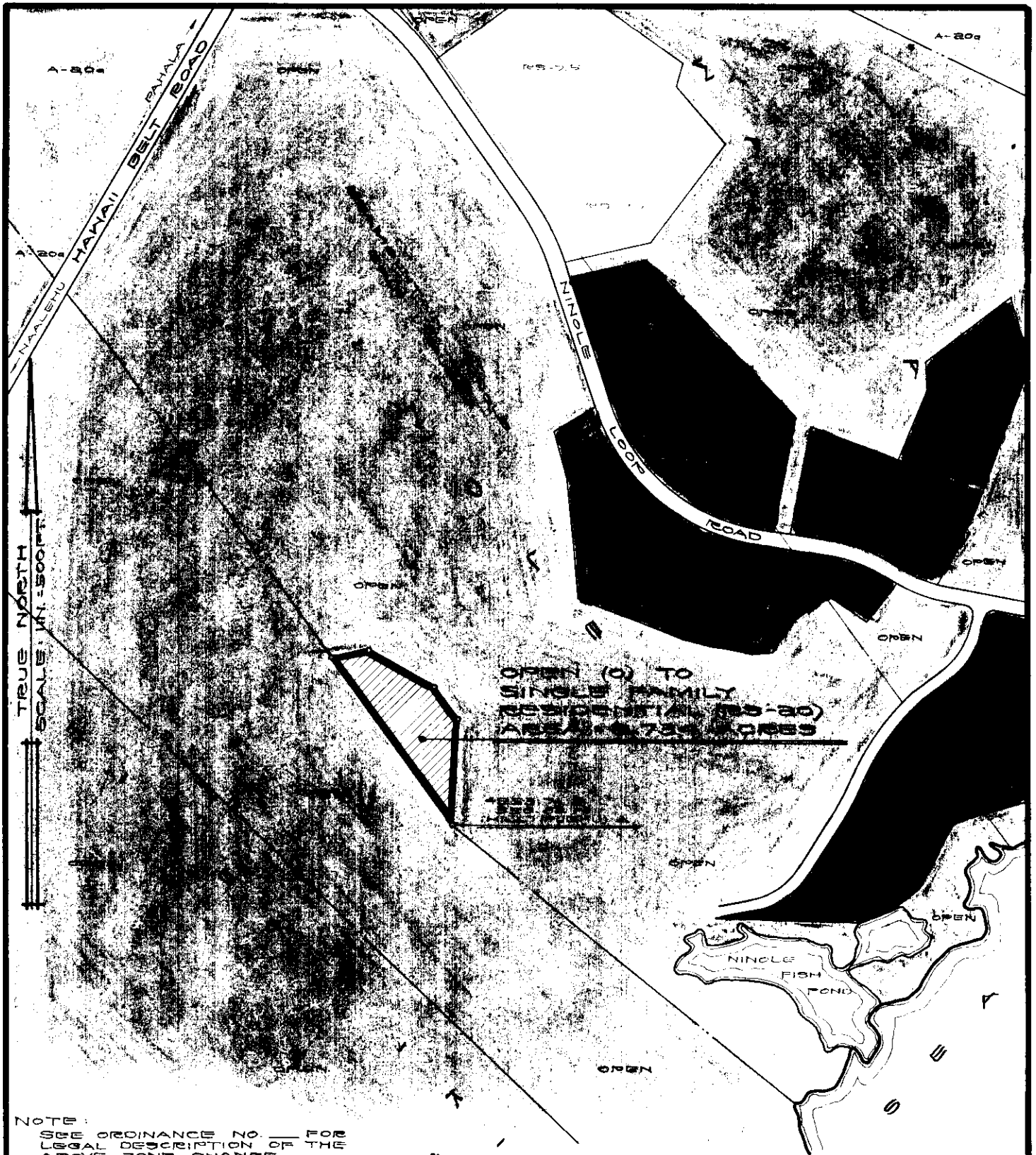

NOTE:  
 SEE ORDINANCE NO. \_\_\_ FOR  
 LEGAL DESCRIPTION OF THE  
 ABOVE ZONE CHANGE.

## AMENDMENT TO THE ZONING CODE

AMENDMENT NO. \_\_\_ OF CHAPTER 8 (ZONING CODE), ARTICLE 2, SECTION 7.24, THE KA'U DISTRICT ZONE MAP, CHANGING THE DISTRICT CLASSIFICATION FROM OPEN (O) TO SINGLE FAMILY RESIDENTIAL (RS-20) AT NINOLE, KA'U, HAWAII.

DATE OF PUBLIC HEARING: JAN. 30, 1975  
 DATE OF APPROVAL:  
 ORDINANCE NO.  
 PREPARED BY: PLANNING DEPARTMENT  
 COUNTY OF HAWAII

Hilo, Hawaii  
Date: April 9, 1975

| FIRST READING |      |      |     |
|---------------|------|------|-----|
|               | AYES | NOES | A/E |
| Carpenter     |      |      | EX. |
| De Luz        | X    |      |     |
| Fujii         | X    |      |     |
| Hisaoka       | X    |      |     |
| Kawahara      | X    |      |     |
| Lai           | X    |      |     |
| Levin         | X    |      |     |
| Yadao         | X    |      |     |
| Yamada        | X    |      |     |
|               | 8    |      | 1   |

Kailua-Kona, Hawaii  
Date: April 24, 1975

| SECOND & FINAL READING |      |      |         |
|------------------------|------|------|---------|
|                        | AYES | NOES | A/E     |
| Carpenter              |      |      | ABSTAIN |
| De Luz                 | X    |      |         |
| Fujii                  | X    |      |         |
| Hisaoka                | X    |      |         |
| Kawahara               | X    |      |         |
| Lai                    | X    |      |         |
| Levin                  | X    |      |         |
| Yadao                  | X    |      |         |
| Yamada                 | X    |      |         |
|                        | 8    | 0    | 1       |

Publication Date: APR 11 1975

Publication Date: May 11, 1975

We do hereby certify that the foregoing BILL was adopted by the County Council and published as indicated above.

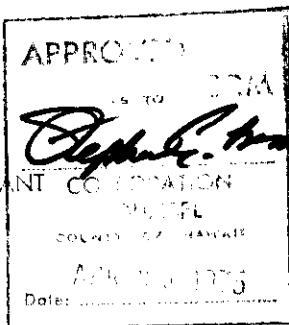

*Robert M. Yamada*  
\_\_\_\_\_  
Council Chairman

*R. O. Mijori*  
\_\_\_\_\_  
Deputy County Clerk

Approved/Disapproved this 11th day of May, 19 75.

*[Signature]*  
\_\_\_\_\_  
Mayor, County of Hawaii

Bill No. 115  
Reference: C-1127/PRDLC-48  
M.B. No. 1211 -  
Ord. No. 108

Bill No. 115 - 1975

AN ORDINANCE AMENDING SECTION 7.24, THE KA'U DISTRICT ZONE MAP OF CHAPTER 8 (ZONING CODE), ARTICLE 2, HAWAII COUNTY CODE, AS AMENDED, BY CHANGING THE DISTRICT CLASSIFICATION FROM OPEN (O) TO SINGLE FAMILY RESIDENTIAL (RS-20) AT NINOLE, KA'U, HAWAII, COVERED BY TAX MAP KEY 9-5-19: PORTION OF 11.

This Bill amends Section 7.24, the Kau District Zone Map, Chapter 8 (Zoning Code), Article 2, Hawaii County Code, as amended, by changing the district classification from Open (O) to Single Family Residential (RS-20) at Ninole, Kau.

Date Introduced: April 9, 1975

Copies of the foregoing Bill, in full, are on file in the Office of the County Clerk for use and examination by the public.

---

I hereby certify that that foregoing Bill passed first reading at the meeting of the County Council on April 9, 1975, by the following aye and no vote:

AYES: Councilmen De Luz, Fujii, Hisaoka, Kawahara, Lai, Levin, Yadao and Chairman Yamada - 8.

EXCUSED FROM VOTING: Councilman Carpenter - 1.

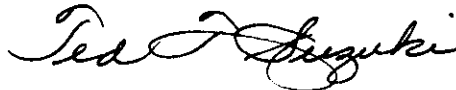

COUNTY CLERK  
COUNTY OF HAWAII

Bill No. 115 - 1975  
AN ORDINANCE AMENDING SECTION 7.24, THE KA'U DISTRICT ZONE MAP OF CHAPTER 8 (ZONING CODE), ARTICLE 2, HAWAII COUNTY CODE, AS AMENDED, BY CHANGING THE DISTRICT CLASSIFICATION FROM OPEN (O) TO SINGLE FAMILY RESIDENTIAL (RS-20) AT NINOLE, KA'U, HAWAII, COVERED BY TAX MAP KEY 9-5-19: PORTION OF 11.

This Bill amends Section 7.24, the Kau District Zone Map, Chapter 8 (Zoning Code), Article 2, Hawaii County Code, as amended, by changing the district classification from Open (O) to Single Family Residential (RS-20) at Ninole, Kau.

Date Introduced: April 9, 1975  
Copies of the foregoing Bill, in full, are on file in the Office of the County Clerk for use and examination by the public.

I hereby certify that the foregoing Bill passed first reading at the meeting of the County Council on April 9, 1975, by the following aye and no vote:

AYES: Councilmen De Luz, Fujii, Hisaoka, Kawahara, Lai, Levin, Yadao and Chairman Yamada - 8.

EXCUSED FROM VOTING: Councilman Carpenter - 1.

TED T. SUZUKI  
COUNTY CLERK  
COUNTY OF HAWAII

ORDINANCE NO. 108  
(Bill No. 115-1975)

AN ORDINANCE AMENDING SECTION 7.24, THE KA'U DISTRICT ZONE MAP OF CHAPTER 8 (ZONING CODE), ARTICLE 2, HAWAII COUNTY CODE, AS AMENDED, BY CHANGING THE DISTRICT CLASSIFICATION FROM OPEN (O) TO SINGLE FAMILY RESIDENTIAL (RS-20) AT NINOLE, KA'U, HAWAII, COVERED BY TAX MAP KEY 9-5-19:PORTION OF 11.

Date Approved: April 24, 1975  
Date Effective: May 2, 1975

Copies of the foregoing Ordinance, in full, are on file in the Office of the County Clerk for use and examination by the public.

---

I hereby certify that the foregoing Ordinance passed second and final reading at the meeting of the County Council on April 24, 1975, by the following aye and no vote:

AYES: Councilmen De Luz, Fujii, Hisaoka, Kawahara, Lai, Levin, Yadao and Chairman Yamada - 8.

NOES: None.

EXCUSED FROM VOTING: Councilman Carpenter - 1.

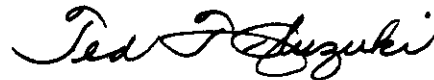

COUNTY CLERK  
COUNTY OF HAWAII



7.24, THE KA'U DISTRICT ZONE MAP OF CHAPTER 8 (ZONING CODE), ARTICLE 2, HAWAII COUNTY CODE, AS AMENDED, BY CHANGING THE DISTRICT CLASSIFICATION FROM OPEN (O) TO SINGLE FAMILY RESIDENTIAL (RS-20) AT NINOLE, KA'U, HAWAII, COVERED BY TAX MAP KEY 9-5-19:PORTION OF 11.

Date Approved: April 24, 1975  
Date Effective: May 2, 1975

Copies of the foregoing Ordinance, in full, are on file in the Office of the County Clerk for use and examination by the public.

I hereby certify that the foregoing Ordinance passed second and final reading at the meeting of the County Council on April 24, 1975, by the following aye and no vote:  
AYES: Councilmen De Luz, Fujii, Hisaoka, Kawahara, Lai, Levin, Yadao and Chairman Yamada - 8.

NOES: None.

EXCUSED FROM VOTING: Councilman Carpenter - 1.

TED T. SUZUKI  
COUNTY CLERK  
COUNTY OF HAWAII





Ted T. Suzuki  
COUNTY CLERK

Robert Shioji  
DEPUTY COUNTY CLERK

OFFICE OF THE COUNTY CLERK  
COUNTY OF HAWAII  
HILO, HAWAII 96720

Mayor Herbert T. Matayoshi  
County of Hawaii  
Hilo, Hawaii

I hereby transmit Ordinance Bill No. 115  
passed by the County Council on second and final  
reading.

  
DEPUTY COUNTY CLERK

Encl.

Dated: APR 2 8 1975