

COUNTY OF HAWAII - STATE OF HAWAII

ORDINANCE NO. 110

AN ORDINANCE AMENDING ORDINANCE NO. 74 WHICH AMENDED SECTION 7.02, THE NORTH KONA ZONE MAP OF CHAPTER 8 (ZONING CODE), ARTICLE 2, HAWAII COUNTY CODE, AS AMENDED, BY CHANGING THE DISTRICT CLASSIFICATION FROM AGRICULTURAL (A-1a) TO MULTIPLE FAMILY RESIDENTIAL (RM-4) AT KANAUEUE 1ST, NORTH KONA, HAWAII, COVERED BY TAX MAP KEY 7-9-10:PORTION OF 4.

BE IT ORDAINED BY THE COUNCIL OF THE COUNTY OF HAWAII:

SECTION 1. Section 7.02 of Chapter 8 (Zoning Code), Article 2, Hawaii County Code, as amended, is hereby further amended by adding thereto the following subsection:

"7.02(). The district classification of the following area situated at Kanaeue 1st, North Kona, Hawaii, shall be Multiple Family Residential (RM-4):

Beginning at the northwest corner of this parcel of land, the coordinates of which referred to Government Survey Triangulation Station "PUU OHAU" being 3582.01 feet North and 11,172.81 feet East, and thence running by azimuths measured clockwise from true South:

Along stonewall, along remainder of Grant 146 to George Thornton for the following five (5) courses:

- | | | |
|----|----------|--------------|
| 1. | 256° 28' | 120.08 feet; |
| 2. | 249° 29' | 144.92 feet; |
| 3. | 250° 40' | 98.09 feet; |
| 4. | 255° 23' | 102.71 feet; |
| 5. | 329° 01' | 55.12 feet; |

thence along remainder of Grant 146 to George Thornton for the following three (3) courses:

- | | | |
|----|----------|--|
| 6. | 256° 17' | 59.44 feet; |
| 7. | 340° 39' | 39.71 feet; |
| 8. | 254° 24' | 486.77 feet, thence |
| 9. | 344° 24' | 223.71 feet along remainder of Grant 146 to George Thornton; |

thence along stonewall, along Grant 173 to John Peters at Kanaeue 2 for the following three (3) courses:

- 10. 69° 32' 30" 87.78 feet;
- 11. 67° 00' 30" [130.00] 130.04 feet;
- 12. 71° 19' 261.82 feet;

thence along Land Court Application 1703 for the following four (4) courses:

- 13. 163° 49' 111.00 feet;
- 14. 75° 57' 30" 164.83 feet;
- 15. 52° 51' 23.43 feet;
- 16. 77° 54' 373.20 feet, thence
- 17. 167° 36' 30" 119.57 feet along the easterly side of Mamalahoa Highway;

thence along the easterly side of Mamalahoa Highway on a 1940.08 foot radius curve to the left, the chord azimuth and distance being:

- 18. 166° 12' 20" 95.00 feet to the point of beginning and containing an area of [5.659] 5.571 Acres.

"All as outlined in red on the map attached hereto, marked Exhibit 'A' and by reference made a part hereof."

SECTION 2. Material to be repealed is bracketed. New material is underscored. When incorporating this ordinance into the Hawaii County Code, the incorporator need not include the brackets, the bracketed material, or the underscoring.

SECTION 3. This ordinance shall take effect upon its approval.

INTRODUCED BY:

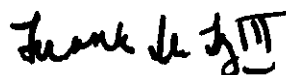

COUNCILMAN, COUNTY OF HAWAII

Hilo, Hawaii

Date of Introduction: April 9, 1975

Date of Adoption: April 24, 1975

Effective Date: May 2, 1975

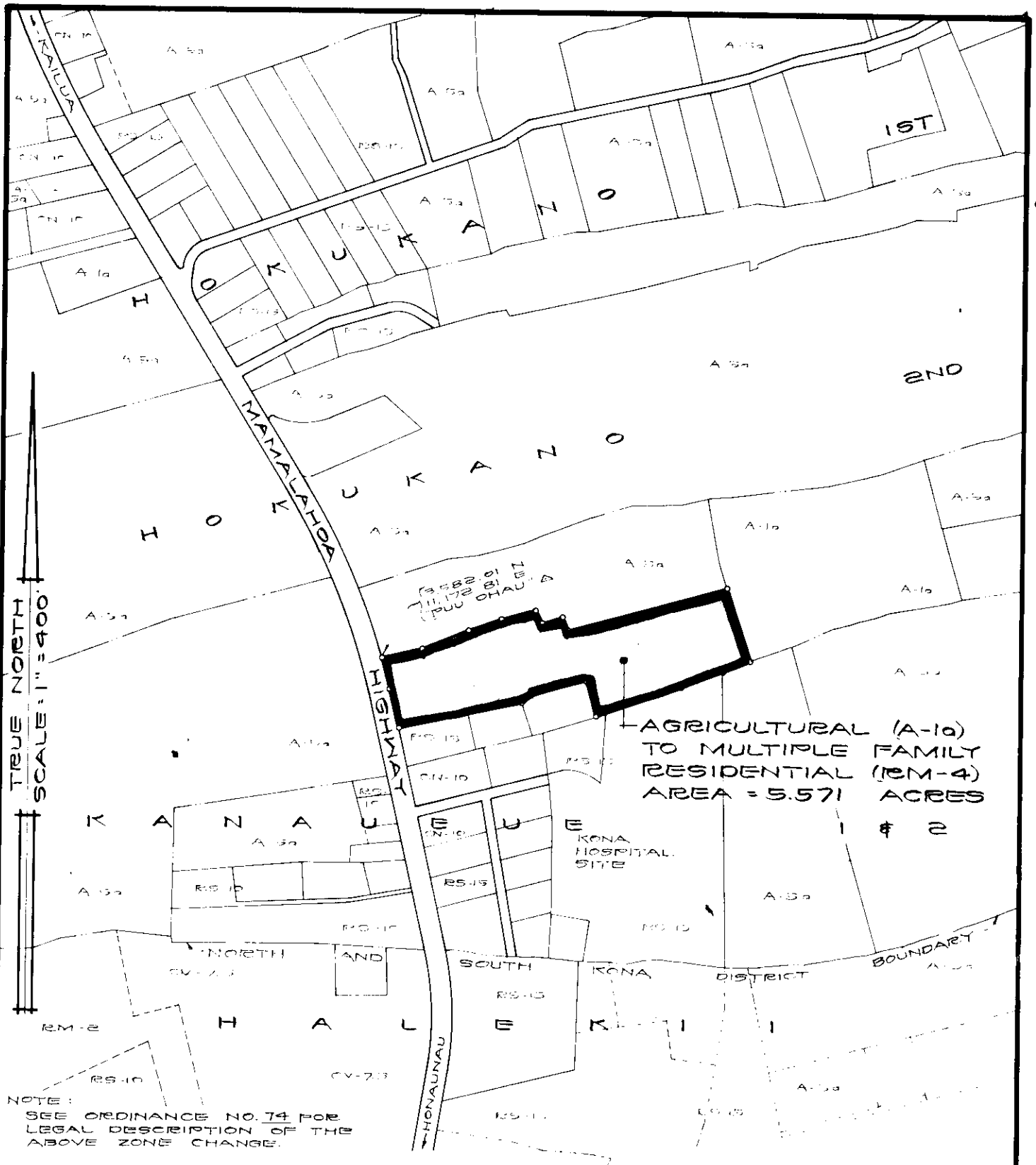

AMENDMENT TO THE ZONING CODE

AMENDMENT NO. 40 OF CHAPTER 8 (ZONING CODE), ARTICLE 2, SECTION 7.02, THE NORTH KONA ZONE MAP, CHANGING THE DISTRICT CLASSIFICATION FROM AGRICULTURAL (A-1a) TO MULTIPLE FAMILY RESIDENTIAL (RM-4) AT KANAUEUE 1ST, NORTH KONA, HAWAII.

DATE OF PUBLIC HEARING: SEPT. 13, 1974

DATE OF APPROVAL: NOV. 20, 1974

ORDINANCE NO. 74

PREPARED BY: PLANNING DEPARTMENT
COUNTY OF HAWAII

TMK: 7-9-10: POR 4

SEPT. 23, 1974

EXHIBIT "A"

REVISED: FEB. 19, 1975

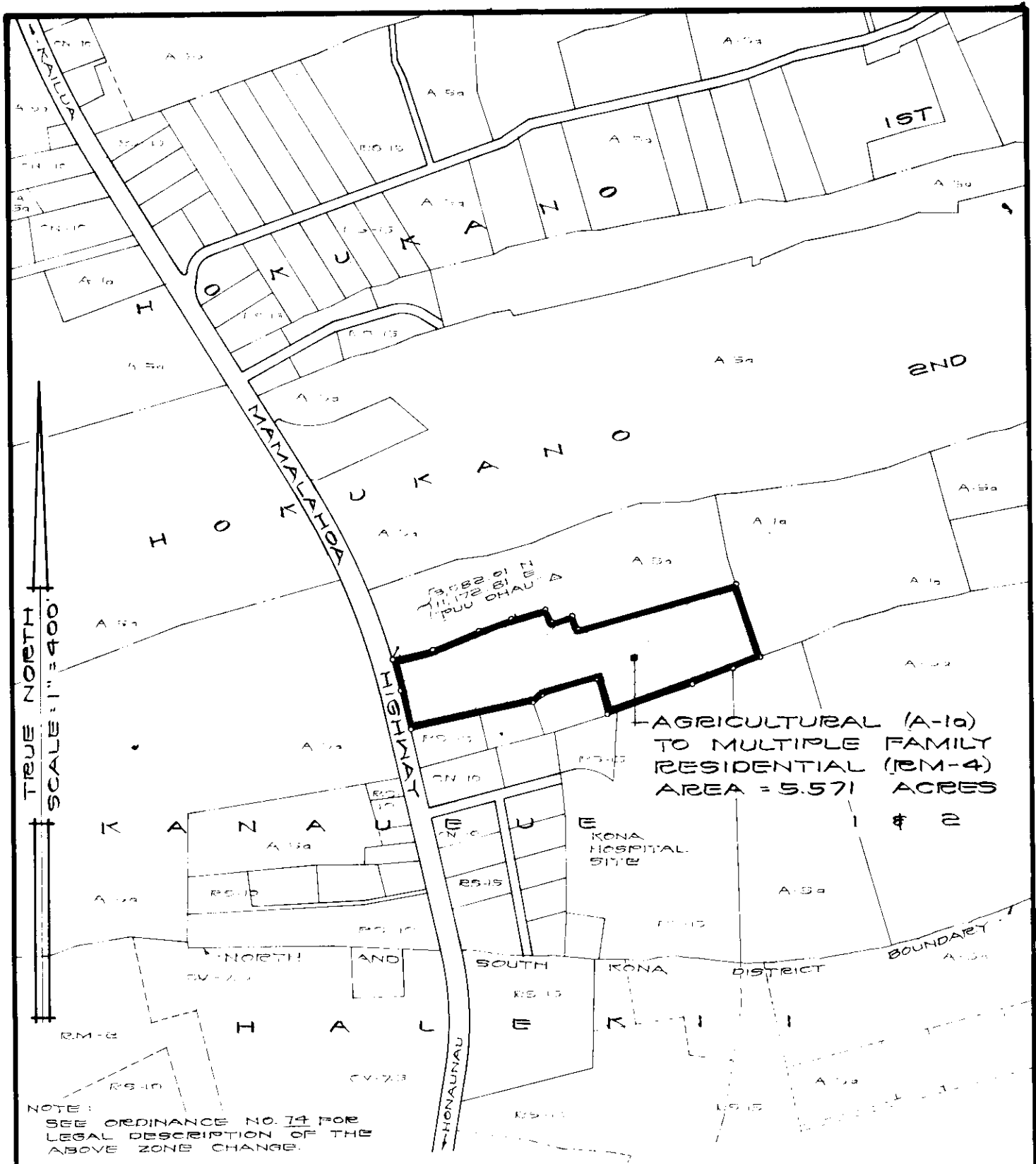

AMENDMENT TO THE ZONING CODE

AMENDMENT NO. 40 OF CHAPTER 8 (ZONING CODE), ARTICLE 2, SECTION 702, THE NORTH KONA ZONE MAP, CHANGING THE DISTRICT CLASSIFICATION FROM AGRICULTURAL (A-1a) TO MULTIPLE FAMILY RESIDENTIAL (RM-4) AT KANAUEUE 1ST, NORTH KONA, HAWAII.

DATE OF PUBLIC HEARING: SEPT. 13, 1974
 DATE OF APPROVAL: NOV. 26, 1974
 ORDINANCE NO. 74
 PREPARED BY: PLANNING DEPARTMENT
 COUNTY OF HAWAII

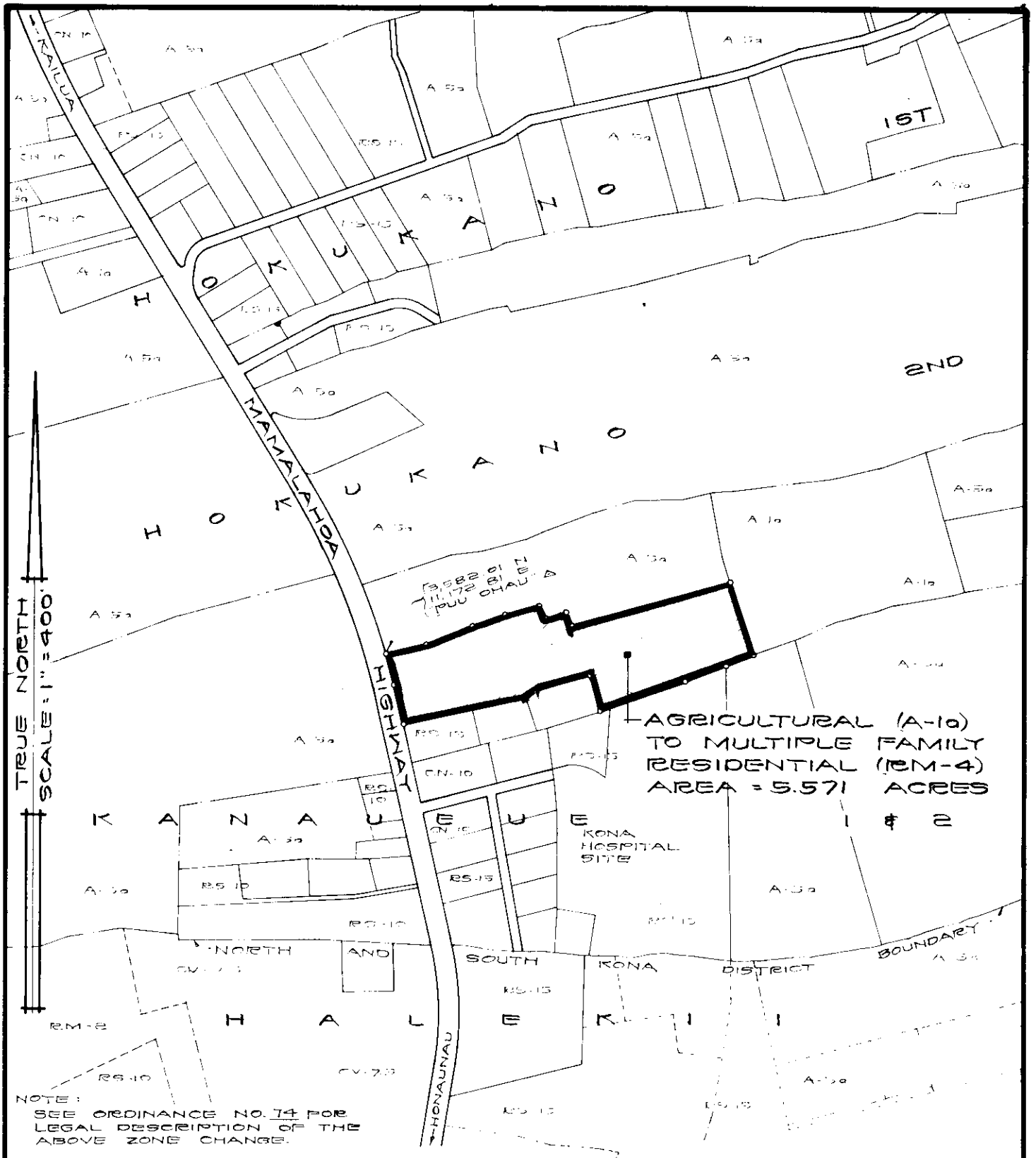

AMENDMENT TO THE ZONING CODE

AMENDMENT NO. 40 OF CHAPTER 8 (ZONING CODE), ARTICLE 2, SECTION 702, THE NORTH KONA ZONE MAP, CHANGING THE DISTRICT CLASSIFICATION FROM AGRICULTURAL (A-1a) TO MULTIPLE FAMILY RESIDENTIAL (RM-4) AT KANAUEUE 1ST, NORTH KONA, HAWAII.

DATE OF PUBLIC HEARING: SEPT. 13, 1974
 DATE OF APPROVAL: NOV. 26, 1974
 ORDINANCE NO. 74
 PREPARED BY: PLANNING DEPARTMENT
 COUNTY OF HAWAII

Hilo, Hawaii
Date: April 9, 1975

FIRST READING			
	AYES	NOES	A/E
Carpenter	X		
De Luz	X		
Fujii	X		
Hisaoka	X		
Kawahara	X		
Lai	X		
Levin	X		
Yadao	X		
Yamada	X		
	9		

Publication Date: APR 14 1975

Kailua-Kona, Hawaii
Date: April 24, 1975

SECOND & FINAL READING			
	AYES	NOES	A/E
Carpenter	X		
De Luz	X		
Fujii	X		
Hisaoka	X		
Kawahara	X		
Lai	X		
Levin	X		
Yadao	X		
Yamada	X		
	9		

Publication Date: May 11, 1975

We do hereby certify that the foregoing BILL was adopted by the County Council and published as indicated above.

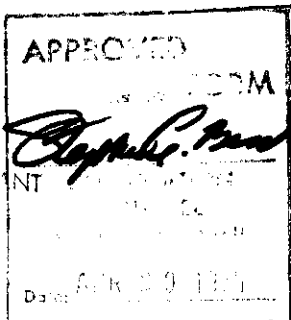

Robert M. Yamada
Council Chairman

R. P. Ohigiji
Deputy County Clerk

Approved/Disapproved this 2nd day of May, 1975

Hubert H. Hironaka
Mayor, County of Hawaii

Bill No. 117
Reference: C-1036.1/PRDLC-48
M.B. No. 12/2 -
Ord. No. 110

Bill No. 117 - 1975

AN ORDINANCE AMENDING ORDINANCE NO. 74 WHICH AMENDED SECTION 7.02, THE NORTH KONA ZONE MAP OF CHAPTER 8 (ZONING CODE), ARTICLE 2, HAWAII COUNTY CODE, AS AMENDED, BY CHANGING THE DISTRICT CLASSIFICATION FROM AGRICULTURAL (A-1a) TO MULTIPLE FAMILY RESIDENTIAL (RM-4) AT KANAUEUE 1ST, NORTH KONA, HAWAII, COVERED BY TAX MAP KEY 7-9-10:PORTION OF 4.

This Bill amends Ord. 74 which amended Section 7.02, the North Kona Zone Map, Chapter 8 (Zoning Code), Article 2, Hawaii County Code, as amended, by changing the district classification from Agricultural (A-1a) to Multiple Family Residential (RM-4) at Kanaueue 1st, N. Kona.

Date Introduced: April 9, 1975

Copies of the foregoing Bill, in full, are on file in the Office of the County Clerk for use and examination by the public.

- - -

I hereby certify that the foregoing Bill passed first reading at the meeting of the County Council on April 9, 1975, by the following aye and no vote:

AYES: Councilmen Carpenter, De Luz, Fujii, Hisaoka, Kawahara, Lai, Levin, Yadao and Chairman Yamada - 9

NOES: None

Bill No. 117 - 1975
**MAP OF CHAPTER 8 (ZONING CODE),
ARTICLE 2, HAWAII COUNTY CODE, AS
AMENDED, BY CHANGING THE
DISTRICT CLASSIFICATION FROM
AGRICULTURAL (A-1a) TO MULTIPLE
FAMILY RESIDENTIAL (RM-4) AT
KANAUEUE 1ST, NORTH KONA,
HAWAII, COVERED BY TAX MAP KEY
7-9-10: PORTION OF 4.**

This Bill amends Ord. 74 which amended Section 7.02, the North Kona Zone Map, Chapter 8 (Zoning Code), Article 2, Hawaii County Code, as amended, by changing the district classification from Agricultural (A-1a) to Multiple Family Residential (RM-4) at Kanaueue 1st, N. Kona.
Date introduced: April 9, 1975
Copies of the foregoing Bill, in full, are on file in the Office of the County Clerk for use and examination by the public.

I hereby certify that the foregoing Bill passed first reading at the meeting of the County Council on April 9, 1975, by the following aye and no vote:

AYES: Councilmen Carpenter, De Luz, Fujii, Hisaoka, Kawahara, Lai, Levin, Yadao and Chairman Yamada - 9.

NOES: None

TED T. SUZUKI
COUNTY CLERK
COUNTY OF HAWAII



COUNTY CLERK
COUNTY OF HAWAII

ORDINANCE NO. 110
(Bill No. 117-1975)

AN ORDINANCE AMENDING ORDINANCE NO. 74 WHICH AMENDED SECTION 7.02, THE NORTH KONA ZONE MAP OF CHAPTER 8 (ZONING CODE), ARTICLE 2, HAWAII COUNTY CODE, AS AMENDED, BY CHANGING THE DISTRICT CLASSIFICATION FROM AGRICULTURAL (A-1a) TO MULTIPLE FAMILY RESIDENTIAL (RM-4) AT KANAUEUE 1ST, NORTH KONA, HAWAII, COVERED BY TAX MAP KEY 7-9-10:PORTION OF 4.

Date Approved: April 24, 1975
Date Effective: May 2, 1975

Copies of the foregoing Ordinance, in full, are on file in the Office of the County Clerk for use and examination by the public.

I hereby certify that the foregoing Ordinance passed second and final reading at the meeting of the County Council on April 24, 1975, by the following aye and no vote:

AYES: Councilmen Carpenter, De Luz, Fujii, Hisaoka, Kawahara, Lai, Levin, Yadao and Chairman Yamada - 9.

NOES: None.

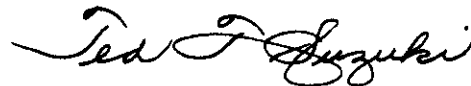

COUNTY CLERK
COUNTY OF HAWAII

AN ORDINANCE AMENDING ORDINANCE NO. 74 WHICH AMENDED SECTION 7.02, THE NORTH KONA ZONE MAP OF CHAPTER 8 (ZONING CODE), ARTICLE 2, HAWAII COUNTY CODE, AS AMENDED, BY CHANGING THE DISTRICT CLASSIFICATION FROM AGRICULTURAL (A-1a) TO MULTIPLE FAMILY RESIDENTIAL (RM-4) AT KANAUEUE 1ST, NORTH KONA, HAWAII, COVERED BY TAX MAP KEY 7-9-10:PORTION OF 4.

Date Approved: April 24, 1975
Date Effective: May 2, 1975

Copies of the foregoing Ordinance, in full, are on file in the Office of the County Clerk for use and examination by the public.

I hereby certify that the foregoing Ordinance passed second and final reading at the meeting of the County Council on April 24, 1975, by the following aye and no vote:
AYES: Councilmen Carpenter, De Luz, Fujii, Hisaoka, Kawahara, Lai, Levin, Yadao and Chairman Yamada - 9.
NOES: None.

TED T. SUZUKI
COUNTY CLERK
COUNTY OF HAWAII

Ted T. Suzuki
COUNTY CLERK

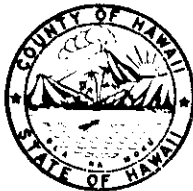

Robert Shioji
DEPUTY COUNTY CLERK

OFFICE OF THE COUNTY CLERK

COUNTY OF HAWAII
HILO, HAWAII 96720

Mayor Herbert T. Matayoshi
County of Hawaii
Hilo, Hawaii

I hereby transmit Ordinance Bill No. 117
passed by the County Council on second and final
reading.

DEP. COUNTY CLERK

Encl.

Dated: APR 28 1975