

COUNTY OF HAWAII - STATE OF HAWAII

ORDINANCE NO. 226

AN ORDINANCE AMENDING SECTION 7.22, THE PAHOA ZONE MAP, CHAPTER 8 (ZONING CODE), ARTICLE 2, HAWAII COUNTY CODE, AS AMENDED, BY CHANGING THE DISTRICT CLASSIFICATION FROM SINGLE FAMILY RESIDENTIAL (RS-10) TO VILLAGE COMMERCIAL (CV-10) AT NANAWALE HOMESTEADS, PAHOA, PUNA, HAWAII, COVERED BY TAX MAP KEY 1-5-11:14; AND REPEALING ORDINANCE NO. 494, ADOPTED ON AUGUST 1, 1972.

BE IT ORDAINED BY THE COUNCIL OF THE COUNTY OF HAWAII:

SECTION 1. Section 7.22 of Chapter 8 (Zoning Code), Article 2, Hawaii County Code, as amended, is hereby further amended by adding thereto the following subsection:

"7.22(b). The district classification of the following area situated at Pahoa, Puna, Hawaii, shall be Village Commercial (CV-10):

Beginning at a point at the southwest corner of this lot and on the north side of Pahoa Road, the coordinates of said point of beginning, referred to Government Survey Triangulation Station "VILLAGE FLAG", being 1108.89 feet South and 1484.81 feet East, thence running by azimuths measured clockwise from true South:

1. 212° 48' 30" 228.34 feet along Lot 14;
2. 304° 58' 49.95 feet along Lot 30 and Lot 31;
3. 32° 17' 224.11 feet along Lot 12;
4. 120° 12' 52.00 feet along the North side of Pahoa Road to the point of beginning, containing an area of 11,522 Square Feet, more or less.

"All as outlined in red on the map attached hereto, marked Exhibit 'A' and by reference made a part hereof."

SECTION 2. Section 1 of this ordinance shall take effect forthwith upon the conditions that (a) the owners shall be responsible for consolidating the area with the adjacent parcel, identified by TMK: 1-5-11:15 after receiving full title to both parcels; and (b) all other applicable rules and regulations be

complied with. Should any of the foregoing conditions not be met, rezoning of the area to its original zoning designation may be initiated.

SECTION 3. In the event that any portion of this ordinance is declared invalid, such invalidity shall not affect the other parts of this ordinance.

SECTION 4. This ordinance repeals Ordinance No. 494, adopted by the County Council of the County of Hawaii on August 1, 1972, in its entirety.

SECTION 5. This ordinance shall take effect upon its approval.

INTRODUCED BY:

Frank de la Torre

COUNCILMAN, COUNTY OF HAWAII

Hilo, Hawaii

Date of Introduction: September 15, 1976

Date of Adoption: October 6, 1976

Effective Date: October 14, 1976

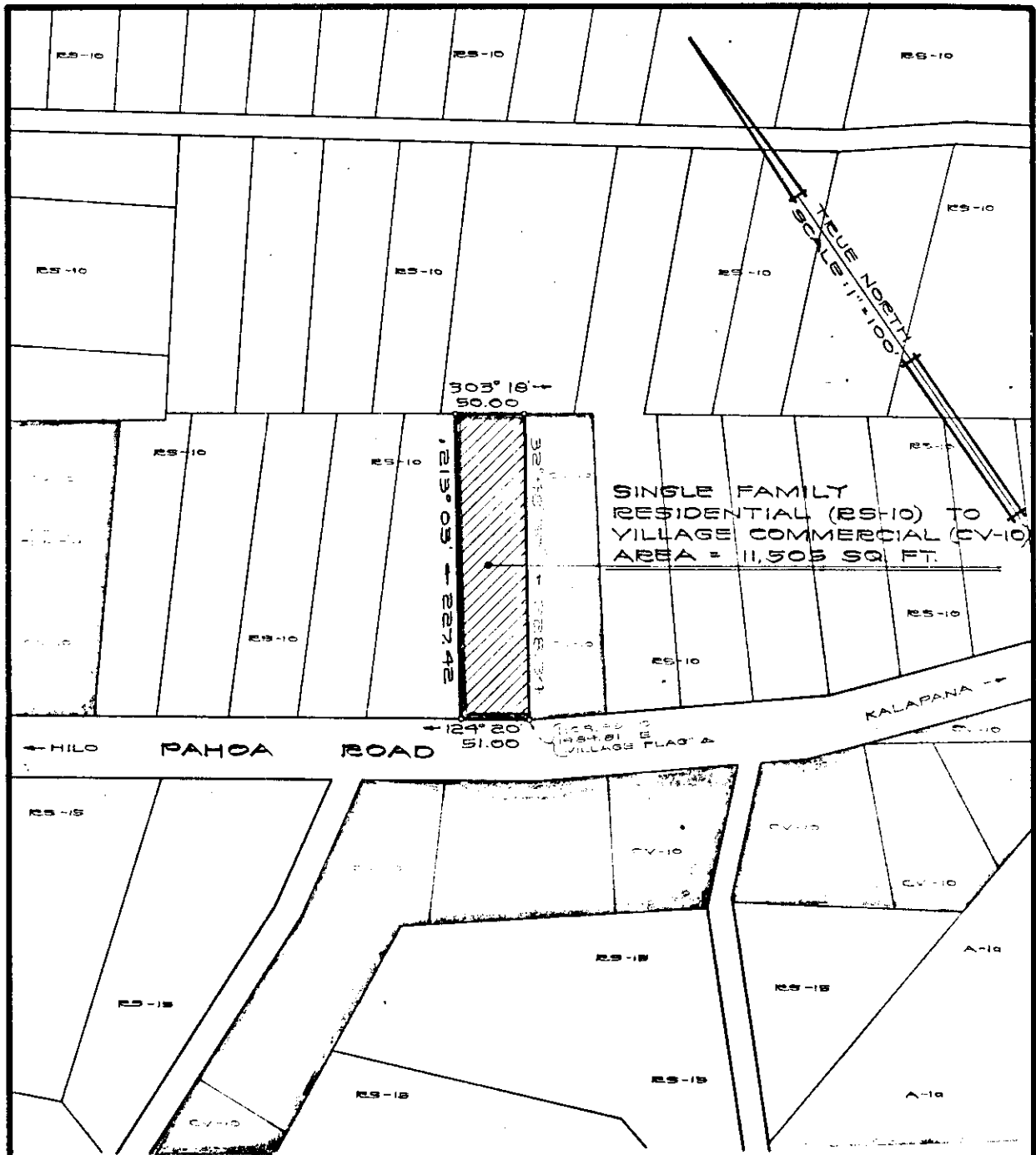

AMENDMENT TO THE ZONING CODE

AMENDMENT NO. TO SECTION 7.22, THE PAHOA ZONE MAP OF CHAPTER 8 (ZONING CODE), ARTICLE 2, HAWAII COUNTY CODE, AS AMENDED, BY CHANGING THE DISTRICT CLASSIFICATION FROM SINGLE FAMILY RESIDENTIAL (RS-10) TO VILLAGE COMMERCIAL (CV-10) AT NANAWALE HOMESTEADS, PUNA, HAWAII.

DATE OF PUBLIC HEARING : JUNE 24, 1976
 DATE OF APPROVAL :
 ORDINANCE NO.
 PREPARED BY : PLANNING DEPARTMENT
 COUNTY OF HAWAII

Hilo, Hawaii
 Date: September 15, 1976

FIRST READING			
	AYES	NOES	A/E
Carpenter	X		
De Luz	X		
Fujii	X		
Hisaoka	X		
Kawahara	X		
Lai	X		
Levin			EX
Yadao	X		
Yamada	X		
	8		1

Publication Date: September 20, 1976

Hilo, Hawaii
 Date: October 6, 1976

SECOND & FINAL READING			
	AYES	NOES	A/E
Carpenter	X		
De Luz	X		
Fujii	X		
Hisaoka	X		
Kawahara	X		
Lai	X		
Levin	X		
Yadao	X		
Yamada	X		
	9		

Publication Date: OCT 20 1976

We do hereby certify that the foregoing BILL was adopted by the County Council and published as indicated above.

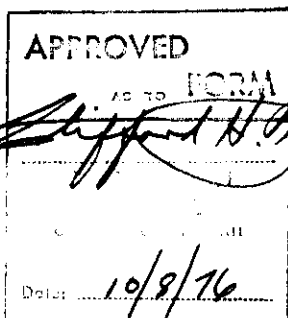

Approved/Disapproved this 14th day of October, 1976

[Signature]
 Mayor, County of Hawaii

[Signature]
 Council Chairman

[Signature]
 County Clerk

Bill No. 243
 Reference: C-1989/PRDLC-84
 M.B. No. 226
 Ord. No. 226

Ted T. Suzuki
COUNTY CLERK

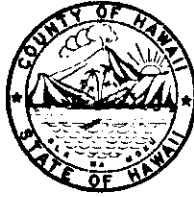

Robert Shioji
DEPUTY COUNTY CLERK

OFFICE OF THE COUNTY CLERK
COUNTY OF HAWAII
HILO, HAWAII 96720

Mayor Herbert T. Matayoshi
County of Hawaii
Hilo, Hawaii

I hereby transmit Ordinance Bill No. 243
passed by the County Council on second and final
reading.

A handwritten signature in cursive script, reading "Ted T. Suzuki".

COUNTY CLERK

Encl.

Dated: 10 - 7 - 76

Bill No. 243 - 1976

AN ORDINANCE AMENDING SECTION 7.22, THE PAHOA ZONE MAP, CHAPTER 8 (ZONING CODE), ARTICLE 2, HAWAII COUNTY CODE, AS AMENDED, BY CHANGING THE DISTRICT CLASSIFICATION FROM SINGLE FAMILY RESIDENTIAL (RS-10) TO VILLAGE COMMERCIAL (CV-10) AT NANAWALE HOMESTEADS, PAHOA, PUNA, HAWAII, COVERED BY TAX MAP KEY 1-5-11:14; AND REPEALING ORDINANCE NO. 494, ADOPTED ON AUGUST 1, 1972.

This Bill amends Section 7.22, the Pahoa Zone Map, Chapter 8 (Zoning Code), Article 2, Hawaii County Code, as amended, by changing the district classification from Single Family Residential (RS-10) to Village Commercial (CV-10) at Nanawale Homesteads, Pahoa.

Date Introduced: September 15, 1976.

Copies of the foregoing Bill, in full, are on file, in the Office of the County Clerk for use and examination by the public.

I hereby certify that the foregoing Bill passed first reading at the meeting of the County Council on September 15, 1976, by the following aye and no vote:

AYES: Councilmen Carpenter, De Luz, Fujii, Hisaoka, Kawahara, Lai, Yadao and Chairman Yamada - 8.

NOES: None.

EXCUSED: Councilman Levin - 1.



SECTION 7.22, THE PAHOA ZONE MAP, CHAPTER 8 (ZONING CODE), ARTICLE 2, HAWAII COUNTY CODE, AS AMENDED, BY CHANGING THE DISTRICT CLASSIFICATION FROM SINGLE FAMILY RESIDENTIAL (RS-10) TO VILLAGE COMMERCIAL (CV-10) AT NANAWALE HOMESTEADS, PAHOA, PUNA, HAWAII, COVERED BY TAX MAP KEY 1-5-11:14; AND REPEALING ORDINANCE NO. 494, ADOPTED ON AUGUST 1, 1972.

This Bill amends Section 7.22, the Pahoa Zone Map, Chapter 8 (Zoning Code), Article 2, Hawaii County Code, as amended, by changing the district classification from Single Family Residential (RS-10) to Village Commercial (CV-10) at Nanawale Homesteads, Pahoa.

Date Introduced: September 15, 1976.

Copies of the foregoing Bill, in full, are on file, in the Office of the County Clerk for use and examination by the public.

I hereby certify that the foregoing Bill passed first reading at the meeting of the County Council on September 15, 1976, by the following aye and no vote:

AYES: Councilmen Carpenter, De Luz, Fujii, Hisaoka, Kawahara, Lai, Yadao and Chairman Yamada - 8.

NOES: None.

EXCUSED: Councilman Levin - 1.

ORDINANCE NO. 226
(Bill No. 243-1976)

AN ORDINANCE AMENDING SECTION 7.22, THE PAHOA ZONE MAP, CHAPTER 8 (ZONING CODE), ARTICLE 2, HAWAII COUNTY CODE, AS AMENDED, BY CHANGING THE DISTRICT CLASSIFICATION FROM SINGLE FAMILY RESIDENTIAL (RS-10) TO VILLAGE COMMERCIAL (CV-10) AT NANAWALE HOMESTEADS, PAHOA, PUNA, HAWAII, COVERED BY TAX MAP KEY 1-5-11:14; AND REPEALING ORDINANCE NO. 494, ADOPTED ON AUGUST 1, 1972.

Date Approved: October 6, 1976
Date Effective: October 14, 1976

Copies of the foregoing Ordinance, in full, are on file in the Office of the County Clerk for use and examination by the public.

I hereby certify that the foregoing Ordinance passed second and final reading at the meeting of the County Council on October 6, 1976, by the following aye and no vote:

AYES: Councilmen Carpenter, De Luz, Fujii, Hisaoka, Kawahara, Lai, Levin, Yadao and Chairman Yamada.- 9.

NOES: None.



COUNTY CLERK
COUNTY OF HAWAII

