

COUNTY OF HAWAII - STATE OF HAWAII

ORDINANCE NO. 242

AN ORDINANCE AMENDING SECTION 7.01 THE NORTH AND SOUTH KONA DISTRICTS ZONE MAP OF CHAPTER 8 (ZONING CODE), ARTICLE 2, HAWAII COUNTY CODE, AS AMENDED, BY CHANGING THE DISTRICT CLASSIFICATION FROM OPEN (O) TO RESORT-HOTEL (V-3) AT KAUPULEHU, NORTH KONA, HAWAII, COVERED BY TAX MAP KEY 7-2-03:PORTION OF 2.

BE IT ORDAINED BY THE COUNCIL OF THE COUNTY OF HAWAII:

SECTION 1. Section 7.01 of Chapter 8 (Zoning Code), Article 2, Hawaii County Code, as amended, is hereby further amended by adding thereto the following subsection:

"7.01 (c-1). The district classification of the following area situated at Kaupulehu, North Kona, Hawaii, shall be Resort-Hotel (V-3):

Beginning at a spike in lava rock at the Southwest corner of this parcel of land, the coordinates of said point of beginning referred to Government Survey Triangulation Station "KUILI" begin 10,907.02 feet North and 7,394.52 feet East, and running by azimuths measured clockwise from true South:

- | | | | |
|----|------|---------|---|
| 1. | 175° | 32' | 125.17 feet along remainder of R.P. 7843, L.C. Aw. 7713, Apana 10 to Lota Kamehameha; |
| 2. | 198° | 01' | 100.00 feet along remainder of R.P. 7843, L.C. Aw. 7713, Apana 10 to Lota Kamehameha; |
| 3. | 272° | 10' | 171.82 feet along remainder of R.P. 7843, L.C. Aw. 7713, Apana 10 to Lota Kamehameha; |
| 4. | 352° | 04' | 117.54 feet along remainder of R.P. 7843, L.C. Aw. 7713, Apana 10 to Lota Kamehameha; |
| 5. | 10° | 54' 30" | 17.88 feet along remainder of R.P. 7843, L.C. Aw. 7713, Apana 10 to Lota Kamehameha; |
| 6. | 342° | 31' 30" | 120.16 feet along remainder of R.P. 7843, L.C. Aw. 7713, Apana 10 to Lota Kamehameha; |
| 7. | 87° | 28' | 128.54 feet along remainder of R.P. 7843, L.C. Aw. 7713, Apana 10 to Lota Kamehameha; |

"7.01 (c-2). The district classification of the following area situated at Kaupulehu, North Kona, Hawaii, shall be Resort-Hotel (V-3):

Beginnig at a PK nail in lava rock at the Southwest corner of this parcel of land, the coordinates of said point of beginning referred to Government Survey Triangulation Station "KUILI" being 10,861.60 feet North and 7,727.18 feet East, and running by azimuths measured clockwise from true South:

1. 205° 23' 94.42 feet along remainder of R.P. 7843, L.C. Aw. 7713, Apana 10 to Lota Kamehameha;
2. 168° 36' 165.87 feet along remainder of R.P. 7843, L.C. Aw. 7713, Apana 10 to Lota Kamehameha;
3. 98° 53' 30" 37.00 feet along remainder of R.P. 7843, L.C. Aw. 7713, Apana 10 to Lota Kamehameha;
4. 178° 00' 10.00 feet along remainder of R.P. 7843, L.C. Aw. 7713, Apana 10 to Lota Kamehameha;
5. 249° 30' 76.49 feet along remainder of R.P. 7843, L.C. Aw. 7713, Apana 10 to Lota Kamehameha;
6. 292° 40' 30.00 feet along remainder of R.P. 7843, L.C. Aw. 7713, Apana 10 to Lota Kamehameha;
7. 339° 48' 30" 123.00 feet along remainder of R.P. 7843, L.C. Aw. 7713, Apana 10 to Lota Kamehameha;
8. 269° 26' 30" 40.00 feet along remainder of R.P. 7843, L.C. Aw. 7713, Apana 10 to Lota Kamehameha;
9. 29° 52' 135.22 feet along remainder of R.P. 7843, L.C. Aw. 7713, Apana 10 to Lota Kamehameha;
10. 342° 27' 46.39 feet along remainder of R.P. 7843, L.C. Aw. 7713, Apana 10 to Lota Kamehameha;
11. 88° 40' 30" 99.24 feet along remainder of R.P. 7843, L.C. Aw. 7713, Apana 10 to Lota Kamehameha, to the point of beginning and containing an area of 0.547 acre.

"7.01 (c-3). The district classification of the following area

situated at Kaupulehu, North Kona, Hawaii, shall be Resort-Hotel (V-3):

1.	148°	46'		133.21 feet along remainder of R.P. 7843, L.C. Aw. 7713, Apana 10 to Lota Kamehameha;
2.	161°	48'	30"	146.92 feet along remainder of R.P. 7843, L.C. Aw. 7713, Apana 10 to Lota Kamehameha;
3.	245°	36'	30"	135.86 feet along remainder of R.P. 7843, L.C. Aw. 7713, Apana 10 to Lota Kamehameha;
4.	294°	32'		47.99 feet along remainder of R.P. 7843, L.C. Aw. 7713, Apana 10 to Lota Kamehameha;
5.	212°	14'	30"	49.86 feet along remainder of R.P. 7843, L.C. Aw. 7713, Apana 10 to Lota Kamehameha;
6.	255°	06'		103.87 feet along remainder of R.P. 7843, L.C. Aw. 7713, Apana 10 to Lota Kamehameha;
7.	194°	32'	30"	148.76 feet along remainder of R.P. 7843, L.C. Aw. 7713, Apana 10 to Lota Kamehameha;
8.	84°	39'	30"	58.53 feet along remainder of R.P. 7843, L.C. Aw. 7713, Apana 10 to Lota Kamehameha;
9.	179°	38'		159.00 feet along remainder of R.P. 7843, L.C. Aw. 7713, Apana 10 to Lota Kamehameha;
10.	171°	10'		40.00 feet along remainder of R.P. 7843, L.C. Aw. 7713, Apana 10 to Lota Kamehameha;
11.	183°	40'		92.00 feet along remainder of R.P. 7843, L.C. Aw. 7713, Apana 10 to Lota Kamehameha;
12.	152°	30'		120.00 feet along remainder of R.P. 7843, L.C. Aw. 7713, Apana 10 to Lota Kamehameha;
13.	157°	00'		80.42 feet along remainder of R.P. 7843, L.C. Aw. 7713, Apana 10 to Lota Kamehameha;
14.	249°	14'		230.62 feet along remainder of R.P. 7843, L.C. Aw. 7713, Apana 10 to Lota Kamehameha;
15.	339°	37'	30"	492.98 feet along remainder of R.P. 7843, L.C. Aw. 7713, Apana 10 to Lota Kamehameha;

- | | | | | |
|-----|------|-----|-----|--|
| 18. | 297° | 46' | 30" | 38.76 feet along remainder of R.P. 7843, L.C. Aw. 7713, Apana 10 to Lota Kamehameha; |
| 19. | 23° | 36' | | 99.32 feet along remainder of R.P. 7843, L.C. Aw. 7713, Apana 10 to Lota Kamehameha; |
| 20. | 356° | 14' | | 79.90 feet along remainder of R.P. 7843, L.C. Aw. 7713, Apana 10 to Lota Kamehameha; |
| 21. | 79° | 16' | | 145.29 feet along remainder of R.P. 7843, L.C. Aw. 7713, Apana 10 to Lota Kamehameha; |
| 22. | 355° | 23' | | 55.83 feet along remainder of R.P. 7843, L.C. Aw. 7713, Apana 10 to Lota Kamehameha; |
| 23. | 70° | 31' | | 81.16 feet along remainder of R.P. 7843, L.C. Aw. 7713, Apana 10 to Lota Kamehameha; |
| 24. | 62° | 48' | | 103.90 feet along remainder of R.P. 7843, L.C. Aw. 7713, Apana 10 to Lota Kamehameha; |
| 25. | 325° | 49' | | 98.38 feet along remainder of R.P. 7843, L.C. Aw. 7713, Apana 10 to Lota Kamehameha; |
| 26. | 51° | 10' | 30" | 113.24 feet along remainder of R.P. 7843, L.C. Aw. 7713, Apana 10 to Lota Kamehameha, to the point of beginning and containing an area of 4.880 acres. |

"7.01 (c-4). The district classification of the following area situated at Kaupulehu, North Kona, Hawaii, shall be Resort-Hotel (V-3):

Beginning at a spike at the North corner of this parcel of land, the coordinates of said point of beginning referred to Government Survey Triangulation Station "KUILI" being 11,560.17 feet North and 9,272.63 feet East, and running by azimuths measured clockwise from true South:

- | | | | | |
|----|------|-----|-----|---|
| 1. | 330° | 28' | | 151.37 feet along remainder of R.P. 7843, L.C. Aw. 7713, Apana 10 to Lota Kamehameha; |
| 2. | 347° | 51' | 30" | 79.12 feet along remainder of R.P. 7843, L.C. Aw. 7713, Apana 10 to Lota Kamehameha; |
| 3. | 338° | 26' | | 101.74 feet along remainder of R.P. 7843, L.C. Aw. 7713, Apana 10 to Lota Kamehameha; |

5.	144°	21'	30"	72.92 feet along remainder of R.P. 7843, L.C. Aw. 7713, Apana 10 to Lota Kamehameha;
6.	233°	40'		39.98 feet along remainder of R.P. 7843, L.C. Aw. 7713, Apana 10 to Lota Kamehameha;
7.	130°	39'	30"	91.20 feet along remainder of R.P. 7843, L.C. Aw. 7713, Apana 10 to Lota Kamehameha;
8.	111°	27'		185.78 feet along remainder of R.P. 7843, L.C. Aw. 7713, Apana 10 to Lota Kamehameha;
9.	90°	51'		65.82 feet along remainder of R.P. 7843, L.C. Aw. 7713, Apana 10 to Lota Kamehameha;
10.	124°	33'		29.21 feet along remainder of R.P. 7843, L.C. Aw. 7713, Apana 10 to Lota Kamehameha;
11.	12°	30'	30"	36.20 feet along remainder of R.P. 7843, L.C. Aw. 7713, Apana 10 to Lota Kamehameha;
12.	82°	12'		252.17 feet along remainder of R.P. 7843, L.C. Aw. 7713, Apana 10 to Lota Kamehameha;
13.	106°	21'		168.06 feet along remainder of R.P. 7843, L.C. Aw. 7713, Apana 10 to Lota Kamehameha;
14.	93°	21'		111.12 feet along remainder of R.P. 7843, L.C. Aw. 7713, Apana 10 to Lota Kamehameha;
15.	59°	08'	30"	29.94 feet along remainder of R.P. 7843, L.C. Aw. 7713, Apana 10 to Lota Kamehameha;
16.	168°	53'		50.58 feet along remainder of R.P. 7843, L.C. Aw. 7713, Apana 10 to Lota Kamehameha;
17.	251°	23'	30"	81.37 feet along remainder of R.P. 7843, L.C. Aw. 7713, Apana 10 to Lota Kamehameha;
18.	257°	29'		139.48 feet along remainder of R.P. 7843, L.C. Aw. 7713, Apana 10 to Lota Kamehameha;
19.	264°	07'	30"	128.41 feet along remainder of R.P. 7843, L.C. Aw. 7713, Apana 10 to Lota Kamehameha;

- | | | | | | |
|-----|------|-----|-----|--------|---|
| 21. | 263° | 14' | 30" | 153.20 | feet along remainder of R.P. 7843, L.C. Aw. 7713, Apana 10 to Lota Kamehameha; |
| 22. | 257° | 47' | 30" | 159.16 | feet along remainder of R.P. 7843, L.C. Aw. 7713, Apana 10 to Lota Kamehameha, to the point of beginning and containing an area of 2.723 acres. |

"7.01 (c-5). The district classification of the following area situated at Kaupulehu, North Kona, Hawaii, shall be Resort-Hotel (V-3):

Beginning at a 1/2" pipe at the Southeast corner of this parcel of land, the coordinates of said point of beginning referred to Government Survey Triangulation Station "KUILI" being 10,644.44 feet North and 8,886.16 feet East, and running by azimuths measured clockwise from true South:

- | | | | | |
|----|------|-----|--------|--|
| 1. | 108° | 00' | 257.55 | feet along remainder of R.P. 7843, L.C. Aw. 7713, Apana 10 to Lota Kamehameha; |
| 2. | 19° | 00' | 60.25 | feet along remainder of R.P. 7843, L.C. Aw. 7713, Apana 10 to Lota Kamehameha; |
| 3. | 105° | 00' | 96.00 | feet along remainder of R.P. 7843, L.C. Aw. 7713, Apana 10 to Lota Kamehameha; |
| 4. | 199° | 00' | 172.00 | feet along remainder of R.P. 7843, L.C. Aw. 7713, Apana 10 to Lota Kamehameha; |
| | | | | thence along remainder of R.P. 7843 L.C. Aw. 7713, Apana 10 to Lota Kamehameha, on a curve to the left with a radius of 130.00 feet, the chord azimuth and distance being: |
| 5. | 177° | 30' | 95.29 | feet; |
| 6. | 156° | 00' | 185.00 | feet along remainder of R.P. 7843, L.C. Aw. 7713, Apana 10 to Lota Kamehameha; |
| 7. | 239° | 47' | 177.98 | feet along remainder of R.P. 7843, L.C. Aw. 7713, Apana 10 to Lota Kamehameha; |
| 8. | 330° | 04' | 56.56 | feet along remainder of R.P. 7843, L.C. Aw. 7713, Apana 10 to Lota Kamehameha; |
| 9. | 241° | 49' | 34.66 | feet along remainder of R.P. 7843, L.C. Aw. 7713, Apana 10 to Lota |

11.	238°	10'	30"	42.96	feet along remainder of R.P. 7843, L.C. Aw. 7713, Apana 10 to Lota Kamehameha;
12.	333°	57'	30"	105.28	feet along remainder of R.P. 7843, L.C. Aw. 7713, Apana 10 to Lota Kamehameha;
13.	69°	37'	30"	35.43	feet along remainder of R.P. 7843, L.C. Aw. 7713, Apana 10 to Lota Kamehameha;
14.	317°	26'		65.14	feet along remainder of R.P. 7843, L.C. Aw. 7713, Apana 10 to Lota Kamehameha;
15.	268°	32'	30"	42.06	feet along remainder of R.P. 7843, L.C. Aw. 7713, Apana 10 to Lota Kamehameha;
16.	225°	18'		177.66	feet along remainder of R.P. 7843, L.C. Aw. 7713, Apana 10 to Lota Kamehameha;
17.	309°	22'		130.63	feet along remainder of R.P. 7843, L.C. Aw. 7713, Apana 10 to Lota Kamehameha;
18.	233°	58'		43.65	feet along remainder of R.P. 7843, L.C. Aw. 7713, Apana 10 to Lota Kamehameha;
19.	126°	57'		100.63	feet along remainder of R.P. 7843, L.C. Aw. 7713, Apana 10 to Lota Kamehameha;
20.	208°	01'		37.98	feet along remainder of R.P. 7843, L.C. Aw. 7713, Apana 10 to Lota Kamehameha;
21.	287°	08'		40.65	feet along remainder of R.P. 7843, L.C. Aw. 7713, Apana 10 to Lota Kamehameha;
22.	211°	21'		39.47	feet along remainder of R.P. 7843, L.C. Aw. 7713, Apana 10 to Lota Kamehameha;
23.	154°	46'		90.66	feet along remainder of R.P. 7843, L.C. Aw. 7713, Apana 10 to Lota Kamehameha;
24.	227°	54'	30"	39.68	feet along remainder of R.P. 7843, L.C. Aw. 7713, Apana 10 to Lota Kamehameha;
25.	292°	48'		84.62	feet along remainder of R.P. 7843, L.C. Aw. 7713, Apana 10 to Lota Kamehameha;

- | | | | |
|-----|------|---------|--|
| 27. | 290° | 07' | 67.24 feet along remainder of R.P. 7843, L.C. Aw. 7713, Apana 10 to Lota Kamehameha; |
| 28. | 334° | 34' | 65.97 feet along remainder of R.P. 7843, L.C. Aw. 7713, Apana 10 to Lota Kamehameha; |
| 29. | 323° | 34' 30" | 69.57 feet along remainder of R.P. 7843, L.C. Aw. 7713, Apana 10 to Lota Kamehameha; |
| 30. | 45° | 42' | 357.20 feet along remainder of R.P. 7843, L.C. Aw. 7713, Apana 10 to Lota Kamehameha; |
| 31. | 71° | 05' | 115.20 feet along remainder of R.P. 7843, L.C. Aw. 7713, Apana 10 to Lota Kamehameha; |
| 32. | 67° | 00' | 94.00 feet along remainder of R.P. 7843, L.C. Aw. 7713, Apana 10 to Lota Kamehameha; |
| 33. | 9° | 00' | 206.00 feet along remainder of R.P. 7843, L.C. Aw. 7713, Apana 10 to Lota Kamehameha, to the point of beginning and containing an area of 5.653 acres. |

"As shown hatched on the map attached hereto, marked Exhibit 'A' and by reference made a part hereof."

SECTION 2. Section 1 of this ordinance shall take effect forthwith upon the conditions that (A) construction of the proposed facilities shall commence within one (1) year from the effective date of approval of the change of zone and shall be completed within two (2) years thereafter; (B) the method of sewage disposal shall conform to the rules and regulations of the State Department of Health; (C) a channelized intersection at the Queen Kaahumanu Highway be constructed meeting the approval of the State Department of Transportation, Highways Division; (D) should any historical and/or archaeological sites and objects of significance be found during the development of the area, the petitioners will be responsible to contact the Historic Preservation Office of the State Department of Land and Natural Resources; and (E) all other applicable rules and regulations, including the Plan Approval process, shall be complied with. Should any of the foregoing

SECTION 3. In the event that any portion of this ordinance is declared invalid, such invalidity shall not affect the other parts of this ordinance.

SECTION 4. This ordinance shall take effect upon its approval.

INTRODUCED BY:

Frank de [unclear]

COUNCILMAN, COUNTY OF HAWAII

Hilo, Hawaii

Date of Introduction: December 6, 1976

Date of Adoption: December 22, 1976

Effective Date: December 29, 1976

EXISTING 2400 FT A.C. RUNWAY

EXISTING 2400 FT A.C. RUNWAY

11,560.17
9,878.69 MZ

ACCESS ROAD

TO QUEEN KAHIUMANU HIGHWAY

10,644.44
8,886.16 MZ

① SUBSECTION 7.01 (C-1)
OPEN (O) TO RESORT-
HOTEL (V-3)
AREA = 1,197 ACRES

④ SUBSECTION 7.01 (C-4)
OPEN (O) TO RESORT-
HOTEL (V-3)
AREA = 3,708 ACRES

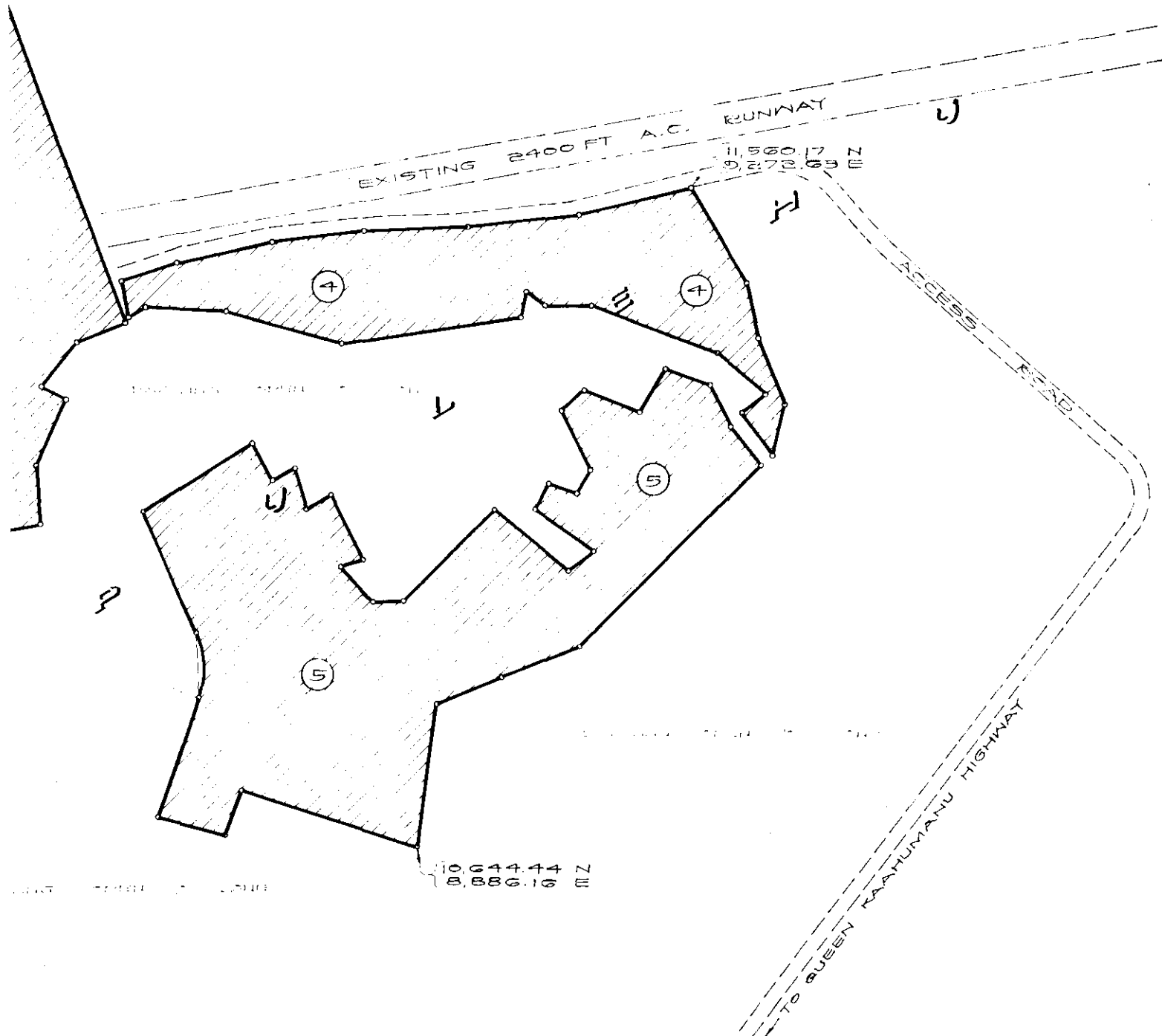

TRUE NORTH
SCALE: 1 IN. = 200 FT.

OCEAN

PACIFIC

KAHUWAI BAY

10,907.02
7,394.52 MZ

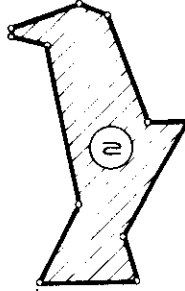
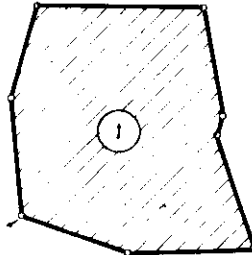

10,861.60
7,727.18 MZ

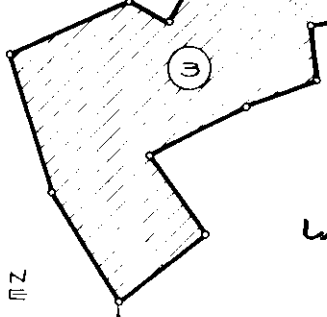

10,791.80
8,026.10 MZ

AMENDMENT TO THE ZONING CODE

AMENDMENT NO. 3 TO SECTION 7.01, THE NORTH AND SOUTH KONA DISTRICTS ZONE MAP OF CHAPTER 8

Hilo, Hawaii
 Date: December 6, 1976

FIRST READING			
	AYES	NOES	A/E
Carpenter	X		
De Luz	X		
Fujii	X		
Hisaoka	X		
Kawahara	X		
Lai	X		
Levin		X	
Yadao	X		
Yamada	X		
	8		

Publication Date: December 10, 1976

Hilo, Hawaii
 Date: December 22, 1976

SECOND & FINAL READING			
	AYES	NOES	A/E
Dahlberg	X		
Domingo	X		
Fujii	X		
Garcia	X		
Kawahara	X		
Lai	X		
Same shima	X		
Yamashiro	X		
Chr. Tajiri	X		
	9		

Publication Date: January 2, 1977

We do hereby certify that the foregoing BILL was adopted by the County Council and published as indicated above.

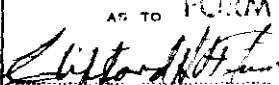
APPROVED
 AS TO FORM

 COUNTY OF HAWAII
 Date: 12/27/76

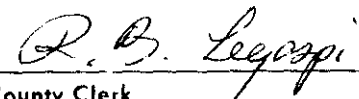
 Council Chairman

 County Clerk

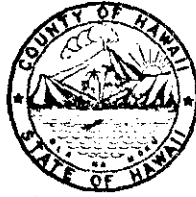
29th



R.B. Legaspi
~~xxxxxxx~~
COUNTY CLERK

Yasuki Arakaki
~~xxxxxxx~~
DEPUTY COUNTY CLERK

OFFICE OF THE COUNTY CLERK
COUNTY OF HAWAII
HILO, HAWAII 96720

Mayor Herbert T. Matayoshi
County of Hawaii
Hilo, Hawaii

I hereby transmit Ordinance Bill No. 260
passed by the County Council on second and final
reading.

R. B. Legaspi
COUNTY CLERK

Encl.

Dated: 12-23-76

Bill No. 260 - 1976

AN ORDINANCE AMENDING SECTION 7.01 THE NORTH AND SOUTH KONA DISTRICTS ZONE MAP OF CHAPTER 8 (ZONING CODE), ARTICLE 2, HAWAII COUNTY CODE, AS AMENDED, BY CHANGING THE DISTRICT CLASSIFICATION FROM OPEN (O) TO RESORT-HOTEL (V-3) AT KAUPULEHU, NORTH KONA, HAWAII, COVERED BY TAX MAP KEY 7-2-03:PORTION OF 2.

This Bill amends Section 7.01, the North and South Kona Districts Zone Map, Chapter 8 (Zoning Code), Article 2, Hawaii County Code, as amended, by changing the district classification from Open (O) to Resort-Hotel (V-3) at Kaupulehu, N. Kona.

Date Introduced: December 6, 1976

Copies of the foregoing Bill, in full, are on file in the Office of the County Clerk for use and examination by the public.

I hereby certify that the foregoing Bill passed first reading at the meeting of the County Council on December 6, 1976, by the following aye and no vote:

AYES: Councilmen Carpenter, De Luz, Fujii, Hisaoka, Kawahara, Lai, Yadao and Chairman Yamada-8.

NOES: Councilman Levin - 1.

AN ORDINANCE AMENDING SECTION 7.01 THE NORTH AND SOUTH KONA DISTRICTS ZONE MAP OF CHAPTER 8 (ZONING CODE), ARTICLE 2, HAWAII COUNTY CODE, AS AMENDED, BY CHANGING THE DISTRICT CLASSIFICATION FROM OPEN (O) TO RESORT-HOTEL (V-3) AT KAUPULEHU, NORTH KONA, HAWAII, COVERED BY TAX MAP KEY 7-2-03:PORTION OF 2.

I hereby certify that the foregoing Bill passed first reading at the meeting of the County Council on December 6, 1976, by the following aye and no vote:

AYES: Councilmen Carpenter, De Luz, Fujii, Hisaoka, Kawahara, Lai, Yadao and Chairman Yamada-8.

NOES: Councilman Levin - 1.

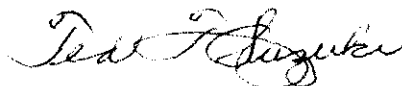

COUNTY CLERK
COUNTY OF HAWAII

ORDINANCE NO. 242
(Bill No. 260-1976)

AN ORDINANCE AMENDING SECTION 7.01 THE NORTH AND SOUTH KONA DISTRICTS ZONE MAP OF CHAPTER 8 (ZONING CODE), ARTICLE 2, HAWAII COUNTY CODE, AS AMENDED, BY CHANGING THE DISTRICT CLASSIFICATION FROM OPEN (O) TO RESORT-HOTEL (V-3) AT KAUPULEHU, NORTH KONA, HAWAII, COVERED BY TAX MAP KEY 7-2-03:PORTION OF 2.

Date Approved: December 22, 1976
Date Effective: December 29, 1976

Copies of the foregoing Ordinance, in full, are on file in the Office of the County Clerk for use and examination by the public.

I hereby certify that the foregoing Ordinance passed second and final reading at the meeting of the County Council on December 22, 1976, by the following aye and no vote:

AYES: Councilmen Dahlberg, Domingo, Fujii, Garcia, Kawahara, Lai, Sameshima, Yamashiro and Chairman Tajiri - 9.

NOES: NONE.

R. B. Legaspi

COUNTY CLERK
COUNTY OF HAWAII

AN ORDINANCE AMENDING SECTION 7.01 THE NORTH AND SOUTH KONA DISTRICTS ZONE MAP OF CHAPTER 8 (ZONING CODE), ARTICLE 2, HAWAII COUNTY CODE, AS AMENDED, BY CHANGING THE DISTRICT CLASSIFICATION FROM OPEN (O) TO RESORT-HOTEL (V-3) AT KAUPULEHU, NORTH KONA, HAWAII, COVERED BY TAX MAP KEY 7-2-03:PORTION OF 2.

Date Approved: December 22, 1976
Date Effective: December 29, 1976

Copies of the foregoing Ordinance, in full, are on file in the Office of the County Clerk for use and examination by the public.

I hereby certify that the foregoing Ordinance passed second and final reading at the meeting of the County Council on December 22, 1976, by the following aye and no vote:

AYES: Councilmen Dahlberg, Domingo, Fujii, Garcia, Kawahara, Lai, Sameshima, Yamashiro and Chairman Tajiri - 9.

NOES: NONE.

R. B. Legaspi
COUNTY CLERK
COUNTY OF HAWAII

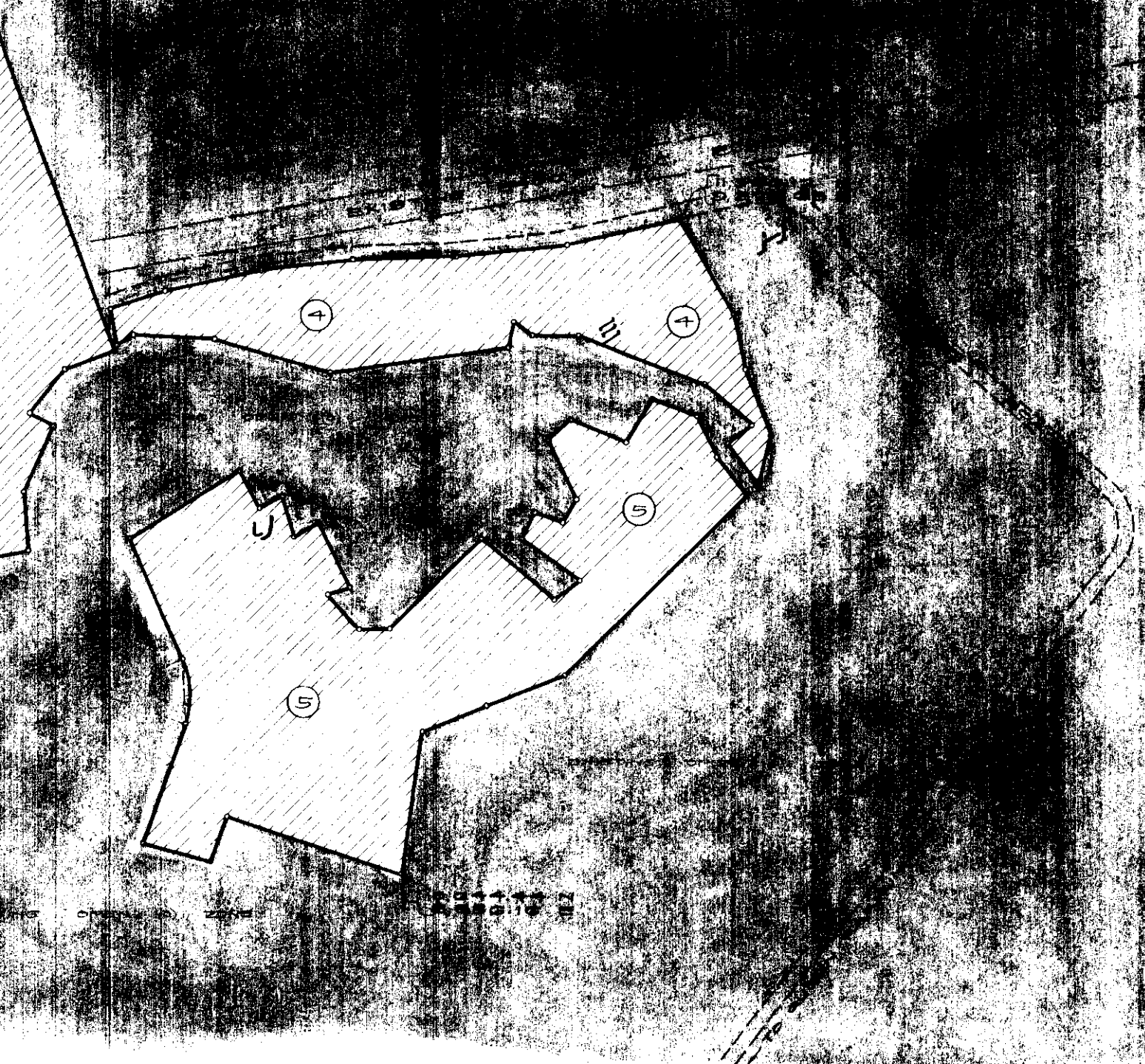

①

SUBSECTION 7.01 (C-1)
OPEN (O) TO RESORT-
HOTEL (V-3)
AREA = 1,197 ACRES

④

SUBSECTION 7.01 (C-4)
OPEN (O) TO RESORT-
HOTEL (V-3)
AREA = 3,732 ACRES

TRUE NORTH
SCALE: 1 IN. = 200 FT.

PACIFIC OCEAN

KAHUWAI BAY

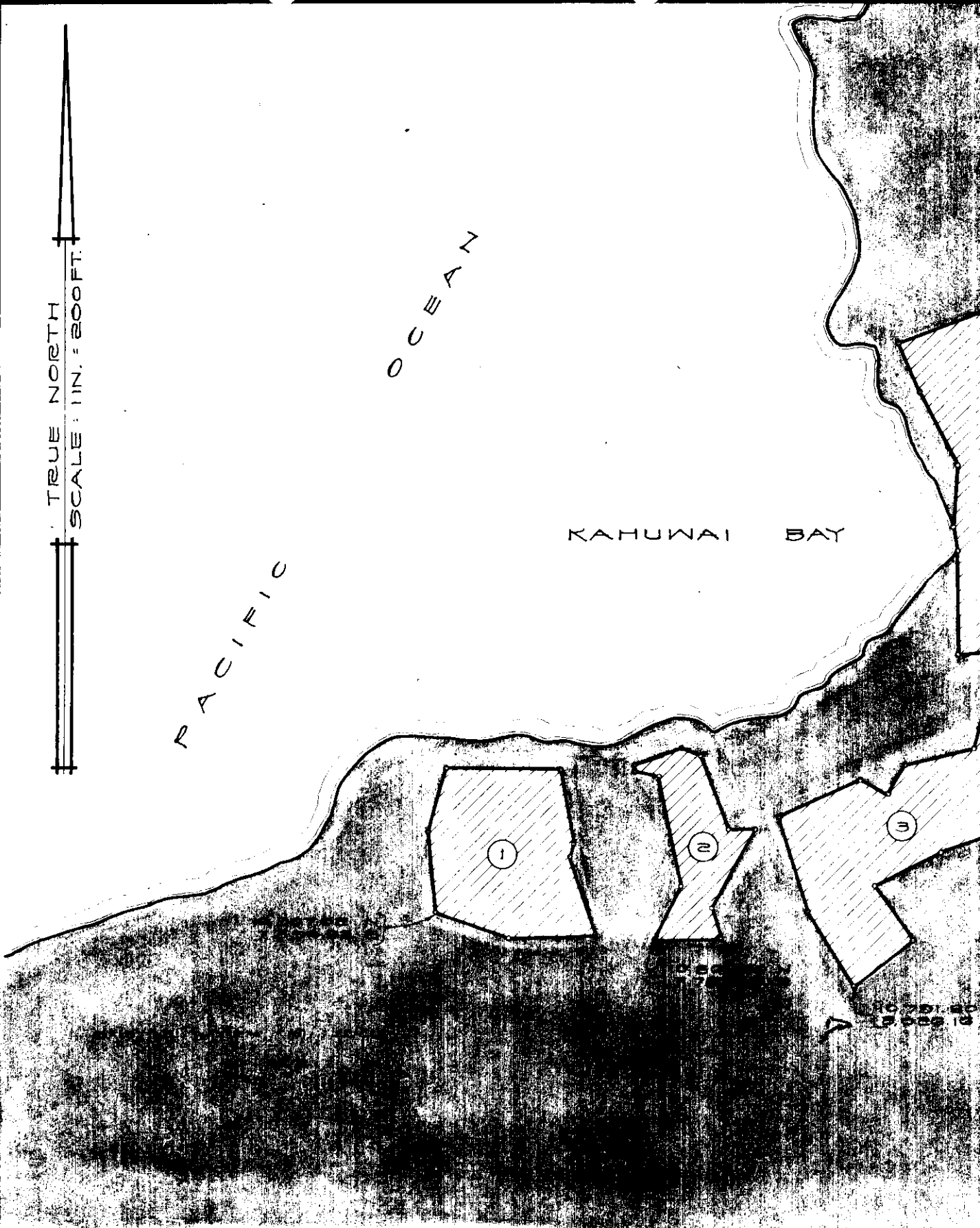

AMENDMENT TO THE ZONING CODE

AMENDMENT NO. 3 TO SECTION 7.01, THE NORTH AND SOUTH KONA DISTRICTS ZONING CODE OF QUARTER 2

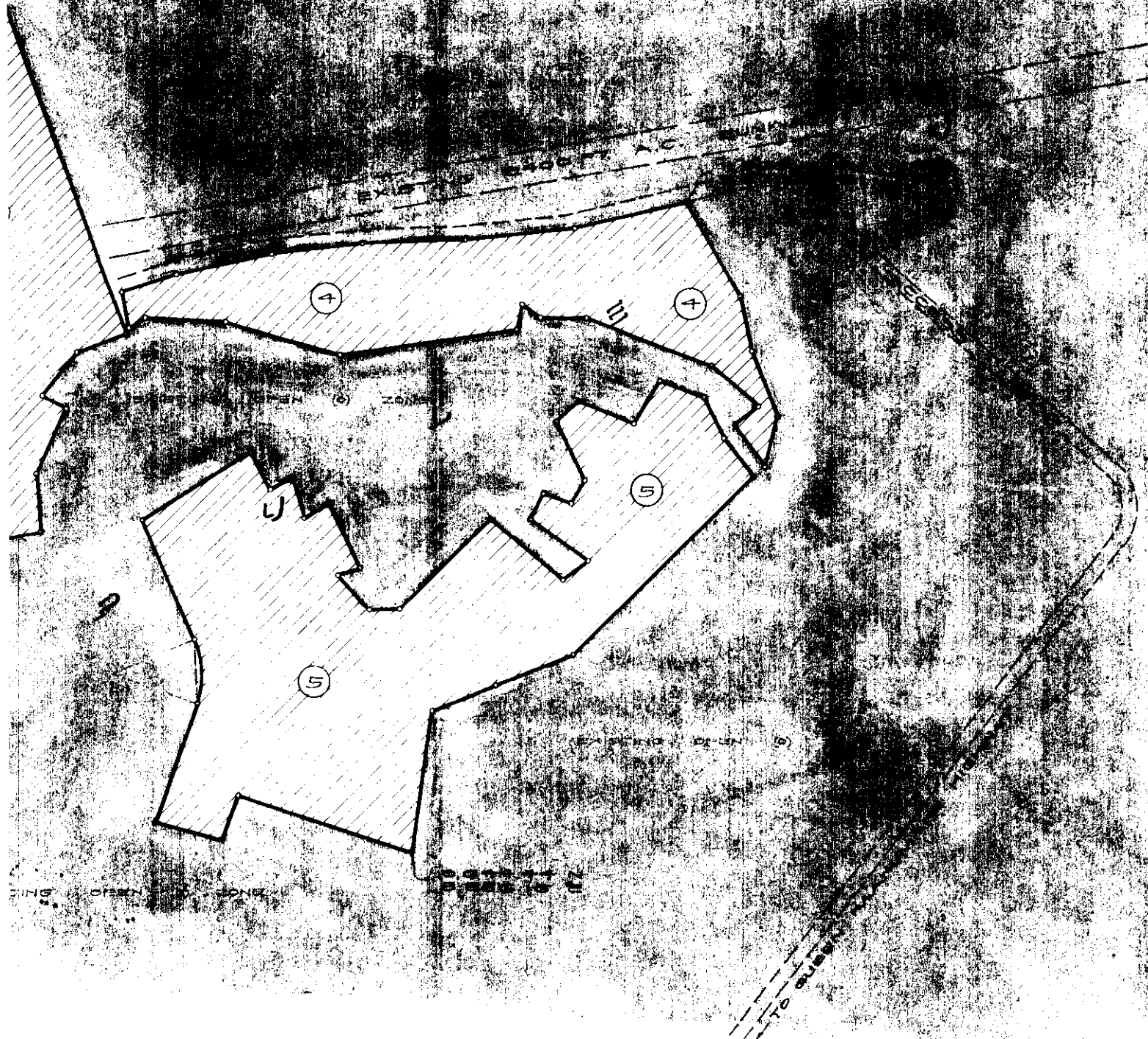

① SUBSECTION 7.01 (C-1)
 OPEN (O) TO RESORT-
 HOTEL (V-3)
 AREA = 1,197 ACRES

④ SUBSECTION 7.01 (C-4)
 OPEN (O) TO RESORT-
 HOTEL (V-3)
 AREA = 2,702 ACRES

TRUE NORTH
SCALE: 1 IN. = 800 FT.

OCEAN

PACIFIC

KAHUWAI BAY

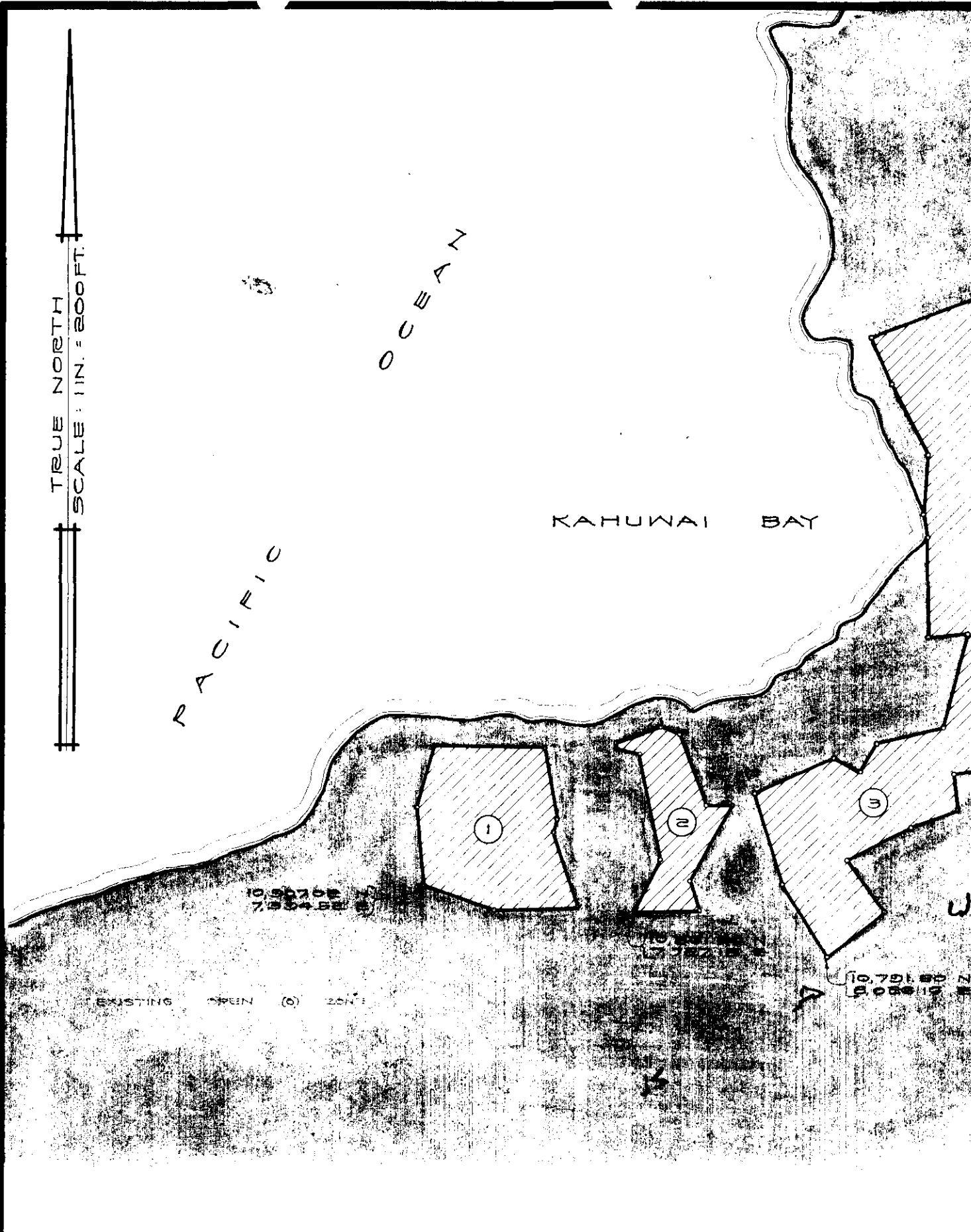

AMENDMENT TO THE ZONING CODE

AMENDMENT NO. 3 TO SECTION 7.01, THE NORTH AND SOUTH KONA DISTRICTS ZONE MAP OF CHARTER...