

COUNTY OF HAWAII - STATE OF HAWAII

ORDINANCE NO. 255

AN ORDINANCE AMENDING SECTION 7.29, THE CITY OF HILO ZONE MAP OF CHAPTER 8 (ZONING CODE), ARTICLE 2, HAWAII COUNTY CODE, AS AMENDED, BY CHANGING THE DISTRICT CLASSIFICATION FROM AGRICULTURAL (A-1a) TO SINGLE FAMILY RESIDENTIAL (RS-10) AT WAIAKEA, SOUTH HILO, HAWAII, COVERED BY TAX MAP KEY 2-2-46:PORTION OF 17.

BE IT ORDAINED BY THE COUNCIL OF THE COUNTY OF HAWAII:

SECTION 1. Section 7.29 of Chapter 8 (Zoning Code), Article 2, Hawaii County Code, as amended, is hereby further amended by adding thereto the following subsection:

"7.29(aaa). The district classification of the following area situated at Waiakea, South Hilo, Hawaii, shall be Single Family Residential (RS-10):

Beginning at the Southwest corner of this parcel of land, being also the Northwest corner of Parcel "F" as shown on County of Hawaii, Waiakea-uka Flood Control Map, Job No. P-1978A and on the easterly side of Kanoelehua Avenue, F.A.P. F-2(3), the coordinates of said point of beginning referred to Government Survey Triangulation Station "HALAI" being 15,071.17 feet South and 11,012.70 feet East, thence running by azimuths measured clockwise from true South:

1. 175° 42' 489.50 feet along the easterly side of Kanoelehua Avenue, F.A.P. F-2(3);
2. 265° 42' 30.00 feet along same;
3. 175° 42' 302.91 feet along same;
4. 265° 42' 454.00 feet along Grant 11537 to Heirs of Abner Kama, deceased;
5. 355° 42' 780.55 feet along Lots 184, 185 and a portion of Lot 186, Panaewa Tract "1", (Hawaiian Homes Land);
6. 89° 56' 44" 66.32 feet along the remainder of Grant 8872 to Arcenia J. Gomes, being also along Parcel "F" as shown

- | | | | | |
|-----|--|-----|-----|--|
| 7. | 64° | 56' | 44" | 105.09 feet along same; |
| 8. | 85° | 40' | | 69.00 feet along same; |
| 9. | 175° | 40' | | 107.88 feet along same; |
| 10. | 85° | 40' | | 25.00 feet along same; |
| 11. | 15° | 40' | | 13.00 feet along same; |
| 12. | Thence along same on a curve to the right with a radius of 114.00 feet, the chord azimuth and distance being 50° 40', 130.78 feet; | | | |
| 13. | 85° | 40' | | 114.00 feet along the remainder of Grant 8872 to Arcenia J. Gomes, being also along Parcel "F" as shown on County of Hawaii, Waiakea-uka Flood Control Map, Job No. P-1978A to the point of beginning and containing an area of 8.502 Acres. |

"All as outlined in red on the map attached hereto, marked Exhibit 'A' and by reference made a part hereof."

SECTION 2. Section 1 of this ordinance shall take effect forthwith upon the conditions that (A) the subject area shall not be developed until after the completion of the Waiakea-Uka Flood Control Project; (b) the area be developed in two (2) zoning increments. The first increment shall consist of a maximum of five (5) contiguous acres, and the second, the remaining area. The effective date of zoning for the second increment shall be after development has occurred on the first increment. Development is defined as building permits issued for single-family residential dwelling units and construction partially completed in the sense of having roofs on a minimum of twenty-five (25) percent of the units for the entire area of 8.5 acres; (C) the petitioner, Hiromu Yamanaka, submit a subdivision plan for the first increment and

of the Waiakea-Uka Flood Control Project, and also assume the responsibility of securing final subdivision approval of the first increment. The petitioner shall also be responsible for submitting a subdivision plan and securing final subdivision approval of the second increment; (D) a hydrologic/drainage study and a grading plan be submitted with the subdivision application for the first increment to the Planning Department and the Chief Engineer of the Department of Public Works; (E) the petitioner be responsible to provide a water system in accordance with the County of Hawaii Department of Water Supply standards; (F) only one (1) access from Kanoelehua Avenue shall be permitted. Since Kanoelehua Avenue will be one-way Hilo-bound fronting the property after the completion of the highway improvements, only right turn movements will be allowed in and out of the proposed subdivision. No through connection to the Keaaau-bound lanes will be permitted at the subdivision access. Access to all lots shall be from the interior subdivision roads; thus, no direct access shall be allowed from the lots onto Kanoelehua Avenue; (G) curbs, gutters and sidewalks shall be constructed within the proposed subdivision; (H) the method of sewage disposal shall meet with the requirements of the State Department of Health; (I) a park fee, using the guidelines of the Park Dedication Code, shall be assessed at the time of subdivision approval; and (J) all other applicable rules and regulations shall be complied with. Should any of the foregoing conditions not be met, rezoning of the property to its original zoning designation may be initiated.

SECTION 3. In the event that any portion of this ordinance is declared invalid, such invalidity shall not affect the other

SECTION 4. This ordinance shall take effect upon its approval.

INTRODUCED BY:



COUNCILMAN, COUNTY OF HAWAII

Hilo, Hawaii

Date of Introduction: March 2, 1977

Date of Adoption: March 16, 1977

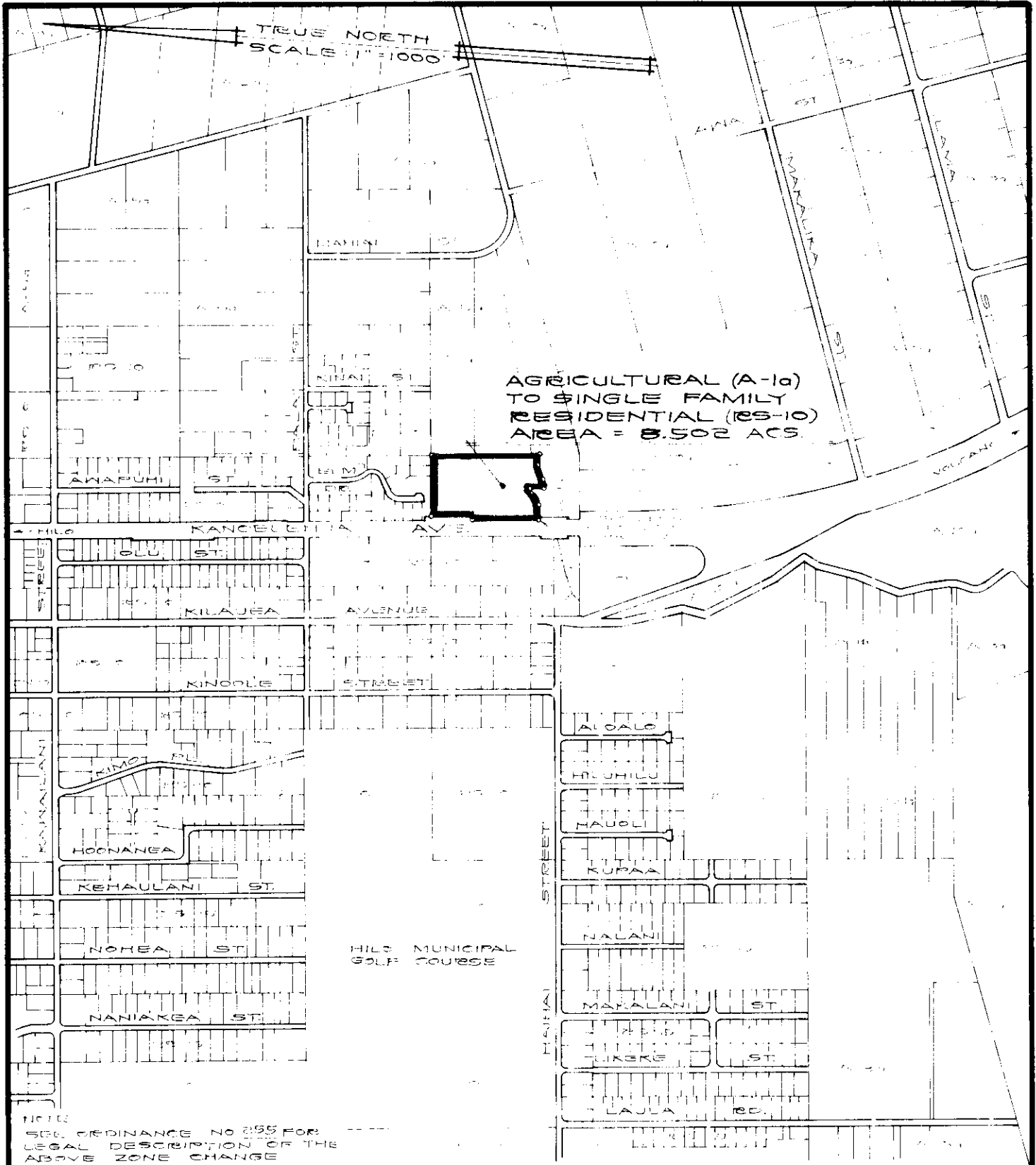
Effective Date: March 30, 1977



AMENDMENT TO THE ZONING CODE

AMENDMENT NO. 53 TO SECTION 7.29, THE CITY OF HILO ZONE MAP OF CHAPTER 8 (ZONING CODE) ARTICLE 2, HAWAII COUNTY CODE, AS AMENDED, BY CHANGING THE DISTRICT CLASSIFICATION FROM AGRICULTURAL (A-1a) TO SINGLE FAMILY RESIDENTIAL (RS-10) AT WAIAKEA, SOUTH HILO, HAWAII.

Hilo, Hawaii
 Date: March 2, 1977

FIRST READING			
	AYES	NOES	A/E
Dahlberg	X		
Domingo	X		
Fujii	X		
Garcia			X
Kawahara	X		
Lai	X		
Sameshima	X		
Yamashiro			X
Chr. Tajiri	X		
	7		2

Publication Date: March 7, 1977

Hilo, Hawaii
 Date: March 16, 1977

SECOND & FINAL READING			
	AYES	NOES	A/E
Dahlberg	X		
Domingo	X		
Fujii	X		
Garcia	X		
Kawahara	X		
Lai	X		
Sameshima			X
Yamashiro	X		
Chr. Tajiri	X		
	8		1

Publication Date: APR 3 1977

We do hereby certify that the foregoing BILL was adopted by the County Council and published as indicated above.

APPROVED as to
 FORM and LEGISLATION
Accepted
 Acting Clerk
 Date 3/29/77

Henry S. Tajiri
 Council Chairman

A. B. Leegaspi
 County Clerk

Approved/Disapproved this 30th day of

R. B. Legaspi
COUNTY CLERK

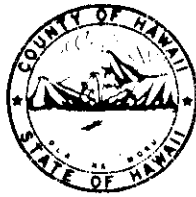

Yasuki Arakaki
DEPUTY COUNTY CLERK

Harry A. Takahashi
LEGISLATIVE AUDITOR

OFFICE OF THE COUNTY CLERK

COUNTY OF HAWAII

HILO, HAWAII 96720

Mayor Herbert T. Matayoshi
County of Hawaii
Hilo, HI

Ord. 255

I hereby transmit Ordinance Bill No. 279
passed by the County Council on second final reading.

R. B. Legaspi
COUNTY CLERK

Encl.

Dated: March 22, 1977

Bill No. 279 - 1977

AN ORDINANCE AMENDING SECTION 7.29, THE CITY OF HILO ZONE MAP OF CHAPTER 8 (ZONING CODE), ARTICLE 2, HAWAII COUNTY CODE, AS AMENDED, BY CHANGING THE DISTRICT CLASSIFICATION FROM AGRICULTURAL (A-1a) TO SINGLE FAMILY RESIDENTIAL (RS-10) AT WAIAKEA, SOUTH HILO, HAWAII, COVERED BY TAX MAP KEY 2-2-46:PORTION OF 17.

This Bill amends Section 7.29, The City of Hilo Zone Map, Chapter 8 (Zoning Code), Article 2, Hawaii County Code, as amended, by changing the district classification from Agricultural (A-1a) to Single Family Residential (RS-10) at Waiakea, S. Hilo.

Date Introduced: March 2, 1977.

Copies of the foregoing Bill, in full, are on file in the Office of the County Clerk for use and examination by the public.

I hereby certify that the foregoing Bill passed first reading at the meeting of the County Council on March 2, 1977, by the following aye and no vote:

AYES: Councilmen Dahlberg, Domingo, Fujii, Kawahara, Lai, Sameshima, and Chairman Tajiri - 7.

NOES: None.

ABSENT AND EXCUSED: Councilmen Garcia and Yamashiro - 2.

AN ORDINANCE AMENDING SECTION 7.29, THE CITY OF HILO ZONE MAP OF CHAPTER 8 (ZONING CODE), ARTICLE 2, HAWAII COUNTY CODE, AS AMENDED, BY CHANGING THE DISTRICT CLASSIFICATION FROM AGRICULTURAL (A-1a) TO SINGLE FAMILY RESIDENTIAL (RS-10) AT WAIAKEA, SOUTH HILO, HAWAII, COVERED BY TAX MAP KEY 2-2-46:PORTION OF 17.

This Bill amends Section 7.29, The City of Hilo Zone Map, Chapter 8 (Zoning Code), Article 2, Hawaii County Code, as amended, by changing the district classification from Agricultural (A-1a) to Single Family Residential (RS-10) at Waiakea, S. Hilo.

Date Introduced: March 2, 1977.
Copies of the foregoing Bill, in full, are on file in the Office of the County Clerk for use and examination by the public.

I hereby certify that the foregoing Bill passed first reading at the meeting of the County Council on March 2, 1977, by the following aye and no vote:

AYES: Councilmen Dahlberg, Domingo, Fujii, Kawahara, Lai, Sameshima, and Chairman Tajiri - 7.
NOES: None.
ABSENT AND EXCUSED: Councilmen Garcia and Yamashiro - 2.

R. B. Leegapi
COUNTY CLERK,
COUNTY OF HAWAII

ORDINANCE NO. 255
(Bill No. 279 - 1977)

AN ORDINANCE AMENDING SECTION 7.29, THE CITY OF HILO ZONE MAP OF CHAPTER 8 (ZONING CODE), ARTICLE 2, HAWAII COUNTY CODE, AS AMENDED, BY CHANGING THE DISTRICT CLASSIFICATION FROM AGRICULTURAL (A-1a) TO SINGLE FAMILY RESIDENTIAL (RS-10) AT WAIAKEA, SOUTH HILO, HAWAII, COVERED BY TAX MAP KEY 2-2-46:PORTION OF 17

Date Approved: March 16, 1977

Date Effective: March 30, 1977

Copies of the foregoing Ordinance, in full, are on file in the Office of the County Clerk for use and examination by the public.

I hereby certify that the foregoing Ordinance passed second and final reading at the meeting of the County Council on March 16, 1977, by the following ye and no vote:

AYES: Councilmen Dahlberg, Domingo, Fujii, Garcia, Kawahara, Lai, Yamashiro and Chairman Tajiri - 8.

NOES: None.

ABSENT AND EXCUSED: Councilman Sameshima - 1.

R. B. Legaspi
COUNTY CLERK
COUNTY OF HAWAII

RECEIVED
COUNTY CLERK
COUNTY OF HAWAII
MARCH 16 1977
Date Approved: March 16, 1977
Date Effective: March 30, 1977
Copies of the foregoing Ordinance, in full, are on file in the Office of the County Clerk for use and examination by the public.
I hereby certify that the foregoing Ordinance passed second and final reading at the meeting of the County Council on March 16, 1977, by the following ye and no vote:
AYES: Councilmen Dahlberg, Domingo, Fujii, Garcia, Kawahara, Lai, Yamashiro and Chairman Tajiri - 8.
NOES: None.
ABSENT AND EXCUSED: Councilman Sameshima - 1.