

COUNTY OF HAWAII - STATE OF HAWAII

ORDINANCE NO. 323

AN ORDINANCE AMENDING SECTION 7.03 THE SOUTH KONA ZONE MAP OF CHAPTER 8 (ZONING CODE), ARTICLE 2, HAWAII COUNTY CODE, AS AMENDED, BY CHANGING THE DISTRICT CLASSIFICATION FROM SINGLE FAMILY RESIDENTIAL (RS-15) TO NEIGHBORHOOD COMMERCIAL (CN-10) AT HALEKII, SOUTH KONA, HAWAII, COVERED BY TAX MAP KEY: 8-1-01:25, 27 AND PORTIONS OF 13 & 15.

BE IT ORDAINED BY THE COUNCIL OF THE COUNTY OF HAWAII:

SECTION 1. Section 7.03 of Chapter 8 (Zoning Code), Article 2, Hawaii County Code, as amended, is hereby further amended by adding thereto the following subsection:

"7.03(t). The district classification of the following area situated at Halekii, South Kona, Hawaii, shall be Neighborhood Commercial (CN-10):

Beginning at the southeast corner of this parcel of land, being also the southwest corner of Lot "A" (portion of L.C. Aw.387, Part 4, Section 2 to the American Board of Commissioners for Foreign Missions), the coordinates of said point of beginning referred to Government Survey Triangulation Station "PUU OHAU" being 2373,56 feet North and 12341.73 feet East and running by azimuths measured clockwise from True South:

1. 94° 33' 30" 156.86 feet along the remainder of a portion of L.C. Aw. 387, Part 4, Section 2 to the American Board of Commissioners for Foreign Missions;
2. 99° 30' 45.00 feet along Lot 14 (portion of L.C. Aw.387, Part 4, Section 2 to the American Board of Commissioners for Foreign Missions);
3. 95° 28' 95.79 feet along same;
4. 90° 19' 30" 17.60 feet along same;
5. 84° 05' 30" 298.35 feet along the remainder of a portion of L.C. Aw. 387, Part 4, Section 2 to the American Board of Commissioners for Foreign Missions;
6. 181° 00' 291.51 feet along Lot 1 (portion of L.C. Aw.387, Part 4, Section 2 to the American Board of Commissioners for Foreign Missions);
7. 272° 55' 19.66 feet along Kona Hospital Site;

8. 266^o 55' 52.00 feet along Kona Hospital Site;
9. 274^o 26' 39.00 feet along Kona Hospital Site;
10. 269^o 02' 169.00 feet along Kona Hospital Site;
11. 265^o 15' 42.00 feet along Kona Hospital Site;
12. 272^o 00' 105.00 feet along Kona Hospital Site;
13. 270^o 25' 54.87 feet along Kona Hospital Site;
14. 270^o 24' 30" 66.44 feet along Kona Hospital Site;
15. 348^o 44' 296.15 feet along Lot "A" (portion of L.C. Aw.387, Part 4, Section 2 to the American Board of Commissioners for Foreign Missions) to the point of beginning and containing an area of 3.671 Acres.

"All as outlined in red on the map attached hereto, marked Exhibit 'A' and by reference made a part hereof."

SECTION 2. Section 1 of this ordinance shall take effect forthwith upon the conditions that (A) construction of the proposed facility commence within one (1) year from the effective date of the change of zone and be completed within two (2) years thereafter; (B) prior to construction, in accordance with Chapter 323, Hawaii Revised Statutes, as amended, the petitioner shall obtain a Certificate of Need from the appropriate State agency; (C) the rules, regulations and requirements of the State Department of Health and the Department of Water Supply shall be complied with; and (D) all other applicable rules and regulations, including the Plan Approval proces shall be complied with. Should any of the foregoing conditions not be met, rezoning of the area to its original zoning designation may be initiated.

SECTION 3. In the event that any portion of this ordinance is declared invalid, such invalidity shall not affect the other parts of this ordinance.

SECTION 4. This ordinance shall take effect upon its approval.

INTRODUCED BY:



COUNCILMAN, COUNTY OF HAWAII

Hilo, Hawaii

Date of Introduction: November 2, 1977

Date of Adoption: November 16, 1977

Effective Date: November 23, 1977

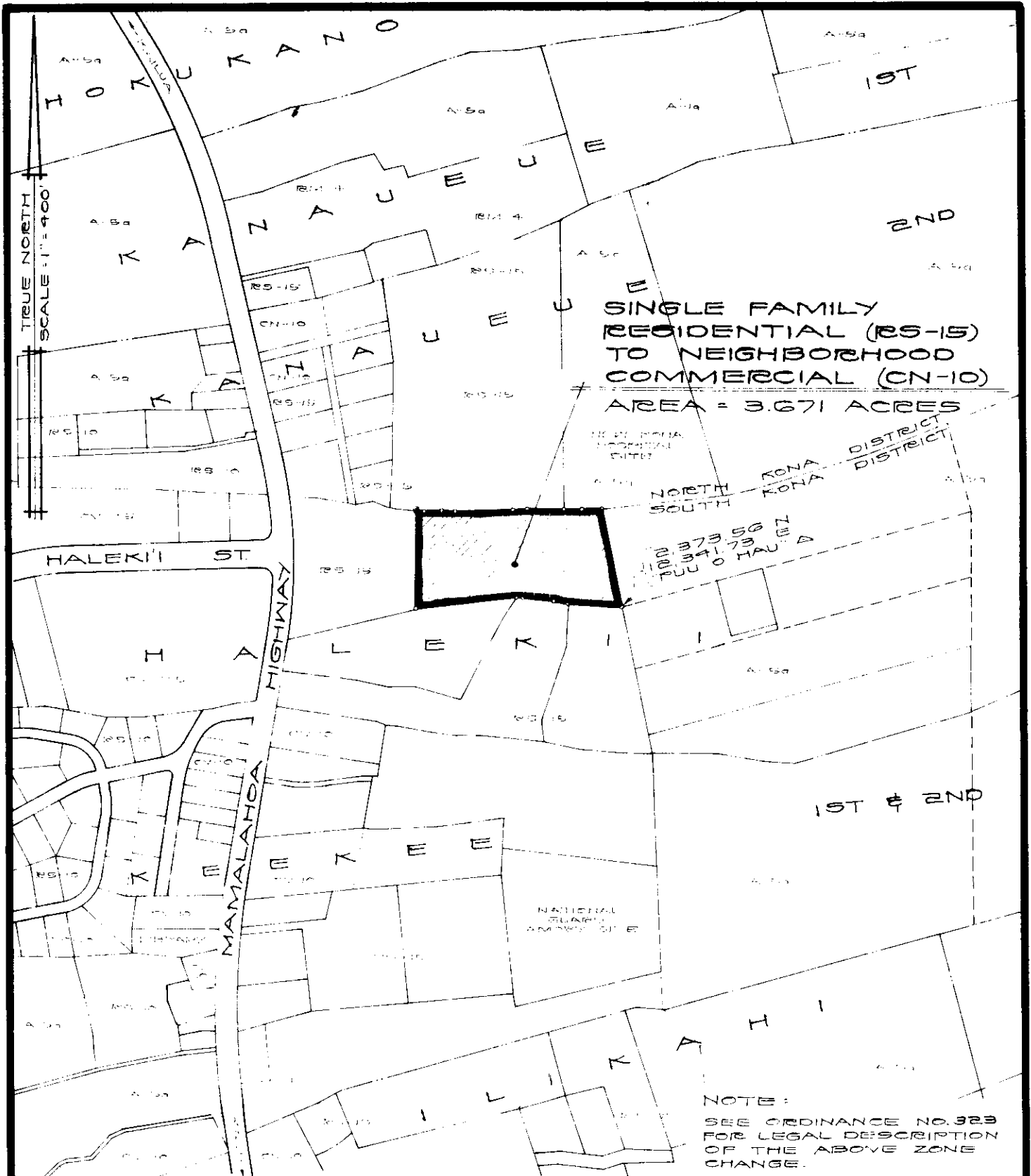

AMENDMENT TO THE ZONING CODE

AMENDMENT NO. 21 TO SECTION 7.03, THE SOUTH KONA ZONE MAP OF CHAPTER 8 (ZONING CODE), ARTICLE 2, HAWAII COUNTY CODE, AS AMENDED, BY CHANGING THE DISTRICT CLASSIFICATION FROM SINGLE FAMILY RESIDENTIAL (RS-15) TO NEIGHBORHOOD COMMERCIAL (CN-10) AT HALEKII, SOUTH KONA, HAWAII.

DATE OF PUBLIC HEARING: AUG. 25, 1977
 DATE OF APPROVAL: NOV. 23, 1977
 ORDINANCE NO. 323
 PREPARED BY: PLANNING DEPARTMENT
 COUNTY OF HAWAII

TAX MAP KEY:
 8-1-01, 25, 27 & PORT OF 13 & 15

SEPT. 26, 1977

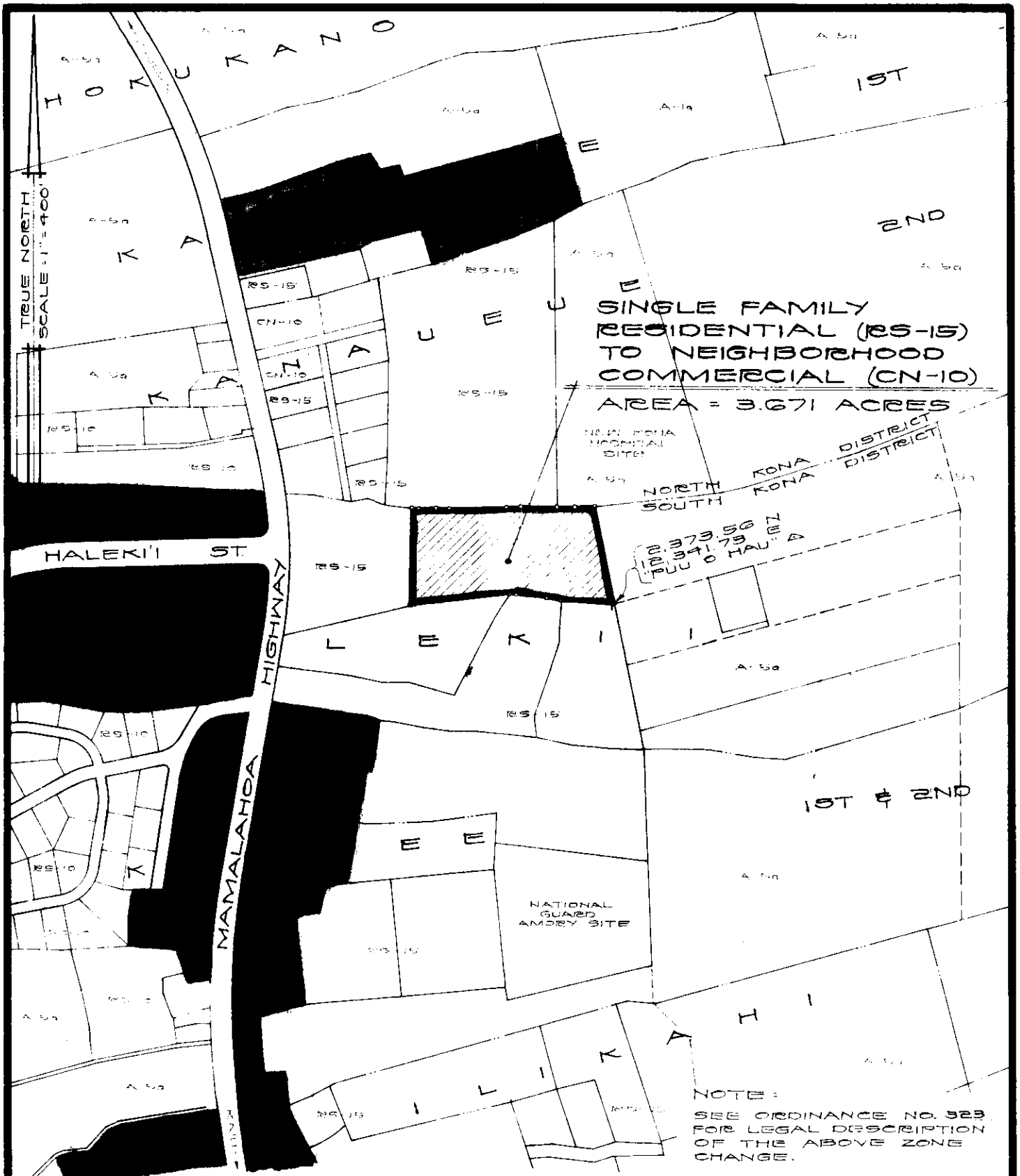

AMENDMENT TO THE ZONING CODE

AMENDMENT NO. 21 TO SECTION 7.03, THE SOUTH KONA ZONE MAP OF CHAPTER 8 (ZONING CODE), ARTICLE 2, HAWAII COUNTY CODE, AS AMENDED, BY CHANGING THE DISTRICT CLASSIFICATION FROM SINGLE FAMILY RESIDENTIAL (RS-15) TO NEIGHBORHOOD COMMERCIAL (CN-10) AT HALEKII, SOUTH KONA, HAWAII.

DATE OF PUBLIC HEARING: AUG. 25, 1977
 DATE OF APPROVAL: NOV. 23, 1977
 ORDINANCE NO. 323
 PREPARED BY: PLANNING DEPARTMENT
 COUNTY OF HAWAII

TAX MAP KEY:
 B-1-01: 25, 27 & POR OF 13 & 15

SEPT. 26, 1977

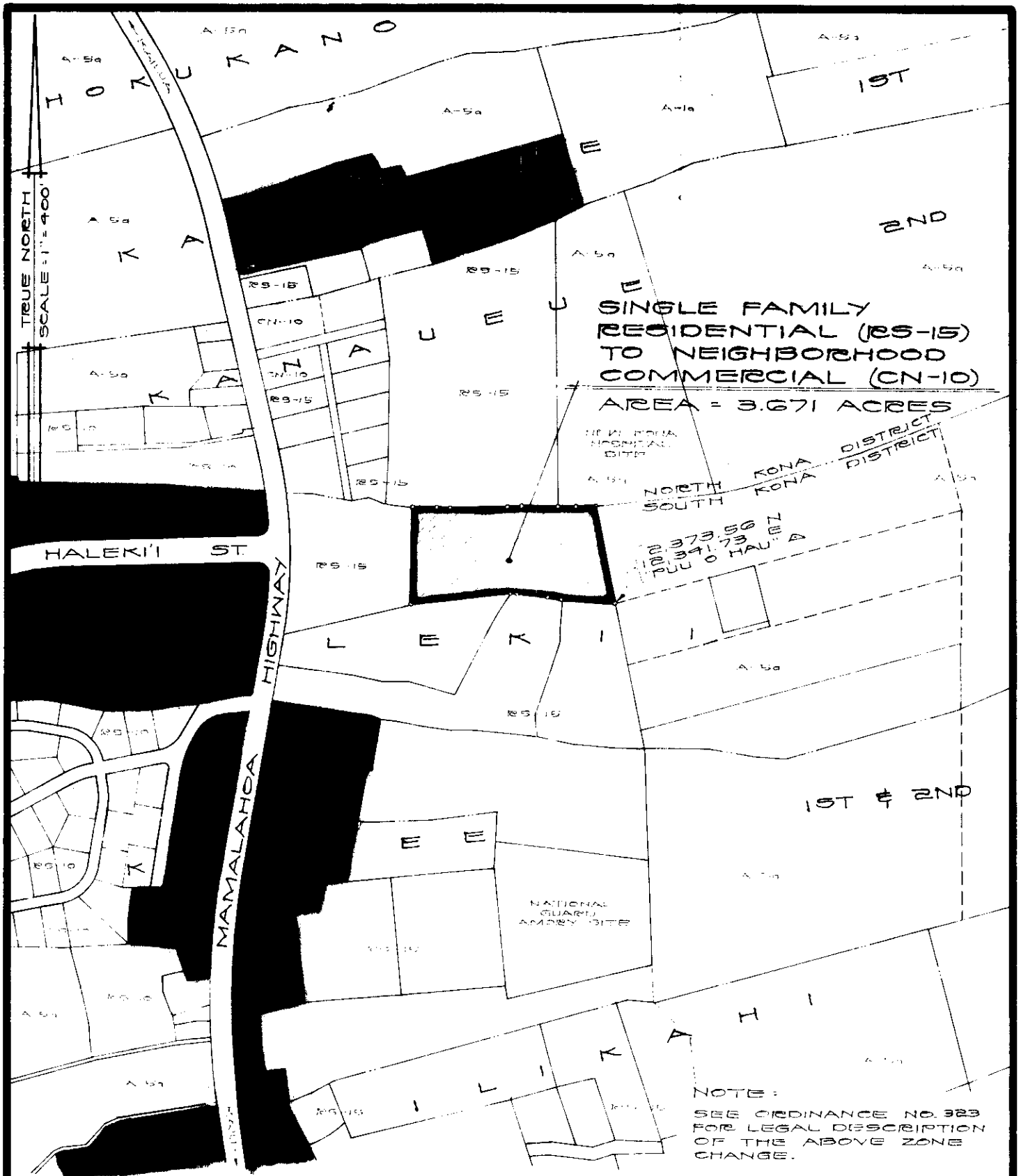

**SINGLE FAMILY
RESIDENTIAL (RS-15)
TO NEIGHBORHOOD
COMMERCIAL (CN-10)**
AREA = 3.671 ACRES

NEW KONA
HOSPITAL
SITE
NORTH
SOUTH
KONA DISTRICT
KONA DISTRICT

23,373.56 ±
12,391.73 ±
PULU O HAU'IA

NATIONAL
GUARDIAN
AMBLY SITE

NOTE:
SEE ORDINANCE NO. 323
FOR LEGAL DESCRIPTION
OF THE ABOVE ZONE
CHANGE.

AMENDMENT TO THE ZONING CODE

AMENDMENT NO. 21 TO SECTION 7.03, THE SOUTH KONA ZONE MAP OF CHAPTER 8 (ZONING CODE), ARTICLE 2, HAWAII COUNTY CODE, AS AMENDED, BY CHANGING THE DISTRICT CLASSIFICATION FROM SINGLE FAMILY RESIDENTIAL (RS-15) TO NEIGHBORHOOD COMMERCIAL (CN-10) AT HALEKII, SOUTH KONA, HAWAII.

DATE OF PUBLIC HEARING: AUG. 25, 1977
DATE OF APPROVAL: NOV. 23, 1977
ORDINANCE NO. 323
PREPARED BY: PLANNING DEPARTMENT
COUNTY OF HAWAII

TAX MAP KEY:
B-1-01: 25, 27 & PORT OF 13 & 15

SEPT. 26, 1977

Hilo, Hawaii

Date: November 2, 1977

FIRST READING			
	AYES	NOES	A/E
Dahlberg	X		
Domingo	X		
Fujii	X		
Garcia	X		
Kawahara	X		
Lai	X		
Sameshima	X		
Yamashiro			X
Chr. Tajiri	X		
	8		1

Publication Date: November 9, 1977

Hilo, Hawaii

Date: November 16, 1977

SECOND & FINAL READING			
	AYES	NOES	A/E
Dahlberg	X		
Domingo	X		
Fujii	X		
Garcia			X
Kawahara	X		
Lai	X		
Sameshima	X		
Yamashiro	X		
Chr. Tajiri	X		
	8		1

Publication Date: December 1, 1977

We do hereby certify that the foregoing BILL was adopted by the County Council and published as indicated above.

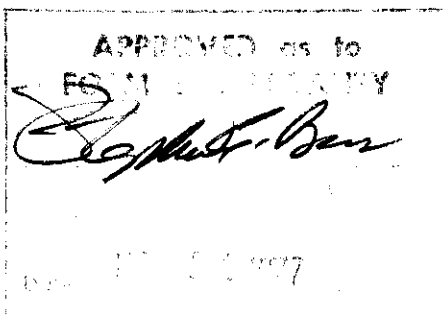

Henry Tajiri
 Council Chairman

P. B. Leguipi
 County Clerk

Approved/Disapproved this 23rd day of
November, 1977

Kubo Matayoshi
 Mayor, County of Hawaii

Bill No. 351
 Reference: PC-21/C-562
 M.B. No. _____
 Ord. No. 323

R. B. Legaspi
COUNTY CLERK

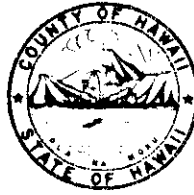

Yasuki Arakaki
DEPUTY COUNTY CLERK

Harry A. Takahashi
LEGISLATIVE AUDITOR

OFFICE OF THE COUNTY CLERK

COUNTY OF HAWAII
HILO, HAWAII 96720

Mayor Herbert T. Matayoshi
County of Hawaii
Hilo, HI

I hereby transmit Ordinance Bill No. 351
passed by the County Council on second final reading.

R. B. Legaspi
COUNTY CLERK

Encl.

Dated: November 17, 1977

BILL NO. 351 - 1977

AN ORDINANCE AMENDING SECTION 7.03 THE SOUTH KONA ZONE MAP OF CHAPTER 8 (ZONING CODE), ARTICLE 2, HAWAII COUNTY CODE, AS AMENDED, BY CHANGING THE DISTRICT CLASSIFICATION FROM SINGLE FAMILY RESIDENTIAL (RS-15) TO NEIGHBORHOOD COMMERCIAL (CN-10) AT HALEKII, SOUTH KONA, HAWAII, COVERED BY TAX MAP KEY: 8-1-01:25, 27 AND PORTIONS OF 13 & 15.

This Bill amends Chapter 8 (Zoning Code), Article 2, by changing the district classification from single family residential (RS-15) to neighborhood commercial (CN-10) at Halekii, South Kona.

Date Introduced: November 2, 1977

Copies of the foregoing Bill, in full, are on file in the Office of the County Clerk for use and examination by the public.

I hereby certify that the foregoing Bill passed first reading at the meeting of the County Council on November 2, 1977, by the following aye and no vote:

AYES: Councilmen Dahlberg, Domingo, Fujii, Garcia, Kawahara, Lai, Sameshima and Chairman Tajiri - 8.

NOES: None.

SENT AND EXCUSED: Councilman Yamashiro - 1.

AN ORDINANCE AMENDING SECTION 7.03 THE SOUTH KONA ZONE MAP OF CHAPTER 8 (ZONING CODE), ARTICLE 2, HAWAII COUNTY CODE, AS AMENDED, BY CHANGING THE DISTRICT CLASSIFICATION FROM SINGLE FAMILY RESIDENTIAL (RS-15) TO NEIGHBORHOOD COMMERCIAL (CN-10) AT HALEKII, SOUTH KONA, HAWAII, COVERED BY TAX MAP KEY: 8-1-01:25, 27 AND PORTIONS OF 13 & 15.

R. B. Legaspi
COUNTY CLERK
COUNTY OF HAWAII

THIS Bill amends Chapter 8 (Zoning Code), Article 2, by changing the district classification from single family residential (RS-15) to neighborhood commercial (CN-10) at Halekii, South Kona, Hawaii, covered by Tax Map Key: 8-1-01:25, 27 and portions of 13 & 15.
Date Introduced: November 2, 1977
Copies of the foregoing Bill, in full, are on file in the Office of the County Clerk for use and examination by the public.

I hereby certify that the foregoing Bill passed first reading at the meeting of the County Council on November 2, 1977, by the following aye and no vote:
AYES: Councilmen Dahlberg, Domingo, Fujii, Garcia, Kawahara, Lai, Sameshima and Chairman Tajiri - 8.

NOES: None.
SENT AND EXCUSED: Councilman Yamashiro - 1.

ORDINANCE NO. 323
(Bill No. 351-1977)

AN ORDINANCE AMENDING SECTION 7.03 THE SOUTH KONA ZONE MAP OF CHAPTER 8 (ZONING CODE), ARTICLE 2, HAWAII COUNTY CODE, AS AMENDED, BY CHANGING THE DISTRICT CLASSIFICATION FROM SINGLE FAMILY RESIDENTIAL (RS-15) TO NEIGHBORHOOD COMMERCIAL (CN-10) AT HALEKII, SOUTH KONA, HAWAII, COVERED BY TAX MAP KEY: 8-1-01:25, 27 AND PORTIONS OF 13 & 15.

Date Approved: November 16, 1977
Date Effective: November 23, 1977

Copies of the foregoing Ordinance, in full are on file in the Office of the County Clerk for use and examination by the public.

I hereby certify that the foregoing Ordinance passed second and final reading at the meeting of the County Council on November 16, 1977, by the following aye and no vote:

AYES: Councilmen Dahlberg, Domingo, Fujii, Kawahara, Lai, Sameshima, Yamashiro and Chairman Tajiri - 8.

NOES: None.

ABSENT & EXCUSED: Councilman Garcia - 1.

ORDINANCE NO. 323
(Bill No. 351-1977)
AN ORDINANCE AMENDING SECTION 7.03 THE SOUTH KONA ZONE MAP OF CHAPTER 8 (ZONING CODE), ARTICLE 2, HAWAII COUNTY CODE, AS AMENDED, BY CHANGING THE DISTRICT CLASSIFICATION FROM SINGLE FAMILY RESIDENTIAL (RS-15) TO NEIGHBORHOOD COMMERCIAL (CN-10) AT HALEKII, SOUTH KONA, HAWAII, COVERED BY TAX MAP KEY: 8-1-01:25, 27 AND PORTIONS OF 13 & 15.

Date Approved: November 16, 1977

Date Effective: November 23, 1977
Copies of the foregoing Ordinance, in full are on file in the Office of the County Clerk for use and examination by the public.

I hereby certify that the foregoing Ordinance passed second and final reading at the meeting of the County Council on November 16, 1977, by the following aye and no vote:

AYES: Councilmen Dahlberg, Domingo, Fujii, Kawahara, Lai, Sameshima, Yamashiro and Chairman Tajiri - 8.

NOES: None.

ABSENT & EXCUSED: Councilman Garcia - 1.

R. B. Legaspi
COUNTY CLERK
COUNTY OF HAWAII

R. B. Legaspi
COUNTY CLERK
COUNTY OF HAWAII