

COUNTY OF HAWAII - STATE OF HAWAII

ORDINANCE NO. 341

AN ORDINANCE AMENDING SECTION 7.12 THE HAMAKUA DISTRICT HOMESTEADS AREA ZONE MAP AND SECTION 7.13 THE HONOKAA-HAINA-KUKUIHAELE ZONE MAP OF CHAPTER 8 (ZONING CODE), ARTICLE 2, HAWAII COUNTY CODE, AS AMENDED, BY CHANGING THE DISTRICT CLASSIFICATION FROM AGRICULTURAL (A-5a) AND AGRICULTURAL (A-40a) TO SINGLE FAMILY RESIDENTIAL (RS-10) AT PAALAEA, PAPAANUI, HAINA AND NAMOKU, HAMAKUA, HAWAII, COVERED BY TAX MAP KEY 4-5-10:PORTIONS OF 1, 2 AND 31.

BE IT ORDAINED BY THE COUNCIL OF THE COUNTY OF HAWAII.

SECTION 1. Section 7.12 of Chapter 8 (Zoning Code), Article 2, Hawaii County Code, as amended, is hereby further amended by adding thereto the following subsections:

"7.12 (c-1). The district classification of the following area situated at Namoku, Hamakua, Hawaii, shall be Single Family Residential (RS-10):

Beginning at the Northeasterly corner of this parcel of land, on the Westerly side of Plumeria Street, the coordinates of said point of beginning referred to Government Survey Triangulation Station "KAAO" being 18.20 feet North and 3,426.75 feet West and running by azimuths measured clockwise from True South:

1. Following along the Westerly side of Plumeria Street on a curve to the left with a radius of 840.00 feet, the chord azimuth and distance being:
7° 33' 32.5" 404.87 feet;
2. 353° 36' 50" 434.15 feet along the Westerly side of Plumeria Street;
3. Thence, following along the Northerly side of Lot 1-B, being the County of Hawaii Refuse Transfer Station, on a curve to the right, with a radius of 20.00 feet, the chord azimuth and distance being:
38° 36' 50" 28.28 feet;
4. 83° 36' 50" 30.00 feet along the Northerly side of the County of Hawaii Refuse Transfer Station;

- | | | | |
|-----|------|-----|--|
| 5. | 74° | 00" | 100.00 feet along the Northerly side of the County of Hawaii Refuse Transfer Station; |
| 6. | 111° | 00' | 56.34 feet along the Northerly side of the County of Hawaii Refuse Transfer Station; |
| 7. | 202° | 30' | 113.62 feet along the remainder of R. P. Grant 1155 to G. M. Coffin, along the Easterly side of the Old Honokaa-Ahualoa Government Road; |
| 8. | 181° | 20' | 301.25 feet along the remainder of R. P. Grant 1155 to G. M. Coffin, along the Easterly side of the Old Honokaa-Ahualoa Government Road; |
| 9. | 186° | 40' | 160.51 feet along the remainder of R. P. Grant 1155 to G. M. Coffin, along the Easterly side of the Old Honokaa-Ahualoa Government Road; |
| 10. | 199° | 00' | 328.43 feet along the remainder of R. P. Grant 1155 to G. M. Coffin, along the Easterly side of the Old Honokaa-Ahualoa Government Road; |
| 11. | 292° | 40' | 27.21 feet along the Southwesterly side of Plumeria Street right of way to the point of beginning and containing an area of 1.895 Acres. |

"7.12 (c-2). The district classification of the following area situated at Paalaea, Papaanui, Haina and Namoku, Hamakua, Hawaii, shall be Single Family Residential (RS-10):

Beginning at the Southeasterly corner of this parcel of land, on the Westerly side of Pakalana Street and on the Northerly side of Hawaii Belt Road (FAP F-019-1(1)), the coordinates of said point of beginning referred to Government Survey Triangulation Station "KAAO" being 1,215.97 feet South and 416.84 feet West and running by azimuths measured clockwise from true South:

1. Thence, following along the Northerly side of Hawaii Belt Road on a curve to the right with a radius of 25.00 feet, the chord azimuth and distance being:

62° 32' 03" 37.57 feet;

2. 111^o 15' 06" 136.04 feet along the Northerly side of Hawaii Belt Road (FAP F-019-1(1));
- Thence, following along the Northerly side of Hawaii Belt Road on a curve to the left with a radius of 2,904.79 feet, the chord azimuth and distance being:
3. 110^o 36' 09" 65.82 feet;
4. 199^o 57' 12" 50.00 feet along the Northeasterly side of Hawaii Belt Road (FAP F-019-1(1));
5. Thence, following along the Northerly side of Hawaii Belt Road (FAP F-019-1(1)), on a curve to the left with a radius of 2,954.79 feet, the chord azimuth and distance being:
- 107^o 57' 12" 206.24 feet;
6. 15^o 57' 12" 50.00 feet along the Northwesterly side of Hawaii Belt Road (FAP F-019-1(1));
7. Thence, following along the Northerly side of Hawaii Belt Road (FAP F-019-1(1)), on a curve to the left with a radius of 2,904.79 feet, the chord azimuth and distance being:
- 102^o 14' 55" 375.38 feet;
8. Thence, following along the Northerly side of Hawaii Belt Road (FAP F-019-1(1)), on a curve to the left with a radius of 2,904.79 feet, the chord azimuth and distance being:
- 98^o 03' 02" 50.02 feet;
9. Thence, following along the Northerly side of Hawaii Belt Road (FAP F-019-1(1)), on a curve to the left with a radius of 2,904.79 feet, the chord azimuth and distance being:
- 94^o 45' 19" 283.99 feet;
10. 181^o 57' 12" 75.00 feet along the Northeasterly side of Hawaii Belt Road (FAP F-019-1(1));

11. Thence, following along the Northerly side of Hawaii Belt Road (FAP F-019-1(1)), on a curve to the left with a radius of 2,979.79 feet, the chord azimuth and distance being:

88°	27'	12"	363.82 feet;
-----	-----	-----	--------------
12. 354° 57' 12" 75.00 feet along the Northwesterly side of Hawaii Belt Road (FAP F-019-1(1));
13. Thence, following along the Northerly side of Hawaii Belt Road (FAP F-019-1(1)), on a curve to the left with a radius of 2,904.79 feet, the chord azimuth and distance being:

84°	16'	59"	67.96 feet;
-----	-----	-----	-------------
14. 83° 36' 46" 182.97 feet along the Northerly side of Hawaii Belt Road (FAP F-019-1(1));
15. 173° 36' 46" 20.00 feet along the Northeasterly side of Hawaii Belt Road (FAP F-019-1(1));
16. 83° 36' 46" 150.00 feet along the Northerly side of Hawaii Belt Road (FAP F-019-1(1));
17. 353° 36' 46" 10.00 feet along the Northwesterly side of Hawaii Belt Road (FAP F-019-1(1));
18. 83° 36' 46" 100.00 feet along the Northerly side of Hawaii Belt Road (FAP F-019-1(1));
19. 353° 36' 46" 10.00 feet along the Northeasterly side of Hawaii Belt Road (FAP F-019-1(1));
20. 83° 36' 46" 200.00 feet along the Northerly side of Hawaii Belt Road (FAP F-019-1(1));
21. 173° 36' 46" 15.00 feet along the Northeasterly side of Hawaii Belt Road (FAP F-019-1(1));
22. 83° 36' 46" 550.00 feet along the Northerly side of Hawaii Belt Road (FAP F-019-1(1));

23. 353^o 36' 46" 10.00 feet along the Northwesterly side of Hawaii Belt Road (FAP F-019-1(1));
24. 83^o 36' 46" 150.00 feet along the Northerly side of Hawaii Belt Road (FAP F-019-1(1));
25. 353^o 36' 46" 5.00 feet along the Northwesterly side of Hawaii Belt Road (FAP F-019-1(1));
26. 83^o 36' 46" 20.47 feet along the Northerly side of Hawaii Belt Road (FAP F-019-1(1));
27. 173^o 36' 50" 19.21 feet along the Easterly side of Plumeria Street;
28. 83^o 36' 50" 15.00 feet along the Northeasterly side of Plumeria Street;
29. 173^o 36' 50" 768.15 feet along the Easterly side of Plumeria Street;
30. Thence, following along the Easterly side of Plumeria Street on a curve to the right with a radius of 760.00 feet, the chord azimuth and distance being:
- 187^o 48' 25" 372.69 feet;
31. 202^o 00' 156.62 feet along the Easterly side of Plumeria Street;
- Thence, following along the Southeasterly side of Plumeria Street on a curve to the right with a radius of 440.00 feet the chord azimuth and distance being:
32. 225^o 52' 356.06 feet;
- Thence, following along the remainder of R. P. Grant 1155 to G. M. Coffin on a curve to the right with a radius of 125.00 feet the chord azimuth and distance being:
33. 346^o 48' 35" 30.80 feet;
34. 270^o 00' 70.41 feet along the remainder of R. P. Grant 1155 to G. M. Coffin (Lot 4);

- | | | | |
|-----|------------------|-----|--|
| 35. | 314 ^o | 00' | 187.62 feet along the remainder of R. P. Grant 1155 to G. M. Coffin (Lot 4); |
| 36. | 205 ^o | 00' | 136.18 feet along the remainder of R. P. Grant 1155 to G. M. Coffin (Lot 4); |
| 37. | 241 ^o | 00' | 113.46 feet along the remainder of R. P. Grant 1155 to G. M. Coffin (Lot 4); |
| 38. | 279 ^o | 00' | 109.74 feet along the remainder of R. P. Grant 1073 to George Hardy (Lot 4); |
| 39. | 262 ^o | 00' | 110.00 feet along the remainder of R. P. Grant 1073 to George Hardy (Lot 4); |
| 40. | 279 ^o | 00' | 186.16 feet along the remainder of R. P. Grant 1073 to George Hardy (Lot 4); |
| 41. | 276 ^o | 00' | 567.07 feet along the remainder of R. P. Grant 1073 to George Hardy (Lot 4); |
| 42. | 270 ^o | 00' | 111.83 feet along the remainder of R. P. Grant 1073 to George Hardy (Lot 4) |
| 43. | 353 ^o | 40' | 360.39 feet along the Westerly side of Lehua Street; |

Thence, following along the Westerly side of Lehua Street on a curve to the left with a radius of 430.00 feet, the chord azimuth and distance being:

- | | | | | |
|-----|------------------|-----|-----|--------------|
| 44. | 318 ^o | 15' | 24" | 498.30 feet; |
|-----|------------------|-----|-----|--------------|

Thence, following along the centerline of the old Lehua Street alignment for the next eighteen (18) courses;

- | | | | |
|-----|------------------|-----|--------------|
| 45. | 4 ^o | 30' | 357.26 feet; |
| 46. | 325 ^o | 00' | 55.51 feet; |
| 47. | 283 ^o | 00' | 124.91 feet; |
| 48. | 259 ^o | 00' | 70.06 feet; |
| 49. | 235 ^o | 00' | 160.68 feet; |

50.	256°	00'		55.05 feet;
51.	280°	00'		227.28 feet
52.	291°	00'		164.30 feet;
53.	306°	00'		161.79 feet;
54.	283°	00'		66.09 feet;
55.	256°	00'		51.54 feet;
56.	231°	00'		78.54 feet;
57.	241°	05'		49.02 feet;
58.	262°	35'		114.81 feet;
59.	286°	37'	30"	61.20 feet;
60.	229°	15'		34.06 feet;
61.	226°	00'		54.43 feet;
62.	338°	00'		97.51 feet;
63.	13°	49'		274.87 feet along the Westerly side of Pakalana Street to the point of beginning and containing an area of 56.297 acres.

"7.12 (c-3). The district classification of the following area situated at Paalaea, Papaanui, Haina, and Namoku, Hamakua, Hawaii, shall be Single Family Residential (RS-10):

Beginning at the Northeasterly corner of this parcel of land, on the Southerly side of Hawaii Belt Road (FAP F-019-1(1)), the coordinates of said point of beginning referred to Government Survey Triangulation Station "KAAO" being 1,128.05 feet South and 1,043.12 feet West and running by azimuths measured clockwise from True South:

1. 17° 08' 01" 177.18 feet along the remainder of R. P. Grant 3163 to J. D. Ackerman;
2. 107° 08' 01" 225.00 feet along the remainder of R. P. Grant 3163 to J. D. Ackerman;
3. 17° 08' 01" 197.45 feet along the remainder of R. P. Grant 3163 to J. D. Ackerman;

4. 83° 43' 36.27 feet along the Northerly side of the Old Mamalahoa Highway (60-ft. right of way);
5. Thence, following along the Northerly side of the Old Mamalahoa Highway (60-ft. right of way) on a curve to the left with a radius of 800.00 feet, the chord azimuth and distance being:
69° 29' 393.39 feet;
6. 55° 15' 454.25 feet along the Northerly side of the Old Mamalahoa Highway (60-ft. right of way);
7. Thence, following along the Northerly side of the Old Mamalahoa Highway (60-ft. right of way) on a curve to the right with a radius of 600.00 feet, the chord azimuth and distance being:
69° 10' 288.61 feet;
8. 83° 05' 500.38 feet along the Northerly side of the Old Mamalahoa Highway (60-ft. right of way);
9. Thence, following along the Northerly side of the Old Mamalahoa Highway (60-ft. right of way) on a curve to the left with a radius of 450.00 feet, the chord azimuth and distance being:
59° 58' 353.34 feet
10. 36° 51' 382.07 feet along the Northerly side of the Old Mamalahoa Highway (60-ft. right of way);
11. Thence, following along the Northerly side of the Old Mamalahoa Highway (60-ft. right of way) on a curve to the right with a radius of 80.00 feet, the chord azimuth and distance being:
79° 28' 30" 108.35 feet;
12. 122° 06' 259.58 feet along the Northerly side of the Old Mamalahoa Highway (60-ft. right of way);
13. Thence, following along the Northerly side of the Old Mamalahoa Highway (60-ft. right of way) on a curve to the left with a radius of 400.00 feet, the chord azimuth and distance being:

- | | | | | |
|-----|-----------------------------|-----|-----|--|
| | 99° | 16' | | 310.44 feet; |
| 14. | 166° | 26' | | 56.67 feet along the remainder of R. P. Grant 1155 to G. M. Coffin; |
| 15. | 219° | 40' | | 583.59 feet along the remainder of R. P. Grant 1155 to G. M. Coffin; |
| 16. | 206° | 40' | | 261.84 feet along the remainder of R. P. Grant 1155 to G. M. Coffin; |
| 17. | 169° | 10' | | 200.83 feet along the remainder of R. P. Grant 1155 to G. M. Coffin; |
| 18. | 144° | 00' | | 89.46 feet along the remainder of R. P. Grant 1155 to G. M. Coffin; |
| 19. | 263° | 36' | 46" | 279.13 feet along the Southerly side of Hawaii Belt Road (FAP F-019-1(1)); |
| 20. | 173° | 36' | 46" | 10.00 feet along the Southeasterly side of Hawaii Belt Road (FAP F-019-1(1)); |
| 21. | 263° | 36' | 46" | 1,150.00 feet along the Southerly side of Hawaii Belt Road (FAP F-019-1(1)); |
| 22. | 353° | 36' | 46" | 10.00 feet along the Southwesterly side of Hawaii Belt Road (FAP F-019-1(1)); |
| 23. | 263° | 36' | 46" | 150.00 feet along the Southerly side of Hawaii Belt Road (FAP F-019-1(1)); |
| 24. | 173° | 36' | 46" | 5.00 feet along the Southeasterly side of Hawaii Belt Road (FAP F-019-1(1)); |
| 25. | 263° | 36' | 46" | 182.97 feet along the Southerly side of Hawaii Belt Road (FAP F-019-1(1)); |
| 26. | Thence, following along the | | | Southerly side of Hawaii Belt Road (FAP F-019-1(1)), on a curve to the right with a radius of 2,819.79 feet, the chord azimuth and distance being: |
| | 265° | 16' | 59" | 164.38 feet; |

27. 356° 57' 12" 10.00 feet along the Southwesterly side of Hawaii Belt Road (FAP F-019-1(1));
28. Thence, following along the Southerly side of Hawaii Belt Road (FAP F-019-1(1)), on a curve to the right with a radius of 2,809.79 feet, the chord azimuth and distance being:
267° 57' 12" 98.08 feet;
29. 178° 57' 12" 10.00 feet along the Southeasterly side of Hawaii Belt Road (FAP F-019-1(1));
30. Thence, following along the Southerly side of Hawaii Belt Road (FAP F-019-1(1)), on a curve to the right with a radius of 2,819.79 feet, the chord azimuth and distance being:
271° 57' 12" 295.15 feet;
31. 184° 57' 12" 5.00 feet along the Southwesterly side of Hawaii Belt Road (FAP F-019-1(1));
32. Thence, following along the Southerly side of Hawaii Belt Road (FAP F-019-1(1)), on a curve to the right with a radius of 2,824.79 feet, the chord azimuth and distance being:
276° 15' 02" 127.90 feet;
33. Thence, following along the Southerly side of Hawaii Belt Road (FAP F-019-1(1)), on a curve to the right with a radius of 2,824.79 feet, the chord azimuth and distance being:
278° 03' 18" 50.01 feet;
34. Thence, following along the Southerly side of Hawaii Belt Road (FAP F-019-1(1)), on a curve to the right with a radius of 2,824.79 feet, the chord azimuth and distance being:
280° 16' 30.5" 168.87 feet to the point of beginning and containing an area of 44,262 acres.

SECTION 2. Section 7.13 of Chapter 8 (Zoning Code), Article 2, Hawaii County Code, as amended, is hereby further amended by adding thereto the following subsection:

"7.13 (d). The district classification of the following area situated at Paalaea, Papaanui and Haina, Hamakua, Hawaii, shall be Single Family Residential (RS-10):

Beginning at the Southeasterly corner of this parcel of land, on the Westerly side of Pakalana Street, the coordinates of said point of beginning referred to Government Survey Triangulation Station "KAAO" being 949.05 feet South and 351.20 feet West and running by azimuths measured clockwise from true South:

Thence, following along the centerline of the old Lehua Street alignment for the next eighteen (18) courses:

1.	158°	00'	97.51 feet;
2.	146°	00'	54.43 feet;
3.	119°	15'	34.06 feet;
4.	106°	37' 30"	61.20 feet;
5.	82°	35'	114.81 feet;
6.	61°	05'	49.02 feet;
7.	51°	00'	78.54 feet;
8.	76°	00'	51.54 feet;
9.	103°	00'	66.09 feet;
10.	126°	00'	161.79 feet;
11.	111°	00'	164.30 feet;
12.	100°	00'	227.28 feet;
13.	76°	00'	55.05 feet;
14.	55°	00'	160.68 feet;
15.	79°	00'	70.06 feet;
16.	103°	00'	124.91 feet;
17.	145°	00'	55.51 feet;
18.	184°	30'	357.26 feet;

Thence, following along the Southerly side of the proposed Lehua Street realignment along the remainder of Grant 1073 to George Hardy, along the remainder of Grant 3163 to J. D. Ackerman on a curve to the left with a radius of 430.00 feet, the chord azimuth and distance being:

- 19. 273° 10' 24" 144.51 feet;
- 20. 263° 30' 193.78 feet along the Southerly side of the proposed Lehua Street realignment along the remainder of Grant 3163 to J. D. Ackerman;

Thence, following along the Southerly side of the proposed Lehua Street realignment along the remainder of Grant 3163 to J. D. Ackerman on a curve to the right with a radius of 770.00 feet, the chord azimuth and distance being:

- 21. 270° 20' 183.23 feet;
- 22. 277° 10' 993.21 feet along the Southerly side of the proposed Lehua Street realignment along the remainder of Grant 3163 to J. D. Ackerman, along the remainder of Land Commission Aware 9971, Apana 5 to W. P. Leleiohoku, and along the remainder of Lot B of Grant 6729 to Honokaa Sugar Company;
- 23. 7° 10' 77.07 feet along the Westerly side of Pakalana Street;
- 24. 13° 42' 144.00 feet along the Westerly side of Pakalana Street;
- 25. 21° 30' 164.20 feet along the Westerly side of Pakalana Street;
- 26. 13° 49' 111.32 feet along the Westerly side of Pakalana Street to the point of beginning and containing an area of 13.201 Acres.

"All as outlined in red on the map attached hereto, marked Exhibit 'A' and by reference made a part hereof."

SECTION 3. Sections 1 and 2 of this ordinance shall take effect forthwith upon the conditions that (A) the petitioner or its

authorized representative shall submit a revised master plan for the subject area to the Planning Department for review and acceptance, taking into consideration such matters as roadway network, drainage, open space, etc., in accordance with the Subdivision Control Code and the Cluster Plan Development requirements. No subdivision plans for any of the proposed phases of development shall be approved until the Master Plan has been reviewed and accepted by the Department;

(B) the petitioner/representative shall submit a subdivision plan for Phase I of its development and secure tentative approval within one (1) year from the date of acceptance of the overall master plan. The petitioner/representative shall also assume the responsibility for securing final subdivision approval;

(C) in order to assure housing development on the proposed lots, the petitioner/representative shall enter into an "Agreement", which may include a Surety Bond, with the County of Hawaii. The "Agreement" shall be approved by the Planning Director and the Corporation Counsel and shall be filed with the State of Hawaii, Bureau of Conveyances. Such "Agreement" shall be entered into prior to receipt of final subdivision approval of the first phase of development;

(D) the petitioner/representative shall be responsible for providing a water system in accordance with the County of Hawaii Department of Water Supply standards;

(E) the method of sewage disposal shall conform to the rules, regulations, and requirements of the State Department of Health;

(F) none of the proposed lots shall have direct access from the Hawaii Belt Highway;

(G) a channelized intersection with left-turn storage lanes and acceleration and deceleration lanes be constructed at the Pakalana Street-Mauna Loa Street-Hawaii Belt Highway intersection meeting with the approval of the State Department of Transportation, Land

Transportation Facilities Division. The intersection shall be constructed concurrently with Phase 2 (mauka area) as shown on the master plan; (H) the petitioner/representative work closely with the Soil Conservation Service to operationalize conservation practices relative to the topographic conditions of the proposed development; (I) a hydrologic/drainage study for the overall development be made by the petitioner/representative and be submitted with the overall master plan; and (J) all other applicable rules and regulations shall be complied with. Should any of the foregoing conditions not be met, rezoning of the area to its original zoning designation may be initiated.

SECTION 4. In the event that any portion of this ordinance is declared invalid, such invalidity shall not affect the other parts of this ordinance.

SECTION 5. This ordinance shall take effect upon its approval.

INTRODUCED BY:



COUNCILMAN, COUNTY OF HAWAII

Hilo, Hawaii

Date of Introduction: April 1, 1978

Date of Adoption: April 15, 1978

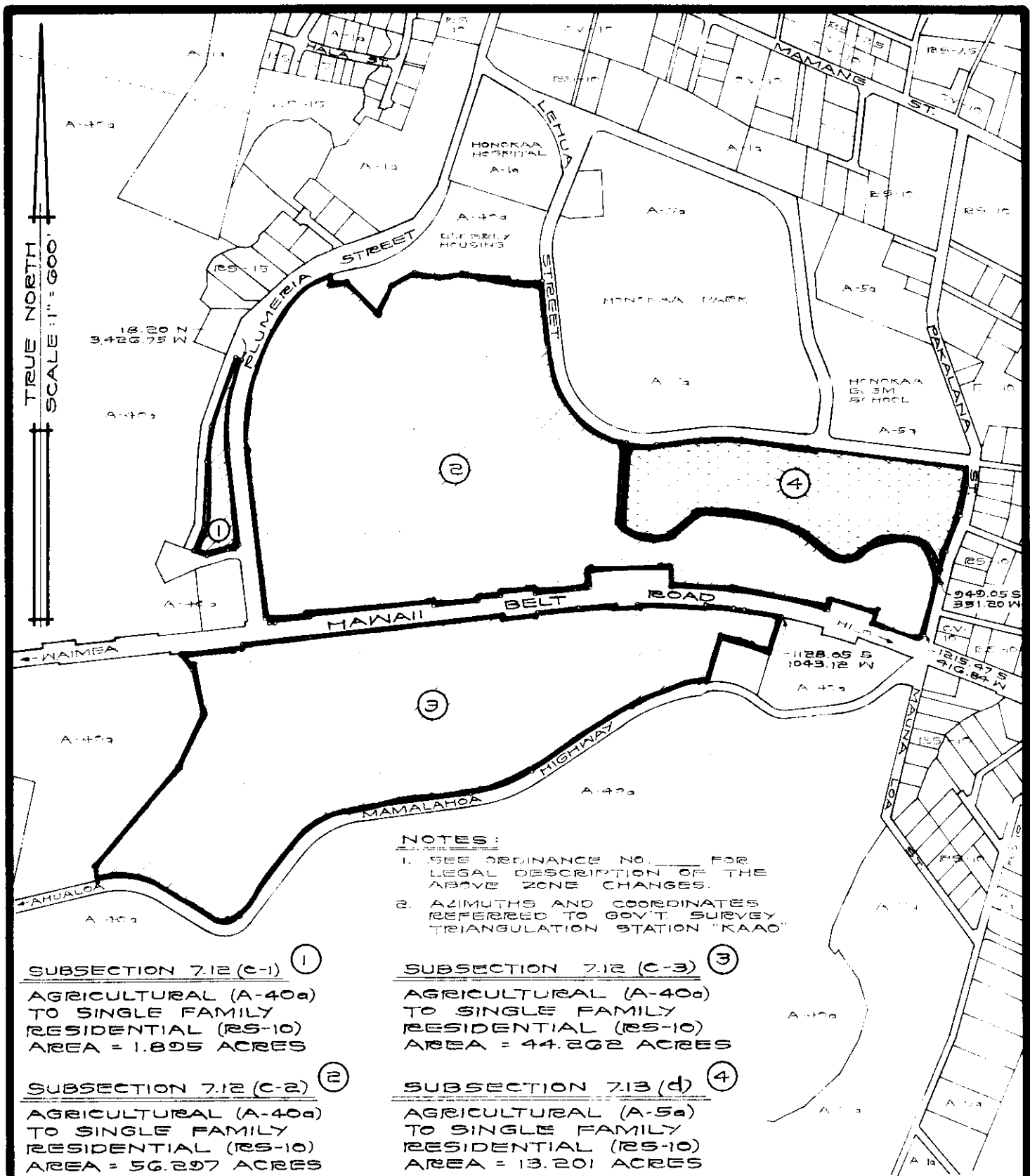
Effective Date: April 24, 1978



NOTES:

1. SEE ORDINANCE NO. _____ FOR LEGAL DESCRIPTION OF THE ABOVE ZONE CHANGES.
2. AZIMUTHS AND COORDINATES REFERRED TO GOV'T SURVEY TRIANGULATION STATION "KAAO"

SUBSECTION 7.12 (c-1) ①
 AGRICULTURAL (A-40a)
 TO SINGLE FAMILY
 RESIDENTIAL (RS-10)
 AREA = 1.895 ACRES

SUBSECTION 7.12 (c-2) ②
 AGRICULTURAL (A-40a)
 TO SINGLE FAMILY
 RESIDENTIAL (RS-10)
 AREA = 56.297 ACRES

SUBSECTION 7.12 (c-3) ③
 AGRICULTURAL (A-40a)
 TO SINGLE FAMILY
 RESIDENTIAL (RS-10)
 AREA = 44.262 ACRES

SUBSECTION 7.13 (d) ④
 AGRICULTURAL (A-5a)
 TO SINGLE FAMILY
 RESIDENTIAL (RS-10)
 AREA = 13.201 ACRES

AMENDMENT TO THE ZONING CODE

AMENDMENT NO. 3 TO SECTION 7.12, THE HAMAKUA DISTRICT HOMESTEADS AREA ZONE MAP AND AMENDMENT NO. 4 TO SECTION 7.13, THE HONOKAA-HAINA-KUKUIHAELE ZONE MAP OF CHAPTER 8 (ZONING CODE), ARTICLE 2, HAWAII COUNTY CODE, AS AMENDED, BY CHANGING THE DISTRICT CLASSIFICATION FROM AGRICULTURAL (A-5a) AND AGRICULTURAL (A-40a) TO SINGLE FAMILY RESIDENTIAL (RS-10) AT PAALAEA, PAPAANUI, HAINA AND NAMOKU, HAMAKUA, HAWAII.

DATE OF PUBLIC HEARING: SEPT. 8, 1977
 DATE OF APPROVAL:
 ORDINANCE NO.
 PREPARED BY: PLANNING DEPARTMENT
 COUNTY OF HAWAII

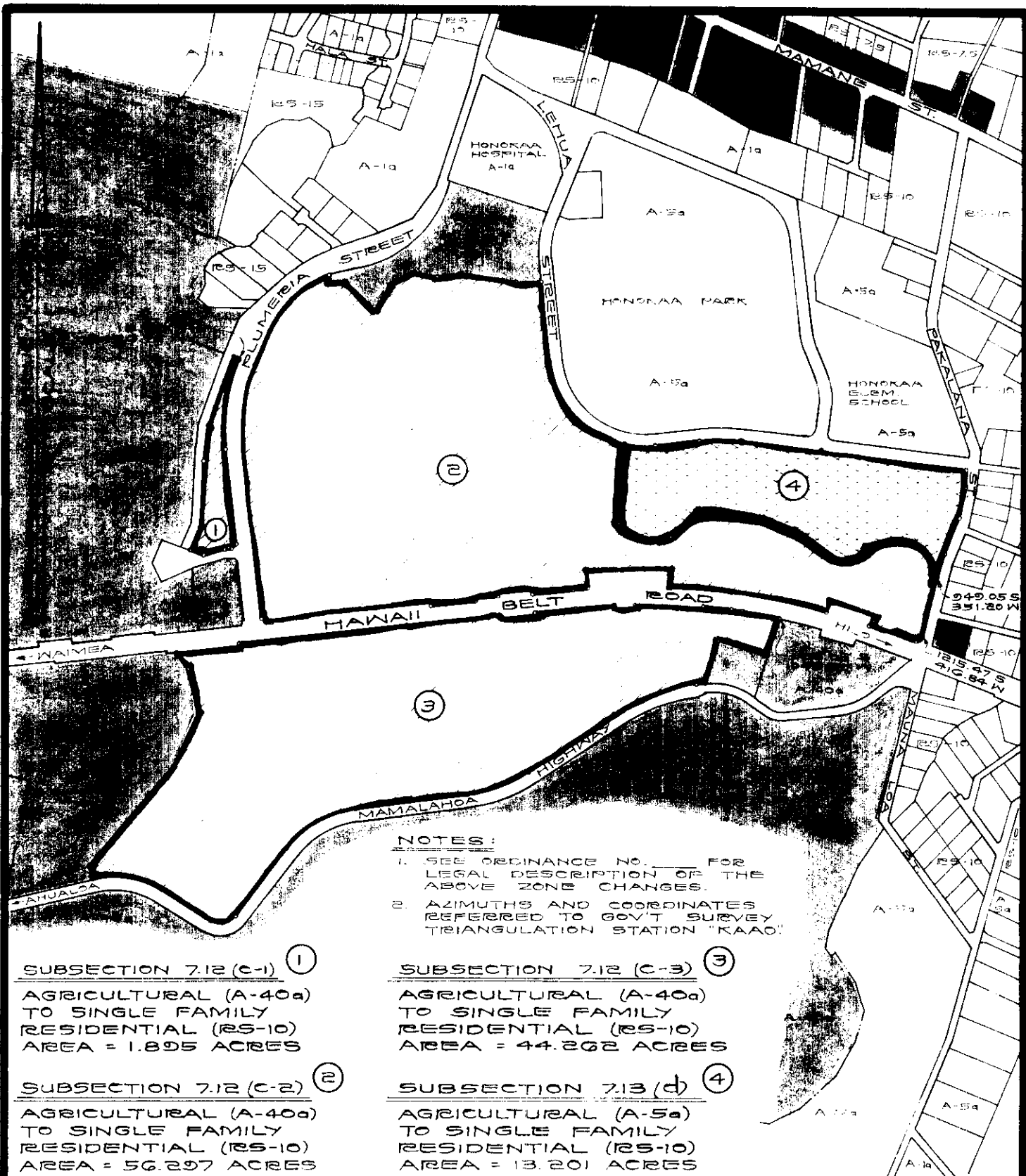

AMENDMENT TO THE ZONING CODE

AMENDMENT NO. 3 TO SECTION 7.12, THE HAMAKUA DISTRICT HOMESTEADS AREA ZONE MAP AND AMENDMENT NO. 4 TO SECTION 7.13, THE HONOKAA-HAINA-KUKUIHAELE ZONE MAP OF CHAPTER 8 (ZONING CODE), ARTICLE 2, HAWAII COUNTY CODE, AS AMENDED, BY CHANGING THE DISTRICT CLASSIFICATION FROM AGRICULTURAL (A-5a) AND AGRICULTURAL (A-40a) TO SINGLE FAMILY RESIDENTIAL (RS-10) AT PAALAEA, PAPAANUI, HAINA AND NAMOKU, HAMAKUA, HAWAII.

DATE OF PUBLIC HEARING: SEPT. 8, 1977
 DATE OF APPROVAL:
 ORDINANCE NO.
 PREPARED BY: PLANNING DEPARTMENT
 COUNTY OF HAWAII

Hilo, Hawaii
Date: April 1, 1978

FIRST READING			
	AYES	NOES	A/E
Dahlberg	X		
Domingo	X		
Fujii	X		
Garcia	X		
Kawahara	X		
Lai	X		
Sameshima	X		
Tajiri	X		
Chr. Yamashiro	X		
	9	0	0

Publication Date: April 6, 1978

Hilo, Hawaii
Date: April 15, 1978

SECOND & FINAL READING			
	AYES	NOES	A/E
Dahlberg	X		
Domingo	X		
Fujii	X		
Garcia	X		
Kawahara	X		
Lai	X		
Sameshima	X		
Tajiri	X		
Chr. Yamashiro	X		
	9	0	0

Publication Date: April 28, 1978

We do hereby certify that the foregoing BILL was adopted by the County Council and published as indicated above.

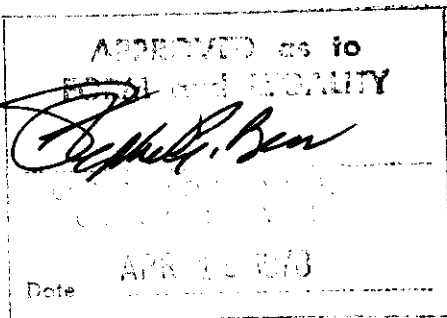

Harold G. ...
Council Chairman

R. B. Leapepi
County Clerk

Approved/Disapproved this 24th day of April, 1978

Hubert H. ...
Mayor, County of Hawaii

Bill No. 369
Reference: C-727/PC-28
M.B. No. _____
Ord. No. 341

R. B. Legaspi
COUNTY CLERK

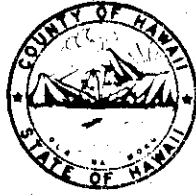

Yasuki Arakaki
DEPUTY COUNTY CLERK

Harry A. Takahashi
LEGISLATIVE AUDITOR

OFFICE OF THE COUNTY CLERK

COUNTY OF HAWAII
HILO, HAWAII 96720

Mayor Herbert T. Matayoshi
County of Hawaii
Hilo, HI

I hereby transmit Ordinance Bill No. 369
passed by the County Council on second final reading.

R. B. Legaspi
COUNTY CLERK

Encl.

Dated: April 17, 1978

Bill No. 369 - 1978

AN ORDINANCE AMENDING SECTION 7.12 THE HAMAKUA DISTRICT HOMESTEADS AREA ZONE MAP AND SECTION 7.13 THE HONOKAA-HAINA-KUKUIHAELE ZONE MAP OF CHAPTER 8 (ZONING CODE), ARTICLE 2, HAWAII COUNTY CODE, AS AMENDED, BY CHANGING THE DISTRICT CLASSIFICATION FROM AGRICULTURAL (A-5a) AND AGRICULTURAL (A-40a) TO SINGLE FAMILY RESIDENTIAL (RS-10) AT PAALAEA, PAPANUI, HAINA AND NAMOKU, HAMAKUA, HAWAII, COVERED BY TAX MAP KEY 4-5-10:PORTIONS OF 1, 2 AND 31.

This Bill proposes to amend Hamakua District Homesteads Area Zone Map, and Honokaa-Haina-Kukuihaele Zone Map, by changing the district classification from Agricultural (A-5a) and Agricultural (A-40a) to Single Family Residential (RS-10) zoned district.

Date Introduced: April 1, 1978

Copies of the foregoing Bill, in full, are on file in the Office of the County Clerk for use and examination by the public.

I hereby certify that the foregoing Bill passed first reading at the meeting of the County Council on April 1, 1978, by the following aye and no vote:

AYES: Councilmen Dahlberg, Domingo, Fujii, Garcia, Kawahara, Lai, Sameshima, Tajiri and Chairman Yamashiro - 9.

NOES: None.

D. B. Leegaspi
COUNTY CLERK
COUNTY OF HAWAII

THE HONOKAA-HAINA-KUKUIHAELE ZONE MAP OF CHAPTER 8 (ZONING CODE), ARTICLE 2, HAWAII COUNTY CODE, AS AMENDED, BY CHANGING THE DISTRICT CLASSIFICATION FROM AGRICULTURAL (A-5a) AND AGRICULTURAL (A-40a) TO SINGLE FAMILY RESIDENTIAL (RS-10) AT PAALAEA, PAPANUI, HAINA AND NAMOKU, HAMAKUA, HAWAII, COVERED BY TAX MAP KEY 4-5-10:PORTIONS OF 1, 2 AND 31.

This Bill proposes to amend Hamakua District Homesteads Area Zone Map, and Honokaa-Haina-Kukuihaele Zone Map by changing the district classification from Agricultural (A-5a) and Agricultural (A-40a) to Single Family Residential (RS-10) zoned district.

Date Introduced: April 1, 1978
Copies of the foregoing Bill, in full, are on file in the Office of the County Clerk for use and examination by the public.

I hereby certify that the foregoing Bill passed first reading at the meeting of the County Council on April 1, 1978, by the following aye and no vote:
AYES: Councilmen Dahlberg, Domingo, Fujii, Garcia, Kawahara, Lai, Sameshima, Tajiri and Chairman Yamashiro - 9.
NOES: None.

D. B. LEEGASPI
COUNTY CLERK
COUNTY OF HAWAII

ORDINANCE NO. 341
(Bill No. 369-1978)

AN ORDINANCE AMENDING SECTION 7.12 THE HAMAKUA DISTRICT HOMESTEADS AREA ZONE MAP AND SECTION 7.13 THE HONOKAA-HAINA-KUKUIHAELE ZONE MAP OF CHAPTER 8 (ZONING CODE), ARTICLE 2, HAWAII COUNTY CODE, AS AMENDED, BY CHANGING THE DISTRICT CLASSIFICATION FROM AGRICULTURAL (A-5a) AND AGRICULTURAL (A-40a) TO SINGLE FAMILY RESIDENTIAL (RS-10) AT PAALAEA, PAPANUI, HAINA AND NAMOKU, HAMAKUA, HAWAII, COVERED BY TAX MAP KEY 4-5-10:PORTIONS OF 1, 2 AND 31.

Date Approved: April 15, 1978
Date Effective: April 24, 1978

Copies of the foregoing Ordinance, in full, are on file in the Office of the County Clerk for use and examination by the public.

I hereby certify that the foregoing Ordinance passed second and final reading at the meeting of the County Council on April 15, 1978, by the following aye and no vote:

AYES: Councilmen Dahlberg, Domingo, Fujii, Garcia, Kawahara, Lai, Sameshima, Tajiri and Chairman Yamashiro - 9.

NOES: None.

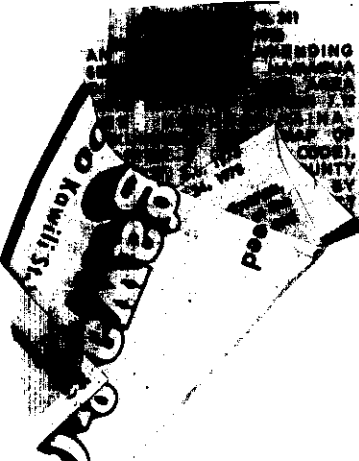

R. B. Leqaapi

COUNTY CLERK
COUNTY OF HAWAII