

COUNTY OF HAWAII - STATE OF HAWAII

ORDINANCE NO. 534

AN ORDINANCE AMENDING SECTION 7.12 THE HAMAKUA DISTRICT HOMESTEADS AREA ZONE MAP, ARTICLE 2, CHAPTER 8 (ZONING CODE) OF THE HAWAII COUNTY CODE, AS AMENDED, BY CHANGING THE DISTRICT CLASSIFICATION FROM SINGLE FAMILY RESIDENTIAL (RS-10) TO AGRICULTURAL (A-5a) AND FROM AGRICULTURAL (A-40a) TO SINGLE FAMILY RESIDENTIAL (RS-10) AT NAMOKU AND PAPAANUI, HAMAKUA, HAWAII, COVERED BY TAX MAP KEY: 4-5-10:82 AND PORTION OF 31.

BE IT ORDAINED BY THE COUNCIL OF THE COUNTY OF HAWAII:

SECTION 1. Section 7.12, Article 2, Chapter 8 (Zoning Code) of the Hawaii County Code, as amended, is hereby further amended by adding thereto the following subsection:

"7.12 (e-1). The district classification of the following area situated at Namoku, Hamakua, Hawaii, shall be Agricultural (A-5a):

Beginning at the Northeasterly corner of this parcel of land, being also a point on the Southerly side of Mamalahoa Highway (Hawaii Belt Road Proj. No. F-019-1(1)), the coordinates of which referred to Government Survey Triangulation Station "KAAO" being 1,237.83 feet South and 3,318.48 feet West and running by azimuths measured clockwise from True South:

1. 34° 00' 100.00 feet along the remainder of R.P. Grant 1155 to G. M. Coffin;
2. 8° 00' 190.00 feet along the remainder of R.P. Grant 1155 to G. M. Coffin;
3. 55° 11' 130.00 feet along the remainder of R.P. Grant 1155 to G. M. Coffin;
4. 8° 00' 115.00 feet along the remainder of R.P. Grant 1155 to G. M. Coffin;
5. 327° 00' 323.69 feet along the remainders of R.P. Grant 1155 to G. M. Coffin and R.P. Grant 1073 to George Hardy;
6. 6° 00' 354.00 feet along the remainder of R.P. Grant 1073 to George Hardy;
7. 39° 00' 225.90 feet along the remainders of R.P. Grant 1073 to George Hardy and R.P. Grant 1155 to G. M. Coffin;

Thence, along the Northerly side of Old Mamalahoa Highway on a curve to the right with a radius of 80.00 feet, the chord azimuth and distance being:

8. 111° 16' 30.07 feet;
9. 122° 06' 259.58 feet along the Northerly side of Old Mamalahoa Highway;

Thence, along the Northerly side of Old Mamalahoa Highway on a curve to the left with a radius of 400.00 feet, the chord azimuth and distance being:

10. 99° 16' 310.44 feet;
11. 166° 26' 56.67 feet along the remainder of R.P. Grant 1155 to G. M. Coffin;
12. 219° 40' 583.59 feet along the remainder of R.P. Grant 1155 to G. M. Coffin;
13. 206° 40' 261.84 feet along the remainder of R.P. Grant 1155 to G. M. Coffin;
14. 169° 10' 200.83 feet along the remainder of R.P. Grant 1155 to G. M. Coffin;
15. 144° 00' 89.46 feet along the remainder of R.P. Grant 1155 to G. M. Coffin;
16. 263° 36' 46" 279.13 feet along the Southerly side of Mamalahoa Highway (Hawaii Belt Road Proj. No. F-019-1(1));
17. 173° 36' 46" 10.00 feet along the Southerly side of Mamalahoa Highway (Hawaii Belt Road Proj. No. F-019-1(1));
18. 263° 36' 46" 100.00 feet along the Southerly side of Mamalahoa Highway (Hawaii Belt Road Proj. No. F-019-1(1)) to the point of beginning and containing an Area of 10.000 Acres.

"7.12 (e-2). The district classification of the following area situated at Papaanui, Hamakua, Hawaii, shall be Single Family Residential (RS-10):

Beginning at the Southeasterly corner of this parcel of land, being also the Southwesterly corner of TMK: 4-5-10:80, 3rd Division and a point on the Northerly side of Old Mamalahoa Highway the coordinates of which are referred to Government Survey Triangulation Station "KAAO" being 1,486.57 feet South and 1,153.65 feet West and running by azimuths measured clockwise from True South:

1. 120° 24' 46" 19.75 feet along Old Mamalahoa Highway;

Thence, along Mamalahoa Highway on a curve to the left with a radius of 200.00 feet, the chord azimuth and distance being:

2. 106° 49' 31" 153.64 feet;
3. 84° 14' 46" 30.50 feet along Old Mamalahoa Highway;
4. 197° 08' 01" 178.20 feet along the remainder of Grant 3163 to J. D. Ackerman;
5. 287° 08' 01" 200.00 feet along the remainder of Grant 3163 to J. D. Ackerman;
6. 17° 08' 01" 172.99 feet along the remainder of Grant 3163 to J. D. Ackerman to the point of beginning and containing an Area of 0.731 Acre.

"All as outlined in red on the map attached hereto, marked Exhibit 'A' and by reference made a part hereof."

"This ordinance shall take effect forthwith upon the conditions as outlined in Change of Zone Ordinance No. 341 and Cluster Plan Development Permit No. 4. Should the stated conditions not be met, rezoning of the area to its original or more appropriate zoning designation may be initiated."

SECTION 2. In the event that any portion of this ordinance is declared invalid, such invalidity shall not affect the other parts of this ordinance.

SECTION 3. This ordinance shall take effect upon its approval.

INTRODUCED BY:



COUNCIL MEMBER, COUNTY OF HAWAII

Hilo, Hawaii

Date of Introduction: January 23, 1980
Date of Adoption: February 6, 1980
Effective Date: February 12, 1980

TRUE NORTH
SCALE: 1" = 600'

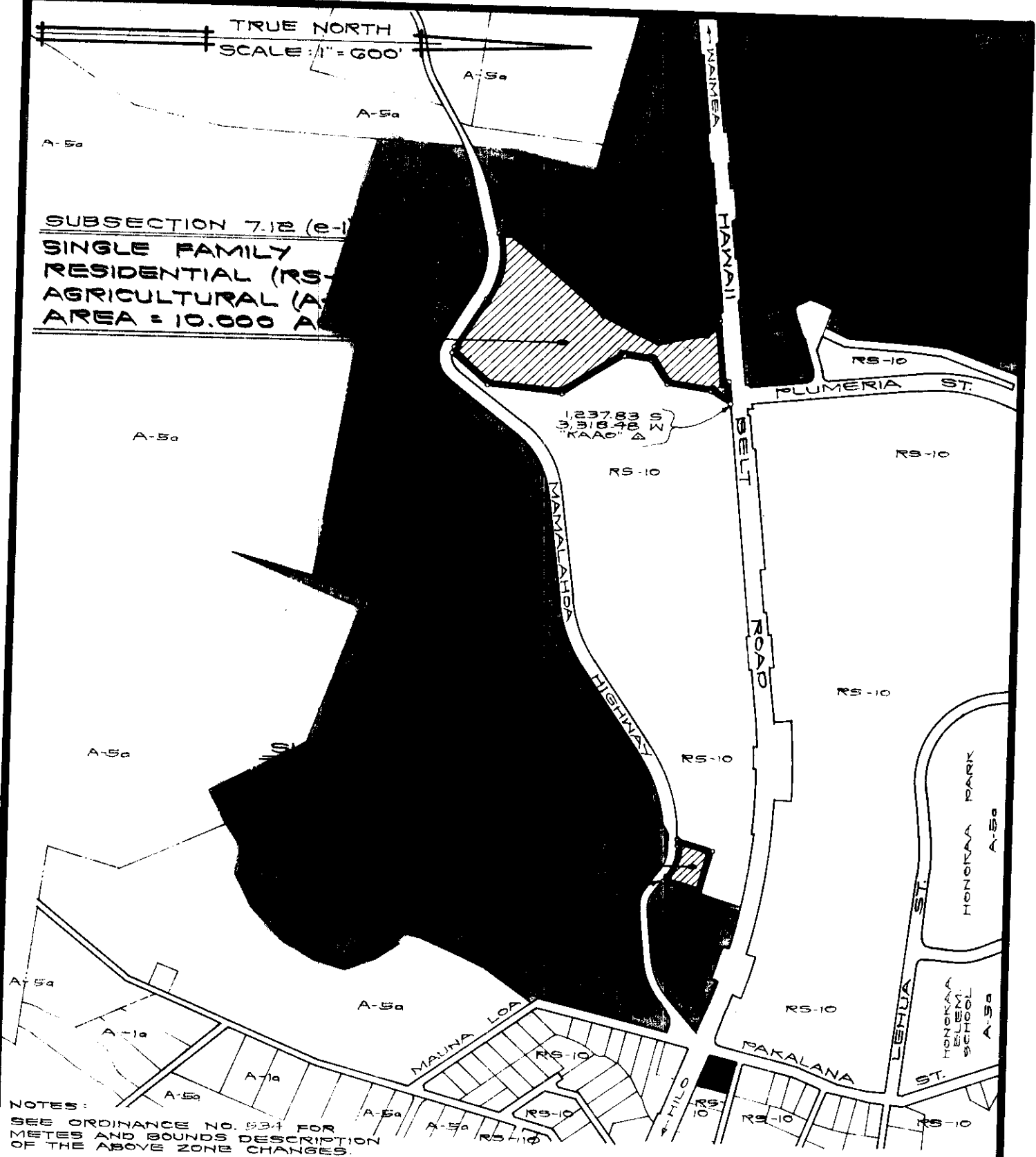
SUBSECTION 7.12 (e-1)
SINGLE FAMILY
RESIDENTIAL (RS-10)
AGRICULTURAL (A-5a)
AREA = 10.000 AC



NOTES:
SEE ORDINANCE NO. 534 FOR
METES AND BOUNDS DESCRIPTION
OF THE ABOVE ZONE CHANGES.

AMENDMENT TO THE ZONING CODE

AMENDMENT NO. 5 TO SECTION 7.12, THE HAMAKUA DISTRICT HOMESTEADS AREA ZONE MAP, ARTICLE 2, CHAPTER 8 (ZONING CODE) OF THE HAWAII COUNTY CODE, AS AMENDED, BY CHANGING THE DISTRICT CLASSIFICATION FROM SINGLE FAMILY RESIDENTIAL (RS-10) TO AGRICULTURAL (A-5a) AND FROM AGRICULTURAL (A-40a) TO SINGLE FAMILY RESIDENTIAL (RS-10) AT NAMOKU AND PAPAANUI, HAMAKUA, HAWAII.

DATE OF PUBLIC HEARING: OCT. 30, 1979
EFFECTIVE DATE: FEB. 12, 1980
ORDINANCE NUMBER: 534
PREPARED BY: PLANNING DEPARTMENT
COUNTY OF HAWAII

TMK: 4-5-10: 82 & POR 31

SEPT. 24, 1979

EXHIBIT "A"

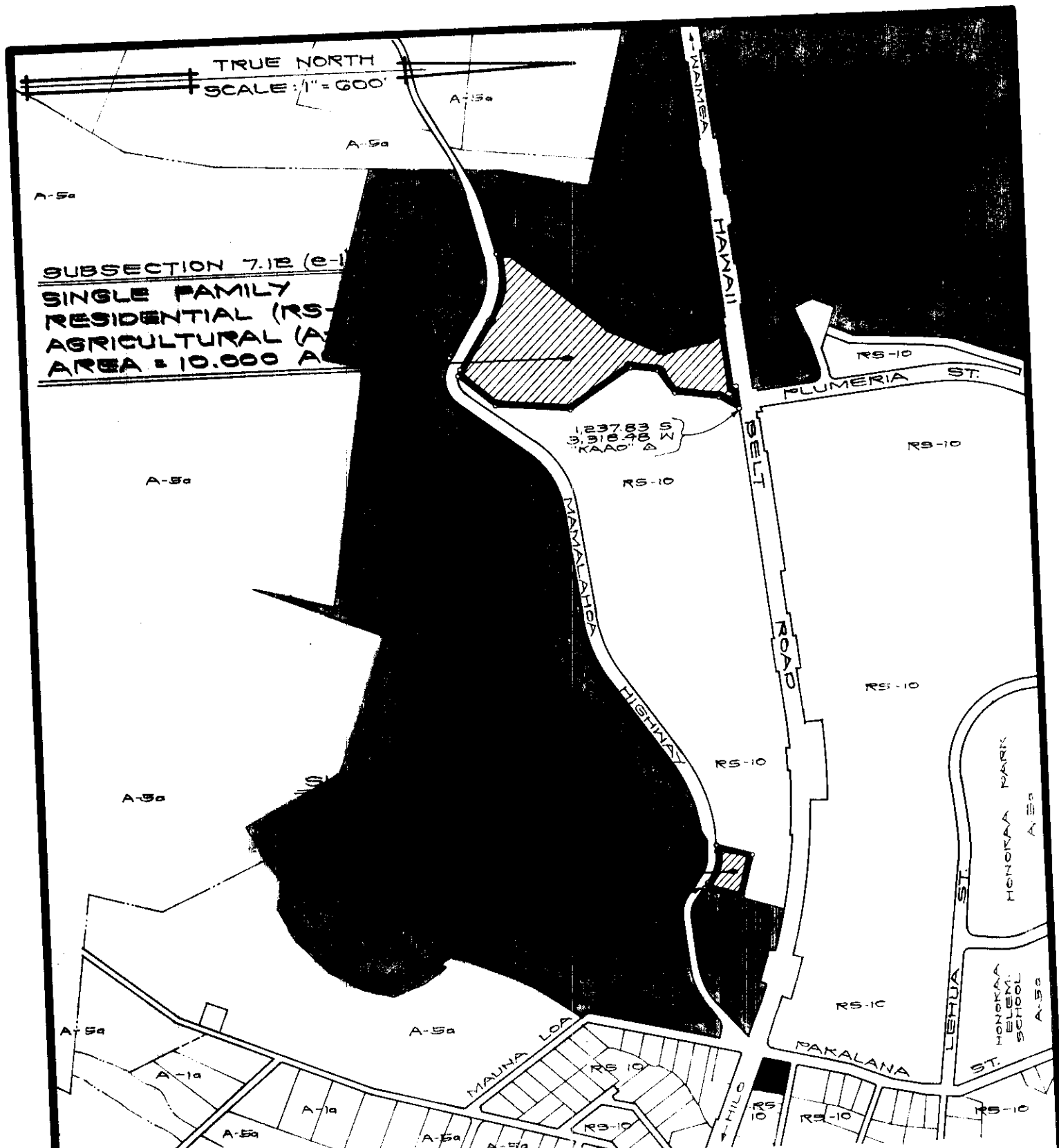

SUBSECTION 7.12 (e-1)
 SINGLE FAMILY
 RESIDENTIAL (RS-10)
 AGRICULTURAL (A-5a)
 AREA = 10,000 A

1,237.83 S
 3,318.48 W
 KAAO' A

NOTES:
 SEE ORDINANCE NO. 534 FOR
 METES AND BOUNDS DESCRIPTION
 OF THE ABOVE ZONE CHANGES.

AMENDMENT TO THE ZONING CODE

AMENDMENT NO. 5 TO SECTION 7.12, THE HAMAKUA DISTRICT HOMESTEADS AREA ZONE MAP, ARTICLE 2, CHAPTER 8 (ZONING CODE) OF THE HAWAII COUNTY CODE, AS AMENDED, BY CHANGING THE DISTRICT CLASSIFICATION FROM SINGLE FAMILY RESIDENTIAL (RS-10) TO AGRICULTURAL (A-5a) AND FROM AGRICULTURAL (A-40a) TO SINGLE FAMILY RESIDENTIAL (RS-10) AT NAMOKU AND PAPAANUI, HAMAKUA, HAWAII.

DATE OF PUBLIC HEARING: OCT. 30, 1979
 EFFECTIVE DATE: FEB 12, 1980
 ORDINANCE NUMBER: 534
 PREPARED BY: PLANNING DEPARTMENT
 COUNTY OF HAWAII

SEPT. 24, 1979

TMK: 4-5-10: 82 & POR 31

EXHIBIT "A"

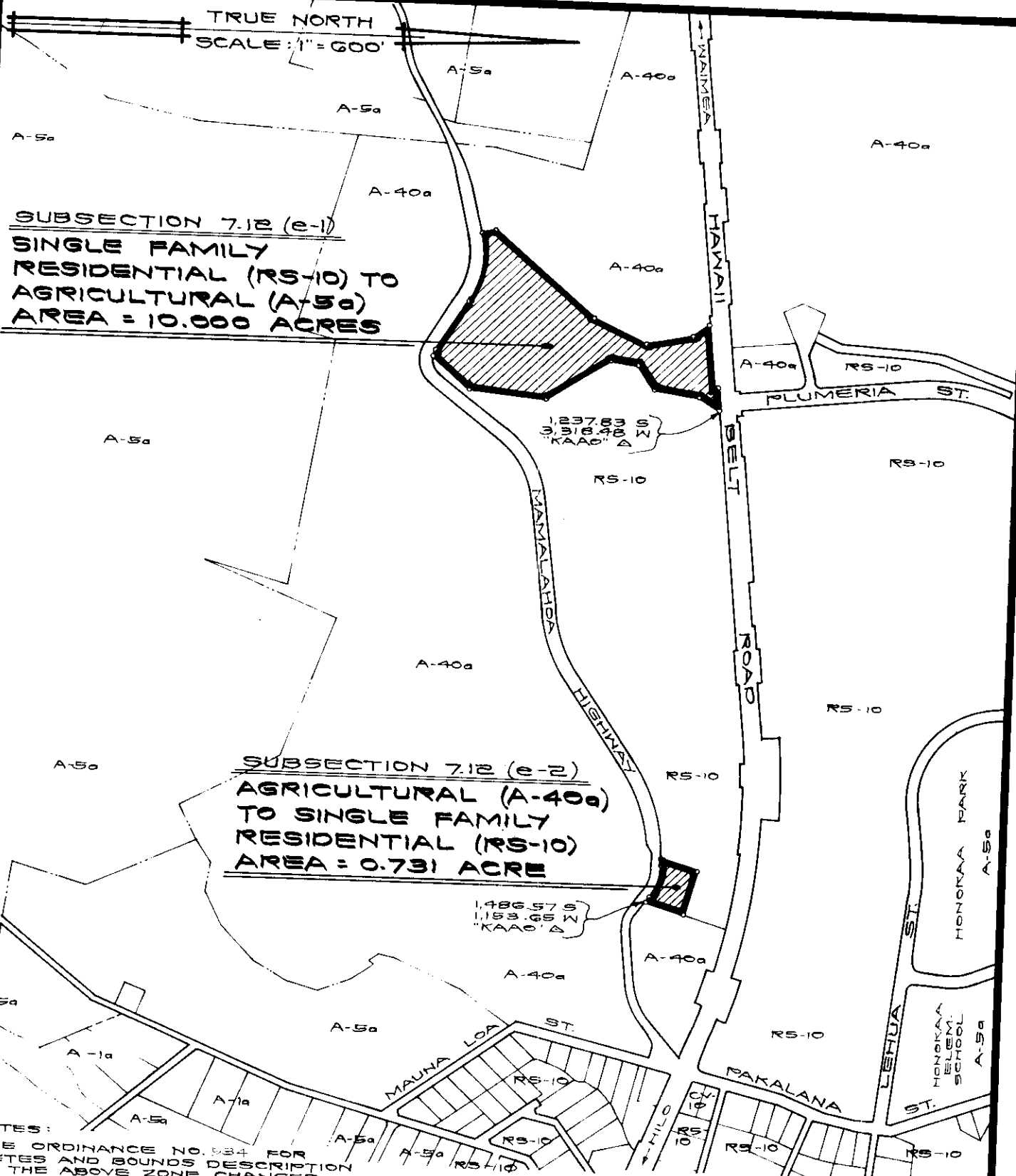

AMENDMENT TO THE ZONING CODE

AMENDMENT NO. 5 TO SECTION 7.12, THE HAMAKUA DISTRICT HOMESTEADS AREA ZONE MAP, ARTICLE 2, CHAPTER 8 (ZONING CODE) OF THE HAWAII COUNTY CODE, AS AMENDED, BY CHANGING THE DISTRICT CLASSIFICATION FROM SINGLE FAMILY RESIDENTIAL (RS-10) TO AGRICULTURAL (A-5a) AND FROM AGRICULTURAL (A-40a) TO SINGLE FAMILY RESIDENTIAL (RS-10) AT NAMOKU AND PAPAANUI, HAMAKUA, HAWAII.

DATE OF PUBLIC HEARING: OCT. 30, 1979
EFFECTIVE DATE: FEB. 12, 1980
ORDINANCE NUMBER: 534
PREPARED BY: PLANNING DEPARTMENT
COUNTY OF HAWAII

Hilo, Hawaii
Date: January 23, 1980

FIRST READING			
	AYES	NOES	EXC XXX
Dahlberg	X		
Domingo			X
Fujii	X		
Garcia	X		
Kawahara	X		
Lai	X		
Sameshima	X		
Tajiri	X		
Chr. Yamashiro	X		
	8	0	1

Hilo, Hawaii
Date: February 6, 1980

SECOND & FINAL READING			
	AYES	NOES	EXC XXX
Dahlberg	X		
Domingo			X
Fujii	X		
Garcia	X		
Kawahara	X		
Lai	X		
Sameshima	X		
Tajiri	X		
Chr. Yamashiro	X		
	8	0	1

Publication Date: JAN 30 1980

Publication Date: _____

We do hereby certify that the foregoing BILL was adopted by the County Council and published as indicated above.

APPROVED as to
FORM and LEGALITY
[Signature]
Date FEB 7 1980

[Signature]
Council Chairman

[Signature]
County Clerk

Approved/Disapproved this 12th day of
February, 1980

[Signature]
Mayor, County of Hawaii

Bill No. 570
Reference: C-1422/PC-138
M.B. No. _____
Ord. No. 534

Bill 570 - 1980

AN ORDINANCE AMENDING SECTION 7.12, THE HAMAKUA DISTRICT HOMESTEADS AREA ZONE MAP, ARTICLE 2, CHAPTER 8 (ZONING CODE), HAWAII COUNTY CODE, AS AMENDED, BY CHANGING THE DISTRICT CLASSIFICATION FROM SINGLE FAMILY RESIDENTIAL (RS-10) TO AGRICULTURAL (A-5A) AND FROM AGRICULTURAL (A-40A) TO SINGLE FAMILY RESIDENTIAL (RS-10) AT NAMOKU AND PAPAANUI, HAMAKUA COVERED BY TMK: 4-5-10:82 AND PORTION OF 31.

This Bill amends the Hamakua District Homesteads Area Zone Map by changing the District Classification from Single Family Residential (RS-10) to Agricultural (A-5A) and from Agricultural (A-40A) to Single Family Residential (RS-10) at Namoku and Papaanui, Hamakua.

Date Introduced: January 23, 1980

Copies of the foregoing Bill, in full, are on file in the Office of the County Clerk for use and examination by the public.

I hereby certify that the foregoing Bill passed first reading at the meeting of the County Council on January 23, 1980, by the following aye and no vote:

AYES: Councilmen Dahlberg, Fujii, Garcia, Kawahara, Lai, Sameshima, Tajiri and Chairman Yamashiro - 8.

NOES: None.

EXCUSED: Councilman Domingo - 1.

AMENDING SECTION 7.12, THE HAMAKUA DISTRICT HOMESTEADS AREA ZONE MAP, ARTICLE 2, CHAPTER 8, HAWAII COUNTY CODE, AS AMENDED, BY CHANGING THE DISTRICT CLASSIFICATION FROM SINGLE FAMILY RESIDENTIAL (RS-10) TO AGRICULTURAL (A-5A) AND FROM AGRICULTURAL (A-40A) TO SINGLE FAMILY RESIDENTIAL (RS-10) AT NAMOKU AND PAPAANUI, HAMAKUA COVERED BY TMK: 4-5-10:82 AND PORTION OF 31.

MON
L SEC

R. B. Leacy
COUNTY CLERK
COUNTY OF HAWAII

ORDINANCE NO. 534
(Bill No. 570-1980)

AN ORDINANCE AMENDING SECTION 7.12, THE HAMAKUA DISTRICT
HOMESTEADS AREA ZONE MAP, ARTICLE 2, CHAPTER 8 (ZONING CODE)
OF THE HAWAII COUNTY CODE, AS AMENDED, BY CHANGING THE
DISTRICT CLASSIFICATION FROM SINGLE FAMILY RESIDENTIAL (RS-10)
TO AGRICULTURAL (A-5a) AND FROM AGRICULTURAL (A-40a) TO
SINGLE FAMILY RESIDENTIAL (RS-10) AT NAMOKU AND PAPAANUI,
HAMAKUA, HAWAII, COVERED BY TAX MAP KEY 4-5-10:82 AND
PORTION OF 31.

Date Approved: February 6, 1980
Date Effective: February 12, 1980

Copies of the foregoing Ordinance, in full, are on file
in the Office of the County Clerk for use and examination by
the public.

I hereby certify that the foregoing Ordinance passed
second and final reading at the meeting of the County Council
on February 6, 1980, by the following aye and no vote:

AYES: Councilmen Dahlberg, Fujii, Garcia, Kawahara,
Lai, Sameshima, Tajiri and Chairman Yamashiro - 8.

NOES: None.

EXCUSED: Mr. Domingo - 1.

Q. B. Leyropi
COUNTY CLERK
COUNTY OF HAWAII

AN ORDINANCE AMENDING SECTION 7.12, THE HAMAKUA DISTRICT
HOMESTEADS AREA ZONE MAP, ARTICLE 2, CHAPTER 8 (ZONING CODE)
OF THE HAWAII COUNTY CODE, AS AMENDED, BY CHANGING THE
DISTRICT CLASSIFICATION FROM SINGLE FAMILY RESIDENTIAL (RS-10)
TO AGRICULTURAL (A-5a) AND FROM AGRICULTURAL (A-40a) TO
SINGLE FAMILY RESIDENTIAL (RS-10) AT NAMOKU AND PAPAANUI,
HAMAKUA, HAWAII, COVERED BY TAX MAP KEY 4-5-10:82 AND
PORTION OF 31.

That the foregoing Ordinance was read and passed at the meeting of the County Council on February 6, 1980, by the following aye and no vote:

AYES: Councilmen Dahlberg, Fujii, Garcia, Kawahara, Lai, Sameshima, Tajiri and Chairman Yamashiro - 8.

NOES: None.

EXCUSED: Mr. Domingo - 1.

Q. B. Leyropi
COUNTY CLERK
COUNTY OF HAWAII

Approved: _____
COUNTY CLERK
COUNTY OF HAWAII