

## COUNTY OF HAWAII - STATE OF HAWAII

ORDINANCE NO. 565

AN ORDINANCE AMENDING SECTION 7.02, (THE NORTH KONA ZONE MAP), ARTICLE 2, CHAPTER 8 (ZONING CODE) OF THE HAWAII COUNTY CODE, AS AMENDED, BY CHANGING THE DISTRICT CLASSIFICATION FROM MULTIPLE FAMILY RESIDENTIAL (RM-5) TO SINGLE FAMILY RESIDENTIAL (RS-10) AT KEALAKEHE, NORTH KONA, HAWAII, COVERED BY TAX MAP KEY 7-4-17:1-7.

BE IT ORDAINED BY THE COUNCIL OF THE COUNTY OF HAWAII:

SECTION 1. Section 7.02, Article 2, Chapter 8 (Zoning Code) of the Hawaii County Code, as amended, is hereby further amended by adding thereto the following subsection:

"7.02(w). The district classification of the following area situated at Kealakehe, North Kona, Hawaii, shall be Single Family Residential (RS-10):

Beginning at the most easterly corner of this parcel of land, the most northerly corner of Grant S-14862 to Hawaii Housing Authority and on the Westerly side of Kealakaa Street, the coordinates of said point of beginning referred to Government Survey Triangulation Station "KEAHUOLU" being 8,325.58 feet North and 14,312.65 feet East, thence running by azimuths measured clockwise from True South:

1. 65° 06' 480.00 feet along Grant S-14862 to Hawaii Housing Authority;
2. 155° 06' 155.10 feet along the easterly side of 'Onipa'a Street;
3. Thence along the southeast corner of the intersection of 'Onipa'a Street and Kealakehe Street on a curve to the right with a radius of 20.00 feet, the chord azimuth and distance being: 200° 06' 28.28 feet;
4. 245° 06' 440.00 feet along the southerly side of Kealakehe Street;
5. Thence along the southwest corner of the intersection of Kealakehe Street and Kealakaa Street on a curve to the right with a radius of 20.00 feet, the chord azimuth and distance being: 290° 06' 28.28 feet;

6. 335° 06' 155.10 feet along the westerly side of Kealakaa Street to the point of beginning and containing an area of 83,875 Square Feet.

All as outlined in red on the map attached hereto, marked Exhibit "A" and by reference made a part hereof.

This subsection shall take effect upon the condition that all applicable rules, regulations, and requirements be complied with."

SECTION 2. In the event that any portion of this ordinance is declared invalid, such invalidity shall not affect the other parts of this ordinance.

SECTION 3. This ordinance shall take effect upon its approval.

INTRODUCED BY:

  
COUNCIL MEMBER, COUNTY OF HAWAII

Hilo, Hawaii

Date of Introduction: April 16, 1980

Date of Adoption: May 7, 1980

Effective Date: May 12, 1980

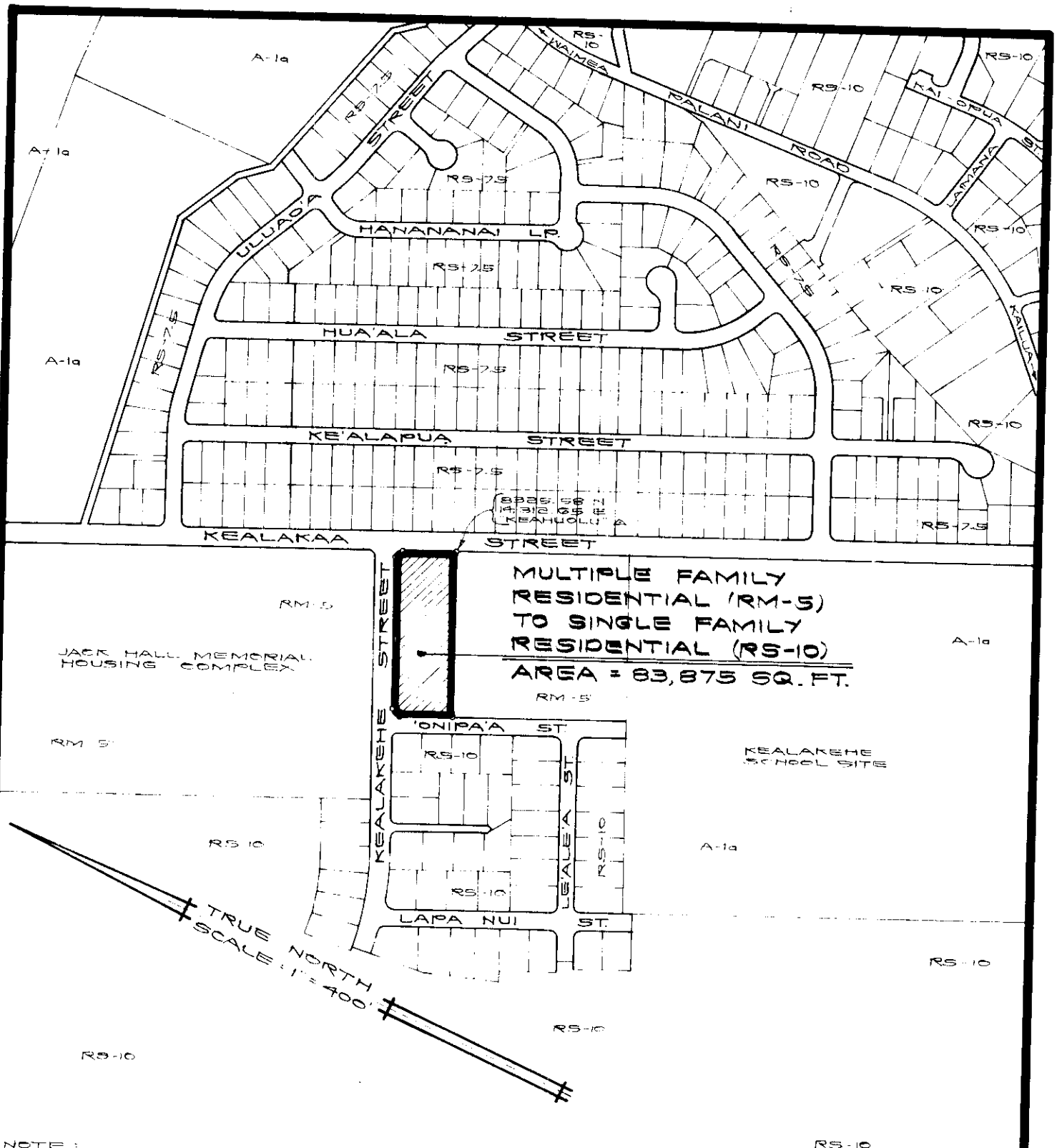

NOTE:  
 SEE ORDINANCE NO. 565 FOR  
 METES AND BOUNDS DESCRIPTION  
 OF THE ABOVE ZONE CHANGE.

## AMENDMENT TO THE ZONING CODE

AMENDMENT NO. 49 TO SECTION 7.02, THE NORTH KONA ZONE MAP, ARTICLE 2, CHAPTER 8 (ZONING CODE) OF THE HAWAII COUNTY CODE, AS AMENDED, BY CHANGING THE DISTRICT CLASSIFICATION FROM MULTIPLE FAMILY RESIDENTIAL (RM-5) TO SINGLE FAMILY RESIDENTIAL (RS-10) AT KEALAKEHE, NORTH KONA, HAWAII.

DATE OF PUBLIC HEARING: FEB. 13, 1980  
 EFFECTIVE DATE: MAY 12, 1980  
 ORDINANCE NUMBER: 565  
 PREPARED BY: PLANNING DEPARTMENT  
 COUNTY OF HAWAII

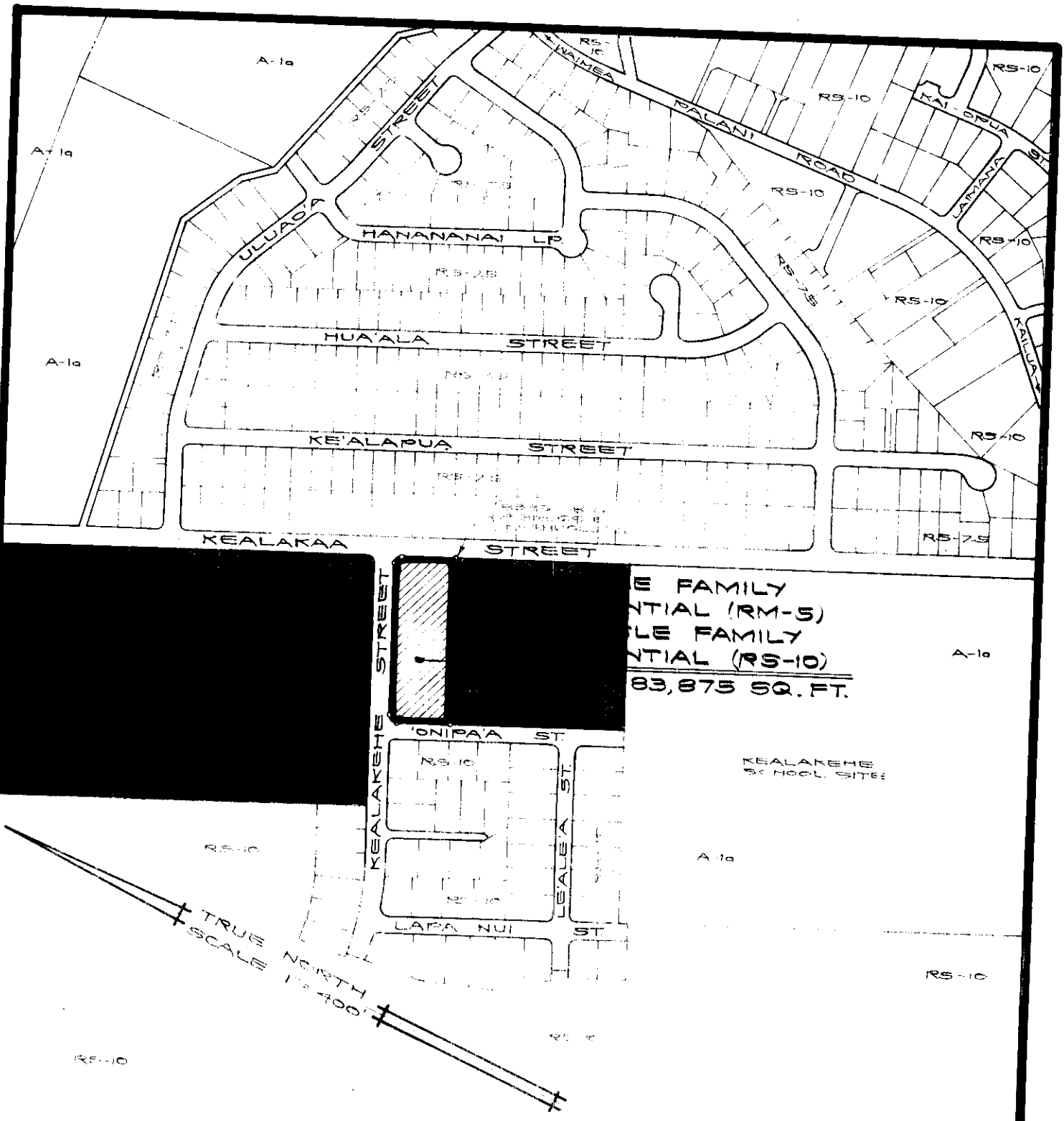

NOTE:  
 SEE ORDINANCE NO. 565 FOR  
 METES AND BOUNDS DESCRIPTION  
 OF THE ABOVE ZONE CHANGE.

## AMENDMENT TO THE ZONING CODE

AMENDMENT NO. 49 TO SECTION 7.02, THE NORTH KONA ZONE MAP, ARTICLE 2, CHAPTER 8 (ZONING CODE) OF THE HAWAII COUNTY CODE, AS AMENDED, BY CHANGING THE DISTRICT CLASSIFICATION FROM MULTIPLE FAMILY RESIDENTIAL (RM-5) TO SINGLE FAMILY RESIDENTIAL (RS-10) AT KEALAKEHE, NORTH KONA, HAWAII.

DATE OF PUBLIC HEARING: FEB. 13, 1980  
 EFFECTIVE DATE: MAY 12, 1980  
 ORDINANCE NUMBER: 565  
 PREPARED BY: PLANNING DEPARTMENT  
 COUNTY OF HAWAII

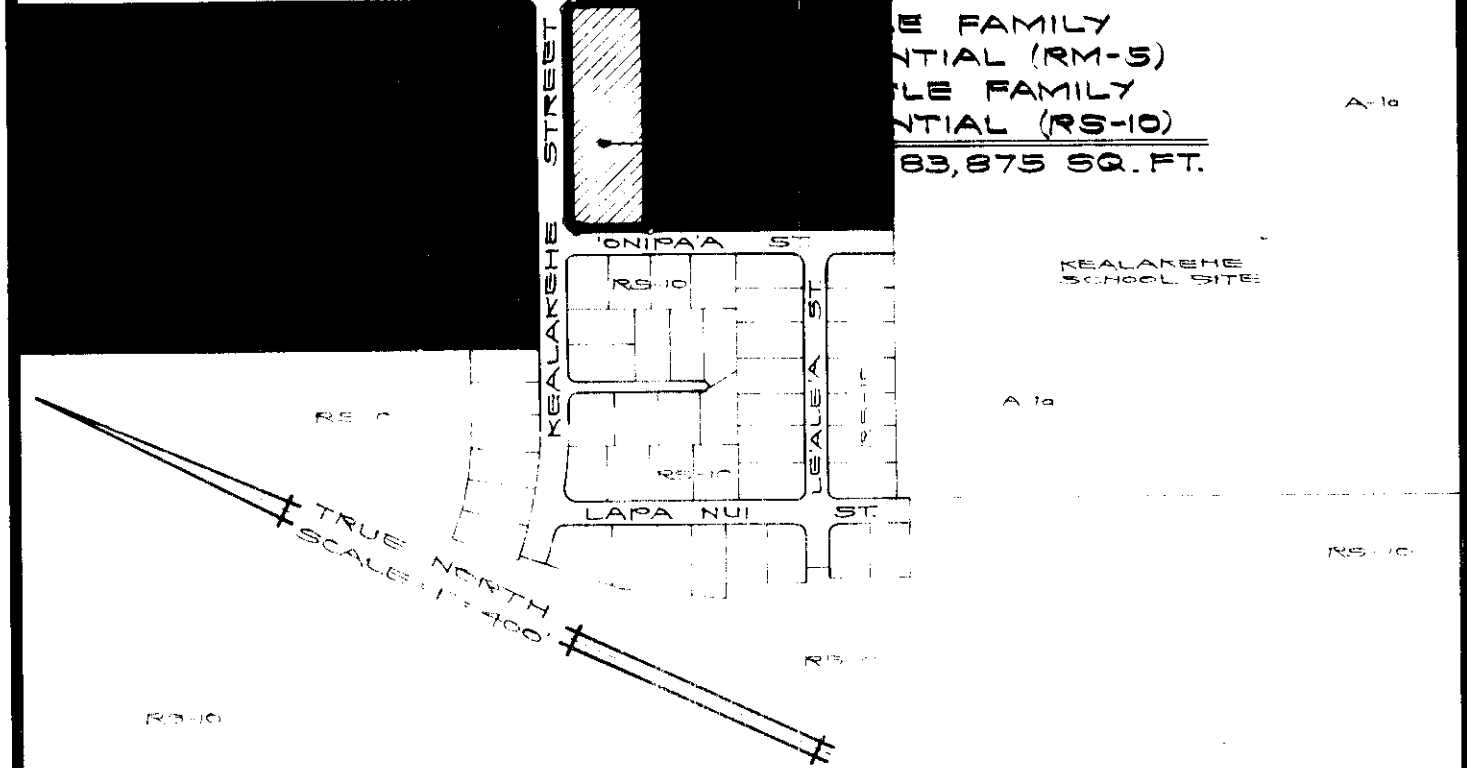
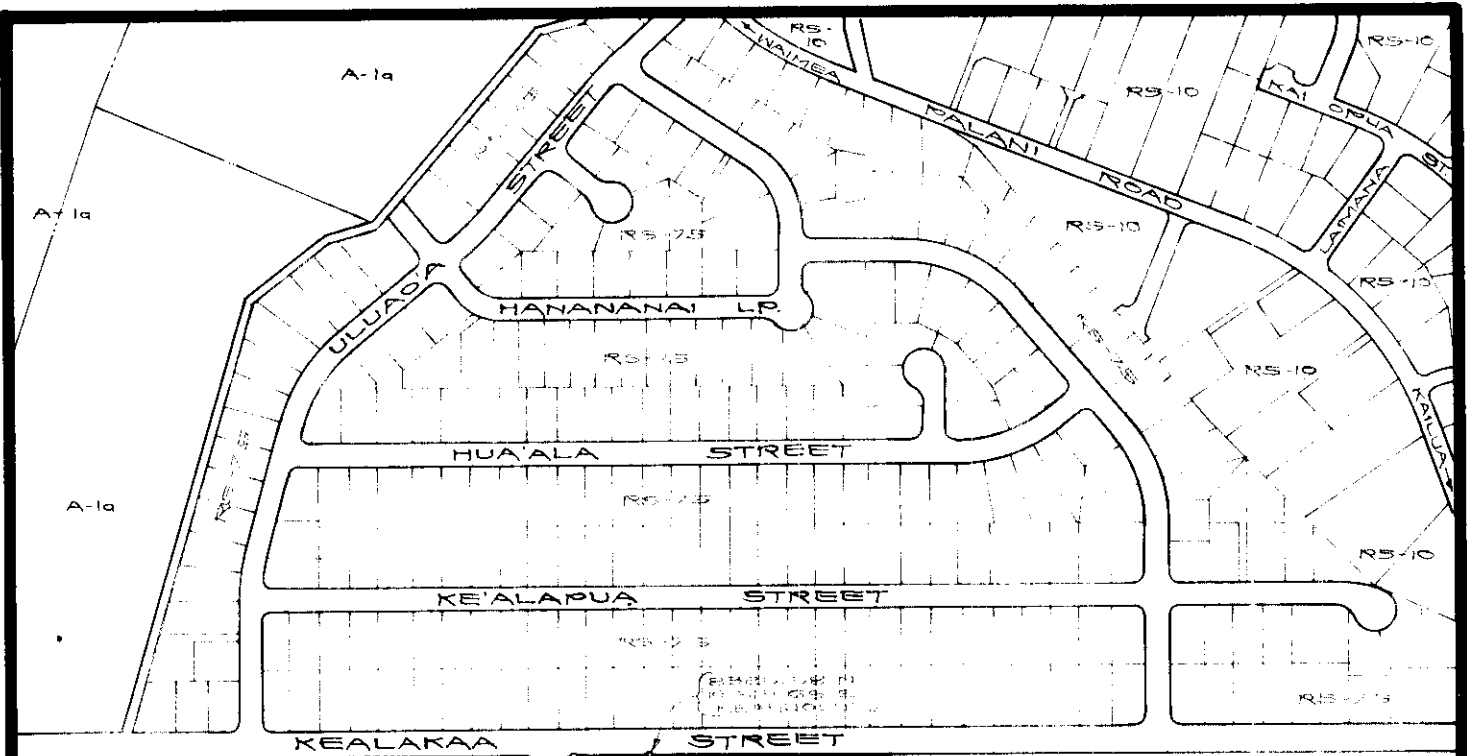

NOTE:  
 SEE ORDINANCE NO. 565 FOR  
 METES AND BOUNDS DESCRIPTION  
 OF THE ABOVE ZONE CHANGE

## AMENDMENT TO THE ZONING CODE

AMENDMENT NO. 49 TO SECTION 7.02, THE NORTH KONA ZONE MAP, ARTICLE 2, CHAPTER 8 (ZONING CODE) OF THE HAWAII COUNTY CODE, AS AMENDED, BY CHANGING THE DISTRICT CLASSIFICATION FROM MULTIPLE FAMILY RESIDENTIAL (RM-5) TO SINGLE FAMILY RESIDENTIAL (RS-10) AT KEALAKEHE, NORTH KONA, HAWAII.

DATE OF PUBLIC HEARING: FEB. 13, 1980  
 EFFECTIVE DATE: MAY 13, 1980  
 ORDINANCE NUMBER: 565  
 PREPARED BY: PLANNING DEPARTMENT  
 COUNTY OF HAWAII

TMK: 7-4-17:1-7

FEB. 1, 1980

Hilo, Hawaii  
 Date: April 16, 1980

FIRST READING			
	AYES	NOES	A/E
Dahlberg	X		
Domingo	X		
Fujii	X		
Garcia	X		
Kawahara	X		
Lai	X		
Sameshima	X		
Tajiri	X		
Chr. Yamashiro	X		
	9	0	0

Publication Date: April 21, 1980

Hilo, Hawaii  
 Date: May 7, 1980

SECOND & FINAL READING			
	AYES	NOES	A/E
Dahlberg	X		
Domingo	X		
Fujii	X		
Garcia	X		
Kawahara	X		
Lai	X		
Sameshima	X		
Tajiri	X		
Chr. Yamashiro	X		

Publication Date: May 7, 1980

We do hereby certify that the foregoing BILL was adopted by the County Council and published as indicated above.

*Robert B. Kazdin*  
 Date 9 May 80

*John G. ...*  
 Council Chairman

*R. M. Legaspi*  
 County Clerk

Approved/Disapproved this 12<sup>th</sup> day of May, 1980

*Robert B. Kazdin*  
 Mayor, County of Hawaii

Bill No. 600  
 Reference: C-1504/PC-151  
 M.B. No. \_\_\_\_\_  
 Ord. No. 565

Bill No. 600 - 1980

AN ORDINANCE AMENDING SECTION 7.02, (THE NORTH KONA ZONE MAP), ARTICLE 2, CHAPTER 8 (ZONING CODE) OF THE HAWAII COUNTY CODE, AS AMENDED, BY CHANGING THE DISTRICT CLASSIFICATION FROM MULTIPLE FAMILY RESIDENTIAL (RM-5) TO SINGLE FAMILY RESIDENTIAL (RS-10) AT KEALAKEHE, NORTH KONA, HAWAII, COVERED BY TAX MAP KEY 7-4-17:1-7.

This Bill amends The North Kona Zone Map, as amended, by changing the district classification from Multiple Family Residential (RM-5) to Single Family Residential (RS-10) at Kealakehe, N. Kona.

Date Introduced: April 16, 1980

Copies of the foregoing Bill, in full, are on file in the Office of the County Clerk for use and examination by the public.

---

I hereby certify that the foregoing Bill passed first reading at the meeting of the County Council on April 16, 1980, by the following aye and no vote:

AYES: Councilmen Dahlberg, Domingo, Fujii, Garcia, Kawahara, Lai, Sameshima, Tajiri and Chairman Yamashiro - 9.

NOES: None.

ABSENT & EXCUSED: None.

*D. M. Legras*  
COUNTY CLERK  
COUNTY OF HAWAII

AN ORDINANCE AMENDING SECTION 7.02, (THE NORTH KONA ZONE MAP), ARTICLE 2, CHAPTER 8 (ZONING CODE) OF THE HAWAII COUNTY CODE, AS AMENDED, BY CHANGING THE DISTRICT CLASSIFICATION FROM MULTIPLE FAMILY RESIDENTIAL (RM-5) TO SINGLE FAMILY RESIDENTIAL (RS-10) AT KEALAKEHE, NORTH KONA, HAWAII, COVERED BY TAX MAP KEY 7-4-17:1-7.

This Bill amends The North Kona Zone Map, as amended, by changing the district classification from Multiple Family Residential (RM-5) to Single Family Residential (RS-10) at Kealakehe, N. Kona.

Date Introduced: April 16, 1980

Copies of the foregoing Bill, in full, are on file in the Office of the County Clerk for use and examination by the public.

I hereby certify that the foregoing Bill passed first reading at the meeting of the County Council on April 16, 1980, by the following aye and no vote:

AYES: Councilmen Dahlberg, Domingo, Fujii, Garcia, Kawahara, Lai, Sameshima, Tajiri and Chairman Yamashiro - 9.

NOES: None.

ABSENT & EXCUSED: None.

*D. M. Legras*  
COUNTY CLERK  
COUNTY OF HAWAII

(100-1000) Hawaii, December 21, 1980

ORDINANCE NO. 565  
(Bill No. 600-1980)

AN ORDINANCE AMENDING SECTION 7.02, (THE NORTH KONA ZONE MAP), ARTICLE 2, CHAPTER 8 (ZONING CODE) OF THE HAWAII COUNTY CODE, AS AMENDED, BY CHANGING THE DISTRICT CLASSIFICATION FROM MULTIPLE FAMILY RESIDENTIAL (RM-5) TO SINGLE FAMILY RESIDENTIAL (RS-10) AT KEALAKEHE, NORTH KONA, HAWAII, COVERED BY TAX MAP KEY 7-4-17:1-7.

Date Approved: May 7, 1980  
Date Effective: May 12, 1980

Copies of the foregoing Ordinance, in full, are on file in the Office of the County Clerk for use and examination by the public.

---

I hereby certify that the foregoing Ordinance passed second and final reading at the meeting of the County Council on May 7, 1980, by the following aye and no vote:

AYES: Councilmen Dahlberg, Domingo, Fujii, Garcia, Kawahara, Lai, Sameshima, Tajiri and Chairman Yamashiro - 9.

NOES: None.

AMENDING  
SECTION 7.02  
ARTICLE 2, CHAPTER 8  
OF THE HAWAII COUNTY CODE,  
AS AMENDED, BY CHANGING THE  
DISTRICT CLASSIFICATION  
FROM MULTIPLE FAMILY  
RESIDENTIAL (RM-5) TO SINGLE  
FAMILY RESIDENTIAL (RS-10)  
AT KEALAKEHE, NORTH KONA,  
HAWAII, COVERED BY TAX MAP  
KEY 7-4-17:1-7.

Date Approved: May 7, 1980  
Date Effective: May 12, 1980  
Copies of the foregoing Ordinance,  
in full, are on file in the Office of the  
County Clerk for use and  
examination by the public.

I hereby certify that the foregoing  
Ordinance passed second and final  
reading at the meeting of the County  
Council on May 7, 1980, by the  
following aye and no vote:

AYES: Councilmen Dahlberg,  
Domingo, Fujii, Garcia, Kawahara,  
Lai, Sameshima, Tajiri and  
Chairman Yamashiro - 9.

NOES: None.

*A. B. Legaspi*  
COUNTY CLERK  
COUNTY OF HAWAII