

COUNTY OF HAWAII - STATE OF HAWAII

ORDINANCE NO. 569

AN ORDINANCE AMENDING SECTION 7.04,(THE KAILUA URBAN ZONE MAP), ARTICLE 2, CHAPTER 8 (ZONING CODE) OF THE HAWAII COUNTY CODE, AS AMENDED, BY CHANGING THE DISTRICT CLASSIFICATION FROM RESORT-HOTEL (V-1.25) TO MULTIPLE FAMILY RESIDENTIAL (RM-4) AT PUA A 2ND AND PUA A 3RD, NORTH KONA, HAWAII, COVERED BY TAX MAP KEY 7-5-10:3 AND 51.

BE IT ORDAINED BY THE COUNCIL OF THE COUNTY OF HAWAII:

SECTION 1. Section 7.04, Article 2, Chapter 8 (Zoning Code) of the Hawaii County Code, as amended, is hereby further amended by adding thereto the following subsection:

"7.04 ( t ). The district classification of the following area situated at Puaa 2nd and Puaa 3rd, North Kona, Hawaii, shall be Multiple Family Residential (RM-4):

Beginning at a pipe at the northwest corner of this parcel of land, the coordinates of said point of beginning referred to Government Survey Triangulation Station "KAHELO" being 4,595.57 feet North and 142.28 feet West and running by azimuths measured clockwise from true South:

1. 264° 27' 113.79 feet along the Land of Puaa 1st, R.P. 7845, L.C. Aw. 7715 Apana 13 to Lota Kamehameha to a pipe;
2. 268° 50' 604.00 feet along the Land of Puaa 1st, R.P. 7845, L.C. Aw. 7715 Apana 13 to Lota Kamehameha to a pipe;
3. 258° 33' 1255.65 feet along the Land of Puaa 1st, R.P. 7845, L.C. Aw. 7715 Apana 13 to Lota Kamehameha to a pipe at the southwesterly side of Hualalai Road; thence along the southwesterly side of Hualalai Road for the following eight (8) courses:
  4. 307° 17' 48.30 feet;
  5. 316° 30' 91.90 feet;
  6. 313° 45' 122.60 feet;

7.	313°	51'	176.40 feet;
8.	314°	27'	110.60 feet;
9.	305°	58'	57.60 feet;
10.	302°	59'	72.79 feet;
11.	307°	40'	531.00 feet to a "+" cut on rock; thence along the Land of Waiaha 1st, portion of R.P. 1930 to Asa Thurston on a portion of L.C. Aw. 387, Part 4, Section 2, No. 3 to American Board of Commissioners for Foreign Missions for the following seven (7) courses:
12.	88°	28'	95.35 feet to a "+" cut on rock;
13.	85°	38'	627.80 feet to a "+" cut on rock;
14.	78°	36'	269.50 feet to a "+" cut on rock;
15.	81°	26'	329.20 feet to a "+" cut on rock;
16.	89°	50'	229.50 feet to a "+" cut on rock;
17.	85°	42'	603.40 feet to a "+" cut on rock;
18.	78°	39'	419.30 feet to a "+" cut on rock;
19.	164°	48'	125.00 feet along Lot 2, Land Court Application 1659;
20.	164°	49'	175.02 feet along Lot 2 and Lot 1, Land Court Application 1659 and Lot F, portion of Grant 4037 Apana 2 to J. Kaaeamoku to a "+" cut on rock;
21.	161°	23' 30"	215.32 feet along Lot F and Lot E, portion of Grant 4037 Apana 2 to J. Kaaeamoku to a "+" cut on rock;
22.	77°	22'	115.60 feet along Lot E, portion of Grant 4037 Apana 2 to J. Kaaeamoku;
23.	74°	02' 30"	28.16 feet along Lot E, portion of Grant 4037 Apana 2 to J. Kaaeamoku;
24.	174°	27'	327.78 feet along remainder of Grant 4100 Apana 2 to Papa and Grant 7489 Apana 2 to

D.P. Waahila to the point of beginning and containing an area of 41.3720 Acres.

All as outlined in red on the map attached hereto, marked Exhibit "A" and by reference made a part hereof.

This subsection shall take effect with the conditions that (A) the petitioner or its authorized representative shall submit plans and receive final approval for the consolidation of parcels 3 and 51 within one (1) year from the effective date of the change of zone; (B) the petitioner/representative shall submit plans and secure final plan approval within one (1) year from the date of receipt of final consolidation action; (C) construction of the proposed facilities shall commence within one (1) year from the date of receipt of final plan approval and be completed within a period of five (5) years; (D) the proposed use shall be in operation within two (2) years from the initial date of construction commencement; (E) the requirements of the Department of Water Supply and the State Department of Health shall be complied with; (F) should access be provided from Kuakini Highway, a left-turn storage lane shall be constructed at the intersection with Kuakini Highway meeting with the approval of the Department of Public Works, and the State Department of Transportation, Highways Division; (G) only one (1) access point shall be provided from Hualalai Road, meeting with the approval of the Department of Public Works. Further, a 5-foot wide road widening strip shall be set aside and delineated on plans submitted for plan approval and building permit; (H) in the event that an Improvement District or other similar arrangement is proposed for the improvement of Hualalai Road the petitioner or its authorized representative shall participate in the

Improvement District; and (I) all other applicable rules, regulations, and requirements shall be complied with. Should any of the foregoing conditions not be met, rezoning of the area to its original or more appropriate zoning designation may be initiated."

SECTION 2. In the event that any portion of this ordinance is declared invalid, such invalidity shall not affect the other parts of this ordinance.

SECTION 3. This ordinance shall take effect upon its approval.

INTRODUCED BY:

Jakashi Domingos  
COUNCIL MEMBER, COUNTY OF HAWAII

Hilo, Hawaii

Date of Introduction: April 16, 1980

Date of Adoption: May 7, 1980

Effective Date: May 12, 1980

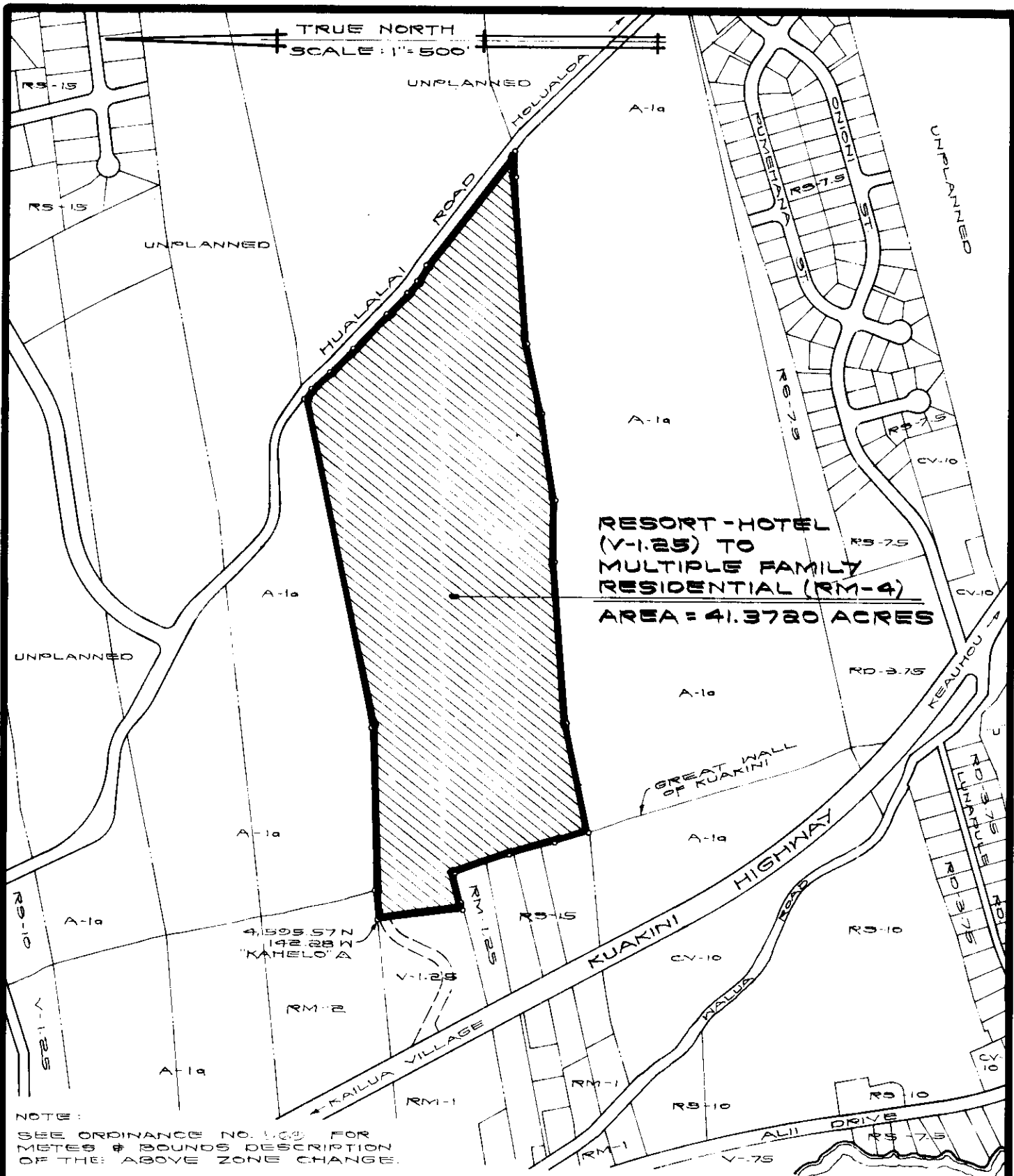

NOTE:  
 SEE ORDINANCE NO. 169, FOR  
 METES & BOUNDS DESCRIPTION  
 OF THE ABOVE ZONE CHANGE.

## AMENDMENT TO THE ZONING CODE

AMENDMENT NO. 20 TO SECTION 7.04, THE KAILUA URBAN ZONE MAP, ARTICLE 2, CHAPTER 8 (ZONING CODE) OF THE HAWAII COUNTY CODE, AS AMENDED, BY CHANGING THE DISTRICT CLASSIFICATION FROM RESORT-HOTEL (V-1.25) TO MULTIPLE FAMILY RESIDENTIAL (RM-4) AT PUA 2ND AND 3RD, NORTH KONA, HAWAII.

DATE OF PUBLIC HEARING: NOV. 15, 1979  
 EFFECTIVE DATE: MAY 12, 1980  
 ORDINANCE NUMBER: 562  
 PREPARED BY: PLANNING DEPARTMENT  
 COUNTY OF HAWAII

TMK: 7-5-10:3 & 51

JAN. 10, 1980

EXHIBIT "A"

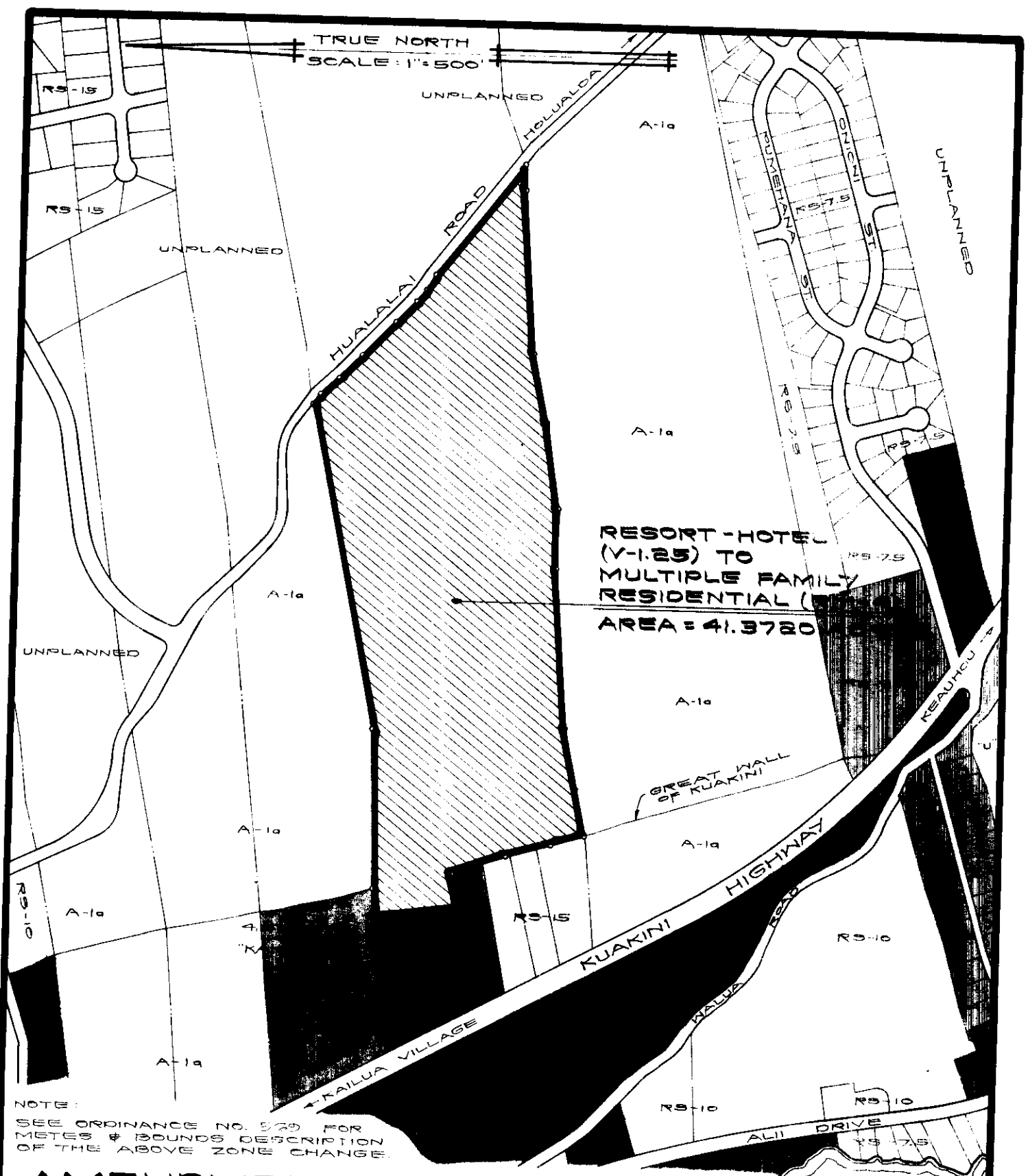

NOTE:  
 SEE ORDINANCE NO. 569 FOR  
 METES & BOUNDS DESCRIPTION  
 OF THE ABOVE ZONE CHANGE.

## AMENDMENT TO THE ZONING CODE

AMENDMENT NO. 20 TO SECTION 7.04, THE KAILUA URBAN ZONE MAP, ARTICLE 2, CHAPTER 8 (ZONING CODE) OF THE HAWAII COUNTY CODE, AS AMENDED, BY CHANGING THE DISTRICT CLASSIFICATION FROM RESORT-HOTEL (V-1.25) TO MULTIPLE FAMILY RESIDENTIAL (RM-4) AT PUA A 2ND AND 3RD, NORTH KONA, HAWAII.

DATE OF PUBLIC HEARING: NOV. 15, 1979  
 EFFECTIVE DATE: MAY 12, 1980  
 ORDINANCE NUMBER: 569  
 PREPARED BY: PLANNING DEPARTMENT  
 COUNTY OF HAWAII

TMK: 7-5-10-3 & 51

JAN. 10, 1980

EXHIBIT "A"



Hilo, Hawaii

Date: April 16, 1980

FIRST READING			
	AYES	NOES	A/E
Dahlberg	X		
Domingo	X		
Fujii	X		
Garcia	X		
Kawahara	X		
Lai	X		
Sameshima	X		
Tajiri			X
Chr. Yamashiro	X		
	8	0	1

Hilo, Hawaii

Date: May 7, 1980

SECOND & FINAL READING			
	AYES	NOES	A/E
Dahlberg	X		
Domingo	X		
Fujii	X		
Garcia	X		
Kawahara	X		
Lai	X		
Sameshima	X		
Tajiri	X		
Chr. Yamashiro	X		
	9	0	0

Publication Date: April 21, 1980

Publication Date: MAY 20 1980

We do hereby certify that the foregoing BILL was adopted by the County Council and published as indicated above.

DEPUTY COUNTY CLERK  
 Date: 9 May 80

Council Chairman  
 County Clerk

Approved/Disapproved this 12th day of May, 1980

Mayor, County of Hawaii

Bill No. 604  
 Reference: C-1508/PC-155  
 M.B. No. 569  
 Ord. No.



ORDINANCE NO. 569  
(Bill No. 604-1980)

AN ORDINANCE AMENDING SECTION 7.04, (THE KAILUA URBAN ZONE MAP), ARTICLE 2, CHAPTER 8 (ZONING CODE) OF THE HAWAII COUNTY CODE, AS AMENDED, BY CHANGING THE DISTRICT CLASSIFICATION FROM RESORT-HOTEL (V-1.25) TO MULTIPLE FAMILY RESIDENTIAL (RM-4) AT PUA A 2ND AND PUA A 3RD, NORTH KONA, HAWAII, COVERED BY TAX MAP KEY 7-5-10:3 AND 51.

Date Approved: May 7, 1980  
Date Effective: May 12, 1980

Copies of the foregoing Ordinance, in full, are on file in the Office of the County Clerk for use and examination by the public.

---

I hereby certify that the foregoing Ordinance passed second and final reading at the meeting of the County Council on May 7, 1980, by the following aye and no vote:

AYES: Councilmen Dahlberg, Domingo, Fujii, Garcia, Kawahara, Lai, Sameshima, Tajiri and Chairman Yamashiro - 9.

NOES: None.

*R. B. Leysopi*  
COUNTY CLERK  
COUNTY OF HAWAII

RECORDING OFFICE  
HAWAII COUNTY DEPARTMENT OF PUBLIC WORKS  
COUNTY CLERK'S OFFICE  
COUNTY OF HAWAII  
150 SOUTH KALANIANA'OHU AVENUE  
HONOLULU, HAWAII 96813  
TELEPHONE: 535-2100  
FAX: 535-2100  
MAY 20 1980

Bill No. 604 - 1980

AN ORDINANCE AMENDING SECTION 7.04, (THE KAILUA URBAN ZONE MAP), ARTICLE 2, CHAPTER 8 (ZONING CODE) OF THE HAWAII COUNTY CODE, AS AMENDED, BY CHANGING THE DISTRICT CLASSIFICATION FROM RESORT-HOTEL (V-1.25) TO MULTIPLE FAMILY RESIDENTIAL (RM-4) AT PUA A 2ND AND PUA A 3RD, NORTH KONA, HAWAII, COVERED BY TAX MAP KEY 7-5-10:3 AND 51.

This Bill amends The Kailua Urban Zone Map, as amended, by changing the district classification from Resort-Hotel (V-1.25) to Multiple Family Residential (RM-4) at Puaa 2nd and Puaa 3rd, N. Kona.

Date Introduced: April 16, 1980

Copies of the foregoing Bill, in full, are on file in the Office of the County Clerk for use and examination by the public.

---

I hereby certify that the foregoing Bill passed first reading at the meeting of the County Council on April 16, 1980, by the following ye and no vote:

AYES: Councilmen Dahlberg, Domingo, Fujii, Garcia, Kawahara, Lai, Sameshima and Chairman Yamashiro - 8.

NOES: None.

ABSENT & EXCUSED: Councilman Tajiri - 1.

*R. B. Leppard*  
COUNTY CLERK  
COUNTY OF HAWAII

AN ORDINANCE AMENDING SECTION 7.04, (THE KAILUA URBAN ZONE MAP), ARTICLE 2, CHAPTER 8 (ZONING CODE) OF THE HAWAII COUNTY CODE, AS AMENDED, BY CHANGING THE DISTRICT CLASSIFICATION FROM RESORT-HOTEL (V-1.25) TO MULTIPLE FAMILY RESIDENTIAL (RM-4) AT PUA A 2ND AND PUA A 3RD, NORTH KONA, HAWAII, COVERED BY TAX MAP KEY 7-5-10:3 AND 51.

This Bill amends The Kailua Urban Zone Map, as amended, by changing the district classification from Resort-Hotel (V-1.25) to Multiple Family Residential (RM-4) at Puaa 2nd and Puaa 3rd, N. Kona.  
Date Introduced: April 16, 1980.

Copies of the foregoing Bill, in full, are on file in the Office of the County Clerk for use and examination by the public.

I hereby certify that the foregoing Bill passed first reading at the meeting of the County Council on April 16, 1980, by the following ye and no vote:

AYES: Councilmen Dahlberg, Domingo, Fujii, Garcia, Kawahara, Lai, Sameshima and Chairman Yamashiro - 8.

NOES: None.

ABSENT & EXCUSED: Councilman Tajiri - 1.

R. B. Leppard  
County Clerk  
County of Hawaii