

COUNTY OF HAWAII - STATE OF HAWAII

ORDINANCE NO. 619

AN ORDINANCE AMENDING SECTION 7.06, THE NORTH AND SOUTH KOHALA DISTRICTS ZONE MAP, ARTICLE 2, CHAPTER 8 (ZONING CODE) OF THE HAWAII COUNTY CODE, AS AMENDED, BY CHANGING THE DISTRICT CLASSIFICATION FROM AGRICULTURAL (A-20a) TO AGRICULTURAL (A-5a) AT KAAUHUU, NORTH KOHALA, HAWAII, COVERED BY TAX MAP KEY 5-5-01:29.

BE IT ORDAINED BY THE COUNCIL OF THE COUNTY OF HAWAII:

SECTION 1. Section 7.06, Article 2, Chapter 8 (Zoning Code) of the Hawaii County Code, as amended, is hereby further amended by adding thereto the following subsection:

"7.06 ( v ). The district classification of the following area situated at Kaauhuhu, North Kohala, Hawaii, shall be Agricultural (A-5a):

Beginning at the North corner of this parcel of land on the Westerly side of Kaauhuhu Road, the coordinates of which referred to Government Survey Triangulation Station "PUU O NALE" being 5937.34 feet North and 5619.60 feet East and running by azimuths measured clockwise from true South:

Along the Westerly side of Kaauhuhu Road, on a curve to the left with a radius of 207.90 feet, the chord azimuth and distance being:

1. 343° 22' 41" 35.48 feet;
2. 338° 29' 256.00 feet along the Westerly side of Kaauhuhu Road;

thence along the Westerly side of Kaauhuhu Road, on a curve to the right with a radius of 697.42 feet, the chord azimuth and distance being:

3. 341° 29' 73.00 feet;

4. 344° 29' 35.00 feet along the Westerly side of Kaauhuhu Road;
- thence along the Westerly side of Kaauhuhu Road, on a curve to the right with a radius of 91.49 feet, the chord azimuth and distance being:
5. 1° 29' 53.50 feet;
6. 18° 29' 319.00 feet along the Westerly side of Kaauhuhu Road;
- thence along the Westerly side of Kaauhuhu Road, on a curve to the left with a radius of 177.00 feet, the chord azimuth and distance being;
7. 2° 55' 95.00 feet;
8. 347° 21' 219.00 feet along the Westerly side of Kaauhuhu Road;
- thence along the Westerly side of Kaauhuhu Road, on a curve to the right with a radius of 46.32 feet, the chord azimuth and distance being:
9. 20° 23' 50.50 feet;
10. 53° 25' 233.18 feet along the Northwesterly side of Kynnersly Road;
11. 139° 16' 815.18 feet along Grant 7455 to K. K. Hall;
12. 268° 30' 81.00 feet along Lot 5 of Bush-Richards Subdivision, File Plan 535;
13. 223° 40' 838.00 feet along Lot 5 of Bush-Richards Subdivision, File Plan 535 and Grant 10036 to Robert McCorrison to the point of beginning and containing an area of 11.290 acres.

"All as outlined in red on the map attached hereto, marked Exhibit 'A' and by reference made a part hereof."

"This ordinance shall take effect forthwith upon the conditions: (A) That the petitioner, or his authorized representative, shall submit the subdivision plans to the Planning Department and receive tentative approval within one (1) year from the effective date of approval of the change of zone. The petitioner/representative shall also be responsible for securing final subdivision approval within one (1) year from the date of receipt of tentative approval; (B) That at least fifty (50) percent of one (1) of the proposed lots shall be put into agricultural production within three (3) years from the date of receipt of final subdivision approval. Agricultural production is defined as the actual use of the land for agricultural purposes, and in accordance with Chapter 205 of the Hawaii Revised Statutes; (C) That the rules, regulations and requirements of the Department of Water Supply shall be complied with; and (D) That all other applicable rules, regulations and requirements shall be complied with. Should any of the foregoing conditions not be met, rezoning of the area to its original or more appropriate zoning designation may be initiated."

SECTION 2. In the event that any portion of this ordinance is declared invalid, such invalidity shall not affect the other parts of this ordinance.

SECTION 3. This ordinance shall take effect upon its approval.

INTRODUCED BY:

*Jesse Roming*

COUNCIL MEMBER, COUNTY OF HAWAII

Hilo, Hawaii

Date of Introduction: August 20, 1980

Date of Adoption: September 3, 1980

Effective Date: September 11, 1980

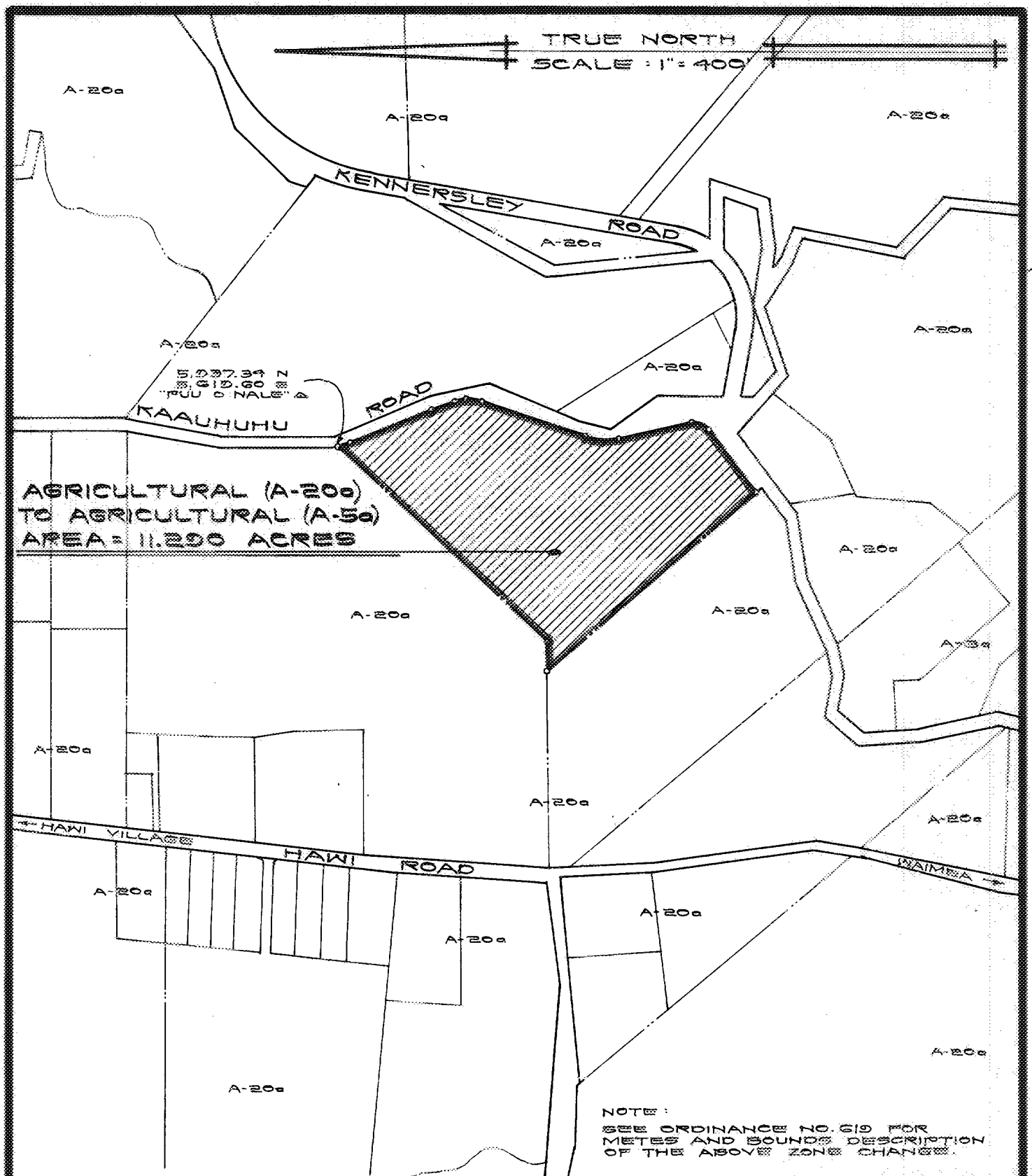

## AMENDMENT TO THE ZONING CODE

AMENDMENT NO. 22 TO SECTION 7.06, THE NORTH AND SOUTH KOHALA DISTRICTS ZONE MAP, ARTICLE 2, CHAPTER 8, (ZONING CODE) OF THE HAWAII COUNTY CODE, AS AMENDED, BY CHANGING THE DISTRICT CLASSIFICATION FROM AGRICULTURAL (A-20a) TO AGRICULTURAL (A-5a) AT KAAUNAHU, NORTH KOHALA, HAWAII.

DATE OF PUBLIC HEARING: OCT. 11, 1979  
EFFECTIVE DATE: SEPT. 11, 1980  
ORDINANCE NUMBER: 619  
PREPARED BY: PLANNING DEPARTMENT  
COUNTY OF HAWAII

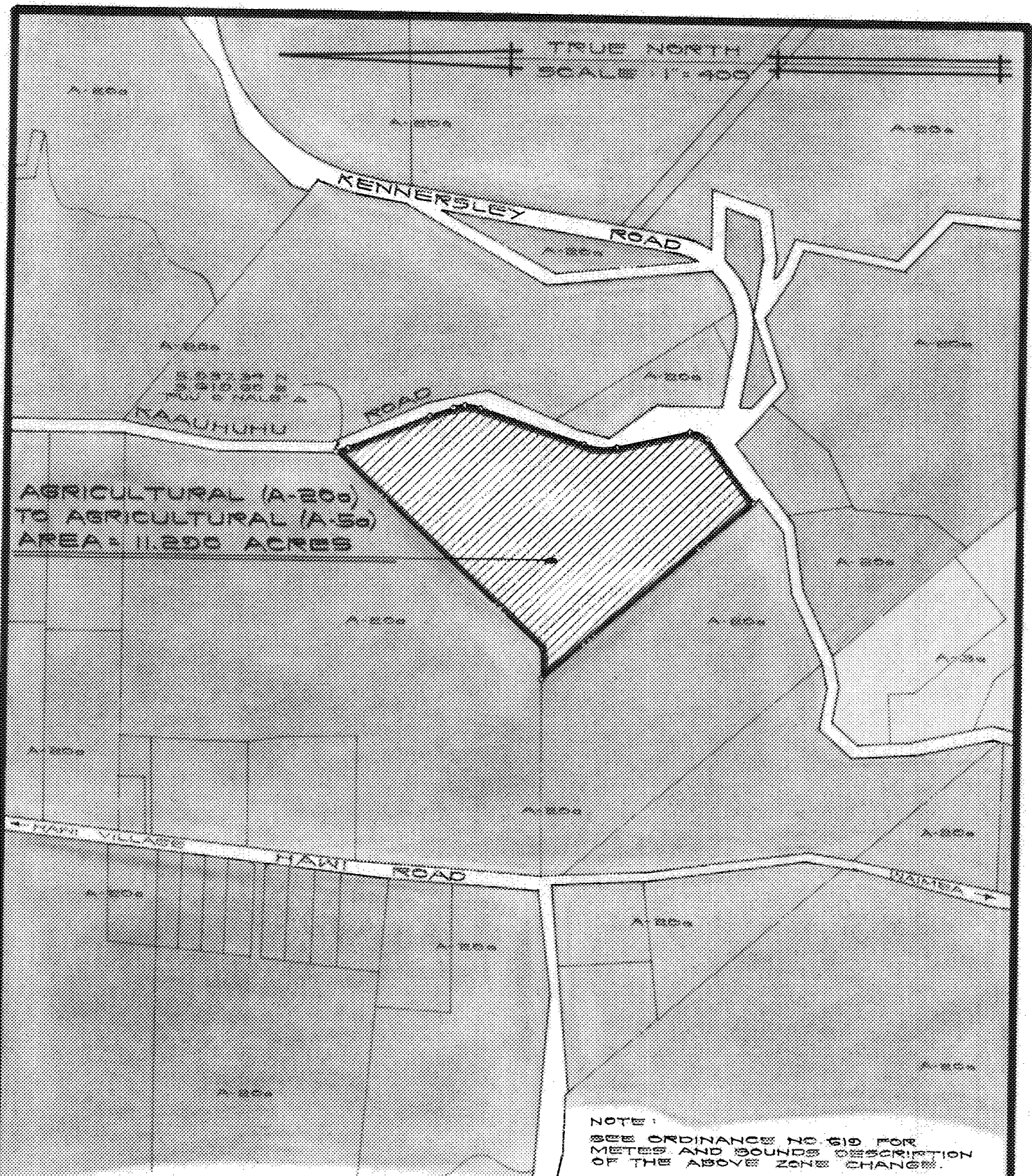

## AMENDMENT TO THE ZONING CODE

AMENDMENT NO. 22 TO SECTION 7.06, THE NORTH AND SOUTH KOHALA DISTRICTS ZONE MAP, ARTICLE 2, CHAPTER 5, (ZONING CODE) OF THE HAWAII COUNTY CODE, AS AMENDED, BY CHANGING THE DISTRICT CLASSIFICATION FROM AGRICULTURAL (A-200) TO AGRICULTURAL (A-50) AT KAAHUHU, NORTH KOHALA, HAWAII.

DATE OF PUBLIC HEARING : OCT. 11, 1979  
EFFECTIVE DATE : SEPT. 11, 1980  
ORDINANCE NUMBER : 619  
PREPARED BY : PLANNING DEPARTMENT  
COUNTY OF HAWAII

TMK : 5-5-01-29

OCT. 4, 1979

EXHIBIT "A"

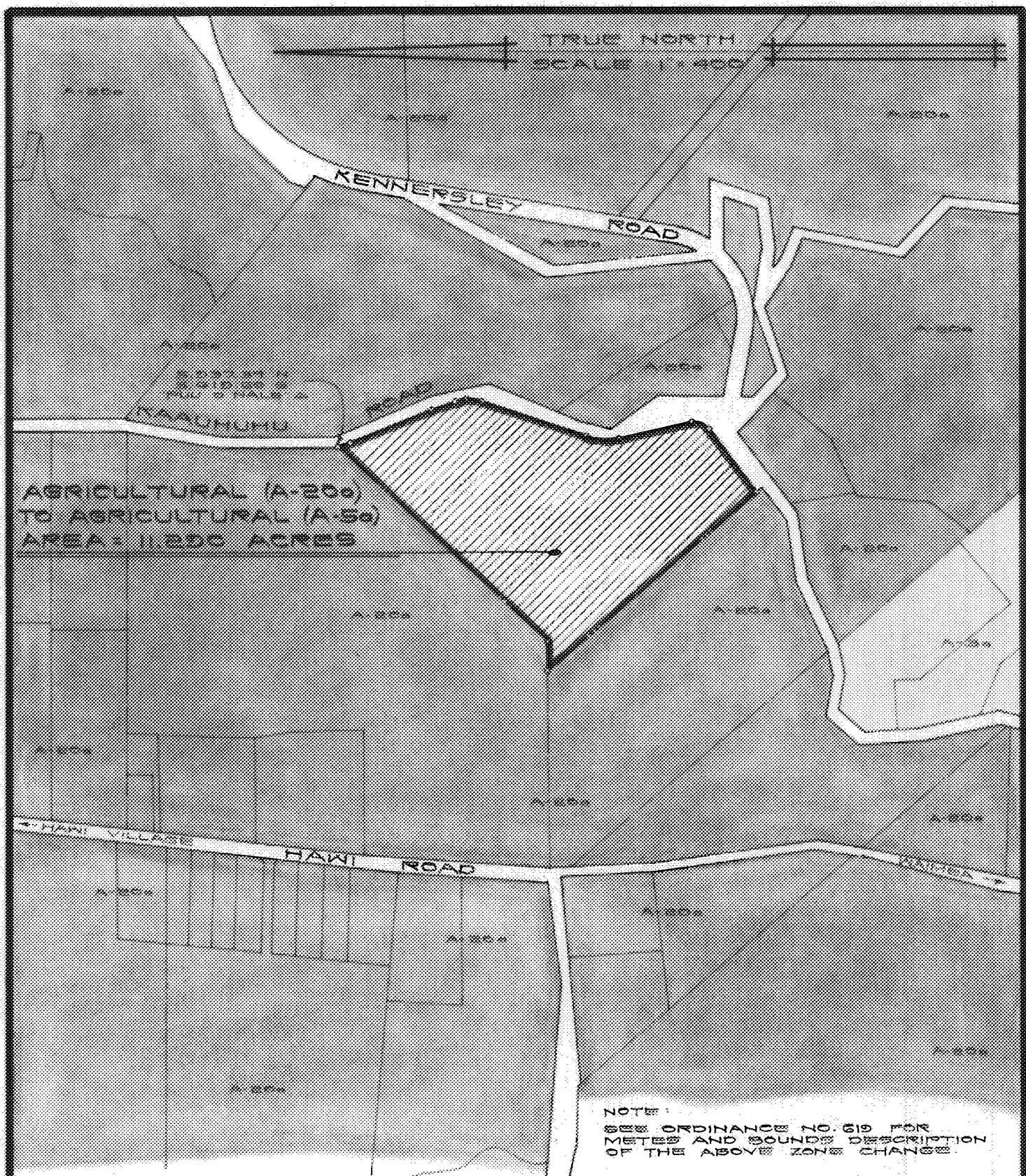

## AMENDMENT TO THE ZONING CODE

AMENDMENT NO. 22 TO SECTION 7.06, THE NORTH AND SOUTH KOHALA DISTRICTS ZONE MAP, ARTICLE 2, CHAPTER 8, (ZONING CODE) OF THE HAWAII COUNTY CODE, AS AMENDED, BY CHANGING THE DISTRICT CLASSIFICATION FROM AGRICULTURAL (A-20a) TO AGRICULTURAL (A-5a) AT KAAUNUU, NORTH KOHALA, HAWAII.

DATE OF PUBLIC HEARING : OCT. 11, 1979  
EFFECTIVE DATE : SEPT. 11, 1980  
ORDINANCE NUMBER : 619  
PREPARED BY : PLANNING DEPARTMENT  
COUNTY OF HAWAII

Hilo, Hawaii  
Date: August 20, 1980

FIRST READING			
	AYES	NOES	A/E
Dahlberg	X		
Domingo	X		
Fujii	X		
Garcia	X		
Kawahara	X		
Lai	X		
Sameshima	X		
Tajiri	X		
Chr. Yamashiro	X		
	9	0	0

AUG 26 1980

Publication Date: \_\_\_\_\_

Hilo, Hawaii  
Date: September 3, 1980

SECOND & FINAL READING			
	AYES	NOES	A/E
Dahlberg	X		
Domingo	X		
Fujii	X		
Garcia	X		
Kawahara	X		
Lai	X		
Sameshima	X		
Tajiri			X
Chr. Yamashiro	X		
	8	0	1

SEP 17 1980

Publication Date: \_\_\_\_\_

We do hereby certify that the foregoing BILL was adopted by the County Council and published as indicated above.

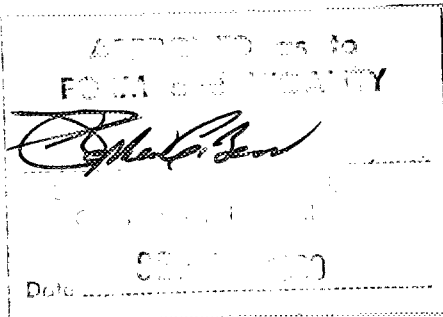

*Chris Yamashiro*  
Council Chairman

*R. J. Legorpi*  
County Clerk

Approved/Disapproved this 17th day of  
September, 1980

*John H. Kamehaha*  
Mayor, County of Hawaii

Bill No. 648  
Reference: C-1598/PC-179  
M.B. No. \_\_\_\_\_  
Ord. No. 619