

COUNTY OF HAWAII - STATE OF HAWAII

ORDINANCE NO. 638

AN ORDINANCE AMENDING SECTION 7.03 (THE SOUTH KONA ZONE MAP), ARTICLE 2, CHAPTER 8 (ZONING CODE) OF THE HAWAII COUNTY CODE, AS AMENDED, BY CHANGING THE DISTRICT CLASSIFICATION FROM SINGLE FAMILY RESIDENTIAL (RS-15) TO SINGLE FAMILY RESIDENTIAL (RS-10) AT ONOULI 2ND, SOUTH KONA, HAWAII, COVERED BY TAX MAP KEY 8-1-07:38.

BE IT ORDAINED BY THE COUNCIL OF THE COUNTY OF HAWAII:

SECTION 1. Section 7.03, Article 2, Chapter 8 (Zoning Code), of the Hawaii County Code, as amended, is further amended to add a new subsection to read as follows:

"7.03 (cc). The district classification of the following area situated at Onouli 2nd, South Kona, Hawaii, shall be Single Family Residential (RS-10):

Beginning at a pipe in concrete at the Northeast corner of this parcel of land, and on the Westerly side of Remnant of the old road, the coordinates of said point of beginning referred to Government Survey Triangulation Station "PUU OHAU" being 2,647.63 feet South and 11,178.35 feet East, and thence running by azimuths measured clockwise from True South:

1. 354° 25' 30" 51.00 feet along Remnant of the old road to a pipe in concrete;

Thence along the Westerly side of Hawaii Belt Road (Mamalahoa Highway) on a 3,849.83 foot radius curve to the left, the chord azimuth and distance being:
2. 0° 28' 05" 81.93 feet;
3. 359° 51' 30" 61.32 feet along the Westerly side of Hawaii Belt Road (Mamalahoa Highway) to a pipe in concrete;

Thence along stonewall, along remainder of Grant 1162 to F. O. Schulze for the following six (6) courses:

- | | | |
|----|-------------|---|
| 4. | 76° 37' | 76.57 feet to a pipe in concrete; |
| 5. | 36° 36' 30" | 47.30 feet to a pipe in concrete; |
| 6. | 79° 27' | 78.80 feet to a pipe in concrete; |
| 7. | 136° 02' | 64.97 feet to a pipe in concrete; |
| 8. | 173° 25' | 154.04 feet to a pipe in concrete; |
| 9. | 254° 54' | 247.03 feet to the point of
beginning and containing
an area of 1.0811 Acres. |

All as outlined in red on the map attached hereto, marked Exhibit "A" and by reference made a part hereof.

This subsection shall take effect upon the conditions that (A) the petitioner or his authorized representative shall submit a subdivision plan and secure tentative approval within one (1) year from the effective date of the change of zone. The petitioner/representative shall also be responsible for securing final subdivision approval within one (1) year from the date of receipt of tentative subdivision approval; (B) a minimum of two (2) single family dwellings shall be constructed on two (2) of the proposed lots within three (3) years from the date of receipt of final subdivision approval; (C) the petitioner/representative shall resolve the drainage situations with the Department of Public Works prior to issuance of final subdivision approval; (D) access to the proposed lots shall be from the interior subdivision roadway. No direct access to the lots shall be permitted from Mamalahoa Highway. Further, the slope or grade of the subdivision roadway shall meet with the requirements of the Department of Public Works; and (F) all other applicable rules, regulations, and requirements shall be complied with. Should any of the foregoing conditions not be met, rezoning of the area to its original or more appropriate zoning designation may be initiated."

SECTION 2. In the event that any portion of this ordinance is declared invalid, such invalidity shall not affect the other parts of this ordinance.

SECTION 3. This ordinance shall take effect upon its approval.

INTRODUCED BY:

Jerashy Dowling
COUNCIL MEMBER, COUNTY OF HAWAII

Hilo, Hawaii

Date of Introduction: September 17, 1980

Date of Adoption: October 1, 1980

Effective Date: October 6, 1980

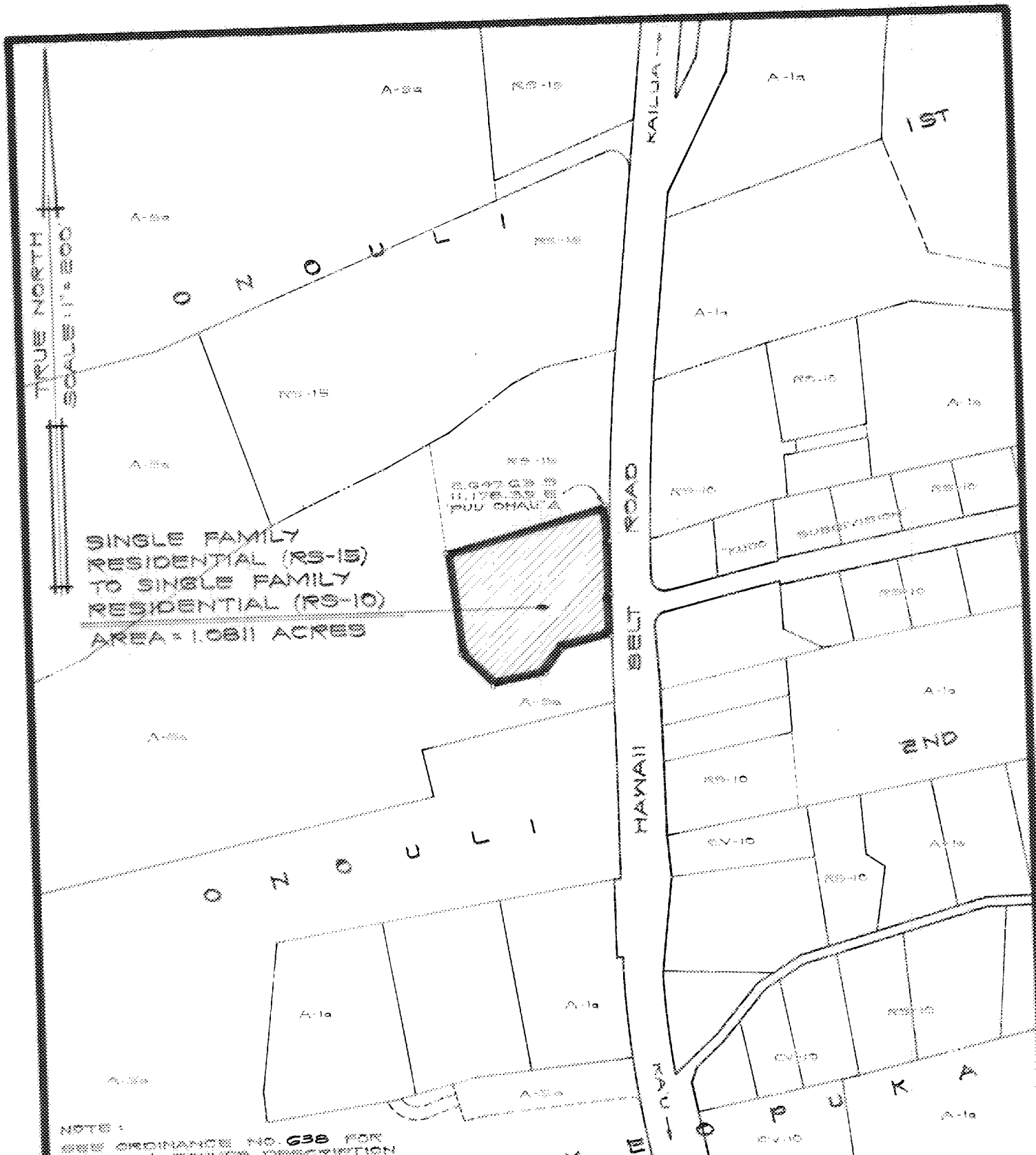

SINGLE FAMILY
RESIDENTIAL (RS-15)
TO SINGLE FAMILY
RESIDENTIAL (RS-10)
AREA = 1.0811 ACRES

NOTE:
SEE ORDINANCE NO. 638 FOR
METES & BOUNDS DESCRIPTION
OF THE ABOVE ZONE CHANGE.

AMENDMENT TO THE ZONING CODE

AMENDMENT NO. 29 TO SECTION 703 (THE SOUTH KONA
ZONE MAP) ARTICLE 2, CHAPTER 8 (ZONING CODE) OF THE
HAWAII COUNTY CODE, AS AMENDED, BY CHANGING THE
DISTRICT CLASSIFICATION FROM SINGLE FAMILY RESI-
DENTIAL (RS-15) TO SINGLE FAMILY RESIDENTIAL (RS-10)
AT ONOULI 2ND, SOUTH KONA, HAWAII.

DATE OF PUBLIC HEARING: JULY 16, 1980
EFFECTIVE DATE: OCT. 6, 1980
ORDINANCE NUMBER: 638
PREPARED BY: PLANNING DEPARTMENT
COUNTY OF HAWAII

AUG. 10, 1980

TMK: 2-1-07-36

EXHIBIT A

Hilo, Hawaii
Date: September 17, 1980

FIRST READING			
	AYES	NOES	A/E
Dahlberg			X
Domingo	X		
Fujii	X		
Garcia	X		
Kawahara	X		
Lai	X		
Sameshima	X		
Tajiri	X		
Chr. Yamashiro	X		
	8	0	1

Hilo, Hawaii
Date: October 1, 1980

SECOND & FINAL READING			
	AYES	NOES	A/E
Dahlberg	X		
Domingo	X		
Fujii	X		
Garcia	X		
Kawahara	X		
Lai	X		
Sameshima	X		
Tajiri	X		
Chr. Yamashiro			X
	8	0	1

Publication Date: SEP 21 1980

Publication Date: OCT 15 1980

We do hereby certify that the foregoing BILL was adopted by the County Council and published as indicated above.

APPROVED as to
FORM AND CONTENT
Acting
Steph Jones
Date 10/2/80

Joseph R. Garcia Jr.
(Acting) Council Chairman

R. B. Leyspi
County Clerk

Approved/Disapproved this 6th day of
October, 1980

Herb Matsuyoshi
Mayor, County of Hawaii

Bill No. 676
Reference: C-1662/PC-184
M.B. No. _____
Ord. No. 638