

COUNTY OF HAWAII - STATE OF HAWAII

ORDINANCE NO. 685

AN ORDINANCE AMENDING SECTION 7.23 (THE KALAPANA-KAIMU ZONE MAP), ARTICLE 2, CHAPTER 8 (ZONING CODE) OF THE HAWAII COUNTY CODE, AS AMENDED, BY CHANGING THE DISTRICT CLASSIFICATION FROM RESIDENTIAL AGRICULTURAL (RA-.5a) TO SINGLE FAMILY RESIDENTIAL (RS-10) AT KAIMU, PUNA, HAWAII, COVERED BY TAX MAP KEY 1-2-04:39.

BE IT ORDAINED BY THE COUNCIL OF THE COUNTY OF HAWAII:

SECTION 1. Section 7.23, Article 2, Chapter 8, (Zoning Code), of the Hawaii County Code, as amended, is further amended to add a new subsection, to read as follows:

"7.23 (b). The district classification of the following area situated at Kaimu, Puna, Hawaii, shall be Single Family Residential (RS-10):

Beginning at a point at the westerly corner of this parcel of land, the coordinates of said point of beginning referred to Government Survey Triangulation Station "HAKUMA (HTS)" being 5,536.91 feet North and 3,162.76 feet East and running by azimuths measured clockwise from True South:

1. 240° 04' 12" 160.00 feet along Lot 40-B, remainder of Grant 5058 to S.W. Waiiau;
2. 327° 50' 299.99 feet along Grant 9758 to a point at the northwesterly side of Government Road; thence along the northwesterly side of Government Road along a curve to the right having a radius of 548.69 feet, the chord azimuth and distance being:
3. 56° 52' 41" 139.90 feet; thence along the northwesterly side of Government Road along a curve to the right having a radius of 548.69 feet, the chord azimuth and distance being:
4. 65° 15' 19" 20.17 feet;

5. 147° 50' 305.96 feet along Lot 40-B, remainder of Grant 5058 to S.W. Waiiau to the point of beginning and containing an area of 1.126 Acres.

All as outlined in red on the map attached hereto, marked Exhibit "A" and by reference made a part hereof.

This subsection is conditioned upon the following:

(A) that the petitioner shall be responsible for complying with all of the stated conditions of approval; (B) that a subdivision plan shall be submitted and tentative approval secured within one (1) year from the effective date of the change of zone. Final subdivision approval shall be secured within one (1) year from the effective date of tentative subdivision approval; (C) that access to all four (4) lots be provided via a single access off of the Kaimu road; and (D) that all other applicable rules, regulations, and requirements including, the Special Management Area Rules and Regulations, be complied with. Should any of the foregoing conditions not be met, rezoning of the area to its original or more appropriate zoning designation may be initiated."

SECTION 2. In the event that any portion of this ordinance is declared invalid, such invalidity shall not affect the other parts of this ordinance.

SECTION 3. This ordinance shall take effect upon its approval.

INTRODUCED BY:



COUNCIL MEMBER, COUNTY OF HAWAII

Hilo, Hawaii

Date of Introduction: March 18, 1981

Date of Adoption: April 1, 1981

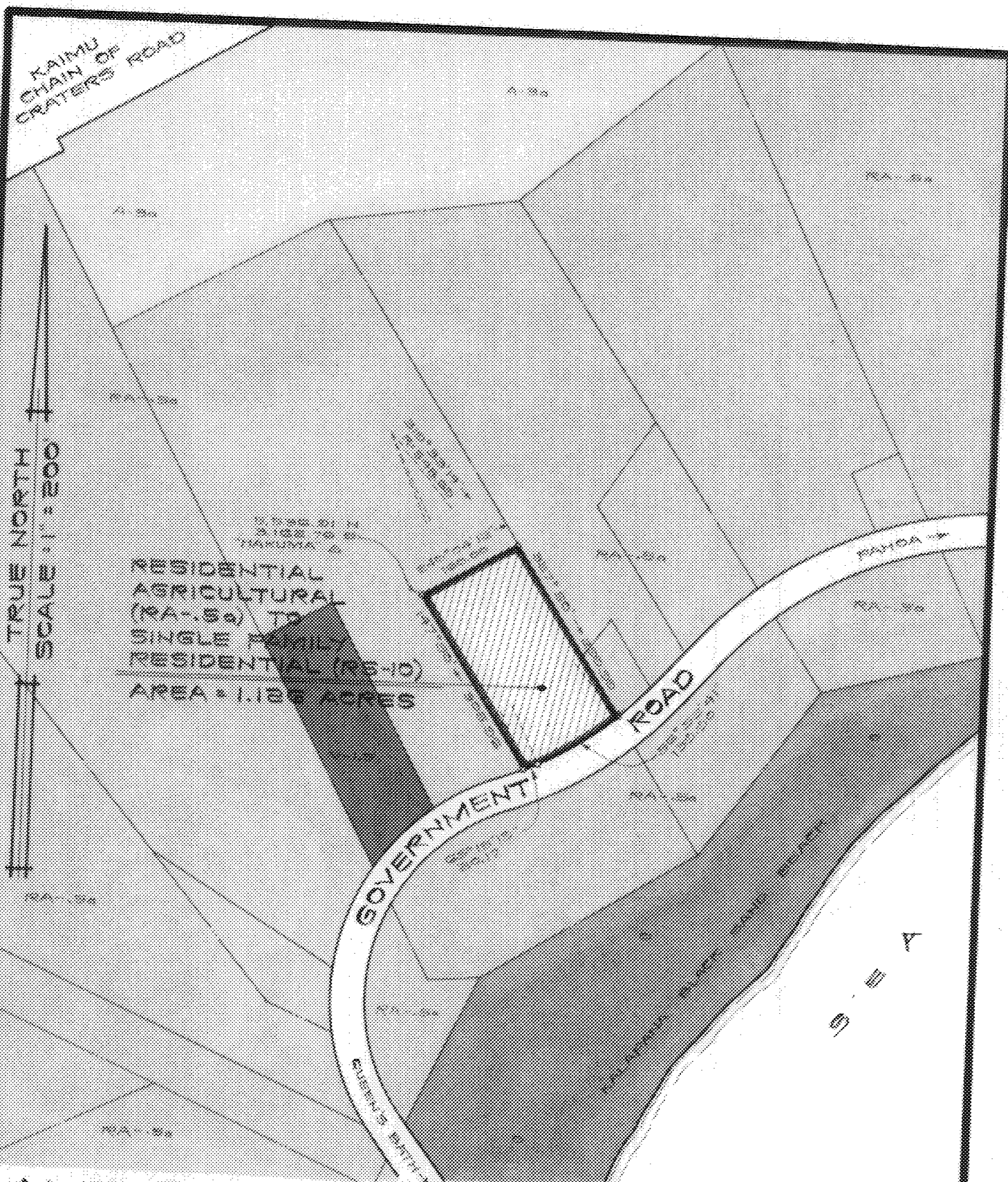
Effective Date: April 10, 1981



AMENDMENT TO THE ZONING CODE

AMENDMENT NO. 2 TO SECTION 7.23 (THE KALAPANA-KAIMU ZONE MAP) ARTICLE 2, CHAPTER 8 (ZONING CODE) OF THE HAWAII COUNTY CODE, AS AMENDED, BY CHANGING THE DISTRICT CLASSIFICATION FROM RESIDENTIAL AGRICULTURAL (RA-50) TO SINGLE FAMILY RESIDENTIAL (RS-10) AT KAIMU, PUNA, HAWAII.

DATE OF PUBLIC HEARING : FEB. 26, 1981
EFFECTIVE DATE : APRIL 10, 1981
ORDINANCE NUMBER : 685
PREPARED BY : PLANNING DEPARTMENT
COUNTY OF HAWAII

TMK: 1-2-04:39

EXHIBIT "A"

FEB. 11, 1981

Hilo, Hawaii
Date: March 18, 1981

FIRST READING			
	AYES	NOES	A/E
Dahlberg	X		
De Luz	X		
Domingo	X		
Fujii	X		
Hale	X		
Kawahara	X		
Lai	X		
Schutte	X		
Chr. Yamashiro	X		
	9	0	0

Publication Date: MAR 23 1981

Kailua-Kona, Hawaii
Date: April 1, 1981

SECOND & FINAL READING			
	AYES	NOES	A/E
Dahlberg	X		
De Luz	X		
Domingo	X		
Fujii	X		
Hale	X		
Kawahara	X		
Lai	X		
Schutte	X		
Chr. Yamashiro	X		
	9	0	0

Publication Date: APR 17 1981

We do hereby certify that the foregoing BILL was adopted by the County Council and published as indicated above.

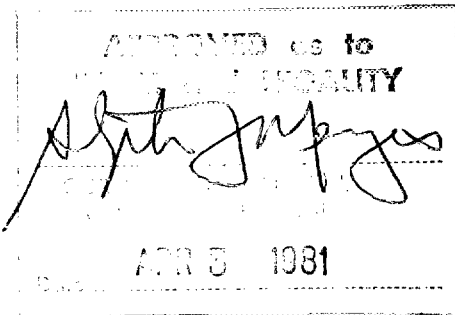

Heath Yamashiro
Council Chairman

R. B. Leysen
County Clerk

Approved/~~Disapproved~~ this 10th day of April, 1981.

Heath Yamashiro
Mayor, County of Hawaii

Bill No. 726

Reference: C-159/PC-22

M.B. No. _____

Ord. No. 685