

COUNTY OF HAWAII - STATE OF HAWAII

ORDINANCE NO. 756

AN ORDINANCE AMENDING SECTION 7.02 (THE NORTH KONA ZONE MAP), ARTICLE 2, CHAPTER 8 (ZONING CODE) OF THE HAWAII COUNTY CODE, AS AMENDED, BY CHANGING THE DISTRICT CLASSIFICATION FROM SINGLE FAMILY RESIDENTIAL (RS-10) TO SINGLE FAMILY RESIDENTIAL (RS-7.5) AT KEALAKEHE, NORTH KONA, HAWAII, COVERED BY TAX MAP KEY 7-4-14:103.

BE IT ORDAINED BY THE COUNCIL OF THE COUNTY OF HAWAII:

SECTION 1. Section 7.02, Article 2, Chapter 8 (Zoning Code), of the Hawaii County Code, as amended, is further amended to add a new subsection, to read as follows:

"7.02 (eee). The district classification of the following area situated at Kealakehe, North Kona, Hawaii, shall be Single Family Residential (RS-7.5):

Beginning at the south corner of this parcel of land, being the east corner of Lot A-2(2), and on the northwesterly side of Palani Road, the coordinates of said point of beginning referred to Government Survey Triangulation Station "KEAHUOLU" being 6,762.90 feet North and 15,308.08 feet East, thence running by azimuths measured clockwise from True South:

1. 109° 26' 74.32 feet along Lot A-2(2);
2. 204° 33' 64.69 feet along Lot 21 of Kona Macadamia Acres, File Plan Number 1414;
3. 179° 56' 30" 133.29 feet along Lot 21 and Lot 22 of Kona Macadamia Acres, File Plan Number 1414;
4. 287° 41' 140.04 feet along Lot A-1;
5. Thence along Palani Road, on a curve to the left with a radius of 714.50 feet, the chord azimuth and distance being: 27° 19' 30" 196.20 feet to the point of beginning and containing an area of 17,926 Square Feet.

All as outlined in red on the map attached hereto, marked Exhibit "A" and by reference made a part hereof.

This subsection is conditioned upon the following:

(A) that the petitioner or his authorized representative submit a subdivision plan and secure tentative approval within one (1) year from the effective date of the change zone. The petitioner/representative shall also be responsible for securing final subdivision approval within one (1) year from the date of receipt of tentative subdivision approval; (B) that a 10-foot wide road widening easement be delineated along Palani Road. The structural setbacks will be taken from this easement; (C) that a single family dwelling shall be constructed on one (1) of the lots within three (3) years from the date of final subdivision approval; (D) that no variances, i.e. setback, etc., shall be applied for any of the proposed lots; (E) that there shall be only one access for the two lots from Palani Road; (F) that all water runoff generated by the proposed development shall be disposed of by a drainage system acceptable to the Department of Public Works; and ~~[(F)]~~ (G) that all other applicable rules, regulations and requirements shall be complied with. Should any of the foregoing conditions not be met, rezoning of the area to its original or more appropriate zoning designation may be initiated."

SECTION 2. Material to be repealed is bracketed. New material is underscored. In printing this ordinance, the brackets, bracketed material, and underscoring need not be included.

SECTION ~~[2.]~~ 3. In the event that any portion of this ordinance is declared invalid, such invalidity shall not affect the other parts of this ordinance.

SECTION ~~[3.]~~ 4. This ordinance shall take effect upon its approval.

INTRODUCED BY:



COUNCIL MEMBER, COUNTY OF HAWAII

Hilo, Hawaii

Date of Introduction: January 19, 1982

Date of Adoption: February 3, 1982

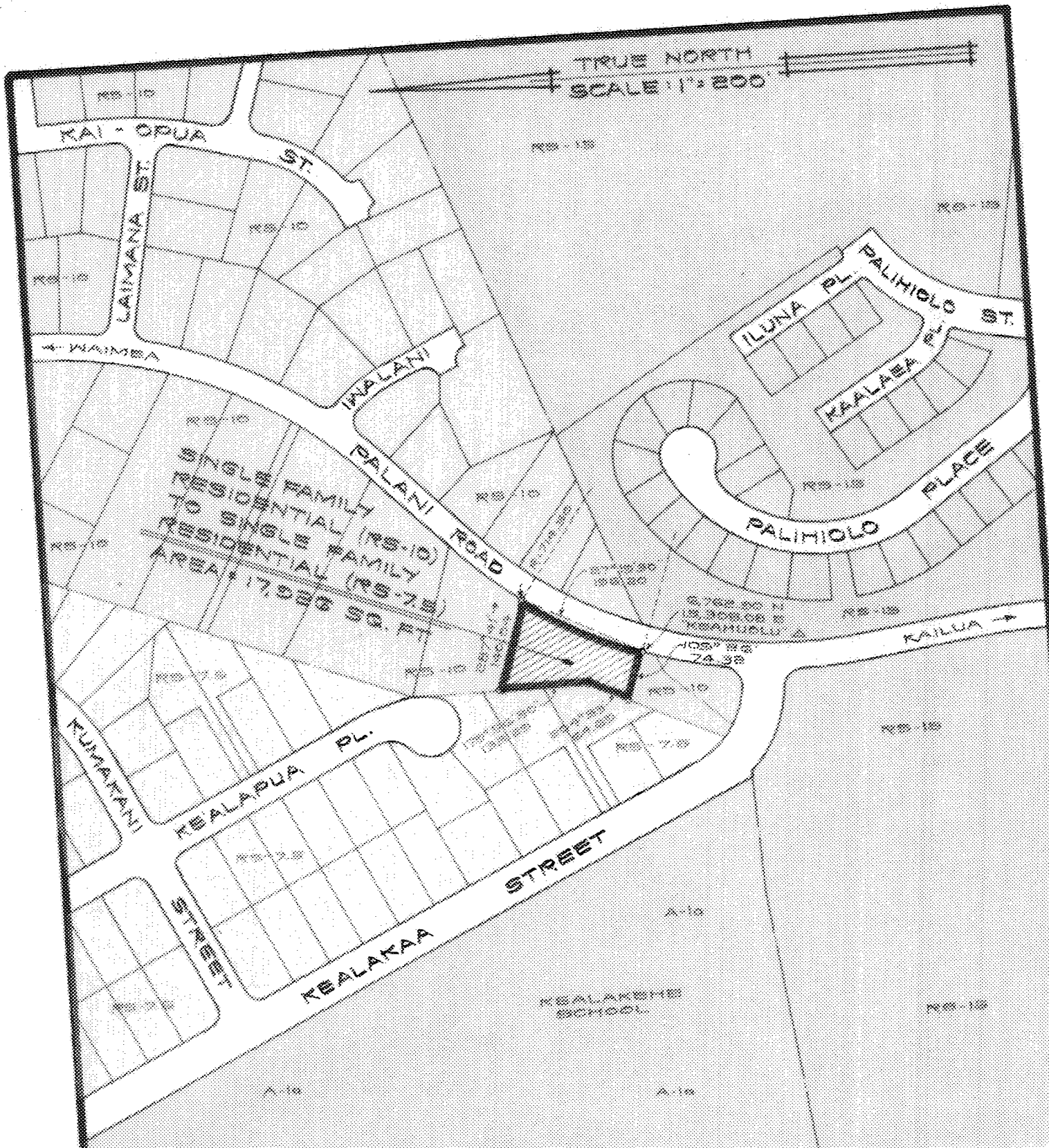
Effective Date: February 9, 1982



AMENDMENT TO THE ZONING CODE

AMENDMENT NO. 57 TO SECTION 7.02 (THE NORTH KONA ZONE MAP) ARTICLE 8, CHAPTER 8 (ZONING CODE) OF THE HAWAII COUNTY CODE, AS AMENDED, BY CHANGING THE DISTRICT CLASSIFICATION FROM SINGLE FAMILY RESIDENTIAL (RS-10) TO SINGLE FAMILY RESIDENTIAL (RS-7S) AT KEALAKAHE, NORTH KONA, HAWAII.

DATE OF PUBLIC HEARING : OCT. 30, 1980
EFFECTIVE DATE : FEB. 9, 1982
ORDINANCE NUMBER : 756
PREPARED BY : PLANNING DEPARTMENT
COUNTY OF HAWAII

NOV. 27, 1981

TMK : 7-4-14 : 103

EXHIBIT "A"

Hilo, Hawaii
Date: January 19, 1982

FIRST READING			
	AYES	NOES	A/E
Dahlberg			X
De Luz	X		
Domingo	X		
Fujii	X		
Hale	X		
Kawahara			X
Lai	X		
Schutte	X		
Chr. Yamashiro	X		
	7	0	2

Publication Date: _____

Hilo, Hawaii
Date: February 3, 1982

SECOND & FINAL READING			
	AYES	NOES	A/E
Dahlberg	X		
De Luz	X		
Domingo	X		
Fujii	X		
Hale	X		
Kawahara	X		
Lai			X
Schutte	X		
Chr. Yamashiro	X		
	8	0	1

Publication Date: FEB 16 1982

We do hereby certify that the foregoing BILL was adopted by the County Council and published as indicated above.

[Signature]
Date FEB 3 1982

[Signature]
Council Chairman

[Signature]
County Clerk

Approved/Disapproved this 9th day of February, 1982.

[Signature]
Mayor, County of Hawaii

Bill No. 815 (REVISED)
Reference: C-612/PC-87
M.B. No. _____
Ord. No. 756