

COUNTY OF HAWAII - STATE OF HAWAII

ORDINANCE NO. 84 23

AN ORDINANCE AMENDING SECTION 25-87 (NORTH KONA ZONE MAP) ARTICLE 3, CHAPTER 25 (ZONING CODE) OF THE HAWAII COUNTY CODE, BY CHANGING THE DISTRICT CLASSIFICATION FROM UNPLANNED (U) TO MULTIPLE FAMILY (RM-5) AND SINGLE FAMILY RESIDENTIAL (RS-15) AT HOLUALOA 1 AND 2, NORTH KONA, HAWAII, COVERED BY TAX MAP KEY 7-6-21:4, 9-13, AND 15-17.

BE IT ORDAINED BY THE COUNCIL OF THE COUNTY OF HAWAII:

SECTION 1. Section 25-87, Article 3, Chapter 25 (Zoning Code) of the Hawaii County Code, is amended to change the district classification of property described hereinafter as follows:

The district classification of the following area situated at Holualoa 1 and 2, North Kona, Hawaii, shall be Multiple Family Residential (RM-5):

(PARCEL 1)

Beginning at the northwest corner of this parcel of land and on the northeasterly side of Kuakini Highway Realignment, Project No. 11A-03-69, the coordinates of said point of beginning referred to Government Survey Triangulation Station "KAILUA," being 9,193.71 feet South and 8,705.53 feet East, thence running by azimuths measured clockwise from true South:

1. 240° 28' 30" 2,903.35 feet along the remainder of R.P. 4475, L.C. Aw. 7713, Ap. 43 to Victoria Kamamalu;
2. 255° 18' 17.97 feet along same;
3. 311° 55' 219.92 feet along same;
4. 331° 14' 15" 143.36 feet along same;

Thence along Stream Lot 14 for the next thirteen (13) courses, the direct azimuths and distances being:

5.	96°	54'	67.99 feet;
6.	112°	56'	86.79 feet;
7.	90°	55'	56.48 feet;
8.	69°	49'	76.70 feet;
9.	46°	39'	114.37 feet;
10.	51°	06'	83.31 feet;
11.	76°	01'	139.84 feet;
12.	51°	29'	175.76 feet;
13.	66°	32'	91.49 feet;
14.	44°	49'	170.06 feet;
15.	25°	59'	247.57 feet;
16.	37°	21'	124.60 feet;
17.	31°	20' 30"	825.56 feet;

Thence along Stream Lot 15 for the next ten (10) courses, the azimuths and distances being:

18.	37°	01'	57.76 feet;
19.	66°	24'	138.13 feet;
20.	44°	01'	114.46 feet;
21.	67°	01'	134.84 feet;
22.	102°	13'	107.13 feet;
23.	69°	30'	139.97 feet;
24.	31°	40'	114.38 feet;
25.	88°	52'	64.54 feet;
26.	114°	04'	60.04 feet;
27.	77°	28'	132.01 feet;

28.	152°	18'	10"	95.72 feet along Kuakini Highway Realignment Project No. 11A-03-69;
29.	139°	59'	30"	20.75 feet along same;
30.	99°	48'	30"	35.58 feet along same;
31.	154°	11'	"	597.05 feet along same to the point of beginning and containing an area of 37.936 Acres. (Refer to Parcel 1 as shown on Exhibit A)

The district classification of the following area situated at Holualoa 1 and 2, North Kona, Hawaii, shall be Multiple Family Residential (RM-5):

(PARCEL 2)

Beginning at the southeast corner of this parcel of land, being the northeast corner of Stream Lot 15, the coordinates of said point of beginning referred to Government Survey Triangulation Station "KAILUA," being 9,565.90 feet South and 11,749.51 feet East, thence running by azimuths measured clockwise from true South:

Along Stream Lot 15 for the next thirteen (13) courses, the direct azimuths and distances being:

1.	65°	05'	2.53 feet;
2.	98°	56'	151.87 feet;
3.	121°	57'	191.39 feet;
4.	95°	15'	205.20 feet;
5.	96°	50'	273.37 feet;
6.	74°	55'	132.84 feet;
7.	107°	39'	54.73 feet;
8.	90°	53'	191.87 feet;
9.	129°	17'	96.53 feet;
10.	80°	07'	71.22 feet;

11.	53°	36'		104.76 feet;
12.	83°	27'		205.32 feet;
13.	84°	08'		104.72 feet;

Thence along Stream Lot 14 for the next thirteen (13) courses, the direct azimuths and distances being:

14.	211°	20'	30"	763.45 feet;
15.	217°	21'		127.42 feet;
16.	205°	59'		243.59 feet;
17.	224°	49'		148.60 feet;
18.	246°	32'		87.91 feet;
19.	231°	29'		170.64 feet;
20.	256°	01'		140.06 feet;
21.	231°	06'		98.89 feet;
22.	226°	39'		104.41 feet;
23.	249°	49'		53.22 feet;
24.	270°	55'		33.64 feet;
25.	292°	56'		83.57 feet;
26.	276°	54'		90.29 feet;
27.	354°	02'		55.41 feet along the remainder of R.P. 4475, L.C. Aw. 7713, Ap. 43 to Victoria Kamamalu;
28.	21°	41'	50"	8.60 feet along same;
29.	359°	37'	20"	20.09 feet along same;
30.	5°	07'	20"	44.89 feet along the remainder of R.P. 4475, L.C. Aw. 7713, Ap. 43 to Victoria Kamamalu and along the remainder of R.P. 8217, L.C. Aw. 3660 to John P. Munn;

31.	355°	00'	65.72 feet along the remainder of R.P. 8217, L.C. Aw. 3660 to John P. Munn and along the remainder of R.P. 4475, L.C. Aw. 7713, Ap. 43 to Victoria Kamamalu;
32.	3°	05'	265.06 feet along the remainder of R.P. 4475, L.C. Aw. 7713, Ap. 43 to Victoria Kamamalu;
33.	77°	08'	20.55 feet along same;
34.	4°	39'	203.73 feet along same;
35.	347°	02'	187.60 feet along same;
36.	337°	00'	679.20 feet along same to the point of beginning and containing an area of 30.901 Acres. (Refer to Parcel 2 as shown on Exhibit A)

The district classification of the following area situated at Holualoa 1 and 2, North Kona, Hawaii, shall be Single Family Residential (RS-15):

(PARCEL 3)

Beginning at the southwest corner of this parcel of land and on the easterly side of Kailua-Keauhou Middle Road, the coordinates of said point of beginning referred to Government Survey Triangulation Station "KAILUA," being 12,047.12 feet South and 11,089.83 feet East, thence running by azimuths measured clockwise from true South:

Along Kailua-Keauhou Middle Road for the next thirty-six (36) courses, the direct azimuths and distances being:

1.	172°	54'	30"	186.38 feet;
2.	177°	19'		91.93 feet;
3.	167°	17'	30"	51.67 feet;
4.	185°	12'		69.99 feet;
5.	192°	52'		74.50 feet;

6.	173°	31'	30"	20.57 feet;
7.	161°	40'	30"	49.48 feet;
8.	141°	33'		41.74 feet;
9.	128°	06'		63.19 feet;
10.	135°	52'		140.78 feet;
11.	124°	23'	30"	65.66 feet;
12.	113°	18'		37.19 feet;
13.	119°	09'	30"	50.14 feet;
14.	111°	13'	30"	24.45 feet;
15.	107°	15'		108.48 feet;
16.	102°	13'		70.44 feet;
17.	112°	58'		84.72 feet;
18.	115°	15'	30"	178.23 feet;
19.	121°	06'		87.41 feet;
20.	111°	55'		32.57 feet;
21.	110°	49'	30"	55.63 feet;
22.	104°	37'		24.92 feet;
23.	104°	38'	30"	35.05 feet;
24.	102°	57'	30"	40.04 feet;
25.	112°	43'	30"	58.53 feet;
26.	102°	40'		32.94 feet;
27.	95°	37'	30"	32.48 feet;
28.	104°	23'		85.44 feet;
29.	91°	43'		44.66 feet;
30.	99°	18'	30"	25.27 feet;
31.	112°	14'		66.03 feet;

32.	117°	51'	30"	31.69 feet;
33.	125°	07'		43.90 feet;
34.	134°	37'	30"	40.62 feet;
35.	134°	37'	30"	41.48 feet;
36.	134°	00'	30"	47.64 feet;
37.	154°	11'		400.86 feet along Kuakini Highway Realignment, Project No. 11A-03-69;
38.	240°	28'	30"	1,332.99 feet along the remainder of R.P. 4475, L.C. Aw. 7713, Ap. 43 to Victoria Kamamalu (Lot 4);
39.	150°	28'	30"	337.56 feet along same;

Thence along Stream Lot 15 for the next ten (10) courses, the direct azimuths and distances being:

40.	233°	36'		91.73 feet;
41.	260°	07'		29.64 feet;
42.	309°	17'		89.97 feet;
43.	270°	53'		203.93 feet;
44.	286°	30'		113.50 feet;
45.	267°	11'		352.71 feet;
46.	275°	15'		185.94 feet;
47.	301°	57'		189.37 feet;
48.	278°	56'		182.35 feet;
49.	245°	05'		10.28 feet;
50.	345°	30'		902.50 feet along the remainder of R.P. 4475, L.C. Aw. 7713, Ap. 43 to Victoria Kamamalu and along the remainder of Grant 3630 to W. H. Cornwell;

51.	334°	30'		969.30 feet along the remainder of R.P. 4475, L.C. Aw. 7713, Ap. 43 to Victoria Kamamalu;
52.	2°	00'		537.04 feet along same;
53.	86°	51'	30"	120.73 feet along Grant 988 to Kamalo;
54.	93°	48'		45.22 feet along same;
55.	84°	14'		106.16 feet along same;
56.	104°	06'	30"	41.60 feet along same;
57.	77°	41'	30"	76.19 feet along Grant 988 to Kamalo and along Grant 1591 to Hoolawaihonua;

Thence along Grant 1591 to Hoolawaihonua for the next nine (9) courses, the direct azimuths and distances being:

58.	82°	34'		126.79 feet;
59.	142°	51'		32.82 feet;
60.	81°	37'		106.15 feet;
61.	67°	57'	30"	30.29 feet;
62.	83°	03'	30"	258.61 feet;
63.	72°	49'	30"	90.07 feet;
64.	84°	37'	30"	76.23 feet;
65.	78°	08'		62.37 feet;
66.	82°	02'	30"	157.05 feet to the point of beginning and containing an area of 103.293 Acres. (Refer to Parcel 3 as shown on Exhibit A)

All as shown on the map attached hereto, marked Exhibit "A" and by reference made a part hereof.

SECTION 2. These changes in district classification are conditioned upon the following:



- (A) The zoning for the property shall be effective only after:  
(1) there are assurances satisfactory to the Departments of Water Supply and Planning, upon consultation with the State Department of Health, and the Division of Water and Land Development of the State Department of Land and Natural Resources, that a water source of sufficient quality and quantity has been established within two years from the effective date of this ordinance; provided that a maximum one-year extension to the two-year time limit may be granted by the Planning Director with reasonable and sufficient justification; and (2) an agreement, accompanied by an appropriate surety bond or other acceptable security, is executed with the Department of Water Supply for the actual development of a proven water source and its water transmission and distribution system within one year from the official date of compliance with condition A(1); provided that a one-year extension to the one-year time limit may be granted by the Planning Director with reasonable and sufficient justification; or (3) the Department of Water Supply issues a water commitment for the proposed development;
- (B) No subdivision or development of any portion of the land shall occur unless and until condition A has been complied with;
- (C) The Planning Director shall be mandated to initiate action for the repeal of this ordinance if conditions A or B have not been complied with;
- (D) The petitioner, its assigns or successors, shall be responsible for complying with all conditions of approval;
- (E) The zoning for the 49+ acres designated by the State Land Use Commission as its second zoning increment shall not become effective until that land is certified by that commission to be within the Urban District;
- (F) The RS zoned area shall be developed in two increments. The first increment shall consist of a maximum of 59.5+ contiguous acres, and the second, the remaining area. The effective date of zoning for the second increment shall be after development has occurred in the first increment, as determined by the Planning Director. "Development" means that building permits have been issued for dwelling units and construction has been partially completed to the extent that roofs have been constructed on a minimum of twenty-five percent of the number of units proposed for the entire area of 103.4+ acres. In lieu of actual construction, the petitioner may enter into an agreement with the Hawaii County Housing Agency to assure the County that the dwellings will be constructed within a given period. Such agreement shall be secured by a surety bond, certified check, or other security acceptable to Corporation Counsel and the Hawaii County Housing Agency. Upon final execution of such agreement and filing of the security with the Hawaii County Housing

Agency, the zoning of the second increment may be deemed by the Planning Director to be effective prior to the actual construction of the dwellings in the first increment provided that condition E is complied with;

- (G) Subdivision plans for the first increment of the RS zoned area shall be submitted within one year from the effective date of the zoning. Final subdivision approval shall be secured within one year from the date of receipt of tentative subdivision approval;
- (H) The RM zoned area shall be developed in two increments. The first increment shall consist of a maximum of 42 acres of the Multiple Family Residential zoned land and the second increment, the remaining area. The effective date of zoning for the second increment shall be after "development," as defined in condition F, has occurred in the first increment, as determined by the Planning Director;
- (I) Plans for the development within the first increment of the RM zoned area shall be submitted to the Planning Department and final plan approval secured within one year from the effective date of the zoning. Construction shall commence within one year from the date of receipt of final plan approval and be completed within three years thereafter;
- (J) Housing opportunities for Hawaii residents shall be provided in accordance with the condition imposed by the State Land Use Commission. The number of units and manner in which they are to be provided shall meet with the approval of the Hawaii County Housing Agency;
- (K) Improvements to the intersections with Kuakini Highway and the Kuakini Highway Extension shall be constructed meeting with the approval of the State Department of Transportation, Highways Division. The intersection improvements shall be constructed concurrently with the development of the first increment of the RS or RM zoned areas, whichever occurs first;
- (L) No direct access shall be provided for the lots within the RS zoned area from the mauka-makai collector road;
- (M) The roadways within the RM zoned area which are proposed for dedication shall be constructed to dedicable standards with curbs, gutters, and sidewalks meeting with the approval of the Department of Public Works. Where a roadway crosses a zone line or if a zone line should divide a roadway, the curbs, gutters, and sidewalks shall be provided for the entire right-of-way and shall continue to the nearest intersection in order to avoid telescoping and to provide consistent improvement;
- (N) At a minimum, roadways within the RS zoned area shall be provided with paved shoulders and paved swales meeting with the approval of the Department of Public Works;

- (O) The method of sewage disposal shall meet with the approval of the appropriate governmental agencies;
- (P) A drainage master plan shall be submitted to the Department of Public Works for review and approval prior to issuance of any subdivision or plan approvals. The plan shall include, as a minimum, hydrological and hydraulic calculations for all components of the drainage system, a construction timetable for all elements of the system, and an analysis of downstream impacts. Further, mitigating measures as approved by the Department of Public Works shall be taken to eliminate any downstream impacts;
- (Q) An intensive archaeological survey shall be conducted for the entire property and a report shall be submitted to the Planning Department prior to issuance of any subdivision or plan approvals;
- (R) Should any unanticipated archaeological sites be found during land preparation activities, work shall immediately stop and the Planning Department notified. Work shall not resume in the affected area until clearance is given by the Planning Department; and,
- (S) All other applicable rules, regulations and requirements shall be complied with. Should any of the foregoing conditions not be met, rezoning of the area to its original or more appropriate designation may be initiated.

SECTION 3. In the event that any portion of the ordinance is declared invalid, such invalidity shall not affect other parts of this ordinance.

SECTION 4. This ordinance shall take effect upon its approval.

Introduced by:

  
COUNCIL MEMBER, COUNTY OF HAWAII

Hilo, Hawaii

Date of Introduction:	April 18, 1984
Date of 1st Reading:	April 18, 1984
Date of 2nd Reading:	May 9, 1984
Effective Date:	May 15, 1984

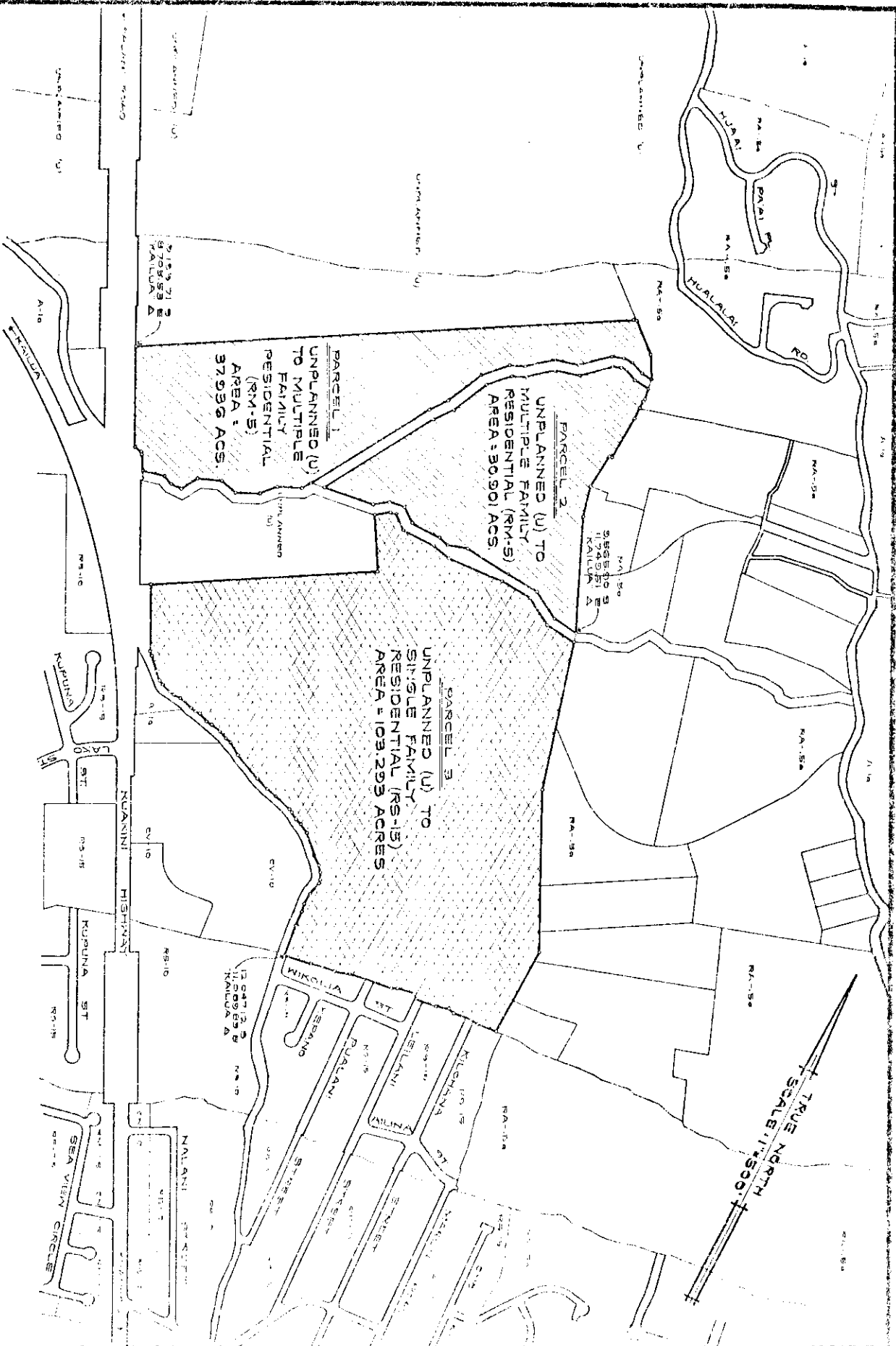

PREPARED BY:  
PLANNING DEPARTMENT  
COUNTY OF HAWAII  
TAX MAP KEY: 7-8-21, 4, 9-13, 15-17

## AMENDMENT TO THE ZONING CODE

AMENDING SECTION 25-87 (NORTH KONA ZONE MAP) ARTICLE 3, CHAPTER 25 (ZONING CODE) OF THE HAWAII COUNTY CODE, BY CHANGING THE DISTRICT CLASSIFICATION FROM UNPLANNED (U) TO MULTIPLE FAMILY RESIDENTIAL (RM-5) AND SINGLE FAMILY RESIDENTIAL (RS-15) AT HUALALAI 1 AND 2, NORTH KONA, HAWAII.